

F.A.P. RITE	SECTION	COUNTY	TOTAL SHEETS	SHEET NO.
331	*	JACKSON	298	68
STA.		TO STA.		
FED. ROAD DIST. NO.		ILLINOIS	FED. AID PROJECT	
* (12-1)2N,1-5,TS-3,B-1				

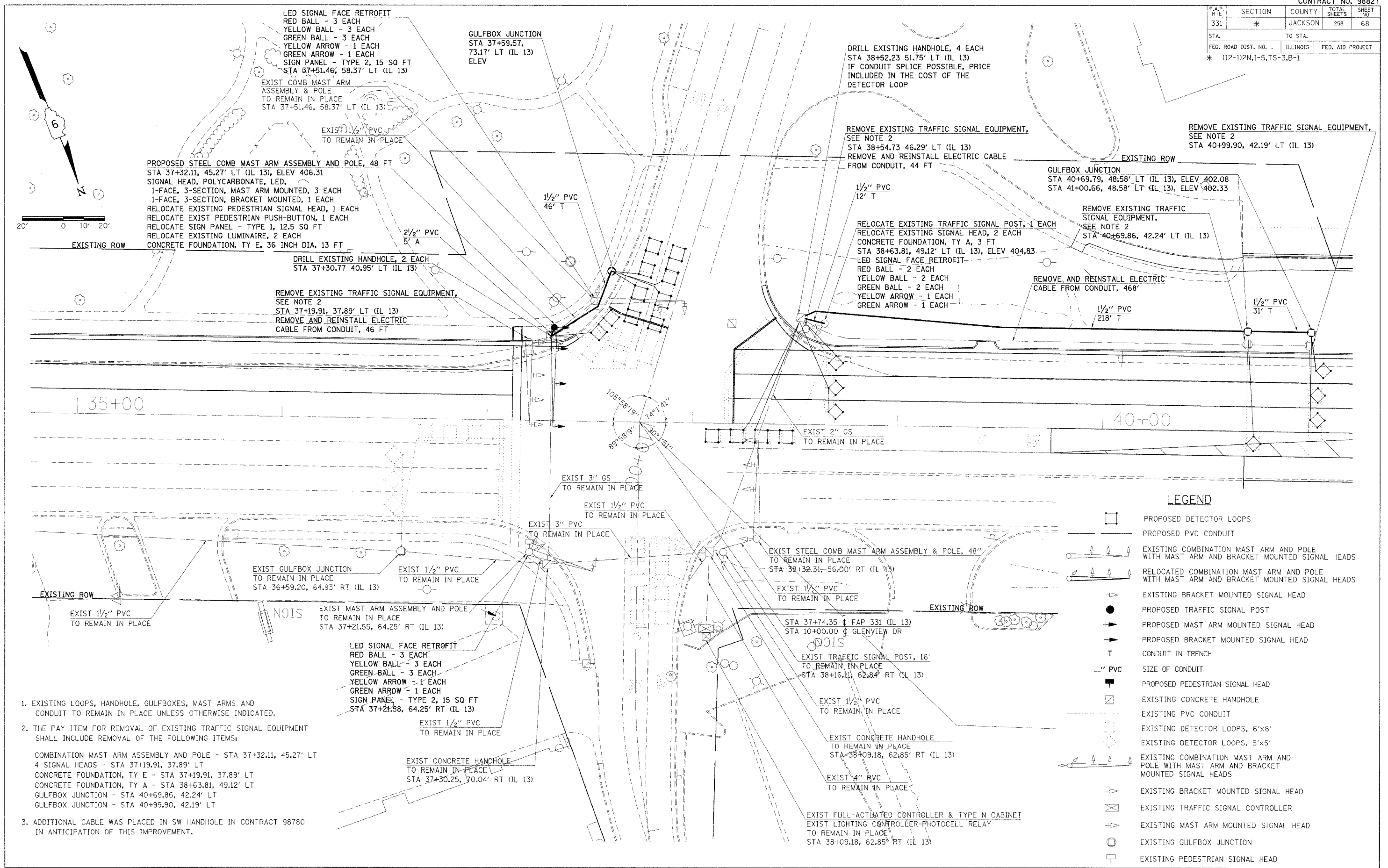

- EXISTING LOOPS, HANDHOLE, GULFBXES, MAST ARMS AND CONDUIT TO REMAIN IN PLACE UNLESS OTHERWISE INDICATED.
- THE PAY ITEM FOR REMOVAL OF EXISTING TRAFFIC SIGNAL EQUIPMENT SHALL INCLUDE REMOVAL OF THE FOLLOWING ITEMS:  
  
COMBINATION MAST ARM ASSEMBLY AND POLE - STA 37+32.11, 45.27' LT  
4 SIGNAL HEADS - STA 37+19.91, 37.89' LT  
CONCRETE FOUNDATION, TY E - STA 37+19.91, 37.89' LT  
CONCRETE FOUNDATION, TY A - STA 38+63.81, 49.12' LT  
GULFBOX JUNCTION - STA 40+69.86, 42.24' LT  
GULFBOX JUNCTION - STA 40+99.90, 42.19' LT
- ADDITIONAL CABLE WAS PLACED IN SW HANDHOLE IN CONTRACT 98780 IN ANTICIPATION OF THIS IMPROVEMENT.

**PROPOSED TRAFFIC SIGNAL & LIGHTING  
ILLINOIS 13 & GLENVIEW DRIVE**