

F.A.P. RTE.	SECTION	COUNTY	TOTAL SHEETS	SHEET NO.
331	*	JACKSON	258	91

STA. 24+50.00 TO STA. 25+00.00
FED. ROAD DIST. NO. 7 ILLINOIS FED. AID PROJECT

DATE	BY

FINAL SURVEY SUBMITTED BY: []
NOTE BOOK NO. []
PLANNING AREA CHECKED: []

DATE	BY

ORIGINAL SURVEY SUBMITTED BY: []
NOTE BOOK NO. []
PLANNING AREA CHECKED: []

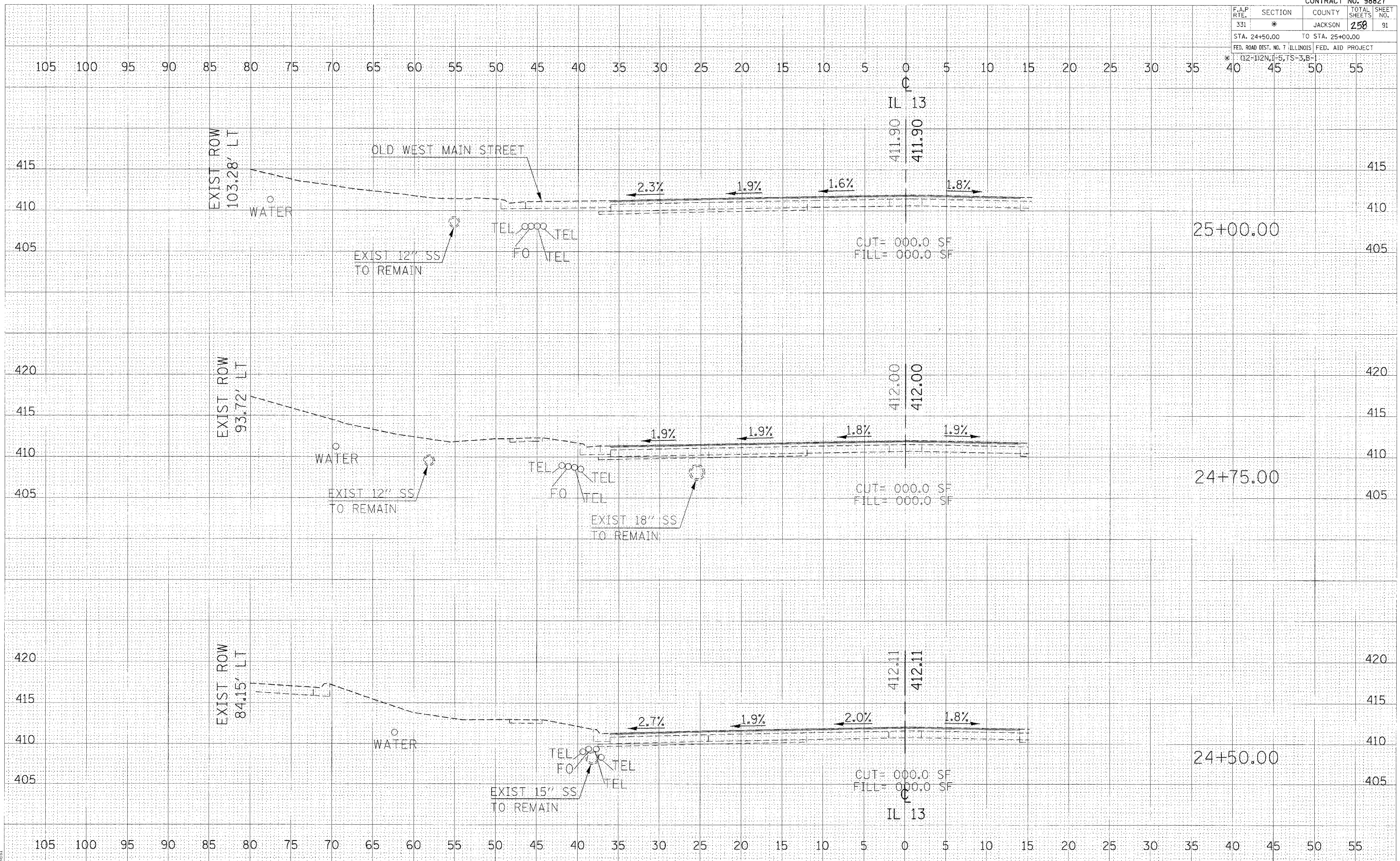

CROSS SECTIONS - IL 13