

F.A.P. RTE.	SECTION	COUNTY	TOTAL SHEETS	SHEET NO.
331	*	JACKSON	258	97

STA. 28+39.62 TO STA. 28+75.00

FED. ROAD DIST. NO. 7 ILLINOIS FED. AID PROJECT

* (112-112N, 1-5, TS-3, B-1)

DATE	BY
DATE	BY
DATE	BY

DATE	BY
DATE	BY
DATE	BY

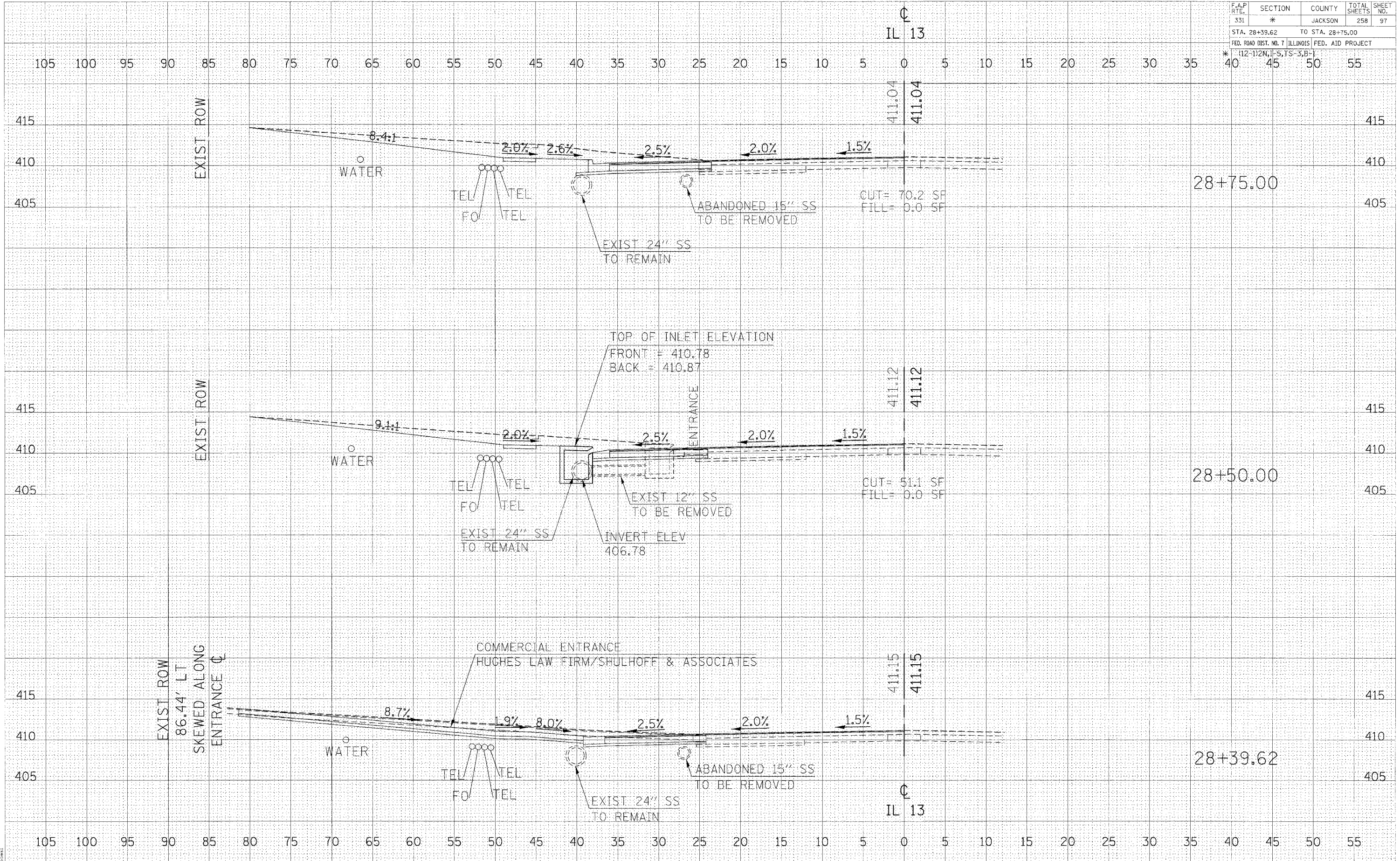

2/15/2006
 c:\projects\98827\112\112n\1-5\ts-3\B-1.dwg
 p:\112\112n\1-5\ts-3\B-1.dwg