

F.A.P. RTE.	SECTION	COUNTY	TOTAL SHEETS	SHEET NO.
331	*	JACKSON	258	119
STA. 46+98.41		TO STA. 47+23.44		
FED. ROAD DIST. NO. 7 ILLINOIS FED. AID PROJECT				
*(12=1)2N, 1-5, TS-3, B-1				

DATE	
BY	
DESIGNED	
PLOTTED	
NOTE BOOK	
AREAS	
CHECKED	
NO.	

DATE	
BY	
DESIGNED	
PLOTTED	
NOTE BOOK	
AREAS	
CHECKED	
NO.	

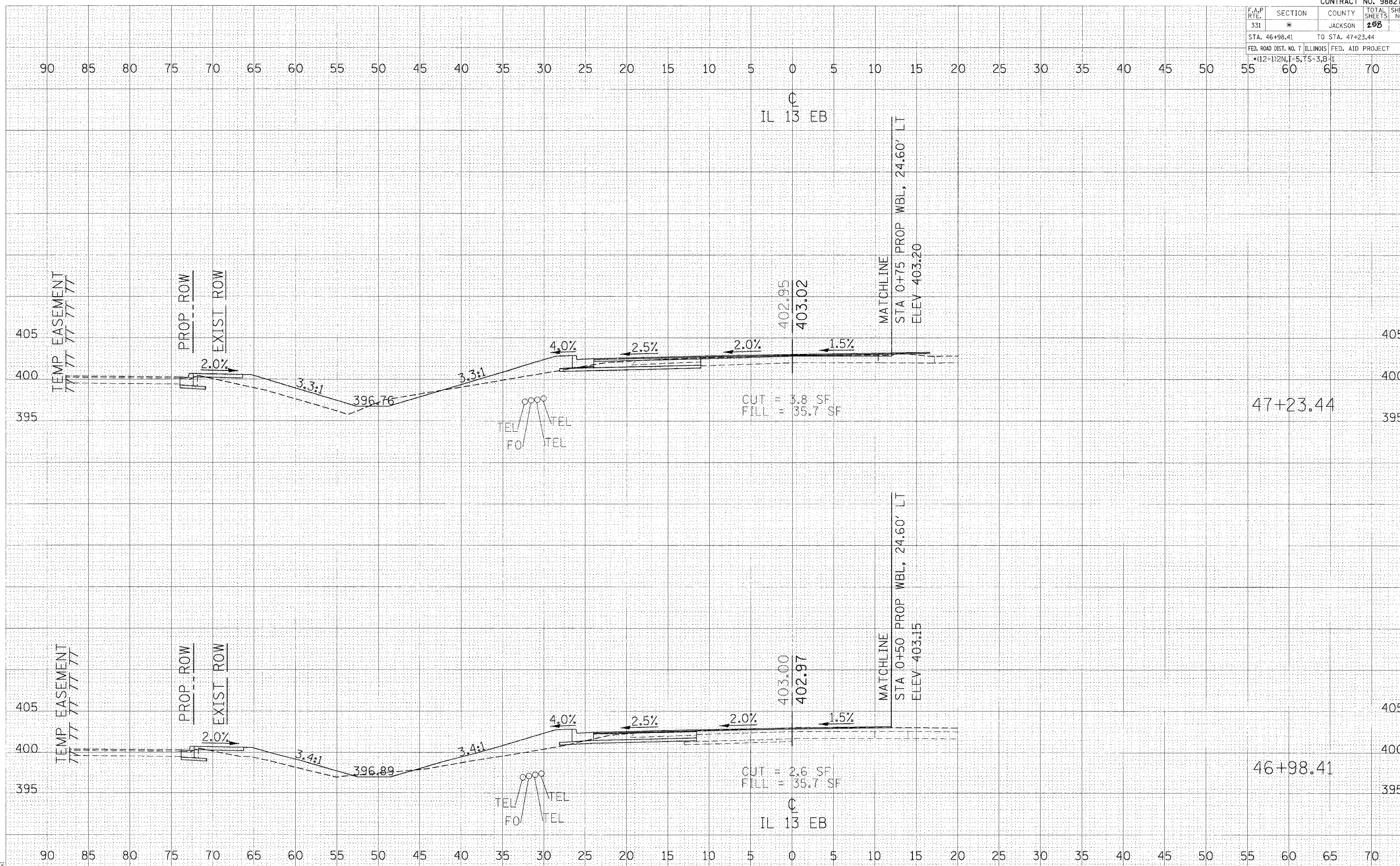

2/15/2006
 C:\p\proj\119\119184423\sheet.dgn
 5:00:00 / IN