

F.A.P. RTE.	SECTION	COUNTY	TOTAL SHEETS	SHEET NO.
331	*	JACKSON	258	140
STA. 57+03.99		TO STA. 57+29.17		
FED. ROAD DIST. NO. 7 ILLINOIS FED. AID PROJECT				

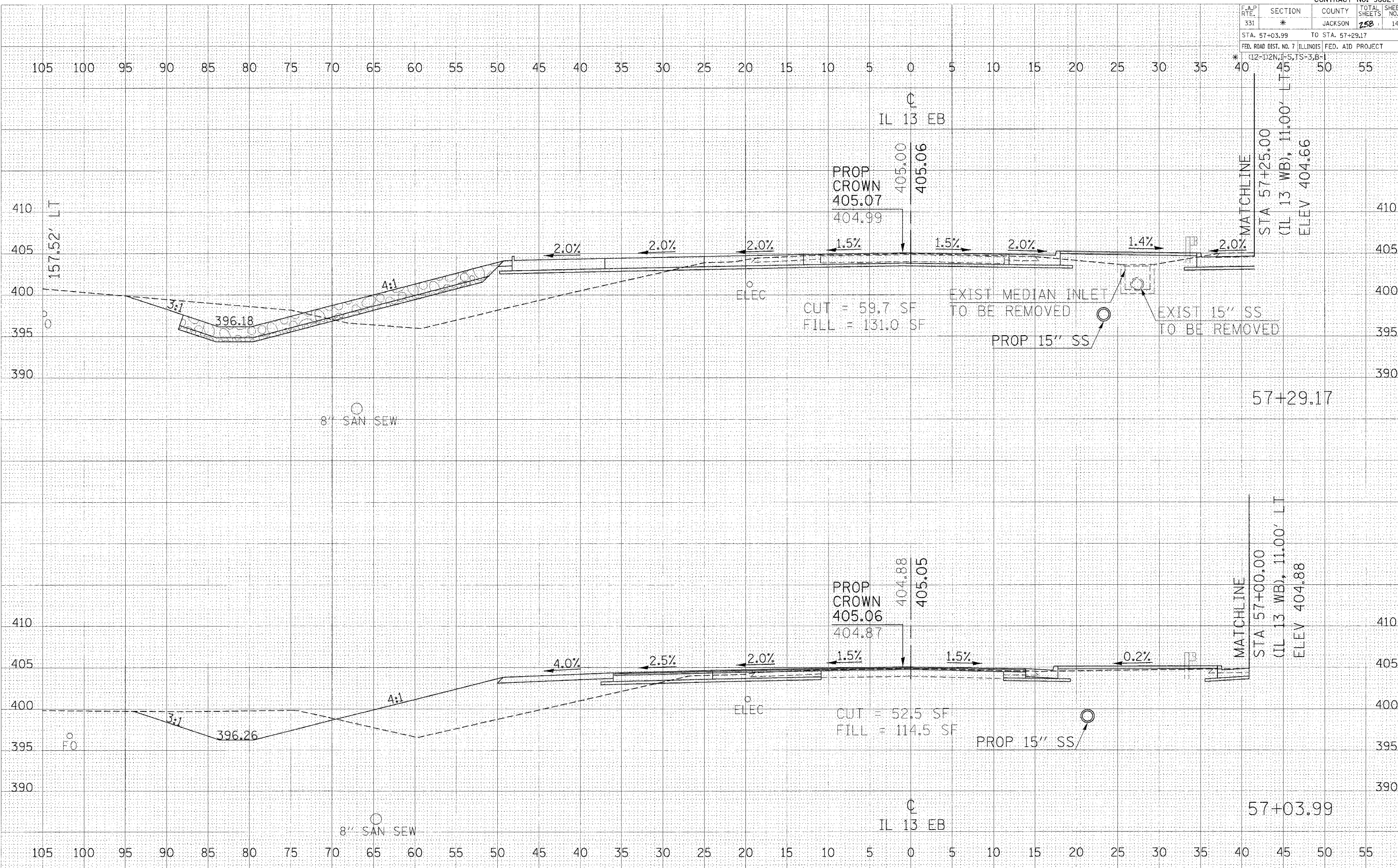

CROSS SECTIONS - IL 13 EB

DATE: _____
 BY: _____
 SURVEYED: _____
 PLOTTED: _____
 CHECKED: _____
 ORIGINAL SURVEY: _____
 NOTE BOOK NO.: _____

DATE: _____
 BY: _____
 SURVEYED: _____
 PLOTTED: _____
 CHECKED: _____
 ORIGINAL SURVEY: _____
 NOTE BOOK NO.: _____

2/15/2006
 en:\proj\secta\proj\403\shp\topo\pab.dwg
 5.00200 / 31