

F.A.P. RTE.	SECTION	COUNTY	TOTAL SHEETS	SHEET NO.
331	*	JACKSON	250	144
STA. 58+80.24		TO STA. 59+05.44		
FED. ROAD DIST. NO. 7 ILLINOIS FED. AID PROJECT				
* (12-1)2N, 1-5, TS-3, B-1				

DATE	BY	APPROVED	DATE
DATE	BY	APPROVED	DATE

DATE	BY	APPROVED	DATE
DATE	BY	APPROVED	DATE

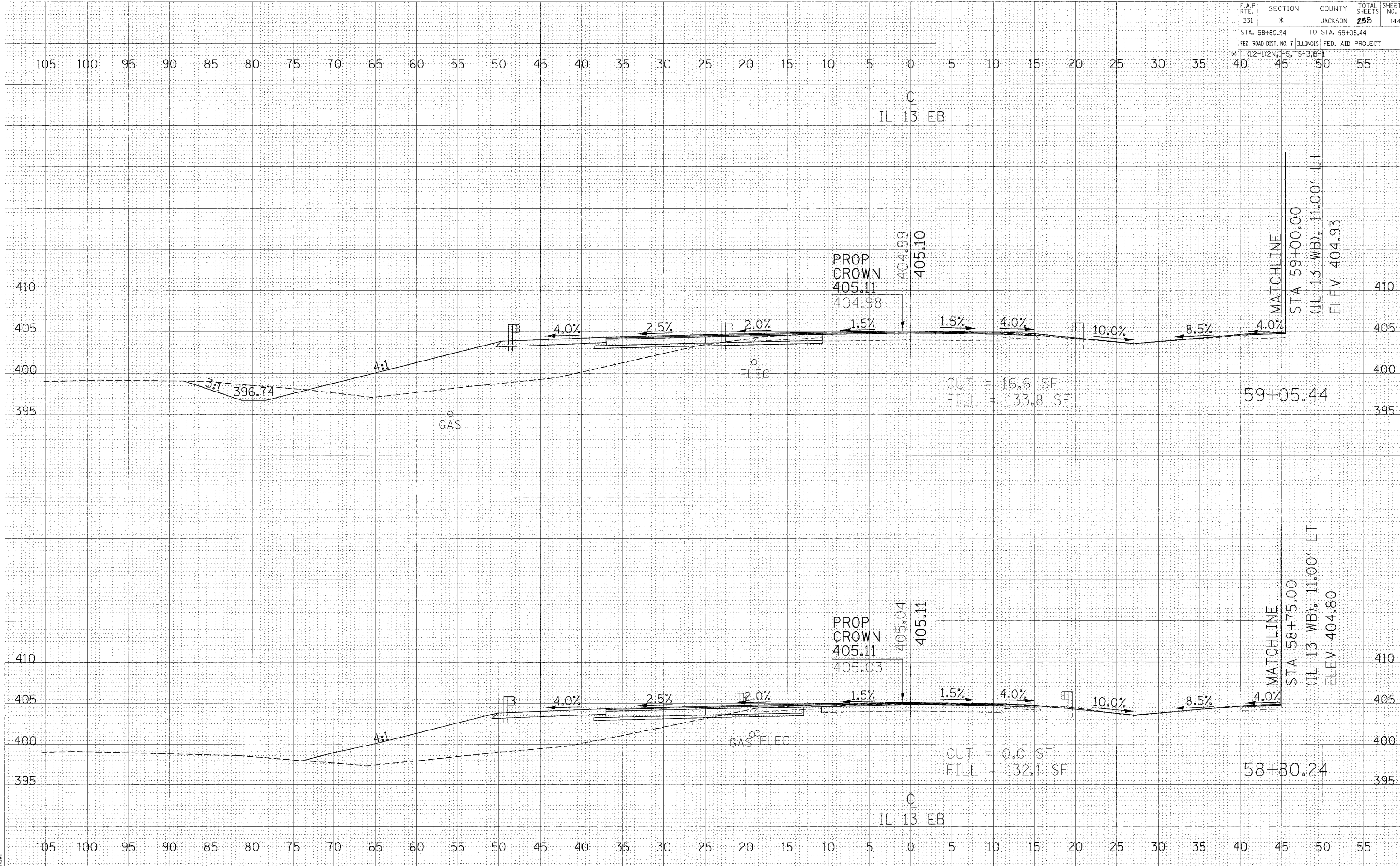

**CROSS SECTIONS - IL 13 EB**

2/15/2006  
 c:\p01\jms\98827\4231\stprreb.dgn  
 1/14  
 pages