

F.A.P. RTE.	SECTION	COUNTY	TOTAL SHEETS	SHEET NO.
331	*	JACKSON	258	196
STA. 8+75.00		STA. 9+25.00		
FED. ROAD DIST. NO. 7 ILLINOIS		FED. AID PROJECT		
* (12-1)2N,1-5,7S-3,B-1				

DATE	BY
DATE	BY
DATE	BY
DATE	BY
DATE	BY

DATE	BY
DATE	BY
DATE	BY
DATE	BY
DATE	BY

2/19/2006
 c:\pwworkspace\1044831483\1044831483\1044831483\1044831483.dgn
 10/1/06

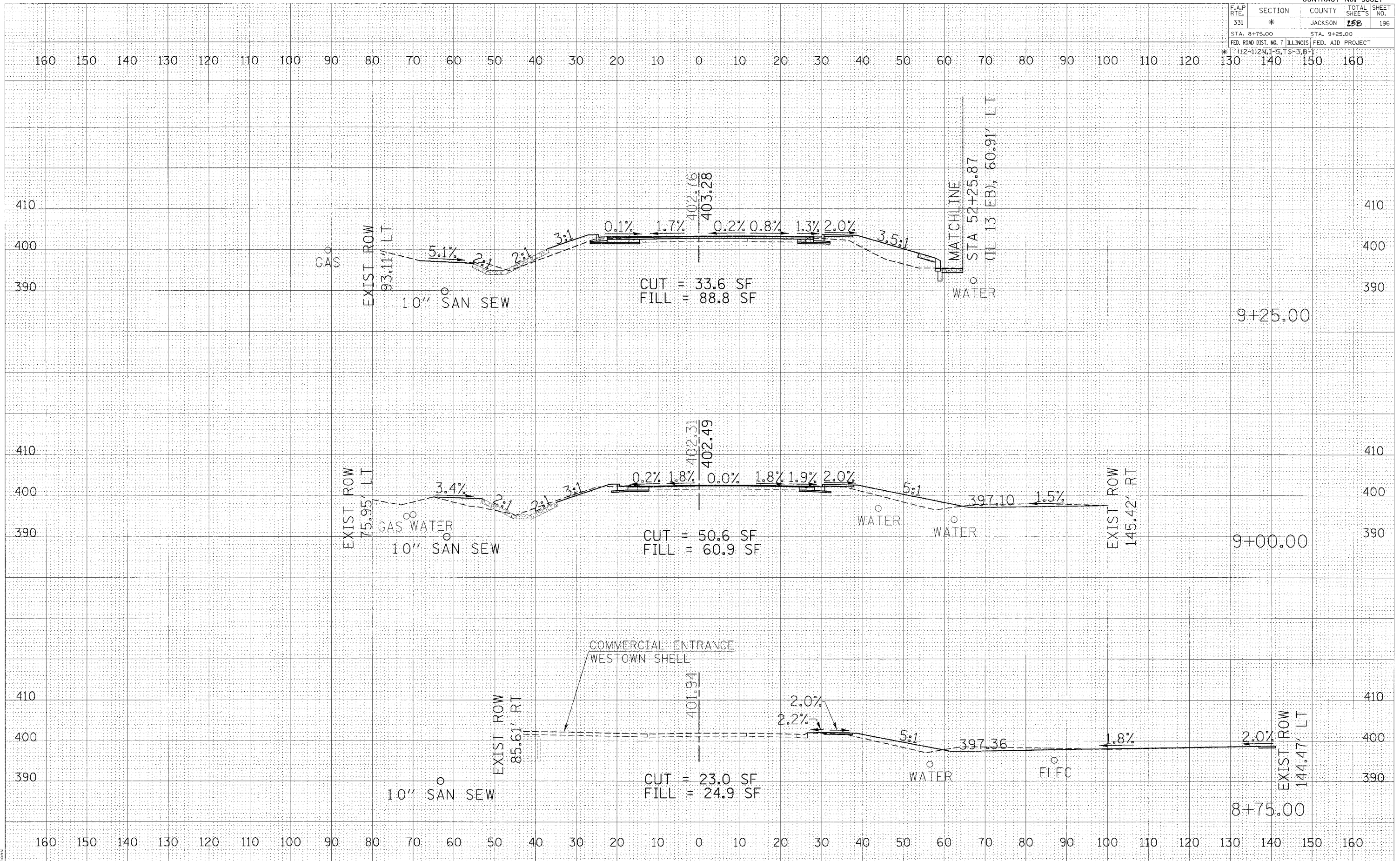

CROSS SECTIONS - EMERALD LANE