

STATE OF ILLINOIS
DEPARTMENT OF TRANSPORTATION

ROUTE NO.	SECTION	COUNTY	SHEET NO.	SHEET NO.
F.A.P. 331	(12-1) B-1	JACKSON	232	32 SHEETS
FED. ROAD DIST. NO. 7	ILLINOIS	FED. AID PROJECT-		

Contract #98827

Note:
Top of slab elevations and offsets are referenced with respect to Eastbound $\text{\textcircled{C}}$ roadway.

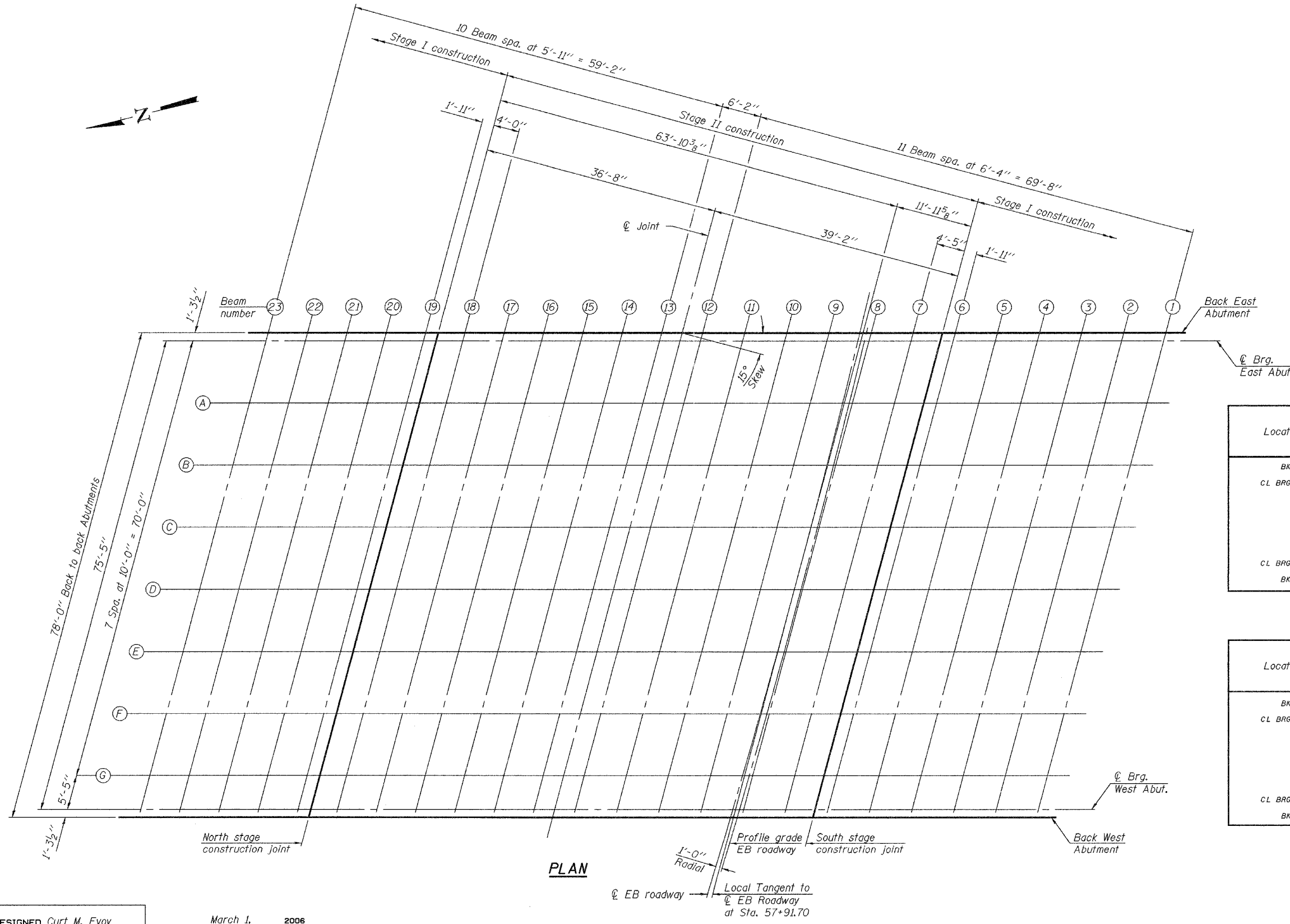

PLAN

$\text{\textcircled{C}}$ EB roadway
Local Tangent to $\text{\textcircled{C}}$ EB Roadway at Sta. 57+91.70
1'-0" Radial
Profile grade EB roadway
South stage construction joint

BEAM 1

Location	Station	Offset	Theoretical Grade Elevations	Theoretical Grade Elevations Adjusted For Dead Load Deflection
BK E. ABUT	5740.767	-45.738	404.206	404.206
CL BRG E. ABUT	5742.053	-45.729	404.206	404.206
A	5751.988	-45.665	404.210	404.271
B	5761.923	-45.616	404.213	404.330
C	5771.858	-45.580	404.216	404.356
D	5781.794	-45.559	404.219	404.370
E	5791.729	-45.552	404.222	404.351
F	5801.665	-45.559	404.224	404.318
G	5811.600	-45.580	404.226	404.259
CL BRG W. ABUT	5816.977	-45.598	404.227	404.227
BK W. ABUT	5818.263	-45.603	404.227	404.227

BEAM 2

Location	Station	Offset	Theoretical Grade Elevations	Theoretical Grade Elevations Adjusted For Dead Load Deflection
BK E. ABUT	5742.409	-39.393	404.338	404.338
CL BRG E. ABUT	5743.696	-39.384	404.338	404.338
A	5753.640	-39.323	404.342	404.403
B	5763.584	-39.276	404.346	404.463
C	5773.528	-39.243	404.349	404.488
D	5783.472	-39.224	404.351	404.503
E	5793.417	-39.219	404.354	404.483
F	5803.361	-39.229	404.356	404.450
G	5813.305	-39.252	404.358	404.391
CL BRG W. ABUT	5818.687	-39.271	404.359	404.359
BK W. ABUT	5819.974	-39.276	404.359	404.359

TOP OF SLAB ELEVATIONS
F.A.P. ROUTE 331 - SEC. (12-1)B-1
JACKSON COUNTY
STATION 57+91.70
STRUCTURE NO. 039-0071

DESIGNED	Curt M. Evoy
CHECKED	Rebecca L. Mitchell
DRAWN	Michael B. Mossman
CHECKED	C.M.E. / R.L.M.

EXAMINED	March 1, 2006	Thomas J. Domagalicki
PASSED		Ralph E. Anderson