



REVISIONS		
NUMBER	BY	DATE

0 1 2  
 THIS BAR IS EQUAL TO 2"  
 AT FULL SCALE (34X22).

**LEGEND**

-  NEW SEEDING (901) AND MULCHING (908)
-  NEW GRADING/LANDSCAPING LIMITS
-  NEW CULVERT AND END SECTION
-  NEW SILT FENCE (156)
-  EXISTING AIRPORT PERIMETER FENCE

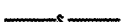
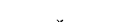
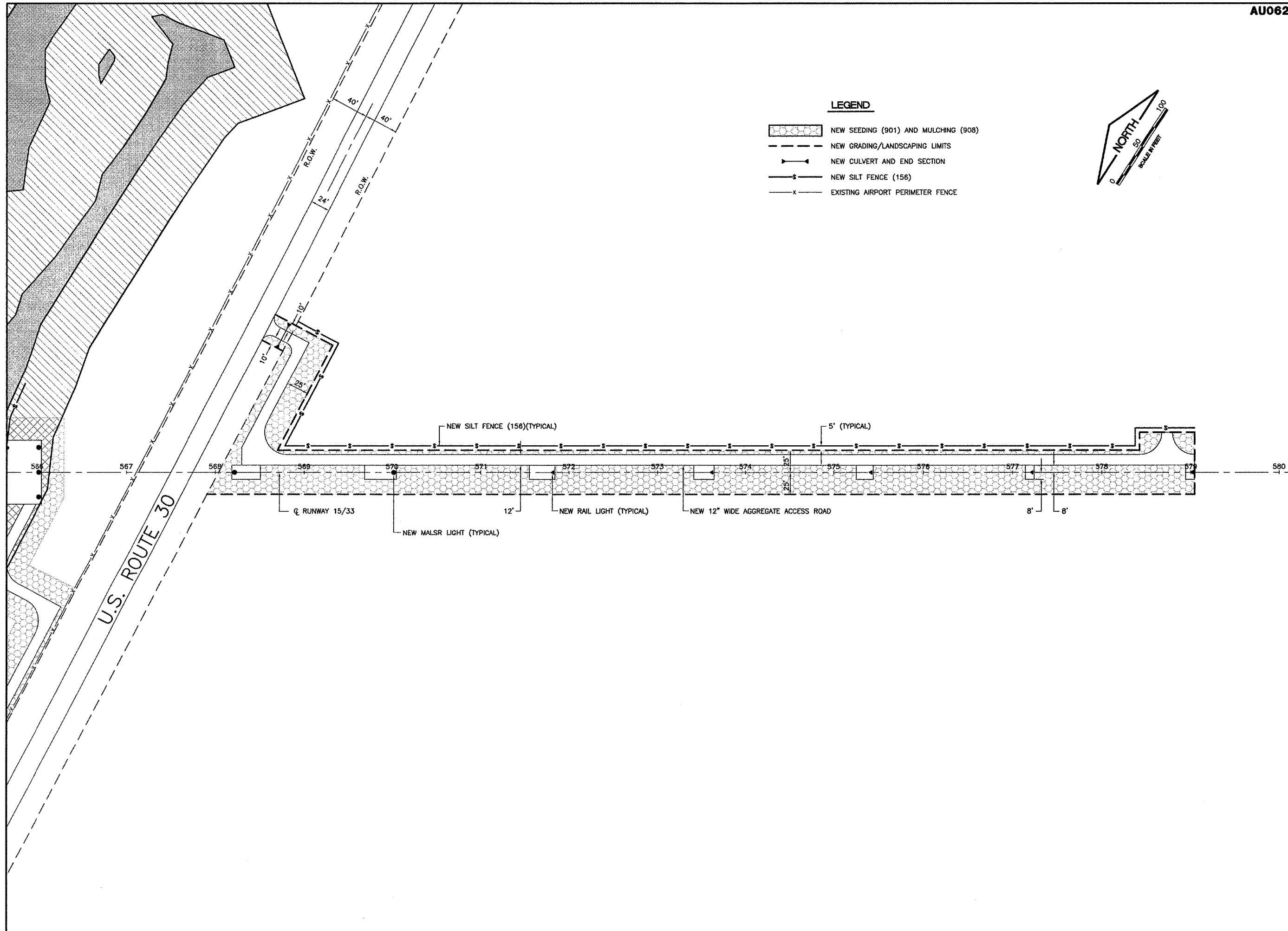
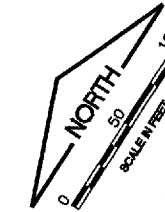

**AURORA MUNICIPAL AIRPORT  
 AURORA, ILLINOIS  
 CONSTRUCT RUNWAY 33 ILS  
 RELOCATE RUNWAY 9 LOCALIZER**

**RUNWAY 33 MALSR STORMWATER  
 POLLUTION PREVENTION PLAN - SHEET 2**

© Copyright GMT, Inc.  
**GMT**  
 CRAWFORD, MERRY & TILLY, INC.  
 CONSULTING ENGINEERS  
 License No. 184-006818

DESIGN BY:	CAL
DRAWN BY:	JRO
CHECKED BY:	CAL
APPROVED BY:	
DATE:	03/03/06
JOB No:	04285-04
ILLINOIS PROJECT: ARR-3468 A.I.P. PROJECT: 3-17-0003-B31 <b>FINAL SUBMITTAL</b>	
SHEET 11 OF 66 SHEETS	