

**NOTES**

1. AREAS ADJACENT TO PROPOSED BITUMINOUS MAINTENANCE DRIVEWAYS DISTURBED BY CONSTRUCTION WILL BE TOPSOILED, (152) LANDSCAPED USING IDOT CLASS 1 SEED MIX (901) AND MULCHED (908).
2. EXISTING AGGREGATE SHOULDER AND GRAVEL FIELD ENTRANCE REMOVAL TO FACILITATE NEW MAINTENANCE DRIVEWAY CONSTRUCTION SHALL BE PAID FOR AS UNCLASSIFIED EXCAVATION (152).
3. TYPE 2 BARRICADES WITH LONG LEGS ARE REQUIRED FOR U.S. ROUTE 30 EDGE DROP-OFFS GREATER THAN 2" (COST INCIDENTAL TO THE CONTRACT).
4. TEMPORARY FLAGGING ON U.S. ROUTE 30 MAY BE REQUIRED FOR MATERIAL DELIVERIES (COST INCIDENTAL TO THE CONTRACT).
5. CONTRACTOR SHALL INSTALL UTILITY MARKER BY FLEXSTAKE OR EQUAL AT EACH END OF CONDUITS (COST INCIDENTAL TO CONDUITS).

**LEGEND**

- NEW BITUMINOUS PAVEMENT
- NEW GRAVEL ACCESS ROADWAY/MAINTENANCE AREA
- NEW GRS CONDUIT
- MALSRS - NEW POWER AND CONTROL CABLES
- PROPOSED TYPE 2 BARRICADES
- EXISTING RIGHT OF WAY (R.O.W.)
- EXISTING FENCE
- EXISTING OVERHEAD ELECTRIC
- EXISTING UTILITY POLE
- EXISTING WATERMAIN
- EXISTING TELEPHONE LINE
- EXISTING GAS LINE
- EXISTING CONTOUR
- EXISTING BUILDING
- EXISTING TREE TO BE REMOVED W/ TRUNK DIAMETER

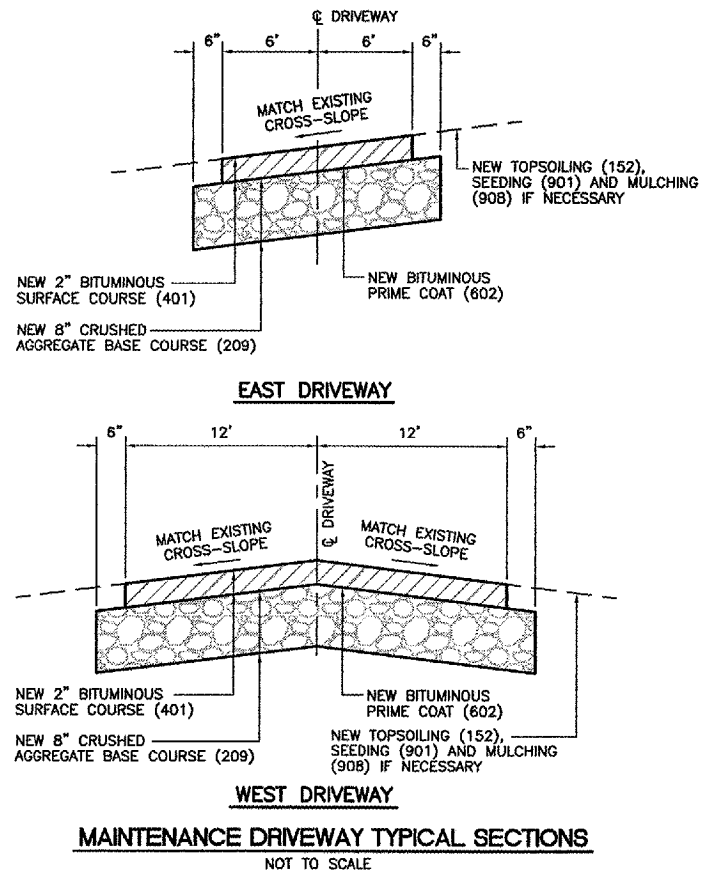

**AU062**

PATH: K:\042850400\DRAW\SHEETS  
FILE: rte30row.dwg  
UPDATE BY: .  
SURVEY BOOK #  
XREF DWG:  
XREF DWG:  
DATE: .

**REVISIONS**

NUMBER	BY	DATE

0 1 2  
THIS BAR IS EQUAL TO 2" AT FULL SCALE (34X22).



**AURORA MUNICIPAL AIRPORT  
AURORA, ILLINOIS  
CONSTRUCT RUNWAY 33 ILS,  
RELOCATE RUNWAY 9 LOCALIZER  
RUNWAY 33 MALSRS U.S. ROUTE 30  
SITE PLAN**

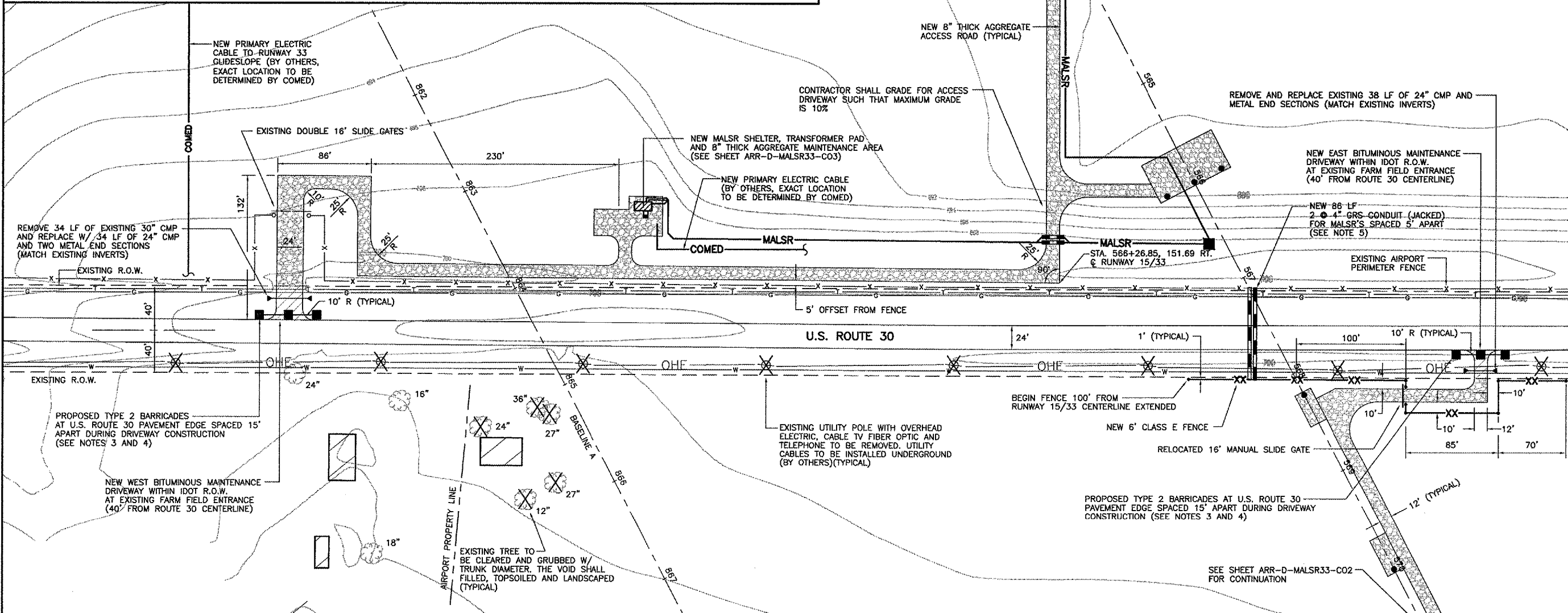

© copyright CMT, Inc.  
**CMT**  
CRAWFORD, MURPHY & TILLY, INC.  
CONSULTING ENGINEERS  
License No. 184-000613

DESIGN BY:	CAL
DRAWN BY:	JRG
CHECKED BY:	CAL
APPROVED BY:	
DATE:	03/03/06
JOB No:	04285-04
ILLINOIS PROJECT: ARR-3468 A.I.P. PROJECT: 3-17-0003-B31 <b>FINAL SUBMITTAL</b>	
SHEET 16 OF 66 SHEETS	