

REVISIONS		
NUMBER	BY	DATE

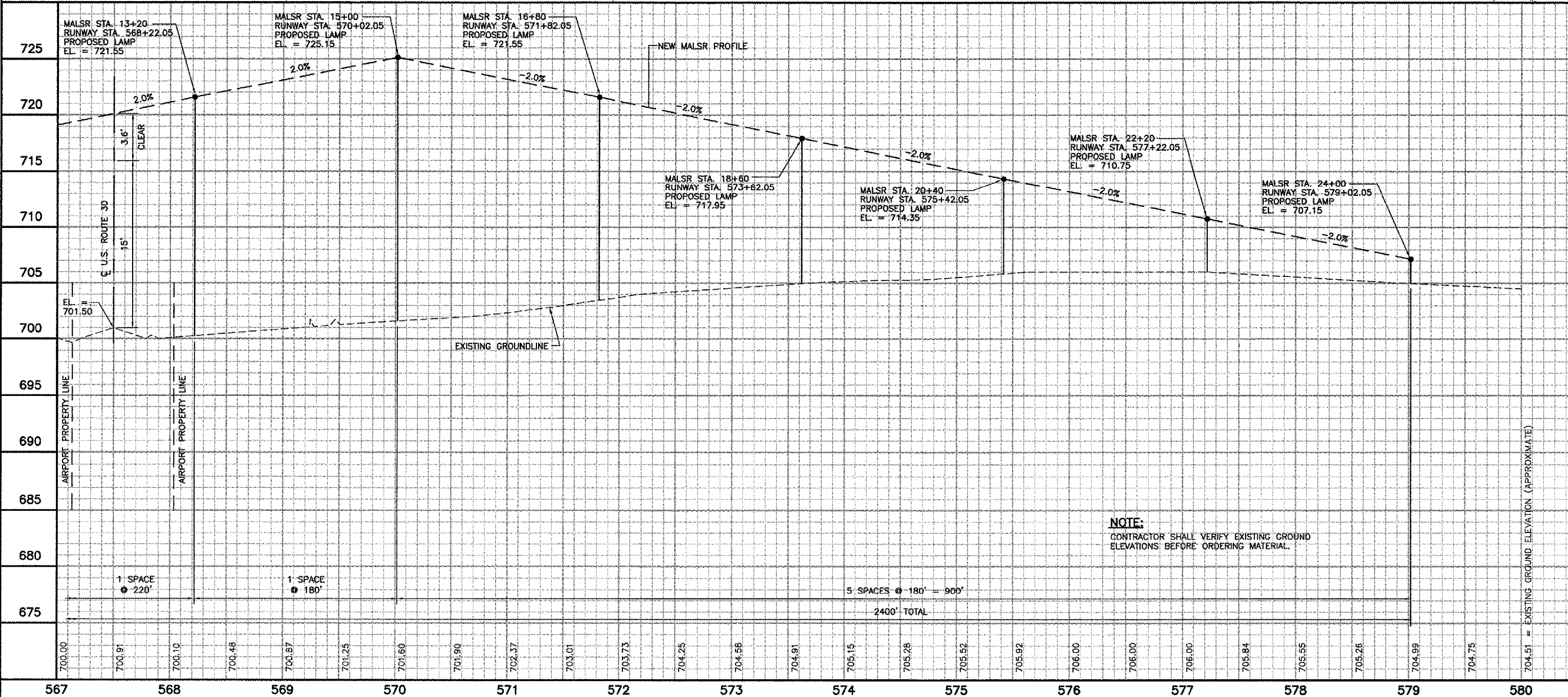
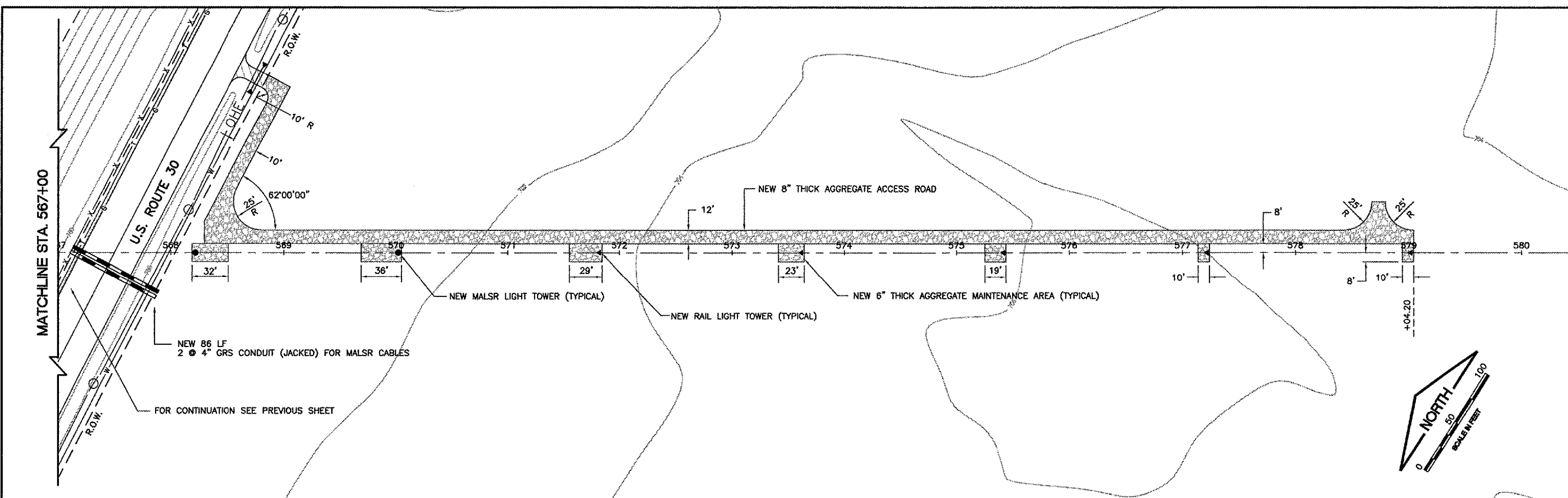
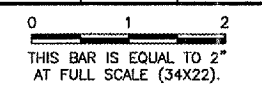

NOTE:
 CONTRACTOR SHALL VERIFY EXISTING GROUND ELEVATIONS BEFORE ORDERING MATERIAL.

EXISTING GROUND ELEVATION (APPROXIMATE)

**AURORA MUNICIPAL AIRPORT
 AURORA, ILLINOIS
 CONSTRUCT RUNWAY 33 ILS,
 RELOCATE RUNWAY 9 LOCALIZER
 RUNWAY 33 MALS PLAN AND PROFILE
 MALS STATIONS 13+20 - 24+00
 ARR-D-MALS33-C02**

CMT
 CRAWFORD, MURPHY & TILLY, INC.
 CONSULTING ENGINEERS
 License No. 984-000613

DESIGN BY: CAL
 DRAWN BY: JRO
 CHECKED BY: CAL
 APPROVED BY:
 DATE: 03/03/06
 JOB No: 04285-04

ILLINOIS PROJECT: ARR-3468
 A.I.P. PROJECT: 3-17-0003-B31
FINAL SUBMITTAL