

NOTES:

- FOR ALIGNMENT DATA, SEE ALIGNMENT DATA TABLE, SHEET 18.
- PAVEMENT EDGES ARE TO MATCH EXISTING LOCATIONS.
- EXISTING UTILITY LOCATIONS ARE ESTIMATED. CONTRACTOR MUST FIELD VERIFY LOCATIONS.
- NOT ALL UTILITIES SHOWN IN PROFILE.
- SUBSURFACE UTILITIES NOT SHOWN.
- FOR ADDITIONAL SAW AND SEAL INFORMATION, SEE STAGING PLAN AND TYPICAL SECTIONS.

LEGEND

- PROPOSED GRADING LIMITS
- PROPOSED UNDERDRAIN
- PROPOSED STORM SEWER
- PROPOSED SAW AND SEAL BITUMINOUS JOINT
- EXISTING SWALE
- EXISTING FENCE
- EXISTING STORM SEWER
- EXISTING ELECTRICAL CABLE
- ▲ PROPOSED FLARED END SECTION
- PROPOSED INSPECTION HOLE
- ⊙ EXISTING STORM SEWER MANHOLE
- ⊙ EXISTING STAKE MOUNTED LIGHT
- ⊙ EXISTING BASE MOUNTED LIGHT
- ⊙ EXISTING RETROREFLECTIVE MARKER
- ⊙ EXISTING HANDHOLE
- ⊙ EXISTING GUIDANCE SIGN
- ⊙ EXISTING RAIL

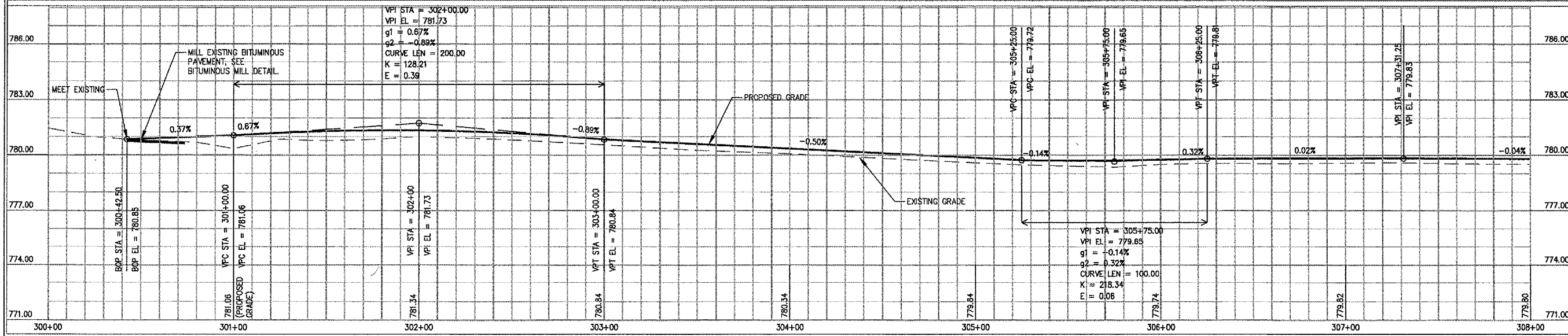

No.	Drawing Issue Description	Date	By

Date: MARCH 3, 2006
Sheet Title:

**PLAN AND PROFILE
TAXIWAY A
STA 300+42.50 THRU
STA 308+00**

843-05B8009

Project Number	LDH	11/14/05
Layout By	LDH, KLK	11/14/05
Designed By	RMH	02/03/06
Reviewed By	LDH	
Drawn By		

10

A:\LOCALS\100841\050809\050809\050809\10-PLAN & PROFILE 300.DWG MAR 10, 2006 10:09AM RLK