

STATE OF ILLINOIS
DEPARTMENT OF TRANSPORTATION

F.A.P. RTE.	SECTION	COUNTY	TOTAL SHEETS	SHEET NO.
332	D3 CRACK SEAL 2017-1	KANKAKEE & IROQUOIS	8	1
KANKAKEE & IROQUOIS ILLINOIS			CONTRACT NO. 66H04	

INDEX OF SHEETS

1	COVER SHEET
2	GENERAL NOTES
3	SUMMARY OF QUANTITIES
4	TYPICAL SECTIONS
5	SCHEDULES
6-7	LAYOUT MAP
8	DETAILS

LIST OF ILLINOIS DOT HIGHWAY STANDARDS

000001-06	STANDARD SYMBOLS, ABBREVIATIONS AND PATTERNS
001006	DECIMAL OF AN INCH AND OF A FOOT
701001-02	OFF-ROAD OPERATIONS 2L, 2W, MORE THAN 15' (4.5 m) AWAY
701006-05	OFF-ROAD OPERATIONS 2L, 2W, 15' (4.5 m) TO 24" (600 mm) FROM
701301-04	LANE CLOSURE, 2L, 2W, SHORT TIME OPERATIONS
701306-03	LANE CLOSURE, 2L, 2W, SLOW MOVING OPERATIONS DAY ONLY.
701311-03	LANE CLOSURE, 2L, 2W, MOVING OPERATIONS - DAY ONLY
701501-06	URBAN LANE CLOSURE, 2L, 2W, UNDIVIDED
701801-06	TRAFFIC CONTROL DEVICES

PROPOSED HIGHWAY PLANS

FAP ROUTE 332 (IL 1)
SECTION: D3 CRACK SEAL 2017-1

CRACK SEALING
KANKAKEE & IROQUOIS COUNTIES

C-93-028-17
CRACK SEALING FROM NCL OF
ST ANNE TO US 52

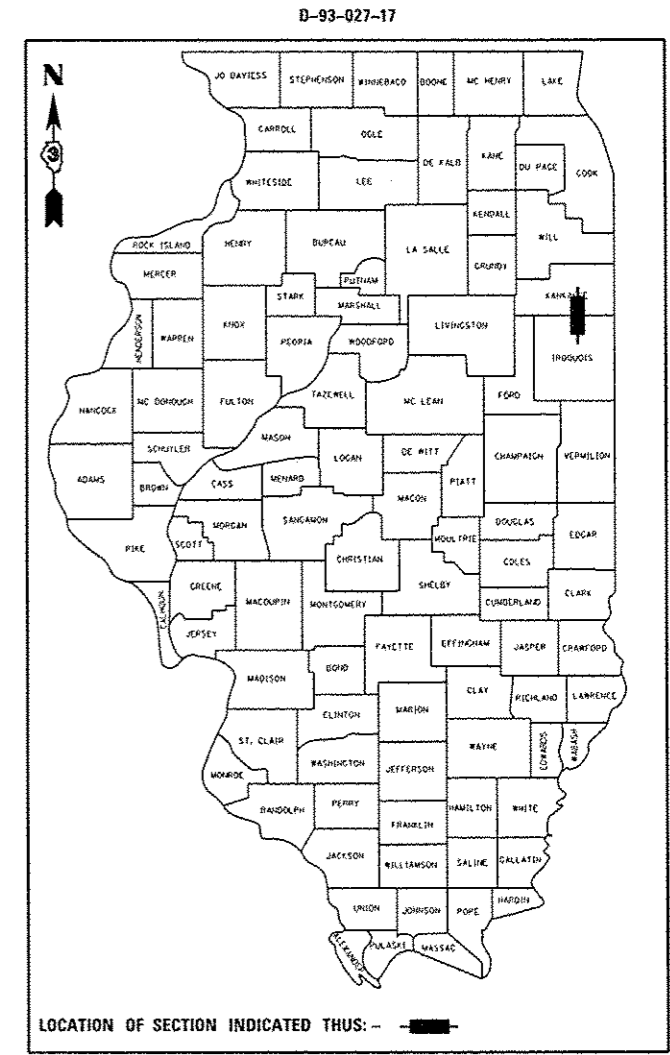

OTHER PRINCIPAL ARTERIAL
2015 ADT = 2350
P.V. = 86%
S.U. = 3%
M.U. = 11%

STATE OF ILLINOIS
DEPARTMENT OF TRANSPORTATION

SUBMITTED Feb 3 20 17
[Signature]
DEPUTY DIRECTOR OF HIGHWAYS, REGION ENGINEER

Mar 24 20 17
[Signature]
ENGINEER OF DESIGN AND ENVIRONMENT

Mar 24 20 17
[Signature]
DIRECTOR OF PROGRAM DEVELOPMENT

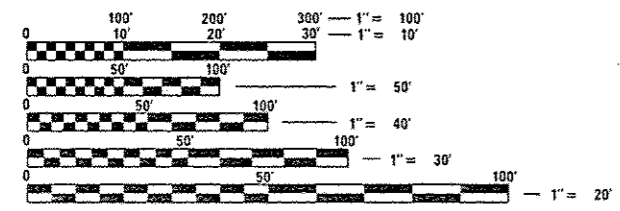

FULL SIZE PLANS HAVE BEEN PREPARED USING STANDARD ENGINEERING SCALES. REDUCED SIZED PLANS WILL NOT CONFORM TO STANDARD SCALES. IN MAKING MEASUREMENTS ON REDUCED PLANS, THE ABOVE SCALES MAY BE USED.

J.U.L.I.E.
JOINT UTILITY LOCATION INFORMATION FOR EXCAVATION
1-800-892-0123
OR 811

DISTRICT 3 NO. (815) 434-6131
PROJECT ENGINEER: JOE KANNEL, P.E.
UNIT CHIEF: MICHELE LINDEMANN, P.E.

CONTRACT NO. 66H04

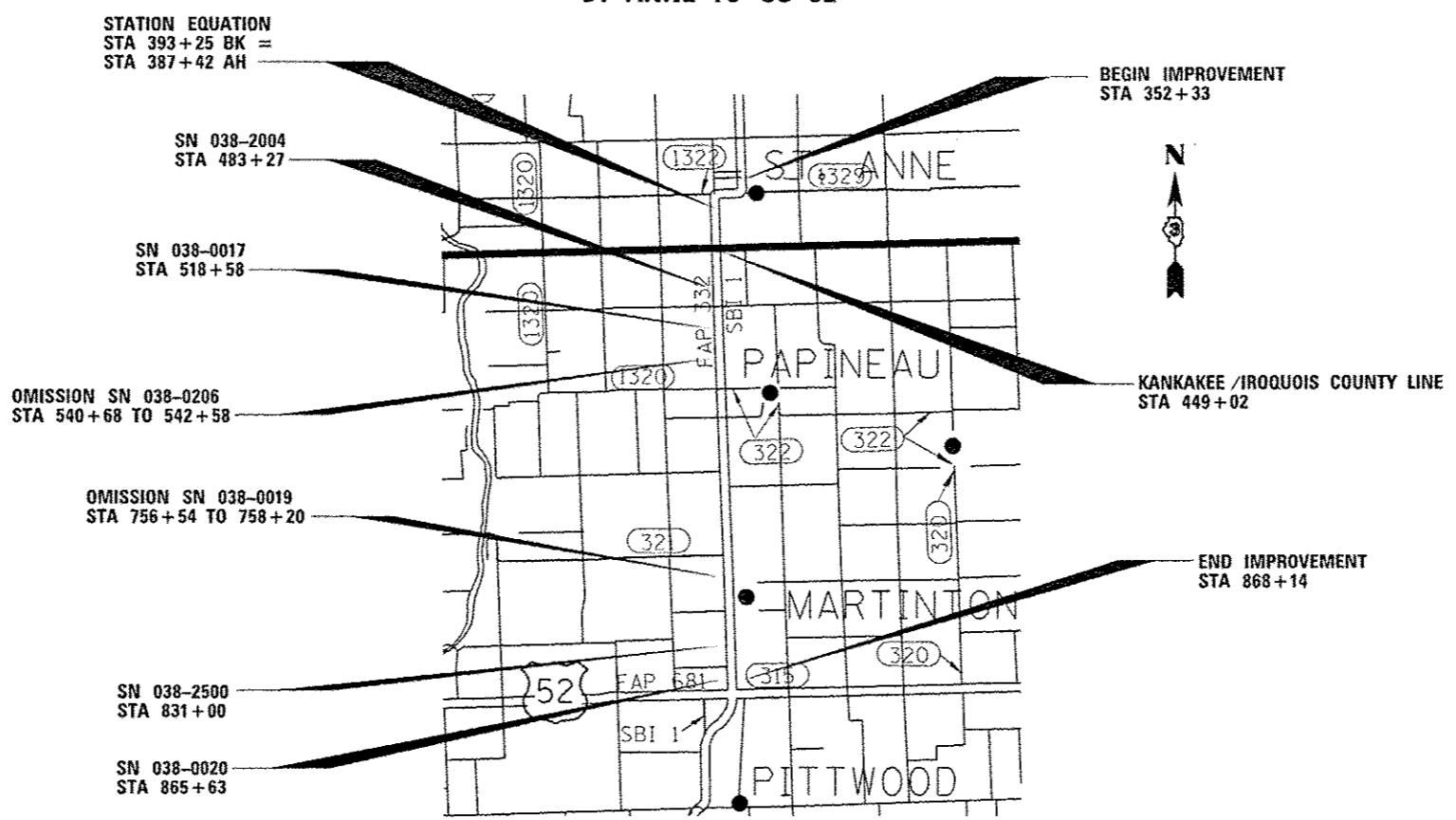

GROSS LENGTH = 52164 FT. = 9.880 MILE
NET LENGTH = 51808 FT. = 9.812 MILE

PRINTED BY THE AUTHORITY
OF THE STATE OF ILLINOIS

GENERAL NOTES

COMMITMENTS

THE INTENT OF THIS PROJECT IS TO ROUT AND SEAL WORKING TRANSVERSE CRACKS AND PRIMARY LONGITUDINAL CRACKS GREATER THAN 1/4" IN WIDTH. SECONDARY CRACKS GREATER THAN 1/4" IN WIDTH SHALL BE CLEANED AND SEALED

THERE ARE NO QUANTITIES TO REPAIR PAVEMENT MARKINGS, SO CARE SHOULD BE TAKEN TO AVOID DAMAGING EXISTING PAVEMENT MARKINGS. LONGITUDINAL CRACKS THAT CONFLICT WITH THE EXISTING PAVEMENT MARKINGS SHALL NOT BE SEALED

ALL PCC BRIDGE DECKS AND PAVEMENTS SHALL BE OMITTED. BRIDGE DECKS WITH HMA OVERLAYS ARE TO BE SEALED ONLY (NO ROUTING)

ANY REFERENCE TO A STANDARD IN THESE PLANS SHALL BE INTERPRETED TO MEAN THE EDITION AS INDICATED BY THE SUBNUMBER SHOWN IN THE LIST OF STANDARDS OR THE COPY INCLUDED IN THESE PLANS.

THE RESIDENT ENGINEER SHALL DETERMINE AT THE TIME OF CONSTRUCTION ANY BRIDGE, INTERSECTION, OR OTHER OMISSIONS NECESSARY.

THE FOLLOWING RATES OF APPLICATION HAVE BEEN USED IN CALCULATING PLAN QUANTITIES:

CRACK FILLING MATERIAL	0.35	POUNDS/FOOT
------------------------	------	-------------

STATE OF ILLINOIS
DEPARTMENT OF TRANSPORTATION
DISTRICT THREE
AS BUILT INFORMATION

SUPERVISING CONSTRUCTION FIELD ENGINEER

RESIDENT ENGINEER / TECHNICIAN

START & END DATES
OF CONSTRUCTION:

INSPECTORS:

STATE OF ILLINOIS
DEPARTMENT OF TRANSPORTATION
DISTRICT THREE

PREPARED BY: Tom Brown
DISTRICT STUDIES & PLANS ENGINEER

DATE: 2-2-17

EXAMINED BY: [Signature]
DISTRICT CONSTRUCTION ENGINEER

[Signature]
DISTRICT MATERIALS ENGINEER

[Signature]
DISTRICT OPERATIONS ENGINEER

STATE OF ILLINOIS
DEPARTMENT OF TRANSPORTATION

GENERAL NOTES

FILE NAME *	USER NAME * ERKILAA	DESIGNED -	REVISED -	STATE OF ILLINOIS DEPARTMENT OF TRANSPORTATION	GENERAL NOTES	F.A.P. RTE.	SECTION	COUNTY	TOTAL SHEETS	SHEET NO.	
0:\pwork\pdat\erkkilaa\0902741\03\	xxx-shr-cover.dgn	DRAWN -	REVISED -			332	D3 CRACK SEAL 2017-1	*	8	2	
*MODELNAME#	PLOT SCALE * 100.0000 / in.	CHECKED -	REVISED -			* KANKAKEE & IROQUOIS CONTRACT NO. 66H04					
	PLOT DATE * 2/1/2017	DATE -	REVISED -			ILLINOIS FED. AID PROJECT					
					SCALE:	SHEET	OF	SHEETS	STA.	TO STA.	

DES 6-137

CODE NO.	ITEM	UNIT	TOTAL QUANTITY	CONSTRUCTION CODE	
				KANKAKEE CO.	IROQUOIS CO.
				ROADWAY 0005 RURAL	ROADWAY 0005 RURAL
45100100	CRACK ROUTING (PAVEMENT)	FOOT	68815	15140	53675
45100200	CRACK FILLING	POUND	24087	5299	18788
67100100	MOBILIZATION	LSUM	1	0.2	0.8
70100460	TRAFFIC CONTROL AND PROTECTION, STANDARD 701306	LSUM	1	0.2	0.8
70102620	TRAFFIC CONTROL AND PROTECTION, STANDARD 701501	LSUM	1	0.2	0.8
Z0030850	TEMPORARY INFORMATION SIGNING	50 FT	42	21	21

6

FILE NAME =	USER NAME = eorcoranm	DESIGNED -	REVISED -	STATE OF ILLINOIS DEPARTMENT OF TRANSPORTATION	SUMMARY OF QUANTITIES	F.A.P. RTE.	SECTION	COUNTY	TOTAL SHEETS	SHEET NO.
Documents\DOT Offices\District 3\Projects\0368-DRAWN\0368H04-sht-details.dgn	DRAWN	REVISED -	332			03 CRACK SEAL 2017-1	*	8	3	
PLOT SCALE = 1/8" = 1' / in.	CHECKED -	REVISED -	* KANKAKEE & IROQUOIS			CONTRACT NO. 66H04				
PLOT DATE = 2/2/2017	DATE -	REVISED -	ILLINOIS FED. AID PROJECT							
Default				SCALE:	SHEET OF SHEETS STA. TO STA.					

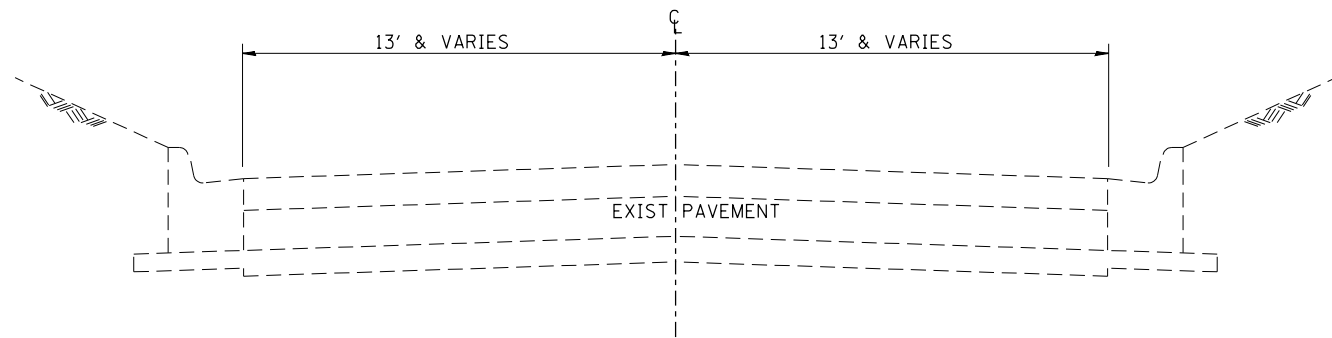

TYPICAL SECTION

352+33 TO 393+25 BK

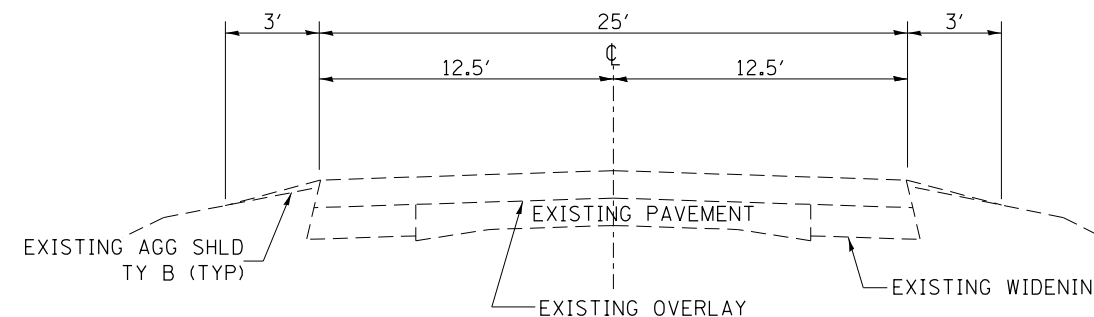

TYPICAL SECTION

387+42 AH TO 535+40
 546+88 TO 754+39
 760+63 TO 827+26
 834+77 TO 865+22

STATION EQUATION:
 393+25 BK = 387+42 AH

OMISSIONS
 STA 540+68 TO 542+58
 STA 756+54 TO 758+20

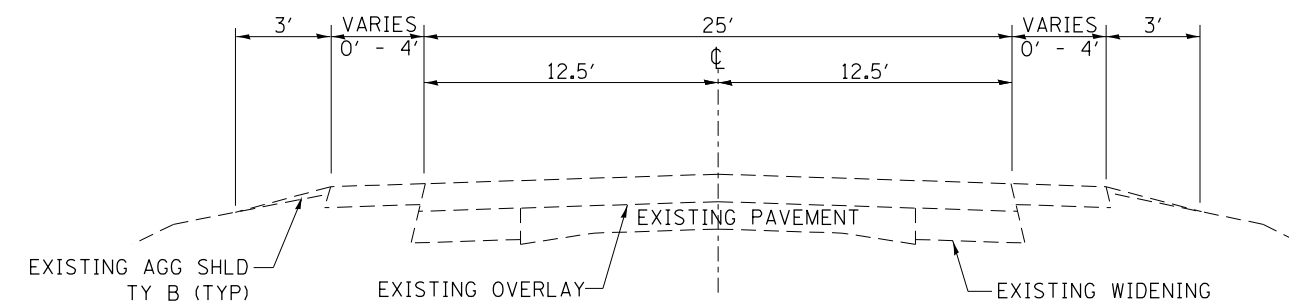

TYPICAL SECTION

535+40 TO 546+88
 754+39 TO 760+63
 827+26 TO 834+77
 865+22 TO 868+14

FILE NAME =	USER NAME = corcoranlm	DESIGNED -	REVISED -
p:\11\084EBIDINTEG.illinois.gov\PWIDOT\Documents\IDOT Offices\District 3\Projects\0366\Drawings\04-shr-details.dgn		CHECKED -	REVISED -
		DATE -	REVISED -

**STATE OF ILLINOIS
 DEPARTMENT OF TRANSPORTATION**

TYPICAL SECTIONS

SCALE: SHEET OF SHEETS STA. TO STA.

F.A.P. RTE.	SECTION	COUNTY	TOTAL SHEETS	SHEET NO.
332	D3 CRACK SEAL 2017-1		8	4
KANKAKEE & IROQUOIS		CONTRACT NO. 66H04		
ILLINOIS FED. AID PROJECT				

CRACK ROUTING AND SEALING SCHEDULE						
LOCATION		LONGITUDINAL CRACK ROUTING (PAVEMENT) FOOT	TRANSVERSE CRACK ROUTING (PAVEMENT) FOOT	LONGITUDINAL CRACK FILLING POUND	TRANSVERSE CRACK FILLING POUND	REMARKS
KANKAKEE COUNTY						
CC&G TO 7000S RD	NB	480	312	168	109	
	SB	165	468	58	164	
7000S RD TO CC&G	NB	400	144	140	50	
	SB	560	96	196	34	
CC&G TO AROMA PARK RD	NB	350	324	123	113	
	SB	420	192	147	67	
AROMA PARK RD - COUNTY LINE	NB	280	84	98	29	
	SB	325	288	114	101	
CENTERLINE	CENTERLINE	10252		3588		
KANKAKEE COUNTY SUBTOTAL		13232	1908	4632	667	
KANKAKEE COUNTY TOTAL		15140		5299		
IROQUOIS COUNTY						
COUNTY LINE - 3300N	NB	185	180	65	63	
	SB	480	468	168	164	
3300N - 3150N	NB	315	288	110	101	
	SB	250	540	88	189	
3150N - 3100N	NB	110	156	39	55	
	SB	150	168	53	59	
3100N - 3000N	NB	230	384	81	134	
	SB	225	720	79	252	
3000N - 2850N	NB	580	660	203	231	
	SB	380	1020	133	357	
2850N - 2750N	NB	375	324	131	113	
	SB	355	588	124	206	
2750N - 2600N	NB	925	264	324	92	
	SB	1175	624	411	218	
CENTERLINE	CENTERLINE	41556		14545		
IROQUOIS COUNTY SUBTOTAL		47291	6384	16554	2234	
IROQUOIS COUNTY TOTAL		53675		18788		
PROJECT TOTAL		68815		24087		

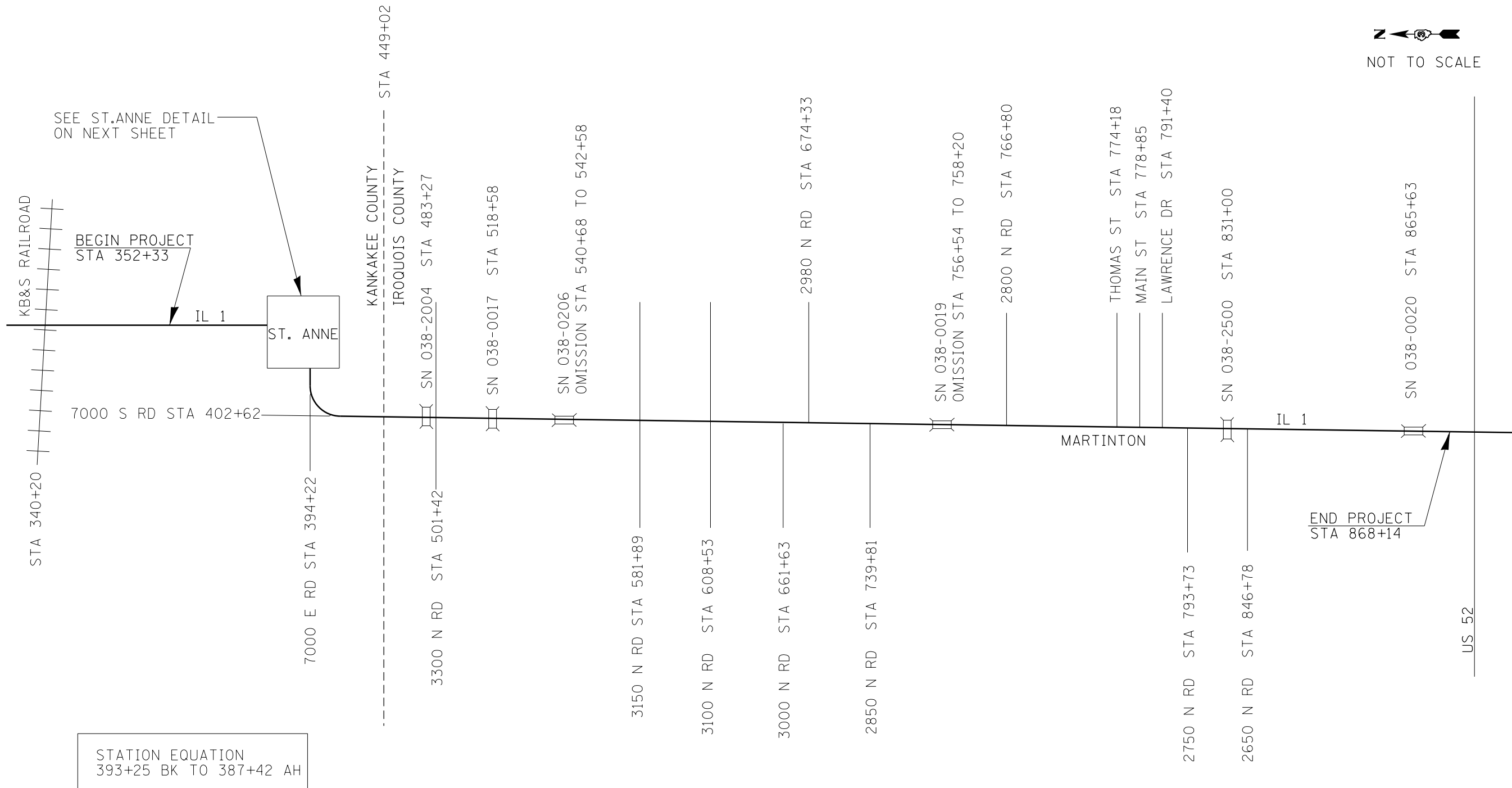
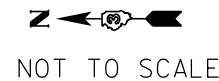

SEE ST. ANNE DETAIL
ON NEXT SHEET

BEGIN PROJECT
STA 352+33

ST. ANNE

7000 S RD STA 402+62

7000 E RD STA 394+22

3300 N RD STA 501+42

SN 038-0017 STA 518+58

SN 038-0206
OMISSION STA 540+68 TO 542+58

3150 N RD STA 581+89

3100 N RD STA 608+53

3000 N RD STA 661+63

2980 N RD STA 674+33

2850 N RD STA 739+81

SN 038-0019
OMISSION STA 756+54 TO 758+20

2800 N RD STA 766+80

MARTINTON

THOMAS ST STA 774+18

MAIN ST STA 778+85

LAWRENCE DR STA 791+40

2750 N RD STA 793+73

SN 038-2500 STA 831+00

2650 N RD STA 846+78

IL 1

END PROJECT
STA 868+14

SN 038-0020 STA 865+63

US 52

STATION EQUATION
393+25 BK TO 387+42 AH

FILE NAME =	USER NAME = corcoranim	DESIGNED -	REVISED -
p:\IL\084EBID\INTEG\illinois.gov\PWIDOT\Documents\IDOT Offices\District 3\Projects\0366H04\Drawings\04-shr-details.dgn		CHECKED -	REVISED -
Default	PLOT DATE = 2/2/2017	DATE -	REVISED -

**STATE OF ILLINOIS
DEPARTMENT OF TRANSPORTATION**

LAYOUT MAP

SCALE: SHEET OF SHEETS STA. TO STA.

F.A.P. RTE.	SECTION	COUNTY	TOTAL SHEETS	SHEET NO.
332	D3 CRACK SEAL 2017-1	*	8	6
* KANKAKEE & IROQUOIS			CONTRACT NO. 66H04	
ILLINOIS FED. AID PROJECT				



NOT TO SCALE

ST. ANNE DETAIL

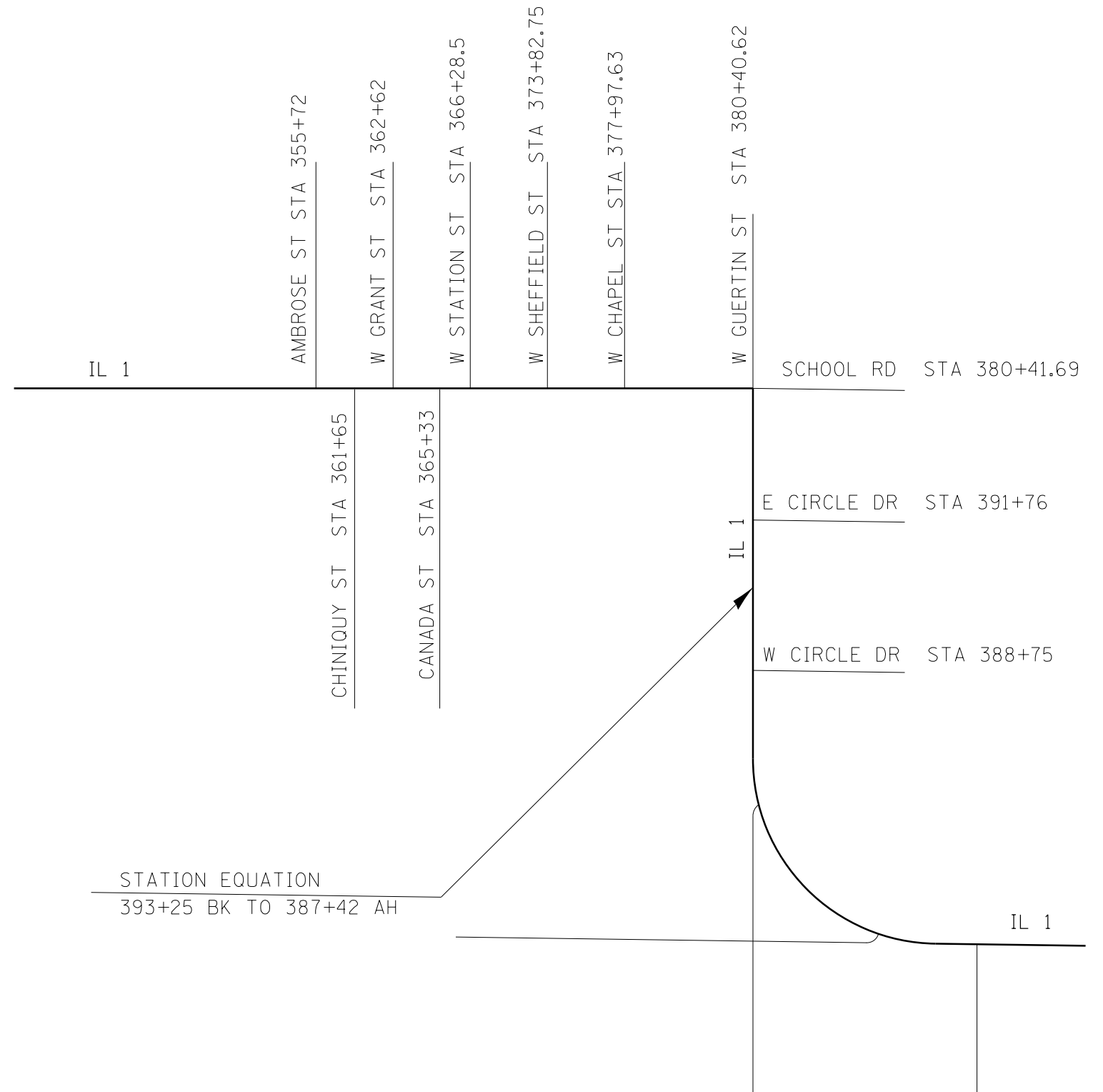

FILE NAME =	USER NAME = corcoranlm	DESIGNED -	REVISED -
p:\IL\084EBIDINTEG\illinois.gov\PWIDOT\Documents\DOT Offices\District 3\Projects\0366H04\Drawings\04-shr-details.dgn		CHECKED -	REVISED -
		DATE -	REVISED -

**STATE OF ILLINOIS
DEPARTMENT OF TRANSPORTATION**

LAYOUT MAP

SCALE: SHEET NO. OF SHEETS STA. TO STA.

F.A.P. RTE.	SECTION	COUNTY	TOTAL SHEETS	SHEET NO.
332	D3 CRACK SEAL 2017-1	•	8	7
• KANKAKEE & IROQUOIS		CONTRACT NO. 66H04		
ILLINOIS FED. AID PROJECT				

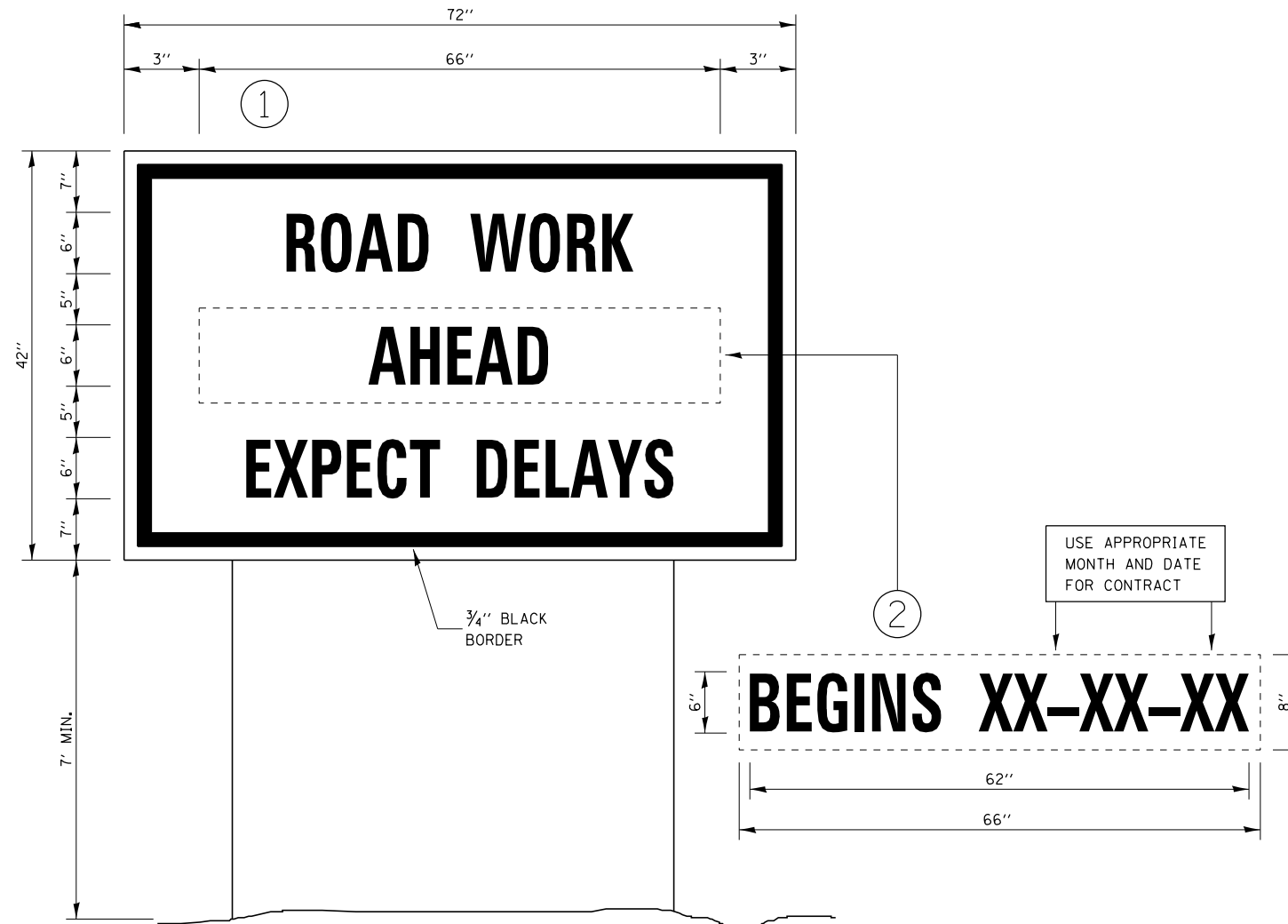

CRACK SEALING HMA PAVEMENT

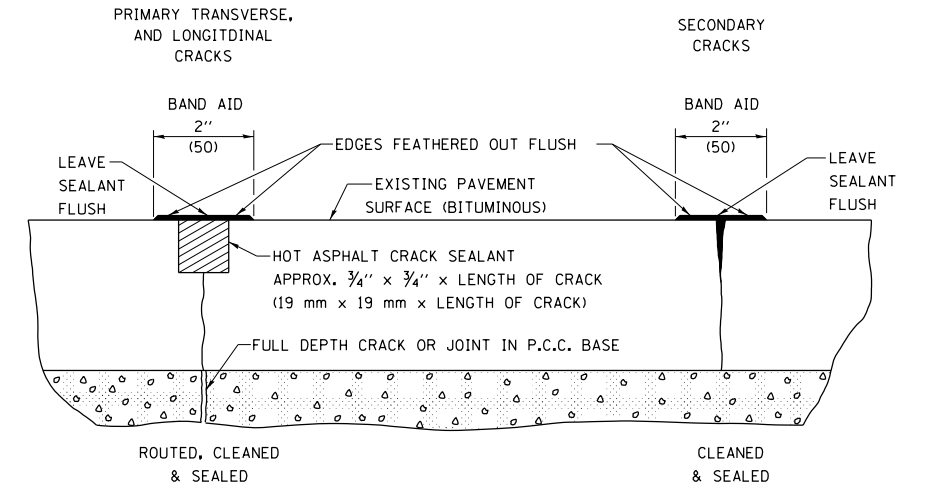

TEMPORARY INFORMATION SIGNING

NOTES:

- USE 6" D BLACK LETTERING ON FLUORESCENT ORANGE BACKGROUND.
- ERECT SIGNS AT LOCATIONS IN ADVANCE OF THE "ROAD CONSTRUCTION AHEAD" SIGNS AS DIRECTED BY THE ENGINEER.
- ERECT SIGN ① WITH INSTALLED PANEL ② A MINIMUM OF ONE WEEK PRIOR TO THE START OF THE LANE CLOSURE.
- REMOVE PANEL ② ON THAT DATE.
- SEE SPECIAL PROVISION "TEMPORARY INFORMATION SIGNING" FOR ADDITIONAL INFORMATION.
- WILL BE PAID FOR PER SQ FT AS "TEMPORARY INFORMATION SIGNING". EACH SIGN = 21 SQ FT AND THE DATE PANEL ② WILL NOT BE MEASURED SEPARATELY FOR PAYMENT.

FILE NAME =	USER NAME = corcoranlm	DESIGNED -	REVISED -	STATE OF ILLINOIS DEPARTMENT OF TRANSPORTATION	DETAILS				F.A.P. RTE.	SECTION	COUNTY	TOTAL SHEETS	SHEET NO.	
p:\11\084EBIDINTEG.illinois.gov\PIWIDOT\Documents\IDOT Offices\District 3\Projects\0366\Drawings\B366H04-shr-details.dgn		CHECKED -	REVISED -		SCALE:	SHEET	OF	SHEETS	STA.	TO STA.	332	D3 CRACK SEAL 2017-1		8
Default		DATE -	REVISED -											8
	PLOT SCALE = 100.0000' / in.													

• KANKAKEE & IROQUOIS CONTRACT NO. 66H04 ILLINOIS FED. AID PROJECT