

INDEX OF SHEETS

- 1 COVER SHEET
- 2 JOB SPECIFIC NOTES & COMMITMENTS
- 3 SUMMARY OF QUANTITIES
- 4 LINE DIAGRAM
- 5 TYPICAL SECTION
- 6-7 SCHEDULE OF QUANTITIES
- 8-9 DISTRICT STANDARDS

HIGHWAY STANDARDS

- 701301-04
- 701306-03
- 701311-03
- 701901-06
- 780001-05

DISTRICT STANDARDS

780001

DESIGN DESIGNATION:

- ADT: 1250 (2015)
- HCV: 138 (11%)
- SU: 38 (3%)
- MU: 100 (8%)

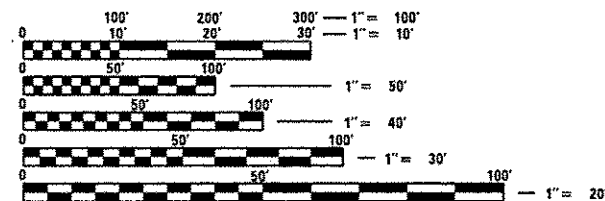

FULL SIZE PLANS HAVE BEEN PREPARED USING STANDARD ENGINEERING SCALES. REDUCED SIZED PLANS WILL NOT CONFORM TO STANDARD SCALES. IN MAKING MEASUREMENTS ON REDUCED PLANS, THE ABOVE SCALES MAY BE USED.

J.U.L.I.E.  
JOINT UTILITY LOCATION INFORMATION FOR EXCAVATION  
1-800-892-0123  
OR 811

PROJECT ENGINEER: CHRISTOPHER MAUSHARD 609-671-3453  
PROJECT MANAGER: SOBHI LABABIDI/RAY SAMARA 309-671-3460  
CATALOG NO. 035412-00D  
CONTRACT NO. 68D28

STATE OF ILLINOIS  
DEPARTMENT OF TRANSPORTATION  
DIVISION OF HIGHWAYS  
**PROPOSED  
HIGHWAY PLANS**

FAP 534 (IL ROUTE 96)  
SECTION 12RS-3

TYPE of IMPROVEMENT: PAVEMENT PRESERVATION  
HENDERSON COUNTY

C-94-071-16

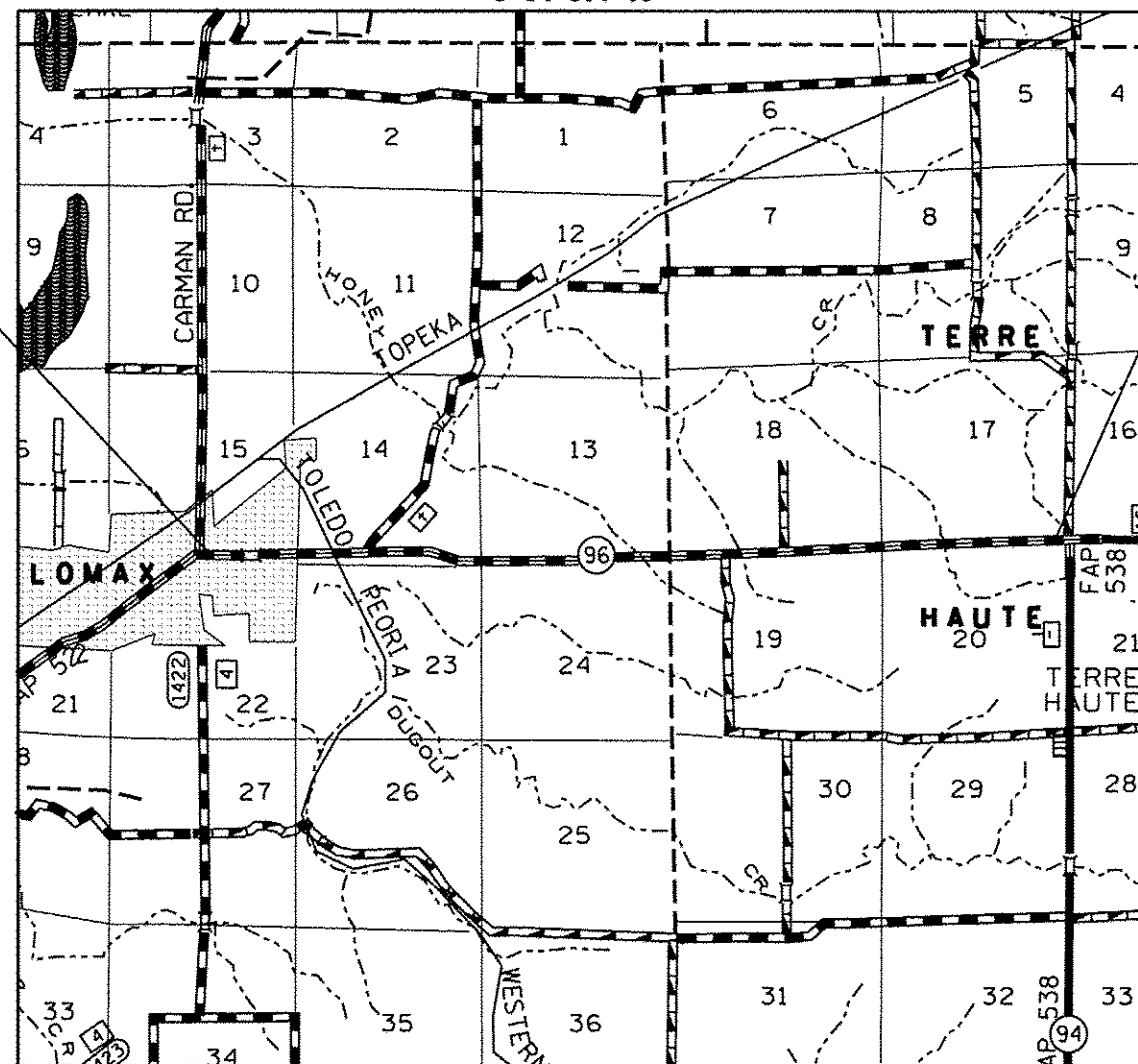

PROJECT BEGINS  
STA. 330 + 73

PROJECT  
ENDS  
STA. 575 + 13

GROSS LENGTH = 24,440 FT. = 4.629 MILE  
NET LENGTH = 24,166 FT. = 4.577 MILE

F.A.P. RTE.	SECTION	COUNTY	TOTAL SHEETS	SHEET NO.
534	12RS-3	HENDERSON	9	1
		ILLINOIS	CONTRACT NO. 68D28	

D-94-039-16

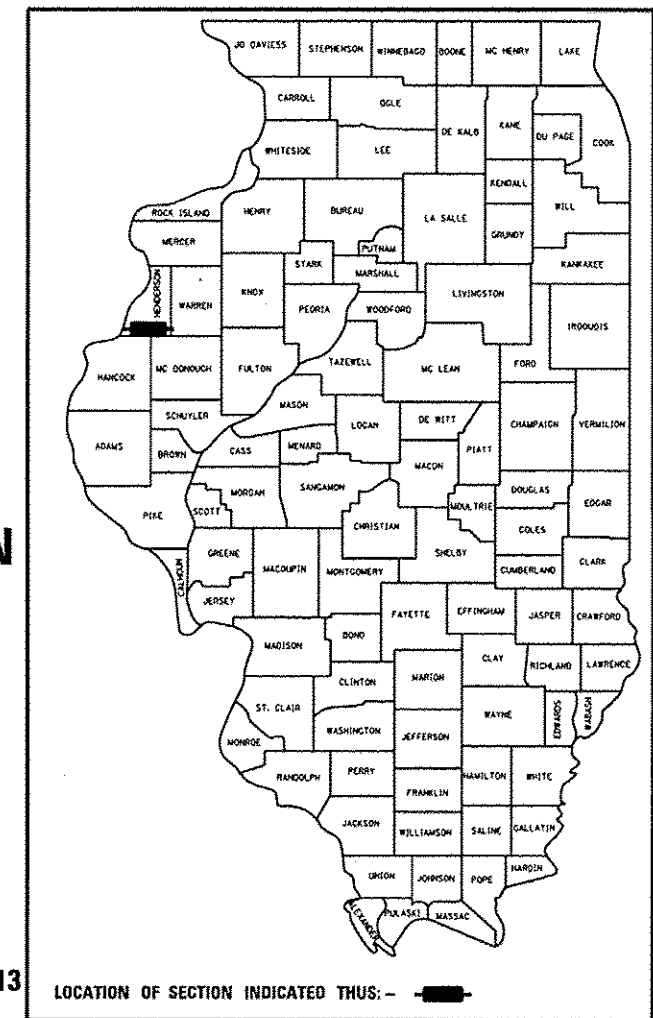

PROJECT DESCRIPTION:

CAPE SEAL ON IL 96 FROM CARMAN ROAD  
TO IL 94 IN HENDERSON COUNTY

STATE OF ILLINOIS  
DEPARTMENT OF TRANSPORTATION  
DIVISION OF HIGHWAYS

SUBMITTED February 9, 2017  
[Signature]  
REGION THREE ENGINEER

Mar 24, 2017  
[Signature]  
ENGINEER OF DESIGN AND ENVIRONMENT

Mar 24, 2017  
[Signature]  
DIRECTOR OF PROGRAM DEVELOPMENT

PRINTED BY THE AUTHORITY  
OF THE STATE OF ILLINOIS

**COMMITMENTS:**

**NO COMMITMENTS HAVE BEEN MADE FOR THIS PROJECT.**

**NO PASSING ZONE VERIFICATION**

**THE RESIDENT SHALL CONTACT OPERATIONS TO VERIFY THE LOCATION OF NO PASSING ZONES PRIOR TO PLACEMENT OF CENTERLINE STRIPING.**

**SURFACE TESTS APPLICATION**

**SMOOTHNESS TESTS ON THE COMPLETED SURFACE WILL NOT BE REQUIRED; BUT THE ENGINEER RESERVES THE RIGHT TO REQUIRE CORRECTIVE MEASURES WHEN OBVIOUS SURFACE VARIATIONS ARE PRESENT.**

**CAPE SEAL TREATMENT**

**THE MATERIALS FOR THE A-1 SURFACE SHALL BE (CRUSHED) CA 20. (CRUSHED) CA 16 MAY BE USED IF APPROVED BY THE ENGINEER.  
THE MICRO-SURFACING APPLICATION SHALL BE SINGLE PASS, TYPE II, 24 LB./SQ. YD.  
THE AGGREGATE FOR THE MICROSURFACING SHALL MEET THE FRICTION AGGREGATE REQUIREMENTS FOR THE MIXTURE C IN ARTICLE 1004.03 (a)**

**STATIONING**

**THE EXISTING ROADWAY STATIONS SHALL BE COVERED PRIOR TO THE CAPE SEAL APPLICATIONS.  
THE COVER SHALL BE REMOVED AFTER WORK IS COMPLETED. THIS WORK SHALL BE INCLUDED IN THE COST OF THE "CAPE SEAL".**

FILE NAME : plan.dgn	USER NAME : lebabidian	DESIGNED - DRAWN -	REVISED - REVISED -	<b>STATE OF ILLINOIS DEPARTMENT OF TRANSPORTATION</b>	<b>JOB SPECIFIC NOTES &amp; COMMITMENTS</b>	F.A.P. RTE. 534	SECTION 12RS-3	COUNTY HENDERSON	TOTAL SHEETS 9	SHEET NO. 2	
Default	PLOT SCALE : 100.0000' = 1" / 10'	CHECKED - DATE -	REVISED - REVISED -			SCALE:	SHEET OF SHEETS	STA. TO STA.	ILLINOIS FED. AID PROJECT CONTRACT NO. 68028		
	PLOT DATE : 2/18/2017										

CODE NO.	ITEM	UNIT	TOTAL QUANTITY	CONSTRUCTION CODE	
				HENDERSON COUNTY	100% STATE ✓ 0005 ✓
48101200	AGGREGATE SHOULDERS, TYPE B	TON	917	917	
67100100	MOBILIZATION	L SUM	1	1	
70100460	TRAFFIC CONTROL AND PROTECTION, STANDARD 701306	L SUM	1	1	
70300100	SHORT-TERM PAVEMENT MARKING	FOOT	2417	2417	
70300150	SHORT TERM PAVEMENT MARKING REMOVAL	SQ FT	806	806	
* 78008200	POLYUREA PAVEMENT MARKING TYPE I - LETTERS & SYMBOLS	SQ FT	122	122	
* 78008210	POLYUREA PAVEMENT MARKING TYPE I - LINE 4"	FOOT	73745	73745	
* 78008270	POLYUREA PAVEMENT MARKING TYPE I - LINE 24"	FOOT	52	52	
X0326218	FIBER-MODIFIED ASPHALT CRACK SEALING	FOOT	500	500	
X3200001	BUMP REMOVAL	EACH	40	40	
X7810400	TEMPORARY RAISED PAVEMENT MARKER	EACH	1208	1208	
Z0064265	CAPE SEAL	SO YD	69813	69813	

RURAL

\* SPECIALTY ITEM

FILE NAME : plan.dgn	USER NAME : labbidian	DESIGNED -	REVISED -
		DRAWN -	REVISED -
	PLOT SCALE : 100.0000' / 1"	CHECKED -	REVISED -
	PLOT DATE : 2/10/2017	DATE -	REVISED -

STATE OF ILLINOIS  
DEPARTMENT OF TRANSPORTATION

SUMMARY OF QUANTITIES

F.A.P. RTE.	SECTION	COUNTY	TOTAL SHEETS	SHEET NO.
534	12RS-3	HENDERSON	9	3
				CONTRACT NO. 6802B
[ILLINOIS] FED. AID PROJECT				

REV

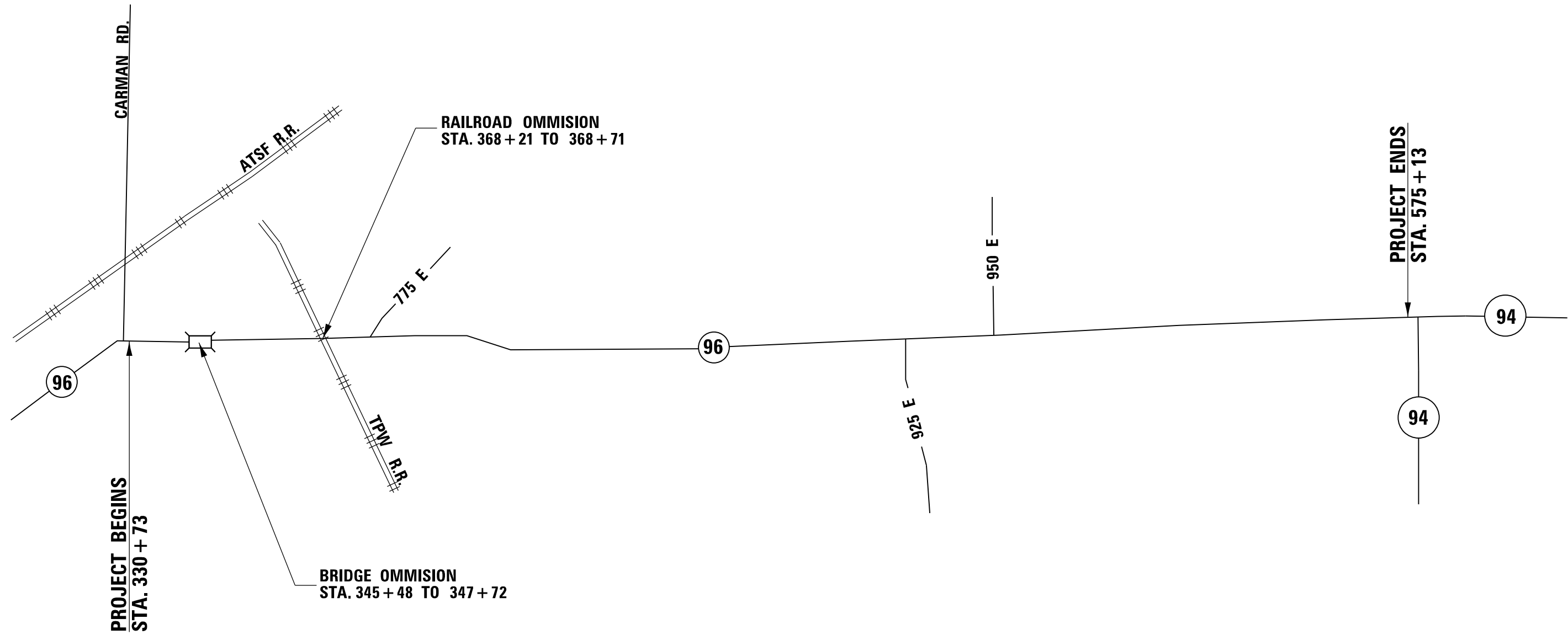

FILE NAME = plan.dgn	USER NAME = lababidism	DESIGNED -	REVISED -
Default	PLOT SCALE = 100.0000' / in.	DRAWN -	REVISED -
	PLOT DATE = 2/10/2017	CHECKED -	REVISED -
		DATE -	REVISED -

**STATE OF ILLINOIS  
DEPARTMENT OF TRANSPORTATION**

<b>LINE DIAGRAM</b>			
SCALE:	SHEET	OF	SHEETS
	STA.		TO STA.

F.A.P. RTE.	SECTION	COUNTY	TOTAL SHEETS	SHEET NO.
534	12RS-3	HENDERSON	9	4
CONTRACT NO. 68D28				
ILLINOIS FED. AID PROJECT				

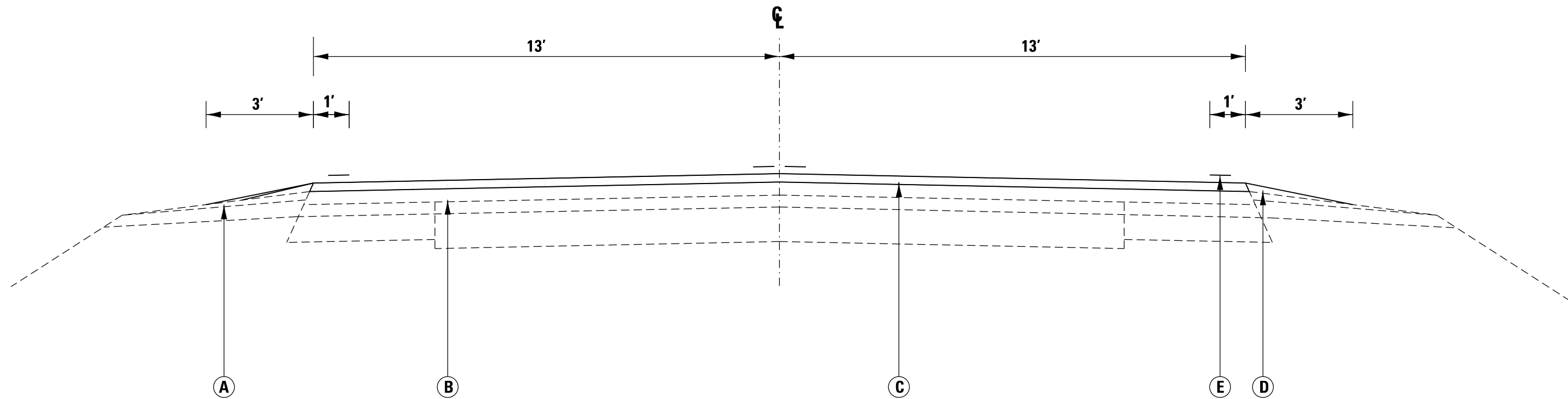

STA 330+73 TO STA 575+13

**LEGEND:**

- (A) EXISTING AGGREGATE SHOULDER**
- (B) EXISTING PAVEMENT & OVERLAY**
- (C) PROPOSED CAPE SEAL**
- (D) PROPOSED AGGREGATE SHOULDER TYPE B**
- (E) PROPOSED PAVEMENT MARKING**

**NOT TO SCALE**

FILE NAME = plan.dgn	USER NAME = lababidism	DESIGNED -	REVISED -	<b>STATE OF ILLINOIS DEPARTMENT OF TRANSPORTATION</b>	<b>PROPOSED TYPICAL SECTION</b>				F.A.P. RTE.	SECTION	COUNTY	TOTAL SHEETS	SHEET NO.
	PLOT SCALE = 100.0000' / in.	DRAWN -	REVISED -						534	12RS-3	HENDERSON	9	5
Default	PLOT DATE = 2/10/2017	CHECKED -	REVISED -		SCALE:	SHEET	OF	SHEETS	STA.	TO	STA.	ILLINOIS FED. AID PROJECT	
		DATE -	REVISED -									CONTRACT NO. 68D28	

POLYUREA PAVEMENT MARKING TYPE I – LINE 4"						
LOCATION			YELLOW LINE 4"			WHITE LINE 4"
			SKIP DASH	NO PASSING		EDGE LINE
STA.	TO	STA.		FT	LT	
Sta. 330 + 73	TO	Sta. 361 + 54	770			6,162
Sta. 361 + 54	TO	Sta. 368 + 21	167		667	1,334
Sta. 368 + 21	TO	Sta. 368 + 71	RAIL ROAD OMMISION			
Sta. 368 + 71	TO	Sta. 368 + 94	6		23	46
Sta. 368 + 94	TO	Sta. 378 + 11	229	917		1,834
Sta. 378 + 11	TO	Sta. 379 + 47		136	136	272
Sta. 379 + 47	TO	Sta. 384 + 87	135		540	1,080
Sta. 384 + 87	TO	Sta. 411 + 24		2,637	2,637	5,274
Sta. 411 + 24	TO	Sta. 413 + 49	56	225		450
Sta. 413 + 49	TO	Sta. 419 + 54	151			1,210
Sta. 419 + 54	TO	Sta. 426 + 22	167		668	1,336
Sta. 426 + 22	TO	Sta. 436 + 24	251	1,002		2,004
Sta. 436 + 24	TO	Sta. 437 + 81		157	157	314
Sta. 437 + 81	TO	Sta. 446 + 54	218		873	1,746
Sta. 446 + 54	TO	Sta. 454 + 90	209	836		1,672
Sta. 454 + 90	TO	Sta. 463 + 60	218			1,740
Sta. 463 + 60	TO	Sta. 473 + 57	249		997	1,994
Sta. 473 + 57	TO	Sta. 483 + 95		1,038	1,038	2,076
Sta. 483 + 95	TO	Sta. 493 + 88	248		993	1,986
Sta. 493 + 88	TO	Sta. 496 + 68		280	280	560
Sta. 496 + 68	TO	Sta. 503 + 75	177	707		1,414
Sta. 503 + 75	TO	Sta. 526 + 84	577			4,618
Sta. 526 + 84	TO	Sta. 534 + 64	195		780	1,560
Sta. 534 + 64	TO	Sta. 536 + 78	54			428
Sta. 536 + 78	TO	Sta. 543 + 89	178	711		1,422
Sta. 543 + 89	TO	Sta. 552 + 39	213		850	1,700
Sta. 552 + 39	TO	Sta. 553 + 79	35			280
Sta. 553 + 79	TO	Sta. 561 + 73	199	794		1,588
Sta. 561 + 73	TO	Sta. 575 + 13	335			2,680
SIDE ROAD SUBTRACTION ( 3 50' avg.)						-150
SUB-TOTAL (YELLOW)			5,036	9,440	10,639	0
SUB-TOTAL (WHITE)			0	0	0	48,630
<b>GRAND TOTAL</b>			<b>73,745</b>			

POLYUREA PAVEMENT MARKING TYPE I – LETTERS AND SYMBOLS			
LOCATION		TYPE	SQ FT
Sta. 367 + 65	RT	"RR"	7.20
Sta. 367 + 65	RT	"X"	54.00
Sta. 369 + 27	LT	"RR"	7.20
Sta. 369 + 27	LT	"X"	54.00
<b>TOTAL</b>			<b>122</b>

POLYUREA PAVEMENT MARKING TYPE I – LINE 24"		
LOCATION	LENGTH FT	
Sta. 367 + 21	13	
Sta. 367 + 71	13	
Sta. 369 + 21	13	
Sta. 369 + 71	13	
<b>TOTAL</b>		<b>52</b>

TEMPORARY RAISED PAVEMENT MARKER			
LOCATION			EACH
Sta. 330 + 73	TO	Sta. 575 + 13	1,208
<b>TOTAL</b>			<b>1,208</b>

SHORT TERM PAVEMENT MARKING			
LOCATION	LENGTH FT		
Sta. 330 + 73	TO	Sta. 575 + 13	2,417
<b>TOTAL</b>			<b>2,417</b>

SHORT TERM PAVEMENT MARKING REMOVAL			
LOCATION			AREA
			SQ FT
Sta. 330 + 73	TO	Sta. 575 + 13	806
<b>TOTAL</b>			<b>806</b>

MOBILIZATION			
LOCATION			LSUM
Sta. 330 + 73	TO	Sta. 575 + 13	1
<b>TOTAL</b>			<b>1</b>

BUMP REMOVAL			
LOCATION			EACH
Sta. 330 + 73	TO	Sta. 575 + 13	40
<b>TOTAL</b>			<b>40</b>

TRAFFIC CONTROL AND PROTECTION STANDARD 701306			
LOCATION			LSUM
Sta. 330 + 73	TO	Sta. 575 + 13	1
<b>TOTAL</b>			<b>1</b>

AGGREGATE SHOULDERS, TYPE B			
LOCATION			TON
Sta. 330 + 73	TO	Sta. 575 + 13	917
<b>TOTAL</b>			<b>917</b>

CAPE SEAL					
LOCATION			LENGTH	WIDTH	AREA
			FT	FT	SQ YD
Sta. 330 + 73	TO	Sta. 575 + 13	24166	26	69,813
<b>TOTAL</b>					<b>69,813</b>

FIBER-MODIFIED ASPHALT CRACK SEALING					
LOCATION			LENGTH	QUANTITIES	
			FT	FT	
Sta. 330 + 73	TO	Sta. 575 + 13	200	500	
<b>TOTAL</b>					<b>500</b>

FILE NAME = plan.dgn	USER NAME = lababidism	DESIGNED -	REVISED -
Default	PLOT SCALE = 100.0000' / in.	DRAWN -	REVISED -
	PLOT DATE = 2/10/2017	CHECKED -	REVISED -
		DATE -	REVISED -

STATE OF ILLINOIS  
DEPARTMENT OF TRANSPORTATION

SCHEDULE OF QUANTITIES

SCALE: SHEET OF SHEETS STA. TO STA.

F.A.P. RTE.	SECTION	COUNTY	TOTAL SHEETS	SHEET NO.
534	12RS-3	HENDERSON	9	7
ILLINOIS FED. AID PROJECT			CONTRACT NO. 68D28	

DESIGNER NOTES:  
1. Include State Standard 780001 (Typical Pavement Markings)

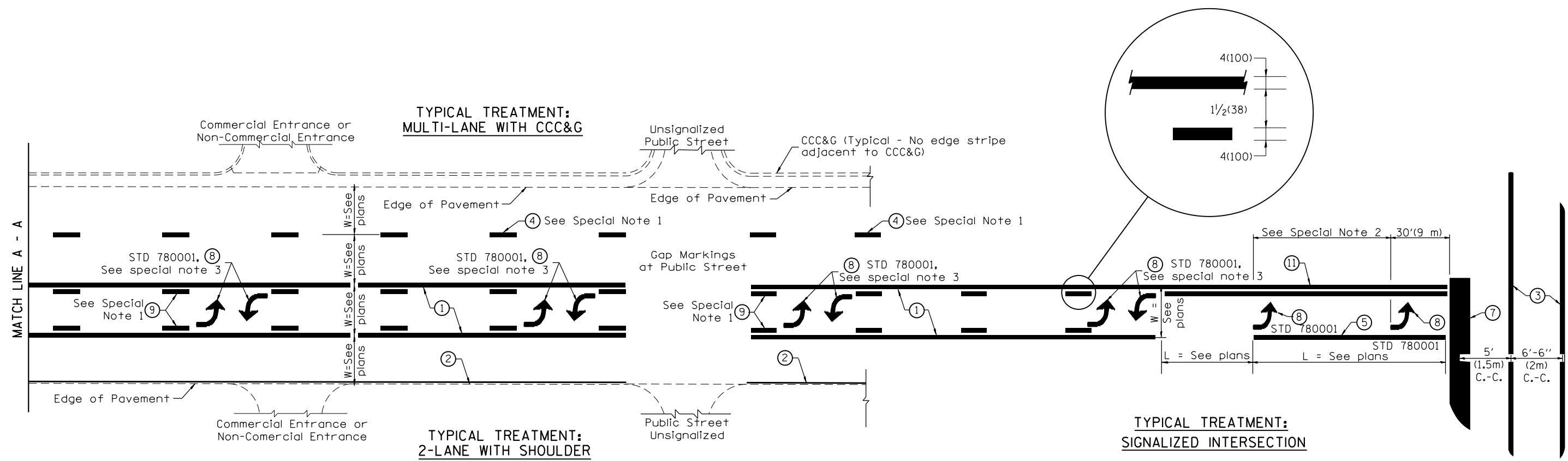

**FLUSH PAVED MEDIAN: TWO-WAY LEFT TURN LANE WITH ONE-WAY LEFT TURN LANE AT SIGNALIZED INTERSECTION**

**TYPICAL PAVEMENT MARKING LEGEND**  
(Note: This is a District Standard Legend. Some elements may not apply to specific project.)

- ① 4(100) Solid (Yellow)
- ② 4(100) Solid (White)
- ③ 2-6(150) Crosswalk @ 6'-6" (2m)min C.-C. (White)  
2-8(200) Crosswalk @ 6'-6" (2m)min C.-C. (White) (When traffic signals are present.)
- ④ 6(150) Skip-Dash (White) (See Special Note 1)
- ⑤ 8(200) Solid (White)
- ⑥ 12(300) Diagonal (White) (Item ⑥ is shown on Std. 780001)
- ⑦ 24(600) Stop Bar (White)
- ⑧ Letters & Arrows (See Std. 780001 and Special Notes 2 & 3)
- ⑨ 4(100) Skip-Dash (Yellow) (See Special Note 1)
- ⑩ 12(300) Diagonal (Yellow) (See Table A)
- ⑪ 4(100) Double Solid (Yellow) (See Table A)

**SPECIAL NOTES**

- Skip-Dash markings will be centered between both ends of city blocks and shall be placed in alignment transversely across the pavement.
- The following shall apply to arrows located in one-way left turn lanes:
  - A. A minimum of two (2) arrows is required.
  - B. The maximum spacing between arrows is 80' (24 m).
  - C. Arrows shall be evenly spaced if three (3) or more are required.
- The following shall apply to arrow pairs located in two-way left turn lanes:
  - A. A minimum of two (2) arrow pairs is required.
  - B. The maximum spacing between arrow pairs is 200' (61 m).
  - C. Arrow pairs shall be evenly spaced if three (3) or more are required.
  - D. The spacing between Bi Directional Left Turn Arrows is 33' (10 m).

**GENERAL NOTES**

- Refer to State Standard 780001 for additional Pavement Markings including letters & arrows.
- See Plans for Pavement Markings adjacent to curbed islands and medians, and through lane reductions.
- Refer to Article 780.13 for letter, number and symbol areas (sq. ft.)
- Areas are grooved 1" beyond each edge for the following symbols:  
Through Arrow= 14.8 sq. ft.  
Large Left or Right Arrow= 21.9 sq. ft.  
2 Arrow Combination Left (or Right) and Through= 34.9 sq. ft.  
Wrong Way Arrow= 29.5 sq. ft.  
Railroad Crossing Symbol= 69.8 sq. ft.  
(For further information, refer to BDE Special Provision: Grooving for Recessed Pavement Markings)

01-01-97	RENUM. F-8.03, NEW REVISION BOX	T.P.	10-16-06	REVISED TO 2007 SPEC.		<b>STATE OF ILLINOIS DEPARTMENT OF TRANSPORTATION</b>	<b>TYPICAL PAVEMENT MARKINGS</b>	F.A.P. RTE.	SECTION	COUNTY	TOTAL SHEETS	SHEET NO.	
02-07-97	ADD BI DIRECTIONAL DIMENSION	J.A.	2/29/16	ADDED GROOVING AREAS	R.D.			534	12RS-3	HENDERSON	9	8	
10-97	CORRECT BI DIRECTIONAL DIMENSION	J.A.						SHT. 1 OF 2 CADD STD. 780001-D4					
08-02	ADD CROSSWALK DMNS. WITH T.S.	M.A.						CONTRACT NO. 68D28					

NOT TO SCALE

FED. ROAD DIST. NO. ILLINOIS FED. AID PROJECT



