

STATE OF ILLINOIS
 DEPARTMENT OF TRANSPORTATION
 DIVISION OF HIGHWAYS

**PROPOSED
 HIGHWAY PLANS**

F.A.I. ROUTE 72 & F.A.I. ROUTE 74 (I-72 & I-74)
 SECTION D5 CRACK & JOINT SEAL 2017-1

CRACK AND JOINT SEALING
 MCLEAN & PIATT COUNTIES

C-95-066-16

(WEST FIELD AREA CRACK SEALING)

F.A.I. RTE.	SECTION	COUNTY	TOTAL SHEETS	SHEET NO.
72&74	**	ILLINOIS	17	1
			CONTRACT NO. 70C39	

• MCLEAN & PIATT COUNTIES
 •D5 CRACK & JOINT SEAL 2017-1

D-95-066-16



FOR INDEX OF SHEETS, SEE SHEET NO. 2
 FOR LOCATION MAP, SEE SHEETS NO. 3-5
 FOR SUMMARY OF QUANTITIES, SEE SHEET NO. 6

ADT

SEE LOCATION MAP, SHEETS 3-5

FOR LOCATION MAP, SEE SHEETS 3-5

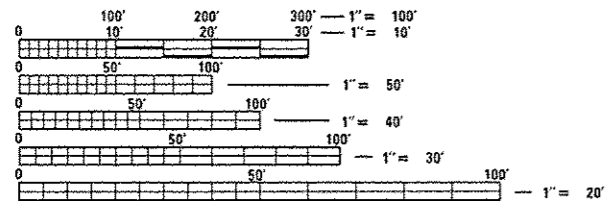

FULL SIZE PLANS HAVE BEEN PREPARED USING STANDARD ENGINEERING SCALES. REDUCED SIZED PLANS WILL NOT CONFORM TO STANDARD SCALES. IN MAKING MEASUREMENTS ON REDUCED PLANS, THE ABOVE SCALES MAY BE USED.

J.U.L.I.E.
 JOINT UTILITY LOCATION INFORMATION FOR EXCAVATION
 1-800-892-0123
 OR 811

PROJECT ENGINEER: NANCY FASIG
 SQUAD LEADER: STEVE COOMBES
 DESIGNER: CHRISTINA GOSNELL
 (217)465-4181
 CONTRACT NO. 70C39

STATE OF ILLINOIS
 DEPARTMENT OF TRANSPORTATION
 DIVISION OF HIGHWAYS

SUBMITTED JANUARY 30 20 17
Kenneth G. Garrett
 REGIONAL ENGINEER

MAR 24 20 17
Mawson M. Adair, P.E.
 ENGINEER OF DESIGN AND ENVIRONMENT

MAR 24 20 17
[Signature]
 DIRECTOR OF PROGRAM DEVELOPMENT

PRINTED BY THE AUTHORITY
 OF THE STATE OF ILLINOIS

INDEX OF SHEETS

SHEET NO.	DESCRIPTION
1	COVER SHEET
2	INDEX OF SHEETS
2	LIST OF STANDARDS
2	GENERAL NOTES
3-5	LOCATION MAP
6	SUMMARY OF QUANTITIES
7-16	EXISTING TYPICAL CROSS SECTIONS
17	DETAIL FOR CRACK AND JOINT SEALING

LIST OF STANDARDS

STANDARD NO.	NAME OF STANDARD
000001-06	STANDARD SYMBOLS, ABBREVIATIONS AND PATTERNS
001006	DECIMAL OF AN INCH AND OF A FOOT
701400-09	APPROACH TO LANE CLOSURE, FREEWAY/EXPRESSWAY
701406-11	LANE CLOSURE, FREEWAY/EXPRESSWAY, DAY OPERATIONS ONLY
701411-09 701456-04	LANE CLOSURE, MULTILANE, AT ENTRANCE OR EXIT RAMP, FOR SPEEDS ≥ 45 MPH PARTIAL EXIT RAMP CLOSURE FREEWAY / EXPRESSWAY
701901-06	TRAFFIC CONTROL DEVICES

GENERAL NOTES

G.N. 100

ENGLISH UNITS OF MEASUREMENT SHALL GOVERN OVER AND SUPERSEDE ANY METRIC UNITS SHOWN IN THIS CONTRACT. WHERE INCLUDED, METRIC UNITS ARE FOR INFORMATION ONLY.

G.N. 100A

ELECTRONIC FILES AND/OR ELECTRONIC SURVEY INFORMATION INCLUDING CADD FILES WILL NOT BE AVAILABLE TO THE CONTRACTOR.

G.N. 451 (SPECIAL)

THE INTENT OF THIS PROJECT IS TO ONLY BLOW OUT AND SEAL THE LONGITUDINAL JOINTS & CRACKS (I.E. - NO ROUTING). ANY CHANGES TO THE INTENT OF SEALING OPERATIONS SHALL BE APPROVED IN ADVANCE BY THE ENGINEER.

LOCATIONS SHALL BE DONE IN THE NUMERICAL ORDER GIVEN IN THE PLANS.

THE FOLLOWING APPLICATION RATE WAS USED TO CALCULATE MATERIAL FOR SEALING JOINTS AND CRACKS AT ALL LOCATIONS:

LONGITUDINAL (OR NON-ROUTED) = 0.2 LBS / LINEAR FOOT

ALL PCC BRIDGE DECKS AND PAVEMENTS ARE TO BE OMISSIONS. BRIDGE DECKS WITH HMA OVERLAYS ARE TO BE SEALED ONLY (NO ROUTING).

LOCATION #1 - I-72 IN PIATT COUNTY FROM MACON COUNTY LINE TO CHAMPAIGN COUNTY LINE.

LOCATION #2 - I-74 IN MCLEAN COUNTY FROM DOWNS TO EAST OF LEROY.

LOCATION #3 - I-74 IN MCLEAN COUNTY FROM EAST OF US 51 TO DOWNS.

- 1) LONGITUDINAL JOINTS AND CRACKS EQUAL TO OR GREATER THAN 1/4" IN WIDTH ALONG CENTER LINE, TURN LANES, EDGE OF PAVEMENT / SHOULDERS AND OTHER PAVING JOINTS (AS DIRECTED BY THE ENGINEER) SHALL BE SEALED.
- 2) LONGITUDINAL CRACKS WITHIN THE MARKED LANES SHALL **NOT** BE SEALED.
- 3) LONGITUDINAL PAVING JOINTS, PARALLEL TO THE MAINLINE, AT SIDE ROADS AND ENTRANCES SHALL BE SEALED AS NEEDED. ALL OTHER CRACKS AT THESE LOCATIONS ARE TO BE OMITTED.
- 4) LONGITUDINAL JOINTS WITH DOUBLE CRACKS ALONG THE CENTERLINE OR ALONG THE EDGE OF PAVEMENT / SHOULDER SHALL BE SEALED AS NEEDED.

APPROXIMATE QUANTITIES AT LOCATION #1:

LONGITUDINAL : 105,692 (RURAL) + 12,931 (URBAN) = 118,623 FOOT
SEALER : 21,138 (RURAL) + 2,586 (URBAN) = 23,725 POUNDS

APPROXIMATE QUANTITIES AT LOCATION #2:

LONGITUDINAL : 234,945 (RURAL) + 27,808 (URBAN) = 262,753 FOOT
SEALER : 46,989 (RURAL) + 5,562 (URBAN) = 52,551 POUNDS

APPROXIMATE QUANTITIES AT LOCATION #3:

LONGITUDINAL : 0 (RURAL) + 234,121 (URBAN) = 234,121 FOOT
SEALER : 0 (RURAL) + 46,824 (URBAN) = 46,824 POUNDS

**STATE OF ILLINOIS
DEPARTMENT OF TRANSPORTATION**

INDEX OF SHEETS, LIST OF STANDARDS, & GENERAL NOTES

FILE NAME =	USER NAME = goanelle1	DESIGNED -	REVISED -	STATE OF ILLINOIS DEPARTMENT OF TRANSPORTATION	INDEX OF SHEETS, LIST OF STANDARDS, & GENERAL NOTES	F.A.I. RTE.	SECTION	COUNTY	TOTAL SHEETS	SHEET NO.	
PH:\IL\804EB\INTEG\Illinois.gov\PI\DOT\Documents\DOT Offices\District 5\Projects\057\DRAWING\0578039-ent-plan.dgn		CHECKED -	REVISED -			72&74	--	MCLEAN&PIATT	17	2	
MODELNAME#	PLOT SCALE = 40,0000 / in.	DATE -	REVISED -			**D5 CRACK & JOINT SEAL 2017-1 CONTRACT NO. 70C39					
	PLOT DATE = 12/14/2016	DATE -	REVISED -			[ILLINOIS] FED. AID PROJECT					

SCALE: N/A SHEET 1 OF 1 SHEETS STA. TO STA.

LOCATION #1 MAP
I- 72 FROM THE MACON COUNTY LINE EAST TO THE BRIDGE STREET AREA
PIATT COUNTY

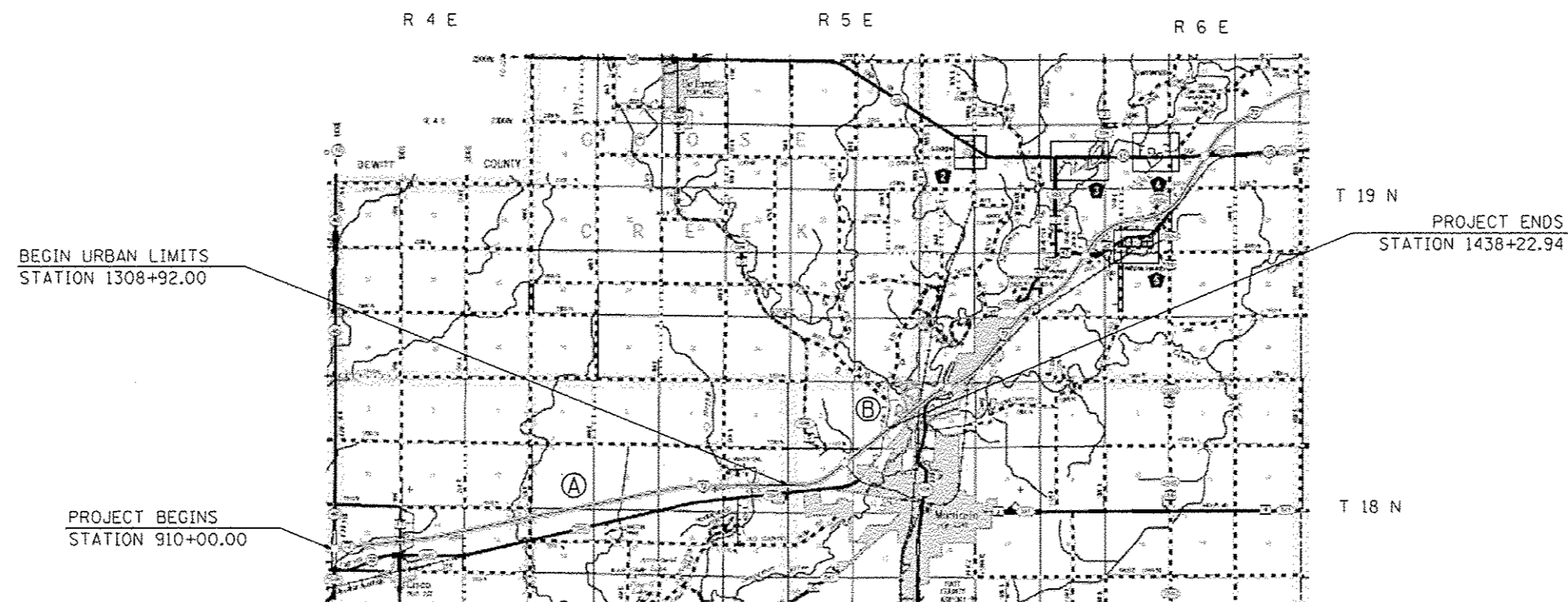

PROJECT BEGINS
STATION 910+00.00

BEGIN URBAN LIMITS
STATION 1308+92.00

T 19 N
PROJECT ENDS
STATION 1438+22.94

T 18 N

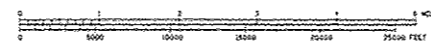

TOTAL LENGTH OF SECTION & PROJECT = 52820 FEET = 10.004 MILES
 NET LENGTH OF SECTION & PROJECT = 52820 FEET = 10.004 MILES

CURRENT TRAFFIC DATA

E.A.I. ROUTE 72

LEG "A"
 2016 ADT = 10,900
 PV % = 72.9
 SU % = 6.0
 MU% = 21.1

TRAFFIC DATA LOCATIONS

LEG "A" = I-72 FROM IL 48 TO BRIDGE ST

CH 36

LEG "B"
 2016 ADT = 12,800
 PV % = 78.9
 SU % = 3.5
 MU% = 17.6

TRAFFIC DATA LOCATIONS

LEG "B" = I-72 FROM BRIDGE ST TO IL 105

FILE NAME =	USER NAME = goanelic	DESIGNED -	REVISED -	STATE OF ILLINOIS DEPARTMENT OF TRANSPORTATION	LOCATION #1 MAP			F.A.I. RTE.	SECTION	COUNTY	TOTAL SHEETS	SHEET NO.
piatt\1204EBIDINTEG\Illinois.gov\PK\DOT\Do	uments\DOT Offices\District 5\Projects\057	DRAWN	REVISED		72&74	**	MCLEAN&PIAT	17	3			
PLOT SCALE = 48.0000" / in.	CHECKED -	REVISED -	REVISED -		**05 CRACK & JOINT SEAL 2017-I							
PLOT DATE = 12/14/2016	DATE -	REVISED -	REVISED -		SCALE: N/A	SHEET NO. 1	OF 3 SHEETS	STA.	TO STA.	CONTRACT NO. 70C39 ILLINOIS FED. AID PROJECT		

LOCATION #2 MAP I-74 FROM DOWNS TO EAST OF LEROY MCLEAN COUNTY

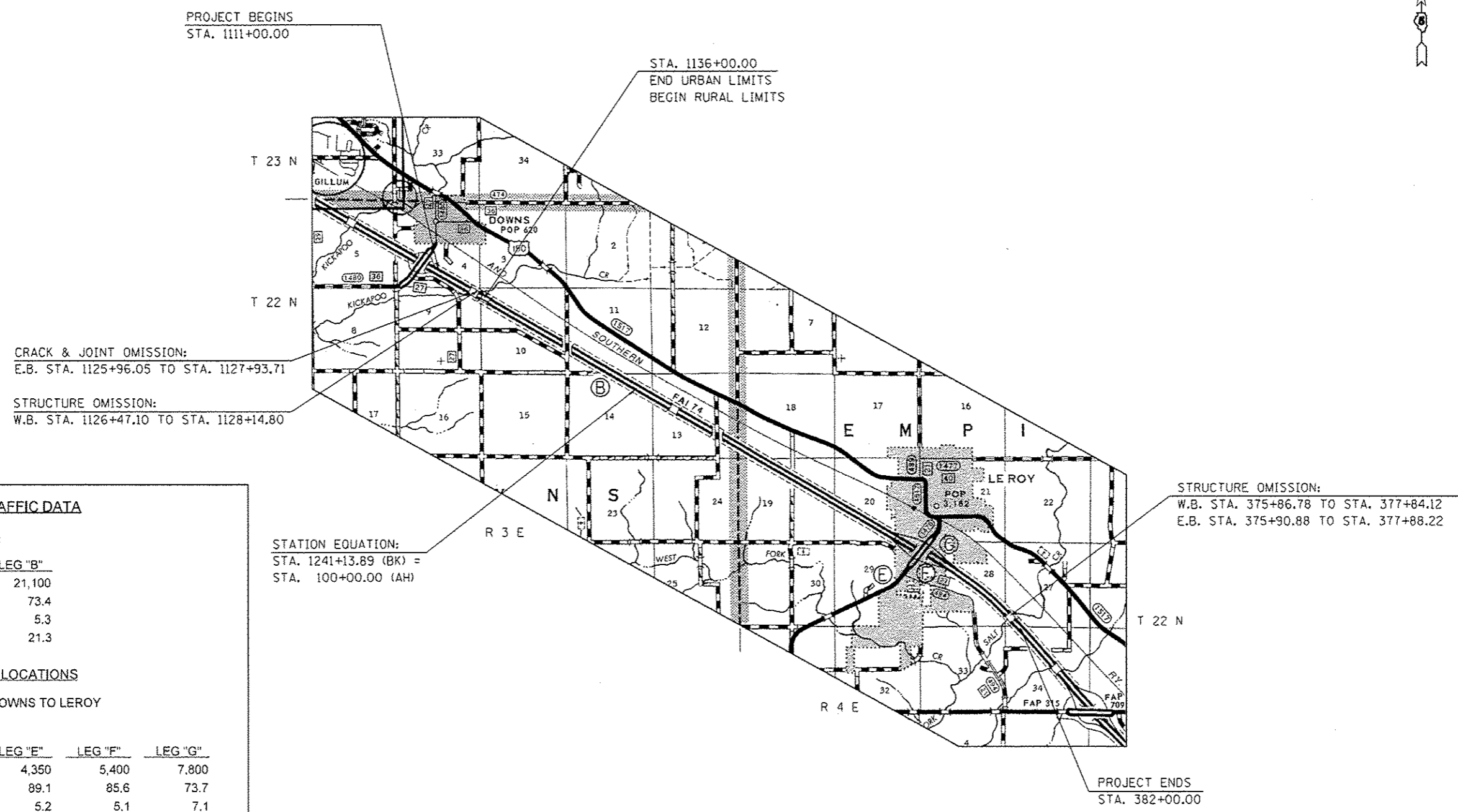

CURRENT TRAFFIC DATA			
E.A.I. ROUTE 74			
	LEG "B"		
2016 ADT =	21,100		
PV % =	73.4		
SU % =	5.3		
MU % =	21.3		
TRAFFIC DATA LOCATIONS			
LEG "B" = DOWNS TO LEROY			
E.A.S. 1478			
	LEG "E"	LEG "F"	LEG "G"
2016 ADT =	4,350	5,400	7,800
PV % =	89.1	85.6	73.7
SU % =	5.2	5.1	7.1
MU % =	5.7	3.6	19.2
TRAFFIC DATA LOCATIONS			
LEG "E" = FAS 494 TO I-74 EB RAMPS			
LEG "F" = I-74 EB RAMPS TO I-74 WB RAMPS			
LEG "G" = I-74 WB RAMP TO SUNSET DR			

STATION EQUATION:
STA. 1241+13.89 (BK) =
STA. 100+00.00 (AH)

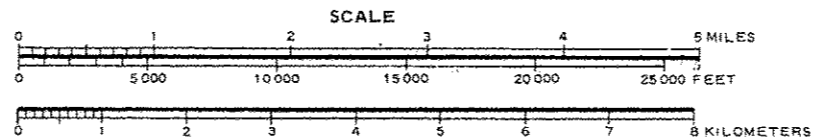

TOTAL LENGTH OF SECTION & PROJECT = 41,213.89 FEET = 7.806 MILES
NET LENGTH OF SECTION & PROJECT = 40,407.11 FEET = 7.653 MILES
(NOTE: LENGTHS ARE CALCULATED ALONG EASTBOUND LANE)

FILE NAME =	USER NAME = goss11e1	DESIGNED =	REVISED =	STATE OF ILLINOIS DEPARTMENT OF TRANSPORTATION	LOCATION #2 MAP	F.A.I. RTE. = 72&74	SECTION = **	COUNTY = MCLEAN&PIATT	TOTAL SHEETS = 17	SHEET NO. = 4
PLT SCALE = 40.0000' / 1"	PLT DATE = 12/14/2016	CHECKED =	REVISIO =	SCALE: N/A SHEET NO. 2 OF 3 SHEETS STA. TO STA.		**05 CRACK & JOINT SEAL 2017- CONTRACT NO. 70C39				
						ILLINOIS FED. AID PROJECT				

LOCATION #3 MAP I-74 FROM EAST OF US 51 TO DOWNS MCLEAN COUNTY



BRIDGE OMISSION
STA. 1037+74.25 TO STA. 1040+25.75 WB
STA. 1037+74.25 TO STA. 1040+25.25 EB

BRIDGE OMISSION
STA. 779+38.47 TO STA. 781+58.39

F.A.I. 74 SECTION BEGINS:
STA. 737+00.00

OVERHEAD
S.N. 057-0122
STA. 833+08.50

OVERHEAD
S.N. 057-0123
STA. 908+01.98

OVERHEAD
S.N. 057-0124
STA. 1008+08.36

F.A.I. 74 SECTION ENDS:
STA. 1111+00.00

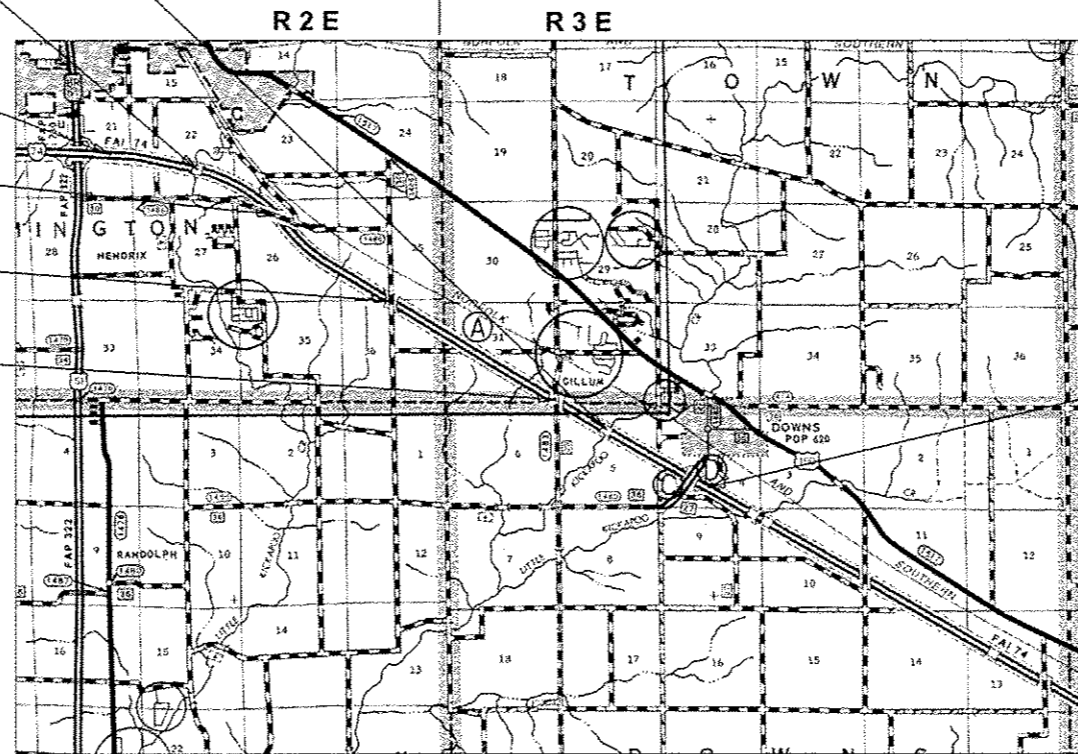

CURRENT TRAFFIC DATA

F.A.I. ROUTE 74

	LEG "A"
2016 ADT =	19,500
PV % =	65.4
SU % =	6.9
MU% =	27.7

TRAFFIC DATA LOCATIONS

LEG "A" = US 51 TO DOWNS

CH 36

	LEG "C"	LEG "D"
2016 ADT =	950	4,150
PV % =	87.3	89.8
SU % =	9.5	6.6
MU% =	3.2	3.6

TRAFFIC DATA LOCATIONS

LEG "C" = 2000 E RD TO I-74 EB RAMPS

LEG "D" = I-74 EB RAMPS TO SHAFER RD

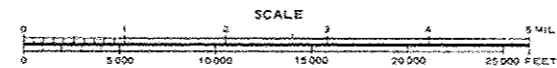

GROSS LENGTH = 37,400.00 FT. = 7.083 MILE

NET LENGTH = 36,929.08 FT. = 6.994 MILE

STRUCTURE INFORMATION

STRUCTURE OMISSIONS (OVERHEADS)

- SN 057-0122
- SN 057-0123
- SN 057-0124

FILE NAME =	USER NAME = gsmellol	DESIGNED -	REVISED -	STATE OF ILLINOIS DEPARTMENT OF TRANSPORTATION	LOCATION #3 MAP	F.A.I. RTE. 72&74	SECTION --	COUNTY MCLEAN&PIATE	TOTAL SHEETS 17	SHEET NO. 5
Documents\1007 Offices\District 5\Projects\057\Drawings\Design\0572039-shr-plan.dgn		DRAWN	REVISED			**05 CRACK & JOINT SEAL 2017-I	CONTRACT NO. 70C39			ILLINOIS FED. AID PROJECT
PLOT SCALE = 48.0000" / 1"		CHECKED -	REVISED -		SCALE: N/A	SHEET NO. 3 OF 3 SHEETS	STA.	TO STA.		
PLOT DATE = 12/14/2016		DATE -	REVISED -							

SUMMARY OF QUANTITIES

LOCATION OF WORK	LOCATION #1	LOCATION #2	LOCATION #3
COUNTY	PIATT	MCLEAN	MCLEAN
	FAI 72 I-72	FAI 74 I-74	FAI 74 I-74
	RURAL URBAN	RURAL URBAN	URBAN
FUNDING BREAKOUT	100% STATE ✓	100% STATE ✓	100% STATE ✓
CONSTRUCTION CODE	✓ 0005	✓ 0005	✓ 0005

CODE NO	ITEM DESCRIPTION	UNIT	TOTAL					
45100200	CRACK FILLING	POUND	125,007.0	21,138.0	2,586.0	49,909.0	3,000.0	48,374.0
67100100	MOBILIZATION	L SUM	1.0	0.2	0.2	0.2	0.2	0.2
70100420	TRAFFIC CONTROL AND PROTECTION, STANDARD 701411	EACH	12.0	2.0	2.0	2.0	2.0	4.0
70100701	TRAFFIC CONTROL AND PROTECTION, STANDARD 701406	EACH	3.0	1.0	0.0	1.0	0.0	1.0
X7010218	TRAFFIC CONTROL AND PROTECTION, SPECIAL	EACH	2.0	0.0	0.0	1.0	0.0	1.0
X7015005	CHANGEABLE MESSAGE SIGN	CAL DA	15.0	2.0	1.0	5.0	1.0	6.0
*DENOTES SPECIALTY ITEM								

6

**SEE GENERAL NOTE 451 (SPECIAL) FOR SPECIFIC ROUT & SEAL INSTRUCTIONS AT THIS LOCATION.

**1 LOCATION 1 (I-72) WB
EXISTING TYPICAL CROSS SECTION**

STATION TO STATION
910+00.00 965+00.00

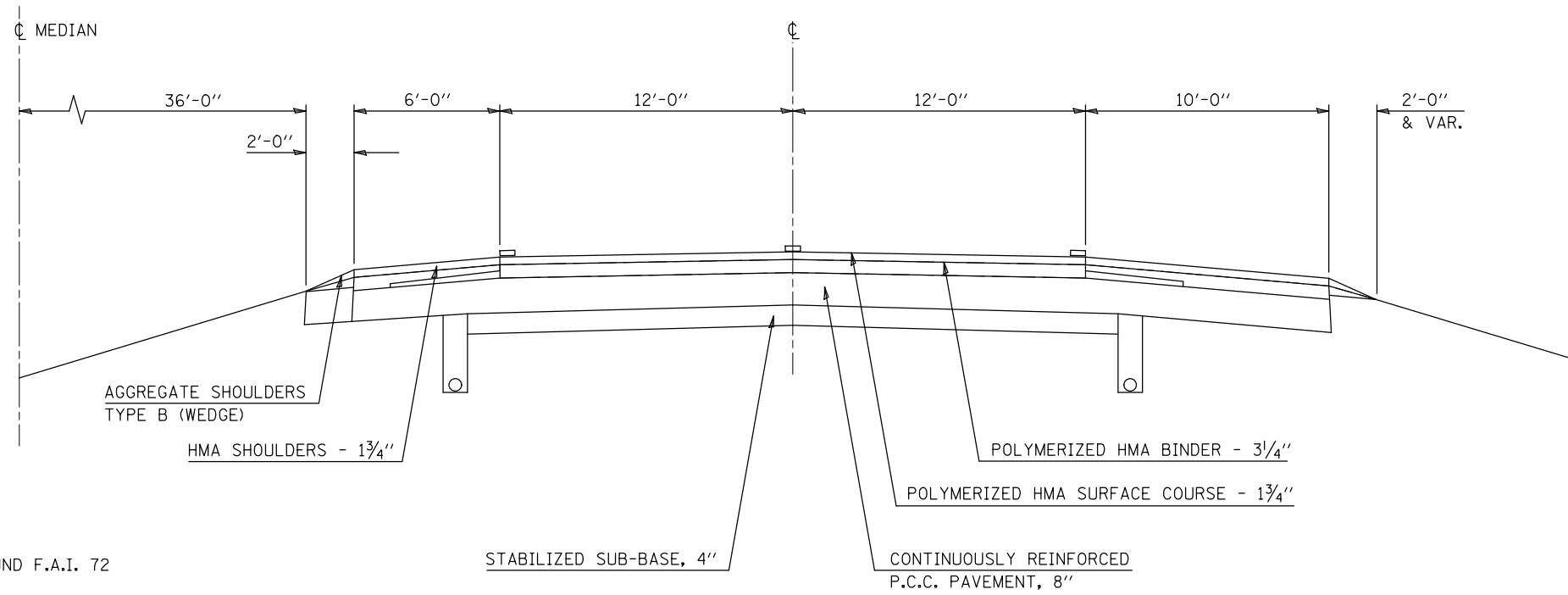

EASTBOUND F.A.I. 72 SHOWN, TYPICAL FOR WESTBOUND F.A.I. 72

**SEE GENERAL NOTE 451 (SPECIAL) FOR SPECIFIC ROUT & SEAL INSTRUCTIONS AT THIS LOCATION.

**2 LOCATION 1 (I-72) WB
EXISTING TYPICAL CROSS SECTION**

STATION TO STATION
965+00.00 1210+00.00

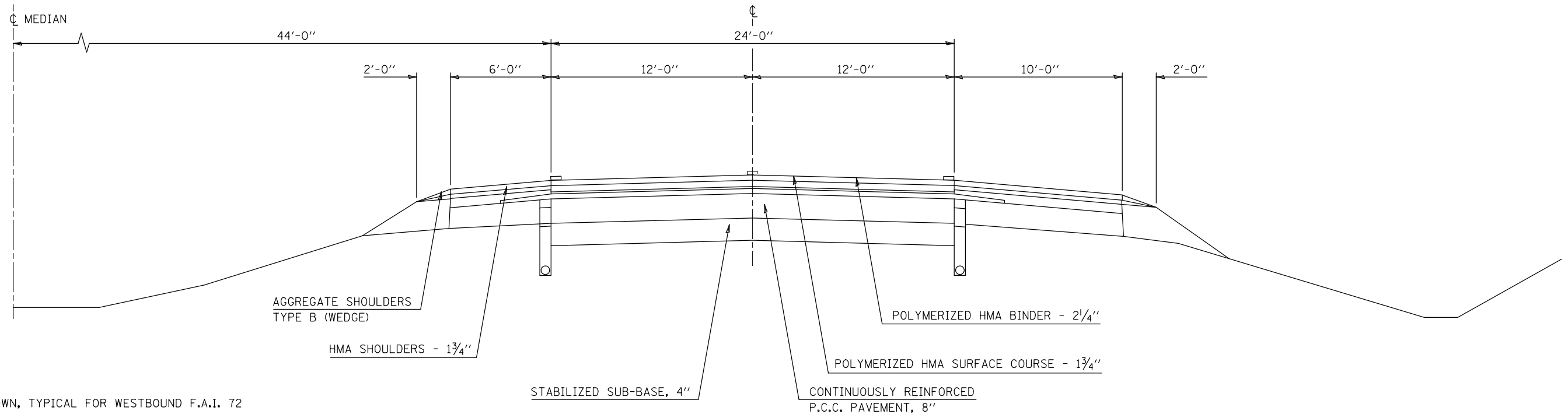

EASTBOUND F.A.I. 72 SHOWN, TYPICAL FOR WESTBOUND F.A.I. 72

FILE NAME =	USER NAME = gosnellc1	DESIGNED -	REVISED -	STATE OF ILLINOIS DEPARTMENT OF TRANSPORTATION	EXISTING TYPICAL CROSS SECTIONS LOCATION #1 (I-72)			F.A.I. RTE.	SECTION	COUNTY	TOTAL SHEETS	SHEET NO.	
p:\IL\084EBIDINTEG.illinois.gov\PI\DOT\Documents\DOT Offices\District 5\Projects\05790\Drawings\Design\05790C39-shr-plan.dgn		DRAWN	REVISED -		SCALE: N/A	SHEET 1	OF 2 SHEETS	STA.	TO STA.	72&74	MCLEAN&PIAT	17	7
MODELNAME	PLOT SCALE = 40.0000' / in.	CHECKED -	REVISED -							**D5 CRACK & JOINT SEAL 2017-1	CONTRACT NO. 70C39		
	PLOT DATE = 12/14/2016	DATE -	REVISED -							ILLINOIS FED. AID PROJECT			

**SEE GENERAL NOTE 451 (SPECIAL) FOR SPECIFIC ROUT & SEAL INSTRUCTIONS AT THIS LOCATION.

3 **LOCATION 1 (I-72) WB**
EXISTING TYPICAL CROSS SECTION

STATION TO STATION
 1210+00.00 1438+20.00

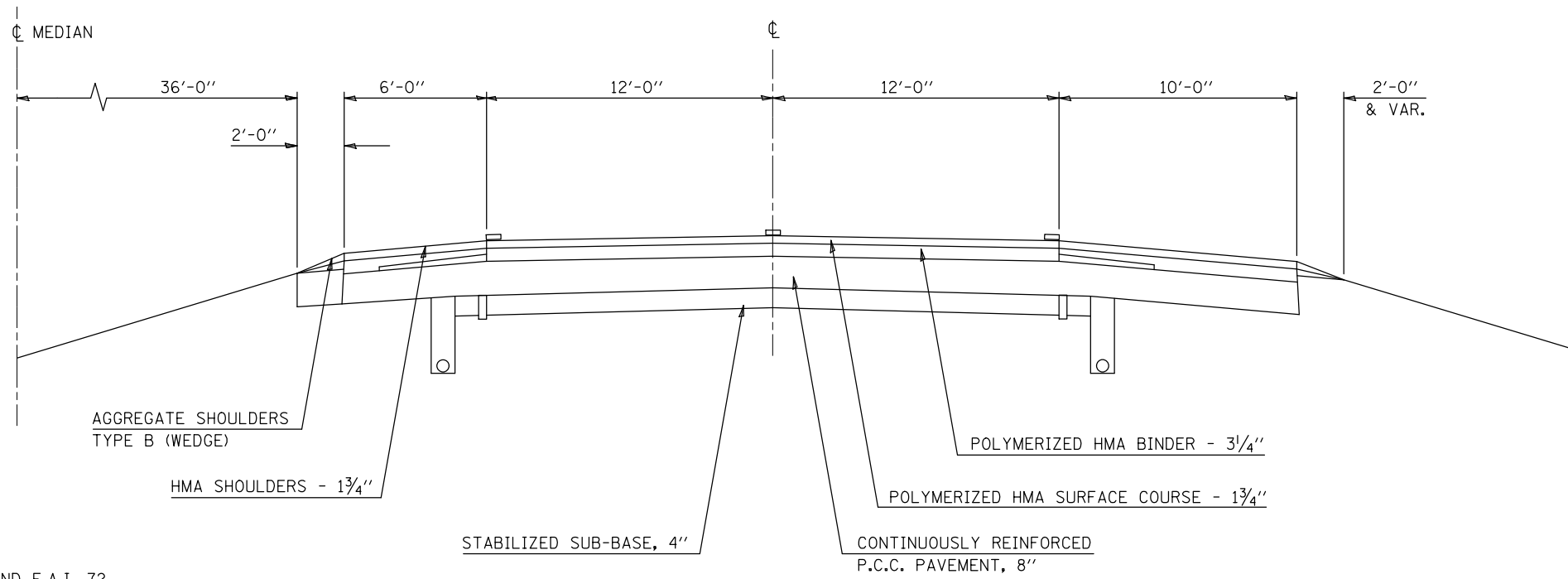

EASTBOUND F.A.I. 72 SHOWN, TYPICAL FOR WESTBOUND F.A.I. 72

FILE NAME =	USER NAME = gosnellc1	DESIGNED -	REVISED -	STATE OF ILLINOIS DEPARTMENT OF TRANSPORTATION	EXISTING TYPICAL CROSS SECTIONS LOCATION #1 (I-72)			F.A.I. RTE.	SECTION	COUNTY	TOTAL SHEETS	SHEET NO.
p:\11\084EBIDINTEG.illinois.gov\PIWIDOT\Documents\IDOT Offices\District 5\Projects\0570\DRAWING\Design\0570C39-shr-plan .dgn		CHECKED -	REVISED -		72&74	••	MCLEAN&PIAT	17	8			
MODELNAME	PLOT SCALE = 40.0000' / in.	DATE -	REVISED -		SCALE: N/A	SHEET 2 OF 2 SHEETS	STA. TO STA.	**D5 CRACK & JOINT SEAL 2017-1 CONTRACT NO. 70C39				
	PLOT DATE = 12/14/2016	DATE -	REVISED -		ILLINOIS FED. AID PROJECT							

STRUCTURE OMISSION
(W.B.); STATION 1126+47.10 TO STATION 1128+14.80

1

LOCATION 2 (I-74)
EXISTING TYPICAL CROSS SECTION

CRACK & JOINT OMISSION
(E.B.); STATION 1125+96.05 TO STATION 1127+93.71

STATION EQUATION:
STATION 1241+13.89 (BK) =
STATION 100+00.00 (AH)

WESTBOUND LANES
STATION TO STATION
1111+00.00 TO 1241+13.89 (BK) ②

EASTBOUND LANES
STATION TO STATION
1111+00.00 TO 1241+13.89 (BK) ②

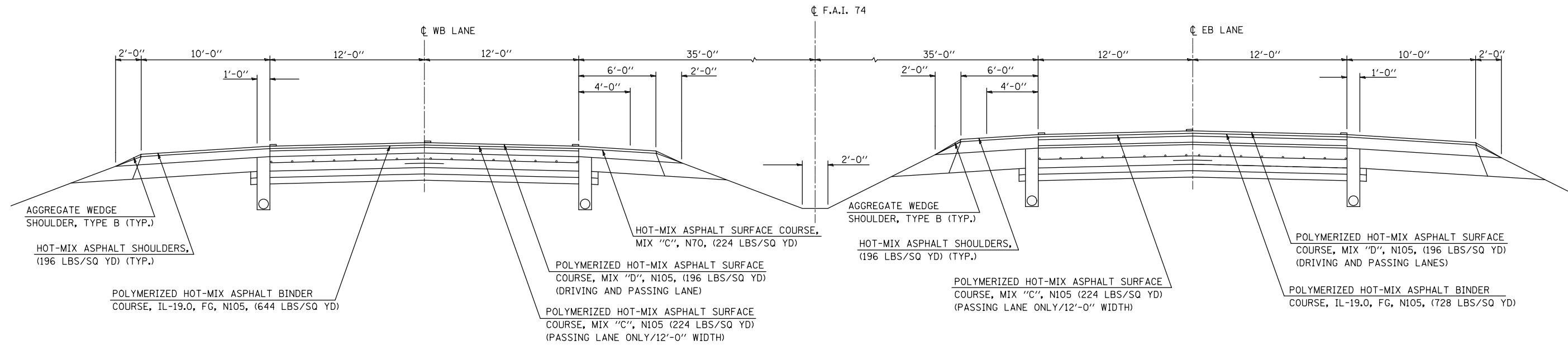

STATION EQUATION:
STATION 1241+13.89 (BK) =
STATION 100+00.00 (AH)

2

LOCATION 2 (I-74)
EXISTING TYPICAL CROSS SECTION

WESTBOUND LANES
STATION TO STATION
① 100+00.00 (AH) TO 375+87.00 ③

EASTBOUND LANES
STATION TO STATION
① 100+00.00 (AH) TO 375+91.00 ③

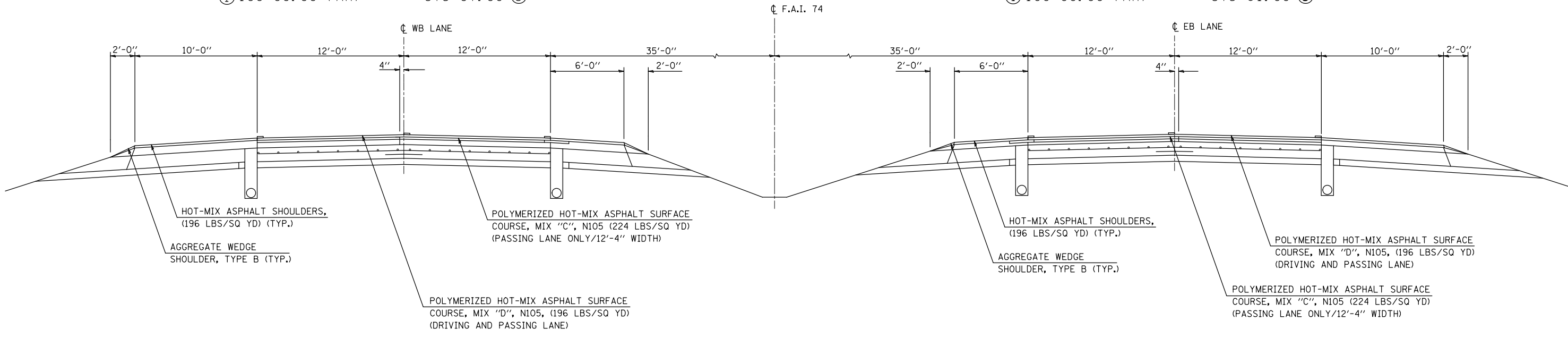

FILE NAME =	USER NAME = gosnellc1	DESIGNED -	REVISED -	STATE OF ILLINOIS DEPARTMENT OF TRANSPORTATION	EXISTING TYPICAL CROSS SECTIONS LOCATION #2 (I-74)			F.A.I. RTE.	SECTION	COUNTY	TOTAL SHEETS	SHEET NO.
pw:\IL\084EBIDINTEG.illinois.gov\PIWIDOT\Documents\IDOT Offices\District 5\Projects\0570\Drawings\Design\0570C39-shr-plan.dgn		CHECKED -	REVISED -					72&74	••	MCLEAN&PIAT	17	9
\$MODELNAME\$		DATE -	REVISED -					••D5 CRACK & JOINT SEAL 2017-1		CONTRACT NO. 70C39		
								ILLINOIS FED. AID PROJECT				

RAMP CB:
E.B. F.A.I. - 74 OFF-RAMP TO F.A.S. 1478

RAMP BD:
F.A.S. 1478 ON-RAMP TO F.A.I. - 74 E.B.

3

LOCATION 2 (I-74)
EXISTING TYPICAL CROSS SECTION

	STATION	TO	STATION
(RAMP CB)	0+00.00		6+77.40
(RAMP CB)	6+77.40		18+61.14
(RAMP BD)	0+23.81		12+81.00
(RAMP BD)	12+81.00		24+72.15

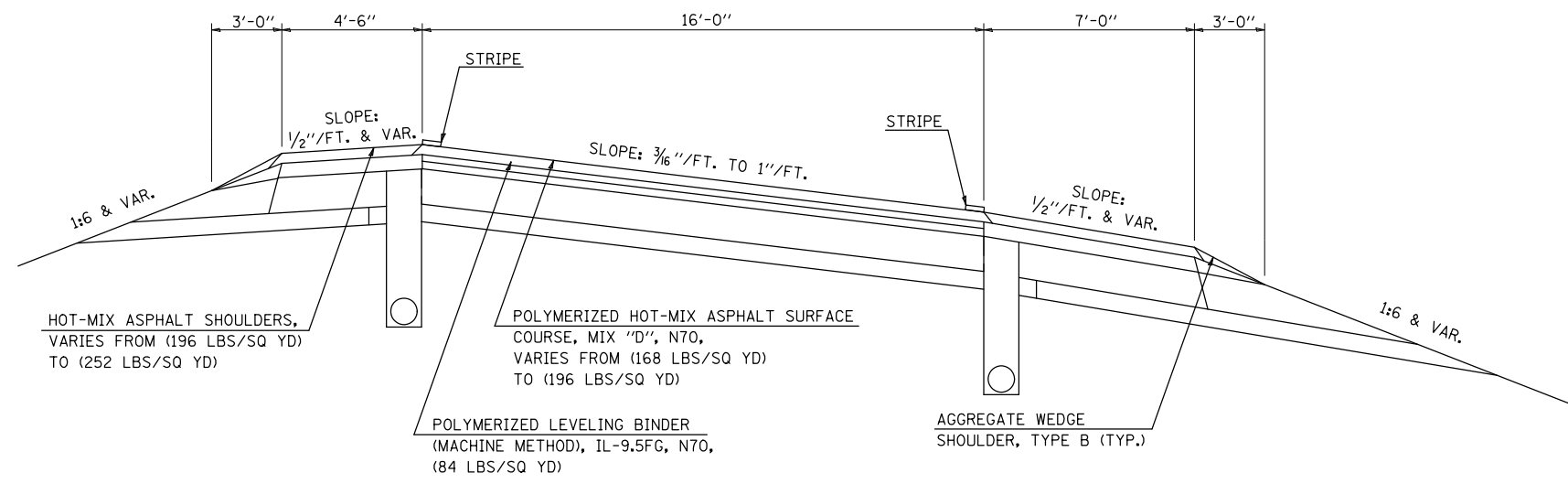

RAMP AC:
F.A.S. 1478 ON-RAMP TO F.A.I. - 74 W.B.

RAMP DA:
W.B. F.A.I. -74 OFF-RAMP TO F.A.S. 1478

4

LOCATION 2 (I-74)
EXISTING TYPICAL CROSS SECTION

	STATION	TO	STATION
(RAMP AC)	0+23.81		12+82.00
(RAMP AC)	12+82.00		24+80.64
(RAMP DA)	0+06.10		7+47.30
(RAMP DA)	7+47.30		18+64.85

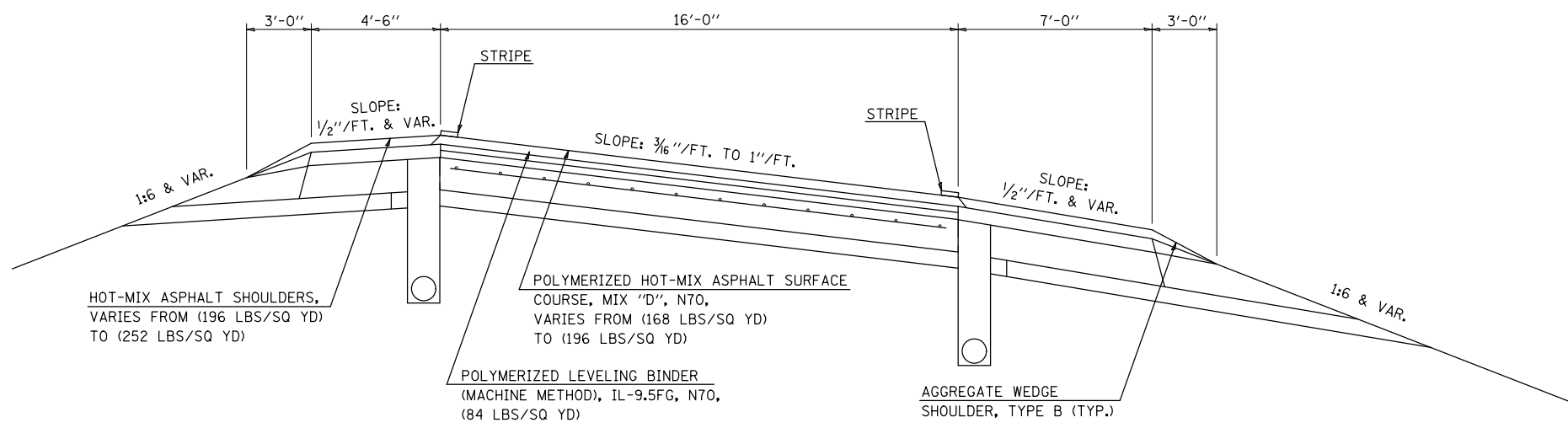

1

LOCATION 3 (I-74) EXISTING TYPICAL CROSS SECTION

STATION	TO	STATION
737+00.00		743+50.00
743+50.00		744+50.00 (S.E. TRANSITION) ②

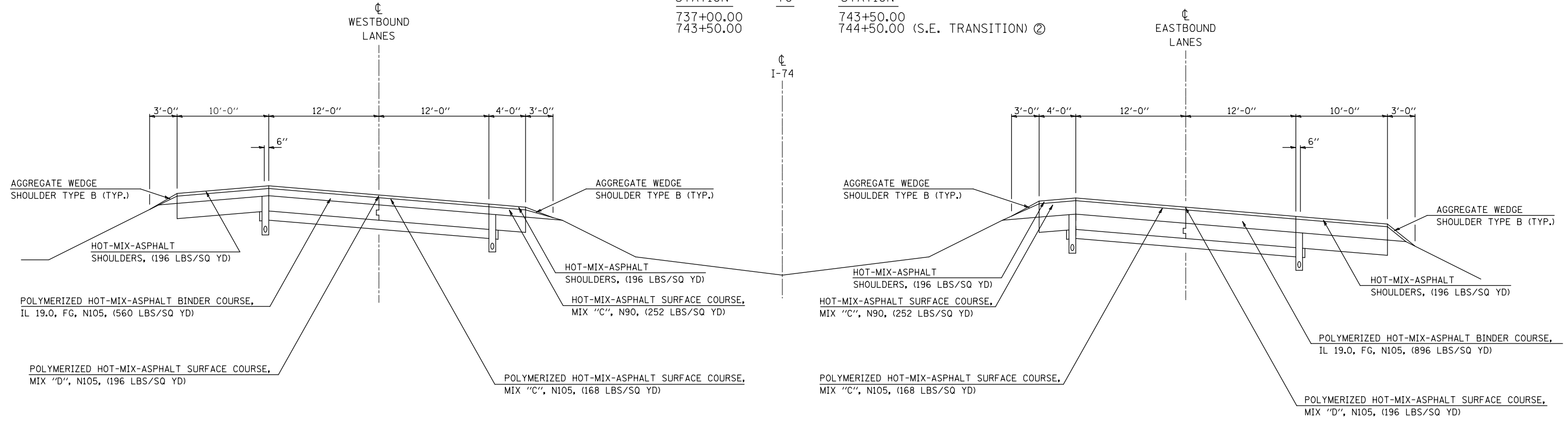

2

LOCATION 3 (I-74) EXISTING TYPICAL CROSS SECTION

STATION	TO	STATION
① 744+50.00		772+00.00 ③

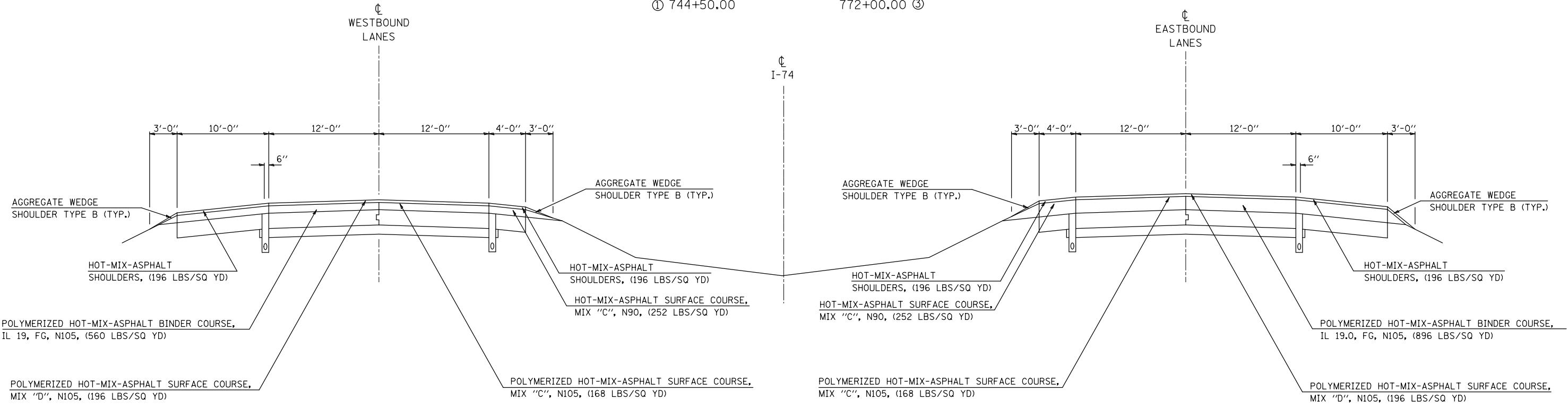

FILE NAME =	USER NAME = gosnellc1	DESIGNED -	REVISED -	STATE OF ILLINOIS DEPARTMENT OF TRANSPORTATION	EXISTING TYPICAL CROSS SECTIONS LOCATION #3 (I-74)			F.A.I. R.T.E.	SECTION	COUNTY	TOTAL SHEETS	SHEET NO.
pw:\IL\084EBIDINTEG.illinois.gov\PIWIDOT\Documents\DOT Offices\District 5\Projects\0579\Drawings\Design\0579039-shr-plan.dgn		CHECKED -	REVISED -					72&74	••	MCLEAN&PIAT	17	11
\$MODELNAME\$	PLOT SCALE = 40.0000' / in.	DATE -	REVISED -					••D5 CRACK & JOINT SEAL 2017-1	CONTRACT NO. 70C39			
	PLOT DATE = 12/14/2016							ILLINOIS FED. AID PROJECT				
				SCALE: N/A			SHEET 1 OF 6 SHEETS			STA. TO STA.		

5

LOCATION 3 (I-74) EXISTING TYPICAL CROSS SECTION

WESTBOUND LANES
STATION TO STATION
④ 782+93.91 TO 784+93.91
784+93.91 (S.E. TRANSITION) TO 829+11.75 ⑥

EASTBOUND LANES
STATION TO STATION
④ 782+93.91 TO 784+93.91
784+93.91 (S.E. TRANSITION) TO 831+00.10
831+00.10 (S.E. TRANSITION) ⑥ TO 833+00.10

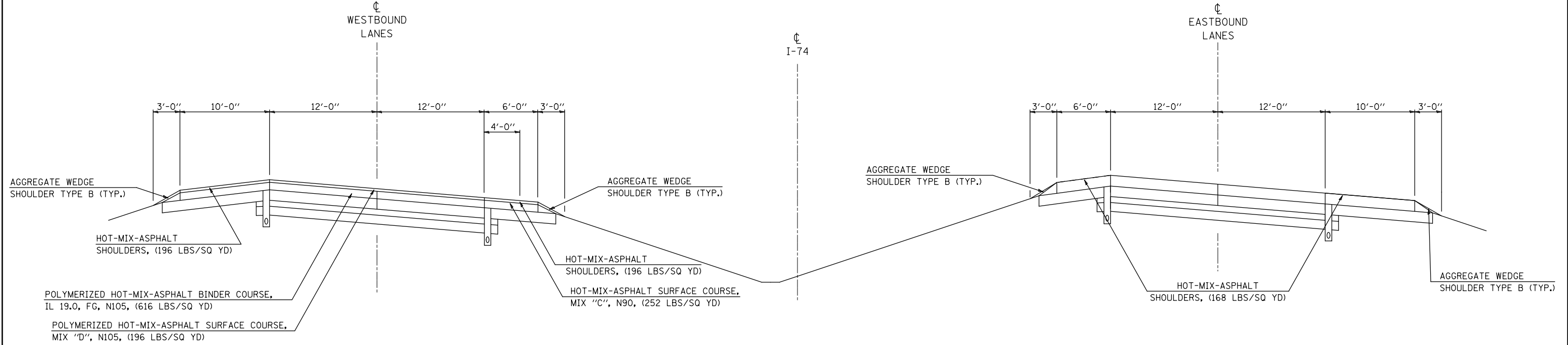

5A

LOCATION 3 (I-74) EXISTING TYPICAL CROSS SECTION

WESTBOUND LANES
STATION TO STATION
⑤ 829+11.75 TO 831+13.81
831+13.81 (S.E. TRANSITION) TO 833+13.81
833+13.81 (S.E. TRANSITION) TO 837+01.74
837+01.74 (S.E. TRANSITION) ⑦

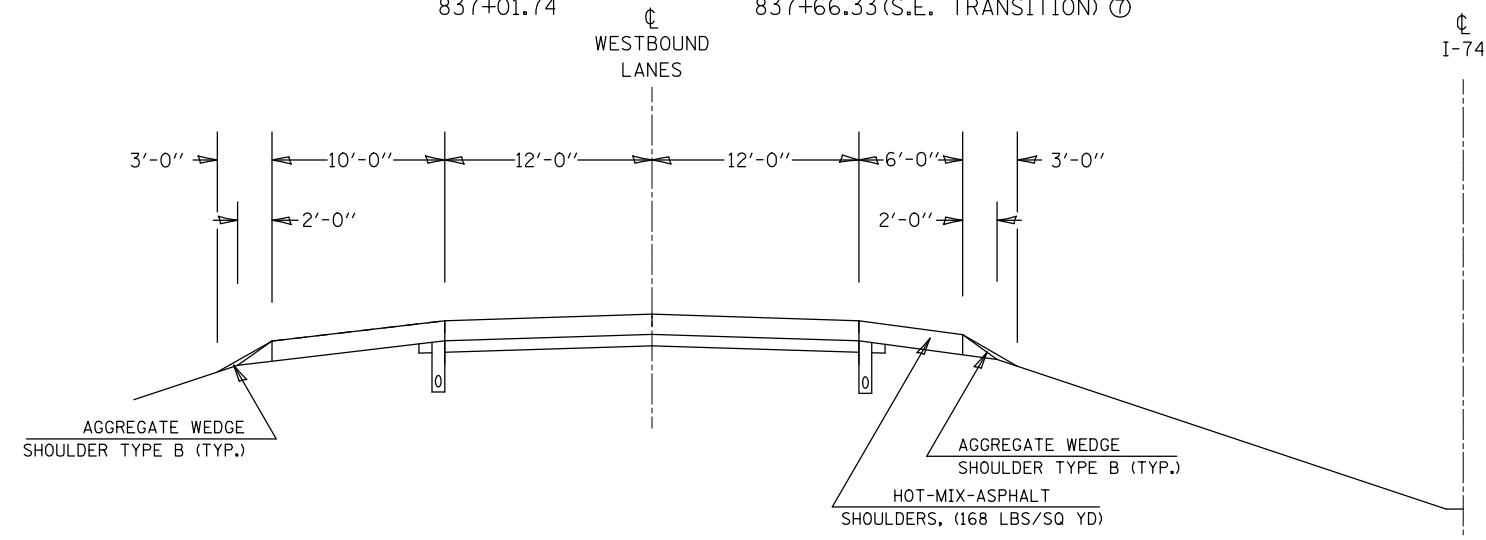

FILE NAME =	USER NAME = gosnellcl	DESIGNED -	REVISED -	STATE OF ILLINOIS DEPARTMENT OF TRANSPORTATION	EXISTING TYPICAL CROSS SECTIONS LOCATION #3 (I-74)				F.A.I. RTE.	SECTION	COUNTY	TOTAL SHEETS	SHEET NO.
pw:\IL\084EBIDINTEG\illinois.gov\PWIDOT\Documents\IDOT Offices\District 5\Projects\0570\DRAWING\Design\0570C39-shr-plan.dgn		REVISOR -	REVISED -		SCALE: N/A	SHEET 3	OF 6 SHEETS	STA.	TO STA.	72&74	MCLEAN&PIATT	17	13
MODELNAME	PLOT SCALE = 40.0219' / in.	CHECKED -	REVISED -						CONTRACT NO. 70C39				
	PLOT DATE = 12/14/2016	DATE -	REVISED -						ILLINOIS FED. AID PROJECT				

6

LOCATION 3 (I-74) EXISTING TYPICAL CROSS SECTION

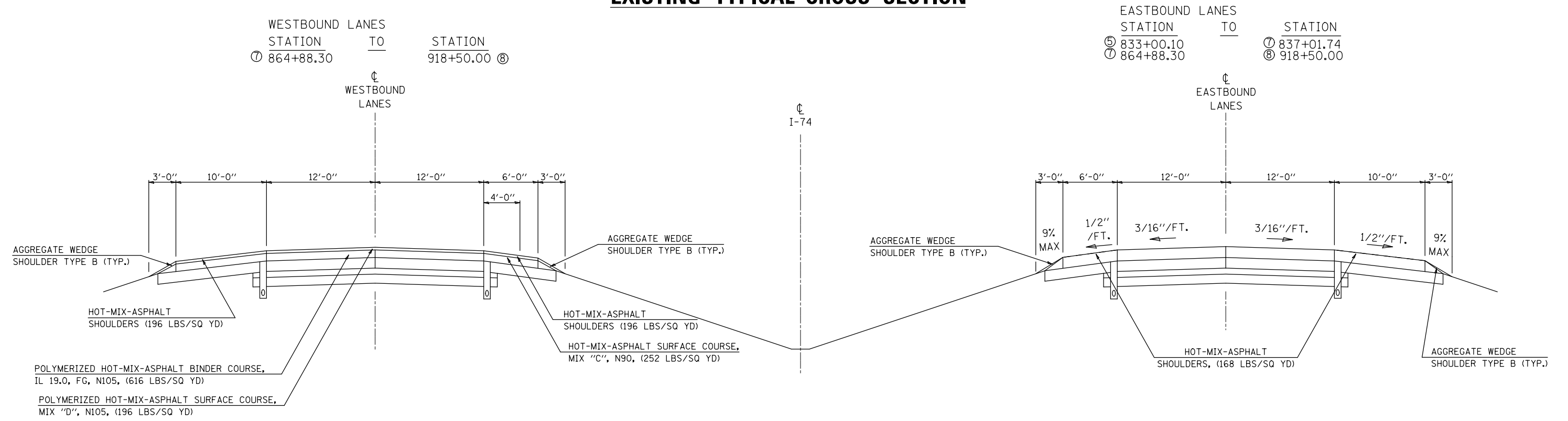

7

LOCATION 3 (I-74) EXISTING TYPICAL CROSS SECTION

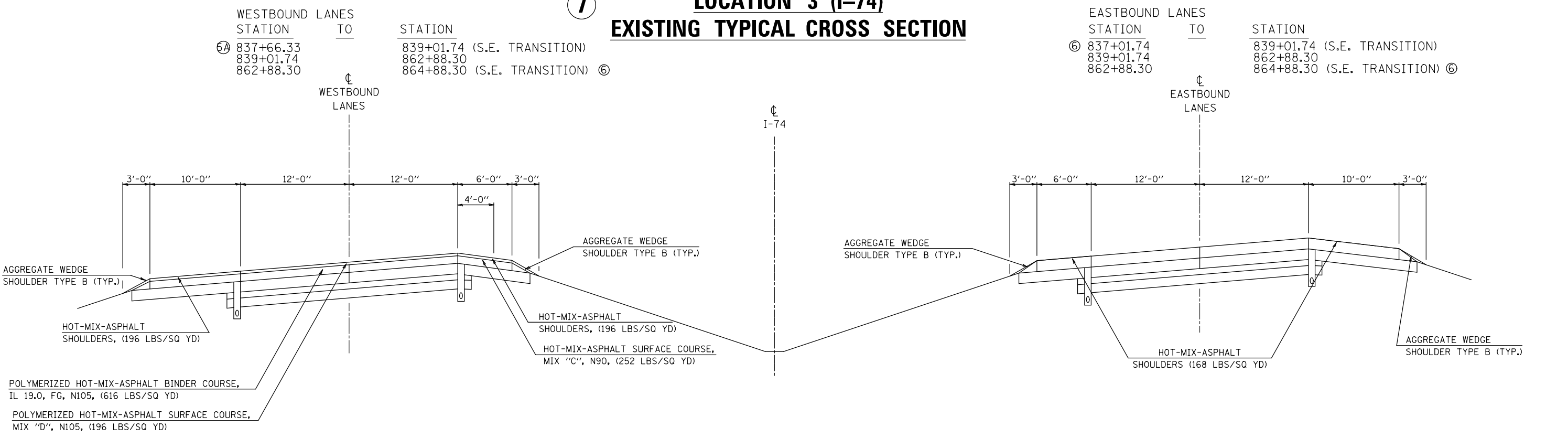

FILE NAME =	USER NAME = gosnellcl	DESIGNED -	REVISED -
p:\11\084EBIDINTEG\illinois.gov\PI\DOT\Documents\DOT Offices\District 5\Projects\0570\Drawings\Design\0570C39-shr-plan.dgn		REVISIONS	REVISIONS
		CHECKED -	REVISIONS
		DATE -	REVISIONS

STATE OF ILLINOIS
DEPARTMENT OF TRANSPORTATION

EXISTING TYPICAL CROSS SECTIONS			
LOCATION #3 (I-74)			
SCALE: N/A	SHEET 4	OF 6 SHEETS	STA. TO STA.

F.A.I. RTE.	SECTION	COUNTY	TOTAL SHEETS	SHEET NO.
72&74	••	MCLEAN&PIAT	17	14
••D5 CRACK & JOINT SEAL 2017-1			CONTRACT NO. 70C39	
ILLINOIS FED. AID PROJECT				

8

LOCATION 3 (I-74) EXISTING TYPICAL CROSS SECTION

WESTBOUND LANES
STATION TO STATION
⑥ 918+50.00 1037+74.25 ⑨

EASTBOUND LANES
STATION TO STATION
⑥ 918+50.00 1037+74.25 ⑨

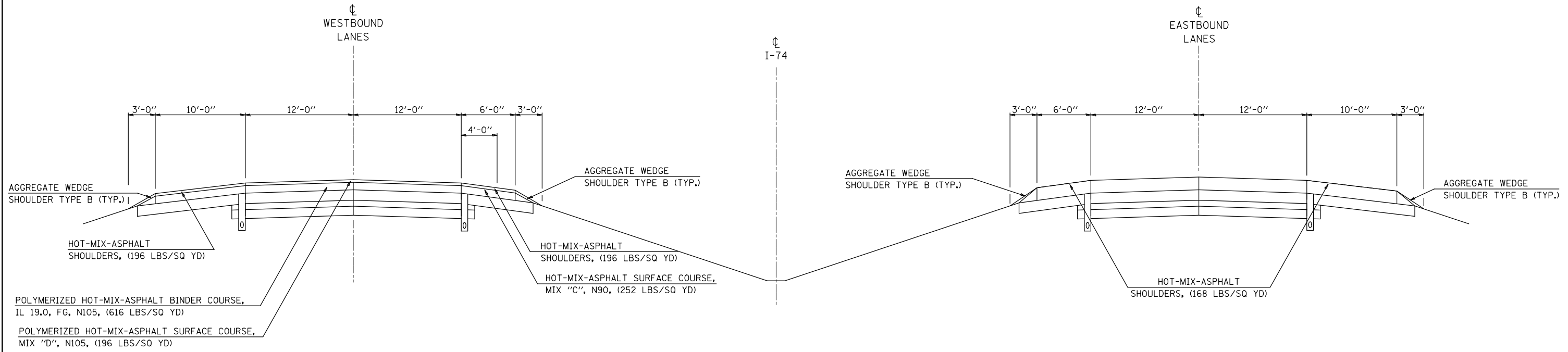

9

LOCATION 3 (I-74) EXISTING TYPICAL CROSS SECTION

WESTBOUND LANES
STATION TO STATION
1040+25.75 1111+00.00

EASTBOUND LANES
STATION TO STATION
1040+25.25 1111+00.00

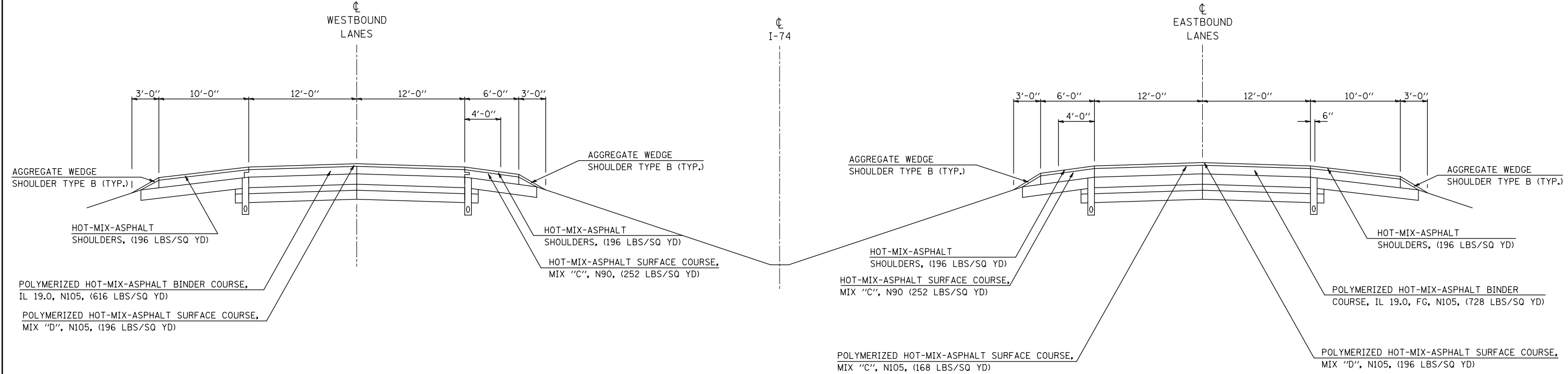

FILE NAME =	USER NAME = gosnellcl	DESIGNED -	REVISED -
p:\1\084EBIDINTEG\illinois.gov\PIWIDOT\Documents\IDOT Offices\District 5\Projects\0570\Drawings\Design\0570C39-shr-plan.dgn		REVISIONS	
	PLOT SCALE = 40.0219' / in.	CHECKED -	REVISED -
MODELNAME	PLOT DATE = 12/14/2016	DATE -	REVISED -

STATE OF ILLINOIS
DEPARTMENT OF TRANSPORTATION

EXISTING TYPICAL CROSS SECTIONS			
LOCATION #3 (I-74)			
SCALE: N/A	SHEET 5	OF 6 SHEETS	STA. TO STA.

F.A.I. RTE.	SECTION	COUNTY	TOTAL SHEETS	SHEET NO.
72&74	**	MCLEAN&PIATT	17	15
••D5 CRACK & JOINT SEAL 2017-1		CONTRACT NO. 70C39		
ILLINOIS FED. AID PROJECT				

10

**LOCATION 3 (I-74)
EXISTING TYPICAL CROSS SECTION**

OFF RAMPS CB AND DA

STATION TO STATION
 CB 10+00.00 28+63.98
 DA 10+00.00 27+60.49

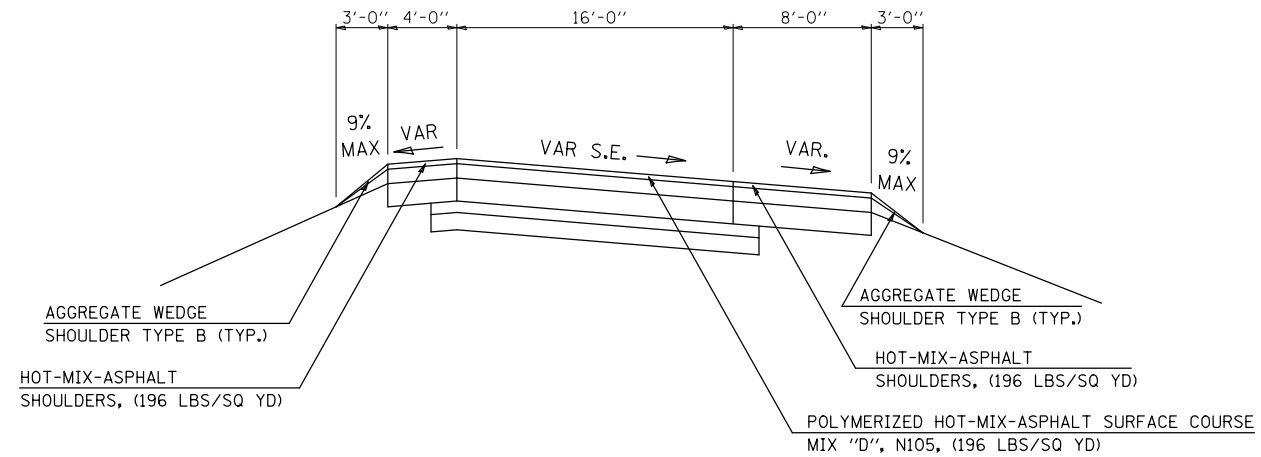

11

**LOCATION 3 (I-74)
EXISTING TYPICAL CROSS SECTION**

ON RAMPS AC AND BD

STATION TO STATION
 AC 10+24.00 31+64.13
 BD 10+24.00 32+79.31

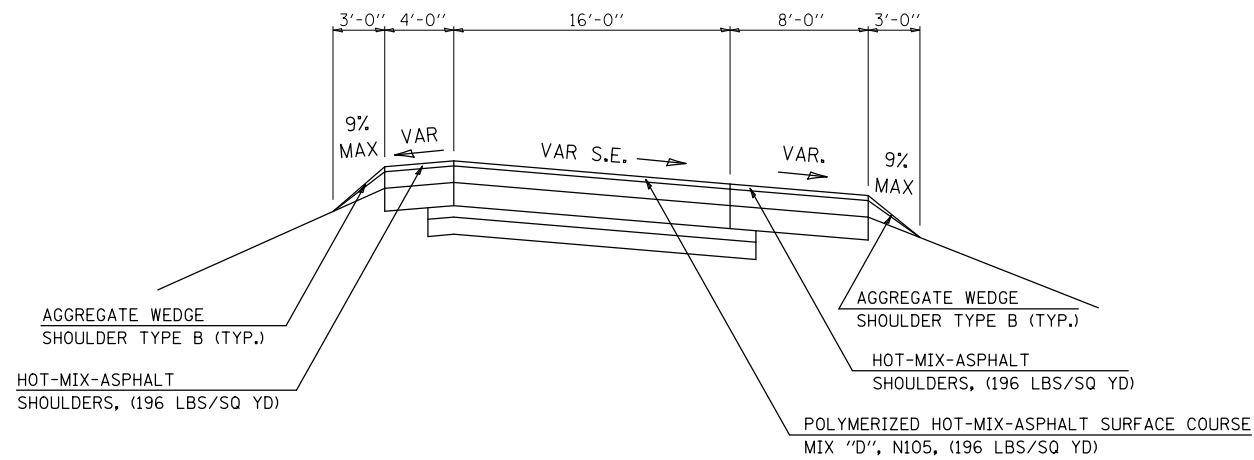

FILE NAME =	USER NAME = gosnellc1	DESIGNED -	REVISED -	STATE OF ILLINOIS DEPARTMENT OF TRANSPORTATION	EXISTING TYPICAL CROSS SECTIONS LOCATION #3 (I-74)			F.A.I. RTE.	SECTION	COUNTY	TOTAL SHEETS	SHEET NO.
p:\11\084EBIDINTEG\illinois.gov\PWIDOT\Documents\DOT Offices\District 5\Projects\0570\DRAWING\Design\0570C39-shr-plan.dgn		REVISOR -	REVISOR -					72&74	••	VARIOUS	17	16
MODELNAME	PLOT SCALE = 40.0219 ' / in.	CHECKED -	REVISOR -		SCALE: N/A			SHEET 6 OF 6 SHEETS STA. TO STA.			CONTRACT NO. 70C39	
	PLOT DATE = 12/14/2016	DATE -	REVISOR -		ILLINOIS FED. AID PROJECT							

HMA PAVEMENT

(USE PAY ITEMS : 45100100 CRACK ROUTING (PAVEMENT)
AND 45100200 CRACK FILLING)

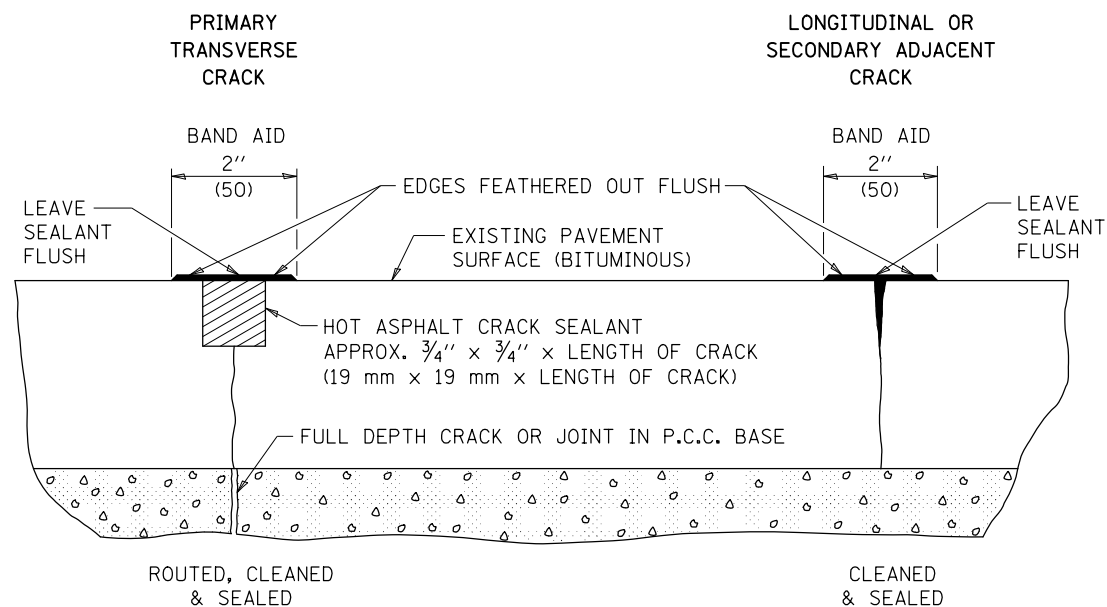

PCC PAVEMENT

(USE PAY ITEMS : 45200100 JOINT OR CRACK ROUTING (P.C.C. PAVEMENT & SHOULDER)
AND 45200300 JOINT OR CRACK FILLING)

TRANSVERSE CRACKS AND JOINTS AND CENTERLINE JOINT

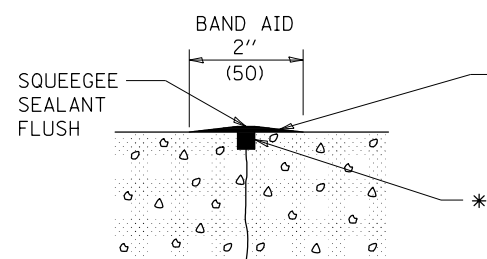

LONGITUDINAL SHOULDER JOINT

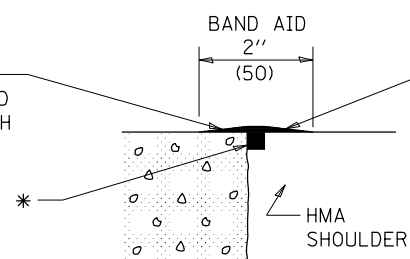

ANY WIDE LONGITUDINAL JOINT OR CRACK

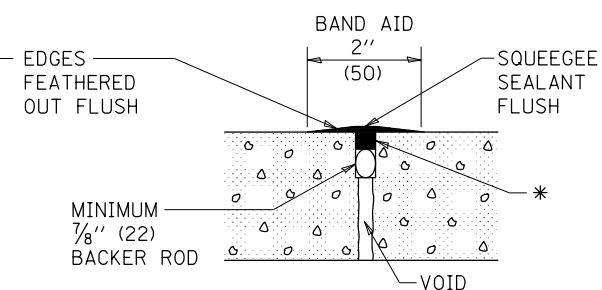

* HOT ASPHALT CRACK SEALANT
APPROX. 3/4 \" x 3/4 \" x LENGTH OF CRACK.
ACTUAL QUANTITY WILL VARY AS NEEDED FOR
PRIMARY OR SECONDARY WORKING CRACK.

LONGITUDINAL RANDOM CRACK

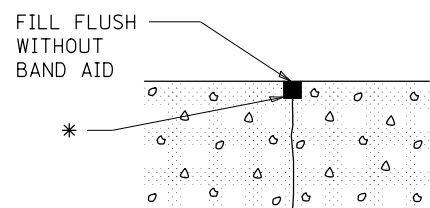

TRANSVERSE EXPANSION JOINT

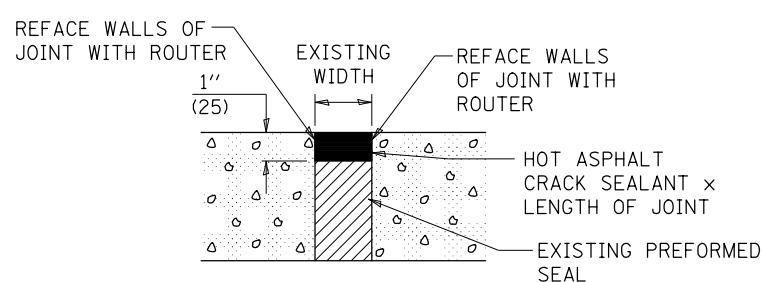

Note: All dimensions are in INCHES
(millimeters) unless otherwise shown.

FILE NAME =	USER NAME = gosnellcl	DESIGNED -	REVISED - -
p:\1\1084EBIDINTEG.illinois.gov\PIWIDOT\Documents\DOT Offices\District 5\Projects\0570039\0570039-shr-plan.dgn		CHECKED -	REVISED - -
		DATE -	REVISED - -

STATE OF ILLINOIS
DEPARTMENT OF TRANSPORTATION

CRACK AND JOINT SEALING

SCALE: SHEET NO. 1 OF 1 SHEETS STA. TO STA.

DISTRICT 5 DETAIL NO. 45AAAAAA

F.A.I. RTE.	SECTION	COUNTY	TOTAL SHEETS	SHEET NO.
72&74	**	MCLEAN&PIATT	17	17
**D5 CRACK & JOINT SEAL 2017-1			CONTRACT NO. 70C39	
FED. ROAD DIST. NO.		ILLINOIS FED. AID PROJECT		