

STATE OF ILLINOIS
DEPARTMENT OF TRANSPORTATION

P.A. RTE.	SECTION	COUNTY	TOTAL SHEETS	SHEET NO.
	ISP EVOC Track	SANGAMON	17	1
		ILLINOIS	CONTRACT NO. 72J82	

PROPOSED HIGHWAY PLANS

ISP TRAINING FACILITY
SECTION ISP EVOC TRACK

PATCHING & OVERLAY
SANGAMON COUNTY

C-96-046-17

INDEX OF SHEETS

- 1 COVER SHEET
- 2 HIGHWAY STANDARDS, GENERAL NOTES, APPLICATION RATES, MIXTURE INFORMATION, SIGNATURES
- 3 SUMMARY OF QUANTITIES
- 4-5 TYPICAL SECTIONS
- 6 SCHEDULE OF QUANTITIES
- 7 PROJECT OVERVIEW
- 8-13 PLAN SHEETS
- 14 PAVEMENT MARKING DETAIL
- 15 CURVE DATA
- 16-17 SUPERELEVATION TRANSITION DETAIL



LOCATION OF SECTION INDICATED THUS: - [thick black line] -

ADT
INFORMATION NOT AVAILABLE

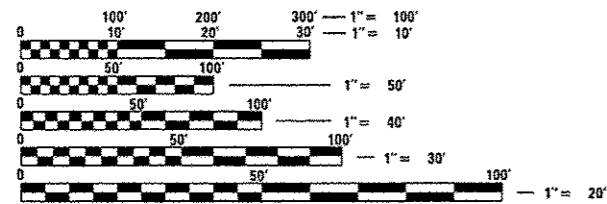

FULL SIZE PLANS HAVE BEEN PREPARED USING STANDARD ENGINEERING SCALES. REDUCED SIZED PLANS WILL NOT CONFORM TO STANDARD SCALES. IN MAKING MEASUREMENTS ON REDUCED PLANS, THE ABOVE SCALES MAY BE USED.

J.U.L.I.E.
JOINT UTILITY LOCATION INFORMATION FOR EXCAVATION
1-800-892-0123
OR 811

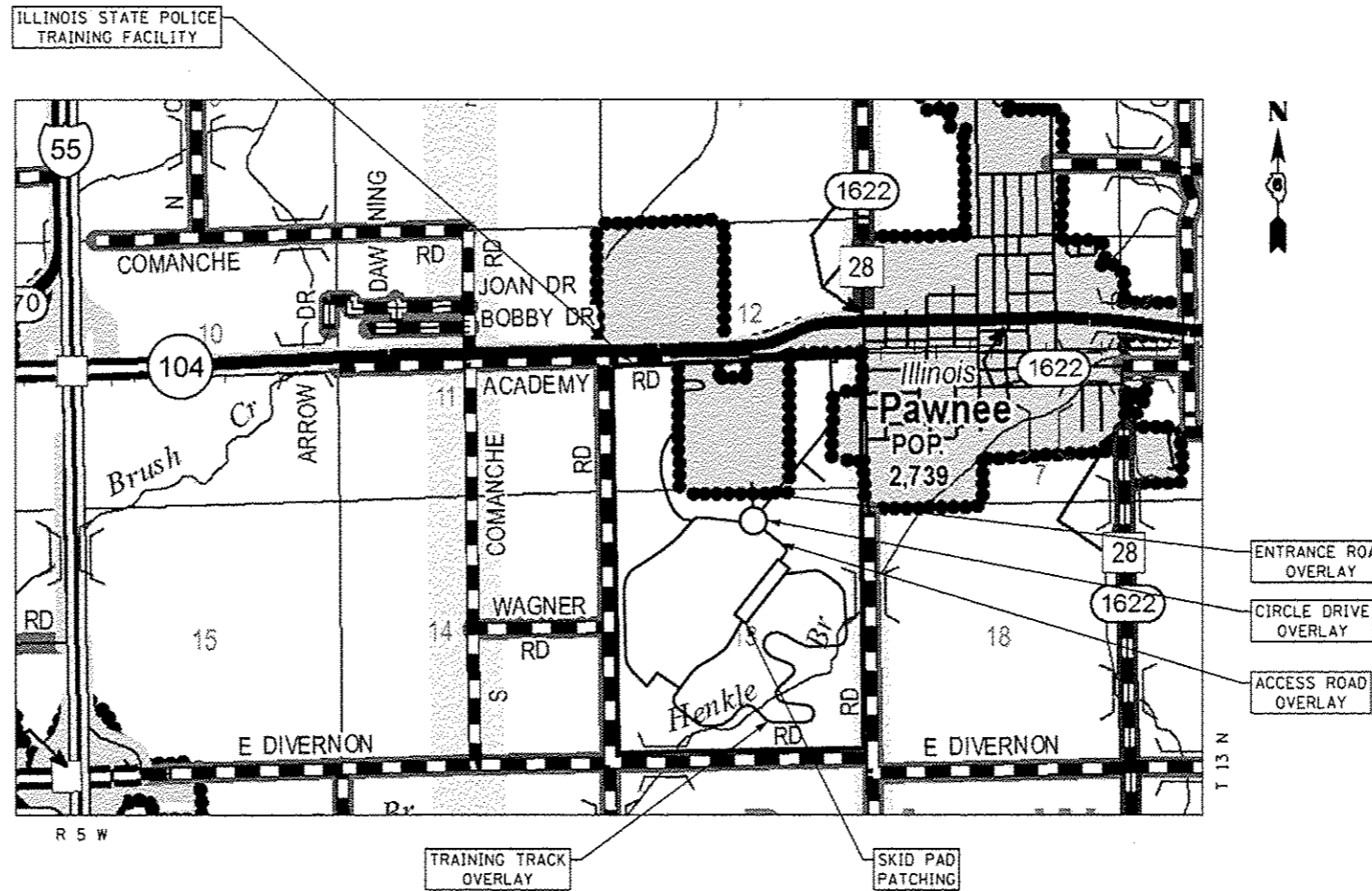

- ENTRANCE ROAD OVERLAY
- CIRCLE DRIVE OVERLAY
- ACCESS ROAD OVERLAY

PROJECT ENGINEER: MICHAEL IRWIN (217) 524-7765

NET LENGTH = 5,269.44 FT. = 0.998 MILE

CONTRACT NO. 72J82

STATE OF ILLINOIS
DEPARTMENT OF TRANSPORTATION

SUBMITTED 17 February 2017

[Signature] REGIONAL ENGINEER

Mar 24 2017
Maureen M. Adkins, P.E.
ENGINEER OF DESIGN AND ENVIRONMENT

Mar 24 2017
[Signature] 2
DIRECTOR OF PROGRAM DEVELOPMENT

PRINTED BY THE AUTHORITY
OF THE STATE OF ILLINOIS

HIGHWAY STANDARDS

000001-06	STANDARD SYMBOLS, ABBREVIATIONS & PATTERNS
442101-07	CLASS B PATCHES
482001-02	HMA SHOULDER ADJACENT TO FLEXIBLE PAVEMENT
601001-05	PIPE UNDERDRAINS
601101-02	CONCRETE HEADWALL FOR PIPE DRAIN
701601-09	URBAN LN CLOSURE, ML, 1W, OR 2W
701901-06	TRAFFIC CONTROL DEVICES

GENERAL NOTES

- ANY REFERENCE TO STANDARDS IN THESE PLANS SHALL BE INTERPRETED TO MEAN THE EDITION AS INDICATED BY THE SUB NUMBER LISTED IN THE INDEX OF SHEETS OR THE COPY OF THE STANDARD INCLUDED IN THESE PLANS.
- ALL ELEVATIONS SHOWN ON THE PLANS ARE ESTABLISHED FROM U.S.G.S. MEAN SEA LEVEL DATUM.
- THE CONTRACTOR SHALL BE RESPONSIBLE FOR PROTECTING UTILITY PROPERTY FROM CONSTRUCTION OPERATIONS, AS OUTLINED IN ARTICLE 107.31 OF THE STANDARD SPECIFICATIONS. THE J.U.L.I.E. NUMBER IS 1-800-892-0123. A MINIMUM OF 48 HOURS ADVANCE NOTICE IS REQUIRED.
- ACCESS MUST BE MAINTAINED TO ALL EXISTING FACILITIES DURING CONSTRUCTION UNLESS ARRANGEMENTS ARE MADE IN WRITING BY THE CONTRACTOR WITH THE ILLINOIS STATE POLICE. ALL AGREEMENTS SHALL BE MADE IN WRITING BY THE CONTRACTOR WITH A COPY TO THE ENGINEER FOR SHORT-TERM CLOSURES.
- CONTINUOUS PAVING OPERATIONS ON THE TRACK AND CIRCLE DRIVE SHALL BE MAINTAINED AT ALL TIMES DURING CONSTRUCTION OF THE HOT-MIX ASPHALT SURFACE. NO INTERRUPTIONS FOR SIDE ROADS AND ENTRANCES WILL BE ALLOWED.
- THE THICKNESS OF HOT-MIX ASPHALT MIXTURES SHOWN ON THE PLANS IS THE NOMINAL THICKNESS. DEVIATIONS FROM THE NOMINAL THICKNESS WILL BE PERMITTED WITH SUCH DEVIATIONS OCCUR DUE TO IRREGULARITIES IN THE EXISTING SURFACE OR BASE ON WHICH THE HOT-MIX ASPHALT MIXTURES IS PLACED.
- THE NOMINAL THICKNESS FOR SURFACE COURSE ARE SHOWN ON THE TYPICAL SECTIONS, STANDARDS, SCHEDULES, OR SPECIAL DETAILS. THE CONSTRUCTED THICKNESS OF THE ABOVE ITEMS SHALL NOT BE LESS THAN 90 PERCENT OF THE NOMINAL THICKNESS AT ANY LOCATION.
- ALL SAW CUTS NECESSARY TO COMPLETE THE WORK DETAILED IN THESE PLANS SHALL BE INCLUDED IN THE COST FOR THE VARIOUS PAY ITEMS INVOLVED. THE MINIMUM SAW CUT DEPTH IN THE PAVEMENT SHALL BE 1/2" UNLESS OTHERWISE SPECIFIED IN A DETAIL SHOWN IN THE PLANS.
- THE DISTRICT BUREAU OF OPERATIONS SHALL BE NOTIFIED AT LEAST 14 DAYS PRIOR TO PLACEMENT OF FINAL PAVEMENT MARKINGS; PHONE (217) 782-7314.
- EXISTING PAVEMENT DAMAGED DUE TO THE CONTRACTOR'S OPERATIONS, AND NOT OTHERWISE NECESSARY TO REPLACE, SHALL BE REPLACED AT THE EXPENSE OF THE CONTRACTOR.
- SEEDING SHALL BE DONE ON ALL AREAS THAT ARE DISTURBED BY CONSTRUCTION OPERATIONS AS DIRECTED BY THE ENGINEER. ALL AREAS DISTURBED BY THE CONTRACTOR OUTSIDE OF THE PROPOSED CONSTRUCTION LIMITS SHALL BE SEEDED, AS DIRECTED BY THE ENGINEER, AT THE CONTRACTOR'S EXPENSE. SEEDING WILL NOT BE PERMITTED AT ANY TIME WHEN THE GROUND IS FROZEN, WET, OR IN A UNTILLABLE CONDITION.
- ANY HMA PATCHES MADE DURING INSTALLATION OF PIPE UNDERDRAIN SHALL BE INCIDENTAL TO "PIPE DRAINS, 4." NO ADDITIONAL COMPENSATION SHALL BE ALLOWED.

APPLICATION RATES

THE FOLLOWING RATES OF APPLICATION HAVE BEEN USED TO CALCULATE THE PLAN QUANTITIES:

GRANULAR MATERIALS	2.05 TONS/CU YD
BITUMINOUS MATERIALS - TACK COAT (EXISTING HMA, MILLED SURFACE, CONCRETE, MILLED/TINED CONCRETE)	0.05 LB/SQ FT
BITUMINOUS MATERIALS - TACK COAT	0.025 LB/SQ FT
HMA SURFACE/BINDER	0.056 TONS/SQ YD*IN

MIXTURE INFORMATION

THE FOLLOWING MIXTURE REQUIREMENTS ARE APPLICABLE FOR THIS PROJECT:

TRACK, CIRCLE DRIVE, ACCESS ROAD, ENTRANCE ROAD	
MIXTURE USE(S):	HMA SURFACE •
PG:	PG 64-22
DESIGN FOR AIR VOIDS:	4.0% @ N50
MIXTURE COMPOSITION: (GRADATION MIXTURE)	IL 9.5
FRICTION AGGREGATE:	MIX "C"
QUALITY MANAGEMENT:	QC/QA
SUBLOT SIZE:	N/A

• TOP AND BOTTOM LIFT WHERE APPLICABLE

DISTRICT 6 SIGNATURES

STATE OF ILLINOIS DEPARTMENT OF TRANSPORTATION DIVISION OF HIGHWAYS DISTRICT 6	
EXAMINED	February 16, 20 17
	<i>John C. Wynn</i> ENGINEER OF OPERATIONS
EXAMINED	February 14, 20 17
	<i>Ron Chambers</i> ENGINEER OF PROJECT IMPLEMENTATION

EXAMINED	February 16, 20 17
	<i>Jeffrey P. May</i> ENGINEER OF PROGRAM DEVELOPMENT

1148 17

CODE NO.	ITEM	UNIT	TOTAL QUANTITY	6-01028-000	
				100% STATE ROADWAY 0005	RURAL
40600290	BITUMINOUS MATERIALS (TACK COAT)	POUND	9213	9213	
40600400	MIXTURE FOR CRACKS, JOINTS, AND FLANGEWAYS	TON	30	30	
40600982	HOT-MIX ASPHALT SURFACE REMOVAL - BUTT JOINT	SO YD	516.4	516.4	
40600990	TEMPORARY RAMP	SO YD	97.5	97.5	
40603310	HOT-MIX ASPHALT SURFACE COURSE, MIX "C", N50	TON	2847	2847	
40800050	INCIDENTAL HOT-MIX ASPHALT SURFACING	TON	171.5	171.5	
44200929	CLASS B PATCHES, TYPE I, 8 INCH	SO YD	21.2	21.2	
44200934	CLASS B PATCHES, TYPE II, 8 INCH	SO YD	23.8	23.8	
44200942	CLASS B PATCHES, TYPE III, 8 INCH	SO YD	165.7	165.7	
44201297	DOWEL BARS 1"	EACH	487	487	
48102100	AGGREGATE WEDGE SHOULDER, TYPE B	TON	366	366	
60100060	CONCRETE HEADWALLS FOR PIPE DRAINS	EACH	1	1	
60100905	PIPE DRAINS 4"	FOOT	189	189	
60107600	PIPE UNDERDRAINS 4"	FOOT	245	245	
67100100	MOBILIZATION	L SUM	1	1	

CODE NO.	ITEM	UNIT	TOTAL QUANTITY	6-01028-000	
				100% STATE ROADWAY 0005	RURAL
* 78001100	PAINT PAVEMENT MARKING - LETTERS AND SYMBOLS	SO FT	6.2	6.2	
* 78001110	PAINT PAVEMENT MARKING - LINE 4"	FOOT	9771	9771	
* 78001140	PAINT PAVEMENT MARKING - LINE 8"	FOOT	405	405	
X0320157	CLEANING UNDERDRAIN OUTLETS	EACH	44	44	
X4401198	HOT-MIX ASPHALT SURFACE REMOVAL, VARIABLE DEPTH	SO YD	16203	16203	
6 XT010216	TRAFFIC CONTROL AND PROTECTION, (SPECIAL)	LSUM	1	1	

* SPECIALTY ITEM

REV

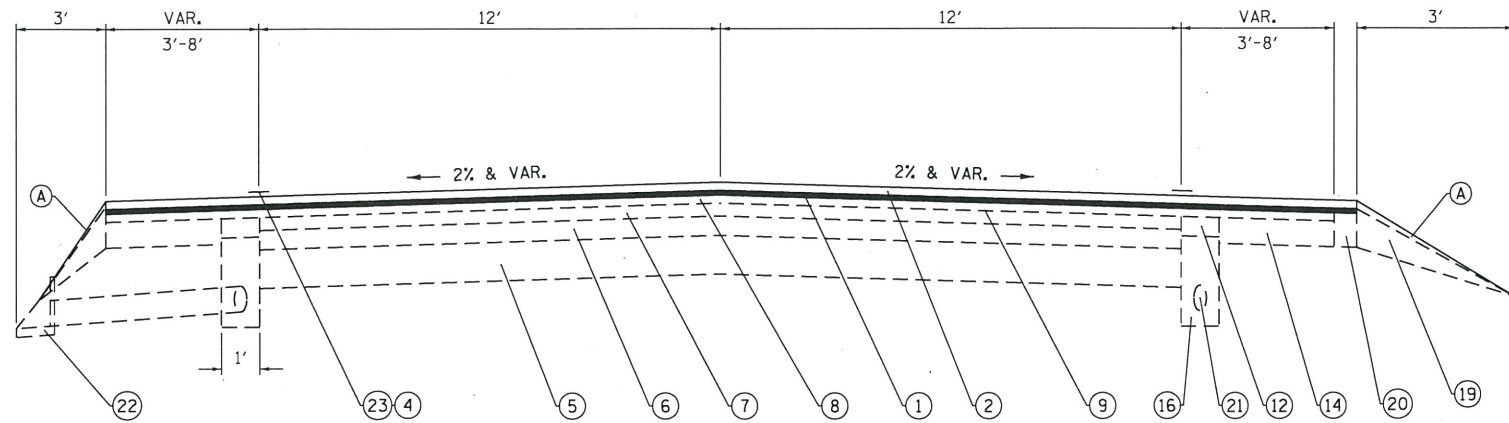

TYPICAL SECTION - TRAINING TRACK

STA 0+00 TO STA 43+17

LEGEND

- ① PROPOSED HMA SURFACE REMOVAL, VARIABLE DEPTH, 3/4"
- ② PROPOSED HMA SURFACE COURSE, MIX "C", N50, 2"
- ③ PROPOSED HMA SURFACE COURSE, MIX "C", N50, 4"
- ④ PROPOSED PAINT PAVEMENT MARKING - LINE 4" (WHITE)
- (A) PROPOSED AGGREGATE WEDGE SHOULDERS, TY B
- (B) PROPOSED PIPE UNDERDRAIN 4"
- ⑤ EXISTING AGGREGATE BASE COURSE, TY A, 6"
- ⑥ EXISTING BITUMINOUS PAVEMENT, CLASS I, 3"
- ⑦ EXISTING BITUMINOUS SURFACE COURSE, CLASS I, TY 2, MIX C, 2"
- ⑧ EXISTING BITUMINOUS SURFACE COURSE, CLASS I, TY 1, MIX D, 2"
- ⑨ EXISTING AREA REFLECTIVE CRACK CONTROL FABRIC, SYSTEM A, (ENTIRE PAVED SURFACE)
- ⑩ EXISTING P.C.C. SKID PAD, 5"
- ⑪ EXISTING P.C.C. WITH WELDED WIRE FABRIC, 3"
- ⑫ EXISTING BITUMINOUS SHOULDER MATERIAL, 3"
- ⑬ EXISTING BITUMINOUS SHOULDER MATERIAL, 5"
- ⑭ EXISTING BITUMINOUS SHOULDER BASE COURSE, 4"
- ⑮ EXISTING BITUMINOUS SURFACE TREATMENT, CLASS A-2, 1 1/2"
- ⑯ EXISTING CA-16 MATERIAL
- ⑰ EXISTING CRUSHED STONE CA-7 MATERIAL, 6"
- ⑱ EXISTING AGGREGATE WEDGE
- ⑲ EXISTING EARTH SHOULDERS
- ⑳ EXISTING CONCRETE CURB
- ㉑ EXISTING PVC PIPE UNDERDRAIN (VAR DEPTH), 4"
- ㉒ EXISTING CONCRETE HEADWALL
- ㉓ EXISTING PAINT PAVEMENT MARKING - LINE 4" (WHITE)

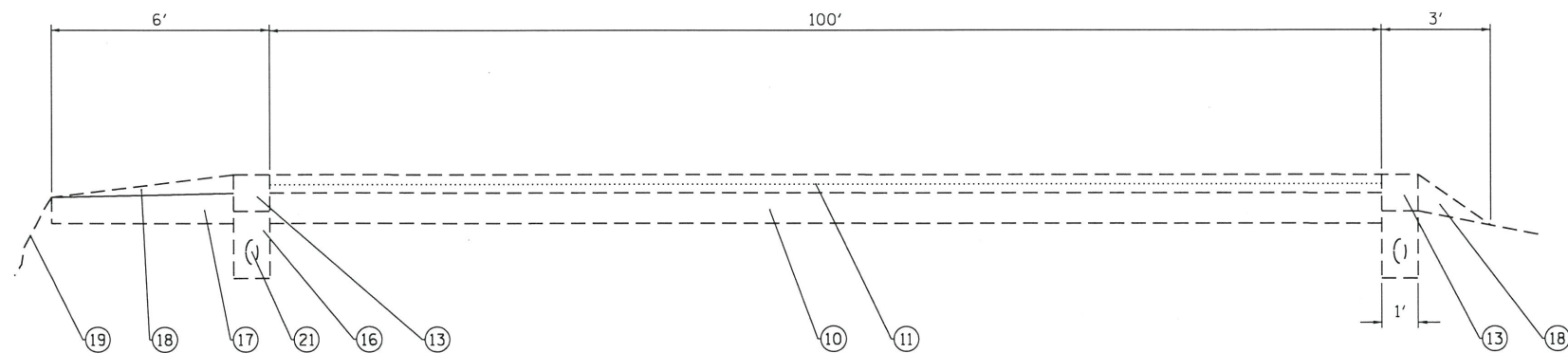

TYPICAL SECTION - SKID PAD

NOTES:

1. TYPICAL SECTIONS ARE DERIVED FROM EXISTING PLANS
2. TYPICAL SECTIONS ARE NOT TO SCALE

FILE NAME =	USER NAME = shahdm	DESIGNED - DMS 2-7-17	REVISED -	STATE OF ILLINOIS DEPARTMENT OF TRANSPORTATION	TYPICAL SECTIONS			F.A. RTE.	SECTION	COUNTY	TOTAL SHEETS	SHEET NO.	
pw:\IL084EBIDINTEG\Illinois.gov\PIDOT\Documents\IDOT Offices\District 6\Projects\0672\DRAWING\EA\shahdm\2-7-17-shd-typical		DATA	REVISED -		SCALE:	SHEET 1	OF 2	SHEETS	STA.	TO STA.	SANGAMON	17	4
Default	PLOT SCALE = 40,0000 ' / in.	CHECKED -	REVISED -								CONTRACT NO. 72J82		
	PLOT DATE = 2/17/2017	DATE -	REVISED -								ILLINOIS FED. AID PROJECT		

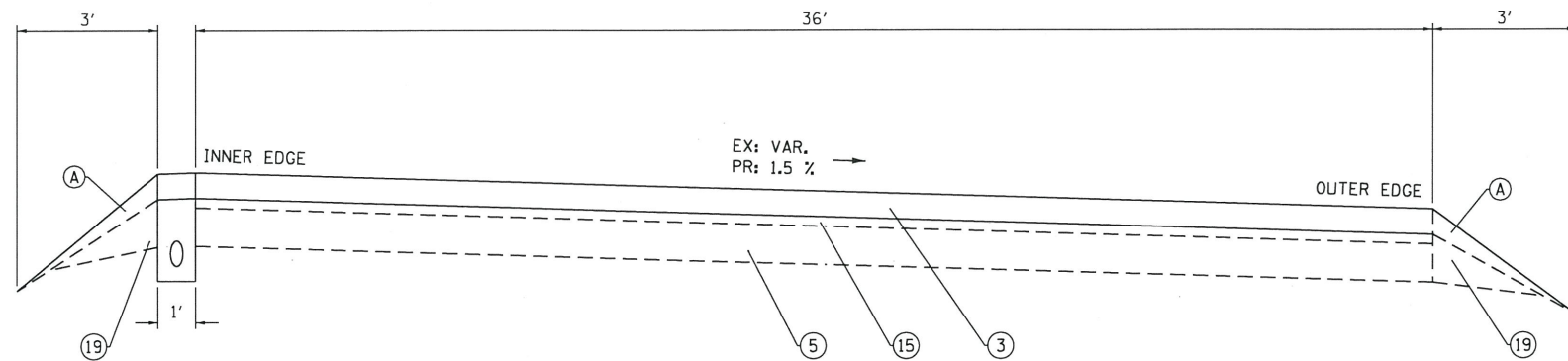

TYPICAL SECTION - CIRCLE DRIVE

(SEE NOTE 3)

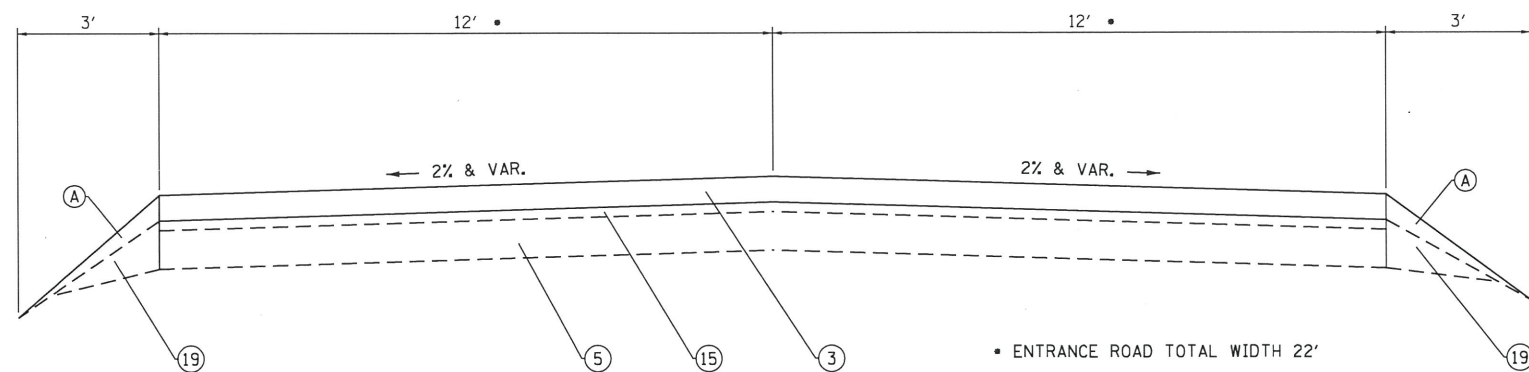

TYPICAL SECTION - ACCESS ROAD & ENTRANCE ROAD

LEGEND

- ① PROPOSED HMA SURFACE REMOVAL, VARIABLE DEPTH, 3/4"
- ② PROPOSED HMA SURFACE COURSE, MIX "C", N50, 2"
- ③ PROPOSED HMA SURFACE COURSE, MIX "C", N50, 4"
- ④ PROPOSED PAINT PAVEMENT MARKING - LINE 4" (WHITE)
- Ⓐ PROPOSED AGGREGATE WEDGE SHOULDERS, TY B
- Ⓑ PROPOSED PIPE UNDERDRAIN 4"
- ⑤ EXISTING AGGREGATE BASE COURSE, TY A, 6"
- ⑥ EXISTING BITUMINOUS PAVEMENT, CLASS I, 3"
- ⑦ EXISTING BITUMINOUS SURFACE COURSE, CLASS I, TY 2, MIX C, 2"
- ⑧ EXISTING BITUMINOUS SURFACE COURSE, CLASS I, TY 1, MIX D, 2"
- ⑨ EXISTING AREA REFLECTIVE CRACK CONTROL FABRIC, SYSTEM A, (ENTIRE PAVED SURFACE)
- ⑩ EXISTING P.C.C. SKID PAD, 5"
- ⑪ EXISTING P.C.C. WITH WELDED WIRE FABRIC, 3"
- ⑫ EXISTING BITUMINOUS SHOULDER MATERIAL, 3"
- ⑬ EXISTING BITUMINOUS SHOULDER MATERIAL, 5"
- ⑭ EXISTING BITUMINOUS SHOULDER BASE COURSE, 4"
- ⑮ EXISTING BITUMINOUS SURFACE TREATMENT, CLASS A-2, 1 1/2"
- ⑯ EXISTING CA-16 MATERIAL
- ⑰ EXISTING CRUSHED STONE CA-7 MATERIAL, 6"
- ⑱ EXISTING AGGREGATE WEDGE
- ⑲ EXISTING EARTH SHOULDERS
- ⑳ EXISTING CONCRETE CURB
- ㉑ EXISTING PVC PIPE UNDERDRAIN (VAR DEPTH), 4"
- ㉒ EXISTING CONCRETE HEADWALL
- ㉓ EXISTING PAINT PAVEMENT MARKING - LINE 4" (WHITE)

NOTES:

1. TYPICAL SECTIONS ARE DERIVED FROM EXISTING PLANS
2. TYPICAL SECTIONS ARE NOT TO SCALE
3. 4" LIFT SHALL BE PLACED IN TWO 2" LIFTS

FILE NAME =	USER NAME = shahdm	DESIGNED - DMS 2-7-17	REVISED -	STATE OF ILLINOIS DEPARTMENT OF TRANSPORTATION	TYPICAL SECTIONS			F.A. RTE.	SECTION	COUNTY	TOTAL SHEETS	SHEET NO.		
pw\11084EBIDINTEG.illinois.gov\PIWIDOT\Documents\DOT Offices\District 6\Projects\0672\DRAWING\DATA\HEADSH\0672\sh-typic		DRAWN - DMS 2-7-17	REVISED -		SCALE:	SHEET 2	OF 2	SHEETS	STA.	TO STA.	ISP EVOC Track	SANGAMON	17	5
Default		PLOT SCALE = 40,0000' / in.	REVIS											
		PLOT DATE = 2/17/2017	REVIS											
											CONTRACT NO. 72JB2		ILLINOIS FED. AID PROJECT	

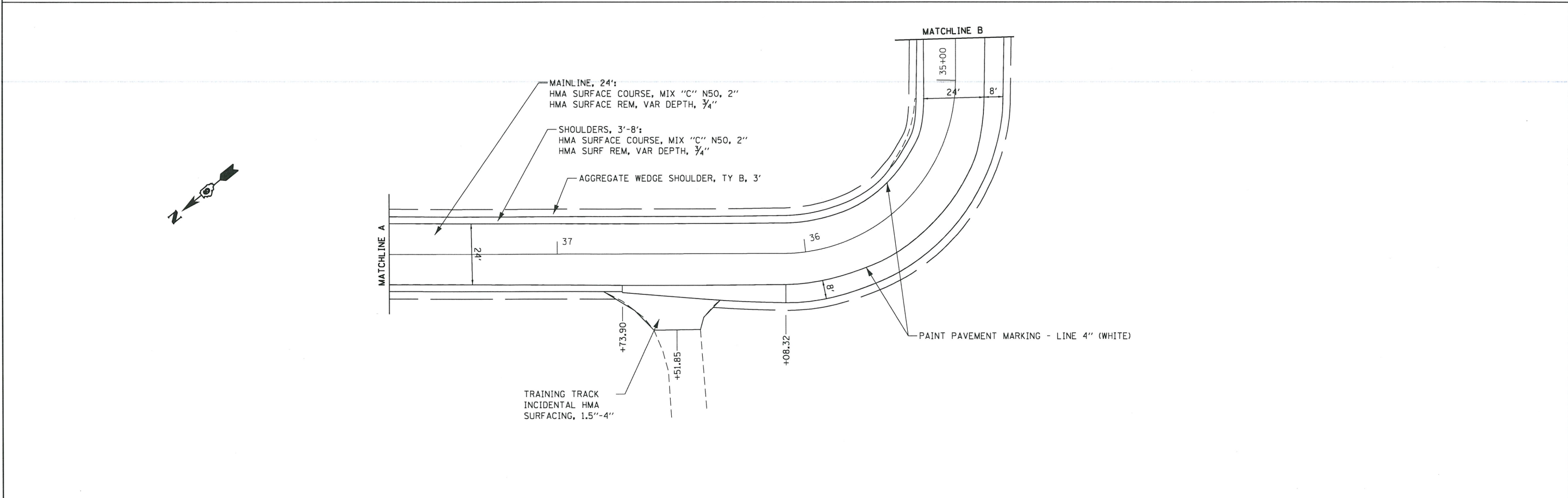
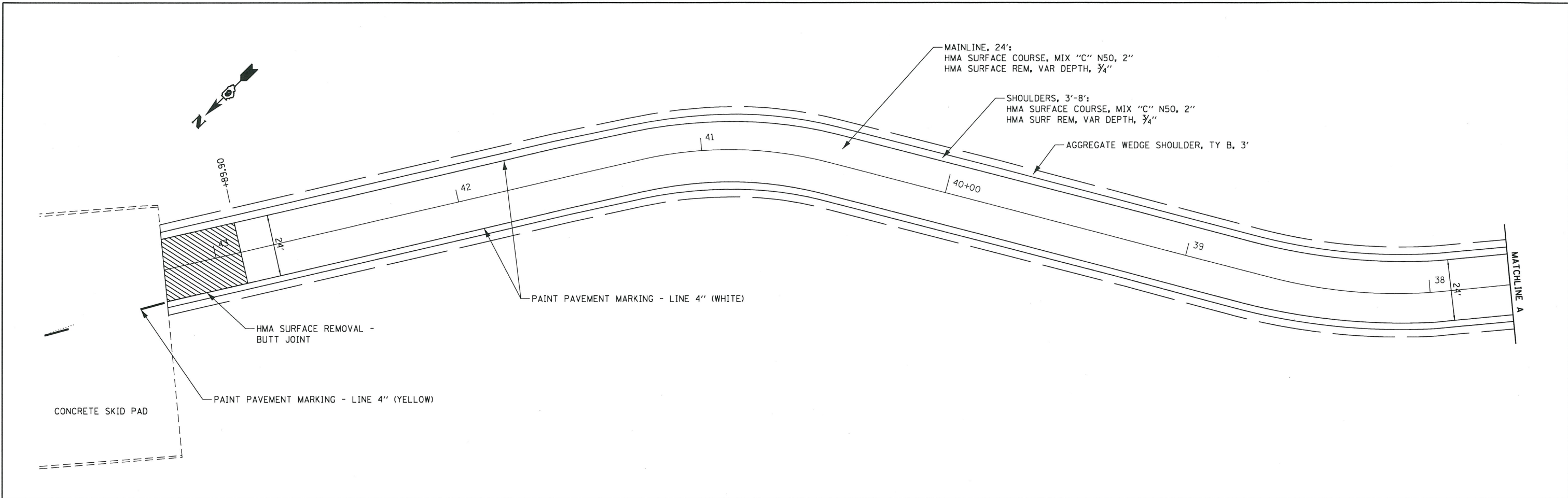

FILE NAME =	USER NAME = shahdn	DESIGNED - DMS 2/2017	REVISED -	STATE OF ILLINOIS DEPARTMENT OF TRANSPORTATION	PLAN SHEET TRAINING TRACK		F.A. RTE.	SECTION	COUNTY	TOTAL SHEETS	SHEET NO.
pw\l\084EBID\INTEG\illinois.gov\PWIDOT\Documents\DOT Offices\District 6\Projects\0872\DRAWING\DATA\EA0\Sheets\0672J82-sht-plan	PLLOT SCALE = 40,0000' / in.	CHECKED -	REVISED -		SCALE:	SHEET 2 OF 6 SHEETS	STA.	ISP EVOC Track	SANGAMON	17	9
Default	PLLOT DATE = 2/17/2017	DATE -	REVISED -		TO STA.			CONTRACT NO. 72J82			
							ILLINOIS FED. AID PROJECT				

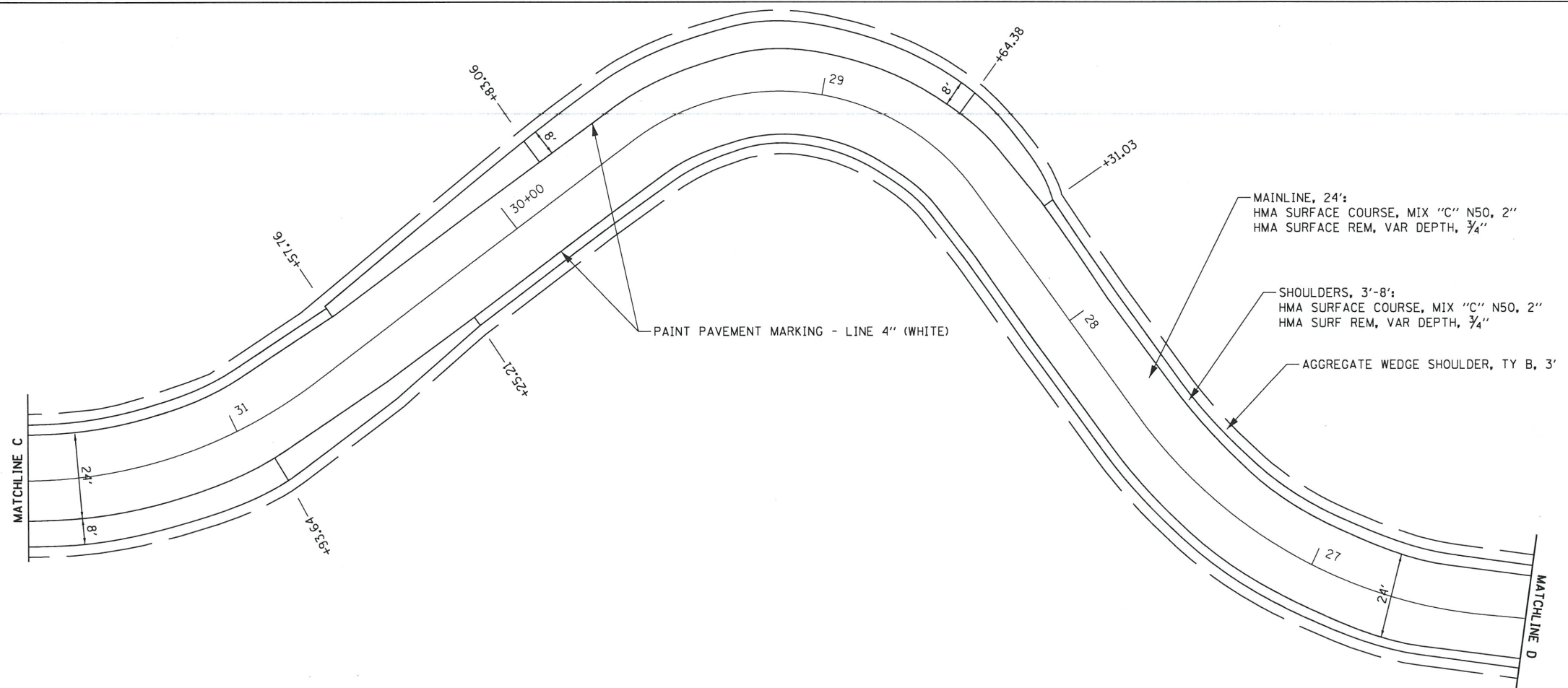
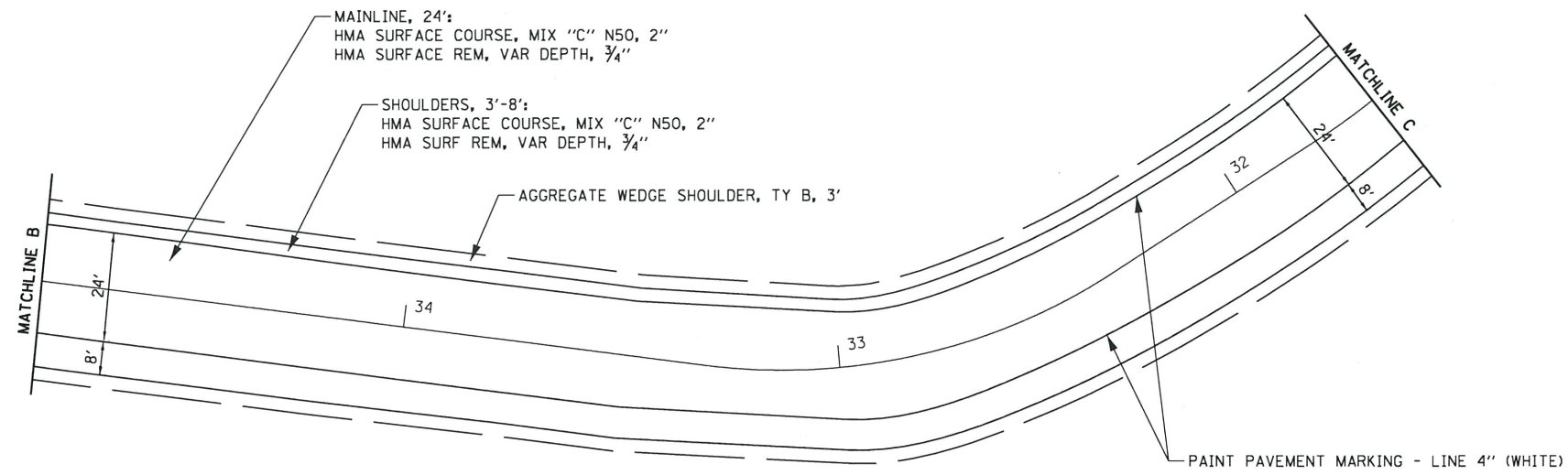
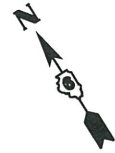

FILE NAME =	USER NAME = shahdn	DESIGNED - DMS 2/2017	REVISED -
pw\1\084EBID\INTEG\illinois.gov\PWIDOT\Documents\IDOT Offices\District 6\Projects\0672\DRAWING\DATA\HEADSHEETS\0672J82-sht-plan.dwg		DRAWN	REVISED -
	PLOT SCALE = 40,0000' / in.	CHECKED -	REVISED -
Default	PLOT DATE = 2/17/2017	DATE -	REVISED -

STATE OF ILLINOIS
DEPARTMENT OF TRANSPORTATION

PLAN SHEET
TRAINING TRACK

SCALE: SHEET 3 OF 6 SHEETS STA. TO STA.

F.A. RTE.	SECTION	COUNTY	TOTAL SHEETS	SHEET NO.
	ISP EVOC Track	SANGAMON	17	10
CONTRACT NO. 72J82			ILLINOIS FED. AID PROJECT	

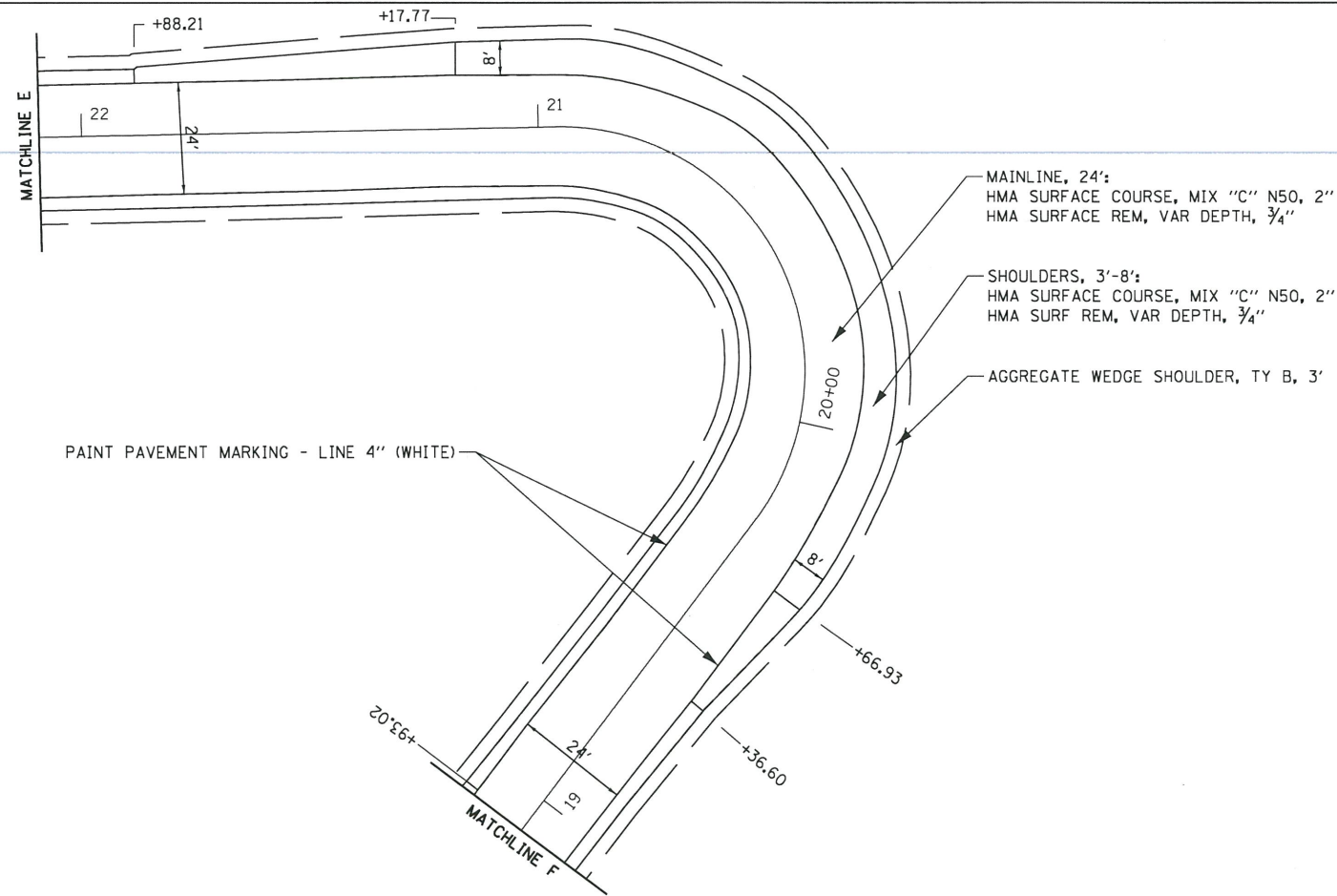
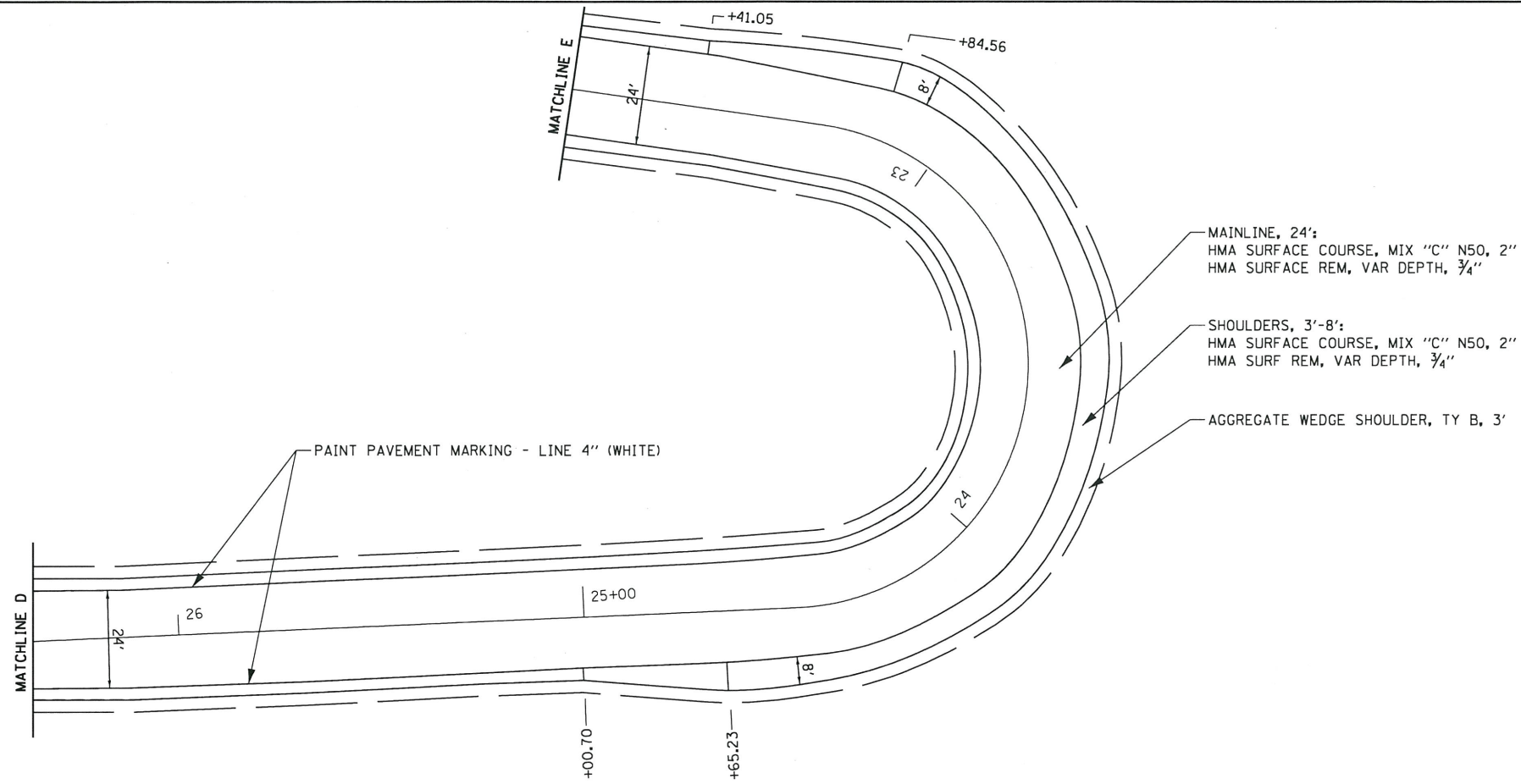

FILE NAME =	USER NAME = shehdm	DESIGNED - DMS 2/2017	REVISED -
p:\l\084EBID\INTEG.illinois.gov\PI\DOT\Documents\DOT Offices\District 6\Projects\0672\DRAWING\DATA\HEADSHEETS\0672J82-shr-plan			REVISED -
Default	PLOT SCALE = 40.0000' / in.	CHECKED -	REVISED -
	PLOT DATE = 2/17/2017	DATE -	REVISED -

**STATE OF ILLINOIS
DEPARTMENT OF TRANSPORTATION**

**PLAN SHEET
TRAINING TRACK**

SCALE: SHEET 4 OF 6 SHEETS STA. TO STA.

F.A. RTE.	SECTION	COUNTY	TOTAL SHEETS	SHEET NO.
	ISP EVOC Track	SANGAMON	17	11
CONTRACT NO. 72J82			ILLINOIS FED. AID PROJECT	

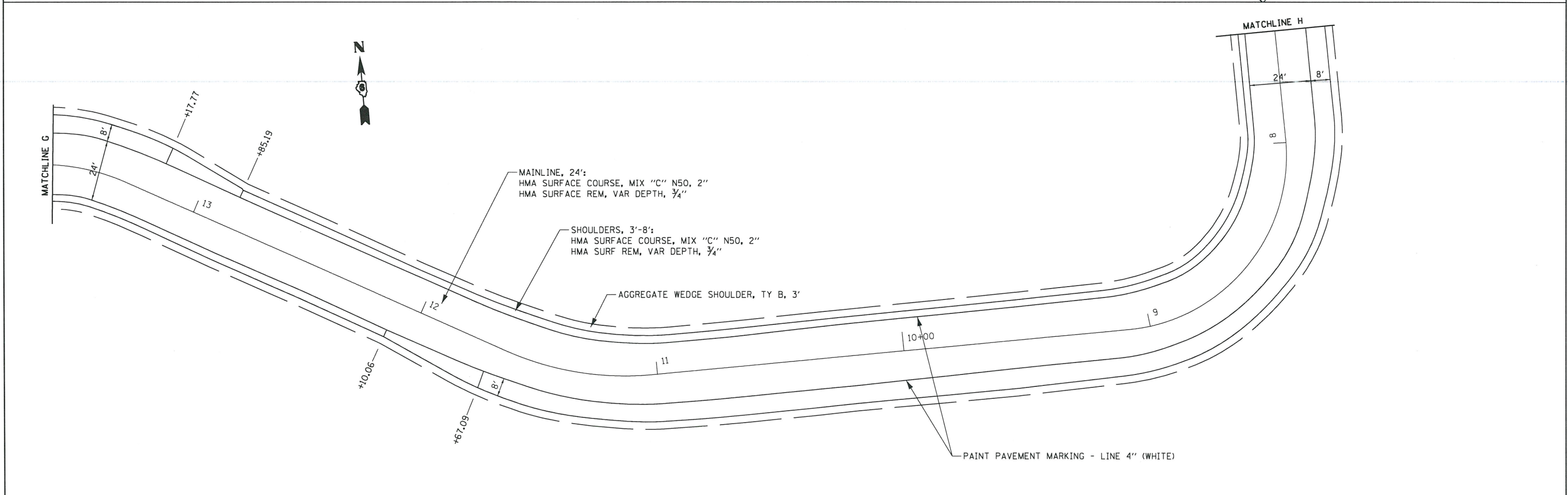
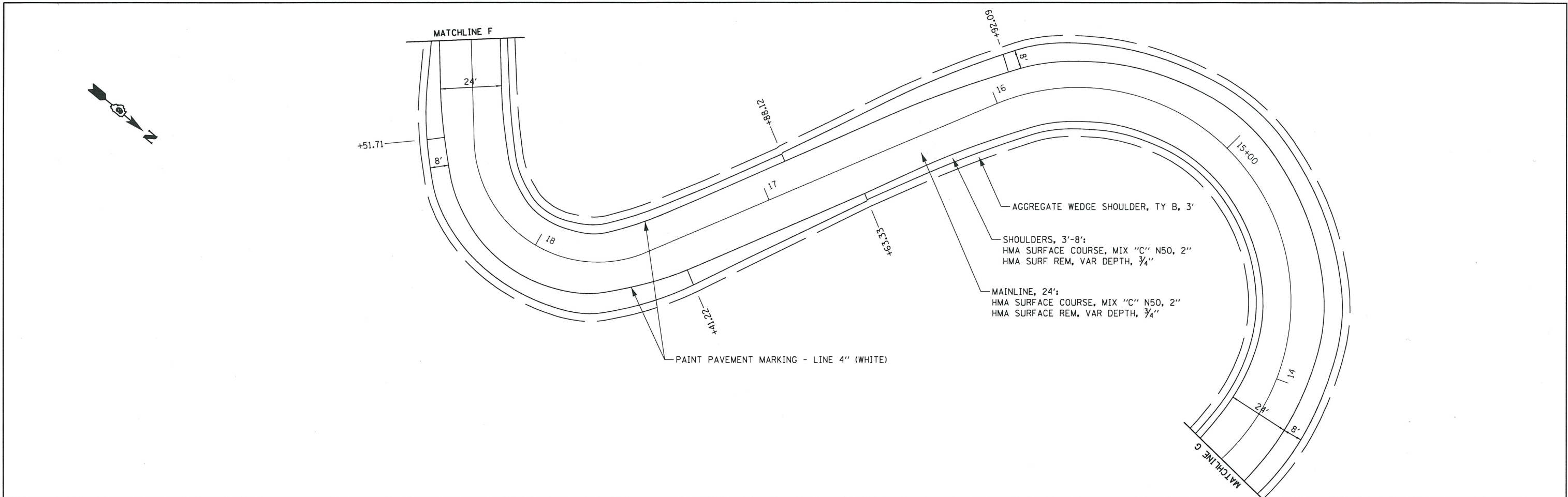

FILE NAME =	USER NAME = shahdm	DESIGNED - DMS 2/2017	REVISED -	STATE OF ILLINOIS DEPARTMENT OF TRANSPORTATION	PLAN SHEET TRAINING TRACK		F.A. RTE.	SECTION	COUNTY	TOTAL SHEETS	SHEET NO.
pw\11084EBIDINTEG.illinois.gov\PWIDOT\Documents\DOT Offices\District 6\Projects\0672\Drawings\EA\Drawings\0672J82-sht-plan.dwg		CHECKED -	REVISED -		SCALE:	SHEET 5 OF 6 SHEETS	STA.	ISP EVOC Track	SANGAMON	17	12
Default		DATE -	REVISED -		TO STA.			CONTRACT NO. 72J82			
								ILLINOIS FED. AID PROJECT			

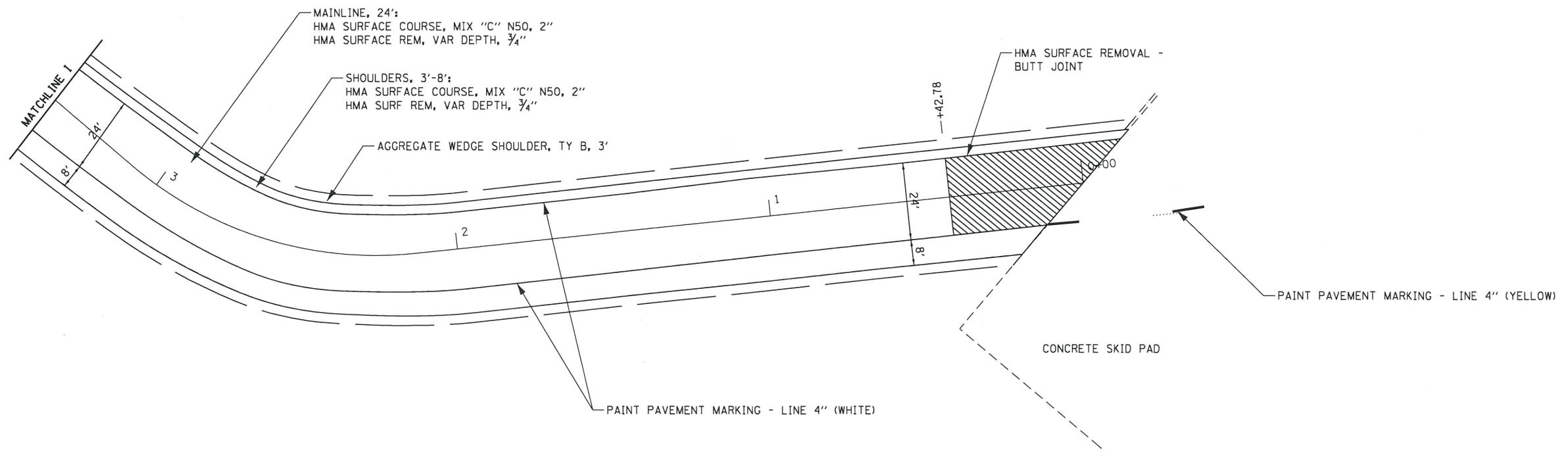
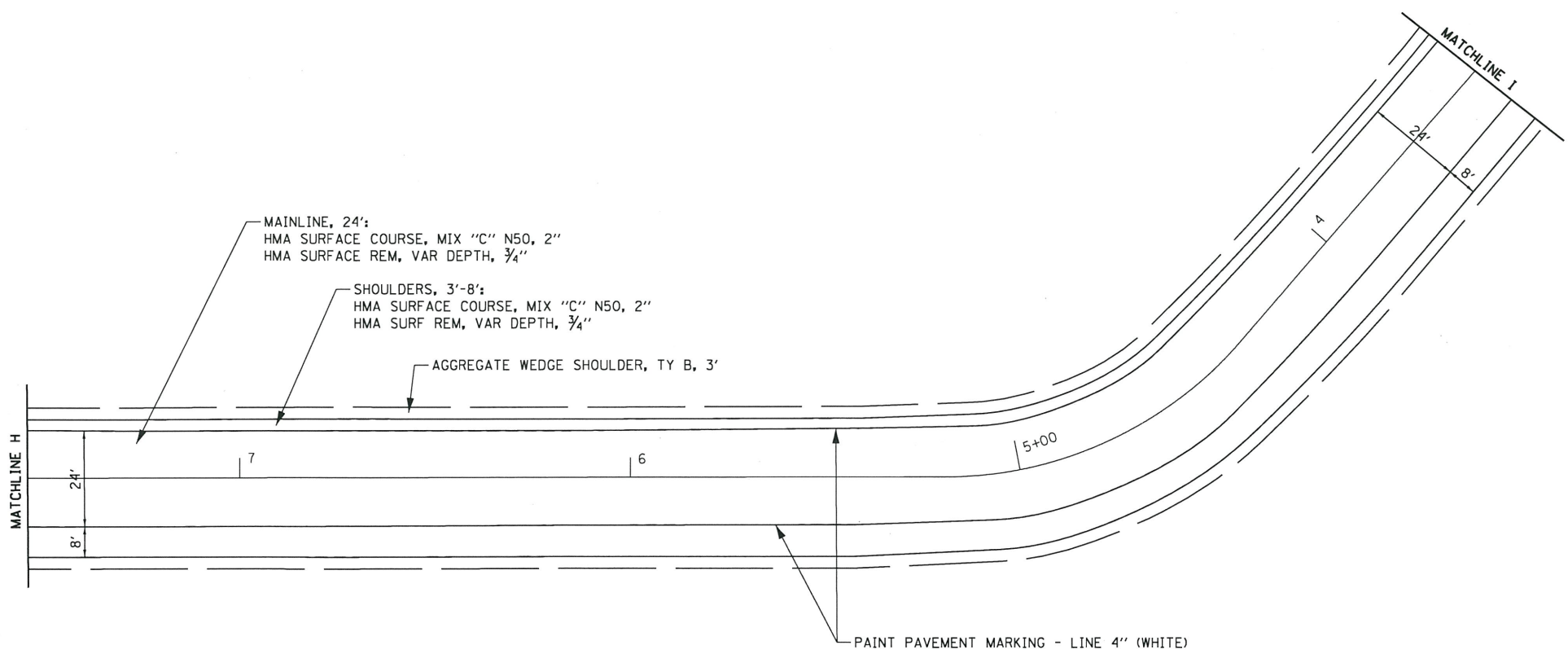

FILE NAME =	USER NAME = shahdm	DESIGNED - DMS 2/2017	REVISED -
pw\11084EBID\INTEG\illinois.gov\PWIDOT\Documents\IDOT Offices\District 6\Projects\0672\Drawings\AD\Sheets\0672J82-sht-plan.dwg			REVISED -
Default	PLOT SCALE = 40.0000' / in.	CHECKED -	REVISED -
	PLOT DATE = 2/17/2017	DATE -	REVISED -

**STATE OF ILLINOIS
DEPARTMENT OF TRANSPORTATION**

PLAN SHEET TRAINING TRACK		
SCALE:	SHEET 6 OF 6 SHEETS	STA. TO STA.

F.A. RTE.	SECTION	COUNTY	TOTAL SHEETS	SHEET NO.
	ISP EVOC Track	SANGAMON	17	13
CONTRACT NO. 72J82			ILLINOIS FED. AID PROJECT	

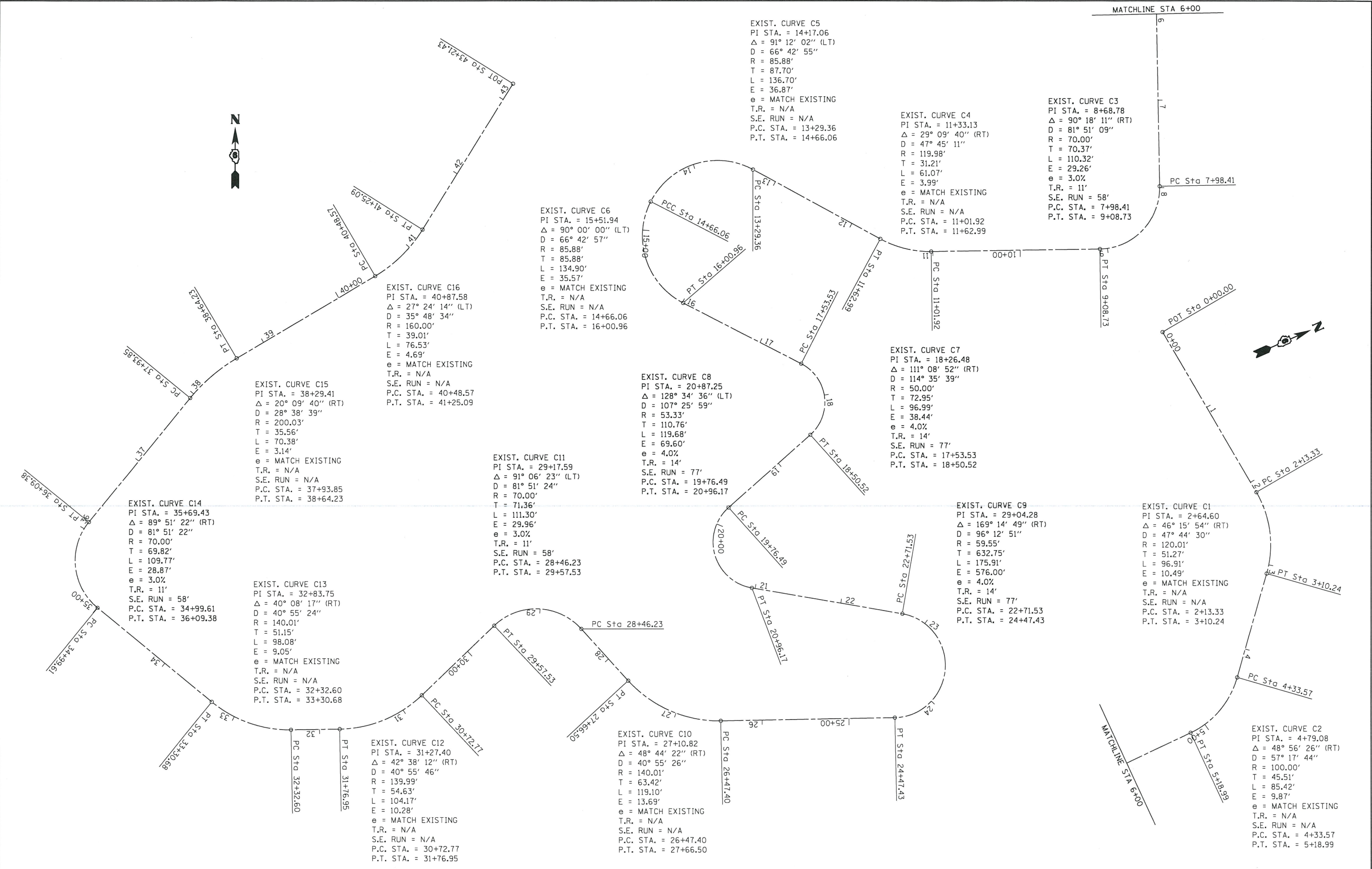

FILE NAME =	USER NAME = shahdm	DESIGNED - DMS 02/17	REVISED -	STATE OF ILLINOIS DEPARTMENT OF TRANSPORTATION	CURVE DATA TRAINING TRACK			F.A. RTE.	SECTION	COUNTY	TOTAL SHEETS	SHEET NO.
pw\11084EBID\INTEG\illinois.gov\PIW001\Documents\DOT Offices\District 6\Projects\0672\Drawings\EA\shahdm\022117-18-19-20-21-22-23-24-25-26-27-28-29-30-31-32-33-34-35-36-37-38-39-40-41-42-43-44-45-46-47-48-49-50-51-52-53-54-55-56-57-58-59-60-61-62-63-64-65-66-67-68-69-70-71-72-73-74-75-76-77-78-79-80-81-82-83-84-85-86-87-88-89-90-91-92-93-94-95-96-97-98-99-100-101-102-103-104-105-106-107-108-109-110-111-112-113-114-115-116-117-118-119-120-121-122-123-124-125-126-127-128-129-130-131-132-133-134-135-136-137-138-139-140-141-142-143-144-145-146-147-148-149-150-151-152-153-154-155-156-157-158-159-160-161-162-163-164-165-166-167-168-169-170-171-172-173-174-175-176-177-178-179-180-181-182-183-184-185-186-187-188-189-190-191-192-193-194-195-196-197-198-199-200-201-202-203-204-205-206-207-208-209-210-211-212-213-214-215-216-217-218-219-220-221-222-223-224-225-226-227-228-229-230-231-232-233-234-235-236-237-238-239-240-241-242-243-244-245-246-247-248-249-250-251-252-253-254-255-256-257-258-259-260-261-262-263-264-265-266-267-268-269-270-271-272-273-274-275-276-277-278-279-280-281-282-283-284-285-286-287-288-289-290-291-292-293-294-295-296-297-298-299-300-301-302-303-304-305-306-307-308-309-310-311-312-313-314-315-316-317-318-319-320-321-322-323-324-325-326-327-328-329-330-331-332-333-334-335-336-337-338-339-340-341-342-343-344-345-346-347-348-349-350-351-352-353-354-355-356-357-358-359-360-361-362-363-364-365-366-367-368-369-370-371-372-373-374-375-376-377-378-379-380-381-382-383-384-385-386-387-388-389-390-391-392-393-394-395-396-397-398-399-400-401-402-403-404-405-406-407-408-409-410-411-412-413-414-415-416-417-418-419-420-421-422-423-424-425-426-427-428-429-430-431-432-433-434-435-436-437-438-439-440-441-442-443-444-445-446-447-448-449-450-451-452-453-454-455-456-457-458-459-460-461-462-463-464-465-466-467-468-469-470-471-472-473-474-475-476-477-478-479-480-481-482-483-484-485-486-487-488-489-490-491-492-493-494-495-496-497-498-499-500-501-502-503-504-505-506-507-508-509-510-511-512-513-514-515-516-517-518-519-520-521-522-523-524-525-526-527-528-529-530-531-532-533-534-535-536-537-538-539-540-541-542-543-544-545-546-547-548-549-550-551-552-553-554-555-556-557-558-559-560-561-562-563-564-565-566-567-568-569-570-571-572-573-574-575-576-577-578-579-580-581-582-583-584-585-586-587-588-589-590-591-592-593-594-595-596-597-598-599-600-601-602-603-604-605-606-607-608-609-610-611-612-613-614-615-616-617-618-619-620-621-622-623-624-625-626-627-628-629-630-631-632-633-634-635-636-637-638-639-640-641-642-643-644-645-646-647-648-649-650-651-652-653-654-655-656-657-658-659-660-661-662-663-664-665-666-667-668-669-670-671-672-673-674-675-676-677-678-679-680-681-682-683-684-685-686-687-688-689-690-691-692-693-694-695-696-697-698-699-700-701-702-703-704-705-706-707-708-709-710-711-712-713-714-715-716-717-718-719-720-721-722-723-724-725-726-727-728-729-730-731-732-733-734-735-736-737-738-739-740-741-742-743-744-745-746-747-748-749-750-751-752-753-754-755-756-757-758-759-760-761-762-763-764-765-766-767-768-769-770-771-772-773-774-775-776-777-778-779-780-781-782-783-784-785-786-787-788-789-790-791-792-793-794-795-796-797-798-799-800-801-802-803-804-805-806-807-808-809-810-811-812-813-814-815-816-817-818-819-820-821-822-823-824-825-826-827-828-829-830-831-832-833-834-835-836-837-838-839-840-841-842-843-844-845-846-847-848-849-850-851-852-853-854-855-856-857-858-859-860-861-862-863-864-865-866-867-868-869-870-871-872-873-874-875-876-877-878-879-880-881-882-883-884-885-886-887-888-889-890-891-892-893-894-895-896-897-898-899-900-901-902-903-904-905-906-907-908-909-910-911-912-913-914-915-916-917-918-919-920-921-922-923-924-925-926-927-928-929-930-931-932-933-934-935-936-937-938-939-940-941-942-943-944-945-946-947-948-949-950-951-952-953-954-955-956-957-958-959-960-961-962-963-964-965-966-967-968-969-970-971-972-973-974-975-976-977-978-979-980-981-982-983-984-985-986-987-988-989-990-991-992-993-994-995-996-997-998-999-1000-1001-1002-1003-1004-1005-1006-1007-1008-1009-1010-1011-1012-1013-1014-1015-1016-1017-1018-1019-1020-1021-1022-1023-1024-1025-1026-1027-1028-1029-1030-1031-1032-1033-1034-1035-1036-1037-1038-1039-1040-1041-1042-1043-1044-1045-1046-1047-1048-1049-1050-1051-1052-1053-1054-1055-1056-1057-1058-1059-1060-1061-1062-1063-1064-1065-1066-1067-1068-1069-1070-1071-1072-1073-1074-1075-1076-1077-1078-1079-1080-1081-1082-1083-1084-1085-1086-1087-1088-1089-1090-1091-1092-1093-1094-1095-1096-1097-1098-1099-1100-1101-1102-1103-1104-1105-1106-1107-1108-1109-1110-1111-1112-1113-1114-1115-1116-1117-1118-1119-1120-1121-1122-1123-1124-1125-1126-1127-1128-1129-1130-1131-1132-1133-1134-1135-1136-1137-1138-1139-1140-1141-1142-1143-1144-1145-1146-1147-1148-1149-1150-1151-1152-1153-1154-1155-1156-1157-1158-1159-1160-1161-1162-1163-1164-1165-1166-1167-1168-1169-1170-1171-1172-1173-1174-1175-1176-1177-1178-1179-1180-1181-1182-1183-1184-1185-1186-1187-1188-1189-1190-1191-1192-1193-1194-1195-1196-1197-1198-1199-1200-1201-1202-1203-1204-1205-1206-1207-1208-1209-1210-1211-1212-1213-1214-1215-1216-1217-1218-1219-1220-1221-1222-1223-1224-1225-1226-1227-1228-1229-1230-1231-1232-1233-1234-1235-1236-1237-1238-1239-1240-1241-1242-1243-1244-1245-1246-1247-1248-1249-1250-1251-1252-1253-1254-1255-1256-1257-1258-1259-1260-1261-1262-1263-1264-1265-1266-1267-1268-1269-1270-1271-1272-1273-1274-1275-1276-1277-1278-1279-1280-1281-1282-1283-1284-1285-1286-1287-1288-1289-1290-1291-1292-1293-1294-1295-1296-1297-1298-1299-1300-1301-1302-1303-1304-1305-1306-1307-1308-1309-1310-1311-1312-1313-1314-1315-1316-1317-1318-1319-1320-1321-1322-1323-1324-1325-1326-1327-1328-1329-1330-1331-1332-1333-1334-1335-1336-1337-1338-1339-1340-1341-1342-1343-1344-1345-1346-1347-1348-1349-1350-1351-1352-1353-1354-1355-1356-1357-1358-1359-1360-1361-1362-1363-1364-1365-1366-1367-1368-1369-1370-1371-1372-1373-1374-1375-1376-1377-1378-1379-1380-1381-1382-1383-1384-1385-1386-1387-1388-1389-1390-1391-1392-1393-1394-1395-1396-1397-1398-1399-1400-1401-1402-1403-1404-1405-1406-1407-1408-1409-1410-1411-1412-1413-1414-1415-1416-1417-1418-1419-1420-1421-1422-1423-1424-1425-1426-1427-1428-1429-1430-1431-1432-1433-1434-1435-1436-1437-1438-1439-1440-1441-1442-1443-1444-1445-1446-1447-1448-1449-1450-1451-1452-1453-1454-1455-1456-1457-1458-1459-1460-1461-1462-1463-1464-1465-1466-1467-1468-1469-1470-1471-1472-1473-1474-1475-1476-1477-1478-1479-1480-1481-1482-1483-1484-1485-1486-1487-1488-1489-1490-1491-1492-1493-1494-1495-1496-1497-1498-1499-1500-1501-1502-1503-1504-1505-1506-1507-1508-1509-1510-1511-1512-1513-1514-1515-1516-1517-1518-1519-1520-1521-1522-1523-1524-1525-1526-1527-1528-1529-1530-1531-1532-1533-1534-1535-1536-1537-1538-1539-1540-1541-1542-1543-1544-1545-1546-1547-1548-1549-1550-1551-1552-1553-1554-1555-1556-1557-1558-1559-1560-1561-1562-1563-1564-1565-1566-1567-1568-1569-1570-1571-1572-1573-1574-1575-1576-1577-1578-1579-1580-1581-1582-1583-1584-1585-1586-1587-1588-1589-1590-1591-1592-1593-1594-1595-1596-1597-1598-1599-1600-1601-1602-1603-1604-1605-1606-1607-1608-1609-1610-1611-1612-1613-1614-1615-1616-1617-1618-1619-1620-1621-1622-1623-1624-1625-1626-1627-1628-1629-1630-1631-1632-1633-1634-1635-1636-1637-1638-1639-1640-1641-1642-1643-1644-1645-1646-1647-1648-1649-1650-1651-1652-1653-1654-1655-1656-1657-1658-1659-1660-1661-1662-1663-1664-1665-1666-1667-1668-1669-1670-1671-1672-1673-1674-1675-1676-1677-1678-1679-1680-1681-1682-1683-1684-1685-1686-1687-1688-1689-1690-1691-1692-1693-1694-1695-1696-1697-1698-1699-1700-1701-1702-1703-1704-1705-1706-1707-1708-1709-1710-1711-1712-1713-1714-1715-1716-1717-1718-1719-1720-1721-1722-1723-1724-1725-1726-1727-1728-1729-1730-1731-1732-1733-1734-1735-1736-1737-1738-1739-1740-1741-1742-1743-1744-1745-1746-1747-1748-1749-1750-1751-1752-1753-1754-1755-1756-1757-1758-1759-1760-1761-1762-1763-1764-1765-1766-1767-1768-1769-1770-1771-1772-1773-1774-1775-1776-1777-1778-1779-1780-1781-1782-1783-1784-1785-1786-1787-1788-1789-1790-1791-1792-1793-1794-1795-1796-1797-1798-1799-1800-1801-1802-1803-1804-1805-1806-1807-1808-1809-1810-1811-1812-1813-1814-1815-1816-1817-1818-1819-1820-1821-1822-1823-1824-1825-1826-1827-1828-1829-1830-1831-1832-1833-1834-1835-1836-1837-1838-1839-1840-1841-1842-1843-1844-1845-1846-1847-1848-1849-1850-1851-1852-1853-1854-1855-1856-1857-1858-1859-1860-1861-1862-1863-1864-1865-1866-1867-1868-1869-1870-1871-1872-1873-1874-1875-1876-1877-1878-1879-1880-1881-1882-1883-1884-1885-1886-1887-1888-1889-1890-1891-1892-1893-1894-1895-1896-1897-1898-1899-1900-1901-1902-1903-1904-1905-1906-1907-1908-1909-1910-1911-1912-1913-1914-1915-1916-1917-1918-1919-1920-1921-1922-1923-1924-1925-1926-1927-1928-1929-1930-1931-1932-1933-1934-1935-1936-1937-1938-1939-1940-1941-1942-1943-1944-1945-1946-1947-1948-1949-1950-1951-1952-1953-1954-1955-1956-1957-1958-1959-1960-1961-1962-1963-1964-1965-1966-1967-1968-1969-1970-1971-1972-1973-1974-1975-1976-1977-1978-1979-1980-1981-1982-1983-1984-1985-1												

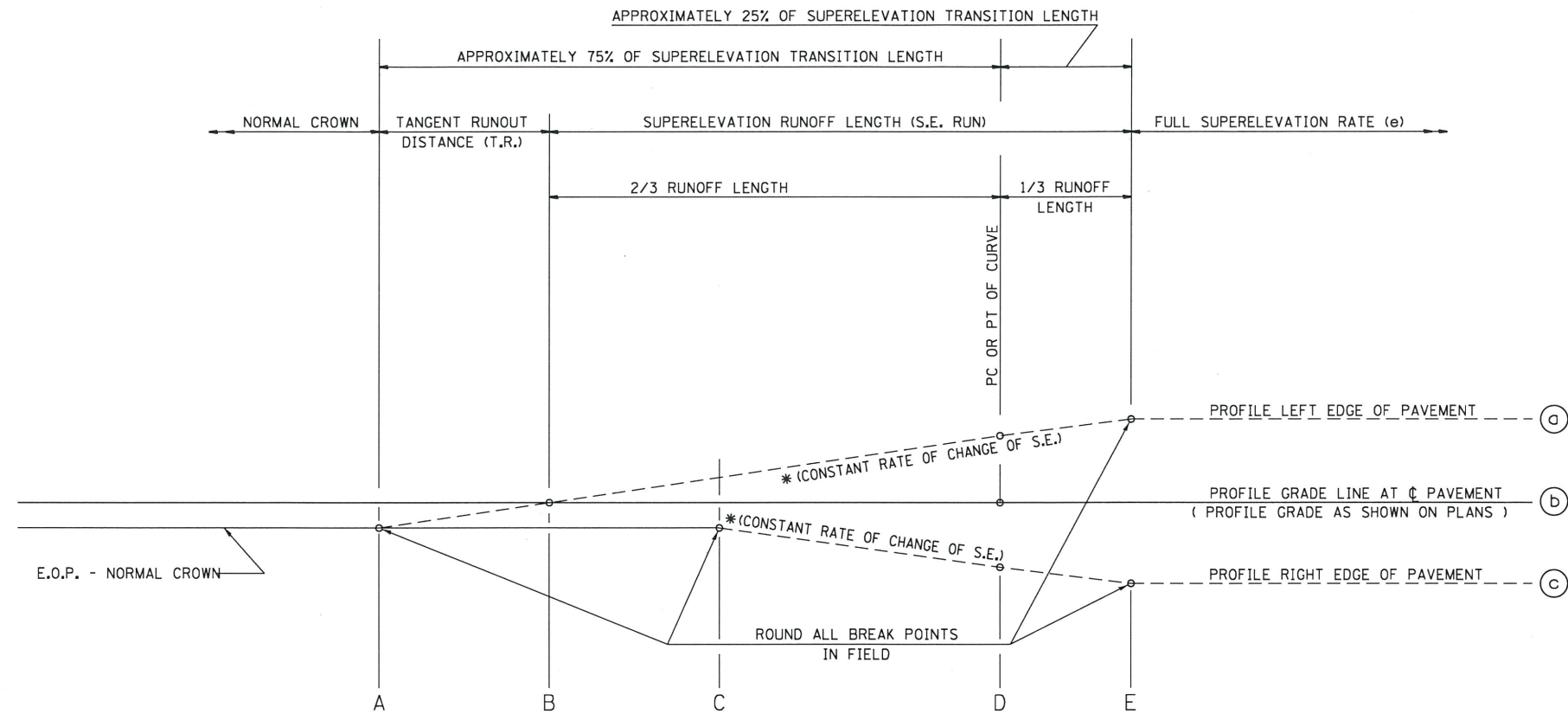

TYPICAL PROFILE - S.E. TRANSITION

SEE PLANS FOR CURVE DATA INFORMATION
 CURVE DATA
 P.I. STA=
 Δ =
 R=
 T=
 L=
 E=
 e= SUPERELEVATION RATE IN PERCENT
 T.R.= TANGENT RUNOUT DISTANCE
 S.E. RUN= SUPERELEVATION RUNOFF LENGTH
 P.C. STA=
 P.T. STA=

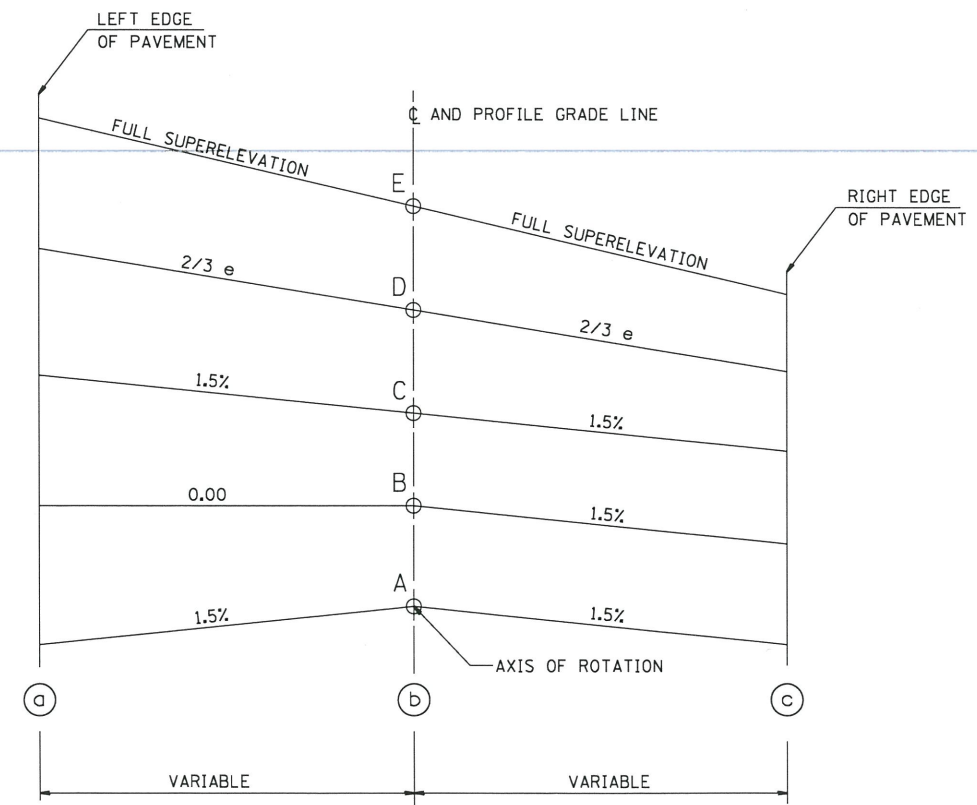

TYPICAL CROSS SECTION - S.E. TRANSITION

FILE NAME =	USER NAME = shahdn	DESIGNED - DMS 02/17	REVISED -
pw:\IL\084EBID\INTEG\illinois.gov\WIDOT\Documents\DOT Offices\District 6\Projects\0672\DRAWN\Date\CAD\shahdn\022117-2-sht-super		DMS 022117-2-sht-super	REVISED -
Default	PLOT SCALE = 100.0000' / in.	CHECKED -	REVISED -
	PLOT DATE = 2/17/2017	DATE -	REVISED -

STATE OF ILLINOIS
 DEPARTMENT OF TRANSPORTATION

SUPERELEVATION TRANSITION
 DETAIL FOR TWO LANE HIGHWAY
 SCALE: SHEET 1 OF 2 SHEETS STA. TO STA.

F.A. RTE.	SECTION	COUNTY	TOTAL SHEETS	SHEET NO.
	ISP EVOC Track	SANGAMON	17	16
CONTRACT NO. 72J82			ILLINOIS FED. AID PROJECT	

TRAINING TRACK S.E.	
Curve No.:	C3
PC:	Sta. 7+98.41
PT:	Sta. 9+08.73
Radius:	70
Design Speed:	35
Lane Width:	12
Curve:	Right
Max e%:	6.0%
e(normal):	1.50%
e(max):	3.00%
RS Value:	58
L1:	21.00
TR:	11.00

TRAINING TRACK S.E.	
Curve No.:	C7
PC:	Sta. 17+53.53
PT:	Sta. 18+50.52
Radius:	50
Design Speed:	35
Lane Width:	12
Curve:	Right
Max e%:	6.0%
e(normal):	1.50%
e(max):	4.00%
RS Value:	77
L1:	37.00
TR:	14.00

TRAINING TRACK S.E.	
Curve No.:	C8
PC:	Sta. 19+76.49
PT:	Sta. 20+96.17
Radius:	53.33
Design Speed:	35
Lane Width:	12
Curve:	Left
Max e%:	6.0%
e(normal):	1.50%
e(max):	4.00%
RS Value:	77
L1:	37.00
TR:	14.00

Plan Entrance Superelevation			
Point	Sta.	LT(e)	RT(e)
A	Sta. 7+73.41	-1.50%	-1.50%
B	Sta. 7+84.41	0.00%	-1.50%
C	Sta. 7+95.41	1.50%	-1.50%
D	Sta. 7+98.41	2.00%	-2.00%
E	Sta. 8+05.41	3.00%	-3.00%

Plan Entrance Superelevation			
Point	Sta.	LT(e)	RT(e)
A	Sta. 17+14.86	-1.50%	-1.50%
B	Sta. 17+28.86	0.00%	-1.50%
C	Sta. 17+42.86	1.50%	-1.50%
D	Sta. 17+53.53	2.67%	-2.67%
E	Sta. 17+65.86	4.00%	-4.00%

Plan Entrance Superelevation			
Point	Sta.	LT(e)	RT(e)
A	Sta. 19+37.82	-1.50%	-1.50%
B	Sta. 19+51.82	0.00%	-1.50%
C	Sta. 19+65.82	1.50%	-1.50%
D	Sta. 19+76.49	2.67%	-2.67%
E	Sta. 19+88.82	4.00%	-4.00%

Plan Exit Superelevation			
Point	Sta.	LT(e)	RT(e)
E	Sta. 9+01.73	3.00%	-3.00%
D	Sta. 9+08.73	2.00%	-2.00%
C	Sta. 9+11.73	1.50%	-1.50%
B	Sta. 9+22.73	0.00%	-1.50%
A	Sta. 9+33.73	-1.50%	-1.50%

Plan Exit Superelevation			
Point	Sta.	LT(e)	RT(e)
E	Sta. 18+38.19	4.00%	-4.00%
D	Sta. 18+50.52	2.67%	-2.67%
C	Sta. 18+61.19	1.50%	-1.50%
B	Sta. 18+75.19	0.00%	-1.50%
A	Sta. 18+89.19	-1.50%	-1.50%

Plan Exit Superelevation			
Point	Sta.	LT(e)	RT(e)
E	Sta. 20+83.84	4.00%	-4.00%
D	Sta. 20+96.17	2.67%	-2.67%
C	Sta. 21+06.84	1.50%	-1.50%
B	Sta. 21+20.84	0.00%	-1.50%
A	Sta. 21+34.84	-1.50%	-1.50%

TRAINING TRACK S.E.	
Curve No.:	C9
PC:	Sta. 22+71.53
PT:	Sta. 24+47.43
Radius:	59.55
Design Speed:	35
Lane Width:	12
Curve:	Right
Max e%:	6.0%
e(normal):	1.50%
e(max):	4.00%
RS Value:	77
L1:	37.00
TR:	14.00

TRAINING TRACK S.E.	
Curve No.:	C11
PC:	Sta. 28+46.23
PT:	Sta. 29+57.53
Radius:	70
Design Speed:	35
Lane Width:	12
Curve:	Left
Max e%:	6.0%
e(normal):	1.50%
e(max):	3.00%
RS Value:	58
L1:	21.00
TR:	11.00

TRAINING TRACK S.E.	
Curve No.:	C14
PC:	Sta. 34+99.61
PT:	Sta. 36+09.38
Radius:	70
Design Speed:	35
Lane Width:	12
Curve:	Right
Max e%:	6.0%
e(normal):	1.50%
e(max):	3.00%
RS Value:	58
L1:	21.00
TR:	11.00

Plan Entrance Superelevation			
Point	Sta.	LT(e)	RT(e)
A	Sta. 22+32.86	-1.50%	-1.50%
B	Sta. 22+46.86	0.00%	-1.50%
C	Sta. 22+60.86	1.50%	-1.50%
D	Sta. 22+71.53	2.67%	-2.67%
E	Sta. 22+83.86	4.00%	-4.00%

Plan Entrance Superelevation			
Point	Sta.	LT(e)	RT(e)
A	Sta. 28+21.23	-1.50%	-1.50%
B	Sta. 28+32.23	0.00%	-1.50%
C	Sta. 28+43.23	1.50%	-1.50%
D	Sta. 28+46.23	2.00%	-2.00%
E	Sta. 28+53.23	3.00%	-3.00%

Plan Entrance Superelevation			
Point	Sta.	LT(e)	RT(e)
A	Sta. 34+74.61	-1.50%	-1.50%
B	Sta. 34+85.61	0.00%	-1.50%
C	Sta. 34+96.61	1.50%	-1.50%
D	Sta. 34+99.61	2.00%	-2.00%
E	Sta. 35+06.61	3.00%	-3.00%

Plan Exit Superelevation			
Point	Sta.	LT(e)	RT(e)
E	Sta. 24+35.1	4.00%	-4.00%
D	Sta. 24+47.43	2.67%	-2.67%
C	Sta. 24+58.1	1.50%	-1.50%
B	Sta. 24+72.1	0.00%	-1.50%
A	Sta. 24+86.1	-1.50%	-1.50%

Plan Exit Superelevation			
Point	Sta.	LT(e)	RT(e)
E	Sta. 29+50.53	3.00%	-3.00%
D	Sta. 29+57.53	2.00%	-2.00%
C	Sta. 29+60.53	1.50%	-1.50%
B	Sta. 29+71.53	0.00%	-1.50%
A	Sta. 29+82.53	-1.50%	-1.50%

Plan Exit Superelevation			
Point	Sta.	LT(e)	RT(e)
E	Sta. 36+02.38	3.00%	-3.00%
D	Sta. 36+09.38	2.00%	-2.00%
C	Sta. 36+12.38	1.50%	-1.50%
B	Sta. 36+23.38	0.00%	-1.50%
A	Sta. 36+34.38	-1.50%	-1.50%

FILE NAME =	USER NAME = shahdm	DESIGNED - DMS 02/17	REVISED -
p:\11\084EBID\INTEG\Illinois.gov\PIWIDOT\Documents\IDOT Offices\District 6\Projects\0672\DRAWING\DATA\VEADshahdm\021717-2ht-super		CHECKED -	REVISED -
Default	PLOT SCALE = 100.0000' / in.	DATE -	REVISED -
	PLOT DATE = 2/17/2017		

**STATE OF ILLINOIS
DEPARTMENT OF TRANSPORTATION**

**SUPERELEVATION TRANSITION
DETAIL FOR TWO LANE HIGHWAY**

SCALE: SHEET 2 OF 2 SHEETS STA. TO STA.

F.A. RTE.	SECTION	COUNTY	TOTAL SHEETS	SHEET NO.
	ISP EVOC Track	SANGAMON	17	17
CONTRACT NO. 72J82			ILLINOIS FED. AID PROJECT	