

STATE OF ILLINOIS
DEPARTMENT OF TRANSPORTATION

F.A. RTE.	SECTION	COUNTY	TOTAL SHEETS	SHEET NO.
VAR	DIST 8 BRIDGE DECK 2017-2	CLINTON	28	1
		ILLINOIS	CONTRACT NO. 76K27	

FOR INDEX OF SHEETS, SEE SHEET NO. 2

PROPOSED HIGHWAY PLANS

VARIOUS ROUTE SECTION DIST 8 BRIDGE DECK 2017-2 BRIDGE DECK SEALING CLINTON COUNTY

C-98-034-17

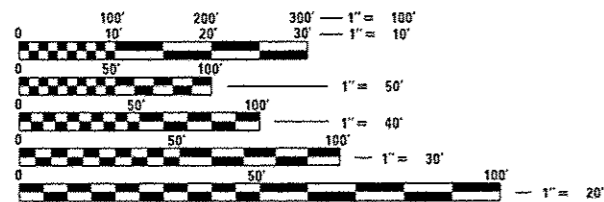
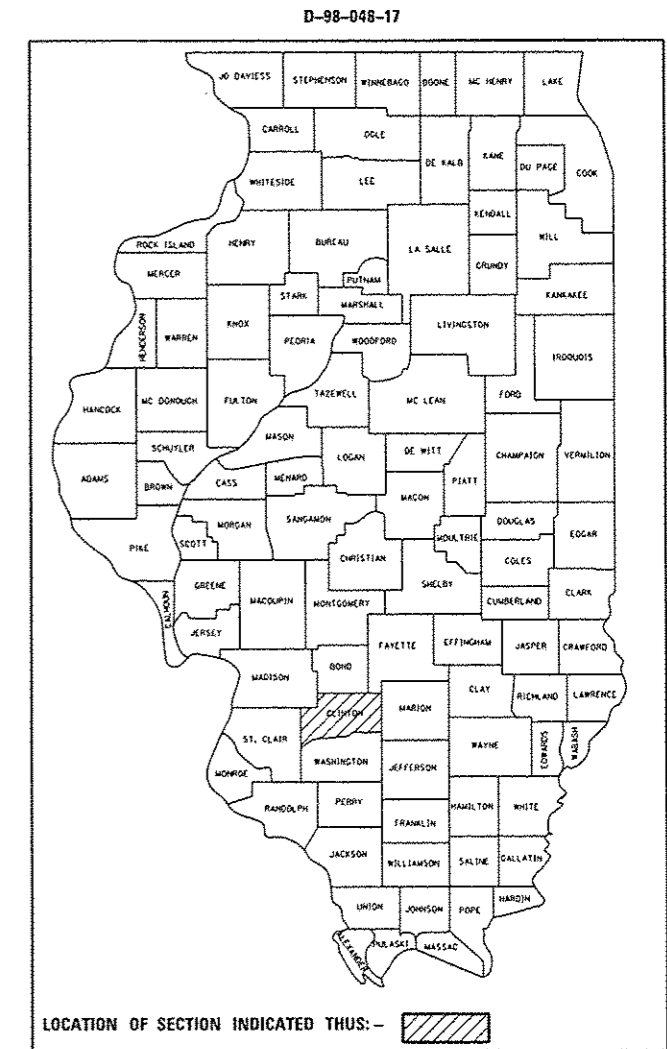

FULL SIZE PLANS HAVE BEEN PREPARED USING STANDARD ENGINEERING SCALES. REDUCED SIZED PLANS WILL NOT CONFORM TO STANDARD SCALES. IN MAKING MEASUREMENTS ON REDUCED PLANS, THE ABOVE SCALES MAY BE USED.

J.U.L.I.E.
JOINT UTILITY LOCATION INFORMATION FOR EXCAVATION
1-800-892-0123
OR 811

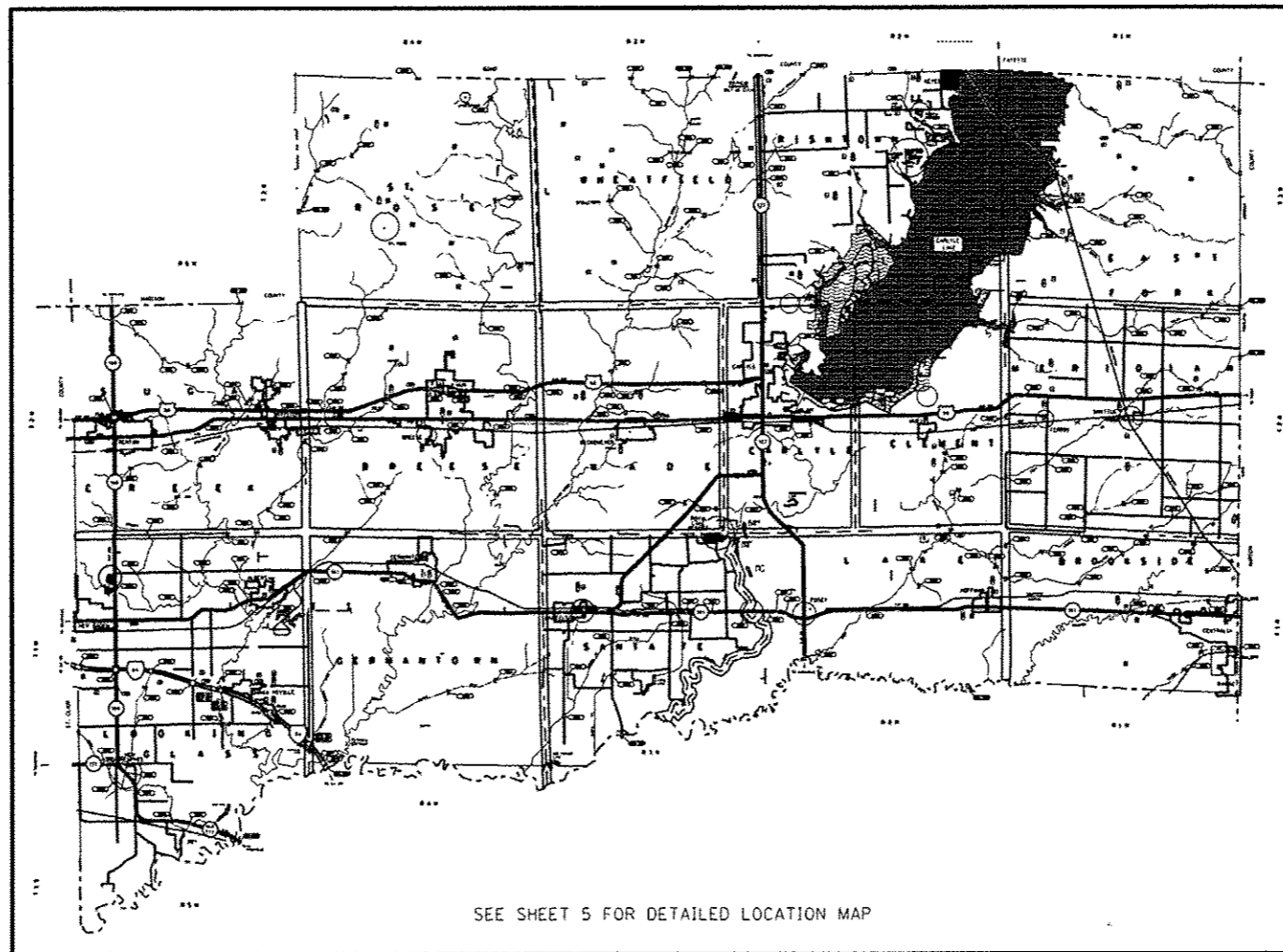

SEE SHEET 5 FOR DETAILED LOCATION MAP

NOT TO SCALE

GROSS LENGTH = 9048.11 FT. = 1.714 MILE
NET LENGTH = 9048.11 FT. = 1.714 MILE

PROJECT ENGINEER: HERVE GELIN (618) 346-3179
PROJECT MANAGER: BILLIE OWEN (618) 346-3209

CONTRACT NO. 76K27

STATE OF ILLINOIS
DEPARTMENT OF TRANSPORTATION

SUBMITTED Jan 25 20 17
Jeffrey Z. Ke...
REGIONAL ENGINEER

Mar 24 20 17
Mawren M. Addis
ENGINEER OF DESIGN AND ENVIRONMENT

Mar 24 20 17
...
DIRECTOR OF PROGRAM DEVELOPMENT

PRINTED BY THE AUTHORITY
OF THE STATE OF ILLINOIS

STRUCTURE NO.	LOCATION	CONCRETE SEALER (SOFT)
SN 014-0009	IL 161 OVER WILKEN LAKE, 1/2 MILE E OF GERMANTOWN	17158.41
SN 014-0010	IL 161 OVER SHOAL CREEK OVERFLOW, 0.6 MILE E IF GERMANTOWN	19110.21
SN 014-0015	IL 127 OVER SOUTHERN RR IN POSEY	7504.58
SN 014-0024	IL 161 OVER LOST CREEK, 1.7 MILES E OF IL 127	14017.28
SN 014-0049	US 50 OVER SUGAR CREEK, 3 MILES E OF TRENTON	26985.15
SN 014-0050	SCHUMACHER RD OVER US 50, 5 MILES E OF TRENTON	7599.63
SN 014-0054	ST. ROSE RD OVER US 50, 7 MILES E OF TRENTON	10169.98
SN 014-0055	FROGTOWN RD OVER US 50, 6 MILES W OF CARLYLE	8478.11
SN 014-0056	FLAT BRANCH RD OVER US 50, 1.5 MILES W OF CARLYLE	6959.46
SN 014-0058	US 50 OVER SHOAL CREEK, 2.5 MILES E OF BREESE	53498.17
SN 014-0060	US 50 OVER BEAVER CREEK, 4 MILES W OF CARLYLE	19823.78
SN 014-0061	US 50 OVER KASKASKIA RIVER AT CARLYLE	11059.50
SN 014-0063	IL 127 OVER FLAT BRANCH CREEK, 6.1 MILES N OF CARLYLE	11096.92
SN 014-0064	IL 127 OVER FLAT BRANCH CREEK, 4 MILES N OF CARLYLE	7161.50
SN 014-0069	OLD US 50 OVER BEAVER CREEK, 1.2 MILES W OF BECKEMEYER	16538.62
SN 014-0070	IL 161 OVER SHOAL CREEK, 1.5 MILES E OF GERMANTOWN	10671.63
SN 014-0071	IL 161 OVER KASKASKIA RIVER, 4.5 MILES E OF BARTELSON	30613.93
SN 014-0072	IL 177 OVER QUEENS LAKE BRANCH, 0.2 MILE E NEW MEMPHIS	6760.78
SN 014-0073	IL 177/160 OVER QUEENS LAKE SLOUGH, 1 MILE E NEW MEMPHIS	21091.40
SN 014-0074	IL 177/160 OVER KASKASKIA OVERFLOW, 1.2 MILES E NEW MEMPHIS	13218.47
SN 014-0076	US 50 OVER LOST CREEK, 9.6 MILES E OF CARLYLE	7919.92
SN 014-0077	OLD US 50 OVER SUGAR CREEK, 1.1 MILES W OF AVISTON	16992.18
SN 014-0078	IL 161 OVER SUGAR CREEK, 4 MILES E OF NEW BADEN	17506.86
	TOTAL	361936

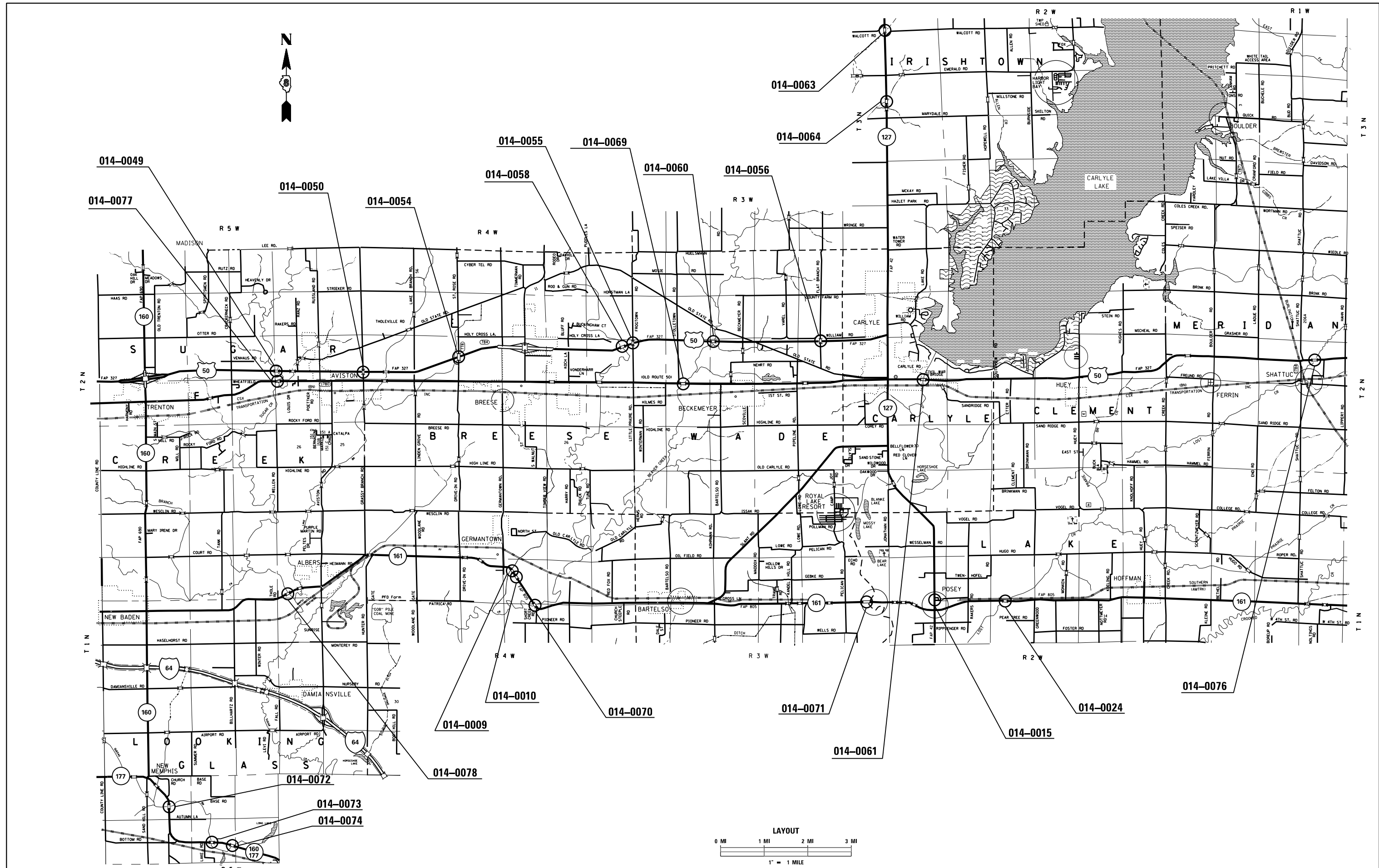

FILE NAME =
 USER NAME = ogbo1010
 DESIGNED -
 REVISIONS -
 PLOT SCALE = 100.0000' / 1" /
 CHECKED -
 REVISIONS -
 PLOT DATE = 1/19/2017
 DATE -
 REVISIONS -

**STATE OF ILLINOIS
 DEPARTMENT OF TRANSPORTATION**

LOCATION MAP

SCALE: SHEET OF SHEETS STA. TO STA.

F.A.P. RTE.	SECTION	COUNTY	TOTAL SHEETS	SHEET NO.
VAR. DIST 8 BRIDGE DECK 2017-2		CLINTON	28	5
CONTRACT NO. 76K27				
ILLINOIS FED. AID PROJECT				

GENERAL NOTES

A CONCRETE SEALER SHALL BE APPLIED TO THE SURFACE OF THE DECK, PARAPETS, AND APPROACH PAVEMENTS. SEE SPECIAL PROVISIONS FOR DECK CONCRETE SEALER.

EXISTING PAVEMENT MARKINGS SHALL BE TEMPORARILY COVERED PRIOR TO APPLICATION OF THE DECK SURFACE TREATMENT, TO PREVENT THE MATERIAL FROM BEING APPLIED OVER THE MARKINGS. THE TEMPORARY COVERING SHALL BE REMOVED AFTER THE APPLICATION OF THE DECK SURFACE TREATMENT AND PRIOR TO OPENING TO TRAFFIC. COST INCLUDED WITH CONCRETE SEALER.

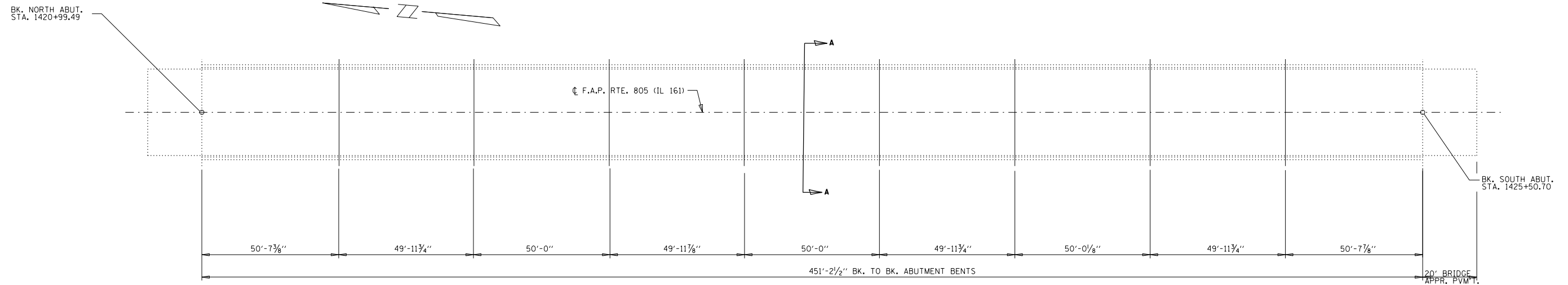

PARTIAL PLAN

TOTAL BILL OF MATERIALS

ITEM	UNIT	TOTAL
BRIDGE DECK CONCRETE SEALER	SO. FT.	19111

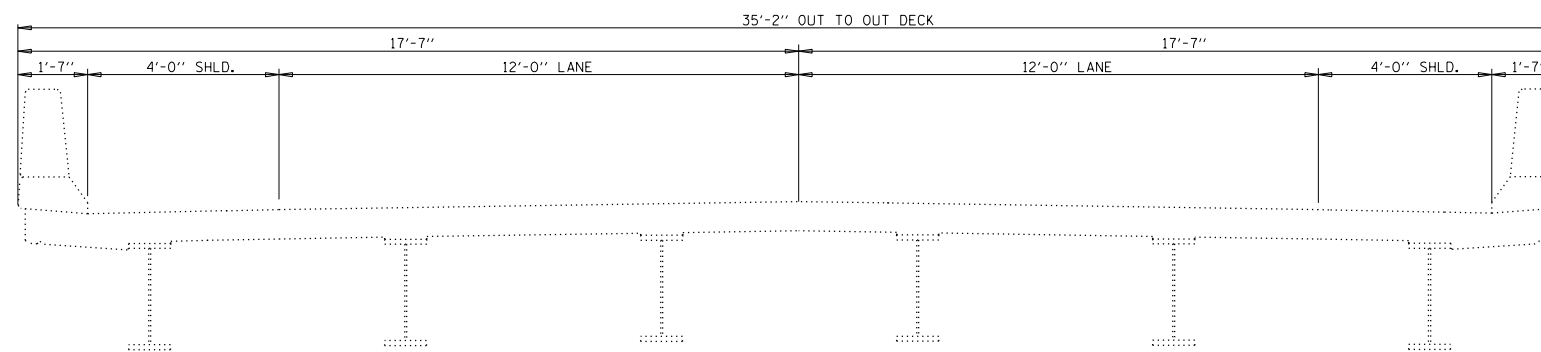

CROSS SECTION
(A-A)

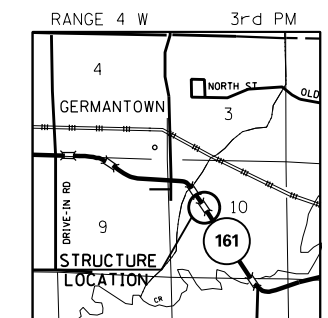

LOCATION SKETCH

FILE NAME =	USER NAME = ogboolato	DESIGNED -	REVISED -	STATE OF ILLINOIS DEPARTMENT OF TRANSPORTATION	PLAN AND SECTION VIEWS			F.A.P. RTE.	SECTION	COUNTY	TOTAL SHEETS	SHEET NO.	
pw:\IL\084EBIDINTEG.illinois.gov\PIWIDOT\Documents\IDOT Offices\District 8\Projects\0875\Drawings\EA\Sheets\0875K27-sht-typoc		CHECKED -	REVISED -		IL RTE 161 OVER SHOAL CREEK OVER OVERFLOW - SN 014-0010			VAR.	DIST 8 BRIDGE DECK 2017-2	CLINTON	28	7	
Default	PLOT SCALE = 100.0000' / in.	DATE -	REVISED -		SCALE:	SHEET	OF	SHEETS	STA.	TO	STA.	CONTRACT NO. 76K27	
	PLOT DATE = 1/19/2017											ILLINOIS FED. AID PROJECT	

GENERAL NOTES

A CONCRETE SEALER SHALL BE APPLIED TO THE SURFACE OF THE DECK, PARAPETS, AND APPROACH PAVEMENTS. SEE SPECIAL PROVISIONS FOR DECK CONCRETE SEALER.

EXISTING PAVEMENT MARKINGS SHALL BE TEMPORARILY COVERED PRIOR TO APPLICATION OF THE DECK SURFACE TREATMENT, TO PREVENT THE MATERIAL FROM BEING APPLIED OVER THE MARKINGS. THE TEMPORARY COVERING SHALL BE REMOVED AFTER THE APPLICATION OF THE DECK SURFACE TREATMENT AND PRIOR TO OPENING TO TRAFFIC. COST INCLUDED WITH CONCRETE SEALER.

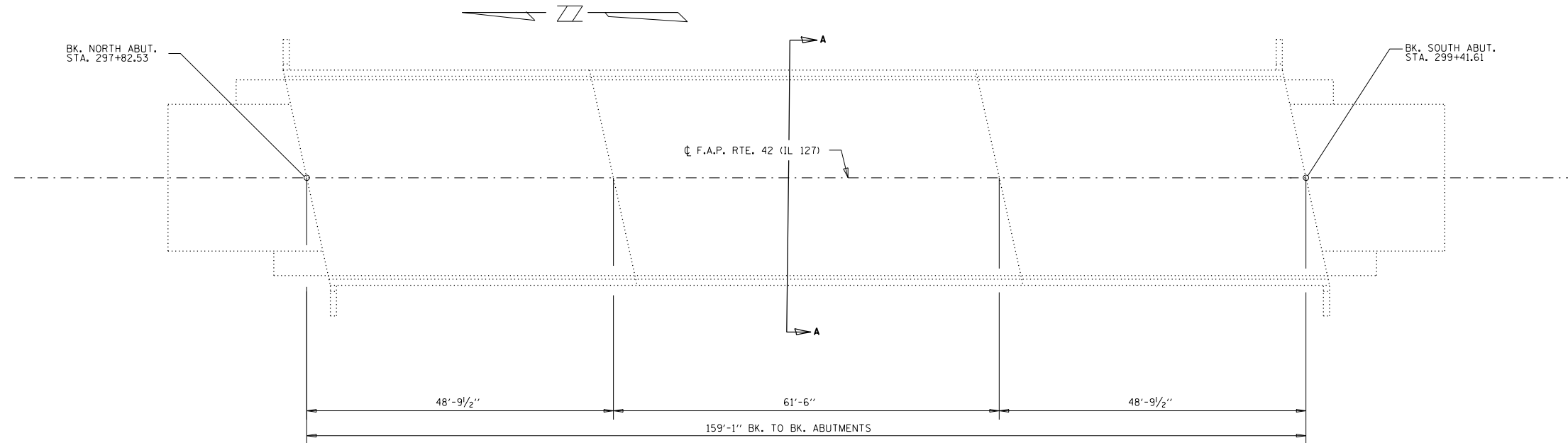

PARTIAL PLAN

TOTAL BILL OF MATERIALS

ITEM	UNIT	TOTAL
BRIDGE DECK CONCRETE SEALER	SO. FT.	7505

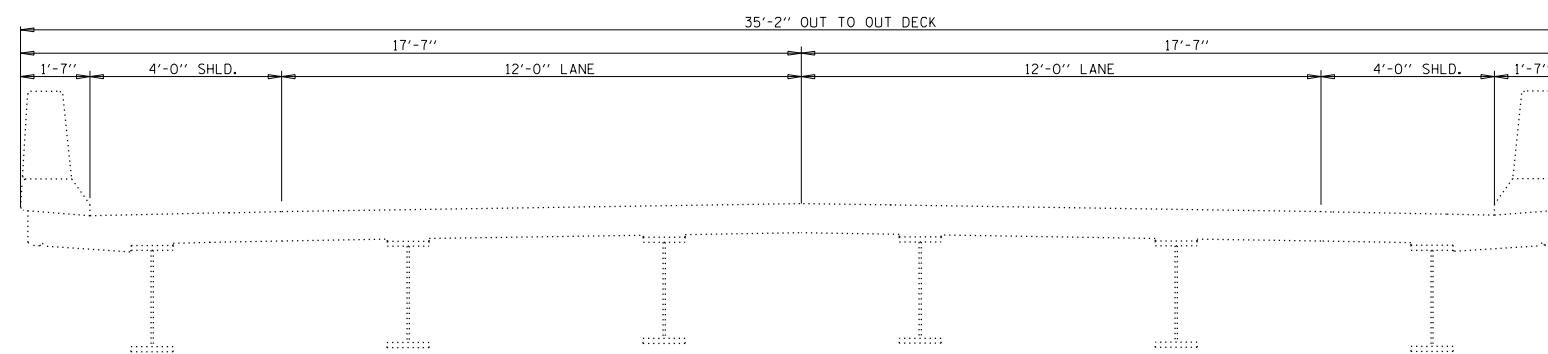

CROSS SECTION

(A-A)

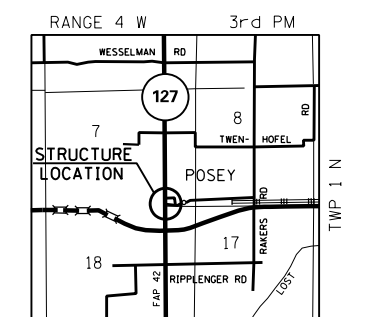

LOCATION SKETCH

FILE NAME =	USER NAME = ogboolato	DESIGNED -	REVISED -	STATE OF ILLINOIS DEPARTMENT OF TRANSPORTATION	PLAN AND SECTION VIEWS			F.A.P. RTE.	SECTION	COUNTY	TOTAL SHEETS	SHEET NO.	
Default		CHECKED -	REVISED -		IL RTE 127 OVER SOUTHERN RR - SN 014-0015			VAR.	DIST 8 BRIDGE DECK 2017-2	CLINTON	28	8	
		DATE -	REVISED -		SCALE:	SHEET	OF	SHEETS	STA.	TO	STA.	CONTRACT NO. 76K27	
												ILLINOIS FED. AID PROJECT	

GENERAL NOTES

A CONCRETE SEALER SHALL BE APPLIED TO THE SURFACE OF THE DECK, PARAPETS, AND APPROACH PAVEMENTS. SEE SPECIAL PROVISIONS FOR DECK CONCRETE SEALER.

EXISTING PAVEMENT MARKINGS SHALL BE TEMPORARILY COVERED PRIOR TO APPLICATION OF THE DECK SURFACE TREATMENT, TO PREVENT THE MATERIAL FROM BEING APPLIED OVER THE MARKINGS. THE TEMPORARY COVERING SHALL BE REMOVED AFTER THE APPLICATION OF THE DECK SURFACE TREATMENT AND PRIOR TO OPENING TO TRAFFIC. COST INCLUDED WITH CONCRETE SEALER.

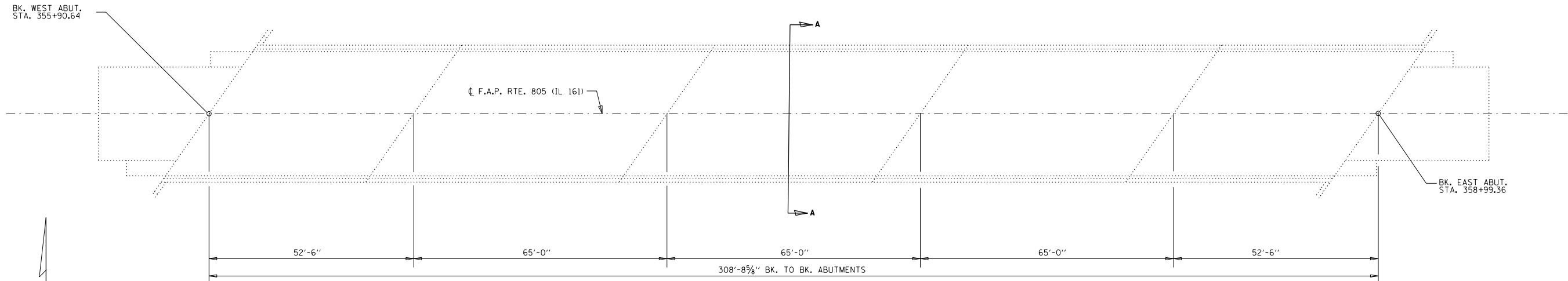

PARTIAL PLAN

TOTAL BILL OF MATERIALS

ITEM	UNIT	TOTAL
BRIDGE DECK CONCRETE SEALER	SO. FT.	14018

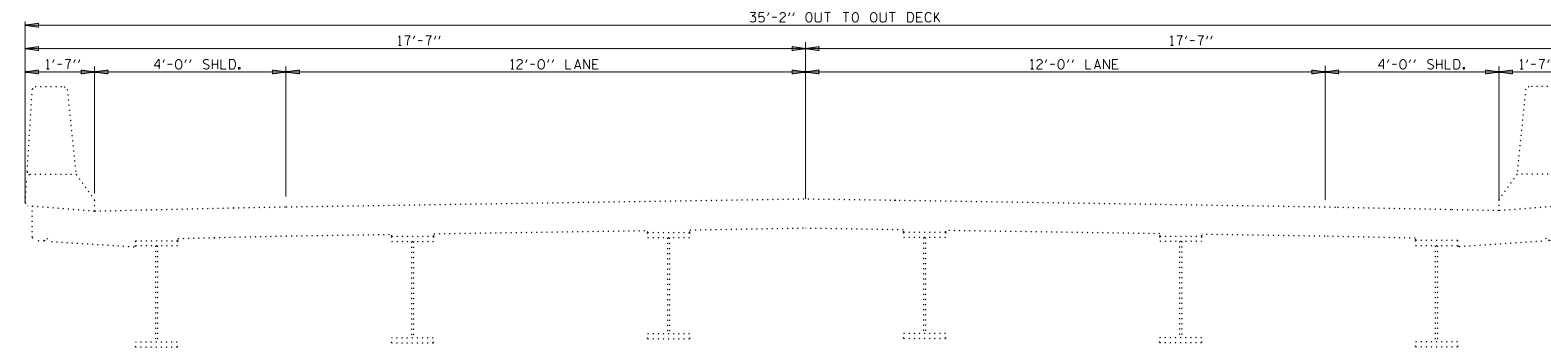

CROSS SECTION

(A-A)

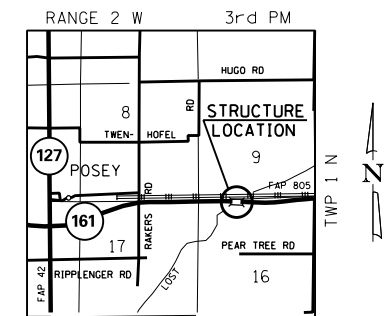

LOCATION SKETCH

FILE NAME =	USER NAME = ogboolato	DESIGNED -	REVISED -	STATE OF ILLINOIS DEPARTMENT OF TRANSPORTATION	PLAN AND SECTION VIEWS IL RTE 161 OVER LOST CREEK - SN 014-0024				F.A.P. RTE.	SECTION	COUNTY	TOTAL SHEETS	SHEET NO.
pw:\IL\084EBIDINTEG.illinois.gov\PWIDOT\Documents\IDOT Offices\District 8\Projects\0875\DRAWING\DATA\CADsheets\D876K27-sht-typro		CHECKED -	REVISED -		VAR.	DIST 8 BRIDGE DECK 2017-2	CLINTON	28	9				
Default	PLOT SCALE = 100.0000' / in.	DATE -	REVISED -		CONTRACT NO. 76K27				ILLINOIS FED. AID PROJECT				
	PLOT DATE = 1/19/2017				SCALE:	SHEET	OF	SHEETS	STA.	TO	STA.		

GENERAL NOTES

A CONCRETE SEALER SHALL BE APPLIED TO THE SURFACE OF THE DECK, PARAPETS, AND APPROACH PAVEMENTS. SEE SPECIAL PROVISIONS FOR DECK CONCRETE SEALER.

EXISTING PAVEMENT MARKINGS SHALL BE TEMPORARILY COVERED PRIOR TO APPLICATION OF THE DECK SURFACE TREATMENT, TO PREVENT THE MATERIAL FROM BEING APPLIED OVER THE MARKINGS. THE TEMPORARY COVERING SHALL BE REMOVED AFTER THE APPLICATION OF THE DECK SURFACE TREATMENT AND PRIOR TO OPENING TO TRAFFIC. COST INCLUDED WITH CONCRETE SEALER.

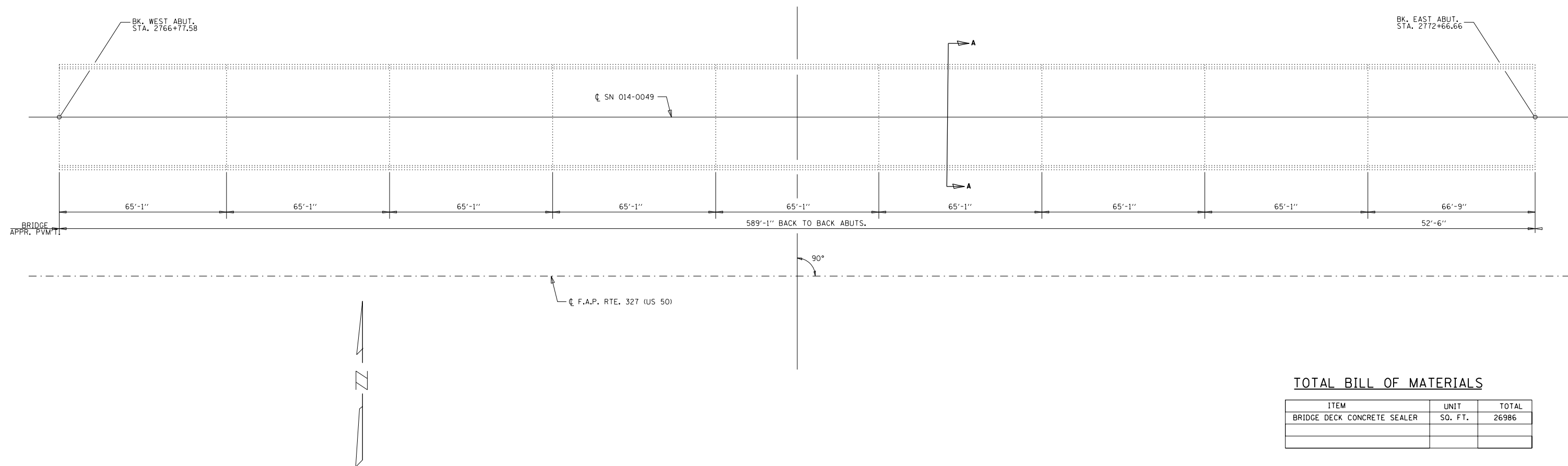

TOTAL BILL OF MATERIALS

ITEM	UNIT	TOTAL
BRIDGE DECK CONCRETE SEALER	SO. FT.	26986

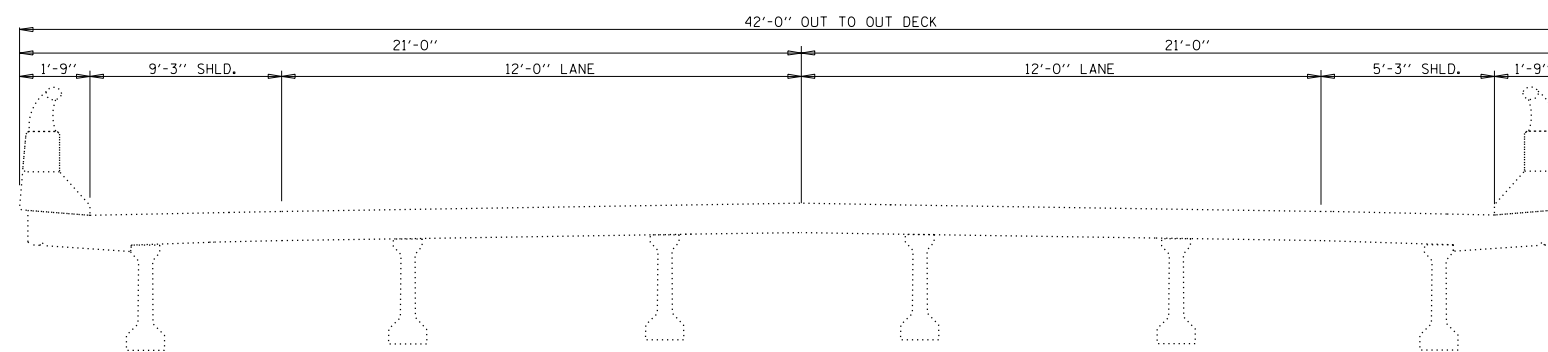

CROSS SECTION
(A-A)

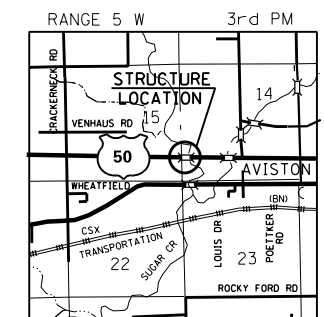

LOCATION SKETCH

FILE NAME =	USER NAME = ogboolato	DESIGNED -	REVISED -	STATE OF ILLINOIS DEPARTMENT OF TRANSPORTATION	PLAN AND SECTION VIEWS US RTE 50 OVER SUGAR CREEK - SN 014-0049				F.A.P. RTE.	SECTION	COUNTY	TOTAL SHEETS	SHEET NO.	
Default		CHECKED -	REVISED -		SCALE:	SHEET	OF	SHEETS	STA.	TO	STA.	CLINTON	28	10
	PLOT SCALE = 100.0000' / 1in.	DATE -	REVISED -						VAR.	DIST 8 BRIDGE DECK 2017-2	CONTRACT NO. 76K27			
	PLOT DATE = 1/19/2017								ILLINOIS FED. AID PROJECT					

GENERAL NOTES

A CONCRETE SEALER SHALL BE APPLIED TO THE SURFACE OF THE DECK, PARAPETS, AND APPROACH PAVEMENTS. SEE SPECIAL PROVISIONS FOR DECK CONCRETE SEALER.

EXISTING PAVEMENT MARKINGS SHALL BE TEMPORARILY COVERED PRIOR TO APPLICATION OF THE DECK SURFACE TREATMENT, TO PREVENT THE MATERIAL FROM BEING APPLIED OVER THE MARKINGS. THE TEMPORARY COVERING SHALL BE REMOVED AFTER THE APPLICATION OF THE DECK SURFACE TREATMENT AND PRIOR TO OPENING TO TRAFFIC. COST INCLUDED WITH CONCRETE SEALER.

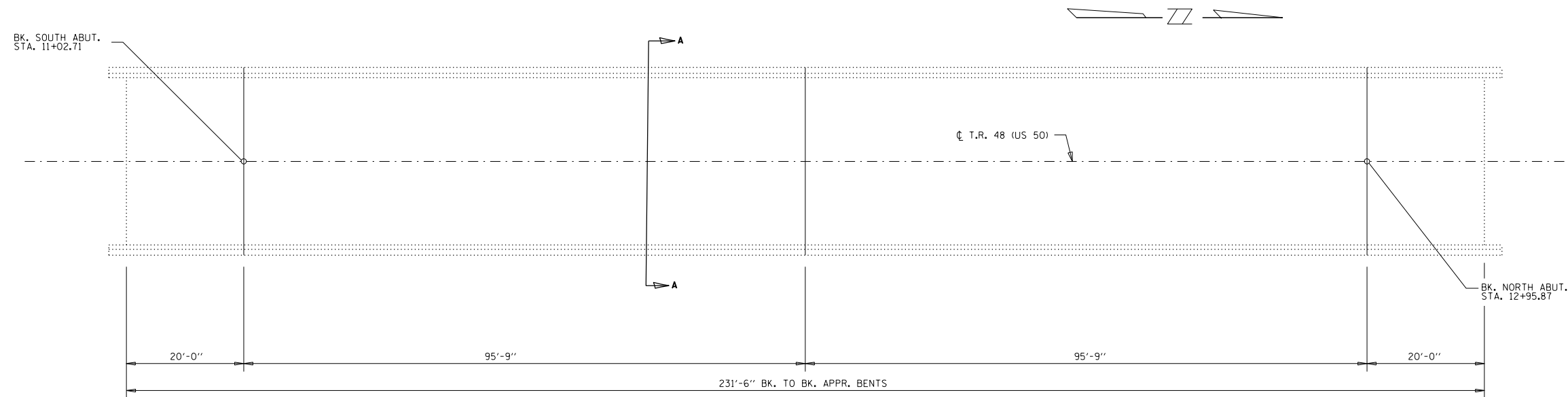

PARTIAL PLAN

TOTAL BILL OF MATERIALS

ITEM	UNIT	TOTAL
BRIDGE DECK CONCRETE SEALER	SO. FT.	7600

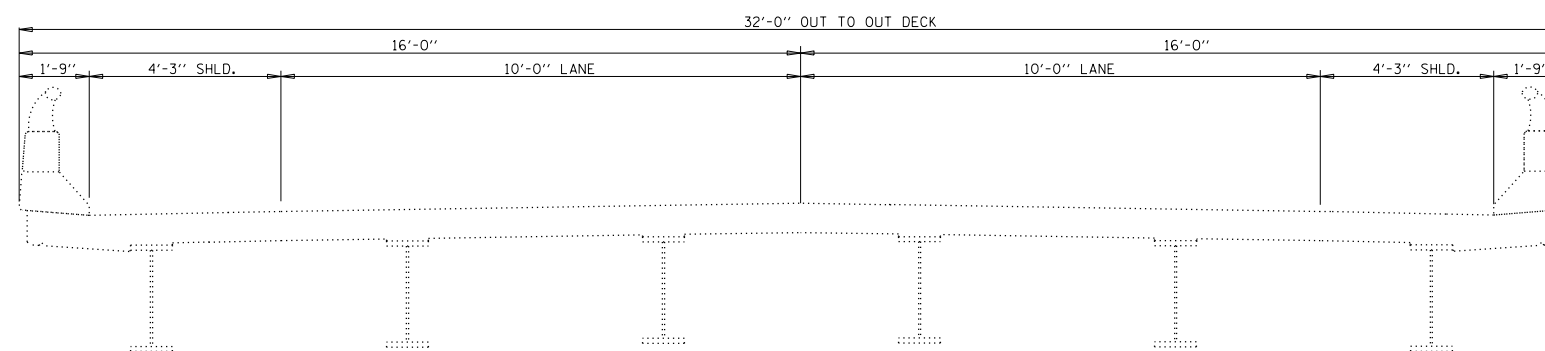

CROSS SECTION

(A-A)

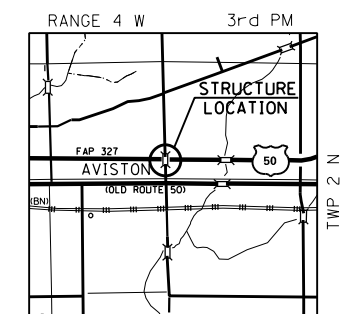

LOCATION SKETCH

FILE NAME =	USER NAME = ogboolato	DESIGNED -	REVISED -	STATE OF ILLINOIS DEPARTMENT OF TRANSPORTATION	PLAN AND SECTION VIEWS				F.A.P. RTE.	SECTION	COUNTY	TOTAL SHEETS	SHEET NO.
pw:\11\084EBIDINTEG.illinois.gov\PIWIDOT\Documents\IDOT Offices\District 8\Projects\D875K\Drawings\EA\Sheets\D875K27-sht-typro1.dwg		CHECKED -	REVISED -		SCHUMACHER RD (TR 48) OVER US 50 - SN 014-0050				VAR.	DIST 8 BRIDGE DECK 2017-2	CLINTON	28	11
Default	PLOT SCALE = 100.0000' / 1in.				SCALE: SHEET OF SHEETS STA. TO STA.				CONTRACT NO. 76K27				
	PLOT DATE = 1/19/2017	DATE -	REVISED -		ILLINOIS FED. AID PROJECT								

GENERAL NOTES

A CONCRETE SEALER SHALL BE APPLIED TO THE SURFACE OF THE DECK, PARAPETS, AND APPROACH PAVEMENTS. SEE SPECIAL PROVISIONS FOR DECK CONCRETE SEALER.

EXISTING PAVEMENT MARKINGS SHALL BE TEMPORARILY COVERED PRIOR TO APPLICATION OF THE DECK SURFACE TREATMENT. TO PREVENT THE MATERIAL FROM BEING APPLIED OVER THE MARKINGS. THE TEMPORARY COVERING SHALL BE REMOVED AFTER THE APPLICATION OF THE DECK SURFACE TREATMENT AND PRIOR TO OPENING TO TRAFFIC. COST INCLUDED WITH CONCRETE SEALER.

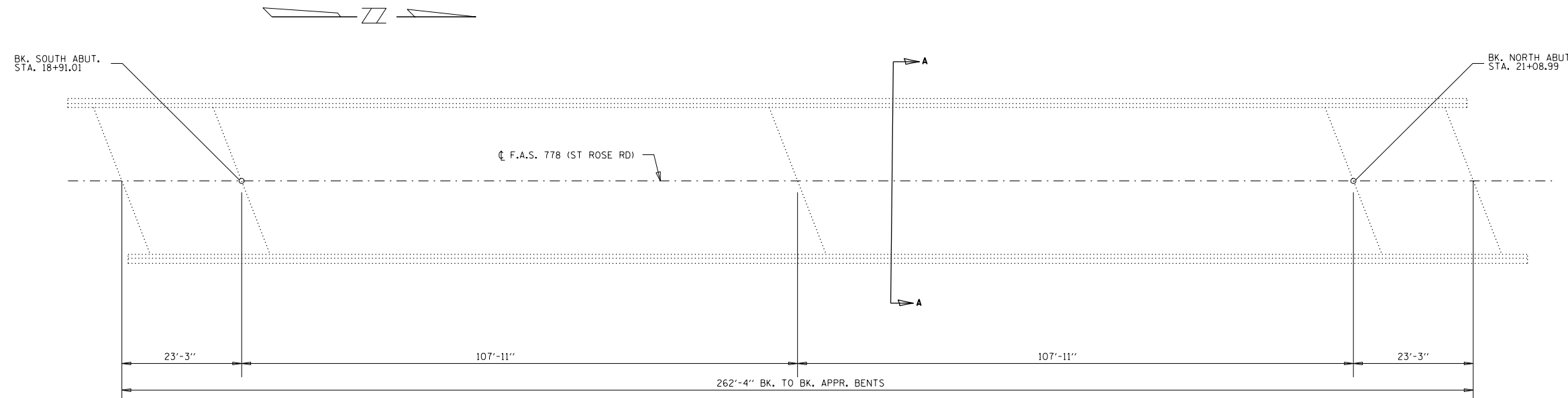

PARTIAL PLAN

TOTAL BILL OF MATERIALS

ITEM	UNIT	TOTAL
BRIDGE DECK CONCRETE SEALER	SO. FT.	10170

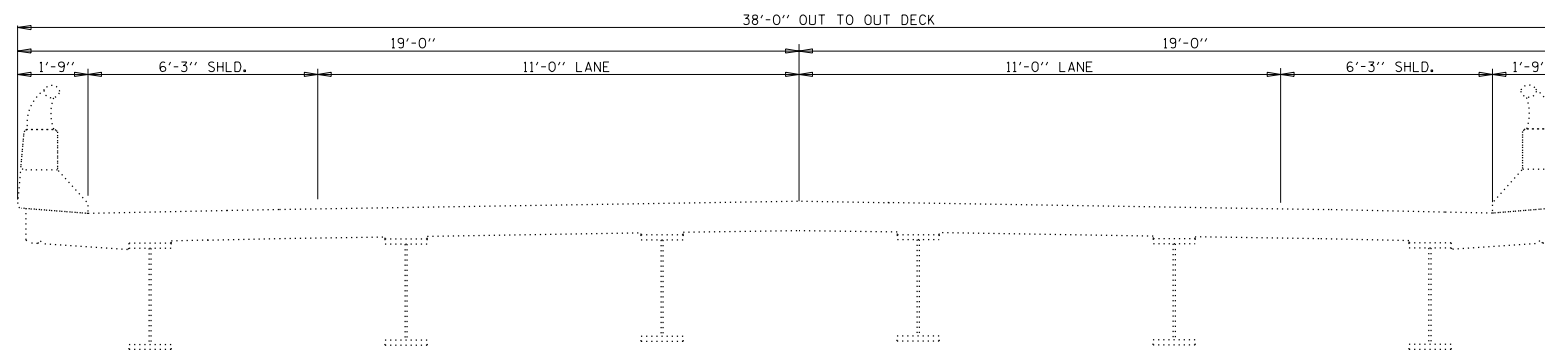

CROSS SECTION

(A-A)

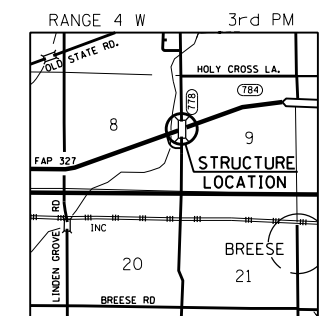

LOCATION SKETCH

GENERAL NOTES

A CONCRETE SEALER SHALL BE APPLIED TO THE SURFACE OF THE DECK, PARAPETS, AND APPROACH PAVEMENTS. SEE SPECIAL PROVISIONS FOR DECK CONCRETE SEALER.

EXISTING PAVEMENT MARKINGS SHALL BE TEMPORARILY COVERED PRIOR TO APPLICATION OF THE DECK SURFACE TREATMENT, TO PREVENT THE MATERIAL FROM BEING APPLIED OVER THE MARKINGS. THE TEMPORARY COVERING SHALL BE REMOVED AFTER THE APPLICATION OF THE DECK SURFACE TREATMENT AND PRIOR TO OPENING TO TRAFFIC. COST INCLUDED WITH CONCRETE SEALER.

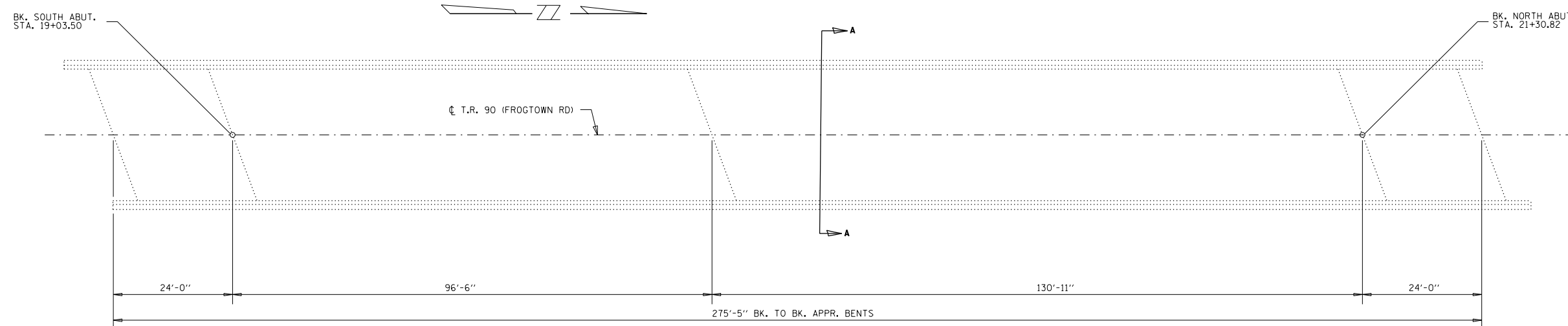

PARTIAL PLAN

TOTAL BILL OF MATERIALS

ITEM	UNIT	TOTAL
BRIDGE DECK CONCRETE SEALER	SO. FT.	8479

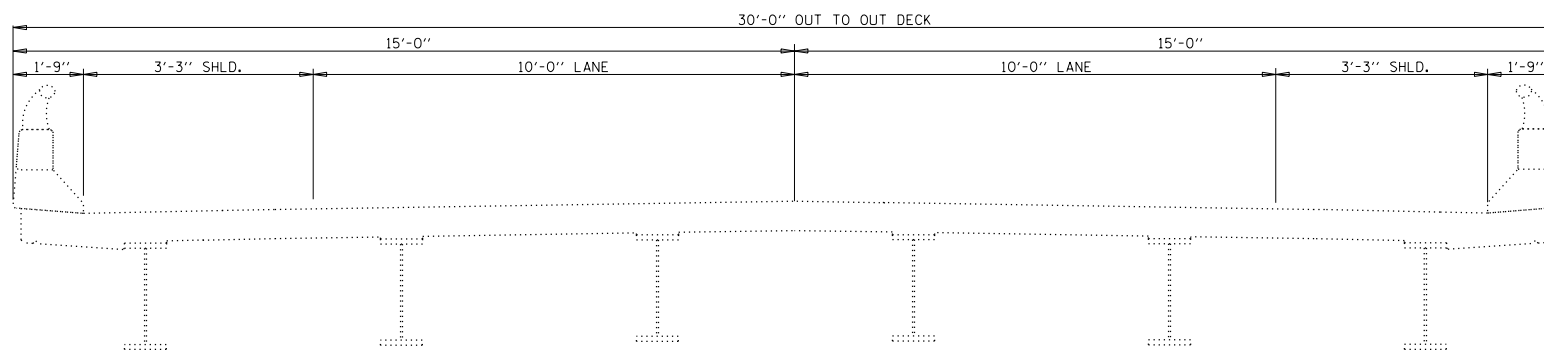

CROSS SECTION

(A-A)

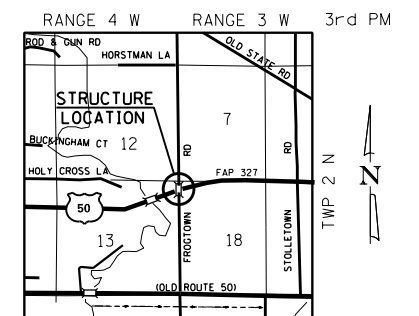

LOCATION SKETCH

FILE NAME =	USER NAME = ogboolato	DESIGNED -	REVISED -	STATE OF ILLINOIS DEPARTMENT OF TRANSPORTATION	PLAN AND SECTION VIEWS			F.A.P. RTE.	SECTION	COUNTY	TOTAL SHEETS	SHEET NO.	
pw:\11\084EBIDINTEG.illinois.gov\PI\DOT\Documents\DOT Offices\District 8\Projects\0875\Drawings\EA\Sheets\D876K27-sht-typro		DRAWN	REVISED -		FROGTOWN RD (TR 90) OVER US 50 - SN 014-0055			VAR.	DIST 8 BRIDGE DECK 2017-2	CLINTON	28	13	
Default	PLOT SCALE = 100.0000' / in.	CHECKED -	REVISED -		SCALE:	SHEET	OF	SHEETS	STA.	TO	STA.	CONTRACT NO. 76K27	
	PLOT DATE = 1/19/2017	DATE -	REVISED -		ILLINOIS FED. AID PROJECT								

GENERAL NOTES

A CONCRETE SEALER SHALL BE APPLIED TO THE SURFACE OF THE DECK, PARAPETS, AND APPROACH PAVEMENTS. SEE SPECIAL PROVISIONS FOR DECK CONCRETE SEALER.

EXISTING PAVEMENT MARKINGS SHALL BE TEMPORARILY COVERED PRIOR TO APPLICATION OF THE DECK SURFACE TREATMENT. TO PREVENT THE MATERIAL FROM BEING APPLIED OVER THE MARKINGS. THE TEMPORARY COVERING SHALL BE REMOVED AFTER THE APPLICATION OF THE DECK SURFACE TREATMENT AND PRIOR TO OPENING TO TRAFFIC. COST INCLUDED WITH CONCRETE SEALER.

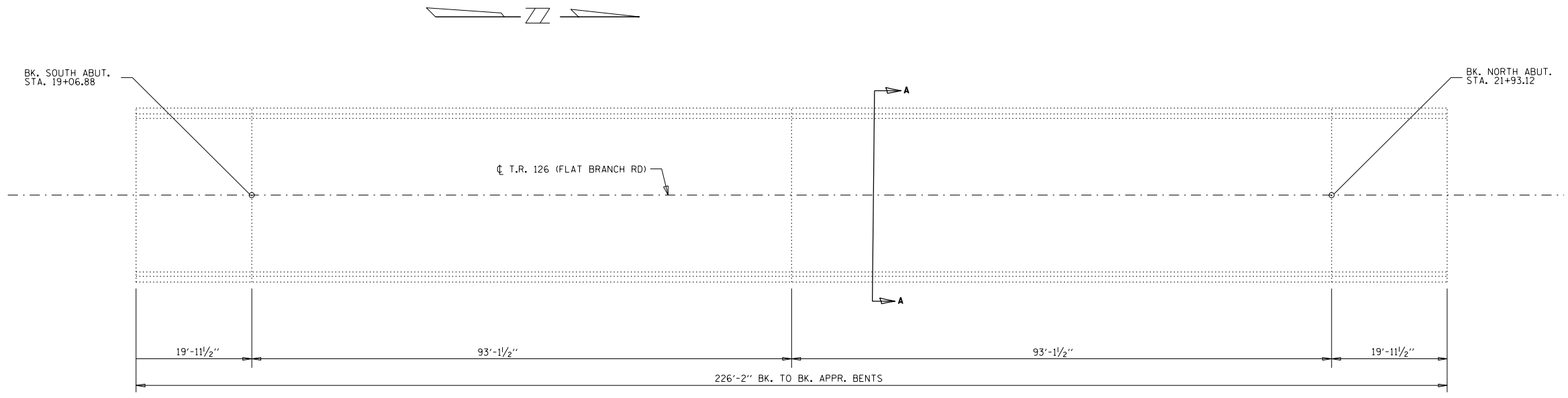

PARTIAL PLAN

TOTAL BILL OF MATERIALS

ITEM	UNIT	TOTAL
BRIDGE DECK CONCRETE SEALER	SO. FT.	6960

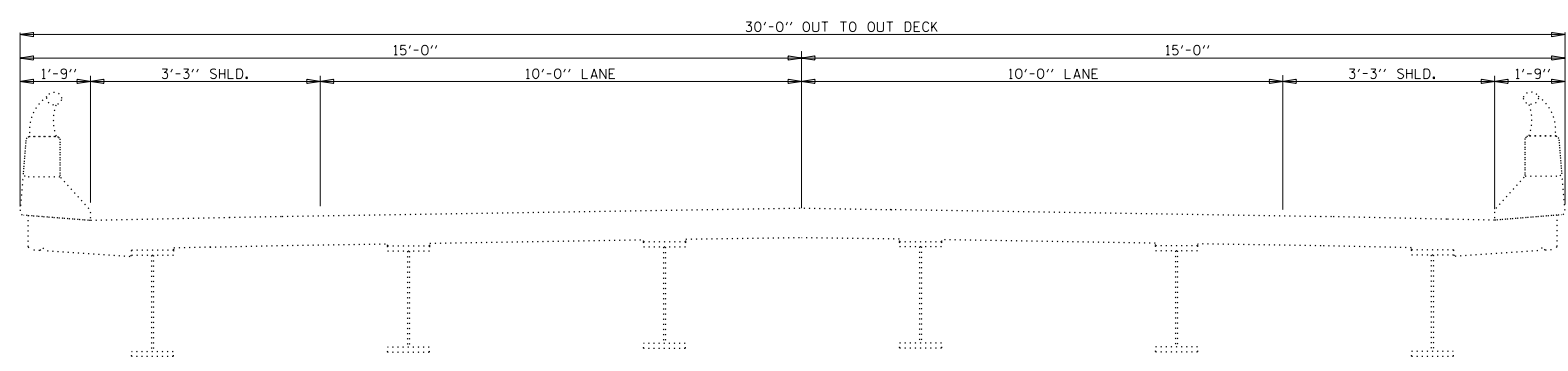

CROSS SECTION

(A-A)

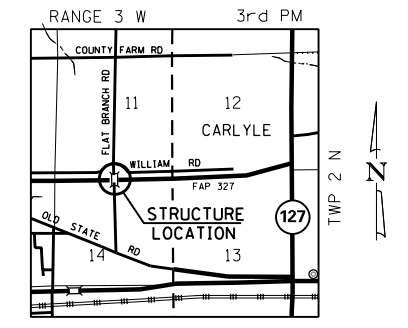

LOCATION SKETCH

GENERAL NOTES

A CONCRETE SEALER SHALL BE APPLIED TO THE SURFACE OF THE DECK, PARAPETS, AND APPROACH PAVEMENTS. SEE SPECIAL PROVISIONS FOR DECK CONCRETE SEALER.

EXISTING PAVEMENT MARKINGS SHALL BE TEMPORARILY COVERED PRIOR TO APPLICATION OF THE DECK SURFACE TREATMENT, TO PREVENT THE MATERIAL FROM BEING APPLIED OVER THE MARKINGS. THE TEMPORARY COVERING SHALL BE REMOVED AFTER THE APPLICATION OF THE DECK SURFACE TREATMENT AND PRIOR TO OPENING TO TRAFFIC. COST INCLUDED WITH CONCRETE SEALER.

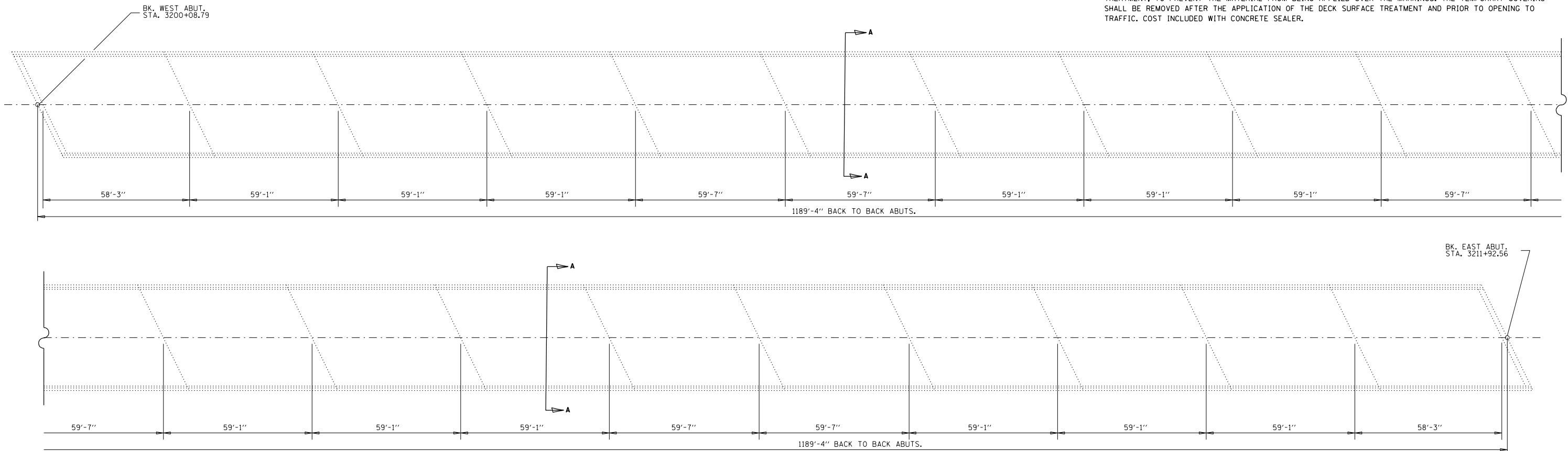

PARTIAL PLAN

TOTAL BILL OF MATERIALS

ITEM	UNIT	TOTAL
BRIDGE DECK CONCRETE SEALER	SO. FT.	53499

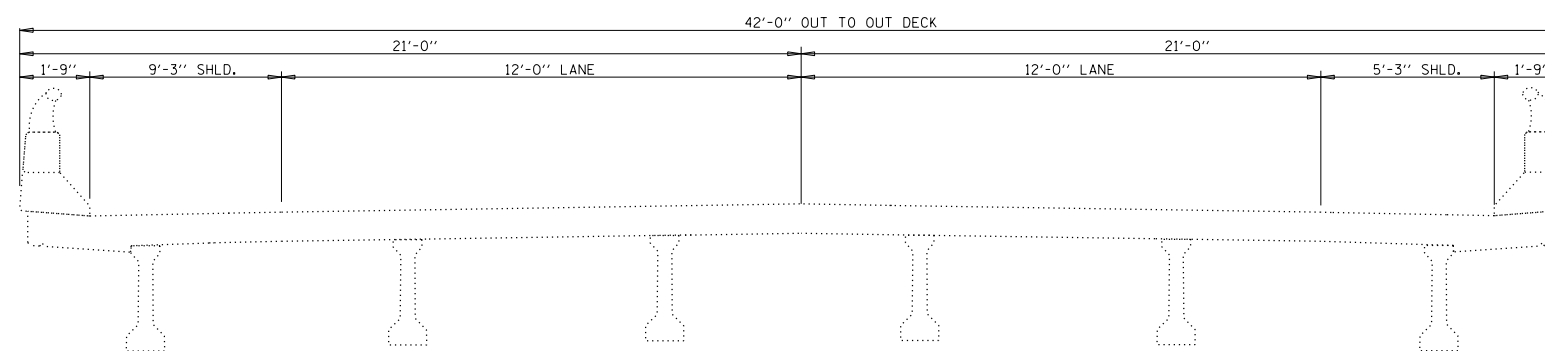

CROSS SECTION
(A-A)

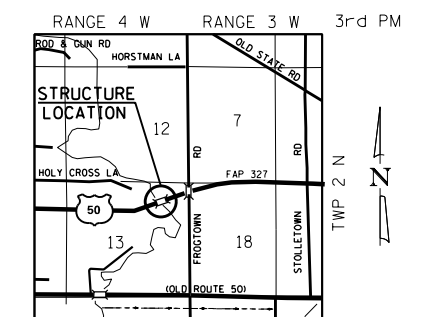

LOCATION SKETCH

FILE NAME =	USER NAME = ogboolato	DESIGNED -	REVISED -	STATE OF ILLINOIS DEPARTMENT OF TRANSPORTATION	PLAN AND SECTION VIEWS US RTE 50 OVER SHOAL CREEK - SN 014-0058				F.A.P. RTE.	SECTION	COUNTY	TOTAL SHEETS	SHEET NO.
Default	PLOT SCALE = 100.0000' / in.	CHECKED -	REVISED -		SCALE:	SHEET	OF	SHEETS	STA.	TO	STA.	28	15
	PLOT DATE = 1/19/2017	DATE -	REVISED -		ILLINOIS FED. AID PROJECT								
					CONTRACT NO. 76K27								

GENERAL NOTES

A CONCRETE SEALER SHALL BE APPLIED TO THE SURFACE OF THE DECK, PARAPETS, AND APPROACH PAVEMENTS. SEE SPECIAL PROVISIONS FOR DECK CONCRETE SEALER.

EXISTING PAVEMENT MARKINGS SHALL BE TEMPORARILY COVERED PRIOR TO APPLICATION OF THE DECK SURFACE TREATMENT, TO PREVENT THE MATERIAL FROM BEING APPLIED OVER THE MARKINGS. THE TEMPORARY COVERING SHALL BE REMOVED AFTER THE APPLICATION OF THE DECK SURFACE TREATMENT AND PRIOR TO OPENING TO TRAFFIC. COST INCLUDED WITH CONCRETE SEALER.

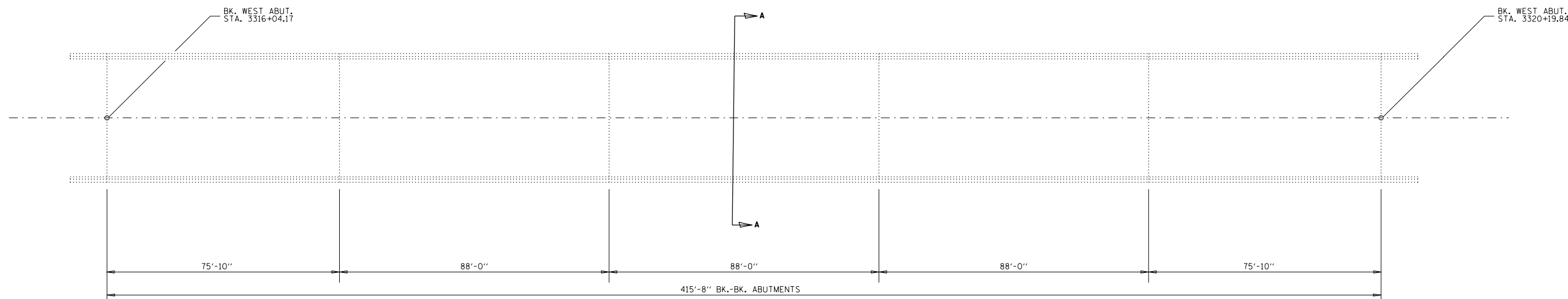

PARTIAL PLAN

TOTAL BILL OF MATERIALS

ITEM	UNIT	TOTAL
BRIDGE DECK CONCRETE SEALER	SO. FT.	19824

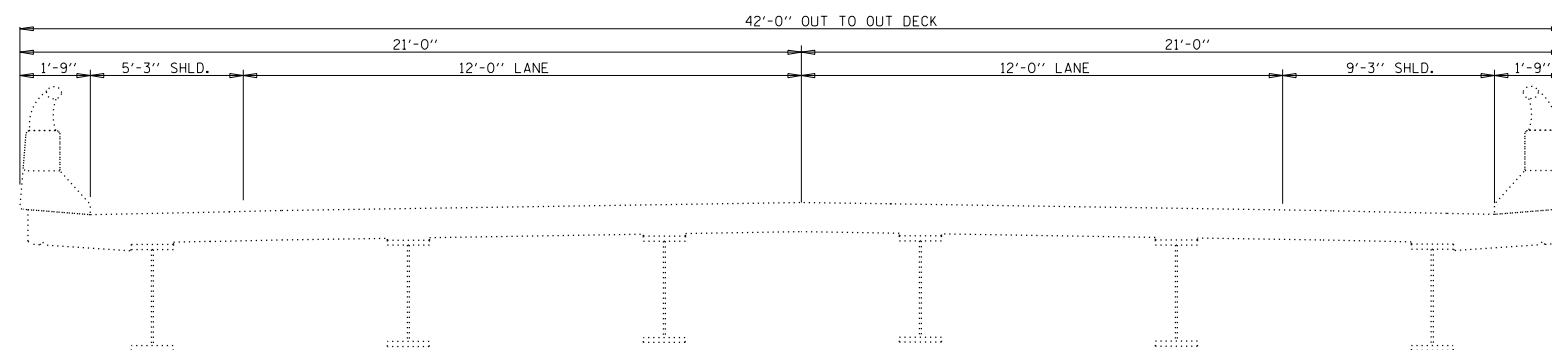

CROSS SECTION

(A-A)

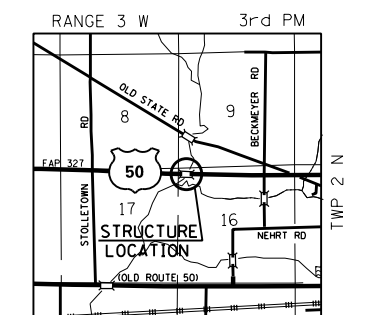

LOCATION SKETCH

FILE NAME =	USER NAME = ogboolato	DESIGNED -	REVISED -	STATE OF ILLINOIS DEPARTMENT OF TRANSPORTATION	PLAN AND SECTION VIEWS US 50 OVER BEAVER CREEK - SN 014-0060				F.A.P. RTE.	SECTION	COUNTY	TOTAL SHEETS	SHEET NO.
pw:\11\084EBIDINTEG.illinois.gov\PIWIDOT\Documents\IDOT Offices\District 8\Projects\0875\DRAWING\DATA\EA\Sheets\0875K27-sht-typro		CHECKED -	REVISED -		VAR.	DIST 8 BRIDGE DECK 2017-2	CLINTON	28	16				
Default	PLOT SCALE = 100.0000' / in.	DATE -	REVISED -		SCALE: SHEET OF SHEETS STA. TO STA.				CONTRACT NO. 76K27				
	PLOT DATE = 1/19/2017				ILLINOIS FED. AID PROJECT								

GENERAL NOTES

A CONCRETE SEALER SHALL BE APPLIED TO THE SURFACE OF THE DECK, PARAPETS, AND APPROACH PAVEMENTS. SEE SPECIAL PROVISIONS FOR DECK CONCRETE SEALER.

EXISTING PAVEMENT MARKINGS SHALL BE TEMPORARILY COVERED PRIOR TO APPLICATION OF THE DECK SURFACE TREATMENT, TO PREVENT THE MATERIAL FROM BEING APPLIED OVER THE MARKINGS. THE TEMPORARY COVERING SHALL BE REMOVED AFTER THE APPLICATION OF THE DECK SURFACE TREATMENT AND PRIOR TO OPENING TO TRAFFIC. COST INCLUDED WITH CONCRETE SEALER.

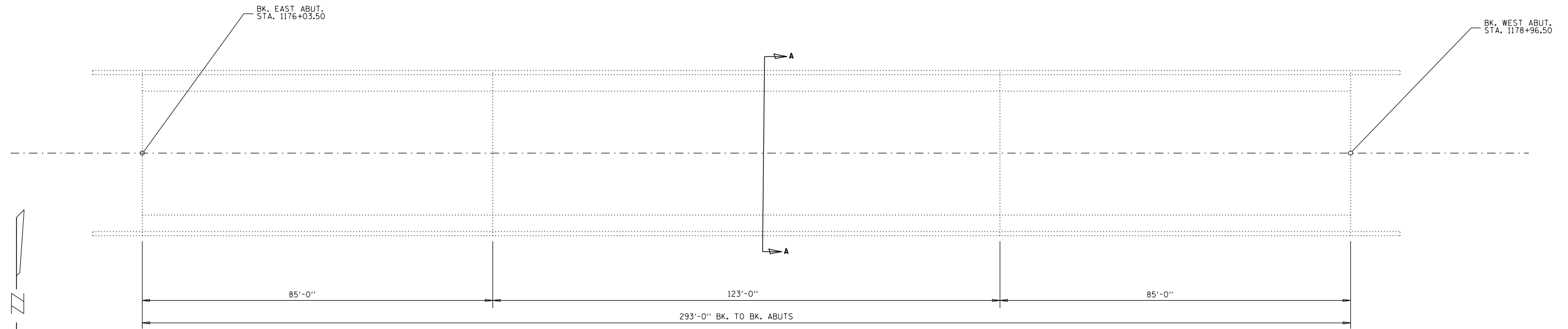

PARTIAL PLAN

TOTAL BILL OF MATERIALS

ITEM	UNIT	TOTAL
BRIDGE DECK CONCRETE SEALER	SQ. FT.	11060

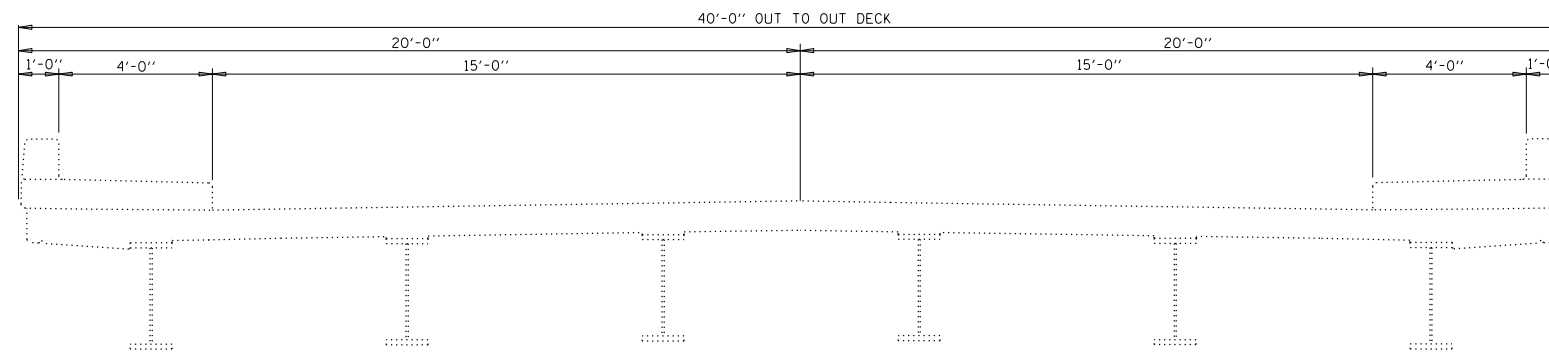

CROSS SECTION

(A-A)

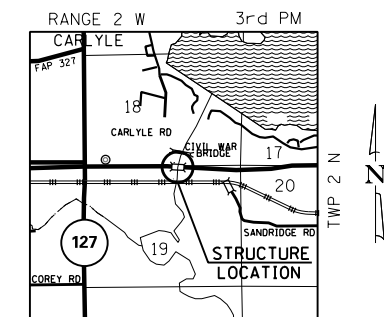

LOCATION SKETCH

FILE NAME =	USER NAME = ogboolato	DESIGNED -	REVISED -	STATE OF ILLINOIS DEPARTMENT OF TRANSPORTATION	PLAN AND SECTION VIEWS US 50 OVER KASKASKIA RIVER - SN 014-0061				F.A.P. RTE.	SECTION	COUNTY	TOTAL SHEETS	SHEET NO.
Default	PLOT SCALE = 100.0000' / 1in.	CHECKED -	REVISED -		SCALE:	SHEET	OF	SHEETS	STA.	TO	STA.	28	17
	PLOT DATE = 1/19/2017	DATE -	REVISED -		ILLINOIS FED. AID PROJECT								
					CONTRACT NO. 76K27								

GENERAL NOTES

A CONCRETE SEALER SHALL BE APPLIED TO THE SURFACE OF THE DECK, PARAPETS, AND APPROACH PAVEMENTS. SEE SPECIAL PROVISIONS FOR DECK CONCRETE SEALER.

EXISTING PAVEMENT MARKINGS SHALL BE TEMPORARILY COVERED PRIOR TO APPLICATION OF THE DECK SURFACE TREATMENT, TO PREVENT THE MATERIAL FROM BEING APPLIED OVER THE MARKINGS. THE TEMPORARY COVERING SHALL BE REMOVED AFTER THE APPLICATION OF THE DECK SURFACE TREATMENT AND PRIOR TO OPENING TO TRAFFIC. COST INCLUDED WITH CONCRETE SEALER.

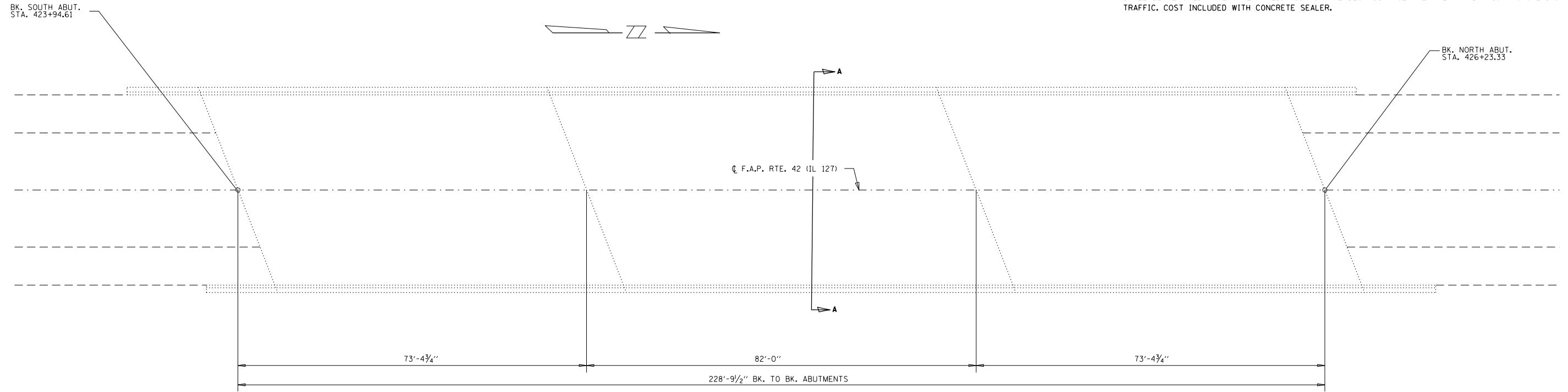

PARTIAL PLAN

TOTAL BILL OF MATERIALS

ITEM	UNIT	TOTAL
BRIDGE DECK CONCRETE SEALER	SO. FT.	11097

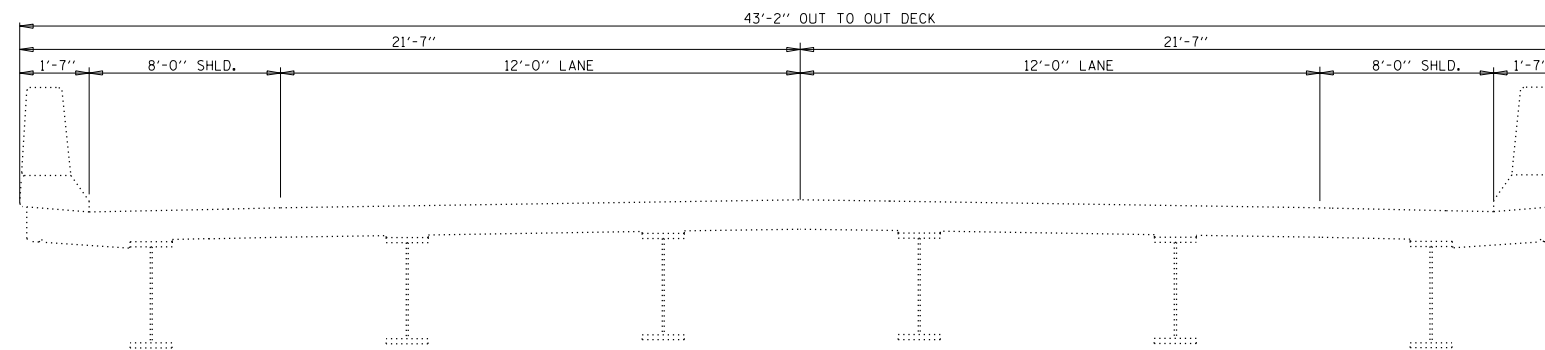

CROSS SECTION

(A-A)

RANGE 3 W RANGE 2 W 3rd PM

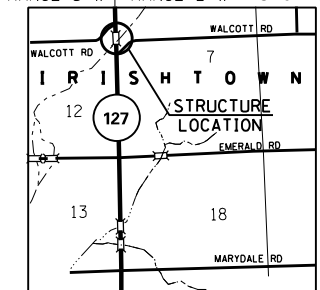

LOCATION SKETCH

FILE NAME =	USER NAME = ogboolato	DESIGNED -	REVISED -	STATE OF ILLINOIS DEPARTMENT OF TRANSPORTATION	PLAN AND SECTION VIEWS				F.A.P. RTE.	SECTION	COUNTY	TOTAL SHEETS	SHEET NO.
pw:\IL\084EBIDINTEG.illinois.gov\PIWIDOT\Documents\DOT Offices\District 8\Projects\0875\DRAWING\DATA\EA\Sheets\D875K27-sht-typoc		CHECKED -	REVISED -		IL RTE 127 OVER FLAT BRANCH CREEK - SN 014-0063				VAR.	DIST 8 BRIDGE DECK 2017-2	CLINTON	28	18
Default	PLOT SCALE = 100.0000' / in.	DATE -	REVISED -		SCALE:	SHEET	OF	SHEETS	STA.	TO	STA.	CONTRACT NO. 76K27	
	PLOT DATE = 1/20/2017				ILLINOIS FED. AID PROJECT								

GENERAL NOTES

A CONCRETE SEALER SHALL BE APPLIED TO THE SURFACE OF THE DECK, PARAPETS, AND APPROACH PAVEMENTS. SEE SPECIAL PROVISIONS FOR DECK CONCRETE SEALER.

EXISTING PAVEMENT MARKINGS SHALL BE TEMPORARILY COVERED PRIOR TO APPLICATION OF THE DECK SURFACE TREATMENT, TO PREVENT THE MATERIAL FROM BEING APPLIED OVER THE MARKINGS. THE TEMPORARY COVERING SHALL BE REMOVED AFTER THE APPLICATION OF THE DECK SURFACE TREATMENT AND PRIOR TO OPENING TO TRAFFIC. COST INCLUDED WITH CONCRETE SEALER.

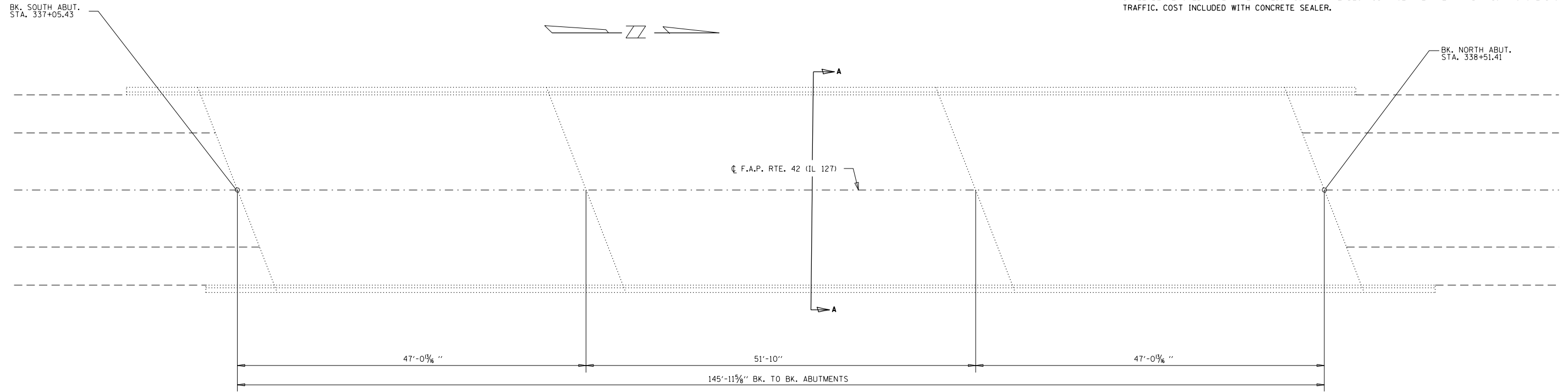

PARTIAL PLAN

TOTAL BILL OF MATERIALS

ITEM	UNIT	TOTAL
BRIDGE DECK CONCRETE SEALER	SO. FT.	7162

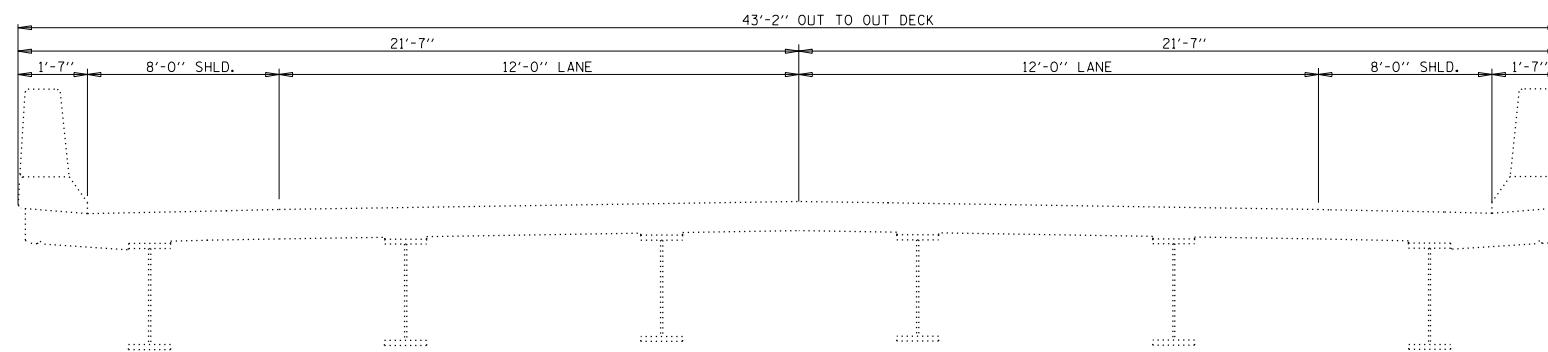

CROSS SECTION
(A-A)

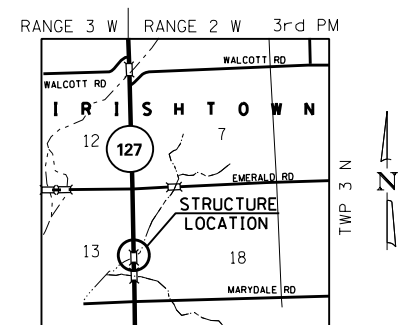

LOCATION SKETCH

FILE NAME =	USER NAME = ogboolato	DESIGNED -	REVISED -	STATE OF ILLINOIS DEPARTMENT OF TRANSPORTATION	PLAN AND SECTION VIEWS			F.A.P. RTE.	SECTION	COUNTY	TOTAL SHEETS	SHEET NO.	
pw:\IL\084EBIDINTEG.illinois.gov\PI\DOT\Documents\DOT Offices\District 8\Projects\0875\DRAWING\DATA\EA\Sheets\D875K27-sht-typoc		CHECKED -	REVISED -		IL RTE 127 OVER FLAT BRANCH CREEK - SN 014-0064			VAR.	DIST 8 BRIDGE DECK 2017-2	CLINTON	28	19	
Default	PLOT SCALE = 100.0000' / in.	DATE -	REVISED -		SCALE:	SHEET	OF	SHEETS	STA.	TO	STA.	CONTRACT NO. 76K27	
	PLOT DATE = 1/20/2017				ILLINOIS FED. AID PROJECT								

GENERAL NOTES

A CONCRETE SEALER SHALL BE APPLIED TO THE SURFACE OF THE DECK, PARAPETS, AND APPROACH PAVEMENTS. SEE SPECIAL PROVISIONS FOR DECK CONCRETE SEALER.

EXISTING PAVEMENT MARKINGS SHALL BE TEMPORARILY COVERED PRIOR TO APPLICATION OF THE DECK SURFACE TREATMENT, TO PREVENT THE MATERIAL FROM BEING APPLIED OVER THE MARKINGS. THE TEMPORARY COVERING SHALL BE REMOVED AFTER THE APPLICATION OF THE DECK SURFACE TREATMENT AND PRIOR TO OPENING TO TRAFFIC. COST INCLUDED WITH CONCRETE SEALER.

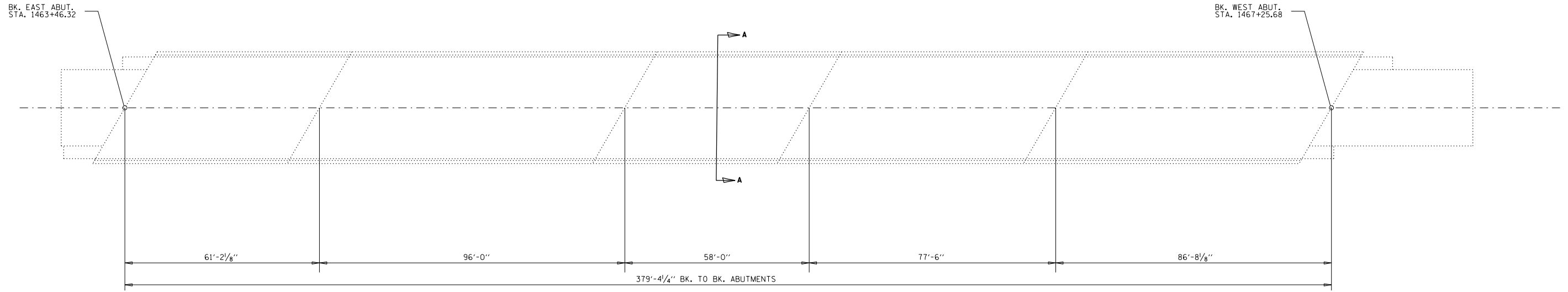

PARTIAL PLAN

TOTAL BILL OF MATERIALS

ITEM	UNIT	TOTAL
BRIDGE DECK CONCRETE SEALER	SO. FT.	16539

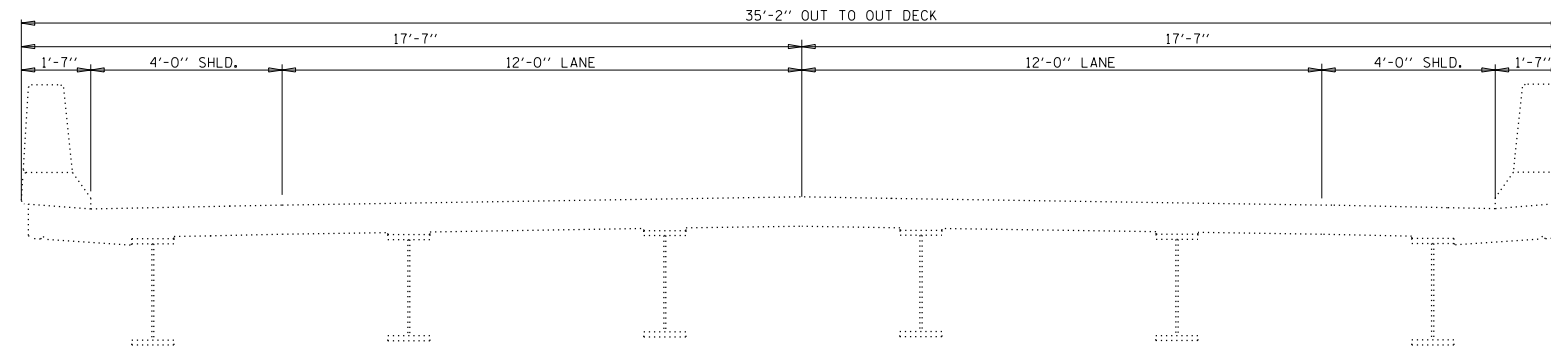

CROSS SECTION

(A-A)

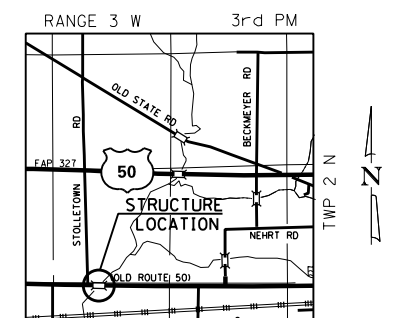

LOCATION SKETCH

FILE NAME =	USER NAME = ogboolato	DESIGNED -	REVISED -	STATE OF ILLINOIS DEPARTMENT OF TRANSPORTATION	PLAN AND SECTION VIEWS OLD US 50 OVER BEAVER CREEK - SN 014-0069				F.A.P. RTE.	SECTION	COUNTY	TOTAL SHEETS	SHEET NO.
Default		CHECKED -	REVISED -		SCALE:	SHEET	OF	SHEETS	STA.	TO	STA.	28	20
		DATE -	REVISED -		CONTRACT NO. 76K27								
					ILLINOIS FED. AID PROJECT								

GENERAL NOTES

A CONCRETE SEALER SHALL BE APPLIED TO THE SURFACE OF THE DECK, PARAPETS, AND APPROACH PAVEMENTS. SEE SPECIAL PROVISIONS FOR DECK CONCRETE SEALER.

EXISTING PAVEMENT MARKINGS SHALL BE TEMPORARILY COVERED PRIOR TO APPLICATION OF THE DECK SURFACE TREATMENT, TO PREVENT THE MATERIAL FROM BEING APPLIED OVER THE MARKINGS. THE TEMPORARY COVERING SHALL BE REMOVED AFTER THE APPLICATION OF THE DECK SURFACE TREATMENT AND PRIOR TO OPENING TO TRAFFIC. COST INCLUDED WITH CONCRETE SEALER.

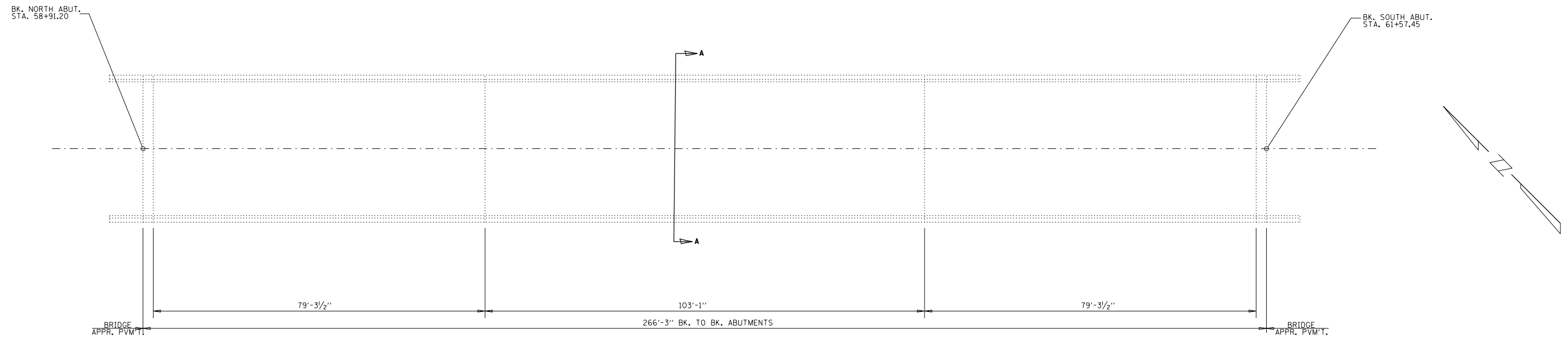

PARTIAL PLAN

TOTAL BILL OF MATERIALS

ITEM	UNIT	TOTAL
BRIDGE DECK CONCRETE SEALER	SQ. FT.	10672

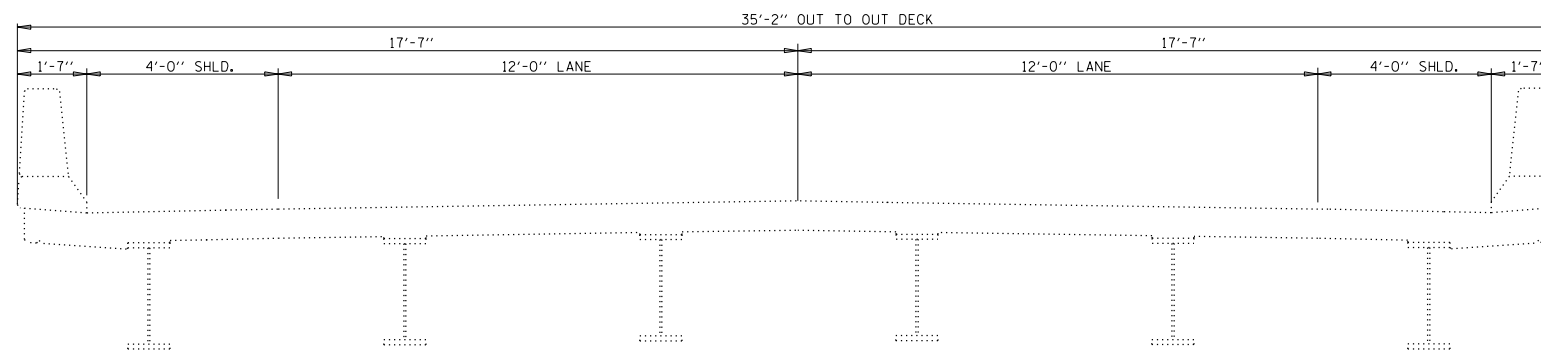

CROSS SECTION

(A-A)

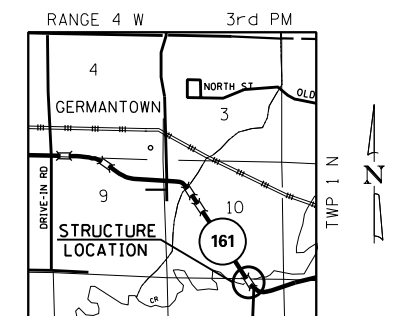

LOCATION SKETCH

FILE NAME =	USER NAME = ogboolato	DESIGNED -	REVISED -	STATE OF ILLINOIS DEPARTMENT OF TRANSPORTATION	PLAN AND SECTION VIEWS IL RTE 161 OVER SHOAL CREEK - SN 014-0070	F.A.P. RTE.	SECTION	COUNTY	TOTAL SHEETS	SHEET NO.	
Default	PLOT SCALE = 100.0000' / in.	CHECKED -	REVISED -			VAR.	DIST 8 BRIDGE DECK 2017-2	CLINTON	28	21	
	PLOT DATE = 1/20/2017	DATE -	REVISED -			CONTRACT NO. 76K27					
						ILLINOIS FED. AID PROJECT					

GENERAL NOTES

A CONCRETE SEALER SHALL BE APPLIED TO THE SURFACE OF THE DECK, PARAPETS, AND APPROACH PAVEMENTS. SEE SPECIAL PROVISIONS FOR DECK CONCRETE SEALER.

EXISTING PAVEMENT MARKINGS SHALL BE TEMPORARILY COVERED PRIOR TO APPLICATION OF THE DECK SURFACE TREATMENT, TO PREVENT THE MATERIAL FROM BEING APPLIED OVER THE MARKINGS. THE TEMPORARY COVERING SHALL BE REMOVED AFTER THE APPLICATION OF THE DECK SURFACE TREATMENT AND PRIOR TO OPENING TO TRAFFIC. COST INCLUDED WITH CONCRETE SEALER.

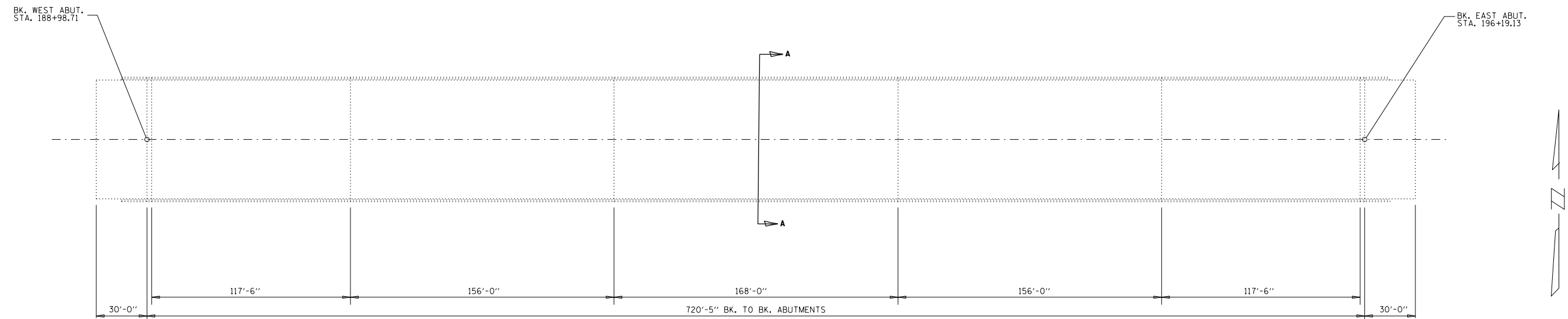

PARTIAL PLAN

TOTAL BILL OF MATERIALS

ITEM	UNIT	TOTAL
BRIDGE DECK CONCRETE SEALER	SG. FT.	30614

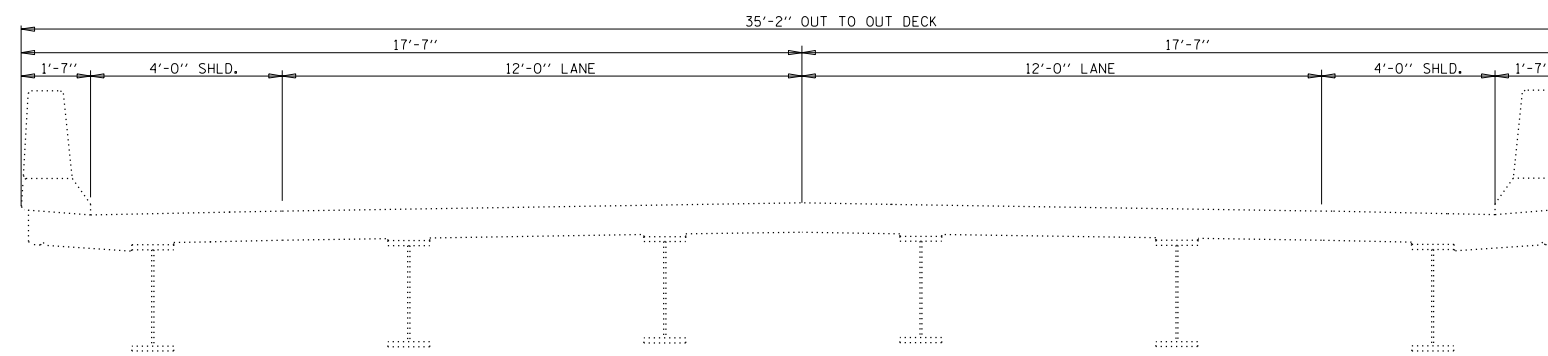

CROSS SECTION

(A-A)

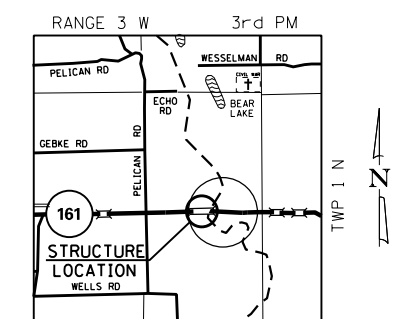

LOCATION SKETCH

FILE NAME =	USER NAME = ogboolato	DESIGNED -	REVISED -	STATE OF ILLINOIS DEPARTMENT OF TRANSPORTATION	PLAN AND SECTION VIEWS IL RTE 161 OVER KASKASKIA RIVER - SN 014-0071				F.A.P. RTE.	SECTION	COUNTY	TOTAL SHEETS	SHEET NO.
pw:\IL\084EBIDINTEG.illinois.gov\PI\DOT\Documents\DOT Offices\District 8\Projects\0875\DRAWING\DATA\EA\Sheets\0875K27-sht-typoc		CHECKED -	REVISED -		VAR.	DIST 8 BRIDGE DECK 2017-2	CLINTON	28	22				
Default	PLOT SCALE = 100.0000' / in.	DATE -	REVISED -		SCALE:	SHEET	OF SHEETS	STA.	TO STA.	ILLINOIS FED. AID PROJECT			
	PLOT DATE = 1/20/2017									CONTRACT NO. 76K27			

GENERAL NOTES

A CONCRETE SEALER SHALL BE APPLIED TO THE SURFACE OF THE DECK, PARAPETS, AND APPROACH PAVEMENTS. SEE SPECIAL PROVISIONS FOR DECK CONCRETE SEALER.

EXISTING PAVEMENT MARKINGS SHALL BE TEMPORARILY COVERED PRIOR TO APPLICATION OF THE DECK SURFACE TREATMENT, TO PREVENT THE MATERIAL FROM BEING APPLIED OVER THE MARKINGS. THE TEMPORARY COVERING SHALL BE REMOVED AFTER THE APPLICATION OF THE DECK SURFACE TREATMENT AND PRIOR TO OPENING TO TRAFFIC. COST INCLUDED WITH CONCRETE SEALER.

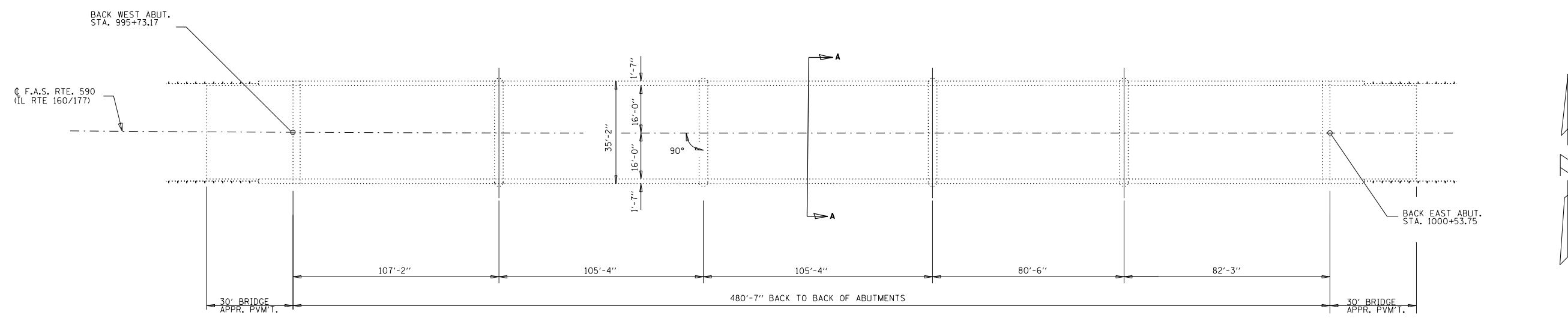

PARTIAL PLAN

TOTAL BILL OF MATERIALS

ITEM	UNIT	TOTAL
BRIDGE DECK CONCRETE SEALER	SO. FT.	21092

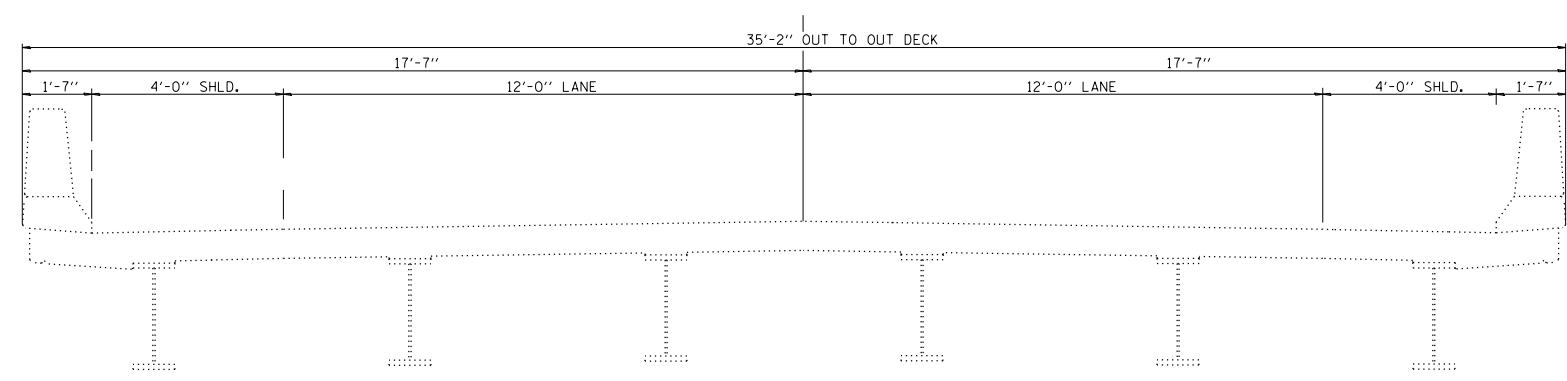

CROSS SECTION

(A-A)

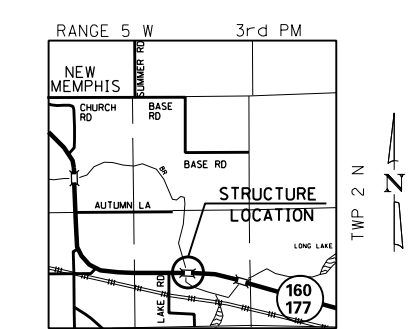

LOCATION SKETCH

GENERAL NOTES

A CONCRETE SEALER SHALL BE APPLIED TO THE SURFACE OF THE DECK, PARAPETS, AND APPROACH PAVEMENTS. SEE SPECIAL PROVISIONS FOR DECK CONCRETE SEALER.

EXISTING PAVEMENT MARKINGS SHALL BE TEMPORARILY COVERED PRIOR TO APPLICATION OF THE DECK SURFACE TREATMENT, TO PREVENT THE MATERIAL FROM BEING APPLIED OVER THE MARKINGS. THE TEMPORARY COVERING SHALL BE REMOVED AFTER THE APPLICATION OF THE DECK SURFACE TREATMENT AND PRIOR TO OPENING TO TRAFFIC. COST INCLUDED WITH CONCRETE SEALER.

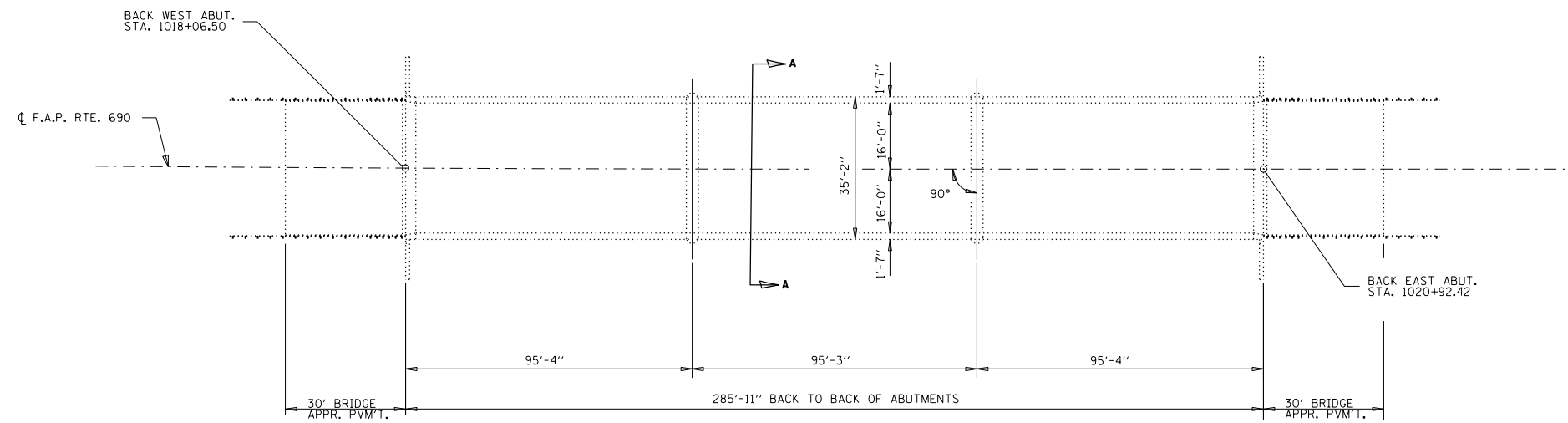

PARTIAL PLAN

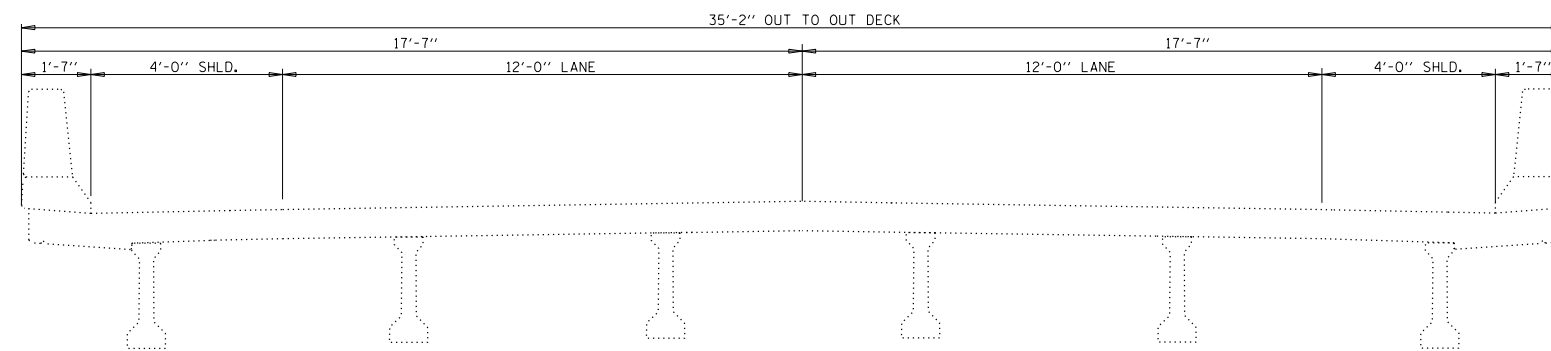
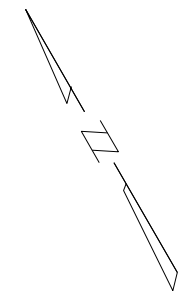

CROSS SECTION
(A-A)

TOTAL BILL OF MATERIALS

ITEM	UNIT	TOTAL
BRIDGE DECK CONCRETE SEALER	SO. FT.	13219

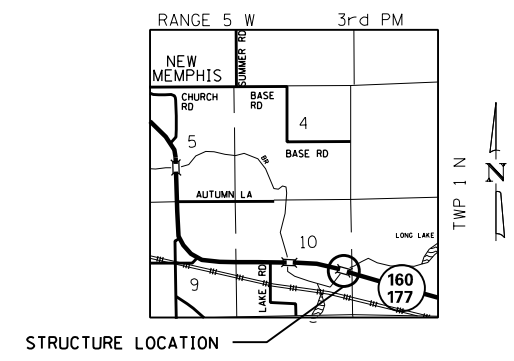

LOCATION SKETCH

FILE NAME =	USER NAME = ogboolato	DESIGNED -	REVISED -	STATE OF ILLINOIS DEPARTMENT OF TRANSPORTATION	PLAN AND SECTION VIEWS IL RTE 177/160 OVER KASKASKIA OVERFLOW - SN 014-0074				F.A.P. RTE.	SECTION	COUNTY	TOTAL SHEETS	SHEET NO.
Default		CHECKED -	REVISED -		SCALE:	SHEET	OF	SHEETS	STA.	TO	STA.	28	25
	PLOT SCALE = 100.0000' / 1in.	DATE -	REVISED -						VAR.	DIST 8 BRIDGE DECK 2017-2	CLINTON	CONTRACT NO. 76K27	
	PLOT DATE = 1/20/2017								ILLINOIS FED. AID PROJECT				

GENERAL NOTES

A CONCRETE SEALER SHALL BE APPLIED TO THE SURFACE OF THE DECK, PARAPETS, AND APPROACH PAVEMENTS. SEE SPECIAL PROVISIONS FOR DECK CONCRETE SEALER.

EXISTING PAVEMENT MARKINGS SHALL BE TEMPORARILY COVERED PRIOR TO APPLICATION OF THE DECK SURFACE TREATMENT. TO PREVENT THE MATERIAL FROM BEING APPLIED OVER THE MARKINGS. THE TEMPORARY COVERING SHALL BE REMOVED AFTER THE APPLICATION OF THE DECK SURFACE TREATMENT AND PRIOR TO OPENING TO TRAFFIC. COST INCLUDED WITH CONCRETE SEALER.

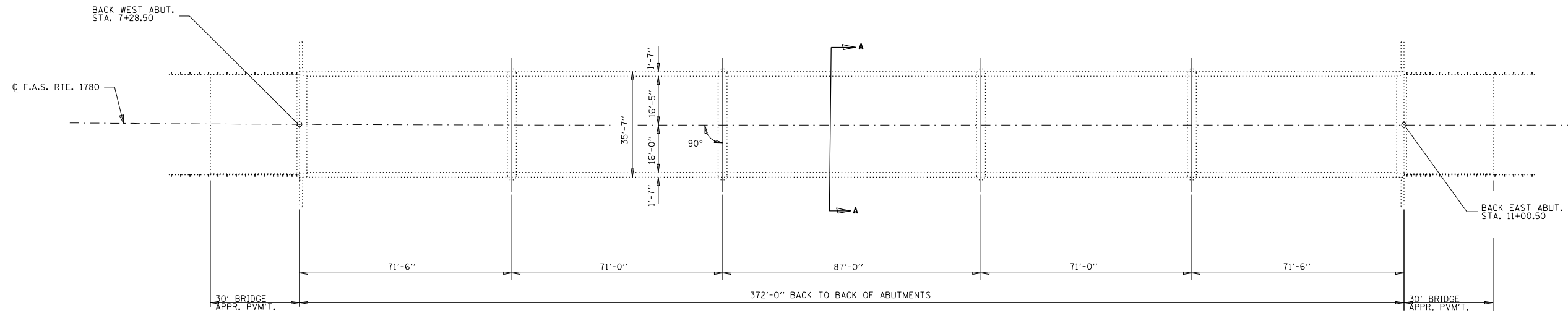

PARTIAL PLAN

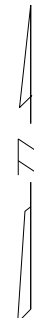

TOTAL BILL OF MATERIALS

ITEM	UNIT	TOTAL
BRIDGE DECK CONCRETE SEALER	SQ. FT.	16993

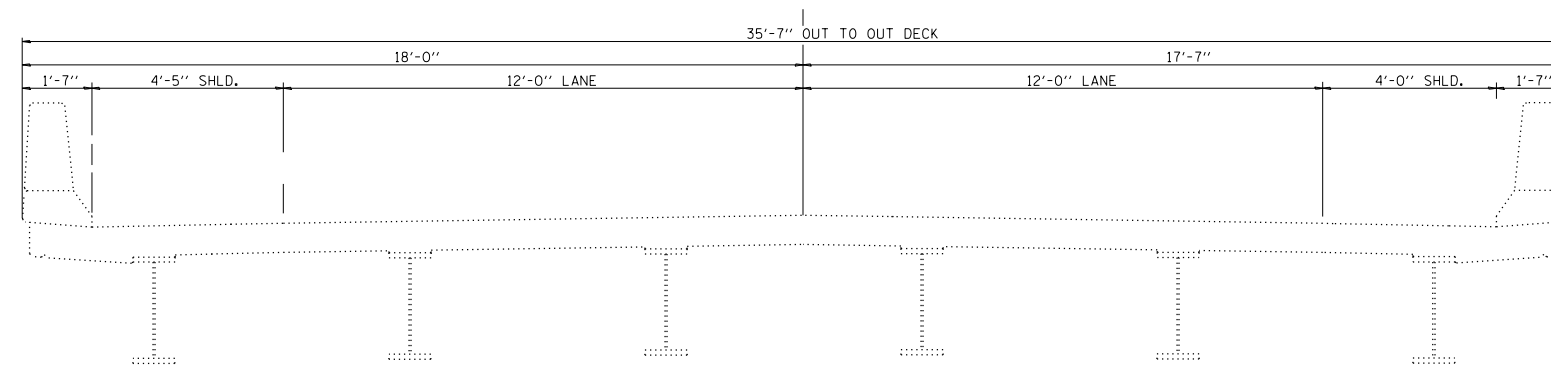

CROSS SECTION

(A-A)

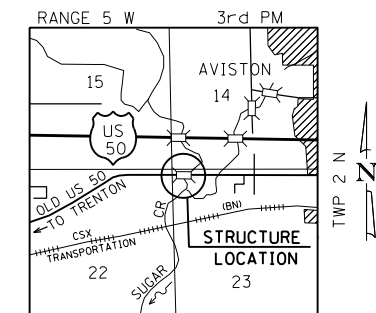

LOCATION SKETCH

FILE NAME =	USER NAME = ogboolato	DESIGNED -	REVISED -	STATE OF ILLINOIS DEPARTMENT OF TRANSPORTATION	PLAN AND SECTION VIEWS OLD US 50 OVER SUGAR CREEK - SN 014-0077			F.A.P. RTE.	SECTION	COUNTY	TOTAL SHEETS	SHEET NO.
pw:\11084EBIDINTEG.illinois.gov\PIWIDOT\Documents\IDOT Offices\District 8\Projects\0875\Drawings\EA\Sheets\D875K27-sht-typro		DRAWN	REVISED -		VAR.	DIST 8 BRIDGE DECK 2017-2	CLINTON	28	27			
Default	PLOT SCALE = 100.0000' / in.	CHECKED -	REVISED -		CONTRACT NO. 76K27							
	PLOT DATE = 1/20/2017	DATE -	REVISED -		SCALE:	SHEET	OF	SHEETS	STA.	TO	STA.	ILLINOIS FED. AID PROJECT

GENERAL NOTES

A CONCRETE SEALER SHALL BE APPLIED TO THE SURFACE OF THE DECK, PARAPETS, AND APPROACH PAVEMENTS. SEE SPECIAL PROVISIONS FOR DECK CONCRETE SEALER.

EXISTING PAVEMENT MARKINGS SHALL BE TEMPORARILY COVERED PRIOR TO APPLICATION OF THE DECK SURFACE TREATMENT, TO PREVENT THE MATERIAL FROM BEING APPLIED OVER THE MARKINGS. THE TEMPORARY COVERING SHALL BE REMOVED AFTER THE APPLICATION OF THE DECK SURFACE TREATMENT AND PRIOR TO OPENING TO TRAFFIC. COST INCLUDED WITH CONCRETE SEALER.

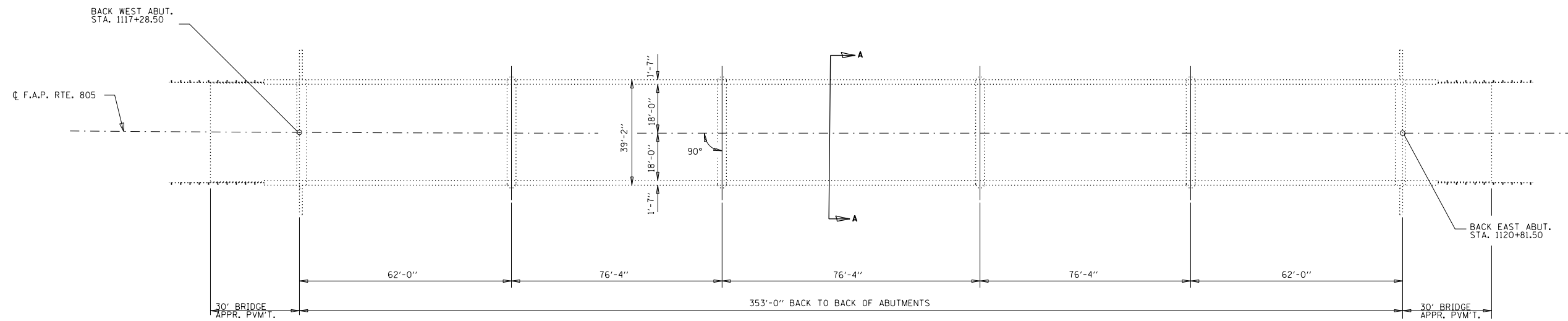

PARTIAL PLAN

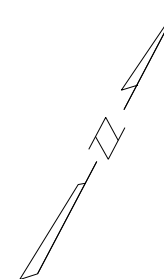

TOTAL BILL OF MATERIALS

ITEM	UNIT	TOTAL
BRIDGE DECK CONCRETE SEALER	SQ. FT.	17506

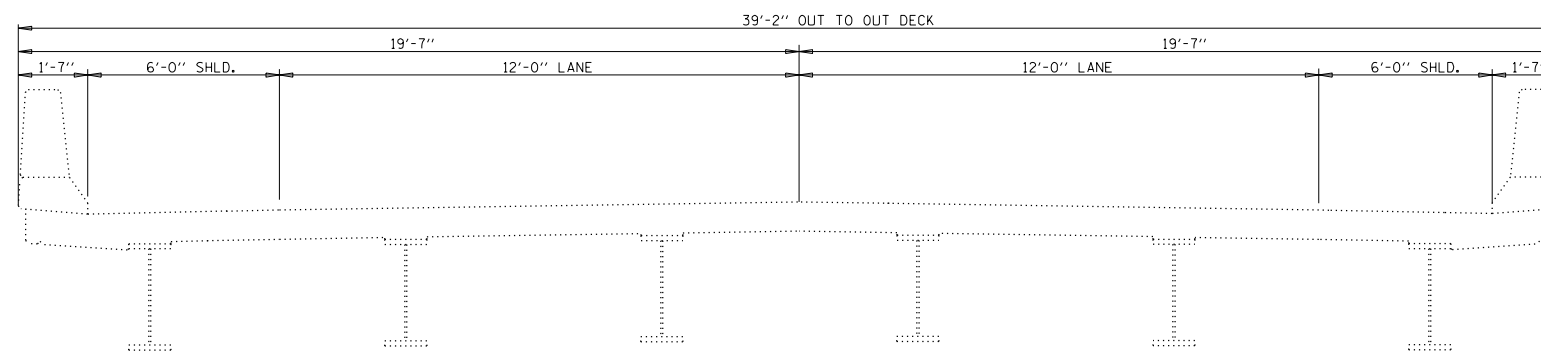

CROSS SECTION

(A-A)

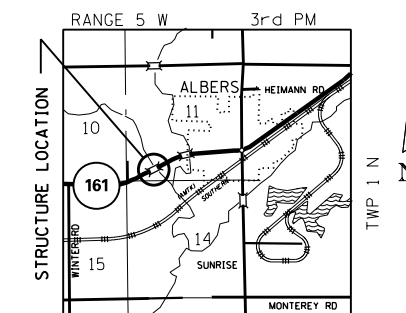

LOCATION SKETCH

FILE NAME =	USER NAME = ogboolato	DESIGNED -	REVISED -	STATE OF ILLINOIS DEPARTMENT OF TRANSPORTATION	PLAN AND SECTION VIEWS IL RTE 161 OVER SUGAR CREEK - SN 014-0078				F.A.P. RTE.	SECTION	COUNTY	TOTAL SHEETS	SHEET NO.
pw:\11\084EBIDINTEG.illinois.gov\PWIDOT\Documents\DOT Offices\District 8\Projects\0875\DRAWING\DATA\EA0\Sheets\D875K27-sht-typro1		CHECKED -	REVISED -		VAR.	DIST 8 BRIDGE DECK 2017-2	CLINTON	28	28				
Default	PLOT SCALE = 100.0000' / in.	DATE -	REVISED -		CONTRACT NO. 76K27				ILLINOIS FED. AID PROJECT				
	PLOT DATE = 1/20/2017				SCALE:	SHEET	OF	SHEETS	STA.	TO	STA.		