

COUNTY	ROUTE	SECTION	SHT. NO.
ADAMS	FAS 1600 FAS 1601	16-00073-01-FP	1
COVER SHEET			
TOTAL NO. SHEETS - 18			

STATE OF ILLINOIS
DEPARTMENT OF TRANSPORTATION
DIVISION OF HIGHWAYS
PLANS FOR PROPOSED
SURFACE TRANSPORTATION / RURAL PROGRAM FUNDS
FAS ROUTE 1600 / FAS ROUTE 1601 (C.H. 6)
ADAMS COUNTY SEC. 16-00073-01-FP
PROJECT NO. RS-1600(123)
JOB NO. C-96-201-17

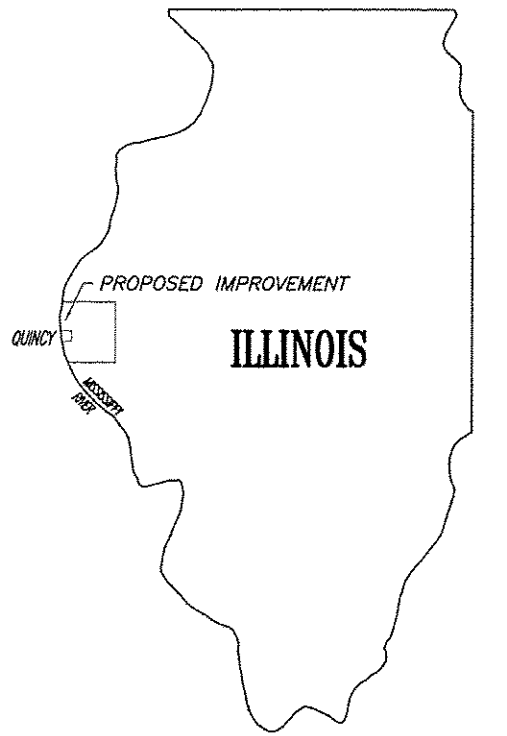

PROPOSED IMPROVEMENT MARKED THUS —

INDEX OF SHEETS

SHEET NO.	SHEET
1	TITLE SHEET
2	TYPICAL CROSS SECTIONS
3	SUMMARY OF QUANTITIES
	TRAFFIC CONTROL AND PROTECTION
	GENERAL NOTES
4	QUANTITY SCHEDULES
	HMA MIXTURE REQUIREMENTS
	APPLICATION RATES
5-6	PLAN & PROFILE SHEETS
7	PAVEMENT MARKINGS
8	ENTRANCE PAVING DETAILS
9	MAILBOX TURNOUT DETAILS
10-11	BUTT JOINT DETAILS
12-16	CROSS SECTIONS (ROADWAY)
17-18	CROSS SECTIONS (DRIVEWAYS)

STANDARDS

- STANDARD 701011-04
- STANDARD 701306-03
- STANDARD 701311-03
- STANDARD 701901-06
- STANDARD 780001-05

SUMMARY OF LENGTH:

GROSS LENGTH:
 STA. 1+00 TO STA. 112+50 (FAS 1601) = 11,150.00 FT.
 STA. 370+52 - 372+41.2 (FAS 1600) = 189.20 FT.
 NET LENGTH TO BE IMPROVED = 11,339.20 FT. = 2.147 MILES

THE PROPOSED IMPROVEMENT CONSISTS OF OVERLAYING THE EXISTING ROADWAY WITH 2 1/2" HMA BINDER CSE. AND 1 1/2" POLY. HMA SURFACE COURSE, CURVE SUPER ELEVATION CORRECTIONS, PLACEMENT OF AGGREGATE SHOULDERS, INCIDENTAL SURFACING AND PAVEMENT MARKINGS.

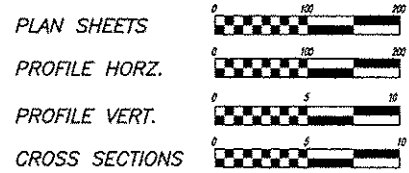

FULL SIZE PLANS HAVE BEEN PREPARED USING STANDARD ENGINEERING SCALES. REDUCED SIZED PLANS WILL NOT CONFORM TO STANDARD SCALES. IN MAKING MEASUREMENTS ON REDUCED PLANS, THE ABOVE SCALES MAY BE USED.

UTILITIES:

- J.U.L.I.E. 1-800-892-0123
- ADAMS ELECTRIC CO-OP CAMP POINT, IL
- VILLAGE OF URSA URSA, IL
- NICOR CARTHAGE, IL
- ADAMS GOLDEN, IL

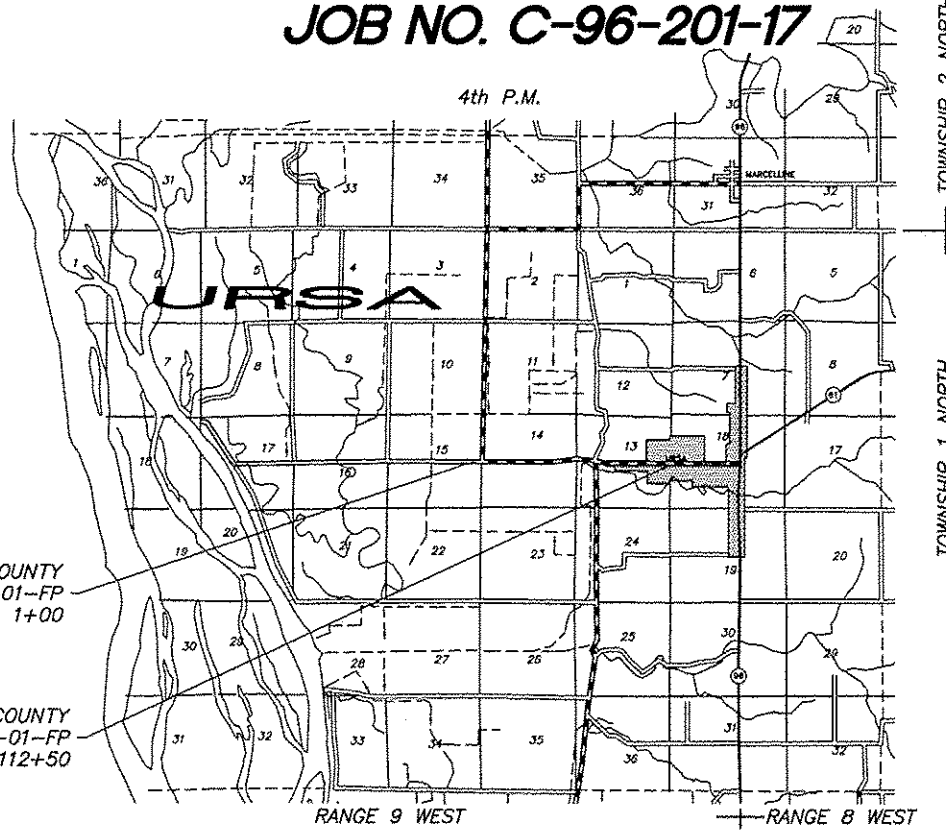

LOCATION MAP

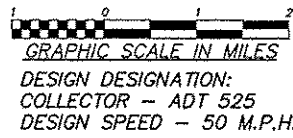

THESE PLANS WERE PREPARED BY ME OR A FULL TIME MEMBER OF MY STAFF WORKING UNDER MY PERSONAL SUPERVISION.

SUBMITTED BY *James R. Frankenkoff* DATE 1/17/17
 COUNTY ENGINEER
 LICENSE NO. 062-044792
 LIC. EXPIRES 11/30/2017



APPROVED January 17, 2017
James R. Frankenkoff
 COUNTY ENGINEER

PASSED February 16, 2017
Ron Anshel
 DISTRICT ENGINEER OF CONSTRUCTION

PASSED FEBRUARY 16, 2017
Simon J. Anshel
 DISTRICT ENGINEER OF LOCAL ROADS AND STREETS

RELEASING FOR BID BASED ON LIMITED REVIEW February 16, 2017
Felton M. Southgate
 REGION FOUR ENGINEER

STATE OF ILLINOIS
DEPARTMENT OF TRANSPORTATION

PREPARED BY
 ADAMS COUNTY HIGHWAY DEPARTMENT
 101 NORTH 54th STREET, QUINCY, ILLINOIS

CONTRACT NO. 93700			
COUNTY	ROUTE	SECTION	SHT. NO.
ADAMS	FAS 1600 FAS 1801	16-00073-01-FP	2
TYPICAL SECTIONS			

TYPICAL CROSS SECTIONS

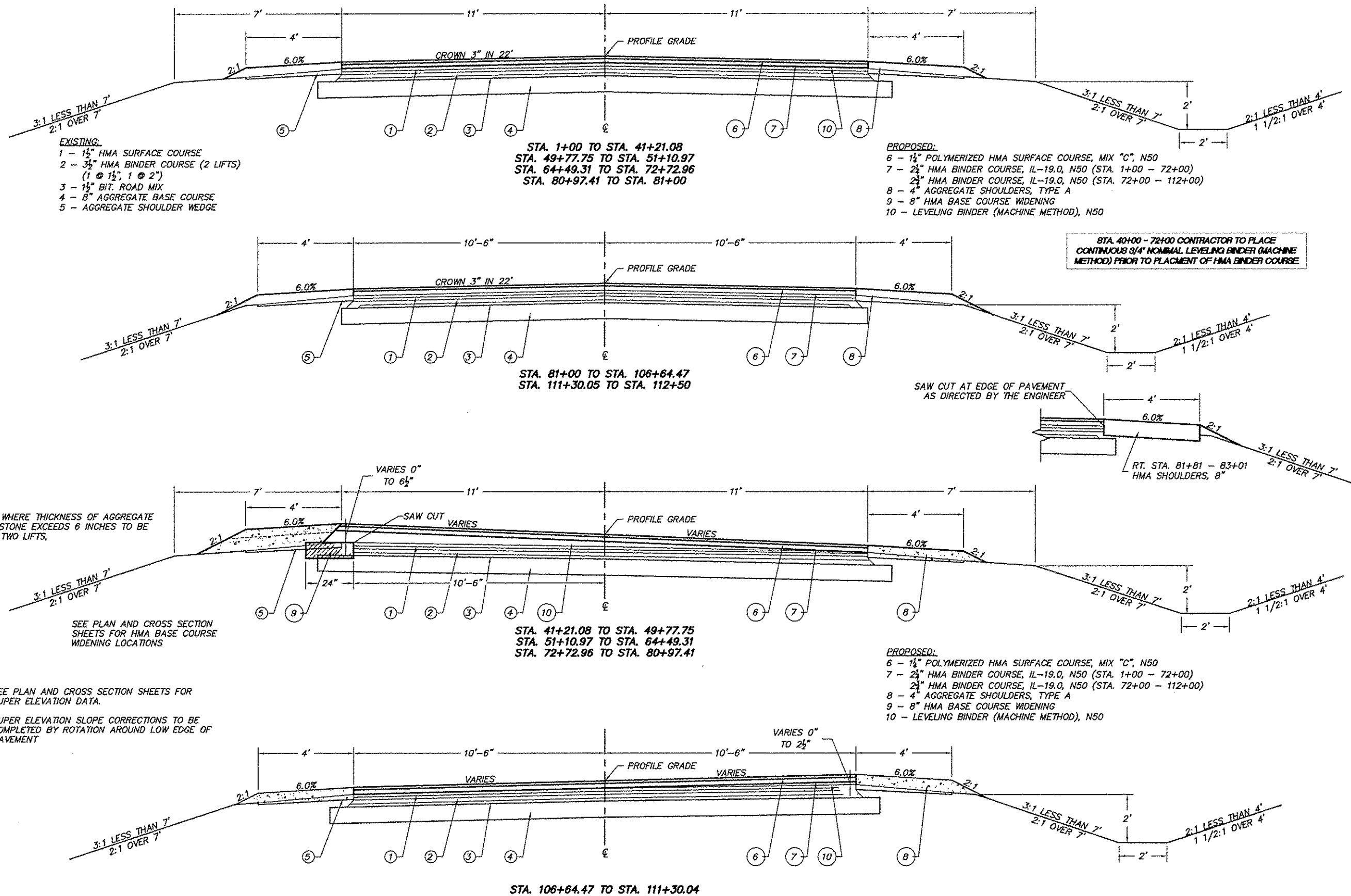

- EXISTING:**
- 1 - 1 1/2" HMA SURFACE COURSE
 - 2 - 3 1/2" HMA BINDER COURSE (2 LIFTS)
(1 @ 1 1/2", 1 @ 2")
 - 3 - 1 1/2" BIT. ROAD MIX
 - 4 - 8" AGGREGATE BASE COURSE
 - 5 - AGGREGATE SHOULDER WEDGE

STA. 1+00 TO STA. 41+21.08
 STA. 49+77.75 TO STA. 51+10.97
 STA. 64+49.31 TO STA. 72+72.96
 STA. 80+97.41 TO STA. 81+00

- PROPOSED:**
- 6 - 1 1/4" POLYMERIZED HMA SURFACE COURSE, MIX "C", N50
 - 7 - 2 1/4" HMA BINDER COURSE, IL-19.0, N50 (STA. 1+00 - 72+00)
 - 8 - 4" AGGREGATE SHOULDERS, TYPE A
 - 9 - 8" HMA BASE COURSE WIDENING
 - 10 - LEVELING BINDER (MACHINE METHOD), N50

BTA. 40+00 - 72+00 CONTRACTOR TO PLACE
 CONTINUOUS 3/4" NOMINAL LEVELING BINDER (MACHINE
 METHOD) PRIOR TO PLACEMENT OF HMA BINDER COURSE

LOCATIONS WHERE THICKNESS OF AGGREGATE
 SHOULDER STONE EXCEEDS 6 INCHES TO BE
 PLACED IN TWO LIFTS.

SEE PLAN AND CROSS SECTION
 SHEETS FOR HMA BASE COURSE
 WIDENING LOCATIONS

SEE PLAN AND CROSS SECTION SHEETS FOR
 SUPER ELEVATION DATA.

SUPER ELEVATION SLOPE CORRECTIONS TO BE
 COMPLETED BY ROTATION AROUND LOW EDGE OF
 PAVEMENT

- PROPOSED:**
- 6 - 1 1/4" POLYMERIZED HMA SURFACE COURSE, MIX "C", N50
 - 7 - 2 1/4" HMA BINDER COURSE, IL-19.0, N50 (STA. 1+00 - 72+00)
 - 8 - 4" AGGREGATE SHOULDERS, TYPE A
 - 9 - 8" HMA BASE COURSE WIDENING
 - 10 - LEVELING BINDER (MACHINE METHOD), N50

STA. 106+64.47 TO STA. 111+30.04

COUNTY	ROUTE	SECTION	SHT. NO.
ADAMS	FAS 1600 FAS 1601	16-00073-01-FP	3

GENERAL NOTES
TRAFFIC CONTROL AND PROTECTION
SUMMARY OF QUANTITIES

GENERAL NOTES

- WHERE SECTION OR SUB-SECTION STONES, PROPERTY PINS, USGS BENCH MARK MONUMENTS, AND U.S. ARMY CORPS OF ENGINEERS SURVEY MARKERS ARE ENCOUNTERED, THE ENGINEER SHALL BE NOTIFIED BEFORE SUCH STONES AND MONUMENTS ARE REMOVED. THE CONTRACTOR SHALL PROTECT AND CAREFULLY PRESERVE ALL PROPERTY MARKS UNTIL AN OWNER, AN AUTHORIZED SURVEYOR OR THEIR REPRESENTATIVE HAS WITNESSED OR OTHERWISE REFERENCED THE PROPERTY MARKS LOCATION.
- ALL PRIVATELY OWNED UTILITIES, UNLESS OTHERWISE SPECIFIED, WILL BE MOVED BY THEIR RESPECTIVE OWNERS WHERE REQUIRED. THE FOLLOWING UTILITY COMPANIES MAY HAVE FACILITIES WITHIN THE LIMITS OF CONSTRUCTION:

VILLAGE OF URSA (SEWER & WATER) ADAMS ELECTRIC COOP	ADAMS TELESYS (COMMUNICATION) ADAMS (TELEPHONE)	NICOR (GAS)
--	--	-------------
- THE NOMINAL THICKNESS FOR HOT-MIX ASPHALT MATERIALS IS SHOWN ON THE TYPICAL SECTION, STANDARDS, SCHEDULES OR SPECIAL DETAILS. THE CONSTRUCTED THICKNESS OF THE ABOVE ITEM SHALL NOT BE LESS THAN 90% OF THE NOMINAL THICKNESS AT ANY LOCATION. DEVIATIONS FROM THE NORMAL THICKNESS WILL BE PERMITTED WHEN SUCH DEVIATIONS OCCUR DUE TO IRREGULARITIES IN THE EXISTING SURFACE OR BASE ON WHICH THE HOT-MIX ASPHALT IS PLACED.
- THE UTILITY LOCATIONS, IF MARKED ON THE PLANS, ARE FOR REFERENCE ONLY, AND ARE SHOWN FOR CONTRACTOR INFORMATIONAL USE ONLY, AND ARE NOT TO BE REFERENCED FOR CONSTRUCTION PURPOSES. THE IMPLIED PRESENCE OR ABSENCE OF UTILITIES IS NOT TO BE CONSTRUED BY THE OWNER, ENGINEER, CONTRACTOR, OR SUBCONTRACTORS TO BE AN ACCURATE AND COMPLETE REPRESENTATION OF UTILITIES THAT MAY OR MAY NOT EXIST ON THE CONSTRUCTION SITE.
- THE CONTRACTOR SHALL BE RESPONSIBLE FOR DETERMINING THE LOCATION AND ELEVATION OF ALL EXISTING UTILITIES AND TO NOTIFY ALL UTILITY COMPANIES PRIOR TO THE BEGINNING OF CONSTRUCTION. THE REROUTING, DISCONNECTION, PROTECTION, ETC. OF ANY UTILITIES MUST BE COORDINATED BETWEEN THE CONTRACTOR, UTILITY AND OWNER. SITE SAFETY, INCLUDING THE AVOIDANCE OF HAZARDS ASSOCIATED WITH BURIED AND ABOVE GROUND UTILITIES REMAINS THE SOLE RESPONSIBILITY OF THE CONTRACTOR. THIS WILL BE CONSIDERED INCIDENTAL TO THE CONTRACT.
- ALL DISTURBED AREAS WITHIN THE RIGHT-OF-WAY SHALL BE SEEDED, FERTILIZED, AND MULCHED AS SHOWN IN THE PLANS AND AS DIRECTED BY THE ENGINEER.
- ANY EXISTING ROAD SIGNS THAT INTERFERE WITH CONSTRUCTION WILL BE REMOVED OR RELOCATED AS DIRECTED BY THE ENGINEER. AFTER THE CONSTRUCTION IS COMPLETED, THE CONTRACTOR WILL REPLACE THE SIGNS AS DIRECTED BY THE ENGINEER. THIS WORK WILL NOT BE PAID FOR SEPERATELY BUT SHALL BE INCLUDED IN THE CONTRACT AND NO ADDITIONAL COMPENSATION WILL BE ALLOWED.
- A 4" LINE WIDTH HAS BEEN USED FOR ALL PAVEMENT MARKING REMOVAL QUANTITY CALCULATIONS.

SUMMARY OF QUANTITIES

CODE NUMBER	ITEM	UNIT	TOTAL QUANTITY	SPECIAL PROVISION
20200500	EARTH EXCAVATION (WIDENING)	CU YD	134	*
20200600	EXCAVATING AND GRADING EXISTING SHOULDERS	UNIT	1.2	
35600708	HOT-MIX ASPHALT BASE COURSE WIDENING, 8"	SQ YD	635	*
40200800	AGGREGATE SURFACE COURSE, TYPE B	TON	100	
40600290	BITUMINOUS MATERIALS (TACK COAT)	POUND	20,710	*
40600625	LEVELING BINDER (MACHINE METHOD), N50	TON	857	*
40600982	HOT-MIX ASPHALT SURFACE REMOVAL - BUTT JOINT	SQ YD	168	*
40600990	TEMPORARY RAMP	SQ YD	17	
40603080	HOT-MIX ASPHALT BINDER COURSE, IL-19.0, N50	TON	3,800	*
40603510	POLYMERIZED HOT-MIX ASPHALT SURFACE COURSE, MIX "C", N50	TON	1,975	*
40800029	BITUMINOUS MATERIALS (TACK COAT)	POUND	366	*
40800050	INCIDENTAL HOT-MIX ASPHALT SURFACING	TON	226	*
48100100	AGGREGATE SHOULDERS, TYPE A	TON	3,500	*
48203029	HOT-MIX ASPHALT SHOULDERS, 8"	SQ YD	54	*
67100100	MOBILIZATION	L SUM	1	
70300100	SHORT TERM PAVEMENT MARKING	FOOT	1,120	
△ 78001110	PAINT PAVEMENT MARKING - LINE 4"	FOOT	6,434	
△ 78001180	PAINT PAVEMENT MARKING - LINE 24"	FOOT	52	
X0327979	PAVEMENT MARKING REMOVAL - GRINDING	SQ FT	2,059	*
X7010216	TRAFFIC CONTROL AND PROTECTION, (SPECIAL)	L SUM	1	*

20076600 Trainees Hour 500 * #
 20076604 Trainees Training Program Graduate Hour 500 * #

#0042
 △ SPECIALTY ITEMS

TRAFFIC CONTROL AND PROTECTION

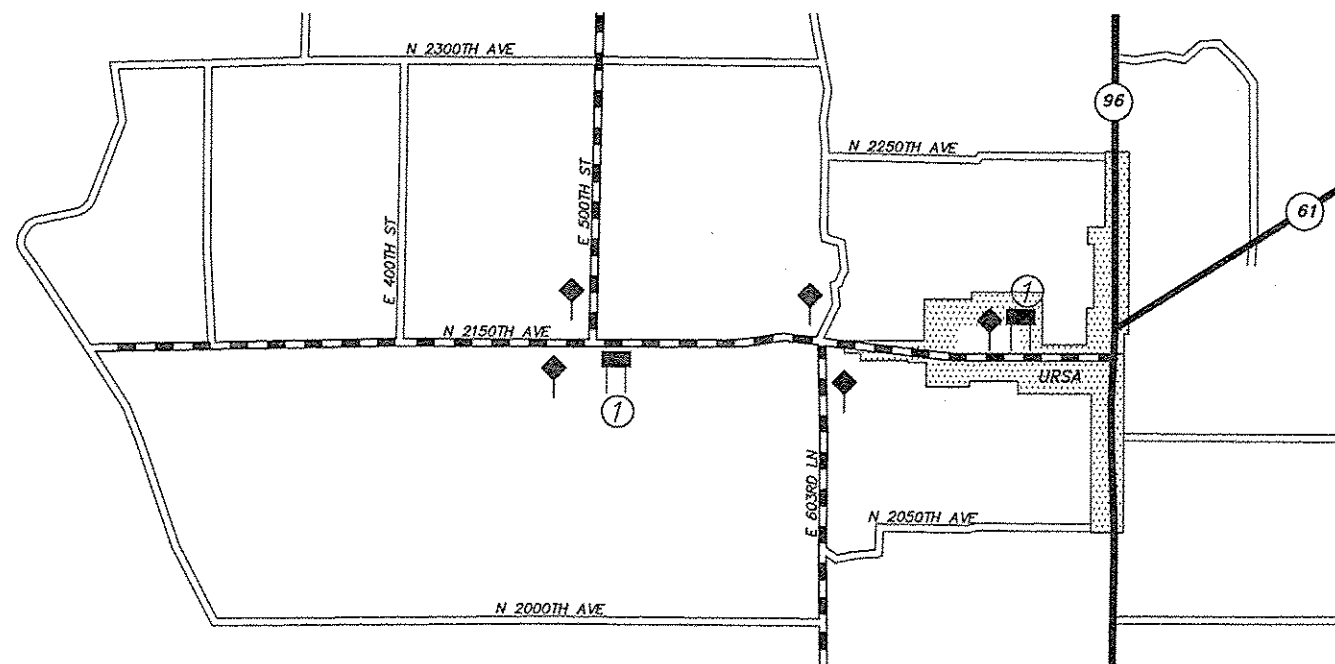

① G20-1(0)-6036 SIGN
 G20-2a(0)-6024 SIGN (OPPOSITE)
 ◆ ROAD CONSTRUCTION AHEAD
 SEE SPECIAL PROVISIONS FOR APPLICATION OF:
 "NO PASSING ZONES NOT STRIPPED NEXT ____ MILES"

CONTRACT NO. 93700			
COUNTY	ROUTE	SECTION	SHT. NO.
ADAMS	FAS 1600 FAS 1601	16-00073-01-FP	4
QUANTITY SCHEDULES		APPLICATION RATES	
HOT-MIX ASPHALT MIXTURE REQUIREMENTS			

EARTH EXCAVATION + WIDENING

LOCATION / STA. - STA.	EARTH EXCAVATION (WIDENING)	EXCAVATING AND GRADING SHOULDERS
	CU YD	UNIT
RT. STA. 41+21 - 49+78	35	
LT. STA. 51+11 - 64+49	62	
RT. STA. 72+73 - 80+97	37	
RT. STA. 81+81 - 83+01		1.2
TOTAL	134	1.2

PAVEMENT SCHEDULE

LOCATION / STA. - STA.	HOT-MIX ASPHALT BASE COURSE WIDENING, 8"	BITUMINOUS MATERIALS (TACK COAT)	LEVELING BINDER (MACHINE METHOD), N50	HOT-MIX ASPHALT BINDER COURSE, IL-19.0, N50	POLYMERIZED HOT-MIX ASPHALT SURFACE COURSE, MIX "C", N50	AGGREGATE SHOULDERS, TYPE A	HOT-MIX ASPHALT SHOULDERS, 8"
	SQ YD	POUND	TON	TON	TON	TON	SQ YD
STA. 1+00 - 112+50		18,160		3,710	1,884	3,500	
STA. 40+00 - 41+21		65	12				
STA. 41+21 - 49+77.75**	190	475	171				
STA. 49+77.75 - 51+10.97		70	13				
STA. 51+10.97 - 64+49.31**	278	735	484				
STA. 64+49.31 - 72+00		410	77				
STA. 72+72.96 - 80+97.41**	167	225	75				
RT. STA. 81+81 - 83+01							54
STA. 106+64.47 - 111+30.04**		120	25				
STA. 372+52 - 373+41.2		450		90	53		
TOTAL	635	20,710	857	3,800	1,975	3,500	54

** - HORIZONTAL CURVE SUPERELEVATION CORRECTION

HMA SURFACE REMOVAL - BUTT JOINT

LOCATION / STA. - STA.	HOT-MIX ASPHALT SURFACE REMOVAL - BUTT JOINT	TEMPORARY RAMP
	SQ. YD.	SQ. YD.
112+25 - 112+50	58	7
370+52 - 370+77	61	10
LT. STA. 82+41	49	
TOTAL	168	17

PAVEMENT MARKINGS

LOCATION / STA. - STA.	PAVEMENT MARKING REMOVAL	PAINT PAVEMENT MARKING - LINE 4" (YELLOW)	PAINT PAVEMENT MARKING - LINE 24" (WHITE)	SHORT TERM PAVEMENT MARKING
	SC	FOOT	FOOT	FOOT
STA. 1+00 - 112+50	2,046	6,254		1,120
STA. 370+52 - 372+52.23	13	180	18	
CH 7 RT. STA. 68+79			34	
TOTAL	2,059	6,434	52	1,120

APPLICATION RATES

BITUMINOUS MATERIALS (TACK COAT)	
ON EXISTING PAVEMENT	0.05 LB/SQ FT
BETWEEN HMA LIFTS	0.025 LB/SQ FT
AGGREGATE (SURFACE, SHOULDERS)	1.8 TON/CU YD

HOT-MIX ASPHALT MIXTURE REQUIREMENTS

PAY ITEM	MIXTURE	ASPHALT GRADE	N Desgn	VOIDS
HOT-MIX ASPHALT BASE COURSE WIDENING	IL-19.0	PG 64-22	N50	4.0%
HOT-MIX ASPHALT SHOULDERS	IL-19.0	PG 64-22	N50	4.0%
LEVELING BINDER, MACHINE METHOD	IL-9.5	PG 64-22	N50	4.0%
HOT-MIX ASPHALT BINDER COURSE	IL-19.0	PG 64-22	N50	4.0%
HOT-MIX ASPHALT SURFACE COURSE	IL-9.5 "C"	PG 64-22	N50	4.0%
POLY. HOT-MIX ASPHALT SURFACE COURSE	IL-9.5 "C"	SBS PG 64-28	N50	4.0%

NOTE: HOT-MIX ASPHALT QUANTITIES CALCULATED @ 112 #/SQ. YD. / IN.

INCIDENTAL PAVING SCHEDULE (SIDE ROADS)

LOCATION / STA. - STA.	BITUMINOUS MATERIALS (PRIME COAT)	INCIDENTAL HOT-MIX ASPHALT BINDER	INCIDENTAL HOT-MIX ASPHALT SURFACE
	POUND	TON	
TR 22 - LT. STA. 68+98	160	26	31
CH 7 - RT. STA. 68+98	105	19	22
TOTAL	265	45	53

INCIDENTAL PAVING SCHEDULE (ENTRANCES)

LOCATION / STA. - STA.	BITUMINOUS MATERIALS (PRIME COAT)	INCIDENTAL HOT-MIX ASPHALT BINDER	INCIDENTAL HOT-MIX ASPHALT SURFACE	AGGREGATE SURFACE CSE, TYPE B
	POUND	TON		
RT. STA. 28+88	15	3	2	3
RT. STA. 57+81	25	5	3	5
LT. STA. 57+97	16	13	2	12
RT. STA. 79+88	3	2	1	
LT. STA. 82+41	33	4	4	
RT. STA. 83+58	13	3	1	2
RT. STA. 94+89	15	4	2	3
RT. STA. 95+42	11	3	1	3
RT. STA. 102+99	12	3	1	
LT. STA. 103+22	12	3	2	2
RT. STA. 107+08	50	21	5	40
RT. STA. 108+43	10	2	1	
RT. STA. 109+08	13	3	1	
RT. STA. 109+98	32	11	4	27
LT. STA. 111+66	10	3	1	3
TOTAL	270	83	31	100

INCIDENTAL PAVING SCHEDULE (MAILBOX TURNOUT)

LOCATION / STA. - STA.	BITUMINOUS MATERIALS (TACK COAT)	INCIDENTAL HOT-MIX ASPHALT BINDER	INCIDENTAL HOT-MIX ASPHALT SURFACE
	POUND	TON	TON
RT. STA. 29+07	6	2	1
RT. STA. 79+79	2	1	1
RT. STA. 83+68	6	2	1
RT. STA. 95+14	9	2	1
RT. STA. 102+74	8	2	1
TOTAL	31	9	5

CONTRACT NO. 93700

COUNTY	ROUTE	SECTION	SHT. NO.
ADAMS	FAS 1800 FAS 1801	16-00073-01-FP	6
STA. 90+00 TO STA. 120+00			

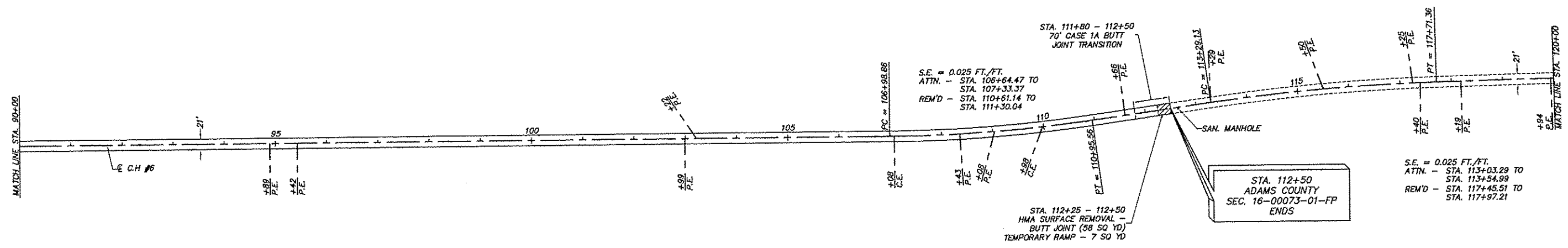

S.E. = 0.025 FT./FT.
 ATTN. - STA. 106+64.47 TO
 STA. 107+33.37
 REM'D - STA. 110+61.14 TO
 STA. 111+30.04

STA. 112+25 - 112+50
 HMA SURFACE REMOVAL -
 BUTT JOINT (58 SQ YD)
 TEMPORARY RAMP - 7 SQ YD

STA. 112+50
 ADAMS COUNTY
 SEC. 16-00073-01-FP
 ENDS

S.E. = 0.025 FT./FT.
 ATTN. - STA. 113+03.29 TO
 STA. 113+54.99
 REM'D - STA. 117+45.51 TO
 STA. 117+97.21

COUNTY	ROUTE	SECTION	SHT. NO.
ADAMS	FAS 1600 FAS 1601	16-00073-01-FP	7

PAVEMENT MARKINGS

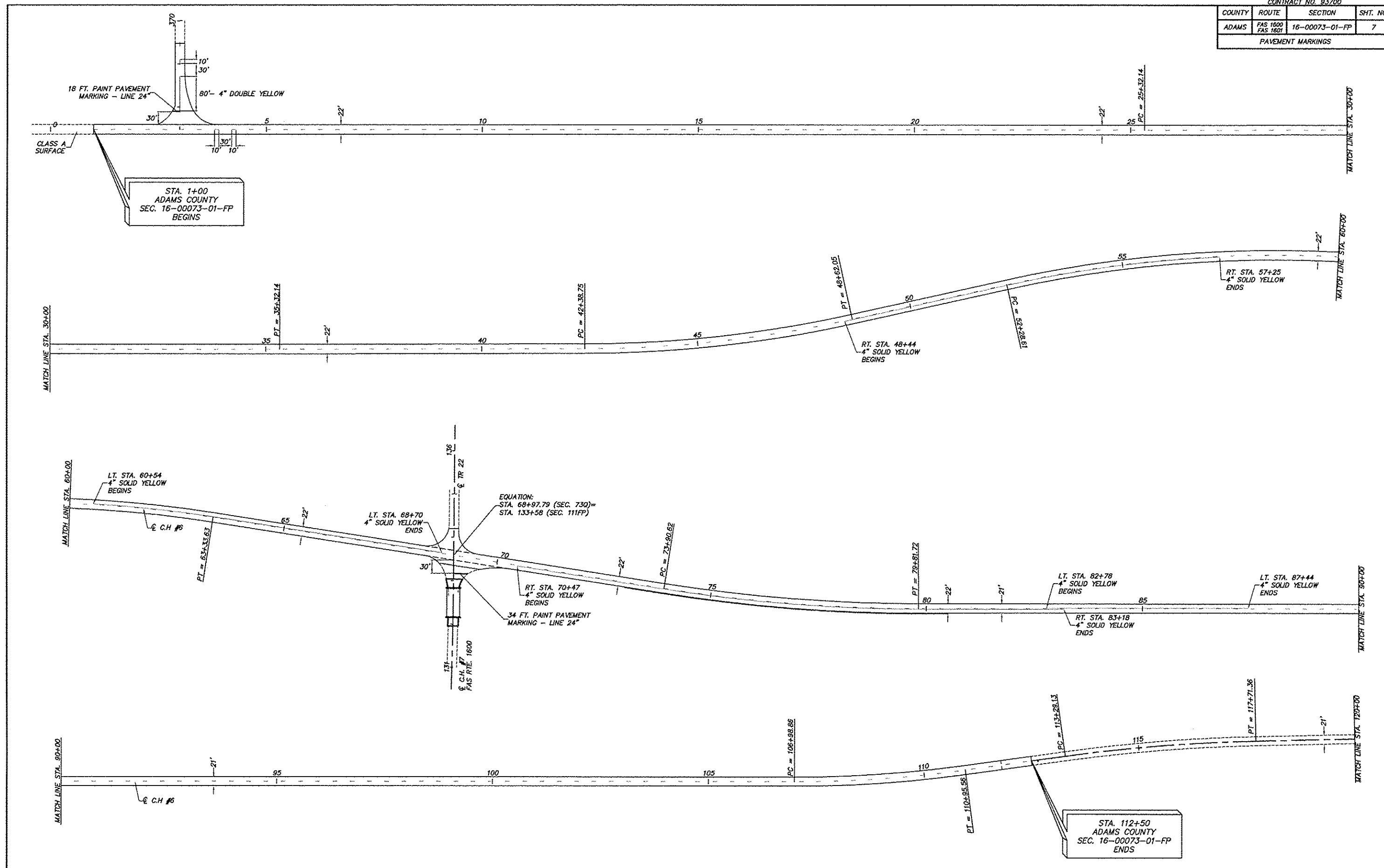

STA. 1+00
ADAMS COUNTY
SEC. 16-00073-01-FP
BEGINS

STA. 112+50
ADAMS COUNTY
SEC. 16-00073-01-FP
ENDS

CONTRACT NO. 93700			
COUNTY	ROUTE	SECTION	SHT. NO.
ADAMS	FAS 1600 FAS 1601	16-00073-01-FP	8
ENTRANCE PAVING DETAILS			

INTERSECTION DETAIL

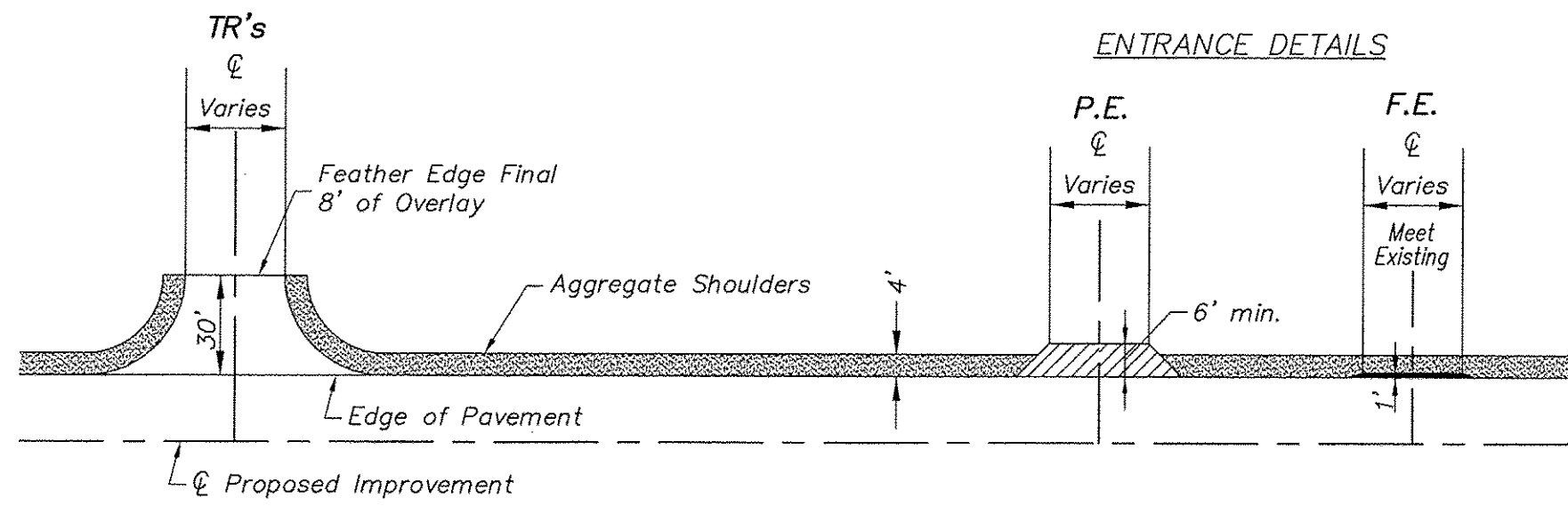

ENTRANCE DETAILS

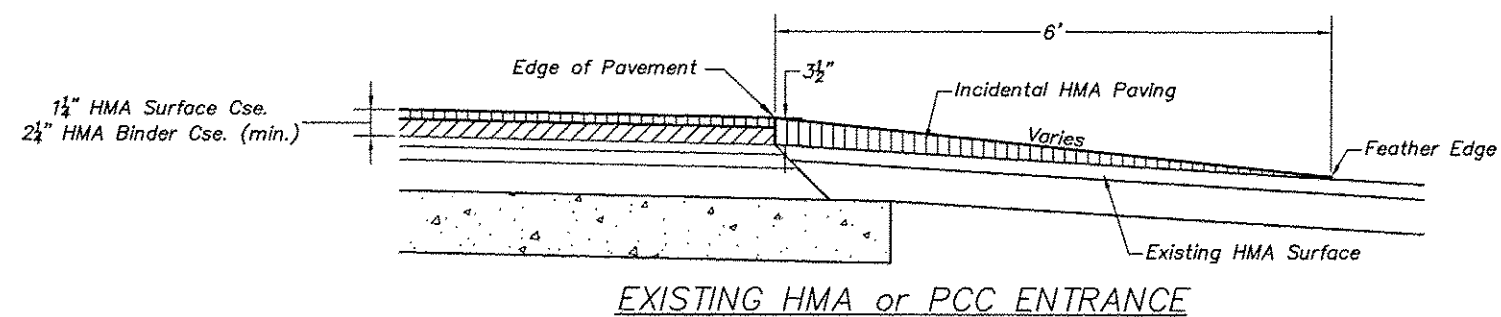

EXISTING HMA or PCC ENTRANCE

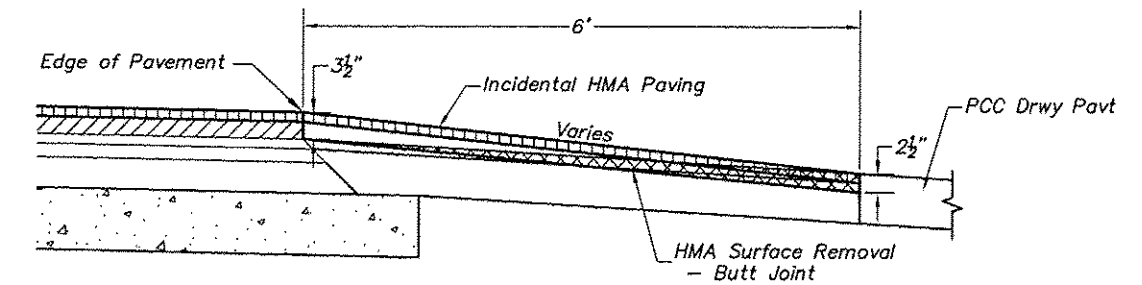

HOT-MIX ASPHALT SURFACE REMOVAL - BUTT JOINT
RT. STA. 82+41

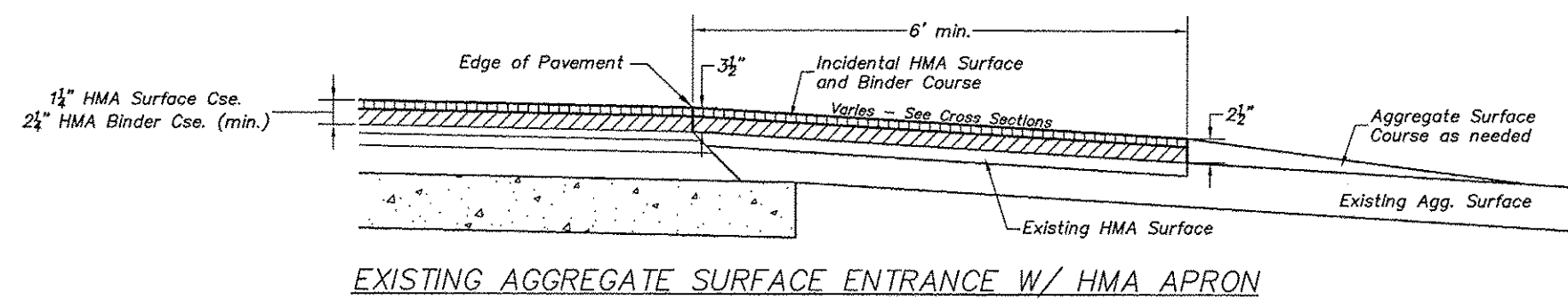

EXISTING AGGREGATE SURFACE ENTRANCE W/ HMA APRON

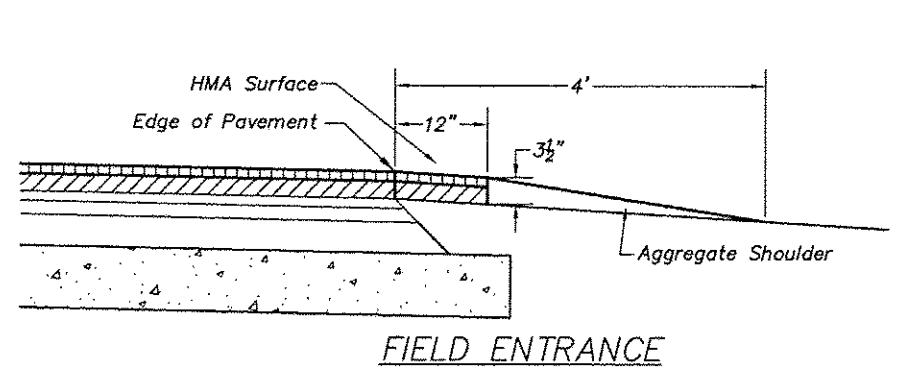

FIELD ENTRANCE

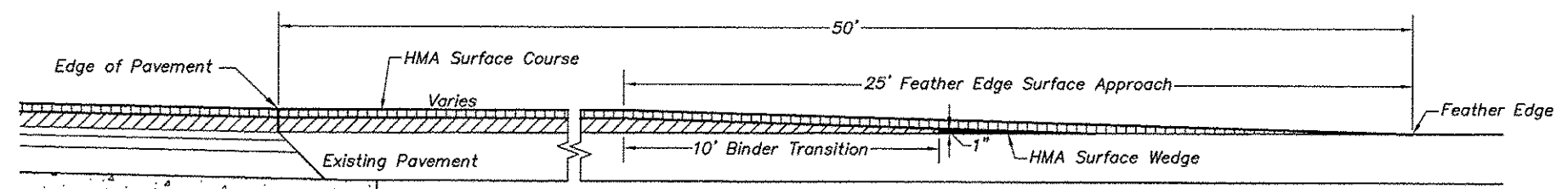

EXISTING SIDE ROADS
TR 22

ENTRANCES

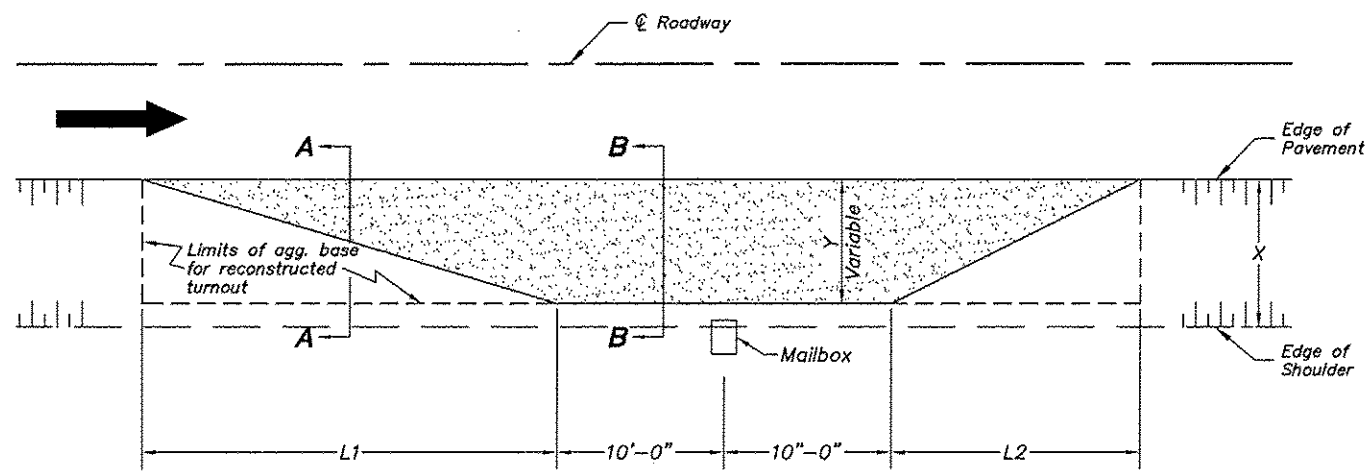

TYPICAL APPLICATION

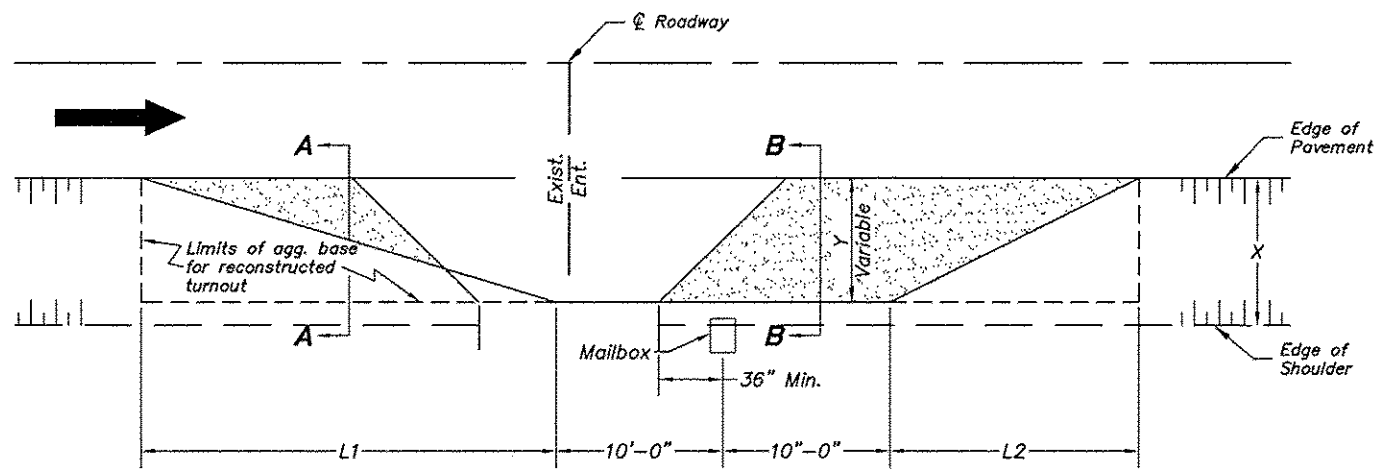

MAILBOX ON FAR SIDE OF ENTRANCE

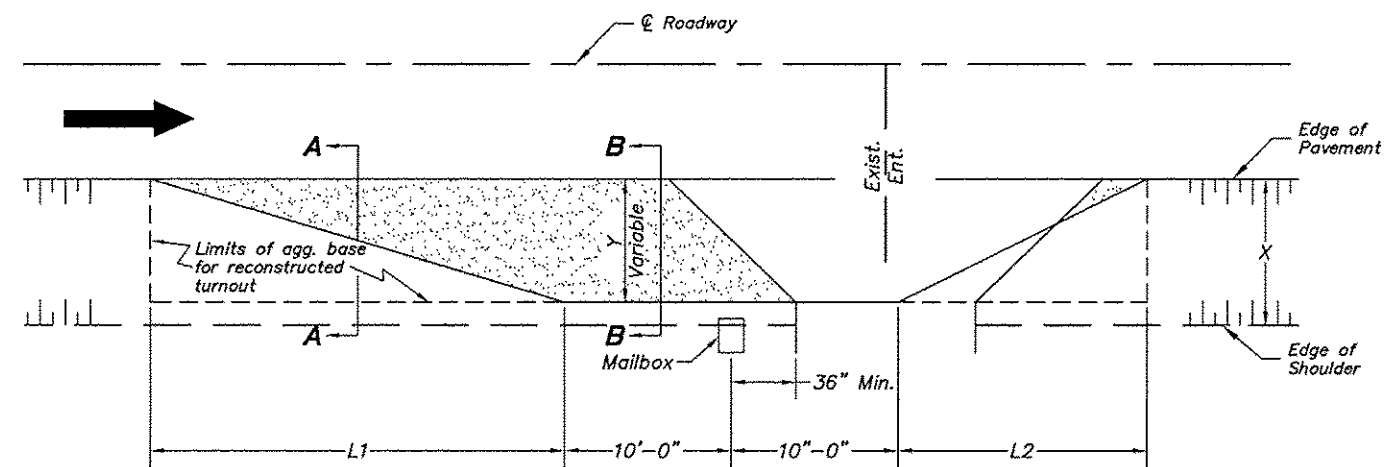

MAILBOX ON NEAR SIDE OF ENTRANCE

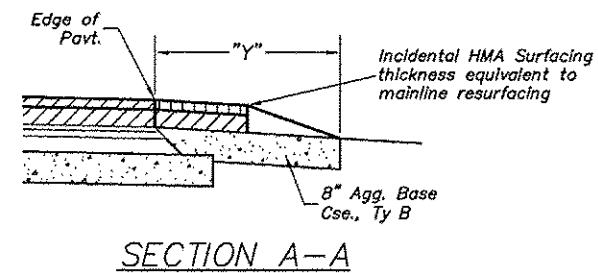

SECTION A-A

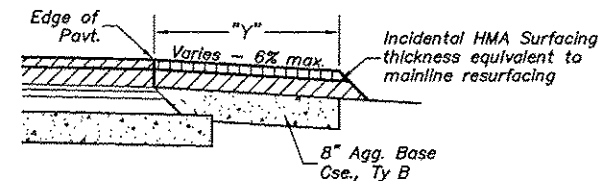

SECTION B-B

RECONSTRUCTED TURNOUTS

DIMENSIONS - ft.						
Width of Shoulder (X)	12	10	8	6	5	4
Width of Turnout (Y)	8	8	6	4	4	4
L1	30	30	23	15	15	15
L2	20	20	15	10	10	10

GENERAL NOTES:

The Engineer reserves the right to alter the placement of the mailbox turnout to match existing conditions and utilize the entrance as part of the taper.

Mailboxes shall be mounted such that the face of the mailbox is 6" to 12" and the post a minimum of 24" from the edge of the turnout surfacing.

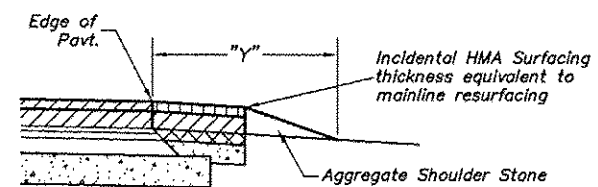

SECTION A-A

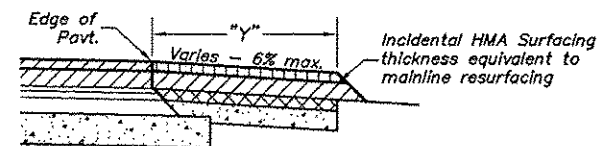

SECTION B-B

RESURFACED TURNOUTS

MAILBOX TURNOUTS

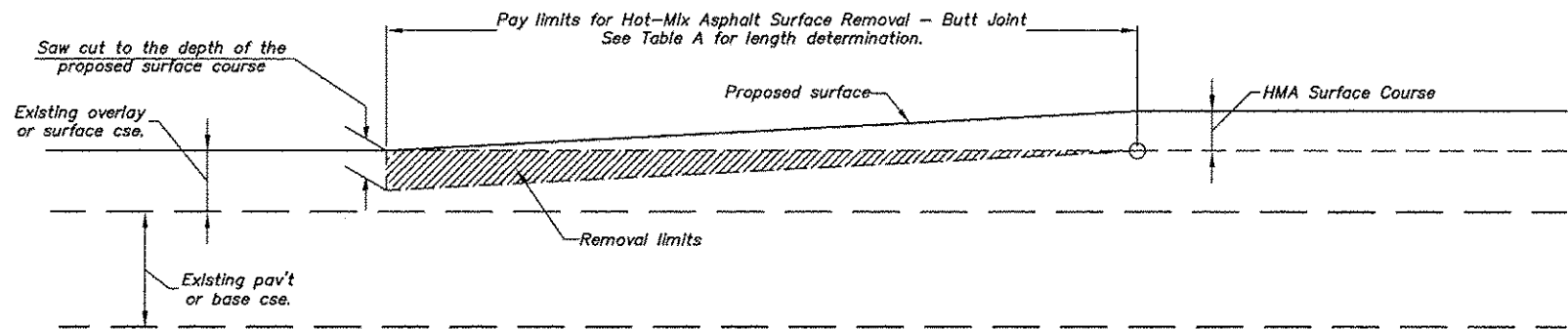

CASE 1: BUTT JOINT w/ SURFACE OVERLAY

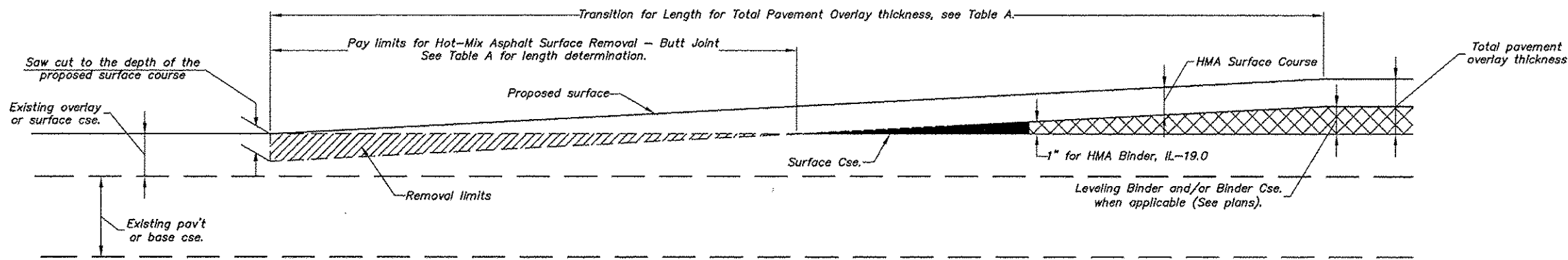

CASE 1A: BUTT JOINT w/ SURFACE & BINDER OVERLAY

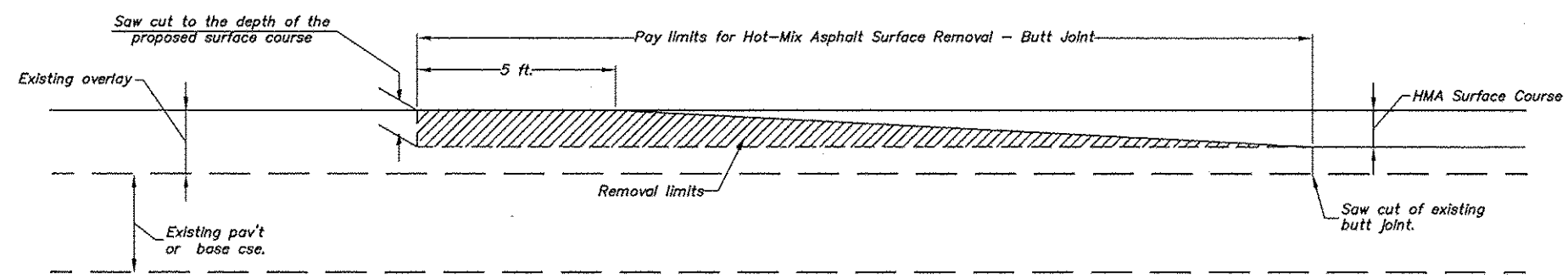

CASE 1B: BUTT JOINT w/ SURFACE OVERLAY TIE-IN TO EXISTING BUTT JOINT

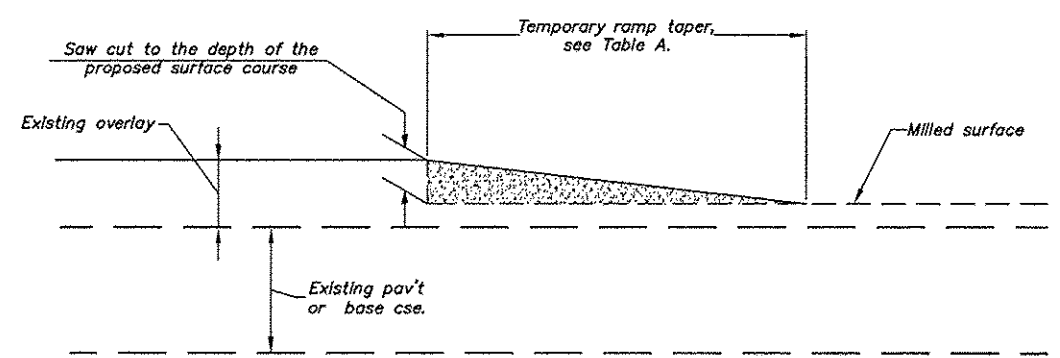

TEMPORARY RAMP DETAIL

General Notes

1. The work shall be done in accordance with Article 406.08 and the Special Provision for Butt Joints.
2. The pavement surface to be removed may be either HMA or P.C. concrete. The work shall be performed in accordance with Article 440.04 and the Special Provisions for Butt Joints.
3. The saw cut joints shall be primed just prior to the placing of HMA material. The work will be in accordance with the applicable portions of Article 406.05.

TABLE A - TAPER RATES

ELEMENT	POSTED SPEED < 45 MPH	POSTED SPEED ≥ 45 MPH
BUTT JOINT	20' per 1" of DEPTH	30' per 1" of DEPTH
FEATHEREDGE	20' per 1" of THICKNESS	30' per 1" of THICKNESS LESS 3/8" from TOTAL
TEMPORARY RAMP	3' per 1" of HEIGHT	4' per 1" of DEPTH

Length of Butt Joint = Thickness of Surface Cse multiplied by the Taper Rate.
 Length of Pav't Transition = Total Pav't thickness multiplied by the Taper Rate.

**BUTT JOINTS
FEATHER-EDGE TRANSITION**

CONTRACT NO. 93700			
COUNTY	ROUTE	SECTION	SHT. NO.
ADAMS	FAS 1600 FAS 1601	16-00073-01-FP	11
BUTT JOINT DETAILS			

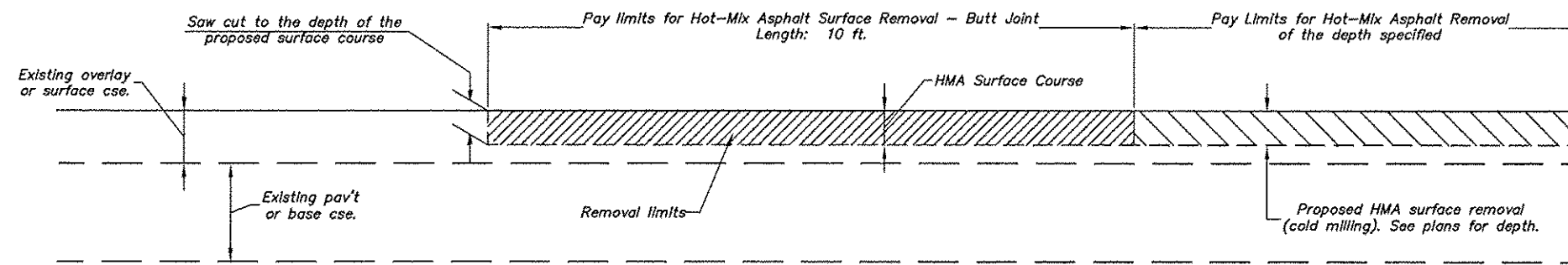

CASE 2: BUTT JOINT & SURFACE REMOVAL w/ RESURFACING

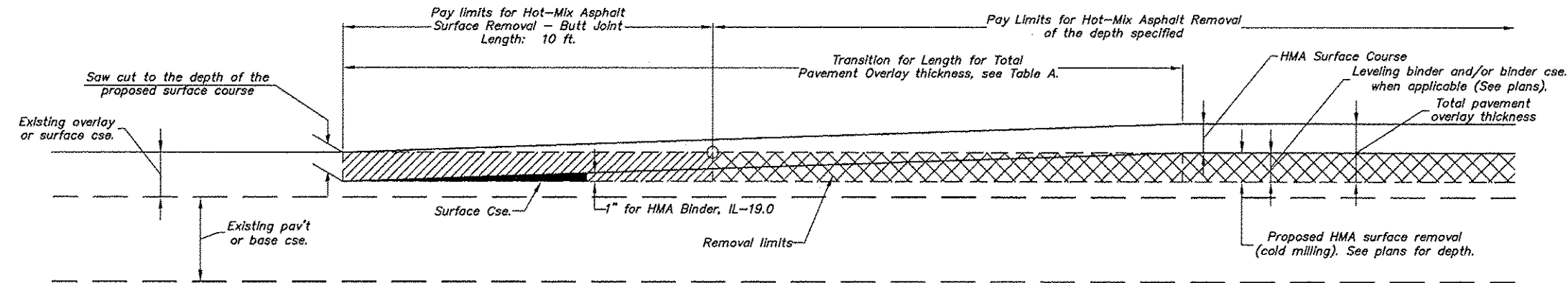

CASE 2A: BUTT JOINT & SURFACE REMOVAL w/ BINDER & RESURFACING

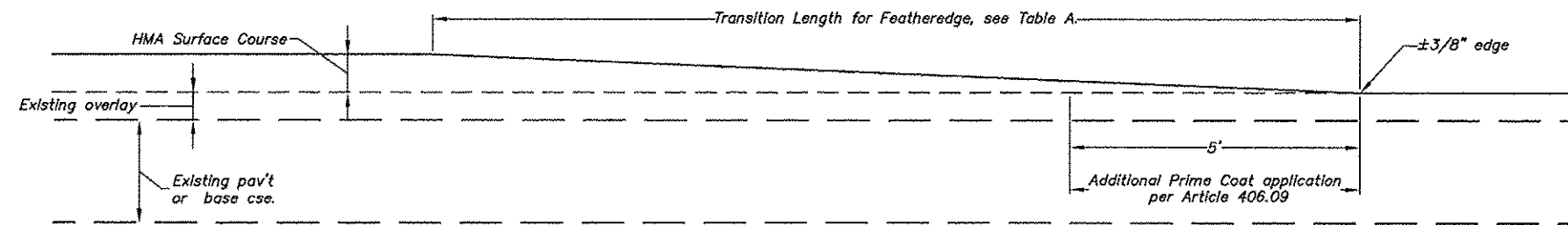

FEATHEREDGE APPROACH - SURFACE CSE

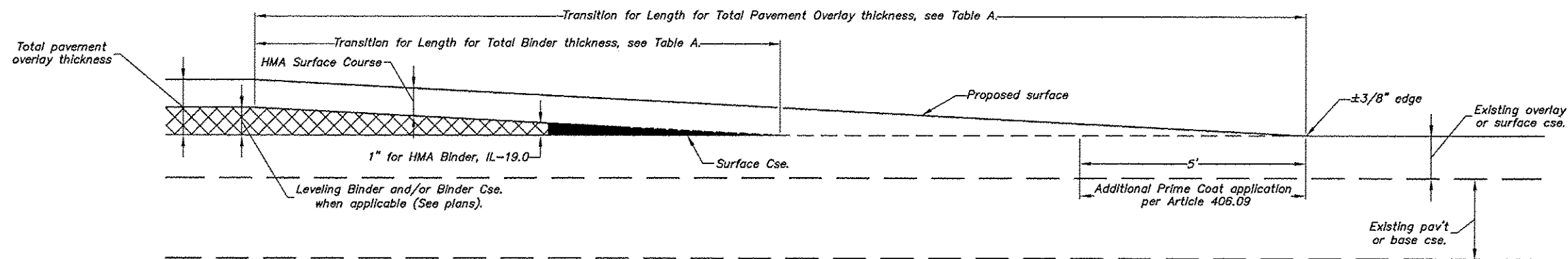

FEATHEREDGE APPROACH - SURFACE & BINDER CSE

**BUTT JOINTS
FEATHER-EDGE TRANSITION**

COUNTY	ROUTE	SECTION	SHT. NO.
ADAMS	FAS 1600 FAS 1801	16-00073-01-FP	12

STA. 6+00 TO STA. 48+02.75

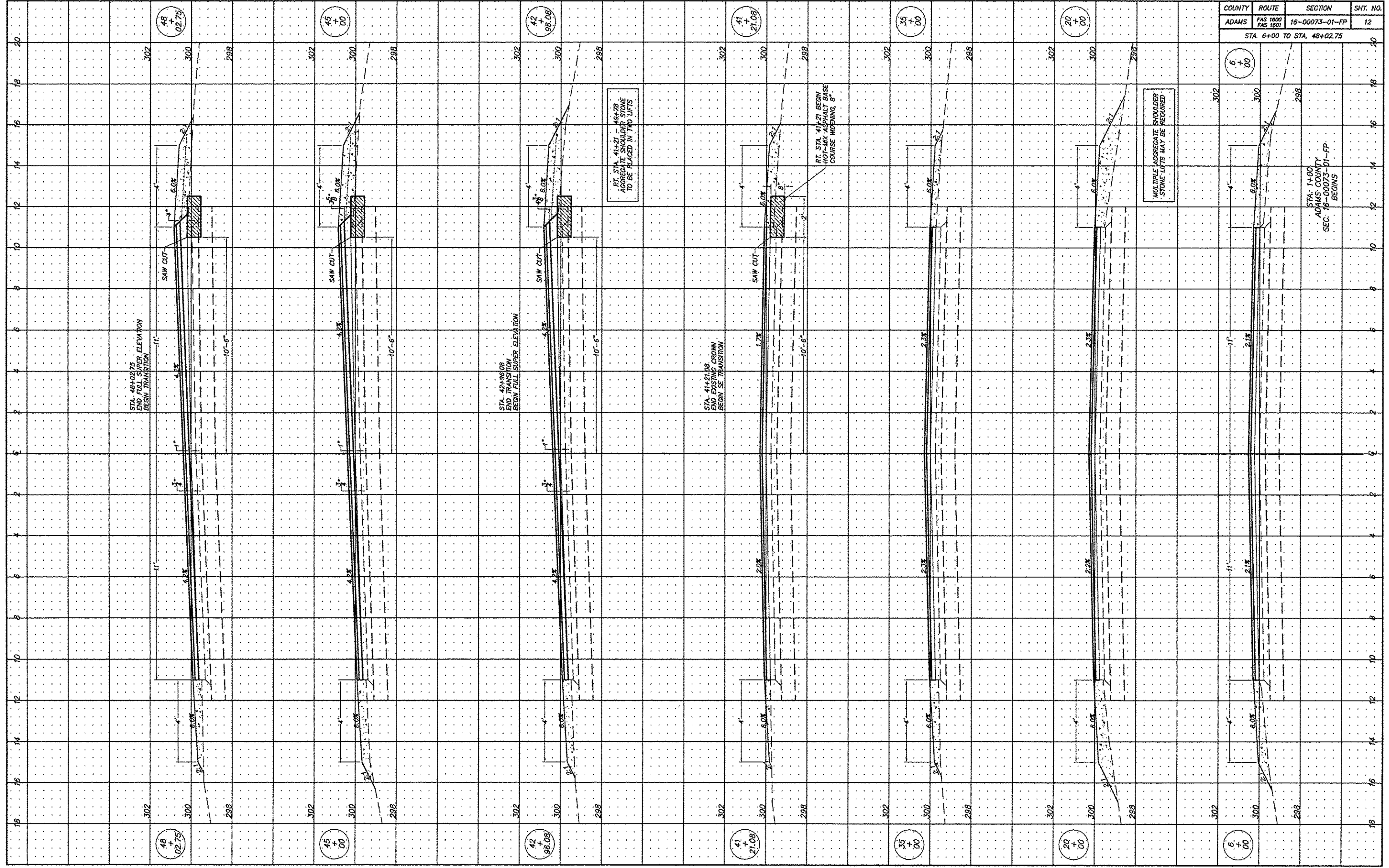

STA. 1+00
ADAMS COUNTY
SEC. 16-00073-01-FP
BEGINS

MULTIPLE AGGREGATE SHOULDER
STONE LIFTS MAY BE REQUIRED

RT. STA. 41+21 - 46+78
AGGREGATE SHOULDER STONE
TO BE PLACED IN TWO LIFTS

RT. STA. 41+21 BEGN.
HOT-MIX ASPHALT BASE
COURSE WIDENING, 8"

COUNTY	ROUTE	SECTION	SHT. NO.
ADAMS	FAS 1800 FAS 1807	16-00073-01-FP	13

STA. 49+77.75 TO STA. 60+00

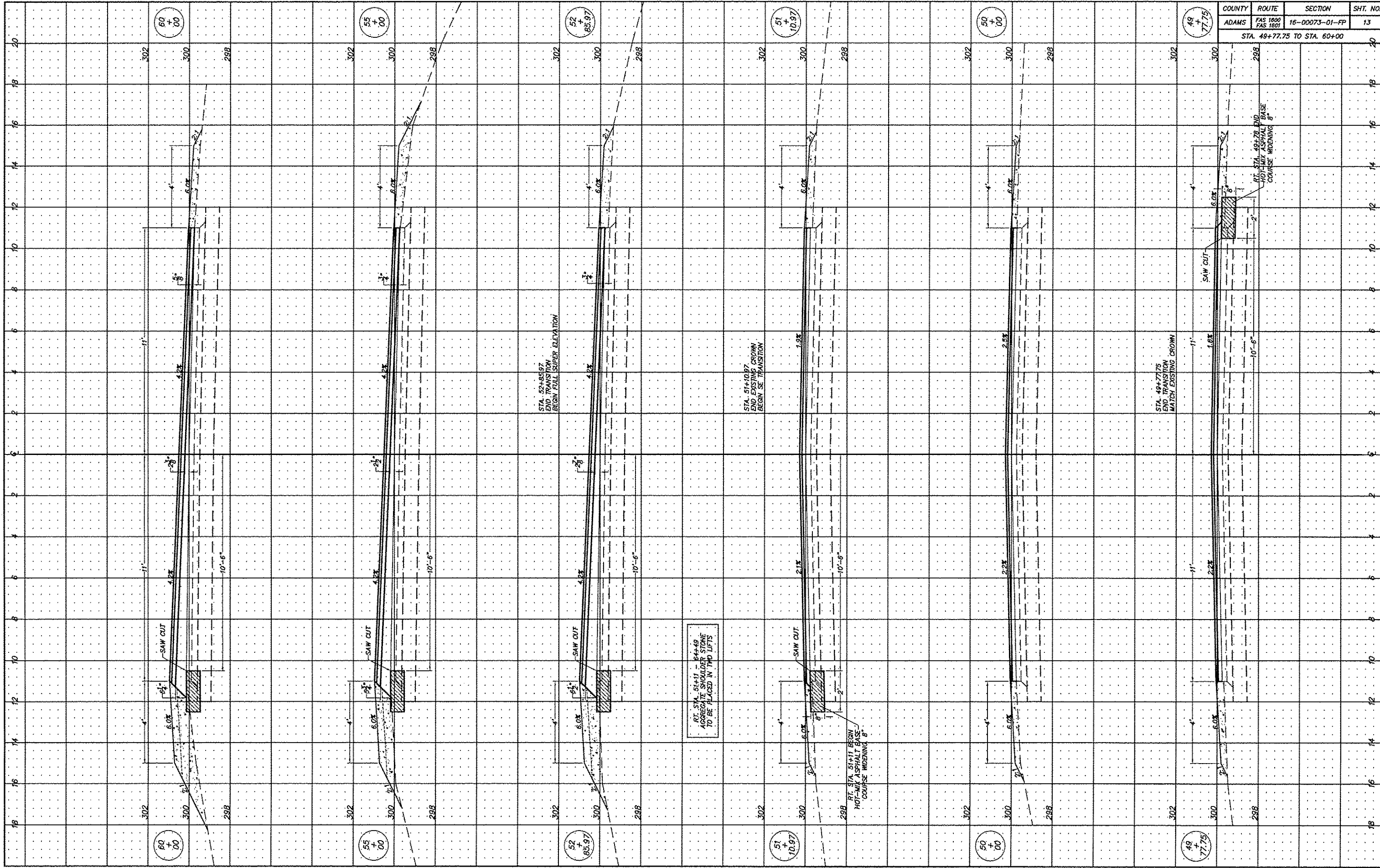

STA. 52+95.97
END TRANSITION
BEGIN FULL SUPER ELEVATION

STA. 51+10.97
END EXISTING CROWN
BEGIN SE TRANSITION

RT. STA. 54+11 - 54+49
AGGREGATE SHOULDER STONE
TO BE PLACED IN TWO LIFTS

RT. STA. 57+51+11 BEGIN
HOT MIX ASPHALT BASE
COURSE WIDENING 8'

STA. 49+77.75
END TRANSITION
MATCH EXISTING CROWN

RT. STA. 49+77.75 END
HOT MIX ASPHALT BASE
COURSE WIDENING 8'

COUNTY	ROUTE	SECTION	SHT. NO.
ADAMS	FAS 1600 FAS 1601	16-00073-01-FP	14

STA. 62+74.31 TO STA. 79+22.41

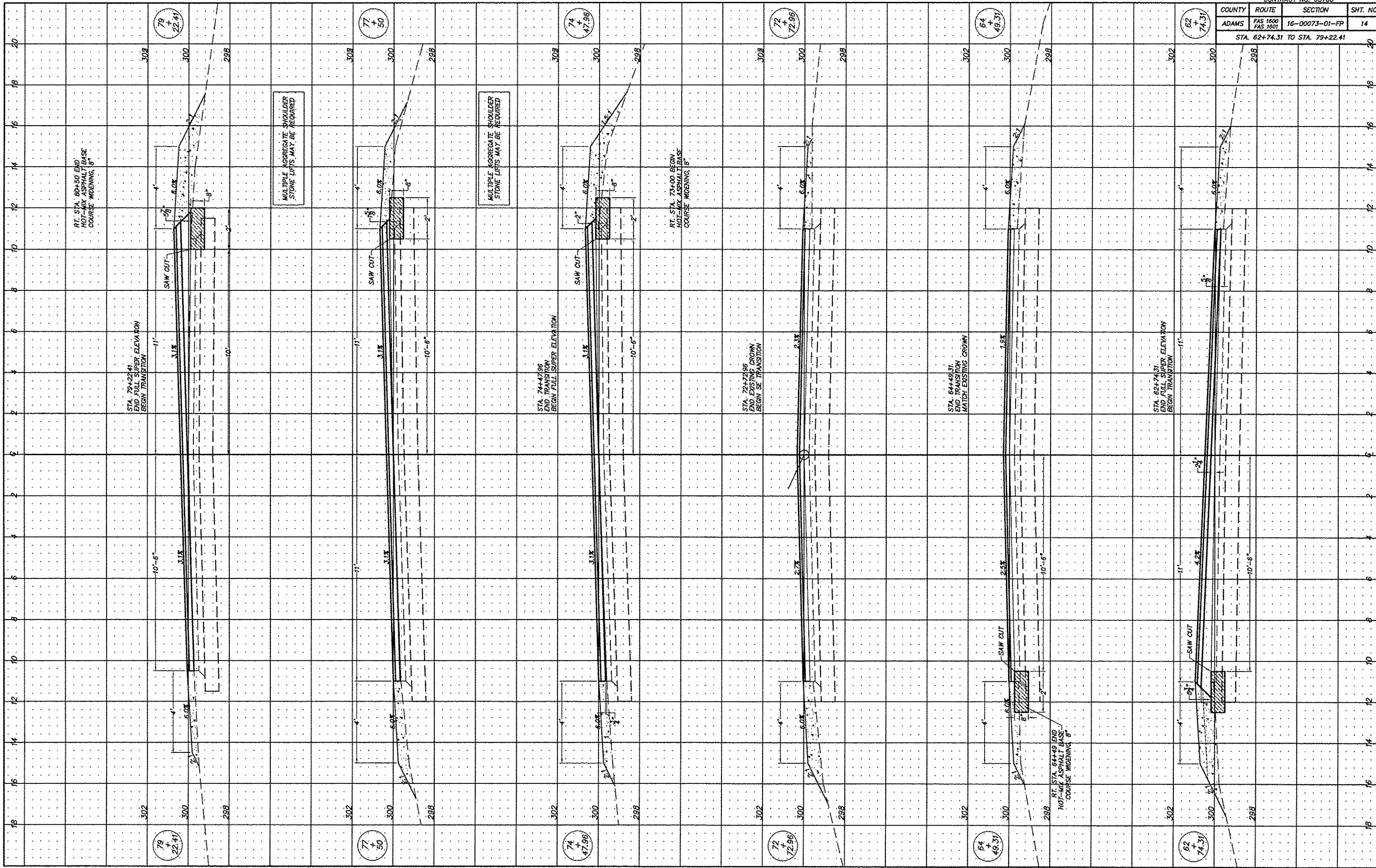

COUNTY	ROUTE	SECTION	SHT. NO.
ADAMS	FAS 1600 FAS 1601	16-00073-01-FP	15

STA. 80+97.41 TO STA. 100+00

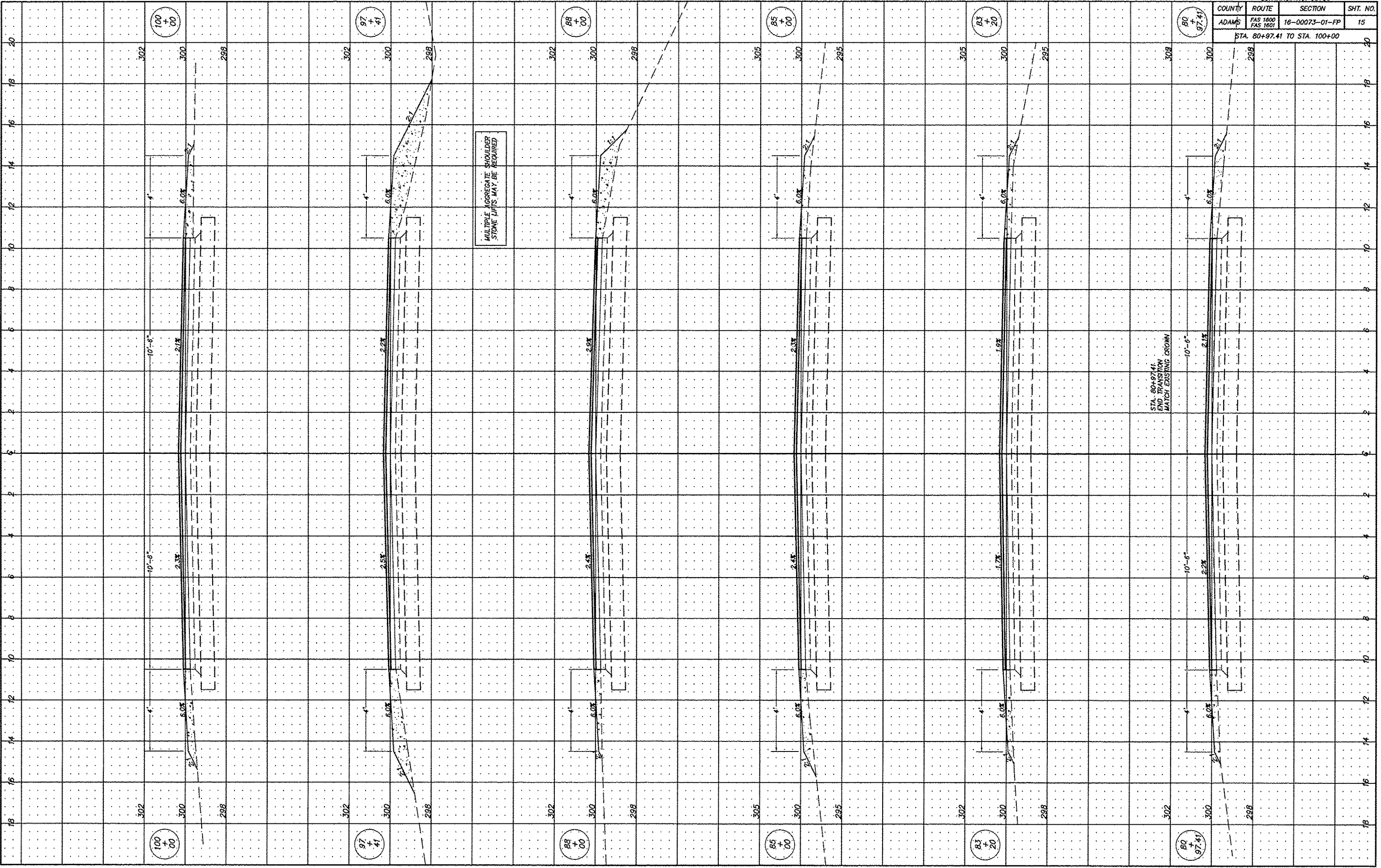

COUNTY	ROUTE	SECTION	SHT. NO.
ADAMS	FAS 1600 FAS 1601	16-00073-01-FP	16

STA. 101+03 TO STA. 112+75

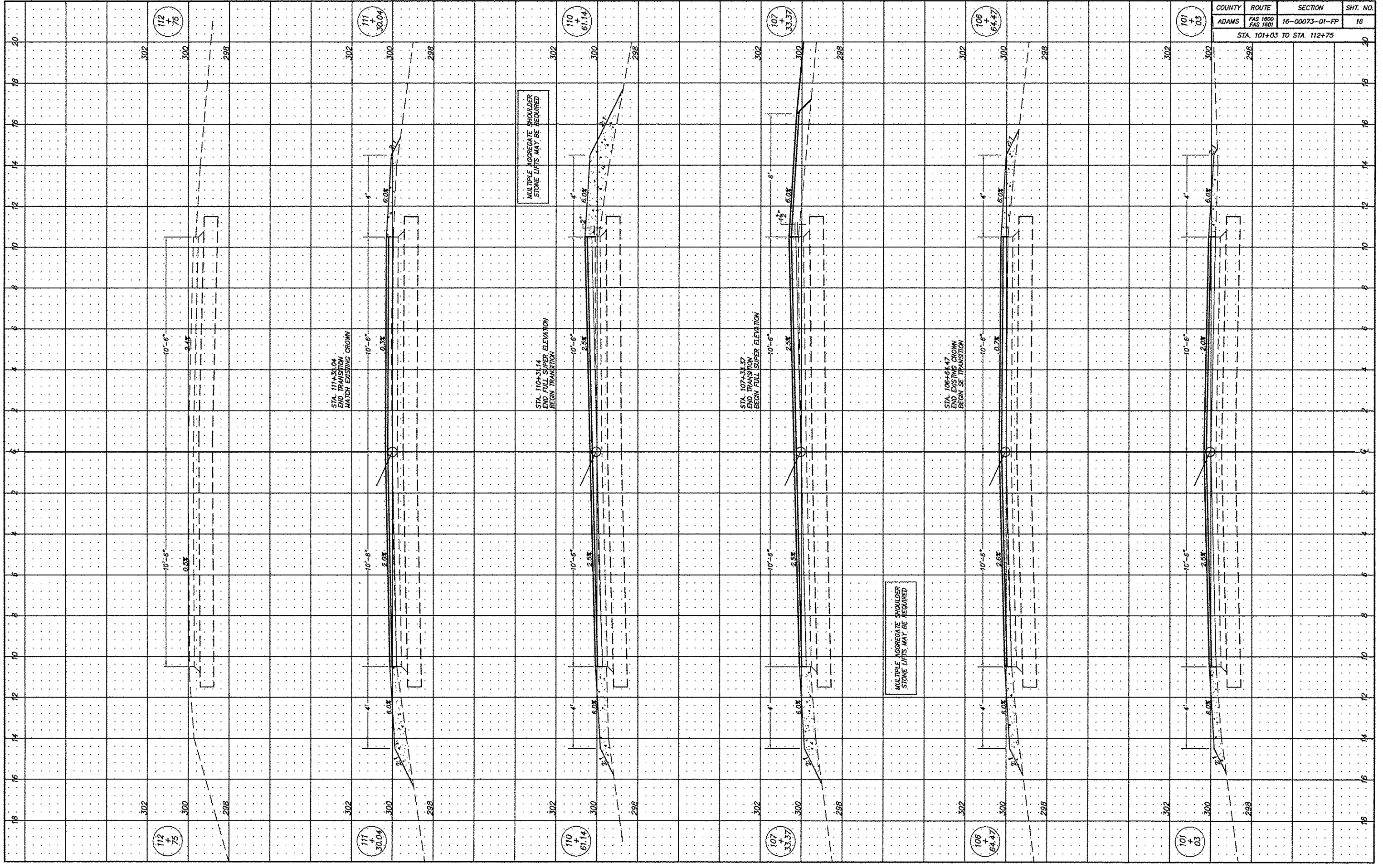

COUNTY	ROUTE	SECTION	SHT. NO.
ADAMS	FAS 1800 FAS 1801	16-00073-01-FP	17

STA. 57+81 TO STA. 108+43

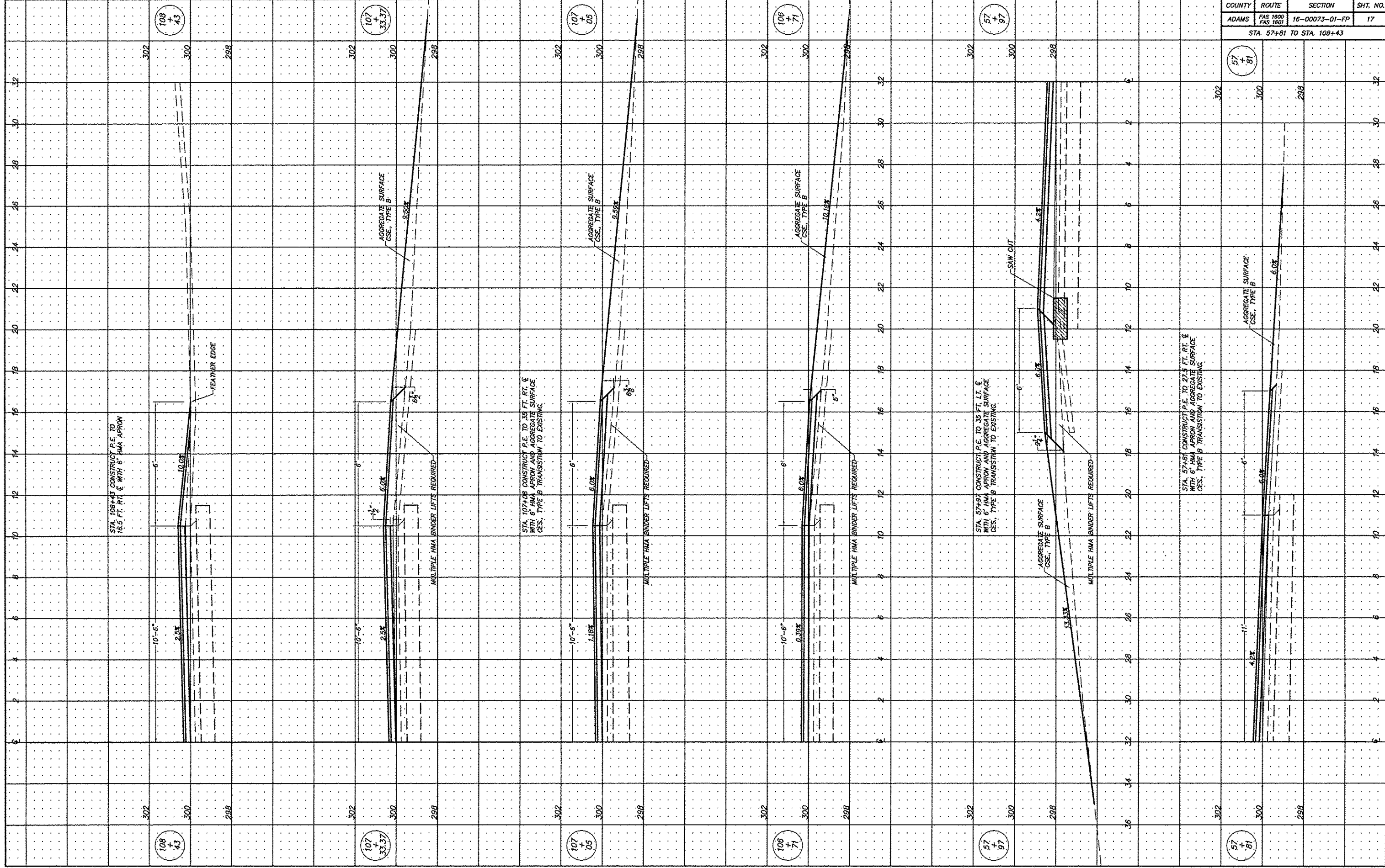

STA. 108+43 CONSTRUCT P.E. TO 16.5 FT. RT. & WITH 6" HMA APRON

STA. 107+05 CONSTRUCT P.E. TO 35 FT. RT. & WITH 6" HMA APRON AND AGGREGATE SURFACE CSE, TYPE B TRANSITION TO EXISTING.

STA. 57+97 CONSTRUCT P.E. TO 35 FT. LT. & WITH 6" HMA APRON AND AGGREGATE SURFACE CSE, TYPE B TRANSITION TO EXISTING.

STA. 57+81 CONSTRUCT P.E. TO 27.5 FT. RT. & WITH 6" HMA APRON AND AGGREGATE SURFACE CSE, TYPE B TRANSITION TO EXISTING.

FEATHER EDGE

AGGREGATE SURFACE CSE, TYPE B

AGGREGATE SURFACE CSE, TYPE B

AGGREGATE SURFACE CSE, TYPE B

AGGREGATE SURFACE CSE, TYPE B

AGGREGATE SURFACE CSE, TYPE B

MULTIPLE HMA BINDER LIFTS REQUIRED

MULTIPLE HMA BINDER LIFTS REQUIRED

MULTIPLE HMA BINDER LIFTS REQUIRED

MULTIPLE HMA BINDER LIFTS REQUIRED

SAW CUT

108
+
43

107
+
05

107
+
05

106
+
71

57
+
97

57
+
81

COUNTY	ROUTE	SECTION	SHT. NO.
ADAMS	FAS 1800 FAS 1801	16-00073-01-FP	18

STA. 109+08 TO STA. 109+93

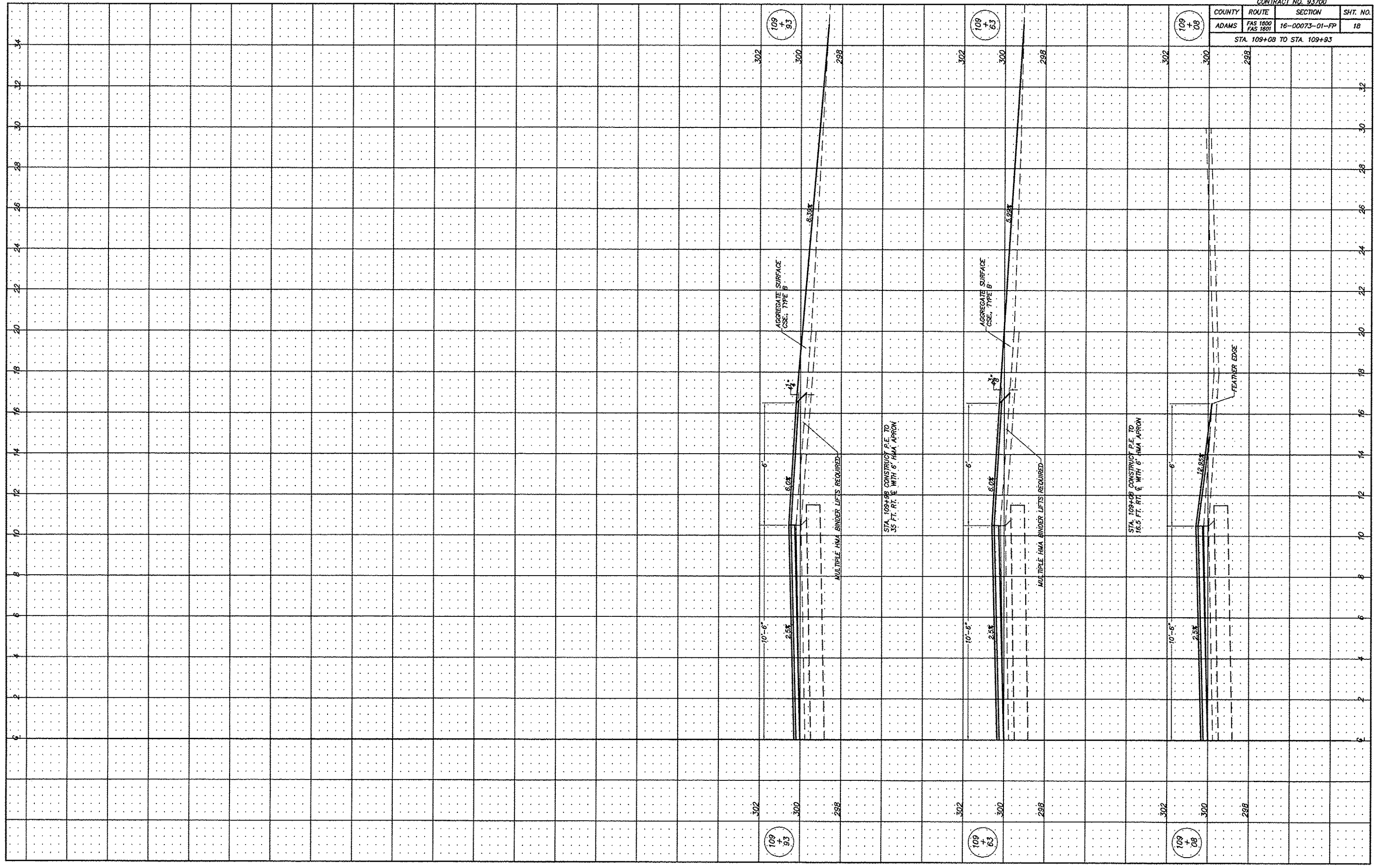

109+93

109+83

109+08

302

300

298

302

300

298

302

300

298

109+93

109+83

109+08

302

300

298

302

300

298

302

300

298