

**STATE OF ILLINOIS**  
**DEPARTMENT OF TRANSPORTATION**  
**DIVISION OF HIGHWAYS**  
**PLANS FOR PROPOSED**  
**FEDERAL AID HIGHWAY**  
**CITY OF SPRING VALLEY**  
**FAU 5604 (W DAKOTA STREET)**  
**SECTION 15-00054-00-RS**  
**PROJECT M-5065 (009)**  
**BUREAU COUNTY**  
**C-93-056-16**

**INDEX OF SHEETS**

1. COVER SHEET
2. GENERAL NOTES AND SUMMARY OF QUANTITIES
3. TYPICAL SECTIONS
- 4.-5. PLAN SHEETS

**HIGHWAY STANDARDS**

- |           |   |
|-----------|---|
| 000001-06 | STANDARD SYMBOLS, ABBREVIATIONS AND PATTERNS                              |
| 001006    | DECIMAL OF AN INCH AND OF A FOOT  |
| 280001-07 | TEMPORARY EROSION CONTROL SYSTEMS   |
| 424001-09 | PERPENDICULAR CURB RAMPS FOR SIDEWALKS                                    |
| 424006-02 | DIAGONAL CURB RAMPS FOR SIDEWALKS   |
| 424011-03 | CORNER PARALLEL CURB RAMPS FOR SIDEWALKS                                  |
| 424016-03 | MID-BLOCK CURB RAMPS FOR SIDEWALKS  |
| 424031-01 | MEDIAN PEDESTRIAN CROSSINGS   |
| 606001-06 | CONCRETE CURB TYPE B AND COMBINATION CONCRETE CURB AND GUTTER             |
| 701001-02 | OFF-RD OPERATIONS, 2L, 2W, MORE THAN 15' (4.5 m) AWAY                     |
| 701006-05 | OFF-RD OPERATIONS, 2L, 2W, 15' (4.5 m) TO 24' (600 mm) FROM PAVEMENT EDGE |
| 701301-04 | LANE CLOSURE, 2L, 2W, SHORT TIME OPERATIONS                               |
| 701311-03 | LANE CLOSURE, 2L, 2W MOVING OPERATIONS - DAY ONLY                         |
| 701501-06 | URBAN LANE CLOSURE, 2L, 2W, UNDIVIDED                                     |
| 701801-06 | SIDEWALK, CORNER OR CROSSWALK CLOSURE                                     |
| 701901-06 | TRAFFIC CONTROL DEVICES   |
| 780001-05 | TYPICAL PAVEMENT MARKINGS   |

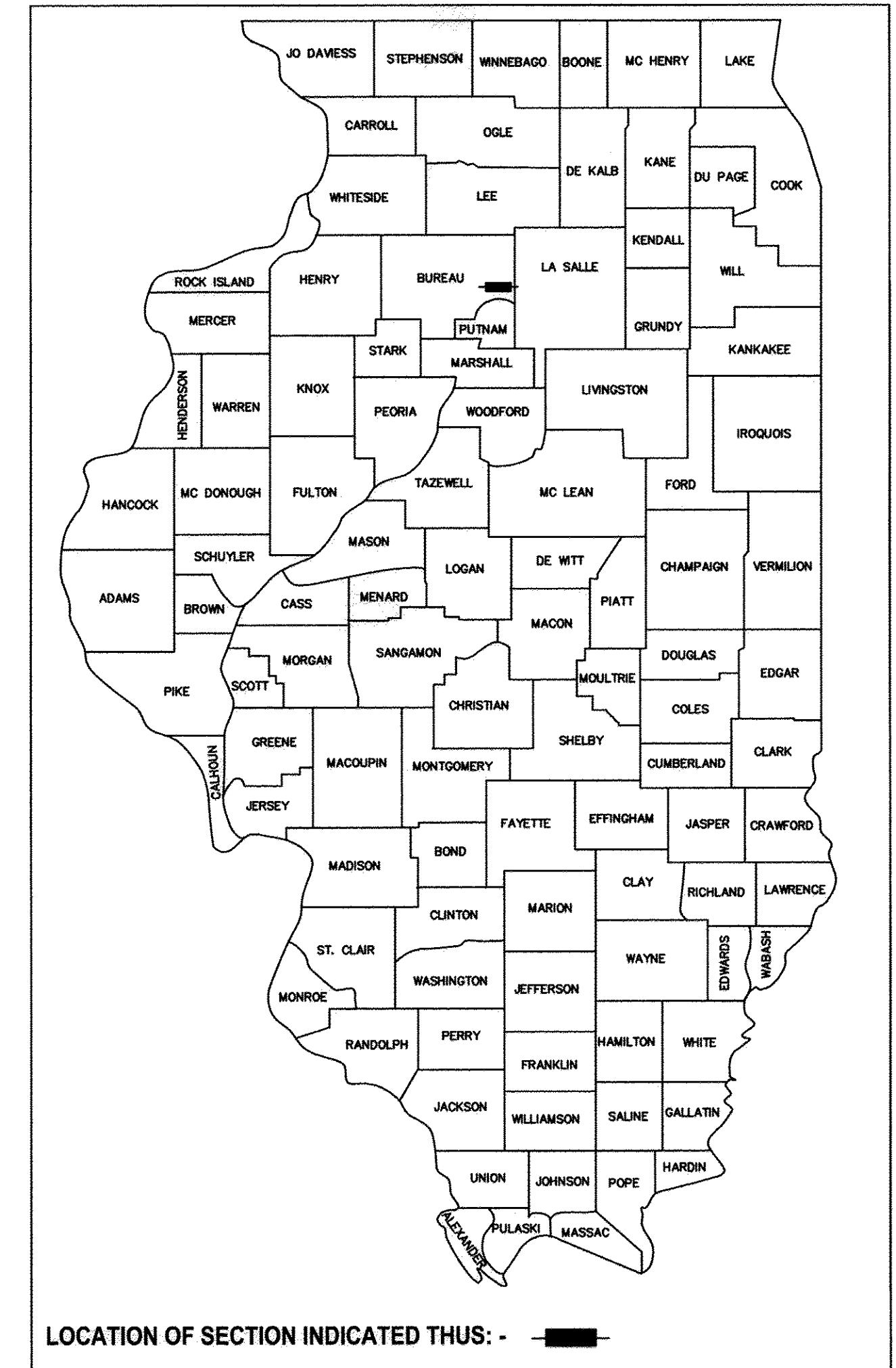

FAU 5604 (W DAKOTA STREET)  
 FUNCTION CLASSIFICATION: MINOR ARTERIAL  
 ADT=750 (2012)  
 POSTED SPEED 30 MPH

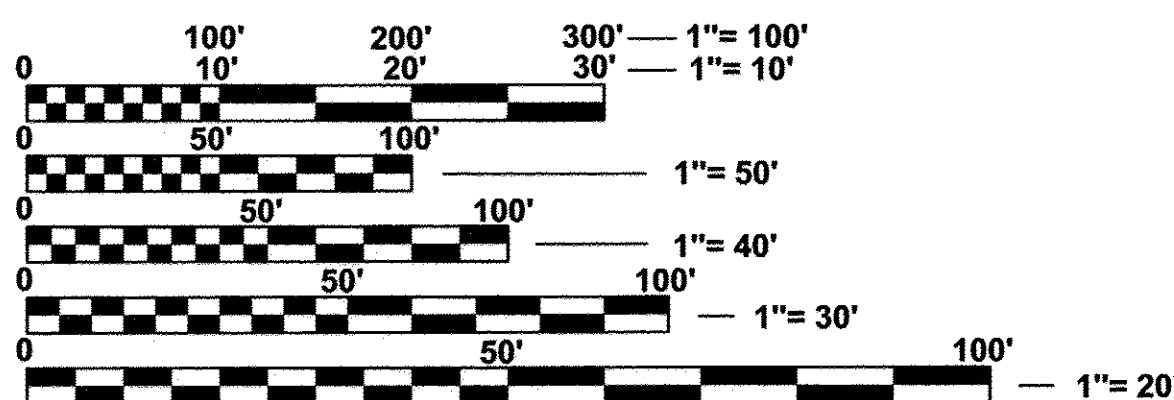
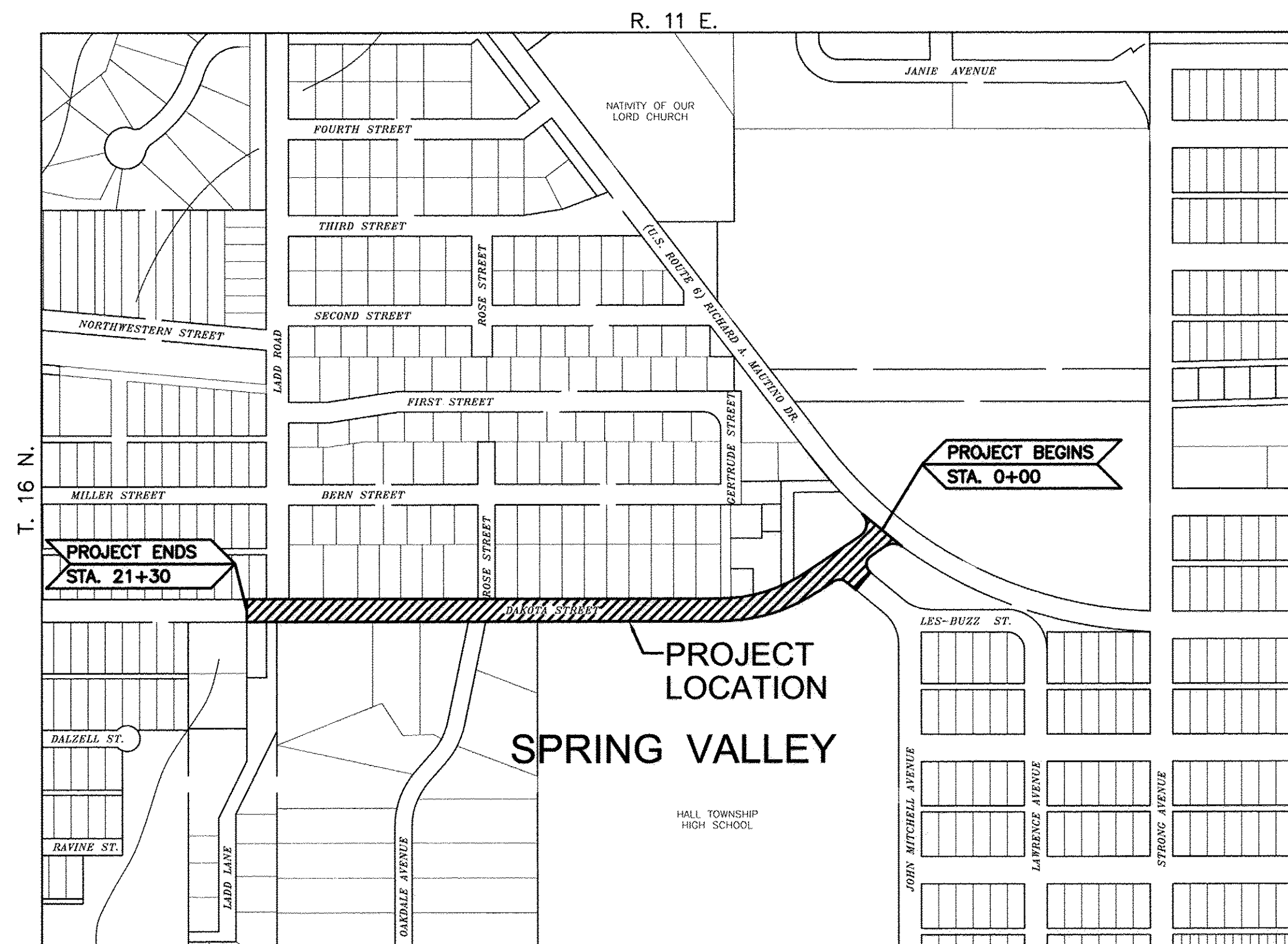

FULL SIZE PLANS HAVE BEEN PREPARED USING STANDARD ENGINEERING SCALES. REDUCED SIZED PLANS WILL NOT CONFORM TO STANDARD SCALES. IN MAKING MEASUREMENTS ON REDUCED PLANS, THE ABOVE SCALES MAY BE USED.

J.U.L.I.E.  
 JOINT UTILITY LOCATION INFORMATION FOR EXCAVATION  
 1-800-892-0123  
 OR 811

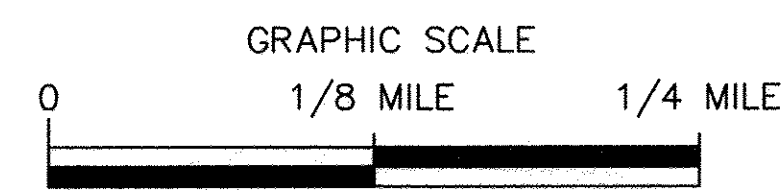

NET LENGTH OF SECTION -- 2130' (0.403 MILES)  
 GROSS LENGTH OF SECTION -- 2130' (0.403 MILES)

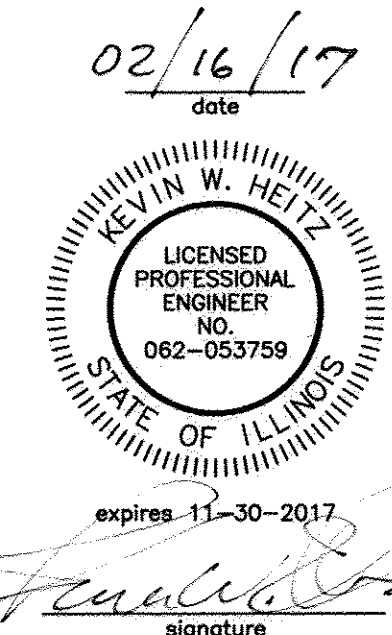

**STATE OF ILLINOIS**  
**DEPARTMENT OF TRANSPORTATION**  
**DIVISION OF HIGHWAYS**

SUBMITTED FEBRUARY 17 2017

MAYOR, CITY OF SPRING VALLEY

PASSED 2-23 2017

DISTRICT 3, LOCAL ROADS AND STREETS ENGINEER

RELEASED 2-23 2017

REGION 2 ENGINEER

FOR BID BASED ON LIMITED REVIEW

**PRINTED BY THE AUTHORITY OF THE STATE OF ILLINOIS**

MICHAEL S. RICHIETTA  
 CHAMLIN & ASSOCIATES  
 815.223.3344

**GENERAL NOTES**

THE THICKNESS OF THE HMA SHOWN ON THE PLANS IS THE NOMINAL THICKNESS. DEVIATIONS FROM THE NOMINAL THICKNESS WILL BE PERMITTED WHEN SUCH DEVIATIONS OCCUR DUE TO IRREGULARITIES IN THE EXISTING SURFACE OR BASE ON WHICH THE HMA IS PLACED

THE ENGINEER WILL BE THE SOLE JUDGE CONCERNING CURING TIME FOR VARIOUS HMA LIFTS.

FOR STABILIZATION ALL TYPE III BARRICADES WILL REQUIRE A MINIMUM OF FOUR SAND BAGS PER BARRICADE.

THE FOLLOWING RATES OF APPLICATION HAVE BEEN USED IN CALCULATING PLAN QUANTITIES.

BITUMINOUS MATERIALS (PRIME COAT) RATES		
SURFACE TYPE	ESTIMATED TRUCK APPLICATION RATE	RESIDUAL RATE
AGGREGATE BASES	0.375 GAL/SQ YD	N/A
MILLED HMA OR PCC PAVEMENT	0.08 GAL/SQ YD	0.04 GAL/SQ YD
EXISTING PAVEMENT	0.05 GAL/SQ YD	0.025 GAL/SQ YD
FOG COAT (BETWEEN ADDITIONAL HMA LIFTS)	0.05 GAL/SQ YD	0.025 GAL/SQ YD

ESTIMATED TRUCK APPLICATION RATE USED FOR CALCULATING PLAN QUANTITIES

CONTRACTOR SHALL CONTACT JULIE AT LEAST 48 HOURS PRIOR TO EXCAVATION.

**CONSTRUCTION TYPE CODE 005  
SUMMARY OF QUANTITIES**

ITEM NO.	DESCRIPTION	UNIT	TOTAL QUANTITY
40600290	BITUMINOUS MATERIALS (TACK COAT)	POUND	5610
40600400	MIXTURES FOR CRACKS, JOINTS AND FLANGWAYS	TON	20
40600627	LEVELING BINDER (MACHINE METHOD), IL 9.5 FG, N50	TON	465
40603310	HOT-MIX ASPHALT SURFACE COURSE, MIX "C", N50	TON	698
Δ 42400200	PORTLAND CEMENT CONCRETE SIDEWALK 5 INCH	SQ FT	585
42400800	DETECTABLE WARNINGS	SQ FT	56
44000158	HOT-MIX ASPHALT SURFACE REMOVAL, 2-1/4"	SQ YD	8105
44000500	COMBINATION CURB AND GUTTER REMOVAL	FOOT	390
44000600	SIDEWALK REMOVAL	SQ FT	585
44201696	CLASS D PATCHES, TYPE IV, 4 INCH	SQ YD	27
60255500	MANHOLES TO BE ADJUSTED	EACH	9
60260100	INLETS TO BE ADJUSTED	EACH	6
60266600	VALVE BOXES TO BE ADJUSTED	EACH	5
60603800	COMBINATION CONCRETE CURB AND GUTTER, TYPE B-6.12	FOOT	390
* 78000100	THERMOPLASTIC PAVEMENT MARKING - LETTERS AND SYMBOLS	SQ FT	31
* 78000200	THERMOPLASTIC PAVEMENT MARKING - LINE 4"	FOOT	200
* 78000500	THERMOPLASTIC PAVEMENT MARKING - LINE 8"	FOOT	137
* 78000650	THERMOPLASTIC PAVEMENT MARKING - LINE 24"	FOOT	34

\* SPECIALTY ITEM

Δ SPECIAL PROVISIONS

CHAMLIN & ASSOCIATES, INC. © 2017  
Drawing Name: C:\Users\msr\Documents\Projects\15-00054-00-RS\15-00054-00-RS-SPRING-VALLEY-STREET-RECONSTRUCTION\15-00054-00-RS-SPRING-VALLEY-STREET-RECONSTRUCTION.dwg, Last Modified: Feb 16, 2017 - 10:47am, Plotted on: Feb 16, 2017 - 3:33pm by drcant

DRAWN BY: NOE	REVISIONS			
CHECKED BY: MSR	LEVEL	BY	DATE	DESCRIPTION
DATE: 09/16				

**CHAMLIN & ASSOCIATES, INC.**  
 PERU MORRIS  
 ILLINOIS

**FAU 5604 (W DAKOTA STREET)  
 SECTION 15-00054-00-RS  
 CITY OF SPRING VALLEY  
 BUREAU COUNTY**

**GENERAL NOTES AND  
 SUMMARY OF QUANTITIES**

**CONSTRUCTION  
 PLANS**

CONTRACT 87655

CURRENT AS OF: 01/12/2017	
SCALE: AS NOTED	SHEET 2
FILE NO.: 66171.00 Y-	OF 5



CHAMLIN & ASSOCIATES, INC. © 2013 Drawing Name: C:\Users\N\Documents\Projects\Spring Valley\STU\West-Dakota-Street\CAD\C3D\003-TYPICALS.dwg Last Modified: Feb 16, 2017 3:04pm Plotted on: Feb 16, 2017 3:05pm by rhhart

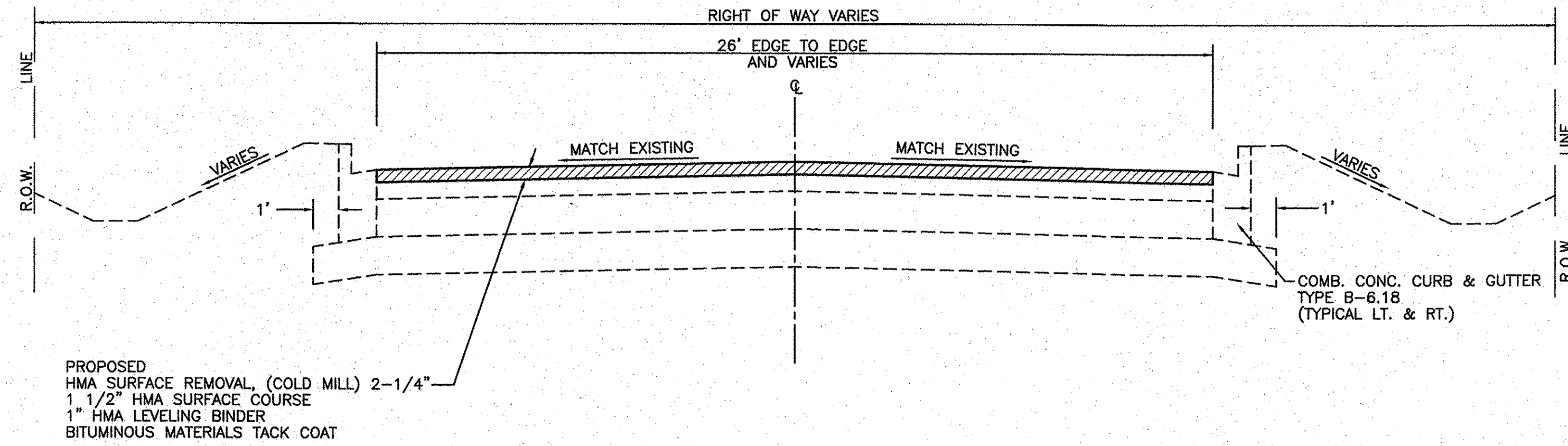

**TYPICAL CROSS SECTION  
WEST DAKOTA STREET**  
N.T.S.  
STA. 0+00 TO STA. 7+48

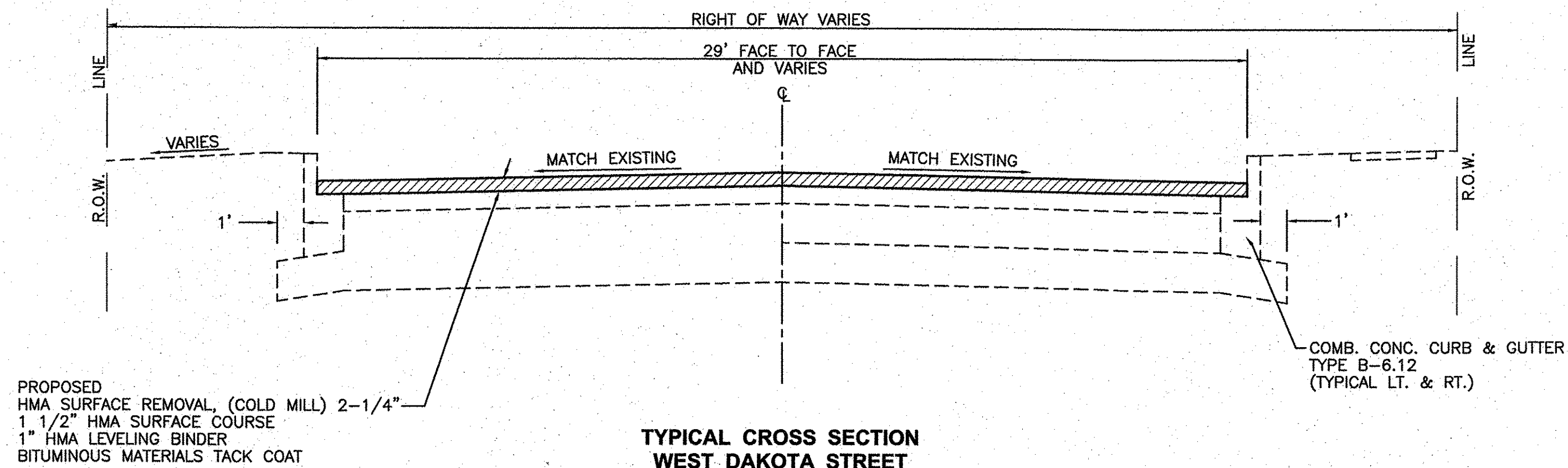

**TYPICAL CROSS SECTION  
WEST DAKOTA STREET**  
N.T.S.  
STA. 7+48 TO STA. 21+30

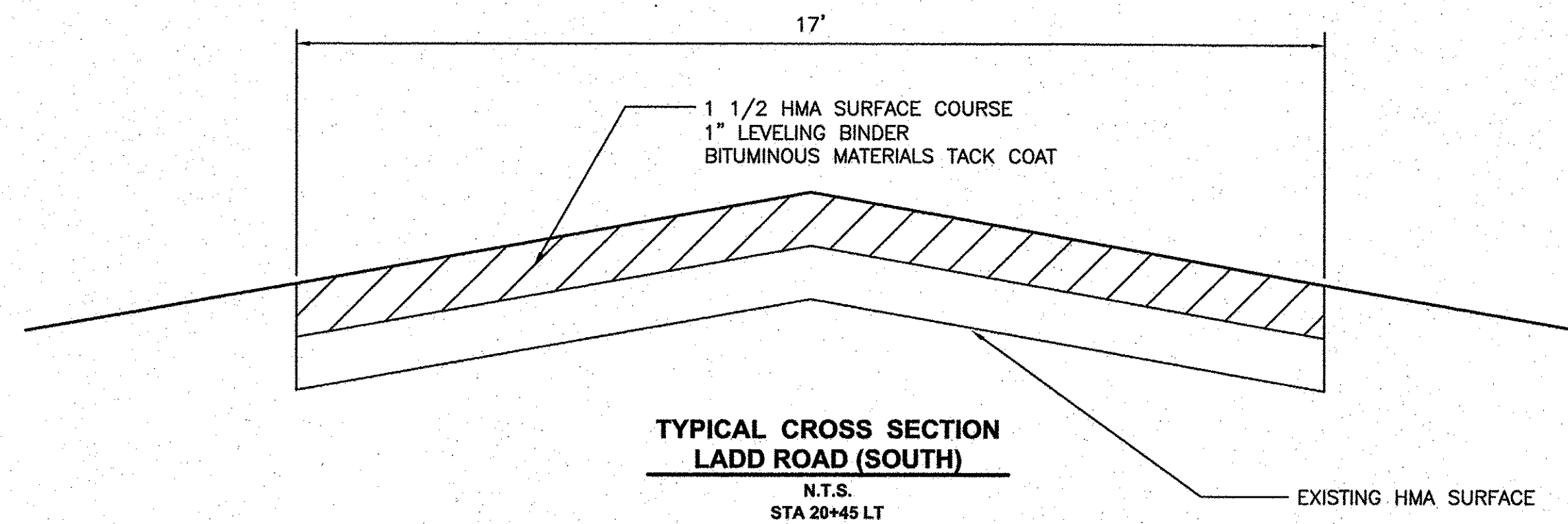

**TYPICAL CROSS SECTION  
LADD ROAD (SOUTH)**  
N.T.S.  
STA 20+45 LT

**HMA MIXTURE REQUIREMENT TABLE**

LOCATION(S):	ENTIRE PROJECT	ENTIRE PROJECT	ENTIRE PROJECT
MIXTURE USE(S):	HMA SURFACE	HMA LEVEL BINDER	CLASS D PATCHING
BINDER GRADE (PG):	PG 64-22	PG 64-22	PG 64-22
DESIGN AIR VOIDS:	4.0% @ N50	4.0% @ N50	4.0% @ N50
MIXTURE COMPOSITION (GRADATION):	IL 9.5	IL 9.5 FG	IL 19.0
FRICTION AGGREGATE:	MIXTURE C		
MIXTURE WEIGHT:	112.0 LB/SY/IN	112.0 LB/SY/IN	112.0 LB/SY/IN
QUALITY MANAGEMENT PROGRAM:	QCQA	QCQA	QCQA
SUBLOT SIZE:	NA	NA	NA
DENSITY TEST METHOD:	LR 1030	LR 1030	LR 1030

NOTE: IF AN ANTI-STRIPPING AGENT IS REQUIRED OR ADDED, THERE WILL BE NO ADDITIONAL COMPENSATION AND THE ANTI-STRIPPING AGENT SHALL BE CONSIDERED INCIDENTAL TO THE PRICE OF THE HOT-MIX ASPHALT.

DRAWN BY: NOE	REVISIONS			
	LEVEL	BY	DATE	DESCRIPTION
CHECKED BY: MSR				
DATE: 09/16				

**CHAMLIN & ASSOCIATES, INC.**  
PERU MORRIS ILLINOIS

**FAU 5604 (W DAKOTA STREET)  
SECTION 15-00054-00-RS  
CITY OF SPRING VALLEY  
BUREAU COUNTY**

**TYPICAL SECTIONS**

**CONSTRUCTION  
PLANS**

CONTRACT 87655

CURRENT AS OF: 01/12/2017	
SCALE: AS NOTED	SHEET 3
FILE NO.: 66171.00 Y-	OF 5





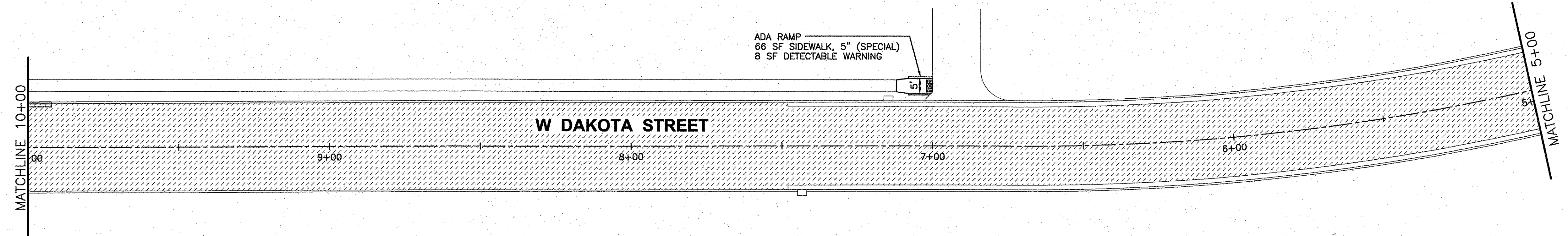
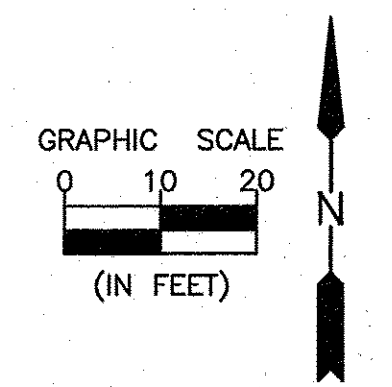

- LEGEND**
- A** INLET, MANHOLE, OR WATER VALVE TO BE ADJUSTED
  - HMA SURFACE REMOVAL, (COLD MILL) 2-1/4"
  - BASE REPAIR
  - HMA OVERLAY ONLY

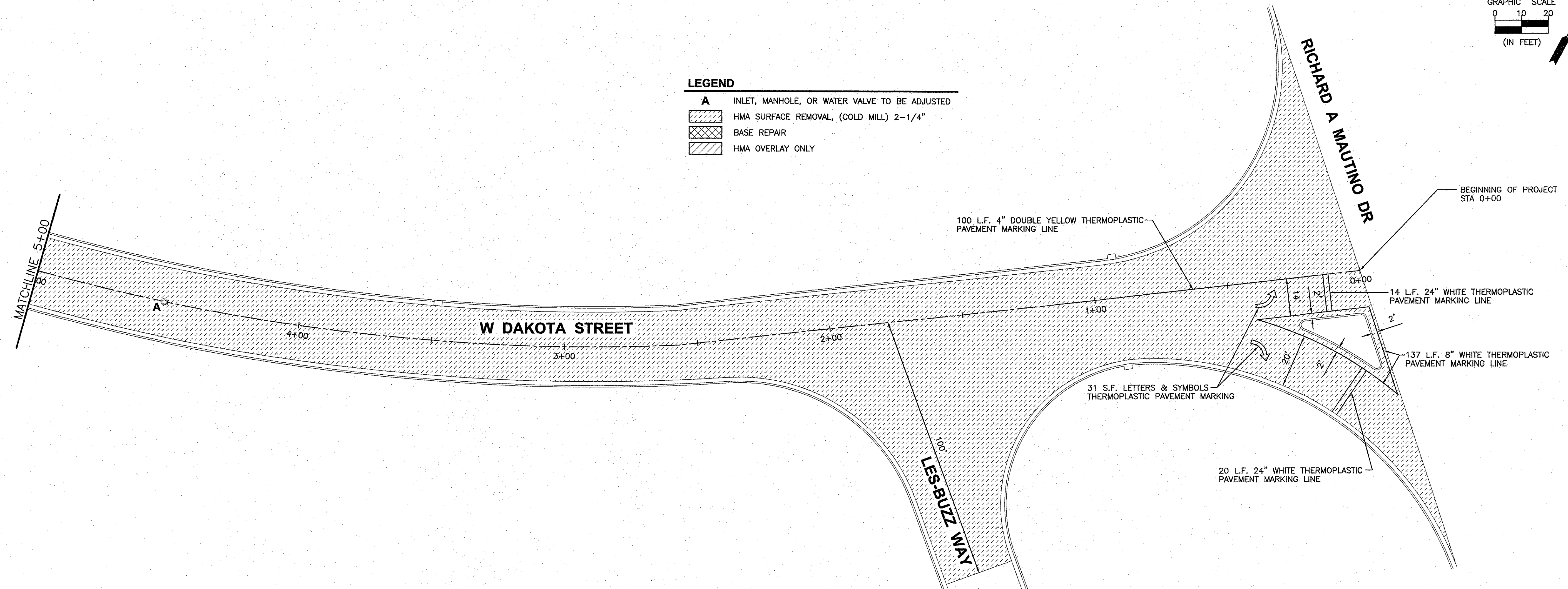
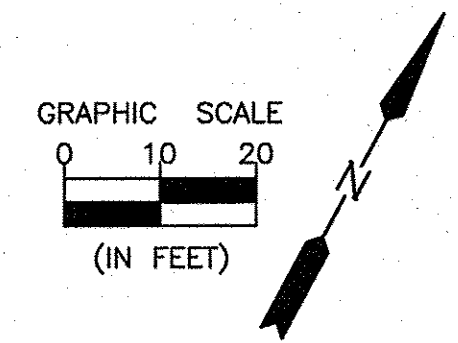

- LEGEND**
- A** INLET, MANHOLE, OR WATER VALVE TO BE ADJUSTED
  - HMA SURFACE REMOVAL, (COLD MILL) 2-1/4"
  - BASE REPAIR
  - HMA OVERLAY ONLY

CHAMLIN & ASSOCIATES, INC. © 2013  
 Drawing Number: 66171-00 - Spring Valley - STU - West - Details - Street (CAD) (CAD) (004 - PLAN) (Last Modified: Feb 16, 2017 - 10:47am) Plotted on: Feb 16, 2017 - 3:09pm by rlsant

DRAWN BY: NOE	REVISIONS			
	LEVEL	BY	DATE	DESCRIPTION
CHECKED BY: MSR				
DATE: 09/16				

**CHAMLIN & ASSOCIATES, INC.**  
 PERU MORRIS ILLINOIS

FAU 5604 (W DAKOTA STREET)  
 SECTION 15-00054-00-RS  
 CITY OF SPRING VALLEY  
 BUREAU COUNTY

PLAN SHEET

**CONSTRUCTION PLANS**

CONTRACT 87655

CURRENT AS OF: 01/12/2017	
SCALE: AS NOTED	SHEET 5
FILE NO.: 66171.00 Y-	OF 5