

04-28-2023 LETTING ITEM 091

**INDEX OF SHEETS**

- 01 TITLE SHEET
- 02 GENERAL NOTES
- 03 SUMMARY OF QUANTITIES
- 04-05 SCHEDULE OF QUANTITIES
- 06-09 TYPICAL SECTIONS
- 10-12 PLAN & PROFILE
- 13-15 SIDEWALK RAMP
- 16-17 DRIVEWAY DETAILS
- 18-19 PAVEMENT MARKING DETAILS
- 20-22 CITY OF MOLINE DETAILS

**HIGHWAY STANDARDS**

- 000001-08 STANDARD SYMBOLS, ABBREVIATIONS, AND PATTERNS
- 280001-07 TEMPORARY EROSION CONTROL SYSTEMS
- 424001-11 PERPENDICULAR CURB RAMPS FOR SIDEWALKS
- 606001-08 CONCRETE CURB & GUTTER TYPE B & COMBINATION CONCRETE CURB & GUTTER
- 701501-06 URBAN LANE CLOSURE, 2L, 2W, UNDIVIDED
- 701701-10 URBAN LANE CLOSURE, 2L, 2W, UNDIVIDED
- 701801-06 SIDEWALK CORNER OR CROSSWALK CLOSURE
- 701901-08 TRAFFIC CONTROL DEVICES
- 728001-01 TELESCOPING STEEL SIGN SUPPORTS
- 729001-01 APPLICATIONS OF TYPES A AND B METAL POSTS (FOR SIGNS & MARKERS)
- 780001-05 TYPICAL PAVEMENT MARKINGS
- BLR 22-7 TYPICAL APPLICATION OF TRAFFIC CONTROL DEVICES

CITY OF MOLINE, ILLINOIS  
CONSTRUCTION PLANS FOR  
**7TH STREET RESURFACING**

FAU 5827  
12TH AVENUE TO 16TH AVENUE  
**PROJECT NO. 2L77 (943)**  
**JOB#C-92-015-20**  
**SECTION 19-00269-00-RS**  
**CONTRACT #85740**

**PROJECT LOCATION MAP**

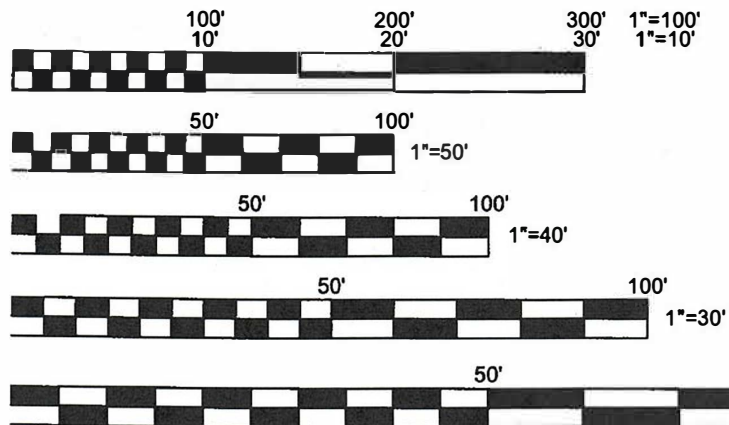

11X17 PLANS HAVE BEEN PREPARED USING STANDARD ENGINEERING SCALES. REDUCED SIZE PLANS MAY NOT CONFORM TO STANDARD SCALES. IN MAKING MEASUREMENTS ON REDUCED PLANS, THE ABOVE SCALES MAY BE USED.

GROSS LENGTH: 1,310.84 FT (0.248 Mi.)  
NET LENGTH: 1,310.84 FT (0.248 Mi.)  
MINOR ARTERIAL  
ADT: 6,700 (2023) 3.0% TRUCKS  
LOCAL AGENCY FUNCTIONAL OVERLAY

J.U.L.I.E.  
JOINT UTILITY LOCATION  
INFORMATION FOR EXCAVATION  
1-800-892-0123 OR 811



CITY OF MOLINE, IL

APPROVED

2/14/23

*David Dryer*  
DAVID DRYER, DIRECTOR OF ENGINEERING

ILLINOIS DEPARTMENT OF TRANSPORTATION

PASSED

2/16/23

*Sha Ch...*  
DISTRICT 2 ENGINEER OF LOCAL ROADS & STREETS

RELEASING FOR BID  
BASED ON LIMITED  
REVIEW

2/16/23

*Muhammad Ahmad...*  
DEPUTY DIRECTOR OF HIGHWAYS, REGION 2 ENGINEER



I HEREBY CERTIFY THAT THESE PLANS WERE PREPARED BY ME OR UNDER MY DIRECT PERSONAL SUPERVISION AND THAT I AM A DULY REGISTERED PROFESSIONAL ENGINEER UNDER THE LAWS OF THE STATE OF ILLINOIS.

*Laura Klauer* 2-14-23  
LAURA C. KLAUER, P.E. DATE  
LICENSE NO. 062-060373 EXPIRES 11-30-23

**SYMBOL LEGEND**

EXISTING	SYMBOL NAME	PROPOSED	EXISTING	SYMBOL NAME	PROPOSED
	MAILBOX			GAS VALVE	-
	MANHOLE			HANDHOLE	
	WATER SERVICE VALVE			ELECTRICAL JUNCTION BOX	
	VALVE & VALVE BOX			TELEPHONE JUNCTION BOX	
	VALVE VAULT			CABLE TELEVISION JUNCTION BOX	
	FIRE HYDRANT			GUY WIRE	-
	REDUCER			UTILITY POLE	-
	LIFT STATION			UTILITY POLE WITH LIGHT	-
	CLEANOUT			STREET LIGHT	
	ALLEY CATCH BASIN			DECORATIVE LIGHT	
	CATCH BASIN			STREET SIGN	
	CATCH BASIN SINGLE			OTHER SIGNS (SINGLE POST)	
	CATCH BASIN DOUBLE			OTHER SIGNS (DOUBLE POST)	
	CATCH BASIN TRIPLE			TRAFFIC CONTROL CABINET	
	CATCH BASIN SPECIAL			TRAFFIC SIGNAL	
	FLARED END SECTION			PROPERTY PIN	
	DIRECTION OF FLOW				
	BUSH				
	DECIDUOUS TREE				
	EVERGREEN TREE	-			
	STUMP	-			

**LINETYPE LEGEND**

EXISTING	LINETYPE NAME	PROPOSED
	CONTOURS	
	RIGHT OF WAY (R.O.W.)	
	CENTER LINE	
	WATER MAIN	
	WATER SERVICE LINE	
	SANITARY SEWER	
	STORM SEWER	
	UNDER DRAIN	
	ELECTRIC	
	GAS	
	CABLE TELEVISION	
	FIBER OPTIC CABLE	
	TELEPHONE LINE	
	TREE LINE	
	FENCE	
	BUILDING	

**ABBREVIATIONS**

T/C	-	TOP OF CURB
T/S	-	TOP OF SIDEWALK
P	-	PAVEMENT
F/L	-	FLOW LINE
L.L.	-	LEVEL LANDING
T.P.	-	TRANSITION PANEL

**GENERAL NOTES**

- THIS PROJECT SHALL BE CONSTRUCTED IN ACCORDANCE WITH THE FOLLOWING STANDARDS: THE "STANDARD SPECIFICATIONS FOR ROAD AND BRIDGE CONSTRUCTION" ADOPTED JANUARY 1, 2022 BY THE ILLINOIS DEPARTMENT OF TRANSPORTATION; THE "SUPPLEMENTAL SPECIFICATIONS AND RECURRING SPECIAL PROVISIONS" ADOPTED JANUARY 1, 2023 BY THE ILLINOIS DEPARTMENT OF TRANSPORTATION; THE "2023 SUPPLEMENTAL SPECIFICATIONS" ADOPTED JANUARY 1, 2023 BY THE CITY OF MOLINE; AND THE SPECIAL PROVISIONS CONTAINED WITHIN THE BIDDING DOCUMENTS.
- ALL POINTS OF POSSIBLE CONFLICT WITH UTILITIES ARE TO BE EXCAVATED AS NECESSARY TO VERIFY THE EXACT LOCATION AND ELEVATION BEFORE COMMENCEMENT OF CONSTRUCTION. THIS WORK SHALL BE CONSIDERED INCIDENTAL TO THE CONTRACT.
- TRAFFIC CONTROL SHALL BE IN ACCORDANCE WITH THE "MANUAL ON UNIFORM TRAFFIC CONTROL DEVICES" ADOPTED 2009 BY THE FEDERAL HIGHWAY ADMINISTRATION WITH REVISIONS 1 AND 2 IN 2012, THE "STANDARD SPECIFICATIONS FOR ROAD AND BRIDGE CONSTRUCTION" ADOPTED JANUARY 1, 2022 BY THE ILLINOIS DEPARTMENT OF TRANSPORTATION, AND THE SPECIAL PROVISIONS CONTAINED WITHIN THE BIDDING DOCUMENTS.
- THE CONTRACTOR SHALL PROVIDE PROTECTION TO THE PUBLIC IN ACCORDANCE WITH ARTICLE 107.14 OF THE "STANDARD SPECIFICATIONS FOR ROAD AND BRIDGE CONSTRUCTION" ADOPTED JANUARY 1, 2022 BY THE ILLINOIS DEPARTMENT OF TRANSPORTATION. THIS SHALL INCLUDE TRAFFIC CONTROL AND OTHER NECESSARY MEASURES TO UPHOLD AN ADEQUATE LEVEL OF SAFETY. TRAFFIC CONTROL SHALL BE PROVIDED, TO THE SATISFACTION OF THE ENGINEER, INCLUDING ALL PROTECTION DEEMED NECESSARY BEYOND THAT SHOWN IN THE PLANS OR SPECIAL PROVISIONS. THE ABSENCE OF TRAFFIC CONTROL DRAWINGS DOES NOT RELIEVE THE CONTRACTOR OF THEIR RESPONSIBILITY TO ENSURE PUBLIC SAFETY.
- THE CONTRACTOR SHALL PROTECT ALL EXISTING SIDEWALK, PAVEMENT, LANDSCAPING, AND RETAINING WALLS THAT ARE NOT MARKED FOR REMOVAL. ANY DAMAGE CAUSED DURING CONSTRUCTION SHALL BE REPAIRED AT THE CONTRACTOR'S EXPENSE.
- THE REMOVAL, STORAGE, AND REINSTALLATION OF EXISTING SIGNS AND FENCING WITHIN THE CONSTRUCTION LIMITS SHALL BE CONSIDERED INCIDENTAL TO THE CONTRACT.
- THE CONTRACTOR SHALL NOTIFY INDIVIDUAL RESIDENTS PRIOR TO THE REMOVAL OF DRIVEWAYS OR TREES. THE CONTRACTOR SHALL BE RESPONSIBLE FOR COORDINATING THE REMOVAL AND RECONSTRUCTION SCHEDULE OF DRIVEWAYS WITH INDIVIDUAL RESIDENTS IN ORDER TO MINIMIZE DISRUPTIONS TO DRIVEWAY ACCESS. THIS WORK SHALL BE CONSIDERED INCIDENTAL TO THE CONTRACT.
- THE CONTRACTOR SHALL ENSURE THE CONTINUATION OF MAIL SERVICES AND GARBAGE COLLECTION SERVICES TO RESIDENTS THROUGHOUT THE DURATION OF THE PROJECT. THE CONTRACTOR SHALL NOTIFY RESIDENTS PRIOR TO ANY CHANGES OR DISRUPTIONS IN THESE SERVICES. THIS WORK SHALL BE CONSIDERED INCIDENTAL TO THE CONTRACT.
- ALL HONEYCOMBING AND/OR POROUS AREAS IN BACK OF CURB WILL BE CORRECTED AS DIRECTED BY THE ENGINEER. SLUMP NOT TO EXCEED 3". REQUIRED AIR, 5% - 8%. NO WATER MAY BE ADDED AT JOBSITE TO EXCEED THE DESIGN SLUMP. ALL TIE BARS, DOWEL BARS AND REINFORCING STEEL SHALL BE EPOXY COATED.

**HMA MIXTURE TABLE**

Location and Mixture Uses:	Surface	Binder
PG:	SBS PG 64-28	SBS PG 64-28
Design Air Voids:	4.0 @ N50	4.0 @ N50
Mixture Composition	IL-9.5FG	IL-9.5
Friction Aggregate	D	N/A
Mix Weight	112 lb/sy/in	112 lb/sy/in
Quality Management Program	QC/QA	QC/QA
Sublot Size	N/A	N/A
Material Transfer Device	N/A	N/A

**UTILITIES**

THE FOLLOWING UTILITY COMPANIES MAY HAVE FACILITIES LOCATED WITHIN THE PROJECT AREA:

CITY OF MOLINE PUBLIC UTILITIES:

- ELECTRICAL MAINTENANCE DEPARTMENT
- STORMWATER DEPARTMENT
- STREET DEPARTMENT
- WATER POLLUTION CONTROL DEPARTMENT
- WATER DEPARTMENT

PRIVATE GAS AND ELECTRIC:

- MIDAMERICAN ENERGY

PRIVATE TELECOMMUNICATIONS:

- AT&T
- CENTURY LINK
- GENESEO COMMUNICATIONS
- MEDIACOM
- VERIZON
- WINDSTREAM
- OTHERS TO BE DETERMINED

THE CONTRACTOR SHALL CALL J.U.L.I.E. AT 1-800-892-0123 OR 811 TO CONTACT ALL UTILITY COMPANIES WHICH MAY HAVE FACILITIES WITHIN THE PROJECT AREA. PRIOR TO THE COMMENCEMENT OF CONSTRUCTION, ALL POINTS OF POSSIBLE CONFLICT SHALL BE EXCAVATED TO VERIFY EXACT LOCATIONS AND ELEVATIONS.

**7TH STREET RESURFACING**

12TH AVENUE - 16TH AVENUE

GENERAL NOTES



CITY OF MOLINE  
ENGINEERING DEPARTMENT  
(309) 524-2350  
3635 4TH AVENUE, MOLINE, IL 61265  
CITY ENGINEER - DAVID DRYER, P.E.

DATE	REVISION

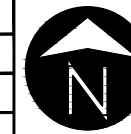

SCALED FOR  
11"X17" PAPER  
0' 0' 0'  
SCALE: N.T.S.

Date **11-07-22**  
Project **19-00269-00-RS**  
Designer **JSM**

SHEET  
**02**  
OF  
**22**

**SUMMARY OF QUANTITIES**

CONSTRUCTION TYPE CODE: 0005

	ITEM	UNIT	QUANTITY
	40600295 POLYMERIZED BITUMINOUS MATERIALS (TACK COAT)	POUND	1947
	40600905 POLYMERIZED BINDER COURSE (HAND METHOD), N50	TON	50
	40603205 POLYMERIZED HOT-MIX ASPHALT BINDER COURSE, IL-9.5, N50	TON	364
	40604110 POLYMERIZED HOT-MIX ASPHALT SURFACE COURSE, IL-9.5FG, MIX "D", N50	TON	364
	42300300 PORTLAND CEMENT CONCRETE DRIVEWAY PAVEMENT, 7 INCH	SQ YD	49
	42400100 PORTLAND CEMENT CONCRETE SIDEWALK, 4 INCH	SQ FT	248.0
	42400300 PORTLAND CEMENT CONCRETE SIDEWALK, 6 INCH	SQ FT	396.5
	42400800 DETECTABLE WARNINGS	SQ FT	34
	44000200 DRIVEWAY PAVEMENT REMOVAL	SQ YD	50
	44000500 COMBINATION CURB AND GUTTER REMOVAL	FOOT	449
	44000600 SIDEWALK REMOVAL	SQ FT	657
*	44200934 CLASS B PATCHES, TYPE II, 8 INCH	SQ YD	14
*	44200942 CLASS B PATCHES, TYPE III, 8 INCH	SQ YD	24
*	44200944 CLASS B PATCHES, TYPE IV, 8 INCH	SQ YD	393
	60300105 FRAMES AND GRATES TO BE ADJUSTED	EACH	7
*	60300305 FRAMES AND LIDS TO BE ADJUSTED	EACH	1
	67100100 MOBILIZATION	L SUM	1
	70300100 SHORT TERM PAVEMENT MARKING	FOOT	160
	70300150 SHORT TERM PAVEMENT MARKING REMOVAL	SQ FT	53
△	78000200 THERMOPLASTIC PAVEMENT MARKING - LINE 4"	FOOT	320
△	78000400 THERMOPLASTIC PAVEMENT MARKING - LINE 6"	FOOT	147
△	78000600 THERMOPLASTIC PAVEMENT MARKING - LINE 12"	FOOT	83
△	78000650 THERMOPLASTIC PAVEMENT MARKING - LINE 24"	FOOT	39
*	K1005421 SEEDING (SPECIAL)	ACRE	0.25
*	X4060995 TEMPORARY RAMP, SPECIAL	SQ YD	62
*	X4401198 HOT-MIX ASPHALT SURFACE REMOVAL VARIABLE DEPTH	SQ YD	4327.5
*	X7010216 TRAFFIC CONTROL AND PROTECTION (SPECIAL)	L SUM	1
*	XX009566 COMBINATION CONCRETE CURB AND GUTTER, TYPE B-6.12 (ABUTTING EXISTING PAVEMENT)	FOOT	449.0

\* INDICATES SPECIAL PROVISION  
 △ INDICATES SPECIALTY ITEM

H:\Engineering\All Projects\MFT 19-00269-00-RS 7th Street, 12th to 16th Ave Resurfacing\Design Documents\Drawings\7thSt 12th-16thAve-Design.dwg



CITY OF MOLINE  
 ENGINEERING DEPARTMENT  
 (309) 524-2350  
 3635 4TH AVENUE, MOLINE, IL 61265  
 CITY ENGINEER - DAVID DRYER, P.E.

**7TH STREET RESURFACING**

12TH AVENUE - 16TH AVENUE

SUMMARY OF QUANTITIES

DATE	REVISION

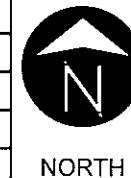

SCALED FOR  
 11"X17" PAPER  
 0' 0' 0'  
 SCALE: N.T.S.

Date **01-13-23**  
 Project **19-00269-00-RS**  
 Designer **JSM**

SHEET  
**03**  
 OF  
**22**



H:\Engineering\All Projects\MFT 19-00269-00-RS 7th Street, 12th to 16th Ave Resurfacing\Design Documents\Drawings\7thSt 12th-16thAve-Design.dwg

40600295		
POLYMERIZED BITUMINOUS MATERIALS (TACK COAT)		
ENTIRE PROJECT	1947.4	LB.
TOTAL:	1947.4	LB.

40600905		
POLYMERIZED BINDER COURSE (HAND METHOD), N50		
ENTIRE PROJECT	50.0	TON
TOTAL:	50.0	TON

40603205		
POLYMERIZED HOT-MIX ASPHALT BINDER COURSE, IL-9.5, N50		
ENTIRE PROJECT	363.5	TON
TOTAL:	363.5	TON

40604110		
POLYMERIZED HOT-MIX ASPHALT SURFACE COURSE, IL-9.5FG, MIX "D", N50		
ENTIRE PROJECT	363.5	TON
TOTAL:	363.5	TON

42300300		
PORTLAND CEMENT CONCRETE DRIVEWAY PAVEMENT, 7 INCH		
STA. 1+39.9 - 1+72.1 RT	49.1	SQ YD
TOTAL:	49.1	SQ YD

42400100		
PORTLAND CEMENT CONCRETE SIDEWALK, 4 INCH		
STA. 1+33.0 - 1+43.0 RT	50.0	SQ FT
STA. 1+69.1 - 1+81.3 RT	62.0	SQ FT
STA. 6+53.3 - 6+63.3 LT	40.6	SQ FT
STA. 11+78.8 - 11+88.8 RT	47.7	SQ FT
STA. 12+08.8 - 12+18.8 RT	47.7	SQ FT
TOTAL:	248.0	SQ FT

42400300		
PORTLAND CEMENT CONCRETE SIDEWALK, 6 INCH		
STA. 9+74.1 - 9+97.6 RT	193.0	SQ FT
STA. 10+32.1 - 10+67.2 RT	203.3	SQ FT
TOTAL:	396.3	SQ FT

42400800		
DETECTABLE WARNINGS		
STA. 9+89.9 - 9+97.6 RT	24.2	SQ FT
STA. 10+36.1 - 10+38.1 RT	10.0	SQ FT
TOTAL:	34.2	SQ FT

44000200		
DRIVEWAY PAVEMENT REMOVAL		
STA. 1+39.9 - 1+72.1 RT	49.1	SQ YD
TOTAL:	49.1	SQ YD

44000500		
COMBINATION CURB AND GUTTER REMOVAL		
STA. 1+39.3 - 1+42.4 RT	13.0	FOOT
STA. 1+61.7 - 1+72.7 RT	11.0	FOOT
STA. 1+69.7 - 1+72.7 RT	13.0	FOOT
STA. 5+76.2 - 6+08.2 RT	32.0	FOOT
STA. 6+36.3 - 7+10.3 LT	74.0	FOOT
STA. 6+88.3 - 7+22.3 RT	34.0	FOOT
STA. 7+41.1 - 7+97.1 RT	56.0	FOOT
STA. 8+16.3 - 8+92.3 RT	76.0	FOOT
STA. 9+85.8 - 10+03.2 RT	27.0	FOOT
STA. 10+31.8 - 10+46.7 RT	30.0	FOOT
STA. 11+03.6 - 11+36.6 LT	30.0	FOOT
STA. 11+08.9 - 11+16.9 RT	8.0	FOOT
STA. 11+59.4 - 11+67.4 LT	8.0	FOOT
STA. 11+81.3 - 12+15.3 RT	34.0	FOOT
TOTAL:	449.0	FOOT

44000600		
SIDEWALK REMOVAL		
STA. 1+33.0 - 1+43.0 RT	50.0	SQ FT
STA. 1+69.1 - 1+81.3 RT	62.0	SQ FT
STA. 6+53.3 - 6+63.3 LT	40.6	SQ FT
STA. 9+74.1 - 9+97.9 RT	205.9	SQ FT
STA. 10+33.5 - 10+67.2 RT	203.3	SQ FT
STA. 11+78.8 - 11+88.8 RT	47.7	SQ FT
STA. 12+08.8 - 12+18.8 RT	47.7	SQ FT
TOTAL:	657.2	SQ FT

44200934		
CLASS B PATCHES, TYPE II, 8 INCH		
STA. 10+90.6 - 11+03.6 LT	14.4	SQ YD
TOTAL:	14.4	SQ YD

44200942		
CLASS B PATCHES, TYPE III, 8 INCH		
STA. 12+49.2 - 12+69.2 LT	24.0	SQ YD
TOTAL:	24.0	SQ YD

44200944		
CLASS B PATCHES, TYPE IV, 8 INCH		
STA. 0+23.5 - 0+39.5	56.9	SQ YD
STA. 0+39.5 - 0+67.5 LT	26.4	SQ YD
STA. 2+10.1 - 2+90.1 LT	88.9	SQ YD
STA. 2+90.1 - 3+11.6	77.0	SQ YD
STA. 10+53.9 - 11+08.9 RT	97.8	SQ YD
STA. 11+82.2 - 12+15.3 RT	45.6	SQ YD
TOTAL:	392.6	SQ YD

60300105		
FRAMES AND GRATES TO BE ADJUSTED		
STA. 0+90.4 LT	1.0	EACH
STA. 3+63.3 RT	2.0	EACH
STA. 4+37.4 LT	2.0	EACH
STA. 4+38.0 RT	2.0	EACH
TOTAL:	7.0	EACH

60300305		
FRAMES AND LIDS TO BE ADJUSTED		
STA. 1+41.6 RT	1.0	EACH
TOTAL:	1.0	EACH

70300100		
SHORT TERM PAVEMENT MARKING		
ENTIRE PROJECT	160.0	FOOT
TOTAL:	160.0	FOOT



CITY OF MOLINE  
ENGINEERING DEPARTMENT  
(309) 524-2350  
3635 4TH AVENUE, MOLINE, IL 61265  
CITY ENGINEER - DAVID DRYER, P.E.

## 7TH STREET RESURFACING

12TH AVENUE - 16TH AVENUE  
SCHEDULE OF QUANTITIES 1 / 2

DATE	REVISION



SCALED FOR  
11"X17" PAPER  
0' 0' 0'  
SCALE: N.T.S.

Date **1-13-23**  
Project **19-00269-00-RS**  
Designer **JSM**

SHEET  
**04**  
OF  
**22**



H:\Engineering\All Projects\MFT 19-00269-00-RS 7th Street, 12th to 16th Ave Resurfacing\Design Documents\Drawings\7thSt 12th-16thAve-Design.dwg

70300150	
SHORT TERM PAVEMENT MARKING REMOVAL	
ENTIRE PROJECT	53.3 SQ FT
TOTAL:	53.3 SQ FT

78000200		
THERMOPLASTIC PAVEMENT MARKING - LINE 4"		
STA. 0+24.5 - 0+34.5	10.0	FOOT
STA. 0+64.5 - 0+74.5	10.0	FOOT
STA. 1+44.5 - 1+54.5	10.0	FOOT
STA. 1+84.5 - 1+94.5	10.0	FOOT
STA. 2+24.5 - 2+34.5	10.0	FOOT
STA. 2+64.5 - 2+74.5	10.0	FOOT
STA. 3+04.5 - 3+14.5	10.0	FOOT
STA. 3+44.5 - 3+54.5	10.0	FOOT
STA. 3+84.5 - 3+94.5	10.0	FOOT
STA. 4+24.5 - 4+34.5	10.0	FOOT
STA. 4+64.5 - 4+74.5	10.0	FOOT
STA. 5+04.5 - 5+14.5	10.0	FOOT
STA. 5+44.5 - 5+54.5	10.0	FOOT
STA. 5+84.5 - 5+94.5	10.0	FOOT
STA. 6+24.5 - 6+34.5	10.0	FOOT
STA. 6+64.5 - 6+74.5	10.0	FOOT
STA. 7+04.5 - 7+14.5	10.0	FOOT
STA. 7+44.5 - 7+54.5	10.0	FOOT
STA. 7+84.5 - 7+94.5	10.0	FOOT
STA. 8+24.5 - 8+34.5	10.0	FOOT
STA. 8+64.5 - 8+74.5	10.0	FOOT
STA. 9+04.5 - 9+14.5	10.0	FOOT
STA. 9+44.5 - 9+54.5	10.0	FOOT
STA. 9+84.5 - 9+94.5	10.0	FOOT
STA. 10+24.5 - 10+34.5	10.0	FOOT
STA. 10+64.5 - 10+74.5	10.0	FOOT
STA. 11+04.5 - 11+14.5	10.0	FOOT
STA. 11+44.5 - 11+54.5	10.0	FOOT
STA. 11+84.5 - 11+94.5	10.0	FOOT
STA. 12+24.5 - 12+34.5	10.0	FOOT
STA. 12+64.5 - 12+74.5	10.0	FOOT
STA. 13+04.5 - 13+14.5	10.0	FOOT
TOTAL:	320.0	FOOT

78000400		
THERMOPLASTIC PAVEMENT MARKING - LINE 6"		
STA. 0+99.6 - 1+00.8	31.5	FOOT
STA. 1+06.0 - 1+07.3	38.2	FOOT
STA. 9+93.3 - 10+35.7	42.5	FOOT
STA. 9+98.3 - 10+32.9	34.5	FOOT
TOTAL:	146.7	FOOT

78000600		
THERMOPLASTIC PAVEMENT MARKING - LINE 12"		
STA. 1+00.2 - 1+06.1	8.2	FOOT
STA. 1+00.3 - 1+06.2	8.2	FOOT
STA. 1+00.5 - 1+06.4	8.2	FOOT
STA. 1+00.6 - 1+06.5	8.2	FOOT
STA. 1+00.7 - 1+06.6	8.2	FOOT
STA. 9+96.3 - 10+02.6	7.2	FOOT
STA. 10+01.9 - 10+08.2	7.1	FOOT
STA. 10+07.6 - 10+09.0	7.1	FOOT
STA. 10+13.2 - 10+19.5	7.0	FOOT
STA. 10+18.9 - 10+25.1	6.9	FOOT
STA. 10+24.6 - 10+30.7	6.9	FOOT
TOTAL:	83.2	FOOT

78000650		
THERMOPLASTIC PAVEMENT MARKING - LINE 24"		
STA. 0+94.5 - 0+96.5	14.0	FOOT
STA. 1+64.9 - 1+66.9	14.0	FOOT
STA. 10+19.9 - 10+30.9	11.0	FOOT
TOTAL:	39.0	FOOT

K1005421		
SEEDING (SPECIAL)		
ENTIRE PROJECT	0.25	ACRE.
TOTAL:	0.25	ACRE.

X4060995		
TEMPORARY RAMP, SPECIAL		
STA. 0+41.0 - 0+57.5/15.0' LT	3.6	SQ YD
STA. 1+39.9 - 1+72.7/15.0' RT	7.2	SQ YD
STA. 5+69.1 - 6+04.1/15.0' LT	7.8	SQ YD
STA. 7+42.6 - 7+72.8/15.0' RT	6.8	SQ YD
STA. 11+07.7 - 11+35.3/15.0' RT	6.2	SQ YD
STA. 11+82.1 - 12+15.3/15.0' RT	7.4	SQ YD
STA. 12+25.1 - 12+48.8/15.0' LT	5.2	SQ YD
STA. 12+33.1 - 12+69.9/15.0' RT	8.2	SQ YD
STA. 12+65.9 - 12+88.4/15.0' LT	5.0	SQ YD
STA. 13+12.3 - 13+34.3/15.0' RT	4.8	SQ YD
TOTAL:	62.2	SQ YD

X4401198		
HOT-MIX ASPHALT SURFACE REMOVAL VARIABLE DEPTH		
ENTIRE PROJECT	4327.2	SQ YD
TOTAL:	4327.2	SQ YD

XX009566		
COMBINATION CONCRETE CURB AND GUTTER, TYPE B-6.12 (ABUTTING EXISTING PAVEMENT)		
STA. 1+39.3 - 1+42.4 RT	13.0	FOOT
STA. 1+61.7 - 1+72.7 RT	11.0	FOOT
STA. 1+69.7 - 1+72.7 RT	13.0	FOOT
STA. 5+76.2 - 6+08.2 RT	32.0	FOOT
STA. 6+36.3 - 7+10.3 LT	74.0	FOOT
STA. 6+88.3 - 7+22.3 RT	34.0	FOOT
STA. 7+41.1 - 7+97.1 RT	56.0	FOOT
STA. 8+16.3 - 8+92.3 RT	76.0	FOOT
STA. 9+85.8 - 10+03.2 RT	27.0	FOOT
STA. 10+31.8 - 10+46.7 RT	30.0	FOOT
STA. 11+03.6 - 11+36.6 LT	33.0	FOOT
STA. 11+08.9 - 11+16.9 RT	8.0	FOOT
STA. 11+59.4 - 11+67.4 LT	8.0	FOOT
STA. 11+81.3 - 12+15.3 RT	34.0	FOOT
TOTAL:	449.0	FOOT



CITY OF MOLINE  
ENGINEERING DEPARTMENT  
(309) 524-2350  
3635 4TH AVENUE, MOLINE, IL 61265  
CITY ENGINEER - DAVID DRYER, P.E.

## 7TH STREET RESURFACING

12TH AVENUE - 16TH AVENUE  
SCHEDULE OF QUANTITIES 2 / 2

DATE	REVISION

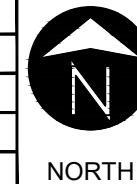

SCALED FOR  
11"X17" PAPER  
0' 0' 0'  
SCALE: N.T.S.

Date **1-13-23**  
Project **19-00269-00-RS**  
Designer **JSM**

SHEET  
**05**  
OF  
**22**

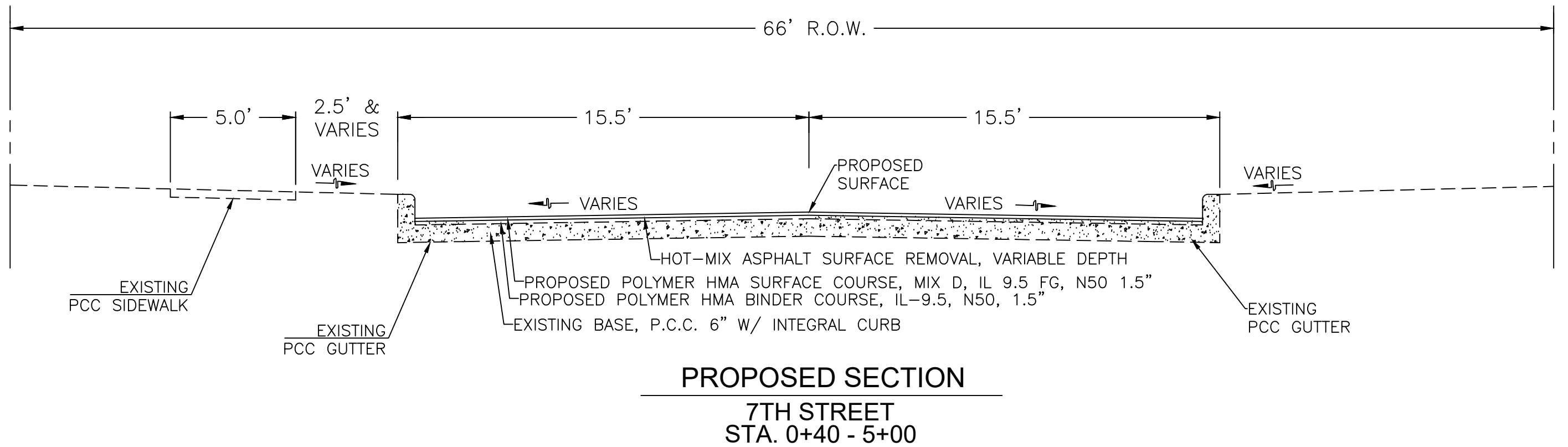
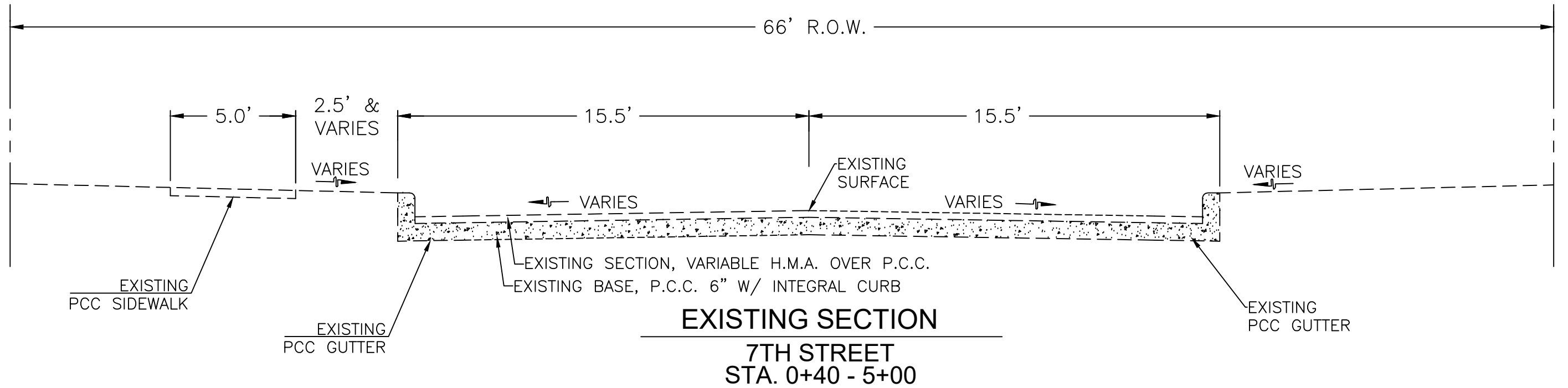

CITY OF MOLINE  
 ENGINEERING DEPARTMENT  
 (309) 524-2350  
 3635 4TH AVENUE, MOLINE, IL 61265  
 CITY ENGINEER - DAVID DRYER, P.E.

### 7TH STREET RESURFACING

12TH AVENUE - 16TH AVENUE  
 TYPICAL SECTION 1 / 4

DATE	REVISION

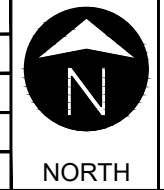

SCALED FOR  
 11"X17" PAPER  
 0' 0' 0'  
 SCALE: N.T.S.

Date **12-20-22**  
 Project **19-00269-00-RS**  
 Designer **JSM**

SHEET  
**06**  
 OF  
**22**

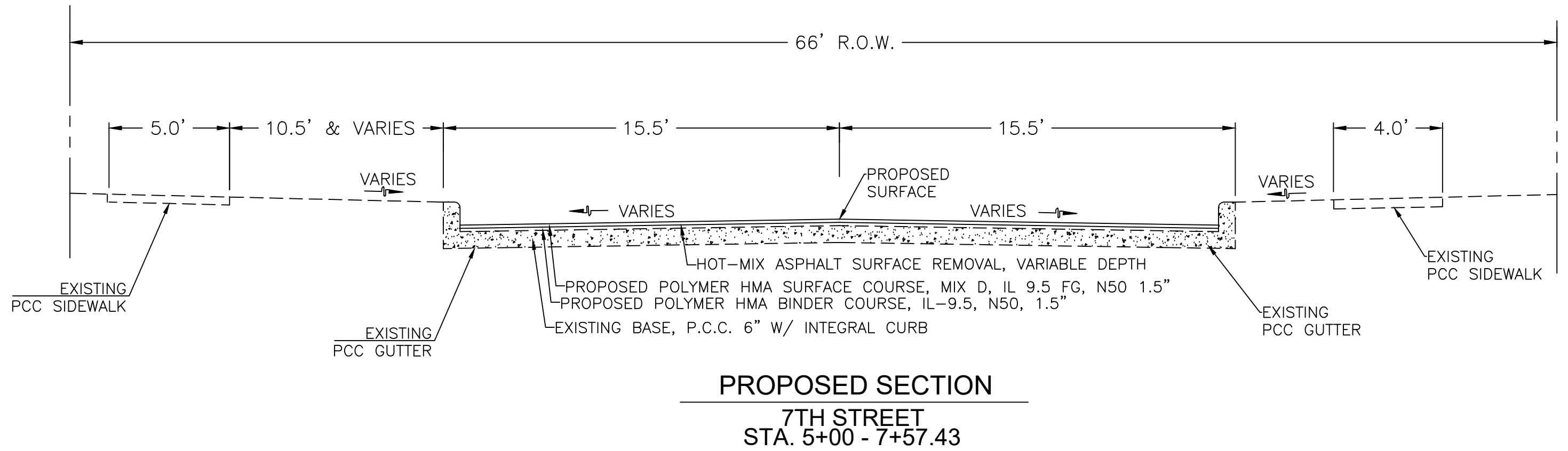
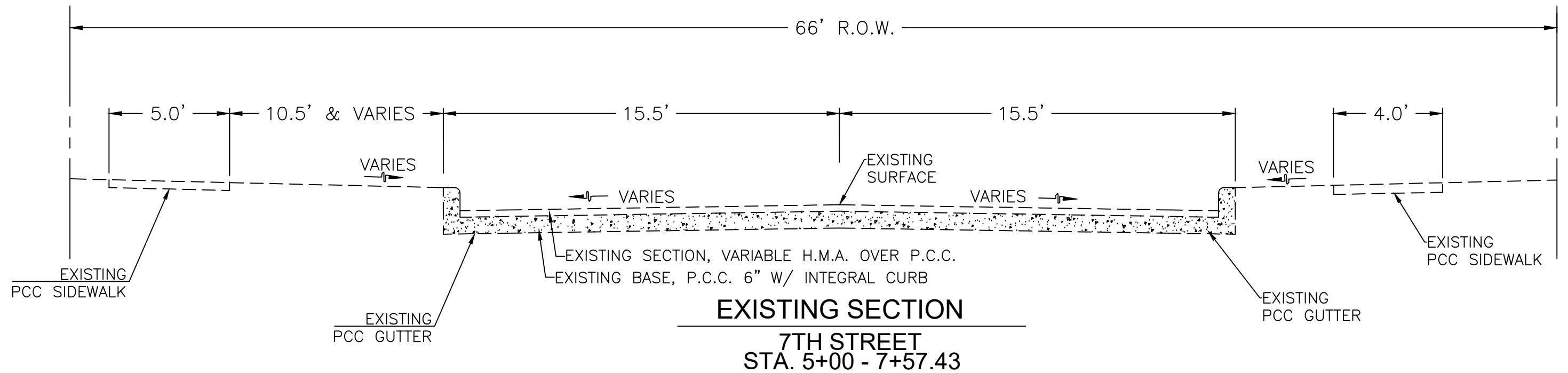

CITY OF MOLINE  
 ENGINEERING DEPARTMENT  
 (309) 524-2350  
 3635 4TH AVENUE, MOLINE, IL 61265  
 CITY ENGINEER - DAVID DRYER, P.E.

### 7TH STREET RESURFACING

12TH AVENUE - 16TH AVENUE  
 TYPICAL SECTION 2 / 4

DATE	REVISION

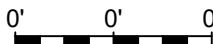

SCALED FOR  
 11"X17" PAPER  
  
 SCALE: N.T.S.

Date **12-20-22**  
 Project **19-00269-00-RS**  
 Designer **JSM**

SHEET  
**07**  
 OF  
**22**



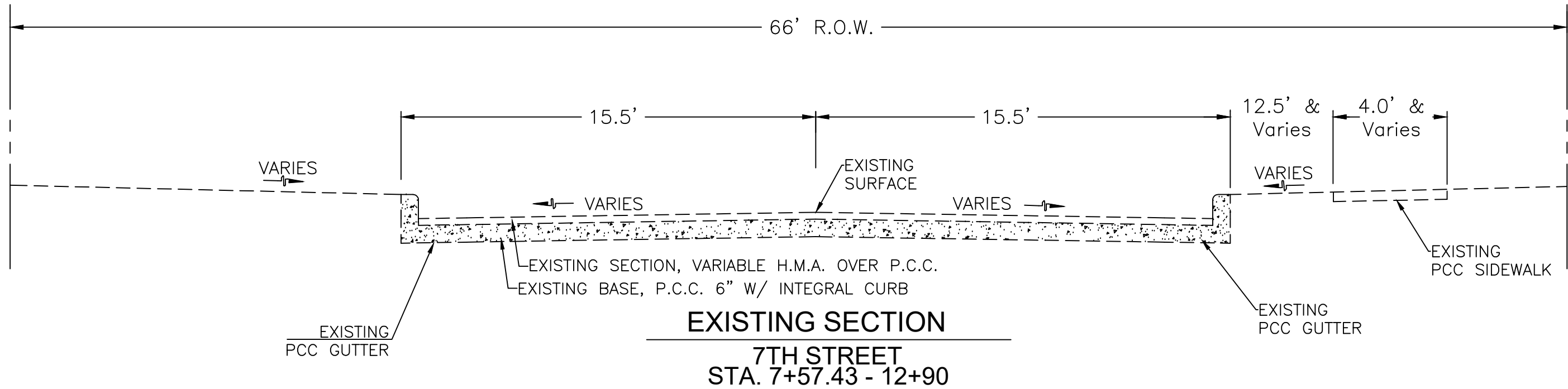

**EXISTING SECTION**  
**7TH STREET**  
**STA. 7+57.43 - 12+90**

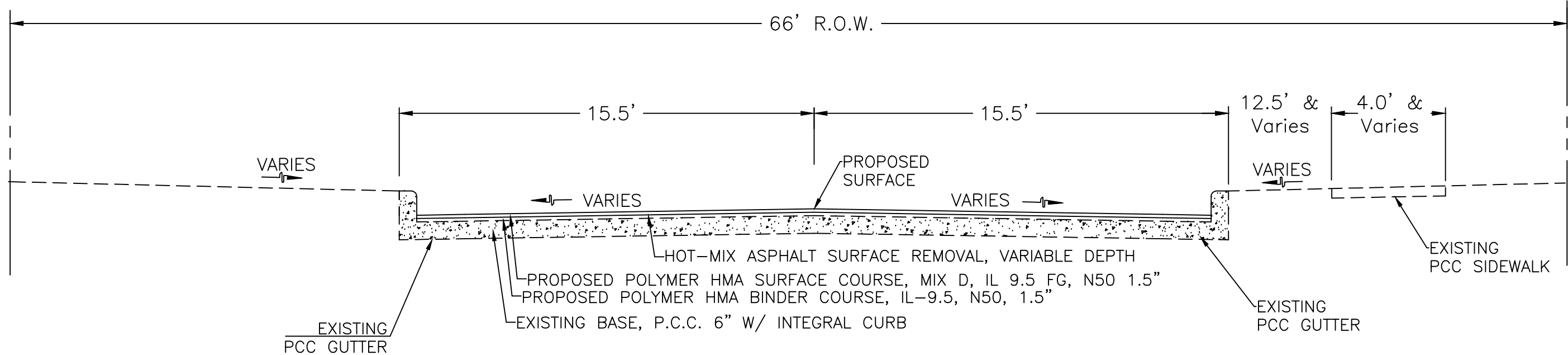

**PROPOSED SECTION**  
**7TH STREET**  
**STA. 7+57.43 - 12+90**



CITY OF MOLINE  
 ENGINEERING DEPARTMENT  
 (309) 524-2350  
 3635 4TH AVENUE, MOLINE, IL 61265  
 CITY ENGINEER - DAVID DRYER, P.E.

**7TH STREET RESURFACING**

12TH AVENUE - 16TH AVENUE  
 TYPICAL SECTION 3 / 4

DATE	REVISION

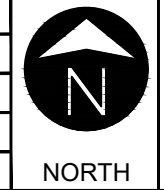

SCALED FOR  
 11"X17" PAPER  
 0' 0' 0'  
 SCALE: N.T.S.

Date **12-20-22**  
 Project **19-00269-00-RS**  
 Designer **JSM**

SHEET  
**08**  
 OF  
**22**

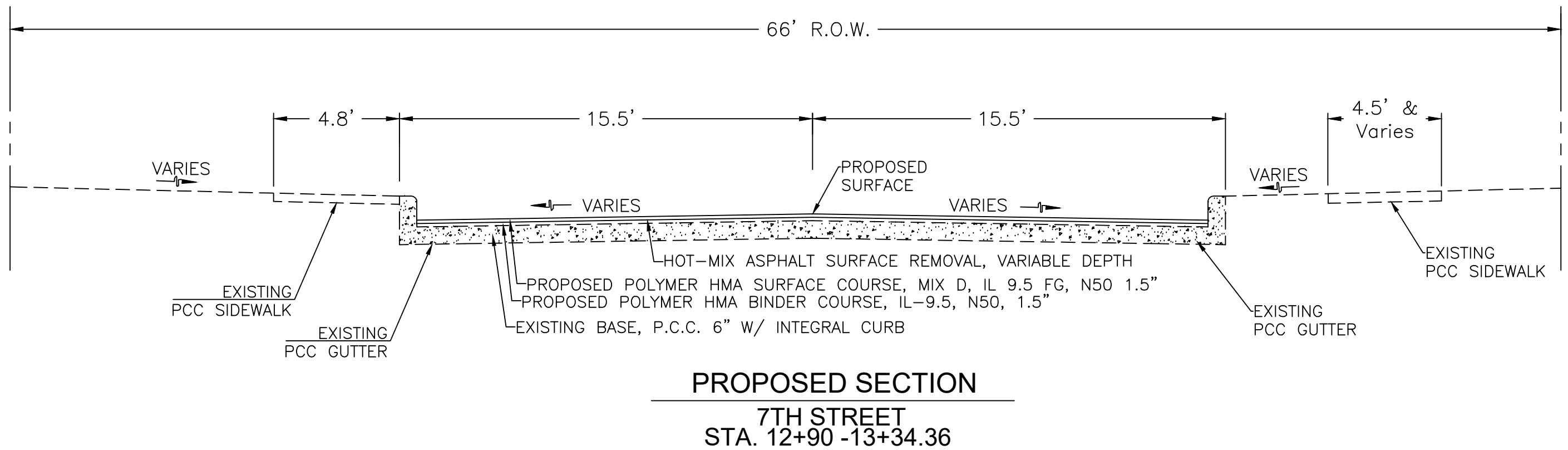
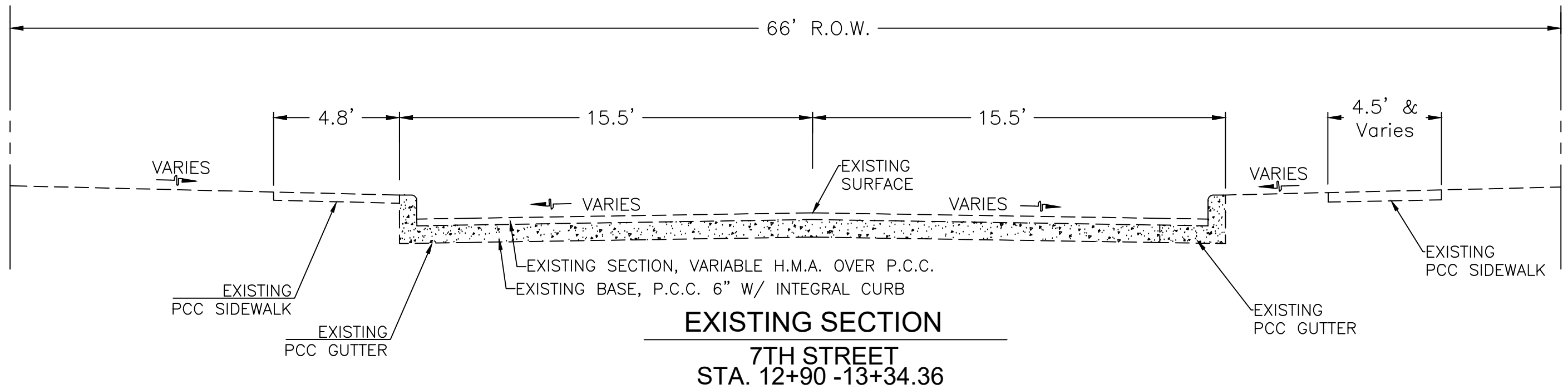

CITY OF MOLINE  
ENGINEERING DEPARTMENT  
(309) 524-2350  
3635 4TH AVENUE, MOLINE, IL 61265  
CITY ENGINEER - DAVID DRYER, P.E.

**7TH STREET RESURFACING**

12TH AVENUE - 16TH AVENUE  
TYPICAL SECTION 4 / 4

DATE	REVISION

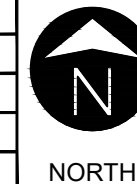

SCALED FOR  
11"X17" PAPER  
0' 0' 0'  
SCALE: N.T.S.

Date **1-13-23**  
Project **19-00269-00-RS**  
Designer **JSM**

SHEET  
**09**  
OF  
**22**

H:\Engineering\All Projects\MFT 19-00269-00-RS 7th Street, 12th to 16th Ave Resurfacing\Design Documents\Drawings\7thst 12th-16thAve-Design.dwg

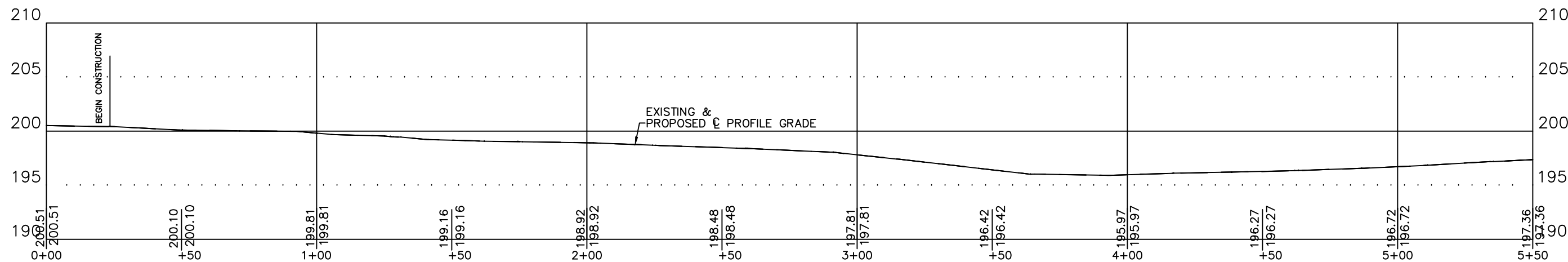
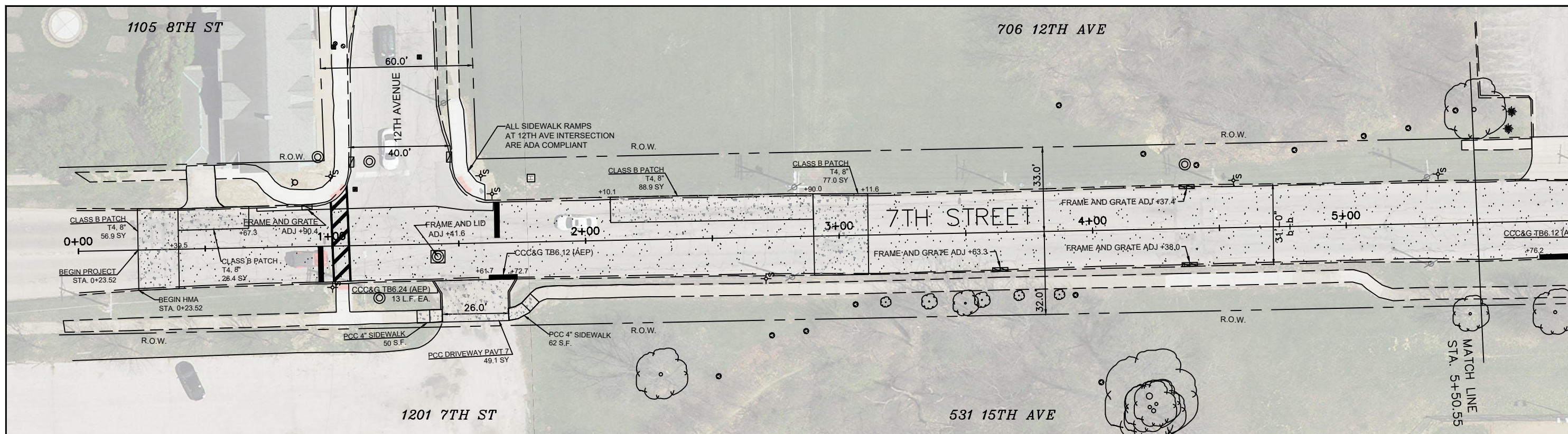

CITY OF MOLINE  
 ENGINEERING DEPARTMENT  
 (309) 524-2350  
 3635 4TH AVENUE, MOLINE, IL 61265  
 CITY ENGINEER - DAVID DRYER, P.E.

## 7TH STREET RESURFACING

12TH AVENUE - 16TH AVENUE  
 PLAN AND PROFILE (1 OF 3)

DATE	REVISION



SCALED FOR  
 11"X17" PAPER  
 0' 20' 40'  
 SCALE: 1" = 40'

Date **1-17-23**  
 Project **19-00269-00-RS**  
 Designer **JSM**

SHEET  
**10**  
 OF  
**22**



H:\Engineering\All Projects\MFT 19-00269-00-RS 7th Street, 12th to 16th Ave Resurfacing\Design Documents\Drawings\7thSt 12th-16thAve-Design.dwg

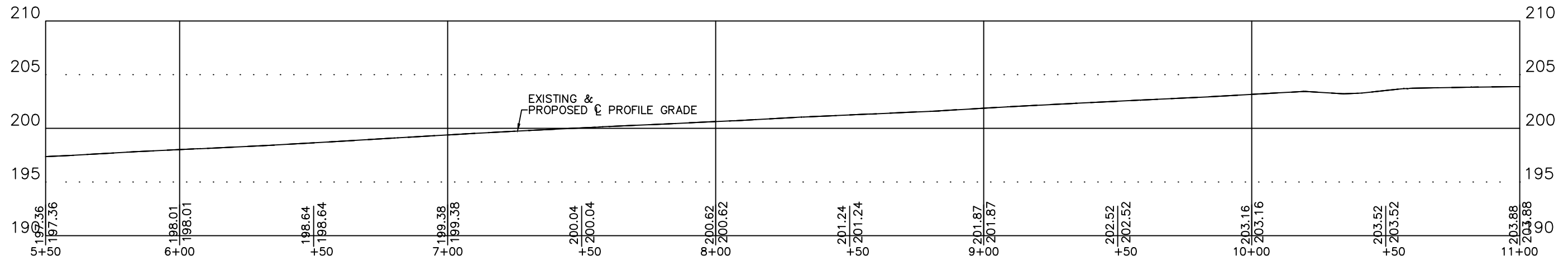
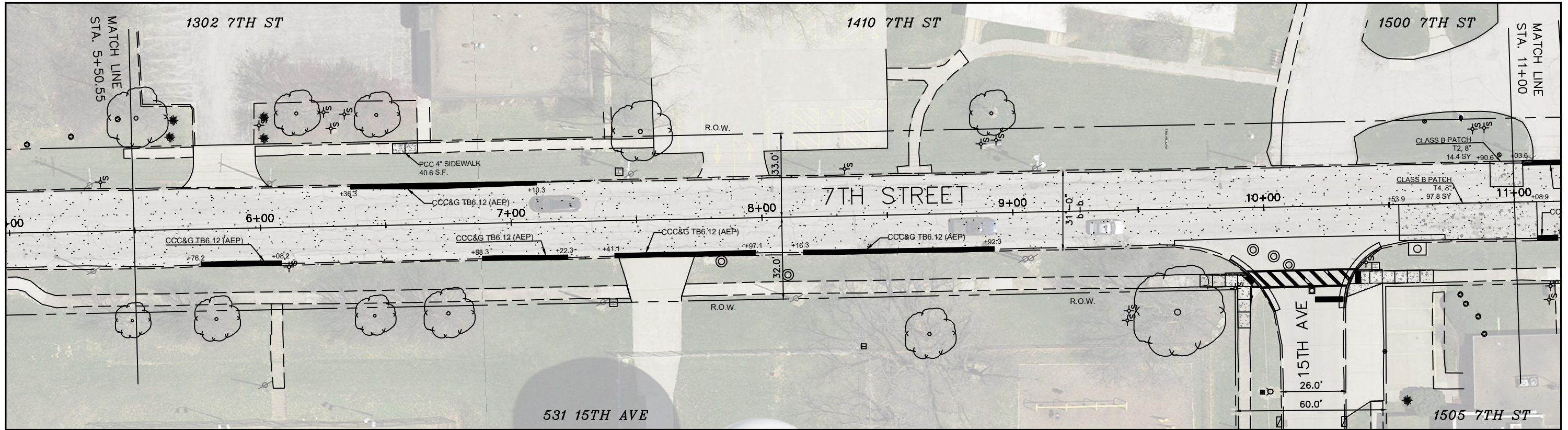

CITY OF MOLINE  
 ENGINEERING DEPARTMENT  
 (309) 524-2350  
 3635 4TH AVENUE, MOLINE, IL 61265  
 CITY ENGINEER - DAVID DRYER, P.E.

## 7TH STREET RESURFACING

12TH AVENUE - 16TH AVENUE  
 PLAN AND PROFILE (2 OF 3)

DATE	REVISION



SCALED FOR  
 11"X17" PAPER  
 0' 20' 40'  
 SCALE: 1" = 40'

Date **01-17-23**  
 Project **19-00269-00-RS**  
 Designer **JSM**

SHEET  
**11**  
 OF  
**22**



H:\Engineering\All Projects\MFT 19-00269-00-RS 7th Street, 12th to 16th Ave Resurfacing\Design Documents\Drawings\7thSt 12th-16thAve-Design.dwg

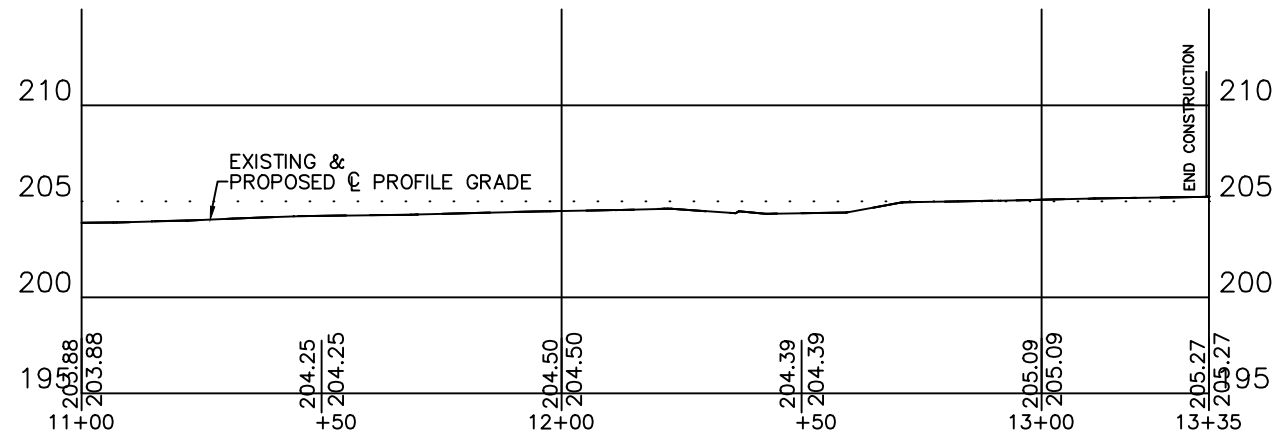
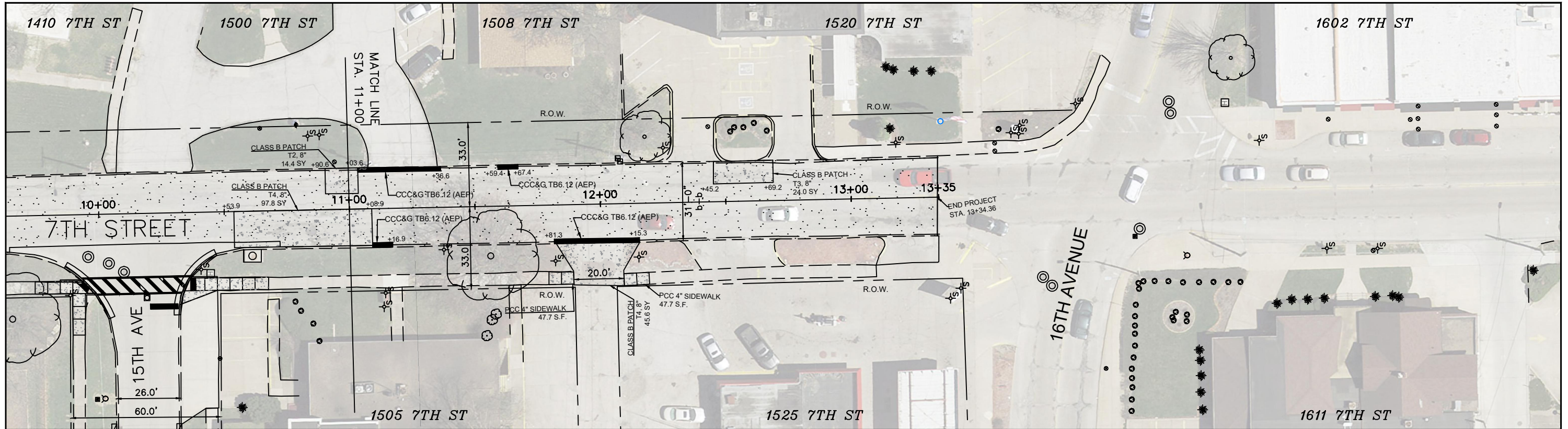

CITY OF MOLINE  
 ENGINEERING DEPARTMENT  
 (309) 524-2350  
 3635 4TH AVENUE, MOLINE, IL 61265  
 CITY ENGINEER - DAVID DRYER, P.E.

### 7TH STREET RESURFACING

12TH AVENUE - 16TH AVENUE  
 PLAN AND PROFILE (3 OF 3)

DATE	REVISION



SCALED FOR  
 11"X17" PAPER  
 0' 20' 40'  
 SCALE: 1" = 40'

Date **12-20-22**  
 Project **19-00269-00-RS**  
 Designer **JSM**

SHEET  
**12**  
 OF  
**22**

H:\Engineering\All Projects\MFT 19-00269-00-RS 7th Street, 12th to 16th Ave Resurfacing\Design Documents\Drawings\7thst 12th-16thAve-Design.dwg



ADA POINT TABLE			
POINT #	STA.	OFFSET	ELEVATION
0	10+32.85	31.10 RT	203.31
1	10+35.39	26.11 RT	203.24
2	10+33.48	31.11 RT	203.33
3	10+36.09	26.12 RT	203.28
4	10+41.72	26.14 RT	203.54
5	10+41.69	31.14 RT	203.61
6	10+46.72	26.15 RT	203.77
7	10+46.70	31.15 RT	203.84
8	10+51.72	26.17 RT	203.85
9	10+51.70	31.17 RT	203.92
10	10+56.72	26.17 RT	203.98
11	10+56.70	31.19 RT	204.05
12	10+46.71	17.35 RT	203.75
13	10+38.10	31.12 RT	203.44
14	10+38.09	26.12 RT	203.37
15	10+36.07	31.12 RT	203.35
16	10+31.47	36.60 RT	203.14
17	10+32.09	36.38 RT	203.44
18	10+31.25	40.59 RT	203.10
19	10+31.83	40.58 RT	203.22
20	10+46.48	16.81 RT	203.42
21	10+61.70	31.21 RT	204.06
22	10+61.71	26.21 RT	203.98
23	10+67.05	31.38 RT	204.01
24	10+67.20	26.38 RT	203.92
25	10+30.93	47.67 RT	203.02
26	10+61.04	14.47 RT	202.98



CITY OF MOLINE  
 ENGINEERING DEPARTMENT  
 (309) 524-2350  
 3635 4TH AVENUE, MOLINE, IL 61265  
 CITY ENGINEER - DAVID DRYER, P.E.

**7TH STREET RESURFACING**  
 7TH STREET AND 15TH AVENUE  
 ADA DETAIL (1 OF 3)

DATE	REVISION



SCALED FOR  
 11"X17" PAPER  
  
 SCALE: 1" = 6'

Date **2-03-23**  
 Project **19-00269-00-RS**  
 Designer **JSM**

SHEET  
**13**  
 OF  
**22**



H:\Engineering\All Projects\MFT 19-00269-00-RS 7th Street, 12th to 16th Ave Resurfacing\Design Documents\Drawings\7thSt 12th-16thAve-Design.dwg



ADA POINT TABLE			
POINT #	STA.	OFFSET	ELEVATION
0	9+98.48	31.70 LT	203.28
1	9+93.78	26.33 LT	203.31
2	9+97.77	31.71 LT	203.31
3	9+92.93	26.33 LT	203.31
4	9+93.94	36.52 LT	203.50
5	9+88.94	36.43 LT	203.57
6	9+93.84	41.52 LT	203.55
7	9+88.84	41.43 LT	203.62
8	9+89.14	26.32 LT	203.36
9	9+89.04	31.32 LT	203.43
10	9+84.13	26.38 LT	203.30
11	9+84.04	31.38 LT	203.38
12	9+79.13	26.28 LT	203.28
13	9+79.03	31.28 LT	203.34
14	9+93.68	47.91 LT	203.63
15	9+88.81	47.81 LT	203.69
16	9+73.98	26.37 LT	203.23
17	9+74.36	31.27 LT	203.35
18	9+89.87	26.32 LT	203.38
19	9+96.48	33.34 LT	203.34
20	9+86.12	20.58 LT	203.35
21	9+85.83	21.08 LT	203.41
22	10+03.73	41.42 LT	203.08
23	10+03.19	41.63 LT	203.46
24	9+94.04	31.42 RT	203.36
25	9+70.70	15.13 RT	202.81
26	10+04.82	47.12 RT	203.00

DETECTABLE WARNINGS INFORMATION:  
 RADIUS = 40.0 FT  
 CHORD LENGTH = 6.9 FT  
 ARC LENGTH = 6.9 FT  
 HEIGHT = 0.2 FT



CITY OF MOLINE  
 ENGINEERING DEPARTMENT  
 (309) 524-2350  
 3635 4TH AVENUE, MOLINE, IL 61265  
 CITY ENGINEER - DAVID DRYER, P.E.

### 7TH STREET RESURFACING

7TH STREET AND 15TH AVENUE  
 ADA DETAIL (2 OF 3)

DATE	REVISION



SCALED FOR  
 11"X17" PAPER  
  
 SCALE: 1" = 6'

Date **2-03-23**  
 Project **19-00269-00-RS**  
 Designer **JSM**

SHEET  
**14**  
 OF  
**22**

H:\Engineering\All Projects\MFT 19-00269-00-RS 7th Street, 12th to 16th Ave Resurfacing\Design Documents\Drawings\7thSt 12th-16thAve-Design.dwg

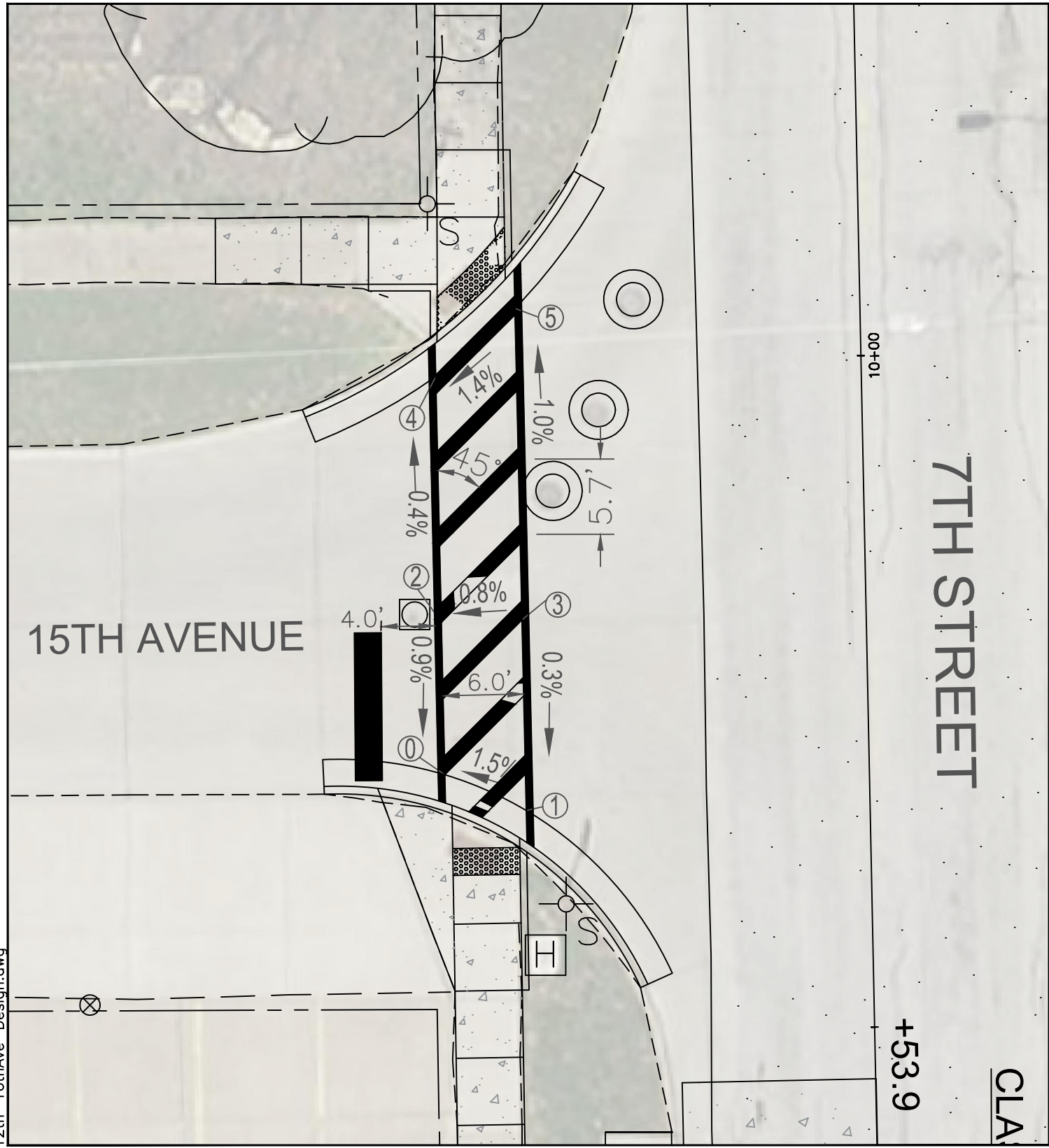

ADA POINT TABLE			
POINT #	STA.	OFFSET	ELEVATION
0	10+30.56	31.58 RT	203.20
1	10+33.03	26.13 LT	203.30
2	10+15.82	31.40 LT	203.30
3	10+15.79	26.22 LT	203.34
4	10+00.90	31.66 LT	203.23
5	9+96.59	26.32 LT	203.13



CITY OF MOLINE  
 ENGINEERING DEPARTMENT  
 (309) 524-2350  
 3635 4TH AVENUE, MOLINE, IL 61265  
 CITY ENGINEER - DAVID DRYER, P.E.

### 7TH STREET RESURFACING

7TH STREET AND 15TH AVENUE  
 ADA DETAIL (3 OF 3)

DATE	REVISION



SCALED FOR  
 11"X17" PAPER  
  
 SCALE: 1" = 10'

Date **1-13-23**  
 Project **19-00269-00-RS**  
 Designer **JSM**

SHEET  
**15**  
 OF  
**22**

20.0' MATCH  
EXISTING  
WIDTH

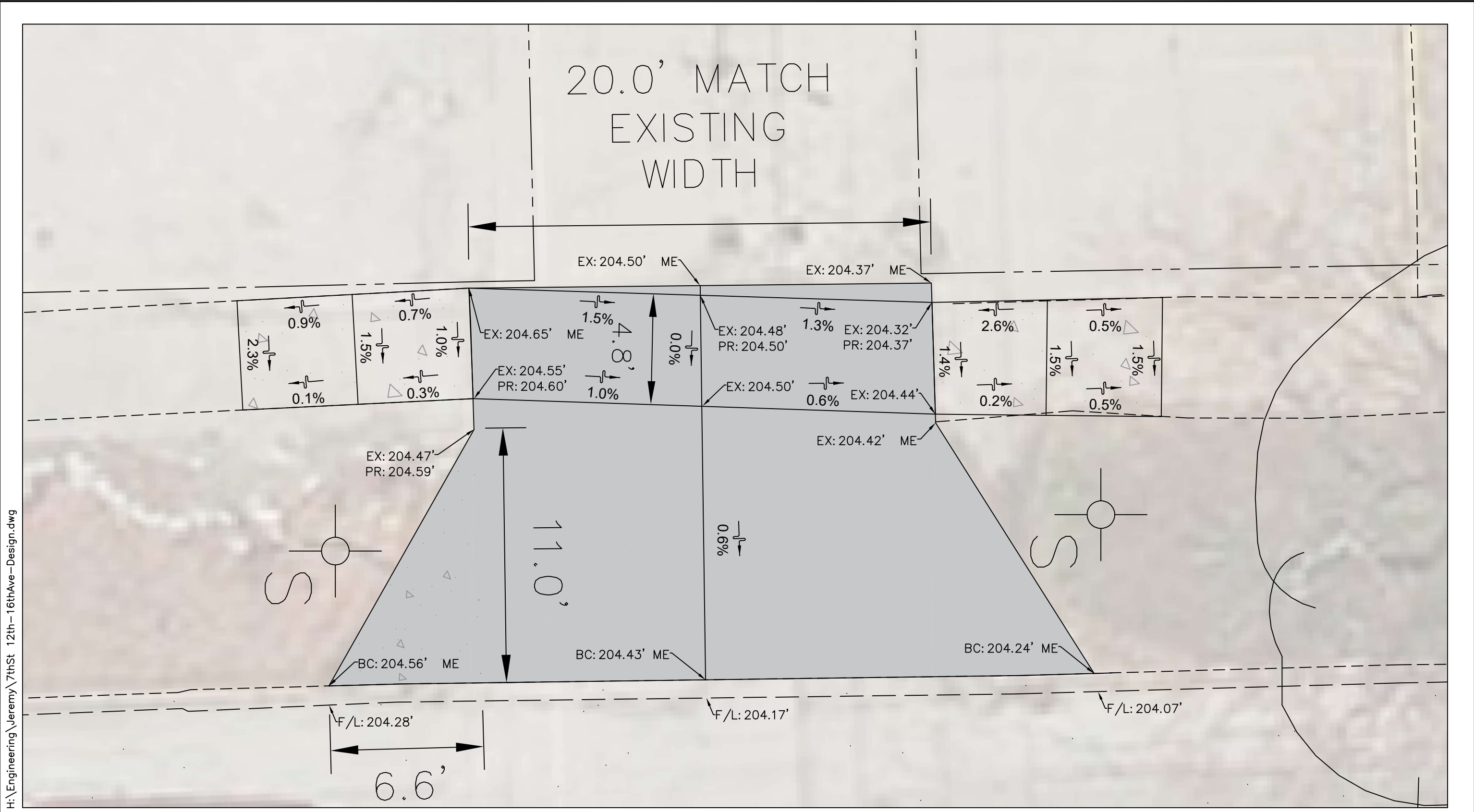

H:\Engineering\Jeremy\7thSt 12th - 16th Ave - Design.dwg



CITY OF MOLINE  
ENGINEERING DEPARTMENT  
(309) 524-2350  
3635 4TH AVENUE, MOLINE, IL 61265  
CITY ENGINEER - DAVID DRYER, P.E.

**7TH STREET RESURFACING**  
7TH STREET AND ALLEY  
ALLEY EXIT DETAIL STA. 11+81.3 - 12+15.3

DATE	REVISION



SCALED FOR  
11"X17" PAPER  
0' 2' 4'  
SCALE: 1" = 4'

Date **2-03-23**  
Project **19-00269-00-RS**  
Designer **JSM**

SHEET  
**16**  
OF  
**22**







H:\Engineering\All Projects\MFT 19-00269-00-RS 7th Street, 12th to 16th Ave Resurfacing\Design Documents\Drawings\7thSt 12th-16thAve-Design.dwg

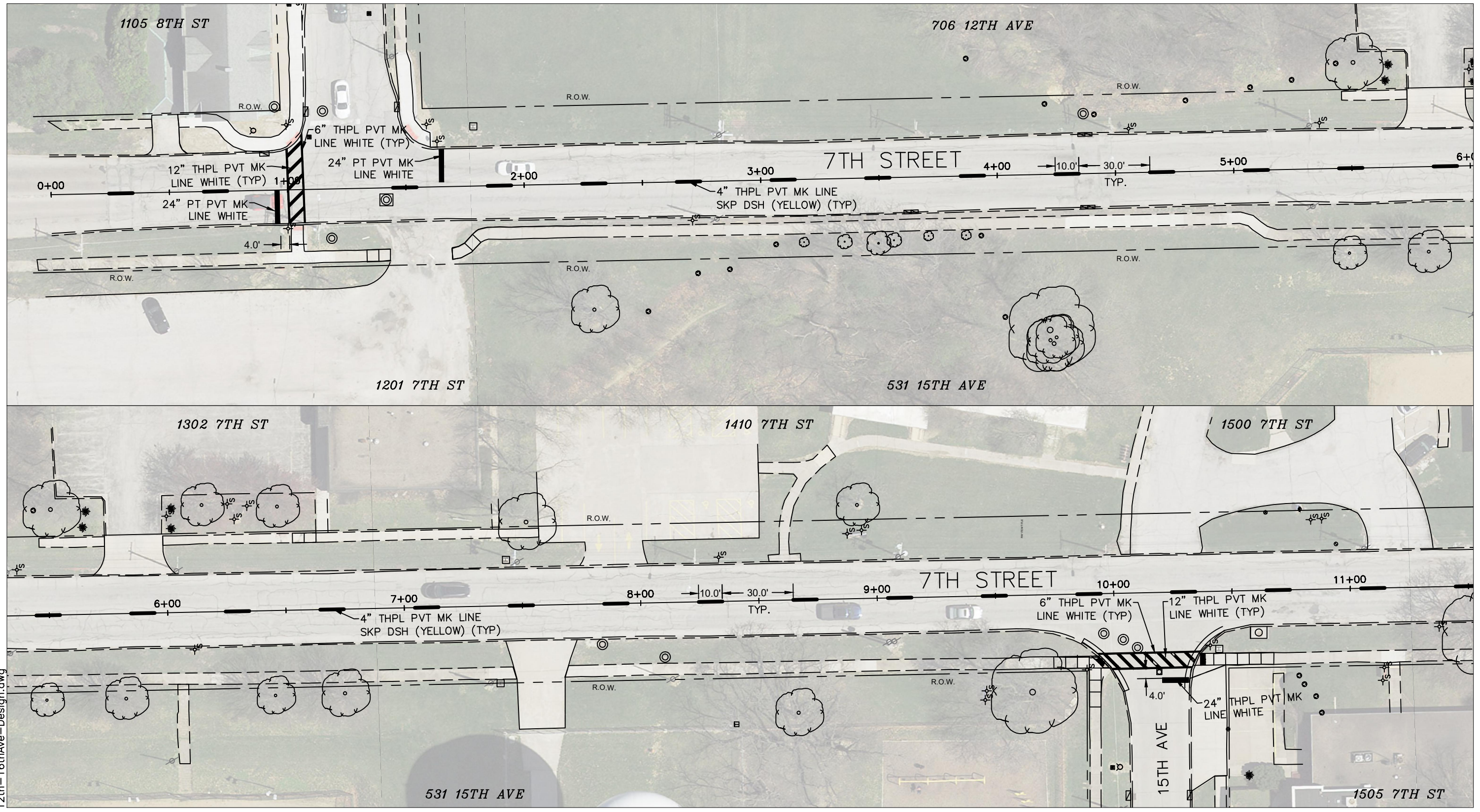

CITY OF MOLINE  
 ENGINEERING DEPARTMENT  
 (309) 524-2350  
 3635 4TH AVENUE, MOLINE, IL 61265  
 CITY ENGINEER - DAVID DRYER, P.E.

## 7TH STREET RESURFACING

12TH AVENUE - 16TH AVENUE  
 PAVEMENT MARKING PLAN 1 / 2

DATE	REVISION

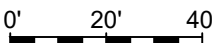

SCALED FOR  
 11"X17" PAPER  
  
 SCALE: 1" = 40'

Date **01-17-23**  
 Project **19-00269-00-RS**  
 Designer **JSM**

SHEET  
**18**  
 OF  
**22**



H:\Engineering\All Projects\MFT 19-00269-00-RS 7th Street, 12th to 16th Ave Resurfacing\Design Documents\Drawings\7thSt 12th-16thAve-Design.dwg

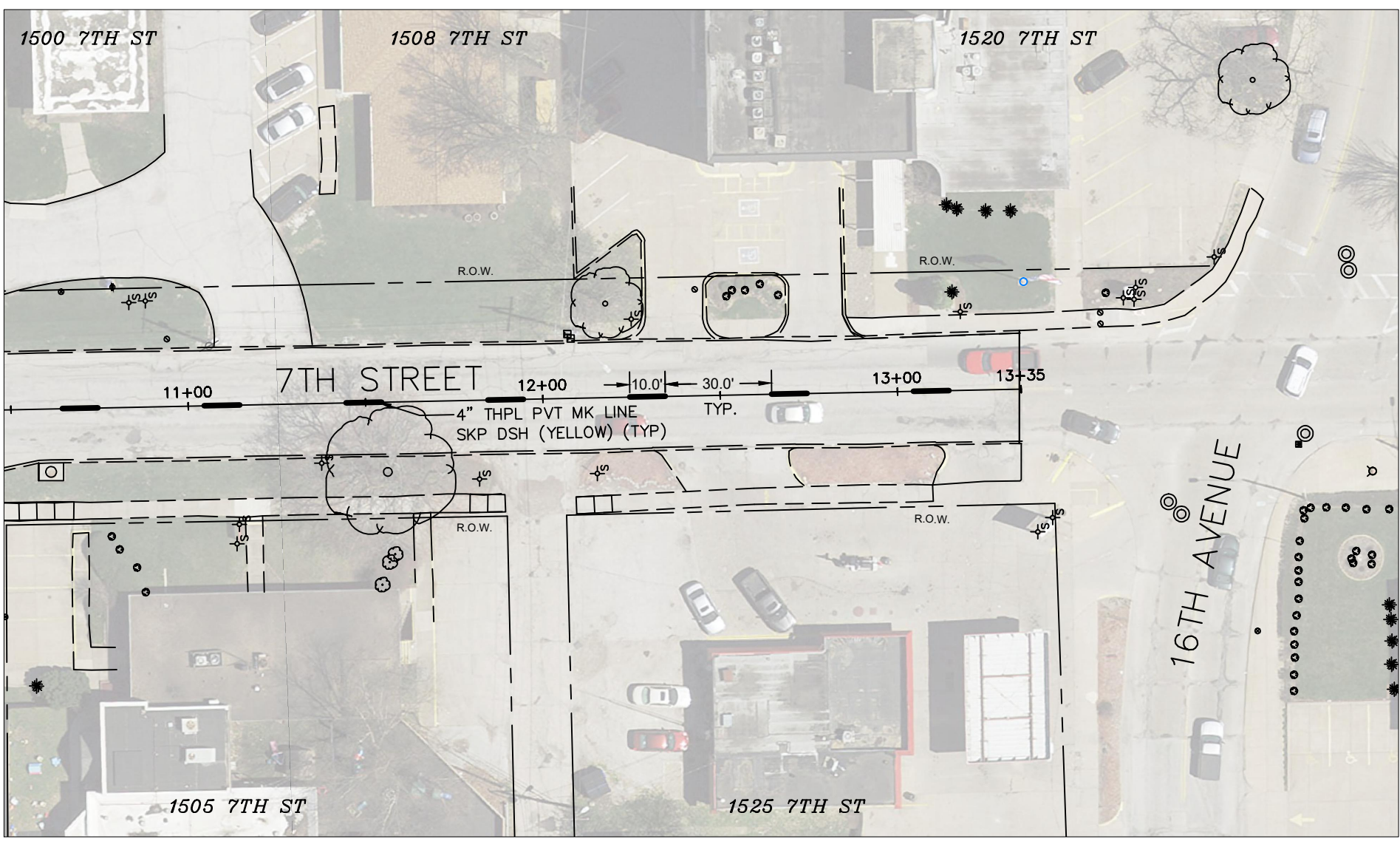

CROSSWALK STRIPING 7TH STREET NORTH OF 12TH AVENUE

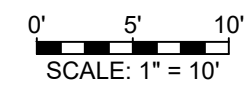
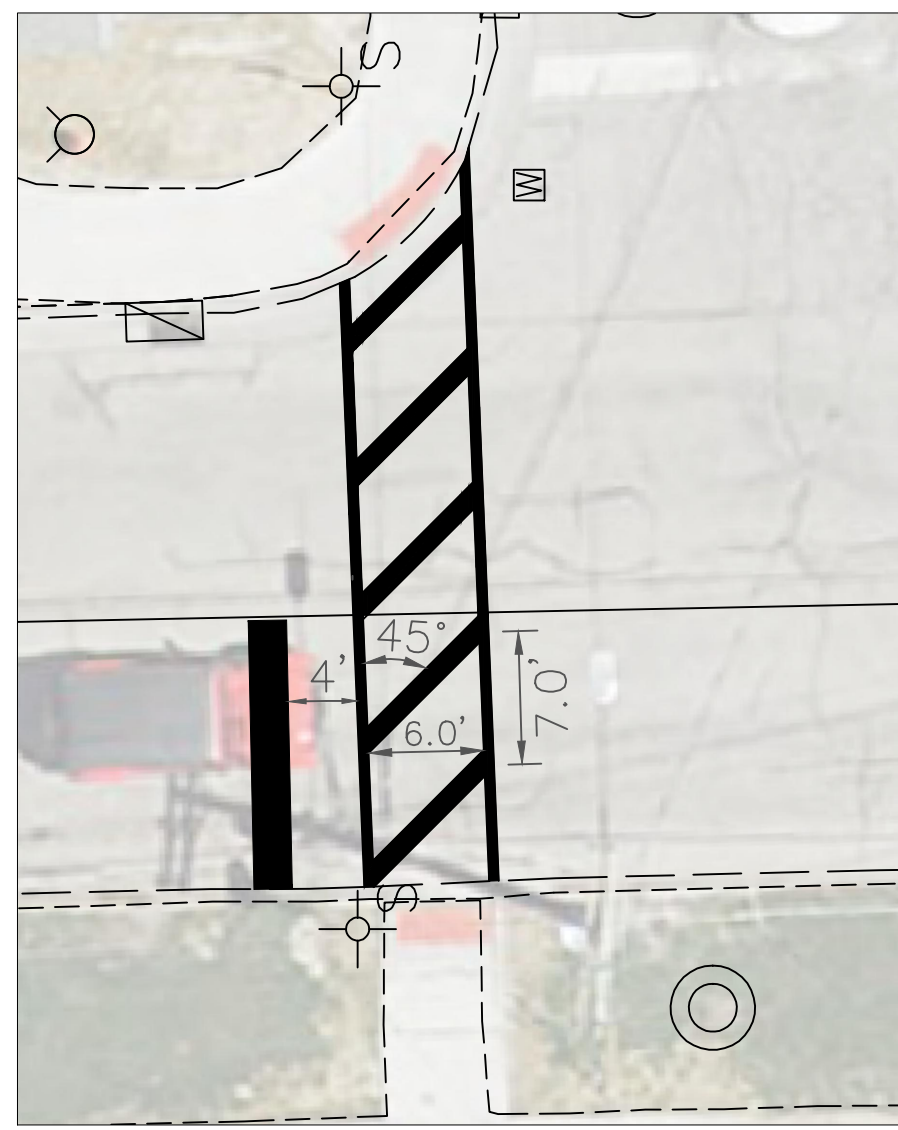

CITY OF MOLINE  
 ENGINEERING DEPARTMENT  
 (309) 524-2350  
 3635 4TH AVENUE, MOLINE, IL 61265  
 CITY ENGINEER - DAVID DRYER, P.E.

**7TH STREET RESURFACING**  
 12TH AVENUE - 16TH AVENUE  
 PAVEMENT MARKING PLAN 2 / 2

DATE	REVISION



SCALED FOR  
 11"X17" PAPER  
  
 SCALE: 1" = 20'

Date **1-17-23**  
 Project **19-00269-00-RS**  
 Designer **JSM**

SHEET  
**19**  
 OF  
**22**

H:\Engineering\All Projects\MFT 19-00269-00-RS 7th Street, 12th to 16th Ave Resurfacing\Design Documents\Drawings\7thSt 12th-16thAve-Design.dwg

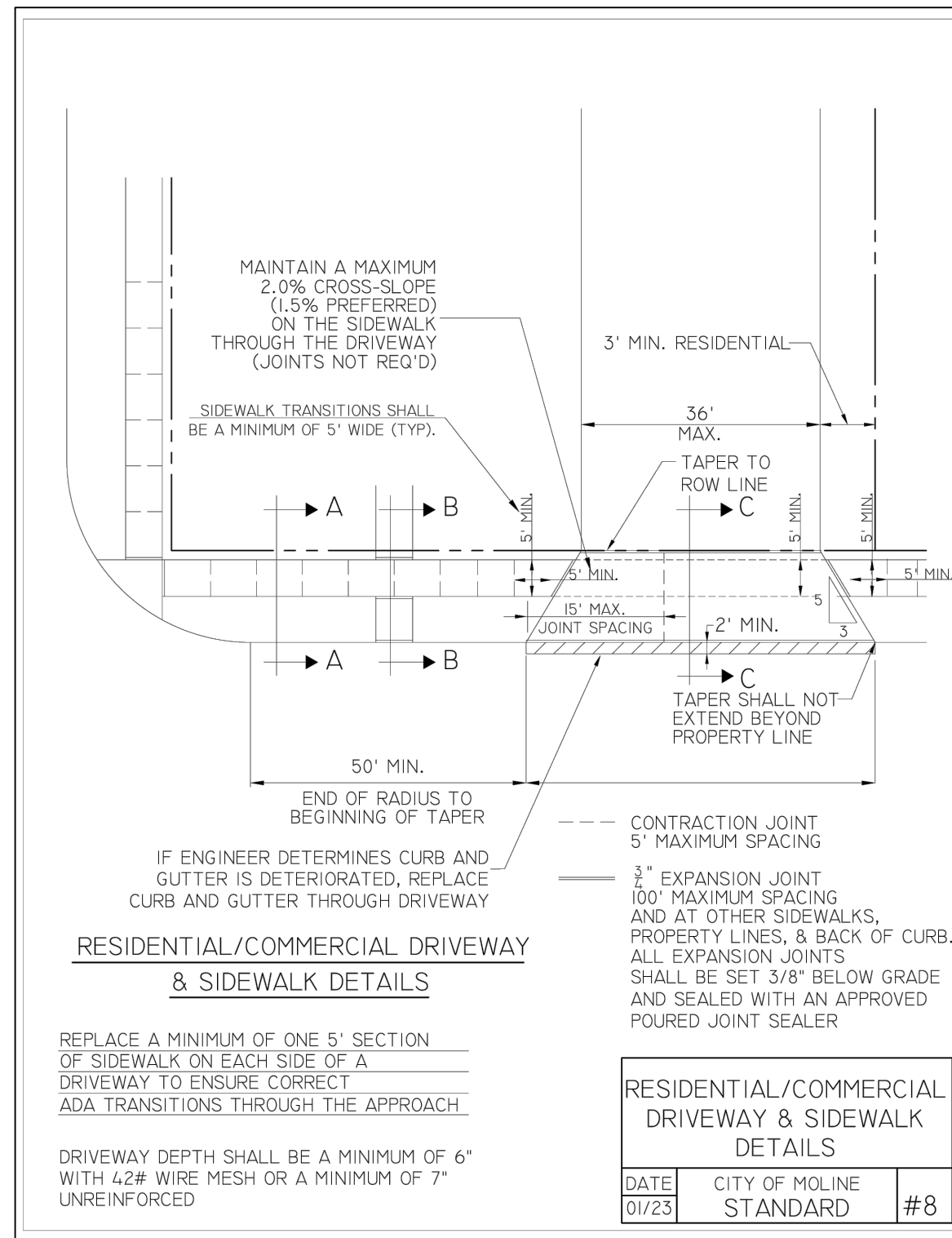
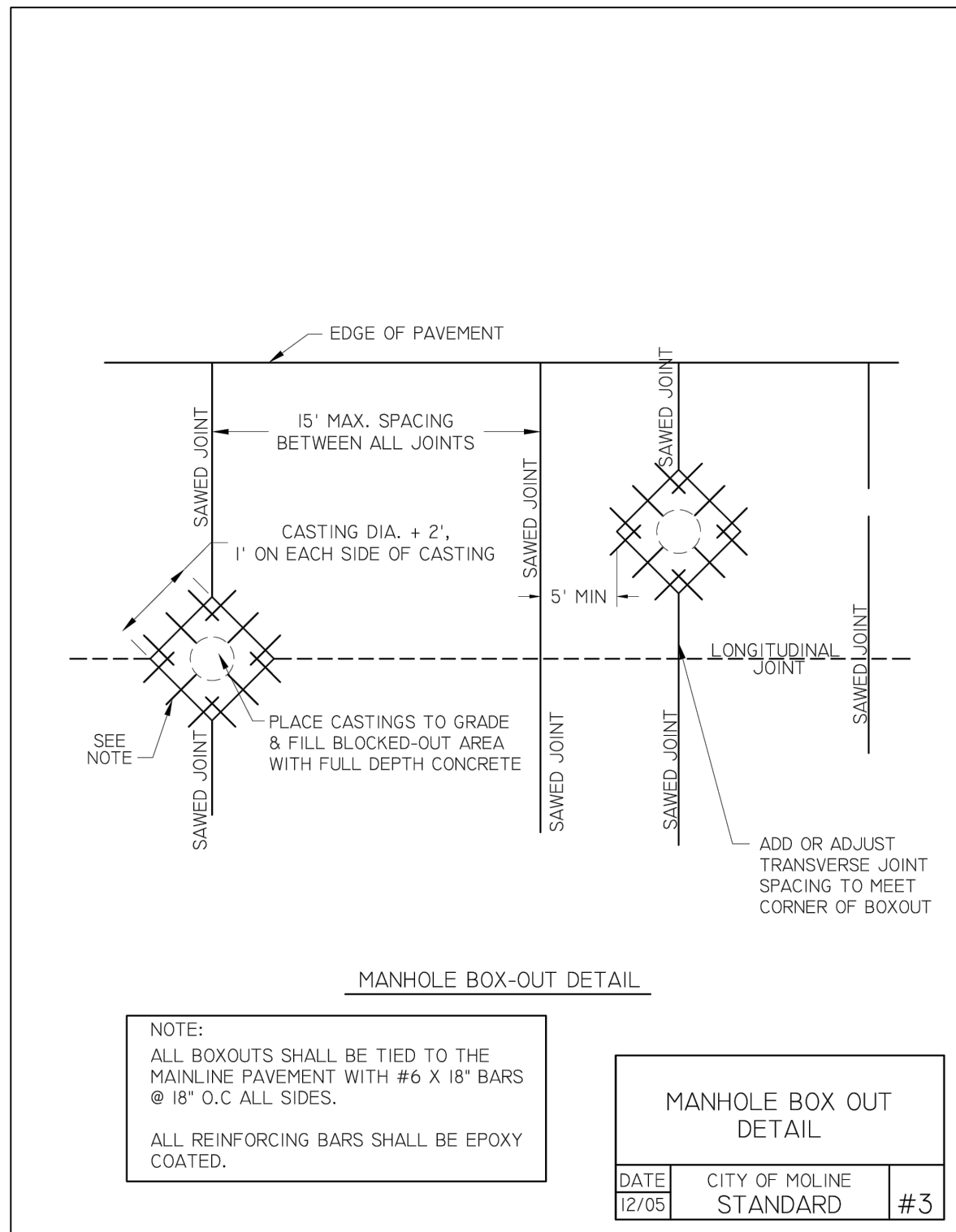

CITY OF MOLINE  
ENGINEERING DEPARTMENT  
(309) 524-2350  
3635 4TH AVENUE, MOLINE, IL 61265  
CITY ENGINEER - DAVID DRYER, P.E.

**7TH STREET RESURFACING**

12TH AVENUE - 16TH AVENUE  
CITY OF MOLINE DETAILS 1 / 3

DATE	REVISION



SCALED FOR 11"X17" PAPER

0' 0' 0'

SCALE: N.T.S.

Date **1-03-23**  
Project **19-00269-00-RS**  
Designer **JSM**

SHEET **20**  
OF  
**22**



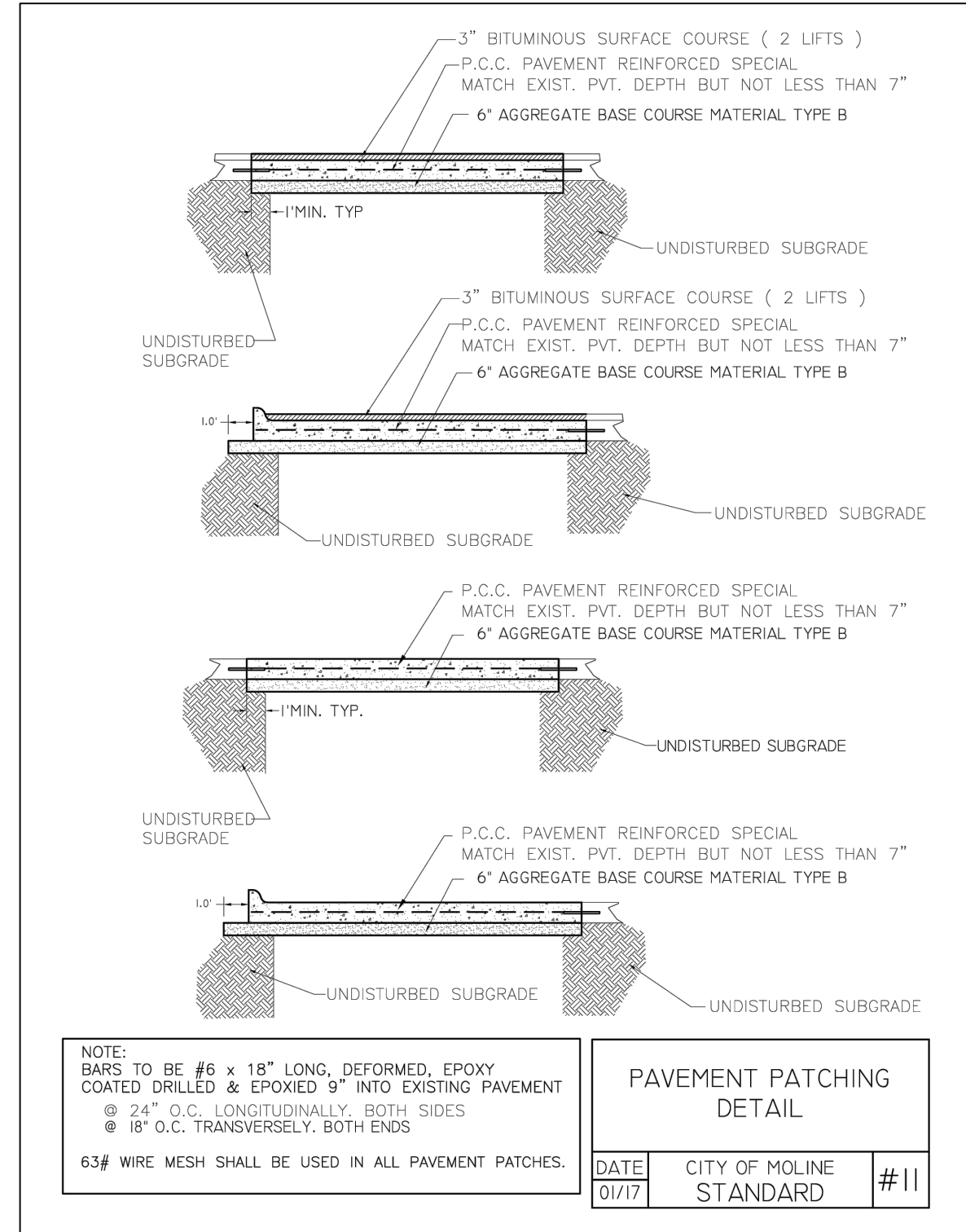
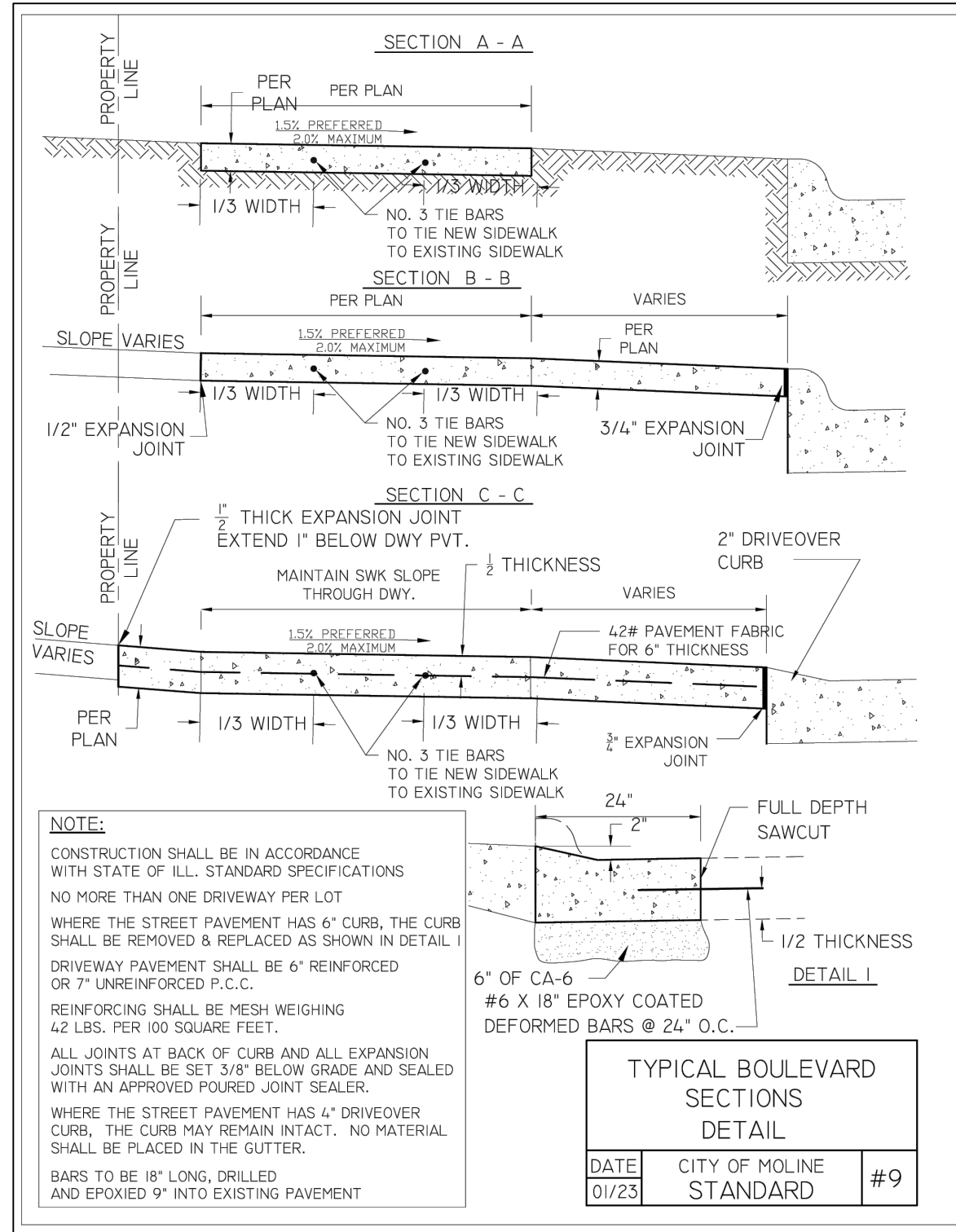

H:\Engineering\All Projects\MFT 19-00269-00-RS 7th Street, 12th to 16th Ave Resurfacing\Design Documents\Drawings\7thSt 12th-16thAve-Design.dwg



CITY OF MOLINE  
 ENGINEERING DEPARTMENT  
 (309) 524-2350  
 3635 4TH AVENUE, MOLINE, IL 61265  
 CITY ENGINEER - DAVID DRYER, P.E.

### 7TH STREET RESURFACING

12TH AVENUE - 16TH AVENUE  
 CITY OF MOLINE DETAILS 2 / 3

DATE	REVISION

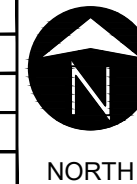

SCALED FOR  
 11"X17" PAPER  
 0' 0' 0'  
 SCALE: N.T.S.

Date	1-03-23
Project	19-00269-00-RS
Designer	JSM

SHEET  
**21**  
 OF  
**22**

H:\Engineering\All Projects\MFT 19-00269-00-RS 7th Street, 12th to 16th Ave Resurfacing\Design Documents\Drawings\7thSt 12th-16thAve-Design.dwg

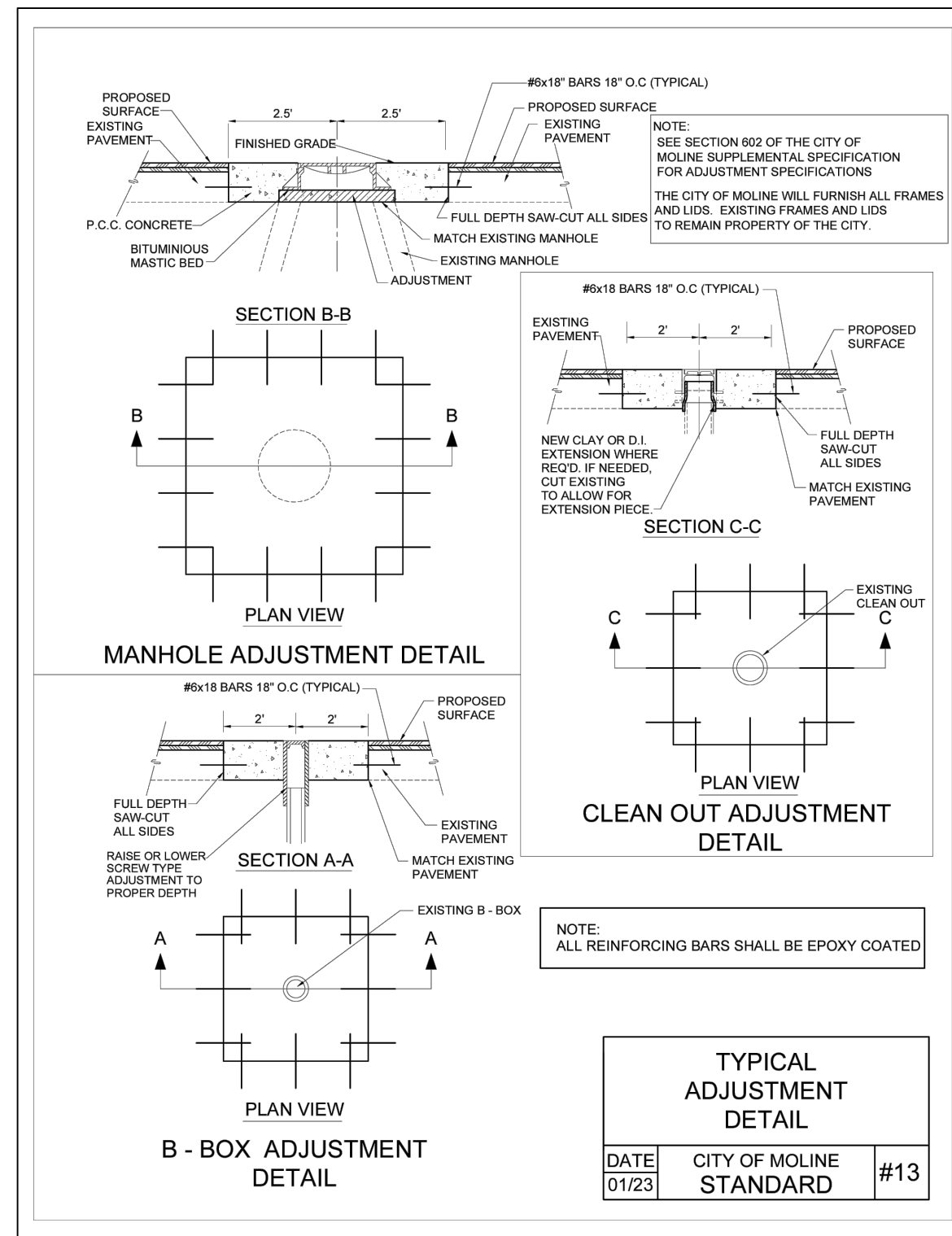
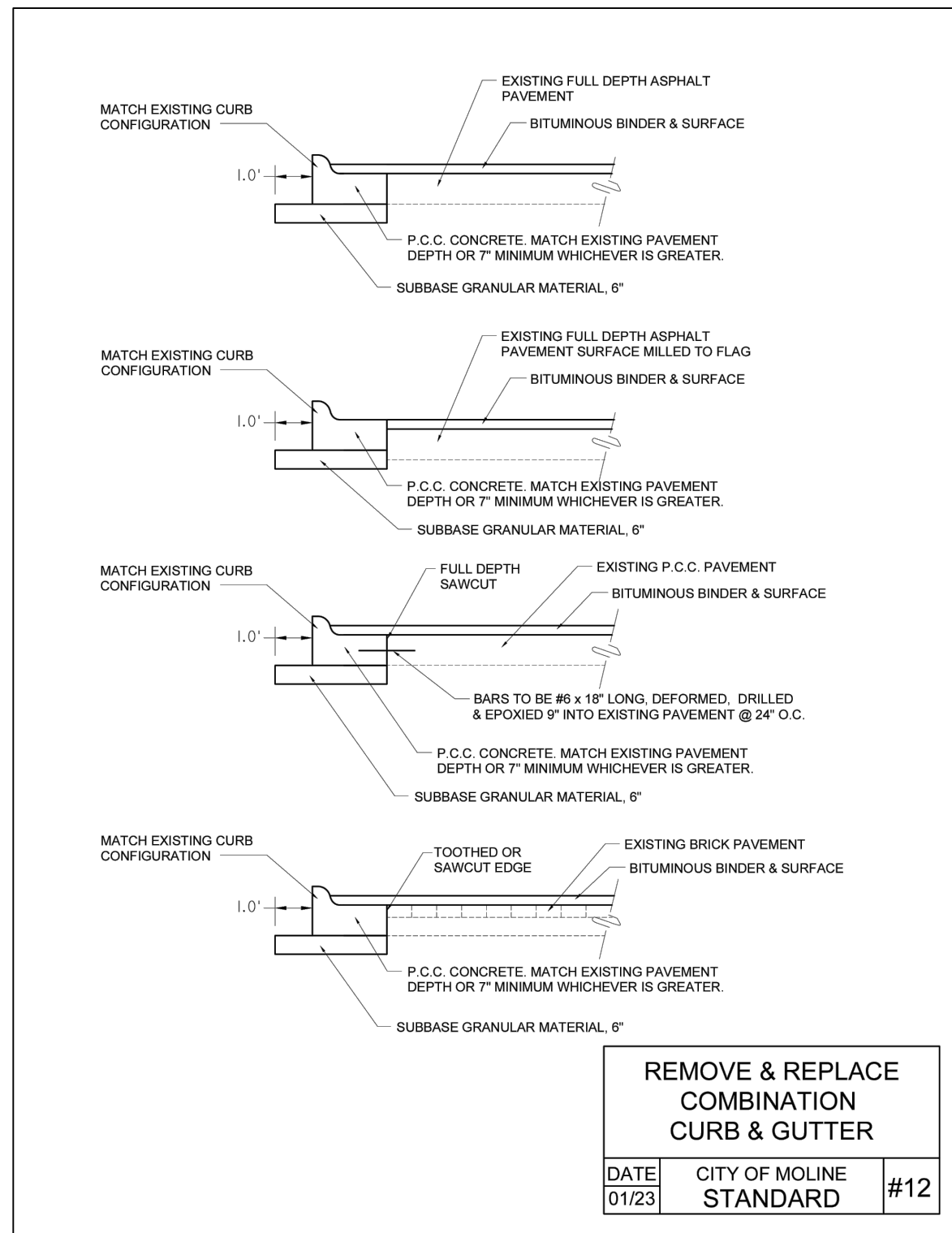

CITY OF MOLINE  
ENGINEERING DEPARTMENT  
(309) 524-2350  
3635 4TH AVENUE, MOLINE, IL 61265  
CITY ENGINEER - DAVID DRYER, P.E.

### 7TH STREET RESURFACING

12TH AVENUE - 16TH AVENUE  
CITY OF MOLINE DETAILS 3 / 3

DATE	REVISION



SCALED FOR  
11"X17" PAPER

0' 0' 0'

SCALE: N.T.S.

Date **1-03-23**  
Project **19-00269-00-RS**  
Designer **JSM**

SHEET  
**22**  
OF  
**22**