

F.A.P. RTE.	SECTION	COUNTY	TOTAL SHEETS	SHEET NO.
317	(46)SR,SLP	PEORIA	18	1
		ILLINOIS	CONTRACT NO. 68F26	

INDEX OF SHEETS

- 1 COVER SHEET
- 2 GENERAL NOTES
- 3-4 SUMMARY OF QUANTITIES
- 5-6 TYPICAL SECTIONS
- 7 SCHEDULE OF QUANTITIES
- 8 ALIGNMENT, BENCHMARKS, AND RECOVERY TIES
- 9 PLAN AND PROFILE SHEET
- 10-16 CROSS SECTIONS
- 17-18 DISTRICT STANDARDS

HIGHWAY STANDARDS

- 000001-08 701106-02
- 280001-07 701421-08
- 601001-05 701422-10
- 601101-02 701901-08
- 630001-12 782006-01
- 701101-05

DISTRICT STANDARDS

- 630101-D4

DESIGN DESIGNATION

- OTHER PRINCIPAL ARTERIAL
- ADT 16,800 (2019)
- SU 375 (2019)
- MU 700 (2019)

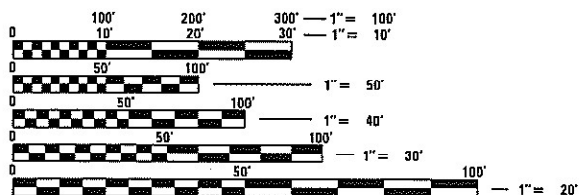

FULL SIZE PLANS HAVE BEEN PREPARED USING STANDARD ENGINEERING SCALES. REDUCED SIZED PLANS WILL NOT CONFORM TO STANDARD SCALES. IN MAKING MEASUREMENTS ON REDUCED PLANS, THE ABOVE SCALES MAY BE USED.

J.U.L.I.E.
JOINT UTILITY LOCATION INFORMATION FOR EXCAVATORS
1-800-892-0123
OR 811

PROJECT ENGINEER: BEN TELLEFSON (309) 671-3333
PROJECT MANAGER: ERIC PRICHARD (309) 671-3333
CATALOG NO. 035855-00D
CONTRACT NO. 68F26

STATE OF ILLINOIS
DEPARTMENT OF TRANSPORTATION
DIVISION OF HIGHWAYS
PROPOSED
HIGHWAY PLANS

FAP ROUTE 317 (US 24)
SECTION (46)SR,SLP
CONTRACT MAINTENANCE
PEORIA COUNTY

C-94-023-20

R 7 E

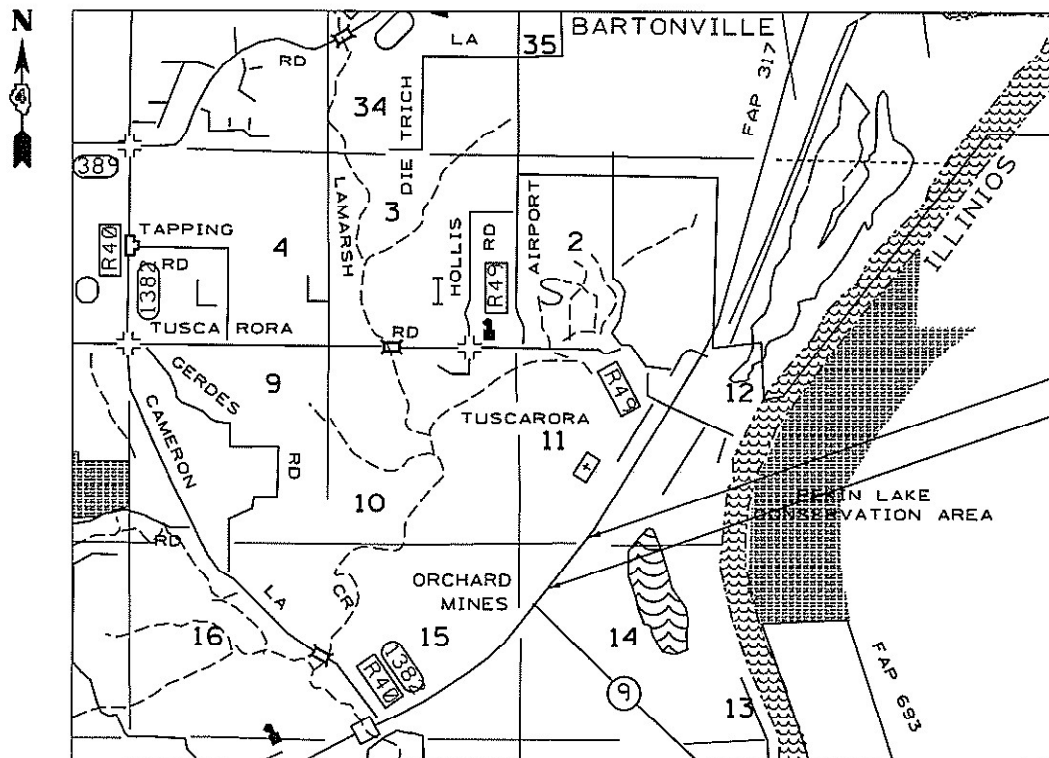

PROJECT BEGINS
STA. 239+00.00
PROJECT ENDS
STA. 244+50.00

GROSS LENGTH = 550.00 FT. = 0.104 MILE
NET LENGTH = 550.00 FT. = 0.104 MILE

MARK C. LEE DATE
REGISTERED PROFESSIONAL ENGINEER
STATE OF ILLINOIS NO. 062-060864
LICENSE EXPIRES NOVEMBER 30, 2023

KLINGNER
& ASSOCIATES, P.C.

Engineers • Architects • Surveyors
www.klingner.com

Galesburg, Illinois
49 North Prairie Street
309.342.4042

Quincy, IL Hannibal, MO
Burlington, IA Peella, IA Columbia, MO
Davenport, IA Carbondale, IL

DESIGN FIRM NO. 184-2738

D-94-016-20

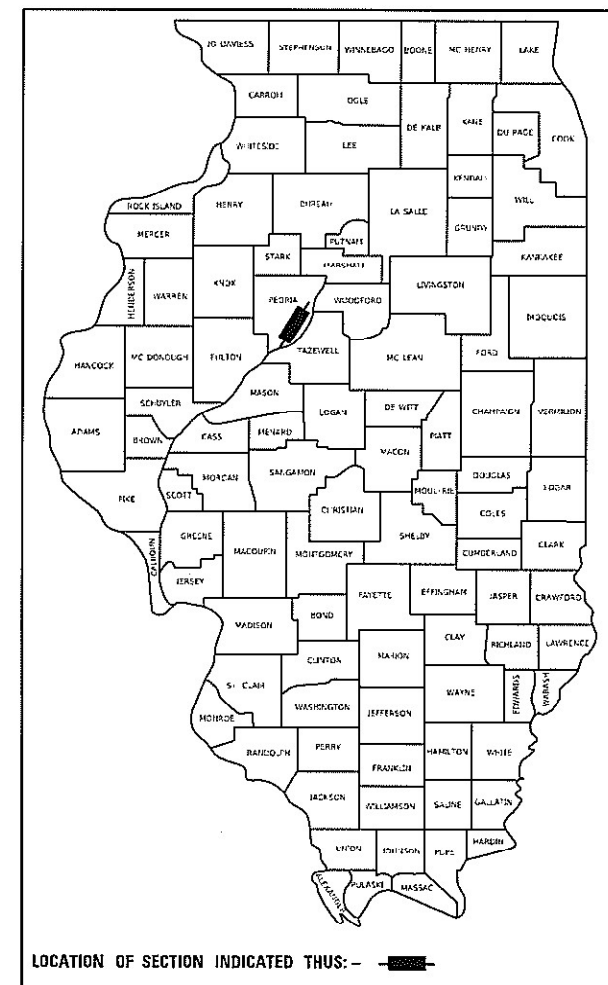

LOCATION OF SECTION INDICATED THUS: - [black rectangle] -

PROJECT DESCRIPTION

WORK ON THIS PROJECT CONSISTS OF SHOULDER REPAIR,
SLOPE GRADING AND GUARDRAIL REPLACEMENT

STATE OF ILLINOIS
DEPARTMENT OF TRANSPORTATION

SUBMITTED February 20 23
Kensil A. Doxsett, Inc.
REGIONAL ENGINEER

March 24, 2023
[Signature]
ENGINEER OF DESIGN AND ENVIRONMENT

March 24, 2023
[Signature]
DIRECTOR OF HIGHWAYS PROJECT IMPLEMENTATION

PRINTED BY THE AUTHORITY
OF THE STATE OF ILLINOIS

COMMITMENTS

COMMITMENTS ARE NOT TO BE ALTERED WITHOUT THE WRITTEN APPROVAL OF ALL PARTIES TO WHICH THE COMMITMENT WAS MADE. NO COMMITMENTS HAVE BEEN MADE ON THIS PROJECT.

GENERAL NOTES

AVAILABILITY OF ELECTRONIC FILES

MICRO STATION AND GEOPAK FILES OF THIS PROJECT WILL BE MADE AVAILABLE TO THE CONTRACTOR AFTER CONTRACT AWARD. IF THERE IS A CONFLICT BETWEEN THE ELECTRONIC FILES AND THE PRINTED CONTRACT PLANS AND DOCUMENTS, THE PRINTED CONTRACT PLANS AND DOCUMENTS SHALL TAKE PRECEDENCE OVER THE ELECTRONIC FILES. THE CONTRACTOR SHALL ACCEPT ALL RISK ASSOCIATED WITH USING THE ELECTRONIC FILES AND SHALL HOLD THE DEPARTMENT HARMLESS FOR ANY ERRORS OR OMISSIONS IN THE ELECTRONIC FILES AND THE DATA CONTAINED THEREIN. ERRORS OR DELAYS RESULTING FROM THE USE OF THE ELECTRONIC FILES BY THE CONTRACTOR SHALL NOT RESULT IN AN EXTENSION OF TIME FOR ANY INTERIM OR FINAL COMPLETION DATE OR SHALL NOT BE CONSIDERED CAUSE FOR ADDITIONAL COMPENSATION. THE CONTRACTOR SHALL NOT USE, SHARE, OR DISTRIBUTE THESE ELECTRONIC FILES EXCEPT FOR THE PURPOSE OF CONSTRUCTING THIS CONTRACT. ANY CLAIMS BY THIRD PARTIES DUE TO USE OR ERRORS SHALL BE THE RESPONSIBILITY OF THE CONTRACTOR. THE CONTRACTOR SHALL INCLUDE THIS DISCLAIMER WITH THE TRANSFER OF THESE ELECTRONIC FILES TO ANY OTHER PARTIES AND SHALL INCLUDE APPROPRIATE LANGUAGE BINDING THEM TO SIMILAR RESPONSIBILITIES.

PLAN ELEVATIONS - U. S. G. S. MEAN SEA LEVEL DATUM

ALL ELEVATIONS SHOWN ON THE PLANS ARE ESTABLISHED FROM U. S. G. S. MEAN SEA LEVEL DATUM.

ENGINEERS FIELD OFFICE

ADD THE FOLLOWING SENTENCE TO THE END OF PARAGRAPH 670.02 (I) AND 670.04 (E):
ALL OF THE TELEPHONE LINES PROVIDED SHALL HAVE UNPUBLISHED NUMBERS.

GENERAL NOTES (CONTINUED)

ENVIRONMENTAL REVIEWS

PRIOR TO THE USE OF ANY PROPOSED BORROW AREAS, USE AREAS (TEMPORARY ACCESS ROADS, DETOURS, RUN-AROUNDS, ETC.) AND / OR WASTE AREAS, THE CONTRACTOR SHALL FILE THE REQUIRED ENVIRONMENTAL RESOURCE REQUEST SURVEYS ACCORDING TO SECTION 107.22 OF THE STANDARD SPECIFICATIONS. THESE SURVEYS ARE REQUIRED IN ORDER FOR THE DEPARTMENT TO CONDUCT CULTURAL AND BIOLOGICAL RESOURCE SURVEYS FOR THE PROPOSED SITE.

PRIOR TO ANY WASTE MATERIALS BEING REMOVED FROM THE CONSTRUCTION SITE THE REQUIRED ENVIRONMENTAL RESOURCE SURVEYS WILL NEED TO BE OBTAINED AND FILED BY THE CONTRACTOR. EXCESS WASTE PRODUCTS REMOVED FROM THE CONSTRUCTION SITE SHALL BE DISPOSED OF AS REQUIRED IN SECTION 202.03 OF THE STANDARD SPECIFICATIONS.

ANY PROTRUDING METAL BARS SHALL BE REMOVED PRIOR TO THE DISPOSAL OF BROKEN CONCRETE AT APPROVED DISPOSAL SITES.

THE REQUIRED ENVIRONMENTAL RESOURCE DOCUMENTATION SHALL INCLUDE THE FOLLOWING:

- *BDE FORM 2289 (ENVIRONMENTAL SURVEY REQUEST)
- *BDE FORM 2290 (WASTE / USE AREA REVIEW)
- *A LOCATION MAP SHOWING THE SIZE LIMITS AND LOCATION OF THE USE AREA
- *COLOR PHOTOGRAPHS DEPICTING THE USE AREA
- *BORROW AREA ENTRY AGREEMENT FORM-D4 PI0101

PLEASE NOTE THAT A MINIMUM OF FOUR WEEKS SHALL BE ALLOWED FOR THE DISTRICT TO OBTAIN THE REQUIRED ENVIRONMENTAL CLEARANCES AND SIX WEEKS FOR THE REQUIRED BORROW SITE ENVIRONMENTAL CLEARANCES.

GENERAL NOTES (CONTINUED)

HOT-MIX ASPHALT MIXTURE REQUIREMENTS

LOCATION(S)	US 24	US 24
MIXTURE USE(S)	HMA SHOULDERS (TOP LIFT)	HMA SHOULDERS (BOTTOM LIFT)
PG:	58-28	58-28
DESIGN AIR VOIDS:	4.0% at N=50	4.0% at N=50
MIXTURE COMPOSITION: (MIXTURE GRADATION)	IL 9.5	IL 9.5
FRICTION AGGREGATE:	MIX C	N/A
MIXTURE WEIGHT:	112 LBS /SQ. YD /IN	112 LBS /SQ. YD /IN
QUALITY MANAGEMENT PROGRAM:	QC /QA	QC /QA

NOTE: HMA SHOULDERS SHALL BE PLACED IN TWO LIFTS, 2" MINIMUM REQUIRED.

JOB SPECIFIC NOTES

ROADWAY DAMAGE
ANY DAMAGE CAUSED TO THE ROADWAY BY CONSTRUCTION ACTIVITIES OR EQUIPMENT SHALL BE REPAIRED BY THE CONTRACTOR AT HIS OR HER EXPENSE. NO ADDITIONAL COMPENSATION FOR SUCH REPAIRS WILL BE ALLOWED.

MODEL Path: \\... \... \DOT - DSE1 - 4 - PTB 201603\Work Order 04 - Eastern DA118\Transportation\US 24\CAD Sheets\General Notes.dgn



USER NAME = ebb	DESIGNED -	REVISED -
	DRAWN -	REVISED -
PLOT SCALE = 100,0000 ' / in.	CHECKED -	REVISED -
PLOT DATE = 1/31/2023	DATE -	REVISED -

**STATE OF ILLINOIS
DEPARTMENT OF TRANSPORTATION**

**FAP RTE 317 (US 24)
GENERAL NOTES**

SCALE: NONE SHEET 1 OF 1 SHEETS STA. TO STA.

F.A.P. RTE. 317	SECTION (46)SR,SLP	COUNTY PEORIA	TOTAL SHEETS 18	SHEET NO. 2
CONTRACT NO. 68F26				
ILLINOIS FED. AID PROJECT				

CODE NO.	ITEM	UNIT	100% STATE TOTAL QUANTITY	CONSTRUCTION CODE								
				CONTRACT MAINTENANCE ROADWAY								
				0021								
				100% URBAN								
* 20201200	REMOVAL AND DISPOSAL OF UNSUITABLE MATERIAL	CU YD	230	230								
20400800	FURNISHED EXCAVATION	CU YD	555	555								
21001000	GEOTECHNICAL FABRIC FOR GROUND STABILIZATION	SQ YD	1400	1400								
28000400	PERIMETER EROSION BARRIER	FOOT	600	600								
40600295	POLYMERIZED BITUMINOUS MATERIALS (TACK COAT)	POUND	138	138								
44004250	PAVED SHOULDER REMOVAL	SQ YD	610	610								
48203029	HOT-MIX ASPHALT SHOULDERS, 8"	SQ YD	612	612								
60100060	CONCRETE HEADWALLS FOR PIPE DRAINS	EACH	2	2								
60108100	PIPE UNDERDRAINS 4" (SPECIAL)	FOOT	52	52								
60108104	PIPE UNDERDRAINS, TYPE 1, 4"	FOOT	550	550								
* 63000003	STEEL PLATE BEAM GUARDRAIL, TYPE A, 9 FOOT POSTS	FOOT	550	550								
63200310	GUARDRAIL REMOVAL	FOOT	550	550								
67100100	MOBILIZATION	LSUM	1	1								
70100310	TRAFFIC CONTROL AND PROTECTION, STANDARD 701421	LSUM	1	1								

* SPECIALTY ITEM

MODEL Path: \\... \Files\213081_IDOT - DIST - 4 - PTB 201603\Work Order 04 - Eastern DA118\Transportation\US 24\CAD Sheets\Summary of Quantities.dgn

KLINGNER & ASSOCIATES, P.C.
 Engineers • Architects • Surveyors
 Galesburg, Illinois
 49 North Park Street
 Galesburg, IL 62541
 Phone: 309.343.1111
 Fax: 309.343.1112
 www.klingner.com

USER NAME = ebb	DESIGNED -	REVISED -
PLOT SCALE = 100,0000' / in.	DRAWN -	REVISED -
PLOT DATE = 1/31/2023	CHECKED -	REVISED -
	DATE -	REVISED -

**STATE OF ILLINOIS
DEPARTMENT OF TRANSPORTATION**

**FAP RTE 317 (US 24)
SUMMARY OF QUANTITIES**

SCALE: NONE SHEET 1 OF 2 SHEETS STA. TO STA.

F.A.P. RTE. 317	SECTION (46)SR,SLP	COUNTY PEORIA	TOTAL SHEETS 18	SHEET NO. 3
CONTRACT NO. 68F26				
ILLINOIS FED. AID PROJECT				

CODE NO.	ITEM	UNIT	TOTAL QUANTITY	CONSTRUCTION CODE						
				100% STATE						
				CONTRACT MAINTENANCE ROADWAY						
				0021						
				100% URBAN						
70100320	TRAFFIC CONTROL AND PROTECTION, STANDARD 701422	LSUM	1	1						
70100350	TRAFFIC CONTROL AND PROTECTION, STANDARD 701101	EACH	1	1						
70103815	TRAFFIC CONTROL SURVEILLANCE	CAL DA	10	10						
70107025	CHANGEABLE MESSAGE SIGN	CAL DA	20	20						
* 78200006	GUARDRAIL REFLECTORS, TYPE B	EACH	3	3						
X0325592	REMOVE AND REPLACE STONE RIPRAP	CU YD	300	300						
Z0001002	GUARDRAIL AGGREGATE EROSION CONTROL	TON	91	91						
Z0048665	RAILROAD PROTECTIVE LIABILITY INSURANCE	L SUM	1	1						

* SPECIALTY ITEM

MODEL Path: \\... FILES\21081 IDOT - DIST - 4 - PTB 201603\Work Order 04 - Eastern DA118\Transportation\US 24\CAD Sheets\Summary of Quantities.dgn

KLINGNER & ASSOCIATES, P.C.
 Engineers • Architects • Surveyors
 Galesburg, Illinois
49 North Park Street, Galesburg, IL 62541, USA
 309.342.4444

USER NAME = ebb	DESIGNED -	REVISED -
PLOT SCALE = 100,0000' / in.	DRAWN -	REVISED -
PLOT DATE = 1/31/2023	CHECKED -	REVISED -
	DATE -	REVISED -

**STATE OF ILLINOIS
DEPARTMENT OF TRANSPORTATION**

**FAP RTE 317 (US 24)
SUMMARY OF QUANTITIES**

SCALE: NONE SHEET 2 OF 2 SHEETS STA. TO STA.

F.A.P. RTE. 317	SECTION (46)SR,SLP	COUNTY PEORIA	TOTAL SHEETS 18	SHEET NO. 4
CONTRACT NO. 68F26				
ILLINOIS FED. AID PROJECT				

MODEL: Default
 FILE NAME: C:\Ifiles\213081_IDOT - DSEI 4 - PTB 201603\Work_Order_04 - Eastern DA118\Transportation\US 24\CAD_Sheets\Typical_Sections.dgn

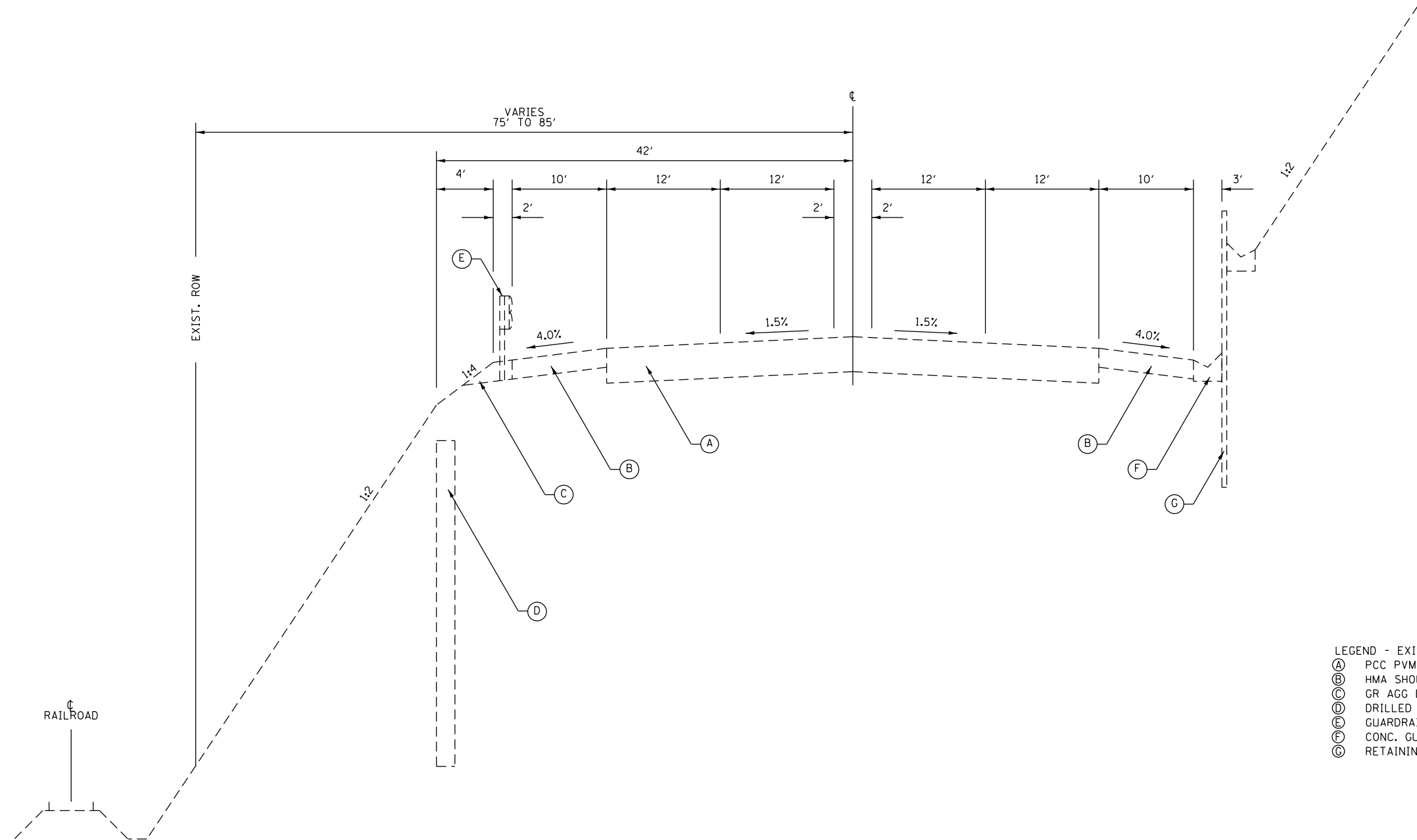

- LEGEND - EXISTING
- (A) PCC PVMT AND HMA OVERLAY, 10 1/4"
 - (B) HMA SHOULDER, 8"
 - (C) GR AGG EROSION CONTROL
 - (D) DRILLED SHAFTS (TO REMAIN)
 - (E) GUARDRAIL
 - (F) CONC. GUTTER, TY A (MODIFIED)
 - (G) RETAINING WALL

US 24 EXISTING TYPICAL SECTION

STA. 239+00 TO STA. 244+50

NOTES:
 •DRILLED SHAFTS EXIST STA. 239+04 TO STA. 242+00

KLINGNER & ASSOCIATES, P.C.
 Engineers • Architects • Surveyors
 Galesburg, Illinois
 49 North Park Street
 Galesburg, IL 62541
 Phone: 309.343.1111
 Fax: 309.343.1112
 www.klingner.com

USER NAME = ebb	DESIGNED -	REVISED -
PLOT SCALE = 100,0000' / in.	DRAWN -	REVISED -
PLOT DATE = 1/31/2023	CHECKED -	REVISED -
	DATE -	REVISED -

**STATE OF ILLINOIS
 DEPARTMENT OF TRANSPORTATION**

**FAP RTE 317 (US 24)
 TYPICAL SECTIONS**

SCALE: NONE	SHEET 1	OF 2 SHEETS	STA.	TO STA.
-------------	---------	-------------	------	---------

F.A.P. RTE.	SECTION	COUNTY	TOTAL SHEETS	SHEET NO.
317	(46)SR,SLP	PEORIA	18	5
CONTRACT NO. 68F26				
ILLINOIS FED. AID PROJECT				

MODEL: Default
 FILE NAME: C:\Users\ebb\OneDrive\Documents\24\ICAD_Sheets\Typical Sections.dgn
 DATE: 1/31/2023 10:08:11 AM
 USER: ebb

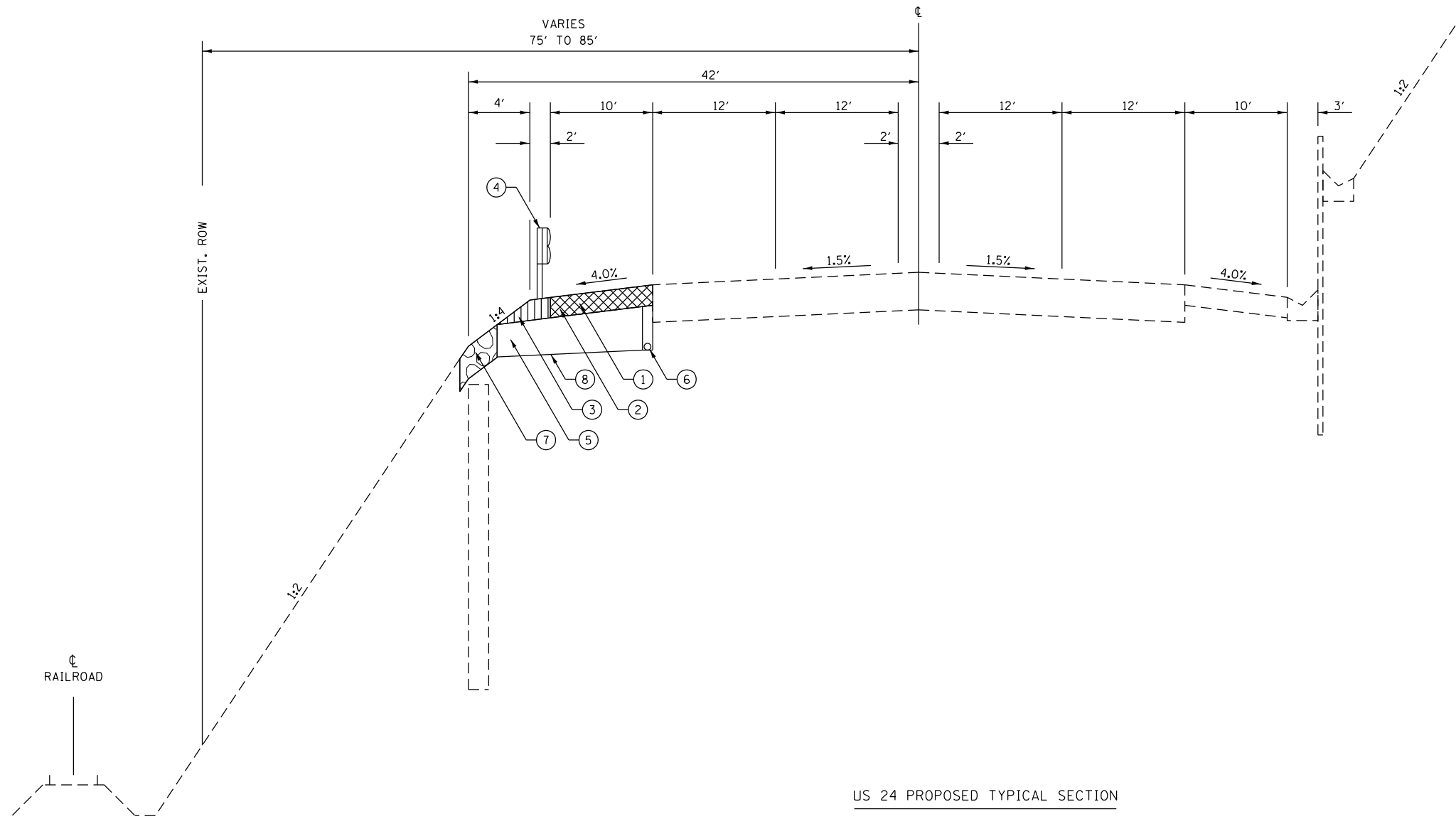

US 24 PROPOSED TYPICAL SECTION

STA. 239+00 TO STA. 244+50

NOTES:
 •DRILLED SHAFTS EXIST STA. 239+04 TO STA. 242+00

- LEGEND - EXISTING
- Ⓐ PCC PVMT AND HMA OVERLAY, 10 1/4"
 - Ⓑ HMA SHOULDER, 8"
 - Ⓒ GR AGG EROSION CONTROL
 - Ⓓ DRILLED SHAFTS (TO REMAIN)
 - Ⓔ GUARDRAIL
 - Ⓕ CONC. GUTTER, TY A (MODIFIED)
 - Ⓖ RETAINING WALL
- LEGEND - PROPOSED
- ① HMA SHLD REMOVAL
 - ② HMA SHOULDER, 8"
 - ③ GR AGG EROSION CONTROL
 - ④ SPB GUARDRAIL, TY A 9 FT POSTS
 - ⑤ REMOVAL UNSUITABLE MATERIAL / FURNISHED EXCAVATION
 - ⑥ PIPE UNDERDRAIN, 4"
 - ⑦ RIPRAP REMOVAL AND REPLACE
 - ⑧ GEOTECHNICAL FABRIC FOR GROUND STABILIZATION

KLINGNER & ASSOCIATES, P.C.
 Engineers • Architects • Surveyors
 Galesburg, Illinois
 49 North Park Street
 Galesburg, IL 62541
 Phone: 309.343.1111
 Fax: 309.343.1112
 www.klingner.com

USER NAME = ebb	DESIGNED -	REVISED -
PLOT SCALE = 100,0000' / in.	DRAWN -	REVISED -
PLOT DATE = 1/31/2023	CHECKED -	REVISED -
	DATE -	REVISED -

**STATE OF ILLINOIS
 DEPARTMENT OF TRANSPORTATION**

**FAP RTE 317 (US 24)
 TYPICAL SECTIONS**

SCALE: NONE SHEET 2 OF 2 SHEETS STA. TO STA.

F.A.P. RTE. 317	SECTION (46)SR,SLP	COUNTY PEORIA	TOTAL SHEETS 18	SHEET NO. 6
CONTRACT NO. 68F26				
ILLINOIS FED. AID PROJECT				

TABULATION OF SHOULDER PAVING QUANTITIES				
LOCATION	SHOULDER WIDTH	PAVED SHOULDER REMOVAL	HMA SHOULDERS 8"	POLY BIT MATERIALS (TACK COAT) 0.025 LB/SQ FT
	FOOT	SQ YD	SQ YD	POUNDS
STA. 239+00.00 TO STA. 244+50.00	10.00	610	612	138
TOTALS:		610	612	138

TABULATION OF EROSION CONTROL QUANTITIES		
LOCATION	PERIMETER EROSION BARRIER	
	FOOT	
STA. 238+75.00 TO STA. 244+75.00	600	
TOTALS:		600

TABULATION OF EARTHWORK QUANTITIES					
LOCATION	SLOPE REPAIR				
	REMOVE AND REPLACE STONE RIPRAP	REMOVAL AND DISPOSAL UNSUITABLE MATERIAL	GEOTECHNICAL FABRIC FOR GROUND STABILIZATION	FURNISHED EXCAVATION	
	CU YD	CU YD	SQ YD	CU YD	
STA. 239+00.00 TO STA. 244+50.00	300	230	1400	555	
TOTALS:		300	230	1400	555

TABULATION OF GUARDRAIL QUANTITIES					
LOCATION	GUARDRAIL REMOVAL	SPBGR, TYPE A, 9 FT POSTS	GUARDRAIL AGGREGATE EROSION CONTROL	GUARDRAIL REFLECTORS TYPE B	
	FOOT	FOOT	TON	EACH	
STA. 239+00.00 TO STA. 244+50.00	550	550	91	3	
TOTALS:		550	550	91	3

TABULATION OF TRAFFIC CONTROL AND PROTECTION QUANTITIES				
LOCATION	STD 701421	STD 701422	STD 701101	
	L SUM	L SUM	EACH	
US 24	1	1	1	
TOTALS:		1	1	1

TABULATION OF UNDERDRAIN QUANTITIES				
LOCATION	PIPE UNDERDRAINS TYPE 1 4"	PIPE UNDERDRAINS 4" (SPECIAL)	CONCRETE HEADWALLS FOR PIPE DRAINS	
	FOOT	FOOT	EACH	
STA. 239+00.00 TO STA. 244+50.00	550			
STA. 239+00.00		26	1	
STA. 244+50.00		26	1	
TOTALS:		550	52	2

RAILROAD PROTECTIVE LIABILITY INSURANCE		
LOCATION	L SUM	
US 24	1	
TOTAL:		1

MOBILIZATION		
LOCATION	L SUM	
US 24	1	
TOTAL:		1

TRAFFIC CONTROL SURVEILLANCE		
LOCATION	CAL DA	
US 24	10	
TOTAL:		10

CHANGEABLE MESSAGE SIGN		
LOCATION	CAL DA	
US 24	20	
TOTAL:		20

MODEL Path: \\... \Files\213081 IDOT - DST - 4 - PTB 201603\Work Order 04 - Eastern D418\Transportation\US 24\CAD Sheets\Schedule of Quantities.dgn



USER NAME = ebb	DESIGNED -	REVISED -
PLOT SCALE = 100,0000' / in.	DRAWN -	REVISED -
PLOT DATE = 1/31/2023	CHECKED -	REVISED -
	DATE -	REVISED -

**STATE OF ILLINOIS
DEPARTMENT OF TRANSPORTATION**

**FAP RTE 317 (US 24)
SCHEDULE OF QUANTITIES**

SCALE: NONE SHEET 1 OF 1 SHEETS STA. TO STA.

F.A.P. RTE.	SECTION	COUNTY	TOTAL SHEETS	SHEET NO.
317	(46)SR,SLP	PEORIA	18	7
CONTRACT NO. 68F26				
ILLINOIS FED. AID PROJECT				

EXIST. CURVE US24EXCL
 PI STA. = 242+09.30
 $\Delta = 2^\circ 50' 51''$ (LT)
 $D = 0^\circ 20' 49''$
 $R = 16,509.10'$
 $T = 410.33'$
 $L = 820.49'$
 $e = 5.10'$
 $\theta = N.C.$
 P.C. STA. = 237+98.97
 P.T. STA. = 246+19.46

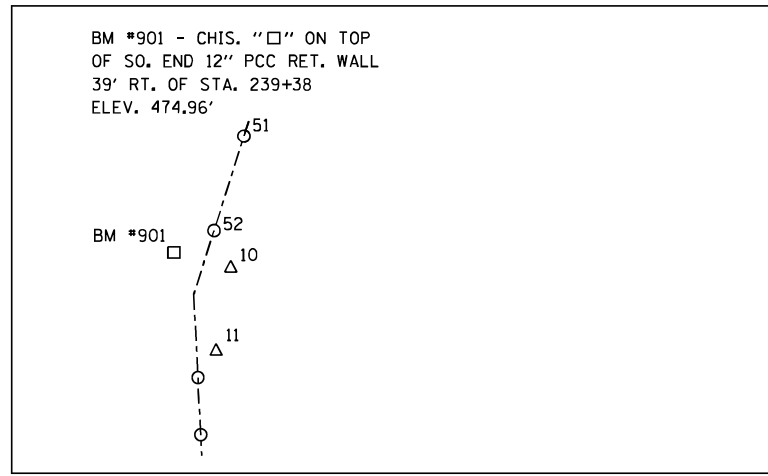
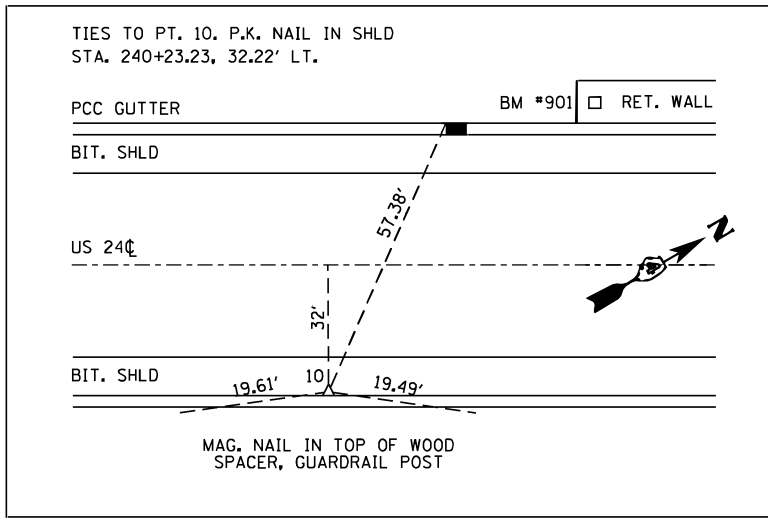
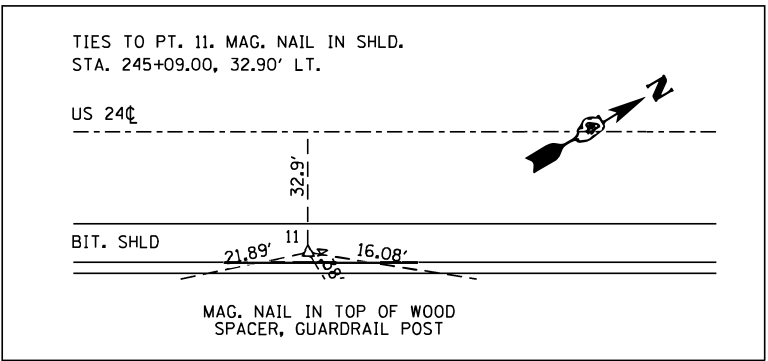
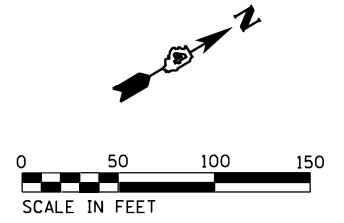
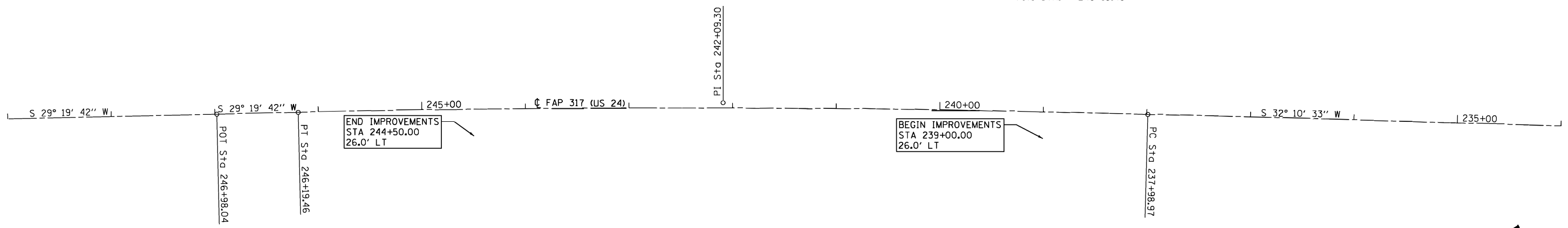

MODEL: D:\p1\11...
 FILE: Main\0321\files\213081_IDOT - DIST 4 - PTB 201-0323\Work_Order_04 - Eastern D418\Transportation\US 24\CAD Sheets\Alignment.dgn

KLINGNER & ASSOCIATES, P.C.
 Engineers - Architects - Surveyors
 Galesburg, Illinois

USER NAME = ebb	DESIGNED -	REVISED -
PLOT SCALE = 100.0000' / in.	DRAWN -	REVISED -
PLOT DATE = 3/19/2022	CHECKED -	REVISED -
	DATE -	REVISED -

**STATE OF ILLINOIS
 DEPARTMENT OF TRANSPORTATION**

**FAP RTE 317 (US 24)
 ALIGNMENT, BENCHMARKS, AND RECOVERY TIES**

SCALE: 1"=50' SHEET 1 OF 1 SHEETS STA. 234+00 TO STA. 249+00

F.A.P. RTE.	SECTION	COUNTY	TOTAL SHEETS	SHEET NO.
317	(46)SR,SLP	PEORIA	18	8
CONTRACT NO. 68F26				
ILLINOIS FED. AID PROJECT				

FINAL SURVEY NO.	SURVEYED	DATE
NOTE BOOK	PLOTTED	
	TEMPLATE	
	AREAS CHECKED	

ORIGINAL SURVEY NO.	SURVEYED	DATE
	PLOTTED	
	TEMPLATE	
	AREAS CHECKED	

MODEL: D:\proj\118\DOT - DIST 4 - P1B 20133\Work Order 04 - Eastern DA118 Transportation\US 24\CAD Sheets\Cross Section.dgn
 FILE NAME: C:\Users\ebb\OneDrive\Documents\DOT - DIST 4 - P1B 20133\Work Order 04 - Eastern DA118 Transportation\US 24\CAD Sheets\Cross Section.dgn

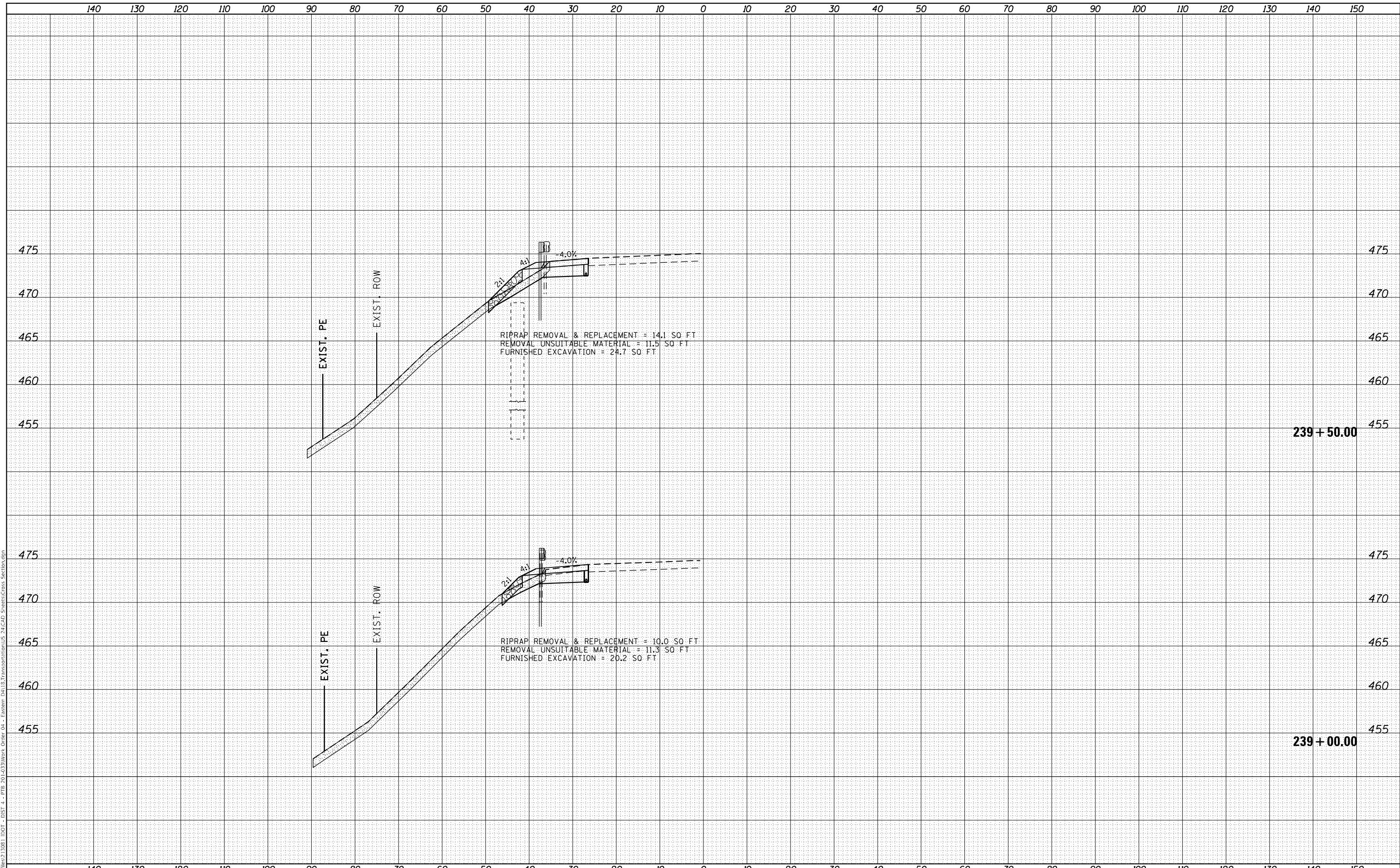

USER NAME = ebb	DESIGNED - EBB	REVISIONS
	DRAWN - MCR	REVISIONS
PLOT SCALE = 100,0000' / 1in.	CHECKED - RJP	REVISIONS
PLOT DATE = 1/31/2023	DATE -	REVISIONS

**STATE OF ILLINOIS
DEPARTMENT OF TRANSPORTATION**

**FAP RTE 317 (US 24)
CROSS SECTIONS**

SCALE: SHEET 1 OF 7 SHEETS STA. 239+00.00 TO STA. 239+50.00

F.A. RTE.	SECTION	COUNTY	TOTAL SHEETS	SHEET NO.
317	(46)SR,SLP	PEORIA	18	10
CONTRACT NO. 68F26			ILLINOIS FED. AID PROJECT	

FINAL SURVEY NO.	SURVEYED	DATE
NOTE BOOK	PLOTTED	
	TEMPLATE	
	AREAS CHECKED	

ORIGINAL SURVEY NO.	SURVEYED	DATE
	PLOTTED	
	TEMPLATE	
	AREAS CHECKED	

MODEL: D:\proj\118\DOT - DIST 4 - P1B 20133\Work Order 04 - Eastern DA118 Transportation\US 24\CAD Sheets\Cross Section.dgn
 FILE NAME: C:\Users\ebb\OneDrive\Documents\DOT - DIST 4 - P1B 20133\Work Order 04 - Eastern DA118 Transportation\US 24\CAD Sheets\Cross Section.dgn

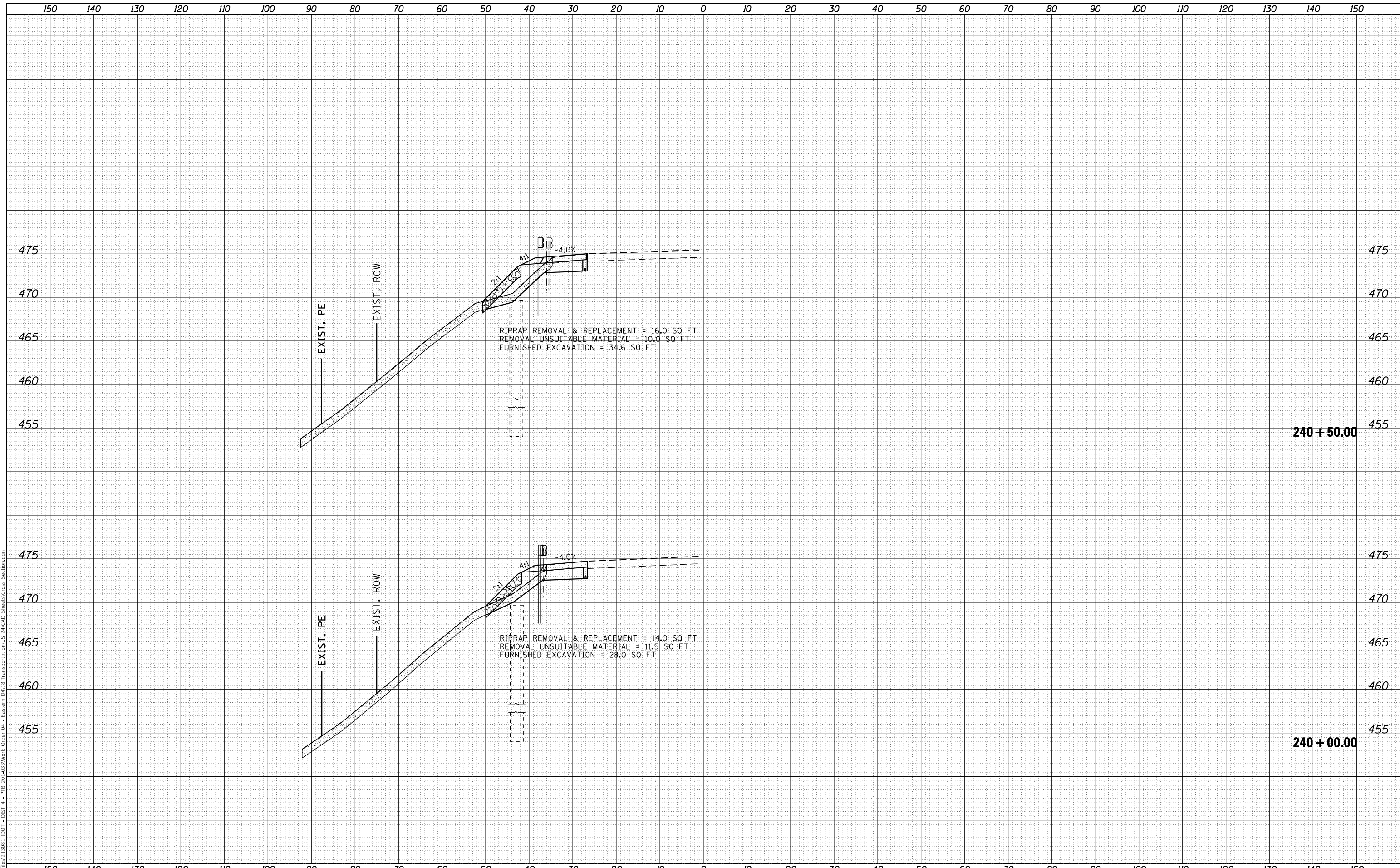

RIPRAP REMOVAL & REPLACEMENT = 16.0 SQ. FT.
 REMOVAL UNSUITABLE MATERIAL = 10.0 SQ. FT.
 FURNISHED EXCAVATION = 34.6 SQ. FT.

RIPRAP REMOVAL & REPLACEMENT = 14.0 SQ. FT.
 REMOVAL UNSUITABLE MATERIAL = 11.5 SQ. FT.
 FURNISHED EXCAVATION = 28.0 SQ. FT.



USER NAME = ebb	DESIGNED - EBB	REVISIONS
	DRAWN - MCR	REVISIONS
PLOT SCALE = 100,0000' / 1"	CHECKED - RJP	REVISIONS
PLOT DATE = 1/31/2023	DATE -	REVISIONS

DESIGNED - EBB	REVISIONS
DRAWN - MCR	REVISIONS
CHECKED - RJP	REVISIONS
DATE -	REVISIONS

**STATE OF ILLINOIS
 DEPARTMENT OF TRANSPORTATION**

**FAP RTE 317 (US 24)
 CROSS SECTIONS**

SCALE: SHEET 2 OF 7 SHEETS STA. 240+00.00 TO STA. 240+50.00

F.A. RTE.	SECTION	COUNTY	TOTAL SHEETS	SHEET NO.
317	(46)SR,SLP	PEORIA	18	11
				CONTRACT NO. 68F26
				ILLINOIS FED. AID PROJECT

DATE	
BY	
FINAL SURVEY	SURVEYED
NOTE BOOK	PLOTTED
NO.	TEMPLATE
	AREAS CHECKED

DATE	
BY	
ORIGINAL SURVEY	SURVEYED
NOTE BOOK	PLOTTED
NO.	TEMPLATE
	AREAS CHECKED

MODEL: D:\proj\118\DOT - DIST 4 - P1B 20133\Work Order 04 - Eastern DA118 Transportation\US 24\CAD Sheets\Cross Section.dgn
 FILE NAME: C:\Users\ebb\OneDrive\Documents\DOT - DIST 4 - P1B 20133\Work Order 04 - Eastern DA118 Transportation\US 24\CAD Sheets\Cross Section.dgn

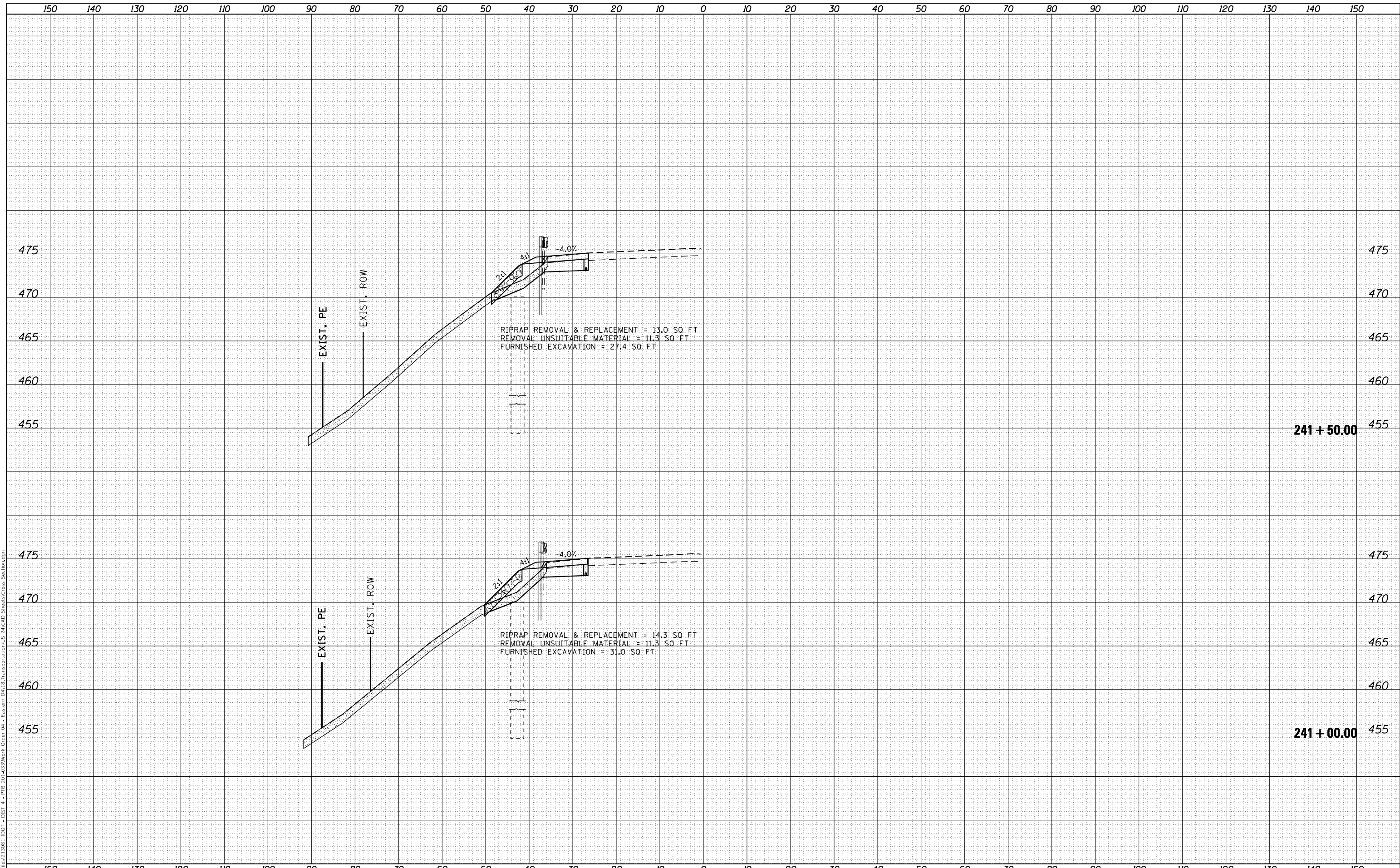

USER NAME	= ebb
DESIGNED	- EBB
DRAWN	- MCR
PLLOT SCALE	= 100,0000' / 1in.
CHECKED	- RJP
DATE	-
REVISIONS	
REVISIONS	
REVISIONS	
REVISIONS	

DESIGNED	- EBB	REVISIONS	
DRAWN	- MCR	REVISIONS	
CHECKED	- RJP	REVISIONS	
DATE	-	REVISIONS	

STATE OF ILLINOIS
 DEPARTMENT OF TRANSPORTATION

FAP RTE 317 (US 24)
 CROSS SECTIONS

SCALE: SHEET 3 OF 7 SHEETS STA. 241+00.00 TO STA. 241+50.00

F.A. RTE.	SECTION	COUNTY	TOTAL SHEETS	SHEET NO.
317	(46)SR,SLP	PEORIA	18	12
				CONTRACT NO. 68F26
ILLINOIS FED. AID PROJECT				

FINAL SURVEY NO.	SURVEYED	DATE
NOTE BOOK	PLOTTED	
	TEMPLATE	
	AREAS CHECKED	

ORIGINAL SURVEY NO.	SURVEYED	DATE
	PLOTTED	
	TEMPLATE	
	AREAS CHECKED	

MODEL: D:\proj\118\DOT - DIST 4 - FAP RTE 317\Work Order 04 - Eastern - DA118 Transportation\US 24\CAD Sheets\Cross Section.dgn
 FILE NAME: C:\Users\ebb\OneDrive\Documents\DOT - DIST 4 - FAP RTE 317\Work Order 04 - Eastern - DA118 Transportation\US 24\CAD Sheets\Cross Section.dgn

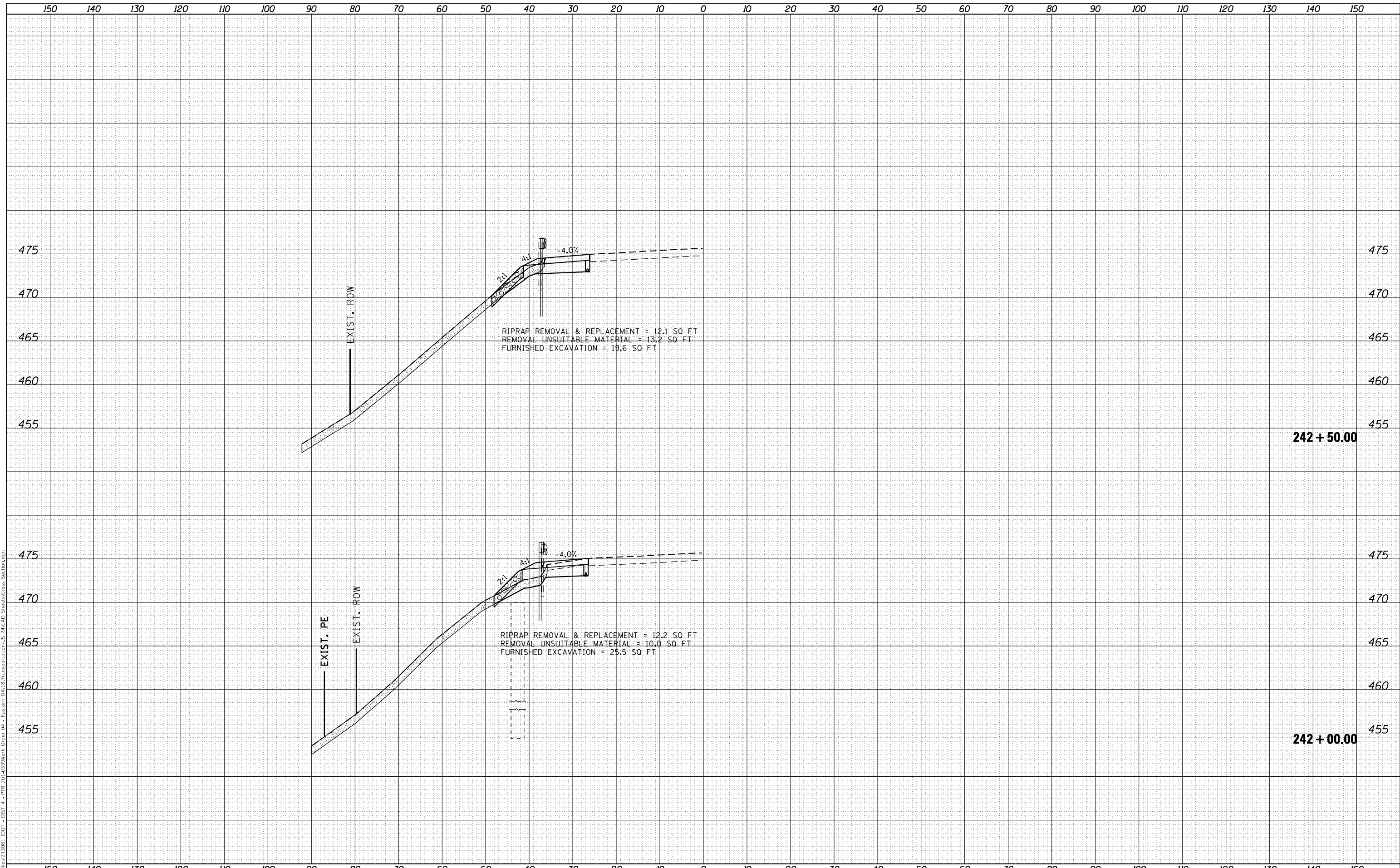

KLINGNER & ASSOCIATES, P.C.
 Engineers • Architects • Surveyors
 Galesburg, Illinois
 400 North Middle Street
 Galesburg, IL 62401
 www.klingner.com

USER NAME = ebb
DESIGNED - EBB
DRAWN - MCR
PLLOT SCALE = 100,0000' / 1in.
CHECKED - RJP
DATE - 1/31/2023

DESIGNED - EBB	REVISD -
DRAWN - MCR	REVISD -
CHECKED - RJP	REVISD -
DATE - 1/31/2023	REVISD -

**STATE OF ILLINOIS
 DEPARTMENT OF TRANSPORTATION**

**FAP RTE 317 (US 24)
 CROSS SECTIONS**

SCALE: SHEET 4 OF 7 SHEETS STA. 242+00.00 TO STA. 242+50.00

F.A. RTE.	SECTION	COUNTY	TOTAL SHEETS	SHEET NO.
317	(46)SR,SLP	PEORIA	18	13
CONTRACT NO. 68F26				
ILLINOIS FED. AID PROJECT				

FINAL SURVEY	SURVEYED	DATE
NOTE BOOK	PLOTTED	BY
NO.	TEMPLATE	
	AREAS CHECKED	

ORIGINAL SURVEY	SURVEYED	DATE
NOTE BOOK	PLOTTED	BY
NO.	TEMPLATE	
	AREAS CHECKED	

MODEL: D:\proj\DOT - DIST 4 - PFB 2013\317\Work Order 04 - Eastern - DA118 Transportation\US 24\CAD Sheets\Cross Section.dgn
 FILE NAME: C:\Users\ebb\Documents\DOT - DIST 4 - PFB 2013\317\Work Order 04 - Eastern - DA118 Transportation\US 24\CAD Sheets\Cross Section.dgn

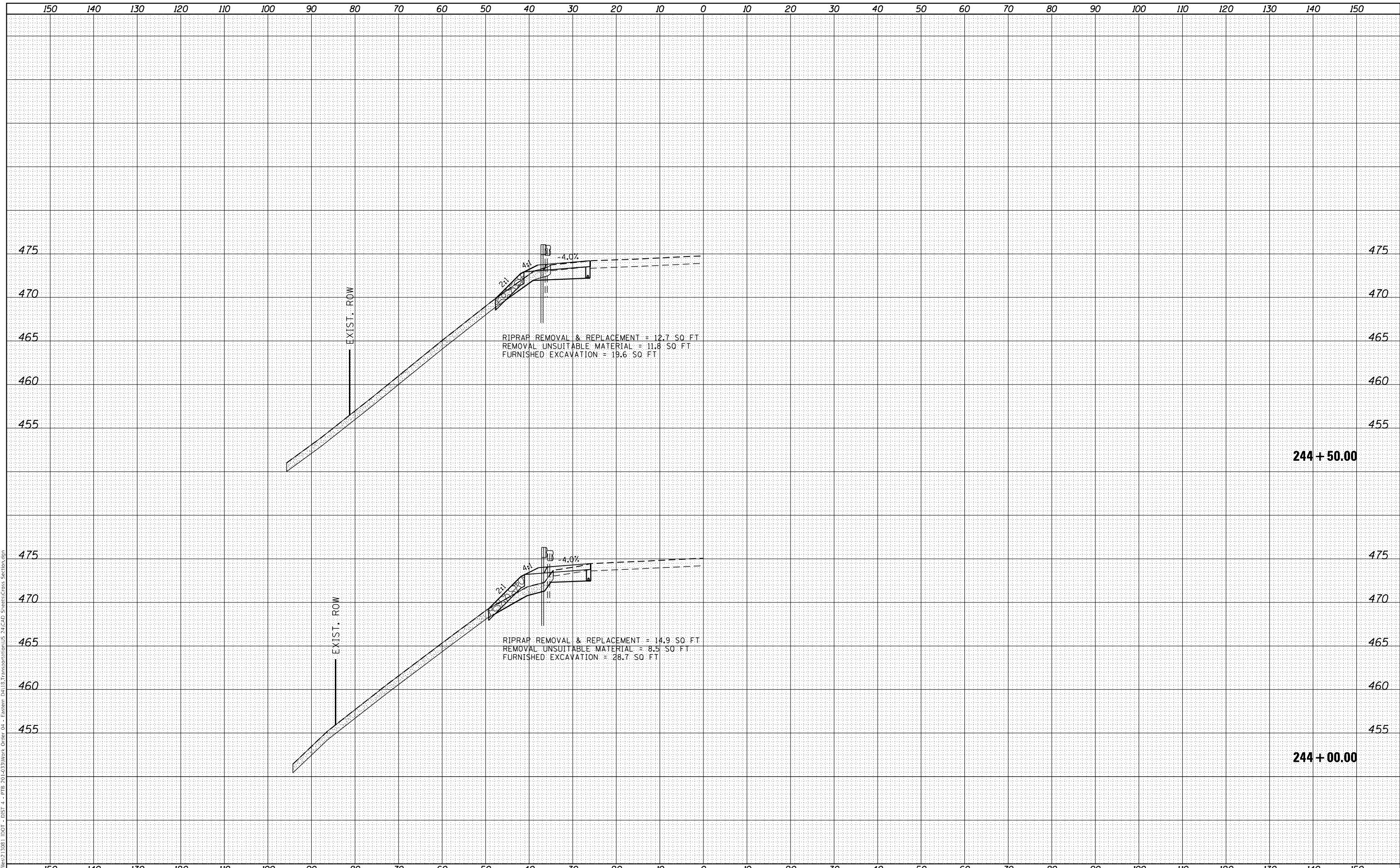

KLINGNER & ASSOCIATES, P.C.
 Engineers • Architects • Surveyors
 Galesburg, Illinois
 400 North Middle Street
 Galesburg, IL 62541
 Phone: 309.343.3333
 Fax: 309.343.3334
 www.klingner.com

USER NAME = ebb	DESIGNED - EBB	REvised -
	DRAWN - MCR	REvised -
PLOT SCALE = 100,000' / 1"	CHECKED - RJP	REvised -
PLOT DATE = 1/31/2023	DATE -	REvised -

**STATE OF ILLINOIS
 DEPARTMENT OF TRANSPORTATION**

**FAP RTE 317 (US 24)
 CROSS SECTIONS**

SCALE: SHEET 6 OF 7 SHEETS STA. 244+00.00 TO STA. 244+50.00

F.A. RTE.	SECTION	COUNTY	TOTAL SHEETS	SHEET NO.
317	(46)SR,SLP	PEORIA	18	15
CONTRACT NO. 68F26				
ILLINOIS FED. AID PROJECT				

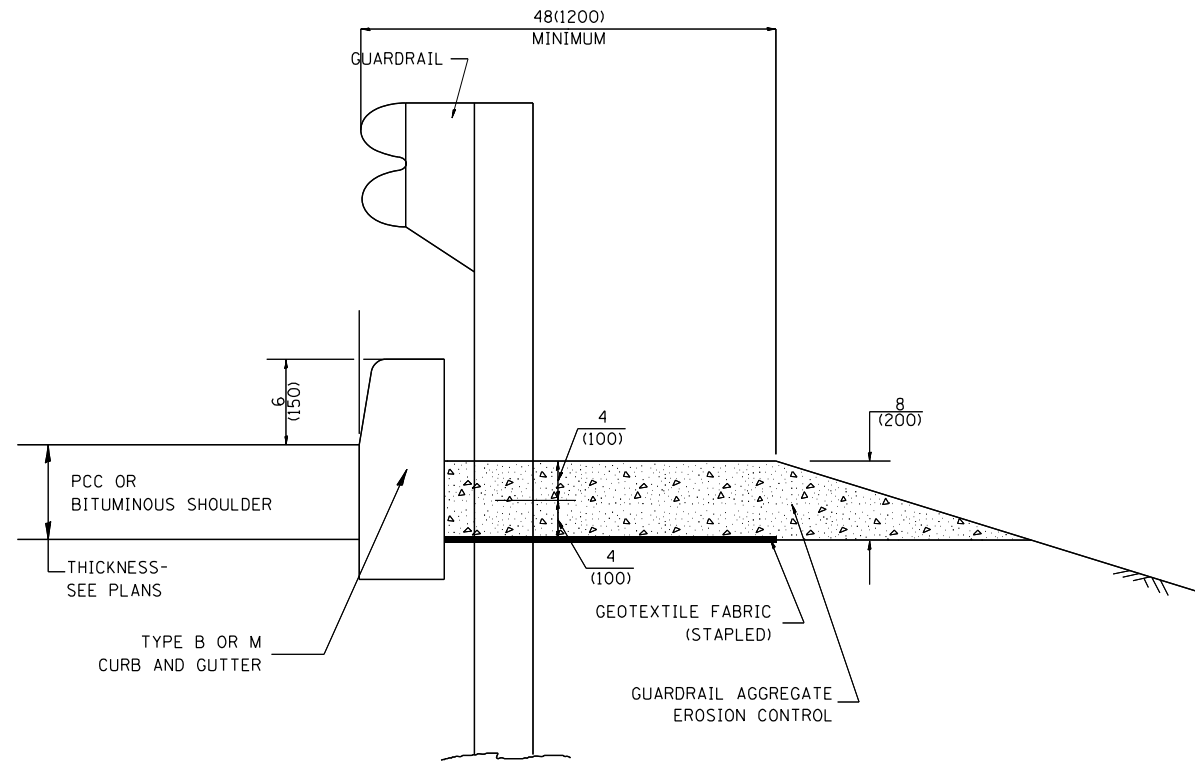

TYPICAL SECTION WITH EROSION CONTROL CURB

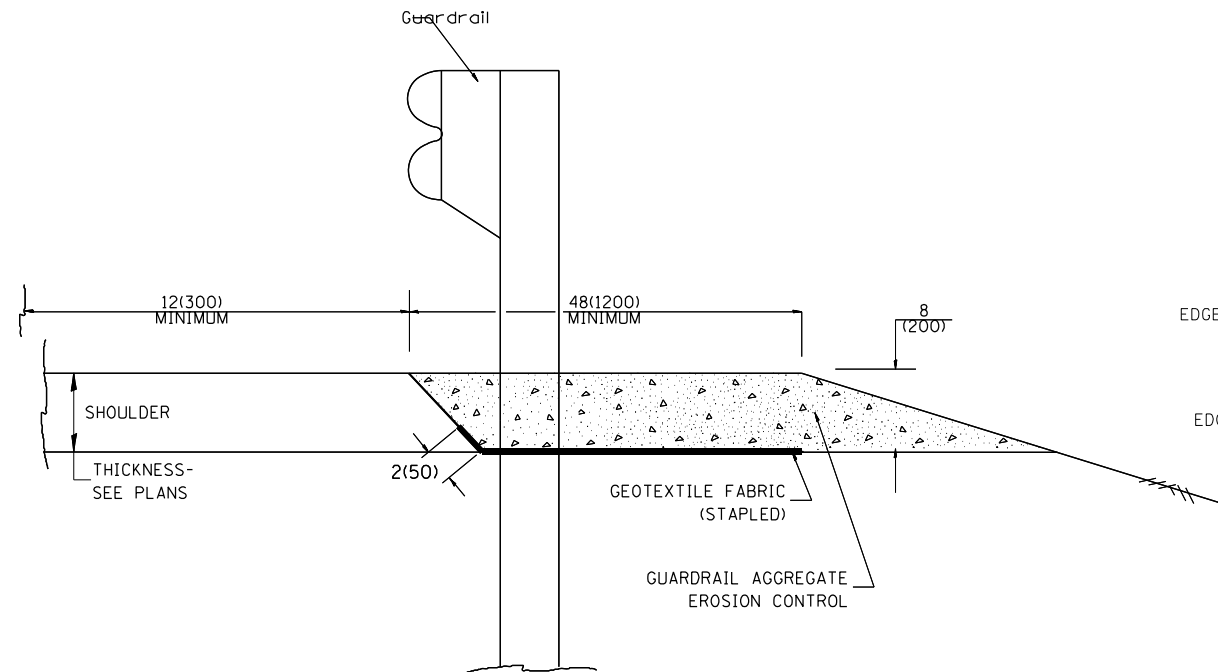

TYPICAL SECTION WITHOUT EROSION CONTROL CURB

GENERAL NOTES: GUARDRAIL AGGREGATE EROSION CONTROL

1. THIS WORK SHALL CONSIST OF GRADING AS NEEDED, FURNISHING AND INSTALLING GEOTEXTILE FABRIC AND STAPLES, AND FURNISHING, PLACING AND SHAPING CRUSHED AGGREGATE AROUND AND BEHIND STEEL PLATE BEAM GUARDRAIL POSTS IN ACCORDANCE WITH PLAN DETAILS.
2. BEFORE PLACING THE AGGREGATE AND THE GEOTEXTILE FABRIC, WEEDS AND GRASS SHALL BE REMOVED FROM THE AREA TO BE COVERED.
3. AFTER THE AREA HAS BEEN PREPARED, AND IN A DRY CONDITION, THE GEOTEXTILE FABRIC SHALL BE PLACED WITH A 12(300) MINIMUM OVERLAP. A KNIFE CUT FOR GUARDRAIL POST INSTALLATION IS NECESSARY.
4. THE AGGREGATE SHALL BE DEPOSITED, COMPACTED AND SHAPED BY EITHER MECHANICAL OR HAND METHODS, IN A MANNER REASONABLY TRUE TO LINE AND GRADE.
5. THE CONTRACTOR SHALL HAVE THE OPTION OF PLACING THE GUARDRAIL BEFORE OR AFTER THE GEOTEXTILE FABRIC AND AGGREGATE ARE IN PLACE. IF THE GUARDRAIL IS PLACED AFTER THE GEOTEXTILE FABRIC AND AGGREGATE, THEN ANY VOIDS MUST BE FILLED AND THE AGGREGATE RETURNED TO LINE AND GRADE.
6. MATERIALS SHALL MEET THE FOLLOWING REQUIREMENTS:
 - A. THE CRUSHED AGGREGATE SHALL BE CA1 GRADATION IN ACCORDANCE WITH ARTICLE 1004.01(C) OF THE STANDARD SPECIFICATIONS.
 - B. THE GEOTEXTILE FABRIC SHALL BE NONWOVEN FABRIC IN ACCORDANCE WITH ARTICLE 1080.02 OF THE STANDARD SPECIFICATIONS.

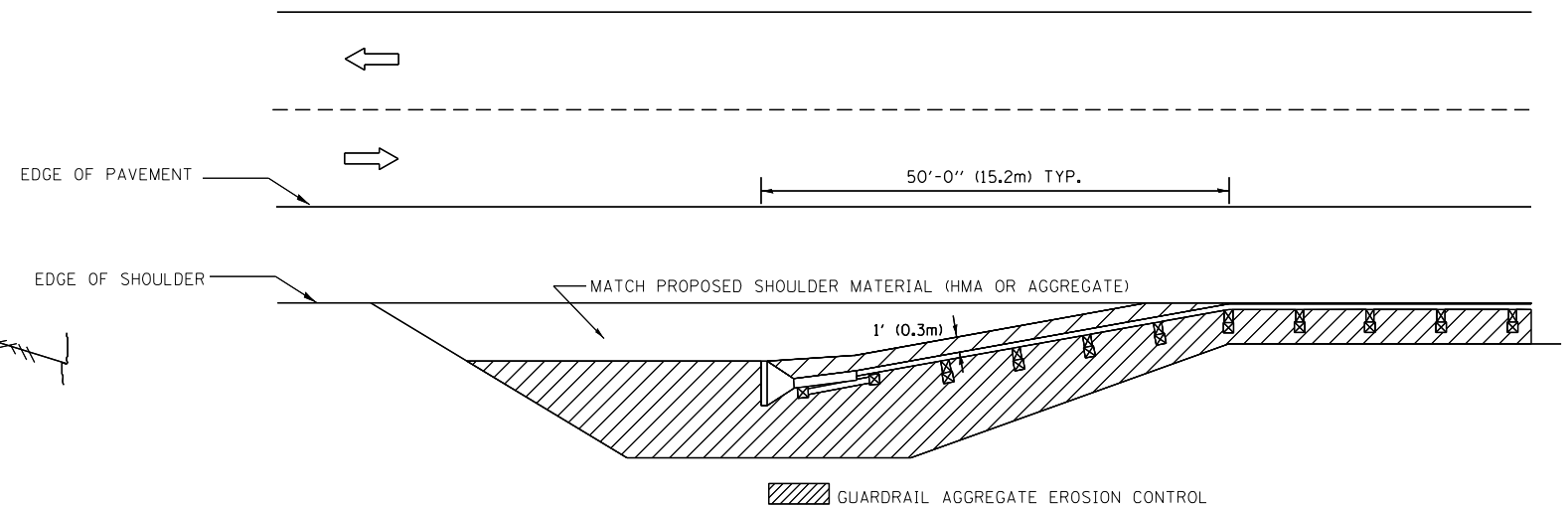

ALL DIMENSIONS ARE IN INCHES (MILLIMETERS) UNLESS OTHERWISE NOTED.

MODEL: Default; FILE NAME: C:\Users\j13081\DOT - DSET 4 - PTB 201603\Work Order 04 - Eastern D4118\Transportation\US 24\CAD Sheets\Detail Standards.dgn

KLINGNER & ASSOCIATES, P.C.
 Engineers • Architects • Surveyors
 Galesburg, Illinois
 49 North Park Street
 Galesburg, IL 62541

USER NAME = ebb	DESIGNED -	REVISED -
PLOT SCALE = 100,0000' / in.	DRAWN -	REVISED -
PLOT DATE = 1/31/2023	CHECKED -	REVISED -
	DATE -	REVISED -

STATE OF ILLINOIS
 DEPARTMENT OF TRANSPORTATION

FAP RTE 317 (US 24)
 GUARDRAIL EROSION CONTROL TREATMENTS

SCALE: NONE SHEET 1 OF 2 SHEETS STA. TO STA.

F.A.P. RTE.	SECTION	COUNTY	TOTAL SHEETS	SHEET NO.
317	(46)SR,SLP	PEORIA	18	17
CONTRACT NO. 68F26				
ILLINOIS FED. AID PROJECT				

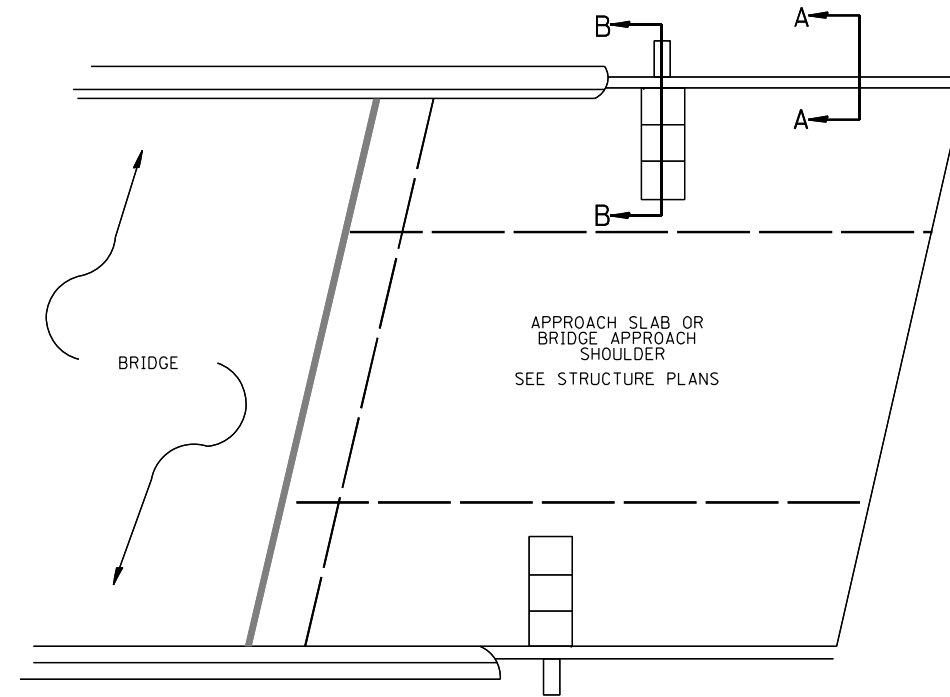
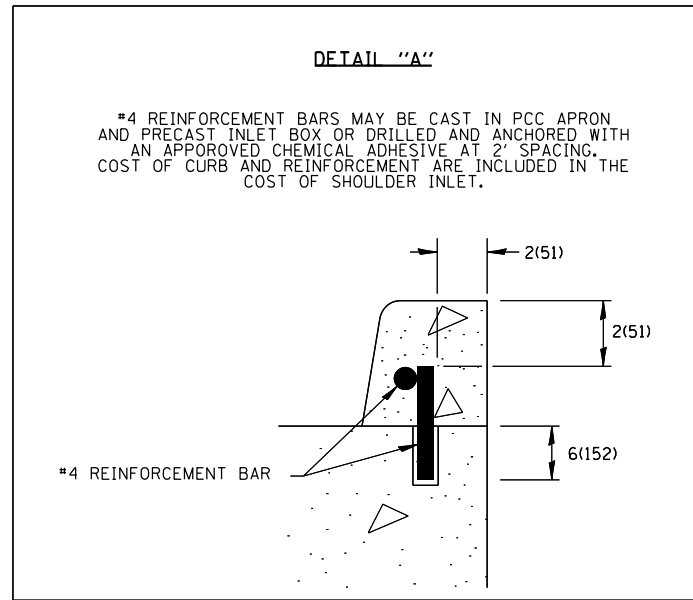

PLAN VIEW
APPROACH SLAB OR SHOULDER PLACEMENT

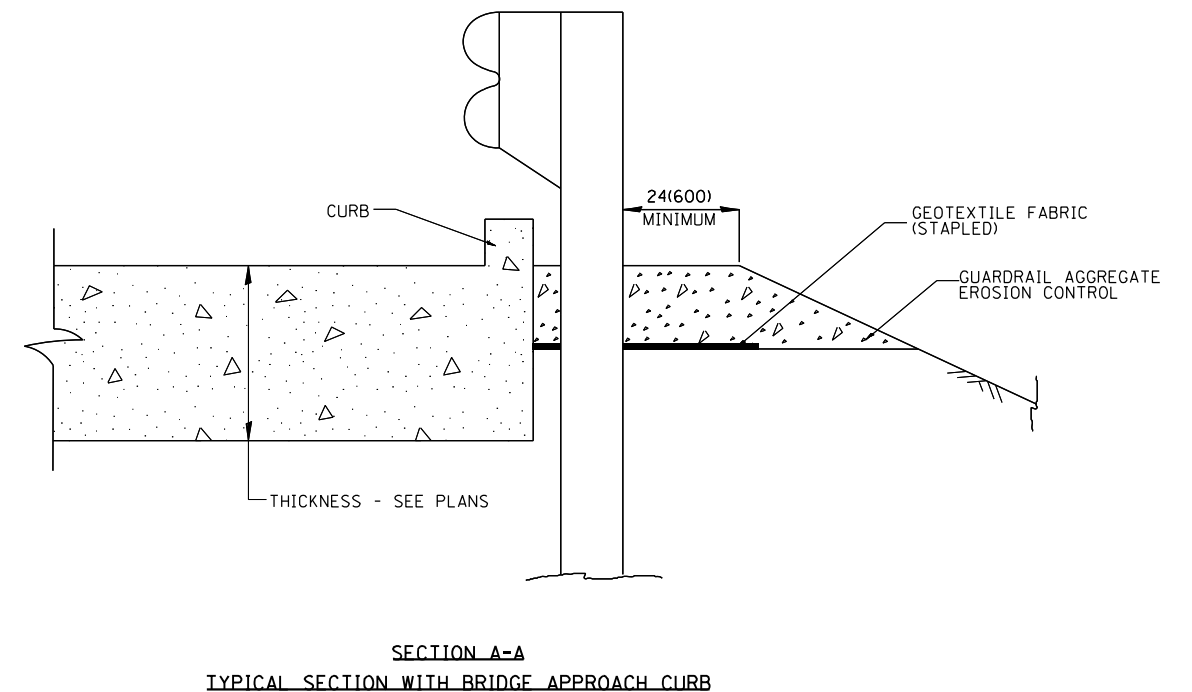
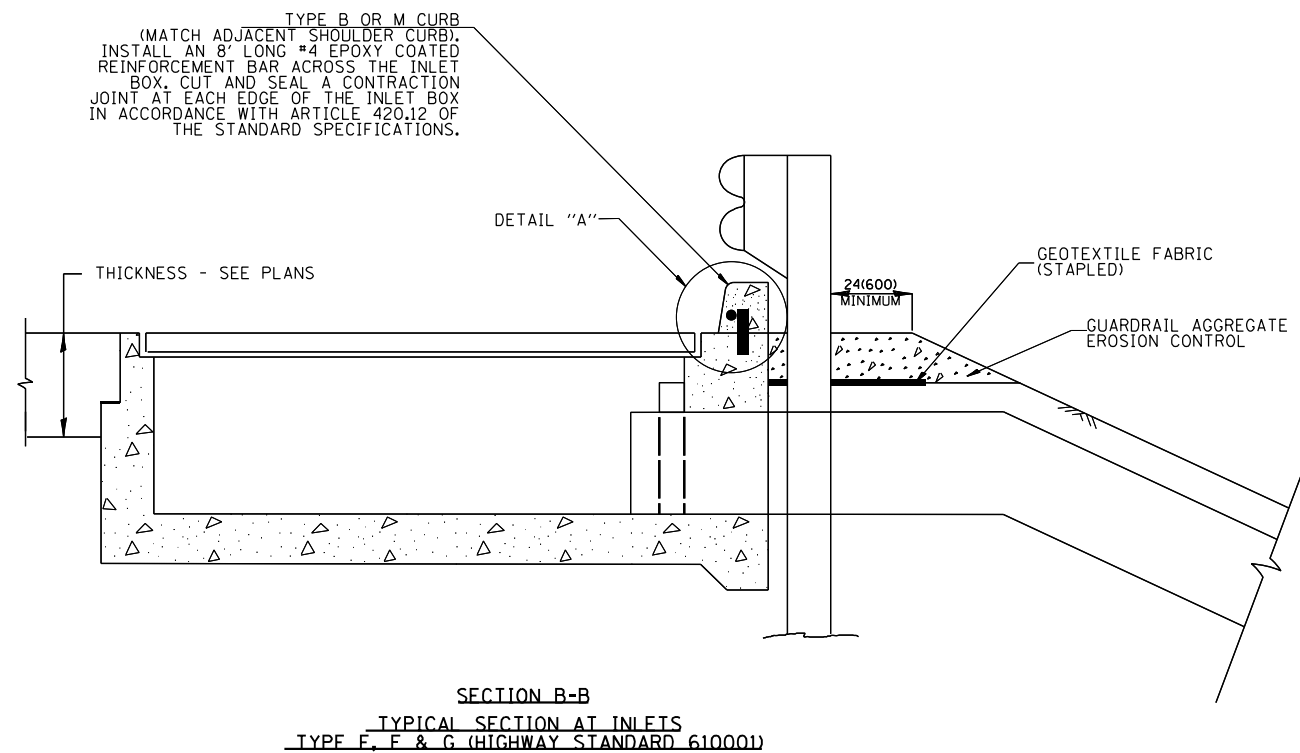

ALL DIMENSIONS ARE IN INCHES (MILLIMETERS) UNLESS OTHERWISE NOTED.

MODEL: Default
FILE NAME: C:\Users\j21081\OneDrive\Documents\24ICAD_Sheets\Detail_Standards.dgn
Eastern D:\18_Transportation\US_24ICAD_Sheets\Detail_Standards.dgn

KLINGNER & ASSOCIATES, P.C.
Engineers • Architects • Surveyors
Galesburg, Illinois
49 North Park Street
Galesburg, IL 62541

USER NAME = ebb
DESIGNED -
DRAWN -
CHECKED -
DATE -
PLOT SCALE = 100,0000' / in.
PLOT DATE = 1/31/2023

DESIGNED -
DRAWN -
CHECKED -
DATE -
REVISED -
REVISED -
REVISED -
REVISED -

STATE OF ILLINOIS
DEPARTMENT OF TRANSPORTATION

FAP RTE 317 (US 24)
GUARDRAIL EROSION CONTROL TREATMENTS

SCALE: NONE SHEET 2 OF 2 SHEETS STA. TO STA.

F.A.P. RTE.	SECTION	COUNTY	TOTAL SHEETS	SHEET NO.
317	(46)SR,SLP	PEORIA	18	18
CONTRACT NO. 68F26				
ILLINOIS FED. AID PROJECT				