

04-28-2023 LETTING ITEM 154

STATE OF ILLINOIS  
DEPARTMENT OF TRANSPORTATION

ROUTE NO. FAS 335	SECTION 19-00154-01-RS	COUNTY IROQUOIS	TOTAL SHEETS 10	SHEET NO. 1
JOB #: C-93-001-24			PROJECT #: N117(942)	

PLANS FOR PROPOSED IMPROVEMENT OF  
FEDERAL AID SECONDARY HIGHWAY 335  
SURFACE TRANSPORTATION PROGRAM - RURAL  
"HMA RESURFACING PROJECT"  
IROQUOIS COUNTY

TOLL FREE JOINT UTILITY LOCATING  
INFORMATION FOR EXCAVATORS (J. U. L. I. E.)  
TELEPHONE NUMBER 1-800-892-0123

INDEX OF SHEETS	
SHEET NUMBER	DESCRIPTION
1	COVER SHEET -- LOCATION MAP
2	SUMMARY OF QUANTITIES, GENERAL NOTES, MIXTURE TABLE, AND BUTT JOINT DETAIL
3	EXISTING & PROPOSED X-SECTIONS - STA. 0+30 TO 54+68
4	EXISTING & PROPOSED X-SECTIONS - STA. 54+60 TO 80+19.50
5	EXISTING & PROPOSED X-SECTIONS - STA. 80+19.5 TO 105+07.8
6	EXISTING & PROPOSED X-SECTIONS - STA. 105+07.8 TO 128+06
7	EXISTING & PROPOSED X-SECTIONS - STA. 128+06 TO 128+95
8	TYPICAL ENTRANCES, SIDE ROAD INTERSECTIONS, MAIL BOX TURNOUTS & INCIDENTAL HMA SURFACING
9	QUANTITY TABLES
10	HMA SHOULDERS & WIDENING DETAILS

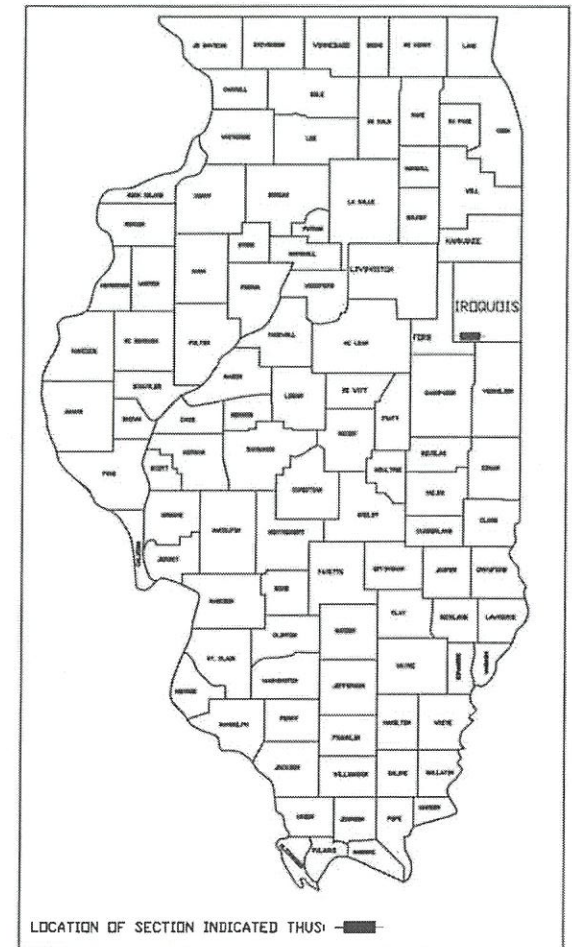

LOCATION OF SECTION INDICATED THUS: [Symbol]

MAJOR COLLECTOR 2032 ADT = 1430  
PV = 88% SU = 7% MU = 5%  
DESIGN SPEED = 50 M. P. H.

ILLINOIS HIGHWAY STANDARD DRAWINGS	
000001-08	SYMBOLS AND ABBREVIATIONS
701301-04	LANE CLOSURE, 2L 2W, SHORT TIME OPERATION, FOR SPEEDS > 45 MPH
701306-04	LANE CLOSURE, 2L 2W, SLOW MOVING DAY ONLY OPERATION, FOR SPEEDS > 45 MPH
701311-03	LANE CLOSURE 2L, 2W MOVING OPERATIONS, DAY ONLY
701901-08	TRAFFIC CONTROL DEVICES
780001-05	TYPICAL PAVEMENT MARKINGS
BLR 21-9	TYPICAL APPLICATION OF TRAFFIC CONTROL DEVICES FOR CONSTRUCTION ON RURAL LOCAL HIGHWAYS
BLR 24-2	MAILBOX TURNOUT

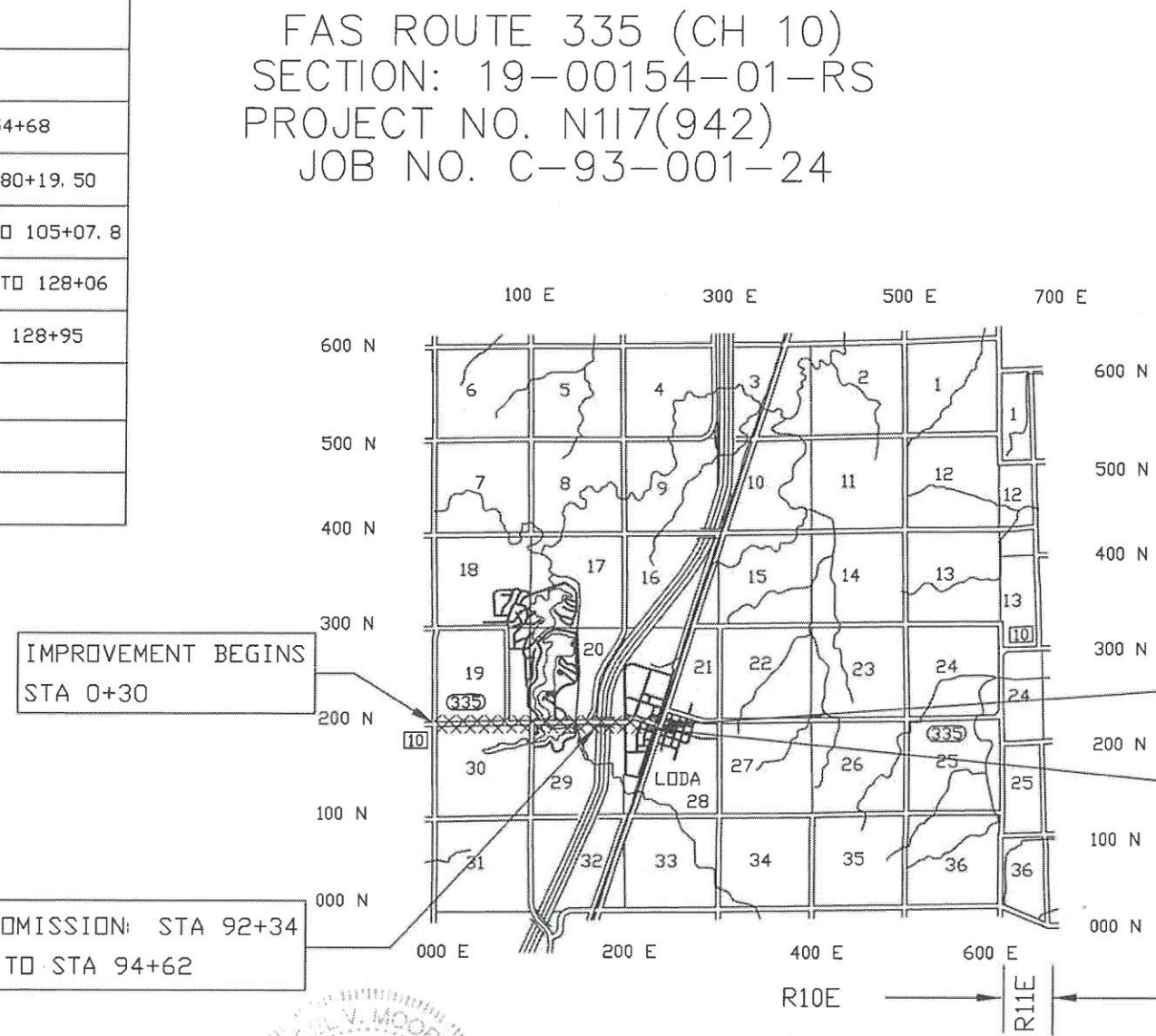

IMPROVEMENT BEGINS  
STA 0+30

IMPROVEMENT ENDS STA 128+95  
INTERSECTION OF CH 10 & US RT 45

OMISSION: STA 92+34  
TO STA 94+62

OMISSION: STA 128+06  
TO STA 128+15

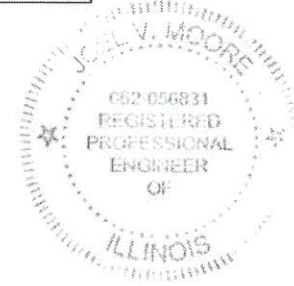

\*THESE PLAN WERE PREPARED BY ME OR BY A  
FULL TIME MEMBER OF MY STAFF WORKING  
UNDER MY DIRECT SUPERVISION\*

*[Signature]*  
JOEL V. MOORE, COUNTY ENGINEER  
ILL. REG. PROF. ENG. #62056831  
DATE EXPIRES: 11/30/23

0 1 2 3 4  
SCALE  
MILE

GROSS LENGTH = 12,865.00 FT. = 2.437 MILE  
OMISSION LENGTH = 237.00 FT. = .045 MILE  
NET LENGTH = 12,628.00 FT. = 2.391 MILE

"PRINTED BY THE AUTHORITY  
OF THE STATE OF ILLINOIS"

CONTRACT 87814

Approved *[Signature]* February 9<sup>th</sup>, 2023  
County Engineer

Passed *[Signature]* FEBRUARY 24, 2023  
DISTRICT THREE LOCAL ROADS AND STREETS ENGINEER

RELEASED FOR BID  
BASED ON LIMITED  
REVIEW *[Signature]* FEBRUARY 24, 2023  
REGION TWO ENGINEER

STATE OF ILLINOIS  
DEPARTMENT OF TRANSPORTATION



SUMMARY OF QUANTITIES			FUND CODE	0005
ITEM #	PAY ITEM #	PAY ITEM	UNIT	QUANTITY
* 1	20200500	EARTH EXCAVATION (WIDENING)	CU YD	137
* 2	35501326	HOT-MIX ASPHALT BASE COURSE, 10 1/2"	SQ YD	267
3	40600290	BITUMINOUS MATERIALS (TACK COAT)	POUND	21,681
4	40600370	LONGITUDINAL JOINT SEALANT	FOOT	12,628
* 5	40600982	HOT-MIX ASPHALT SURFACE REMOVAL-BUTT JOINT	SQ YD	643
6	40600990	TEMPORARY RAMP	SQ YD	102
7	40602978	HOT-MIX ASPHALT BINDER COURSE, IL-9.5, N50	TON	2,750
8	40604050	HOT-MIX ASPHALT SURFACE COURSE, IL-9.5, MIX "C", N50	TON	2,750
9	40800050	INCIDENTAL HOT-MIX ASPHALT SURFACING	TON	487
* 10	44000100	PAVEMENT REMOVAL	SQ YD	267
* 11	48101200	AGGREGATE SHOULDERS, TYPE B	TON	2,400
* 12	48203100	HOT-MIX ASPHALT SHOULDERS	TON	277
13	67100100	MOBILIZATION	L SUM	1
14	70300100	SHORT TERM PAVEMENT MARKING	FOOT	2,530
15	70300150	SHORT TERM PAVEMENT MARKING REMOVAL	SQ FT	422
16	70300221	TEMPORARY PAVEMENT MARKING - LINE 4' - PAINT	FOOT	43,238
# 17	78000100	THERMOPLASTIC PAVEMENT MARKING - LETTERS & SYMBOLS	SQ FT	122
# 18	78000200	THERMOPLASTIC PAVEMENT MARKING - LINE 4'	FOOT	700
# 19	78000650	THERMOPLASTIC PAVEMENT MARKING - LINE 24'	FOOT	77
# * 20	78001110	PAINT PAVEMENT MARKING - LINE 4'	FOOT	85,076
# 21	78011000	GROOVING FOR RECESSED PAVEMENT MARKING, LETTERS & SYMBOLS	SQ FT	122
# 22	78011025	GROOVING FOR RECESSED PAVEMENT MARKING 5'	FOOT	700
# 23	78011125	GROOVING FOR RECESSED PAVEMENT MARKING 25'	FOOT	77
* 24	X7010216	TRAFFIC CONTROL AND PROTECTION, (SPECIAL)	L SUM	1
* 25	Z0034105	MATERIAL TRANSFER DEVICE	TON	5,500
* 26	Z0048665	RAILROAD PROTECTIVE LIABILITY INSURANCE	L SUM	1

\* SEE SPECIAL PROVISIONS  
# SPECIALTY ITEMS

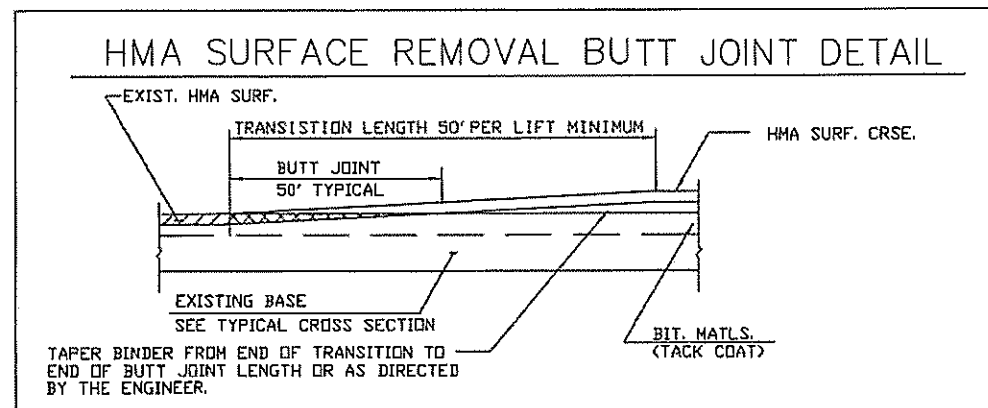

### MIXTURE TABLE

	HMA BINDER	HMA SURFACE	INCIDENTAL HMA	HMA SHOULDER BOTTOM 6"	HMA BASE COURSE 10 1/2"
PG GRADE	PG64-22	PG64-22	PG64-22	PG64-22	PG64-22
DESIGN AIR Voids	4.0% @ N50	4.0% @ N50	4.0% @ N50	4.0% @ N50	4.0% @ N50
MIXTURE COMPOSITION	IL 9.5	IL 9.5	IL 9.5	IL 19.0	IL 19.0
FRICTION AGGREGATE	N/A	MIXTURE C	MIXTURE C		
DENSITY TEST METHOD	CORES/NUCLEAR	CORES/NUCLEAR	SATISFACTION OF ENGINEER	CORES/NUCLEAR	CORES/NUCLEAR
MIXTURE WEIGHT	112#/Sq. Yd./In.	112#/Sq. Yd./In.	112#/Sq. Yd./In.	112#/Sq. Yd./In.	112#/Sq. Yd./In.
QUALITY MANAGEMENT PROGRAM	QC/QA	QC/QA	QC/QA	QC/QA	QC/QA
SUBLOT SIZE	N/A	N/A	N/A	N/A	N/A
LOCATION(S)	ENTIRE PROJECT	ENTIRE PROJECT	ENTIRE PROJECT	HMA SHOULDERS	STA 128+15 TO 128+95
MATERIAL TRANSFER DEVICE (REQUIRED)	YES	YES	NO	NO	NU

MATERIAL SHALL BE COMPACTED TO 93.0-97.4 PERCENT OF THE MAXIMUM THEORETICAL DENSITY, EXCEPT THAT WHEN PLACED AS FIRST LIFT ON AN UNIMPROVED SUBGRADE THE MINIMUM PERCENT COMPACTION SHALL BE 92.0 PERCENT. THE MAXIMUM THEORETICAL DENSITY SHALL BE DETERMINED FROM THE MOVING AVERAGE AS SPECIFIED IN THE QC/QA SPECIFICATION.

### GENERAL NOTES

THE THICKNESS OF HOT-MIX ASPHALT MIXTURES SHOWN ON THE TYPICAL X-SECTION IS THE NOMINAL THICKNESS. DEVIATIONS FROM THE NOMINAL THICKNESS WILL BE PERMITTED WHEN SUCH DEVIATIONS OCCUR DUE TO IRREGULARITIES IN THE EXISTING SURFACE.

THE ENGINEER SHALL BE THE SOLE JUDGE CONCERNING CURING TIME FOR THE VARIOUS HOT-MIX ASPHALT LIFTS.

ANY REFERENCE TO A STANDARD IN THESE PLANS SHALL BE INTERPRETED TO MEAN THE EDITION AS INDICATED BY THE SUB-NUMBER LISTED IN THE INDEX OF SHEETS OR THE COPY OF THE STANDARD INCLUDED IN THESE PLANS.

### SECTION NOTES

THE PROPOSED IMPROVEMENT CONSISTS OF A HOT MIX ASPHALT SURFACE COURSE INCLUDING BINDER COURSE, SHOULDER STONE AND ALL WORK NECESSARY TO COMPLETE THE PROJECT ACCORDING TO THE PLANS AND SPECIFICATIONS. COUNTY HIGHWAY 10 WAS CONSTRUCTED UNDER SECTIONS: 154-15d, 154S, 154 Q1 AND TWO NON-MFT SECTIONS IN (1972,1973). THE EXISTING BITUMINOUS CONCRETE SURFACE WAS CONSTRUCTED IN 1975 AS 154-Q1 & IN 1999 AS 99-00154-00-RS.

### APPLICATION RATES

THE FOLLOWING RATES OF APPLICATION HAVE BEEN ASSUMED IN CALCULATING PLAN QUALITIES:

GRANULAR MATERIALS	2.05	TONS/CU YD
BITUMINOUS MATERIALS PRIME COAT	0.05/0.025	LBS/SQ FT
HOT MIX ASPHALT SURFACE COURSE	112	LBS/SQ YD/INCH
BINDER COURSE, IL-19.0, N50	112	LBS/SQ YD/INCH
SHORT TERM PAVEMENT MARKING	4	FT/40 FT OF APPLICATION
PAINT PAVEMENT MARKING - LINE 4'	10	FT/40 FT OF APPLICATION

EXISTING TYPICAL SECTION 1 - 0+30 TO 54+68

ROUTE NO.	SECTION	COUNTY	TOTAL SHEETS	SHEET NO.
FAS 335	19-00154-01-RS	IRROQUOIS	10	3
JOB # : C-93-001-24			PROJECT # : N117(942)	
CONTACT 87814				

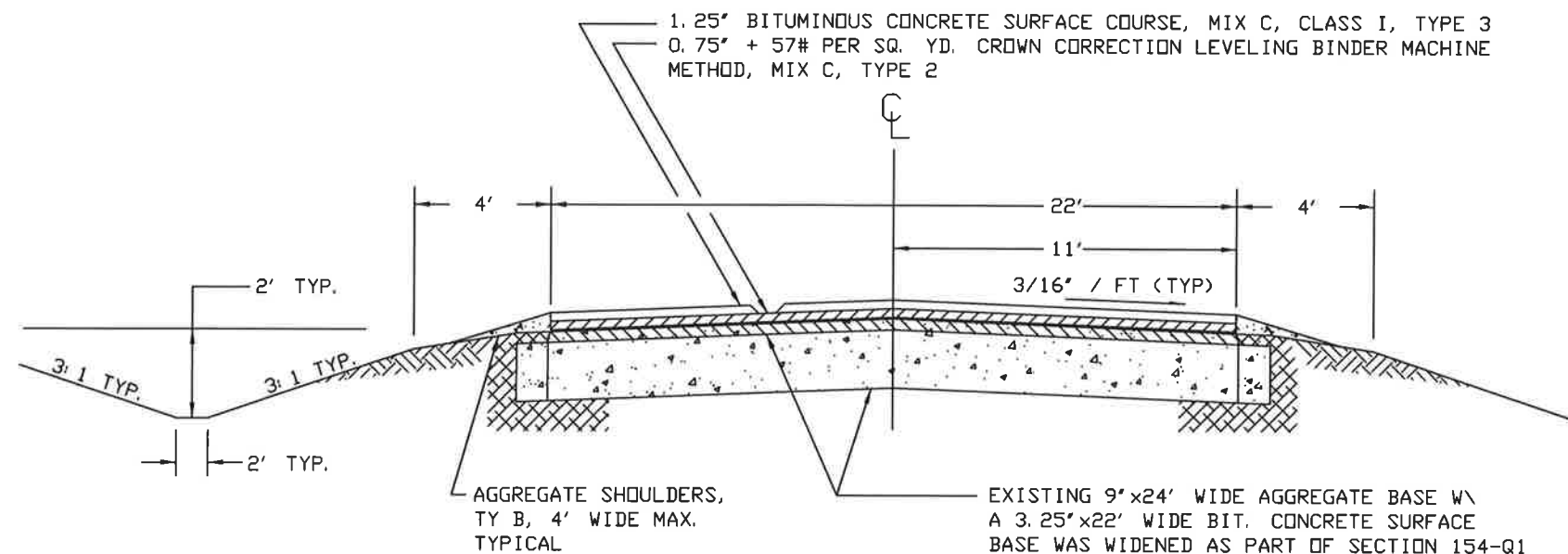

PROPOSED TYPICAL SECTION 1 - 0+30 TO 54+68

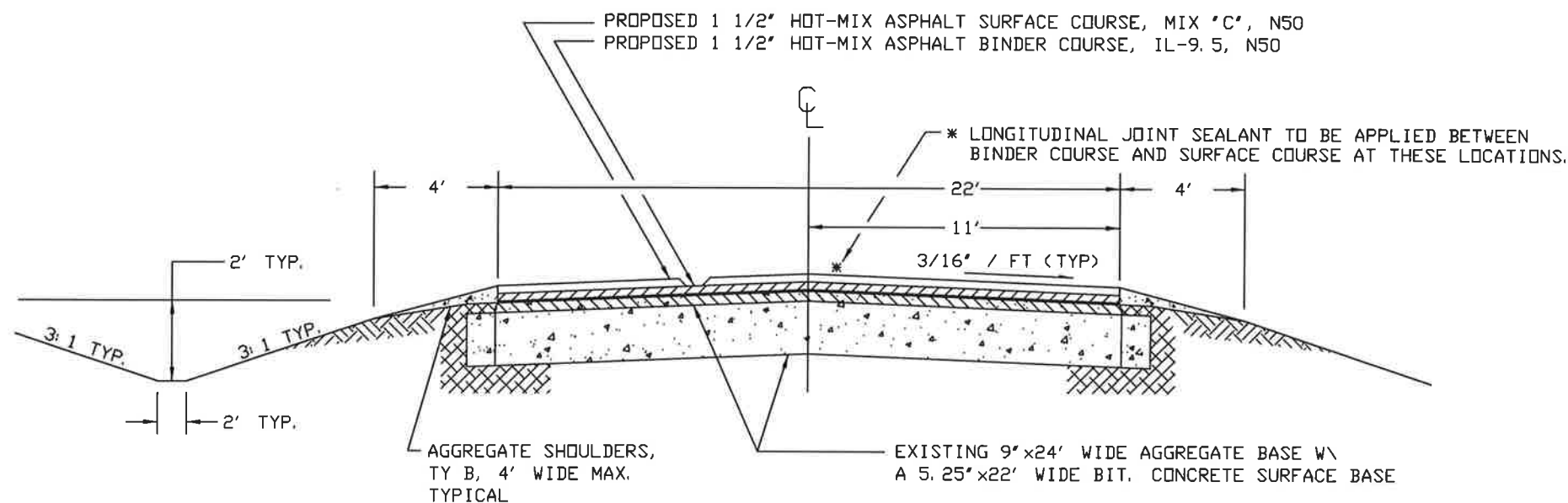

PAVEMENT DESIGN - CH 10

STRUCTURAL DESIGN TRAFFIC:	YEAR 2031	
PV= 581 (88%)	SU= 46 (7%)	MU= 33 (5%)
ROAD CLASSIFICATION	CLASS III	
TRAFFIC FACTOR:	ACTUAL TF = 0.18	AC TYPE = PG 64-22
	MINIMUM TF = 1.70	
PG GRADE:	BINDER = PG 64-22	SURFACE = PG 64-22
SUB GRADE SUPPORT RATING:	IBV = 2.4 (STA. 0+30 TO 54+68)	

EXISTING TYPICAL SECTION - 54+68 TO 80+19.5

ROUTE NO.	SECTION	COUNTY	TOTAL SHEETS	SHEET NO.
FAS 335	19-00154-01-RS	IRROQUOIS	10	4
JOB # : C-93-001-24			PROJECT # : N117(942)	
CONTACT 87814				

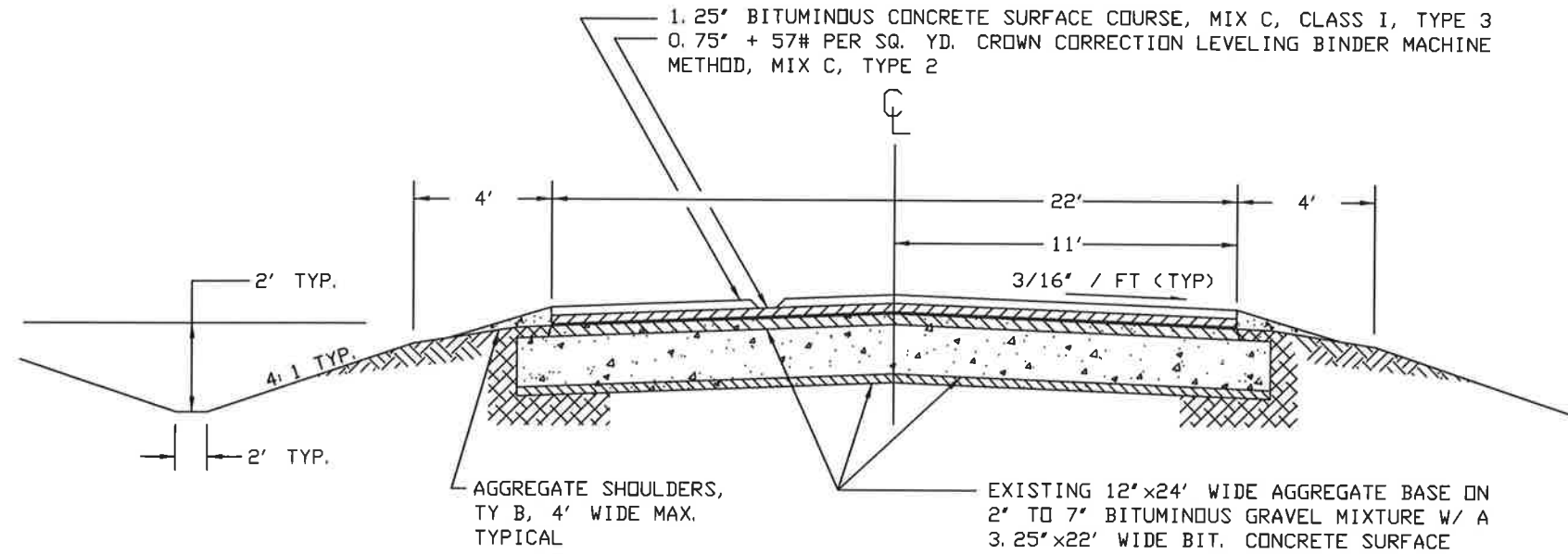

PROPOSED TYPICAL SECTION - 54+68 TO 80+19.5

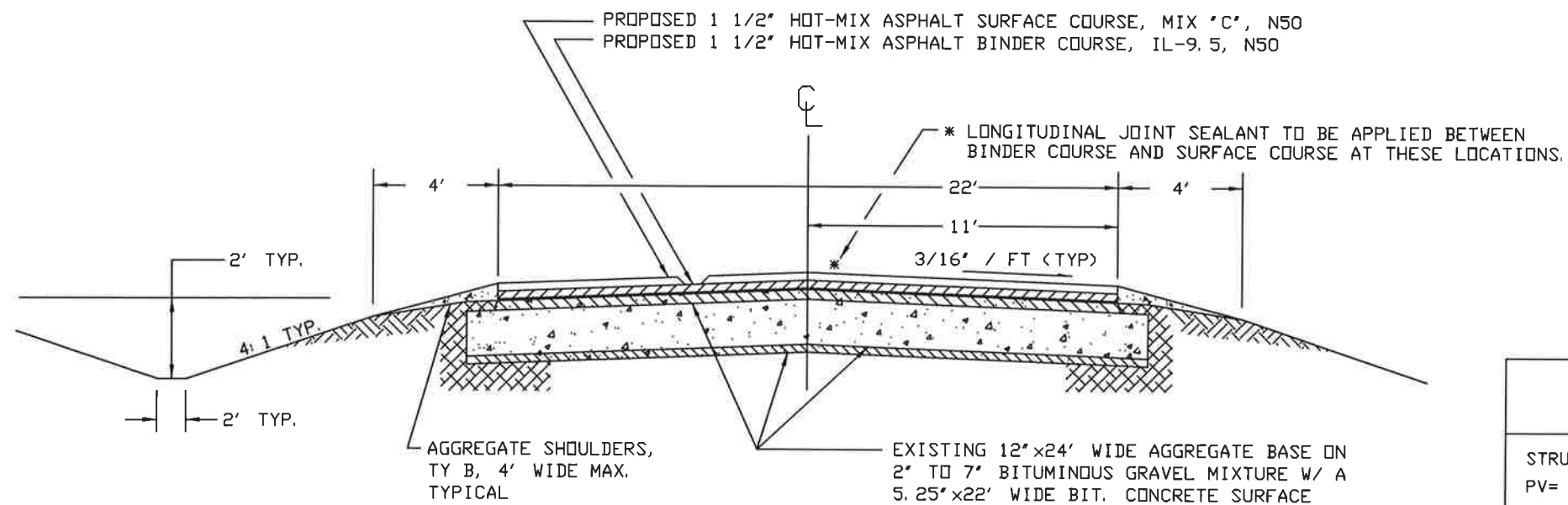

PAVEMENT DESIGN - CH 10

STRUCTURAL DESIGN TRAFFIC:	YEAR 2031	
PV= 581 (88%)	SU= 46 (7%)	MU= 33 (5%)
ROAD CLASSIFICATION	CLASS III	
TRAFFIC FACTOR:	ACTUAL TF = 0.18	AC TYPE = PG 64-22
	MINIMUM TF = 1.70	
PG GRADE:	BINDER = PG 64-22	SURFACE = PG 64-22
SUB GRADE SUPPORT RATING:	IBV = 2.4 (STA. 54+68 TO 80+19.5)	

EXISTING TYPICAL SECTION 3 - 80+19.5 TO 105+07.8

ROUTE NO.	SECTION	COUNTY	TOTAL SHEETS	SHEET NO.
FAS 335	19-00154-01-RS	IRROQUOIS	10	5
JOB # : C-93-001-24			PROJECT # : N117(942)	
CONTACT 87814				

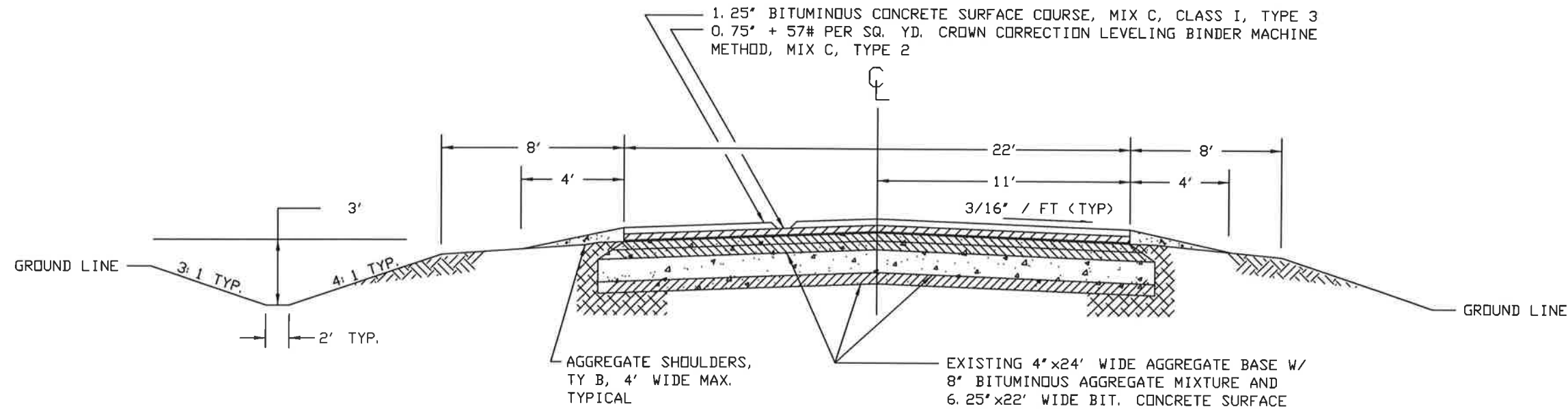

PROPOSED TYPICAL SECTION 3 - 80+19.5 TO 105+07.8

BRIDGE OMISSION: (FAI 57) - 92+34 TO 94+62

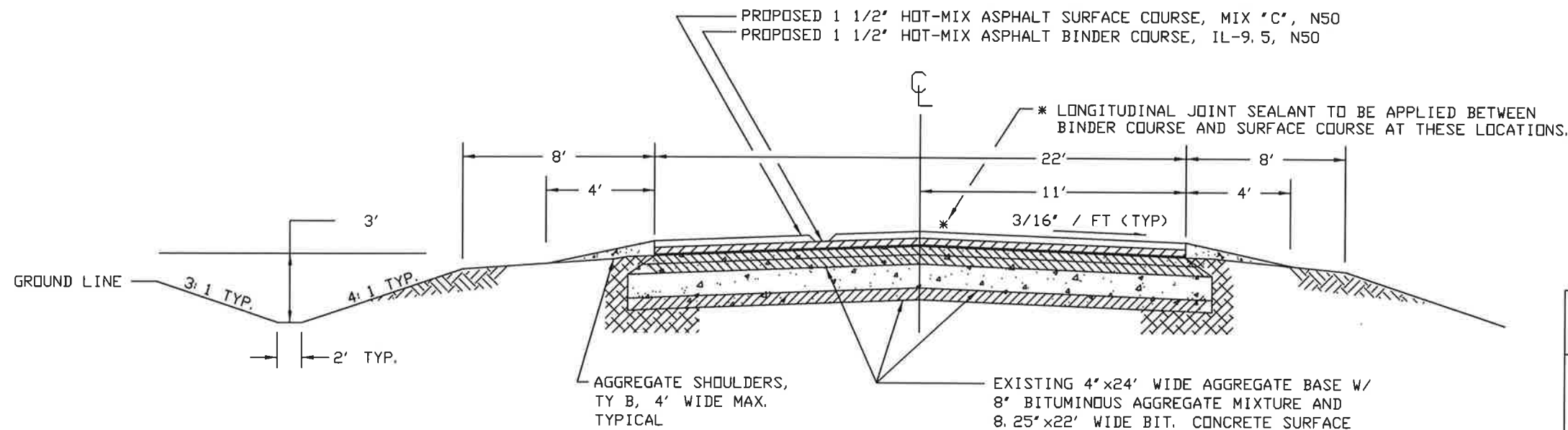

PAVEMENT DESIGN - CH 10

STRUCTURAL DESIGN TRAFFIC:	YEAR 2031	
PV= 1,258 (88%)	SU= 100 (7%)	MU= 72 (5%)
ROAD CLASSIFICATION	CLASS III	
TRAFFIC FACTOR:	ACTUAL TF = 0.39	AC TYPE = PG 64-22
	MINIMUM TF = 1.70	
PG GRADE:	BINDER = PG 64-22	SURFACE = PG 64-22
SUB GRADE SUPPORT RATING:	IBV = 2.4 (STA 80+19.5 TO 105+07.80)	

EXISTING TYPICAL SECTION 4 - 105+07.8 TO 128+06

ROUTE NO.	SECTION	COUNTY	TOTAL SHEETS	SHEET NO.
FAS 335	19-00154-01-RS	IRROQUOIS	10	6
JOB # : C-93-001-24			PROJECT #: N117(942)	
CONTACT 87814				

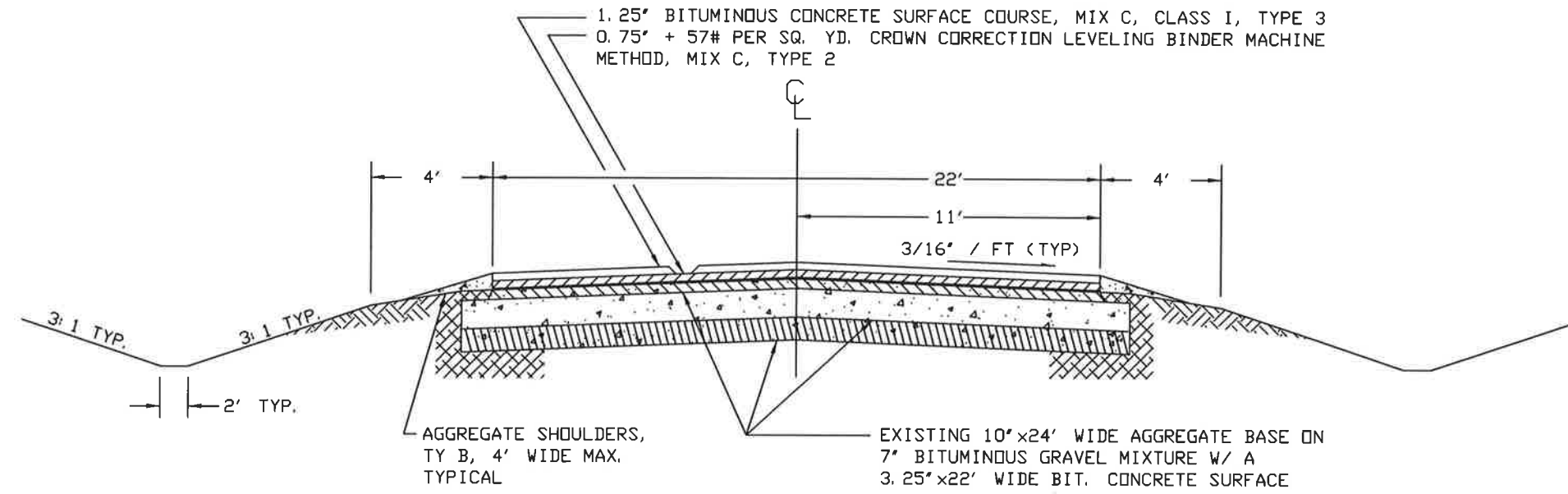

PROPOSED TYPICAL SECTION 4 - 105+07.8 TO 128+06

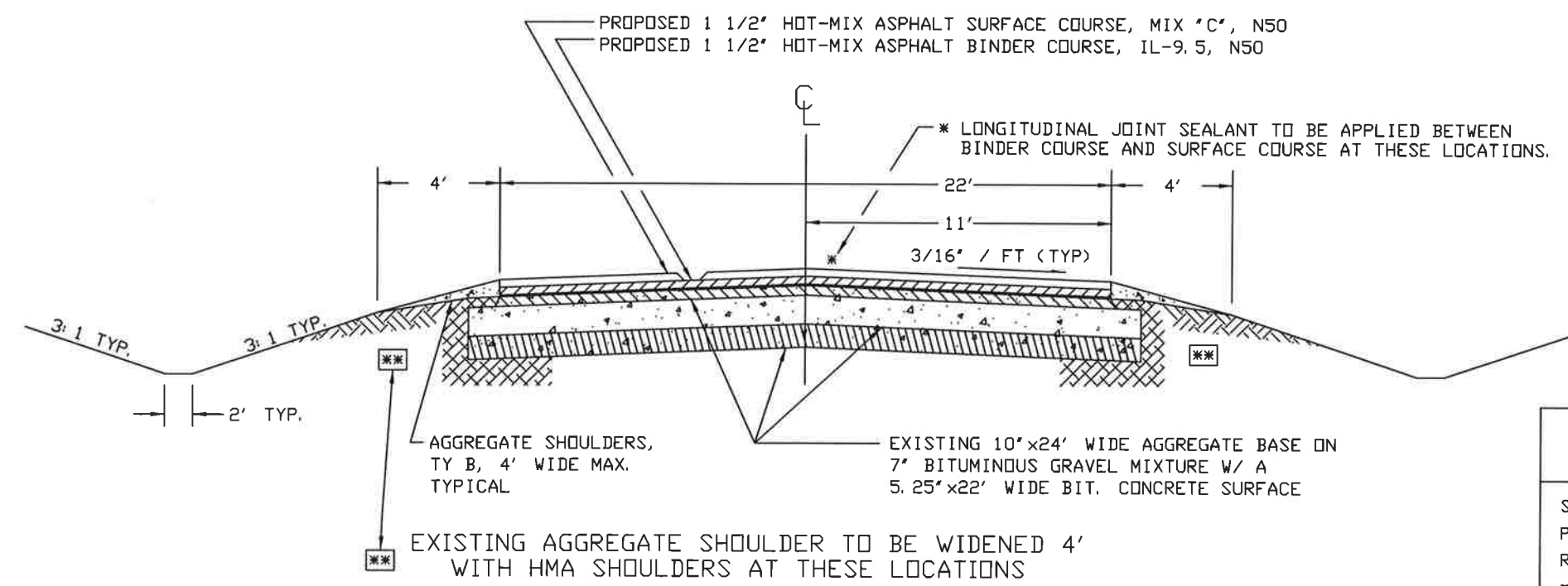

STATION 105+00 TO 107+44 RT	STATION 105+00 TO 107+93 LT
STATION 108+50 TO 115+60 RT	STATION 108+72 TO 113+15 LT
STATION 127+33 TO 128+06 RT	STATION 127+20 TO 128+06 LT

PAVEMENT DESIGN - CH 10

STRUCTURAL DESIGN TRAFFIC:	YEAR 2031
PV= 1,258 (88%)	SU= 100 (7%) MU= 72 (5%)
ROAD CLASSIFICATION	CLASS III
TRAFFIC FACTOR:	ACTUAL TF = 0.39 AC TYPE = PG 64-22 MINIMUM TF = 1.70
PG GRADE:	BINDER = PG 64-22 SURFACE = PG 64-22
SUB GRADE SUPPORT RATING:	IBV = 2.4 (STA. 105+07.8 TO 128+06)

EXISTING TYPICAL SECTION 5 - 128+06 TO 128+95

ROUTE NO.	SECTION	COUNTY	TOTAL SHEETS	SHEET NO.
FAS 335	19-00154-01-RS	IRROQUOIS	10	7
JOB # : C-93-001-24			PROJECT # : N117(942)	
CONTACT 87814				

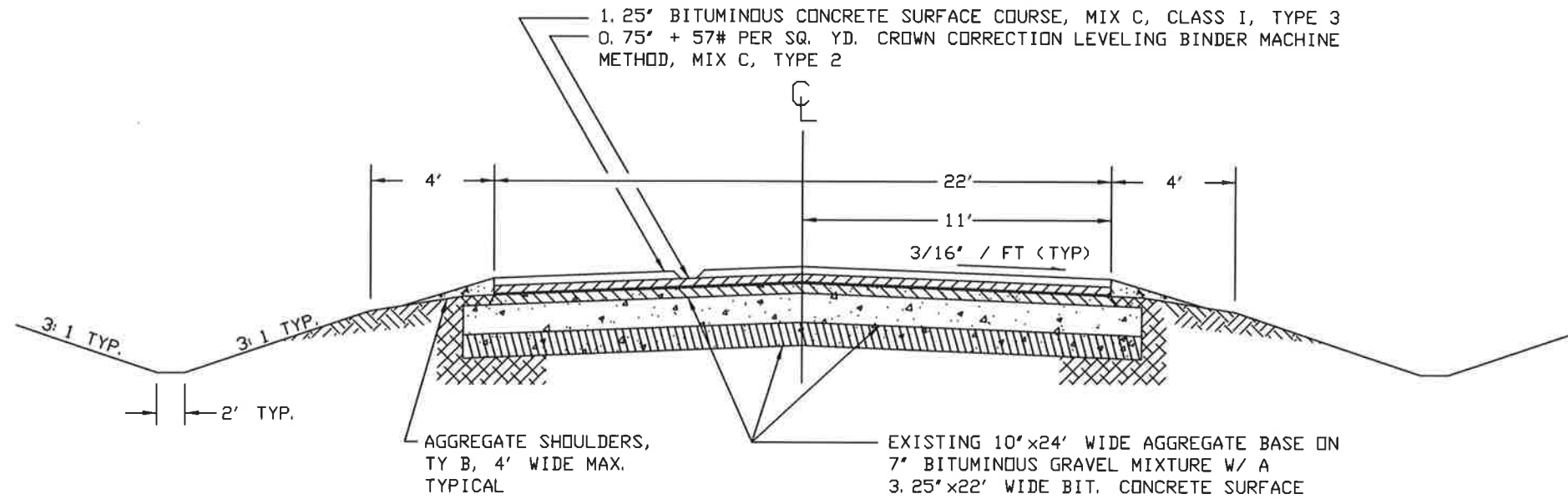

PROPOSED TYPICAL SECTION 5 - 128+06 TO 128+95

\*\* RAILROAD OMISSION - 128+06 TO 128+15

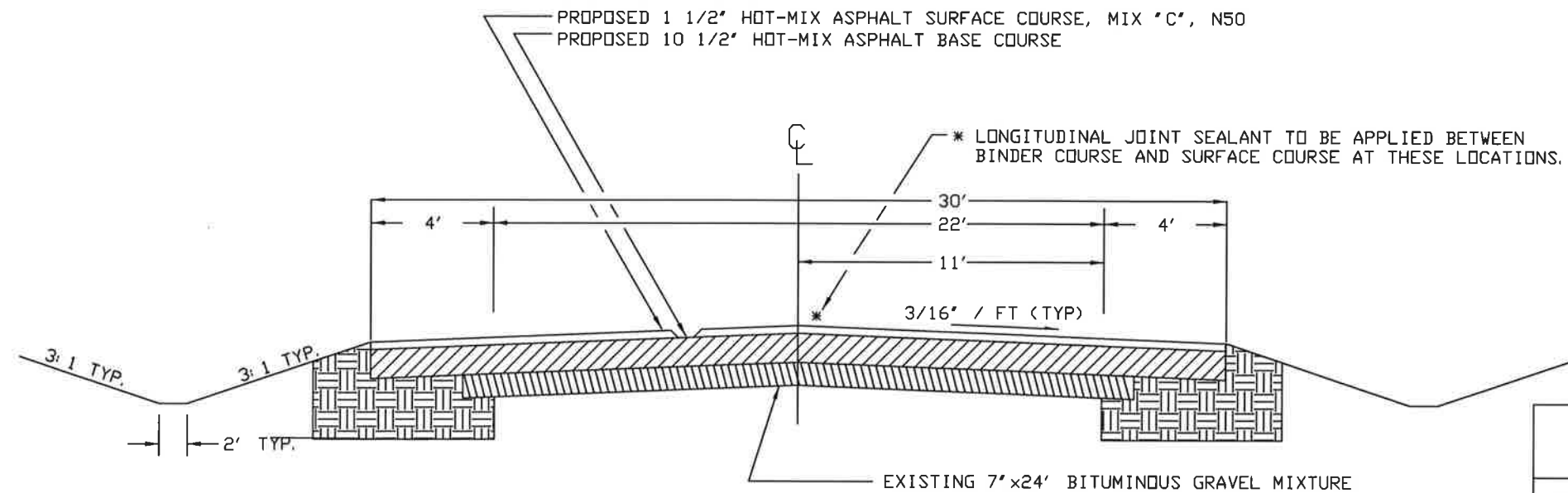

PAVEMENT DESIGN - CH 10

STRUCTURAL DESIGN TRAFFIC:	YEAR 2031	
PV= 1,258 (88%)	SU= 100 (7%)	MU= 72 (5%)
ROAD CLASSIFICATION	CLASS III	
TRAFFIC FACTOR:	ACTUAL TF = 0.39	AC TYPE = PG 64-22
	MINIMUM TF = 1.70	
PG GRADE:	BINDER = PG 64-22	SURFACE = PG 64-22
SUB GRADE SUPPORT RATING:		
IBV = 2.4	(STA. 128+06 TO 128+95)	

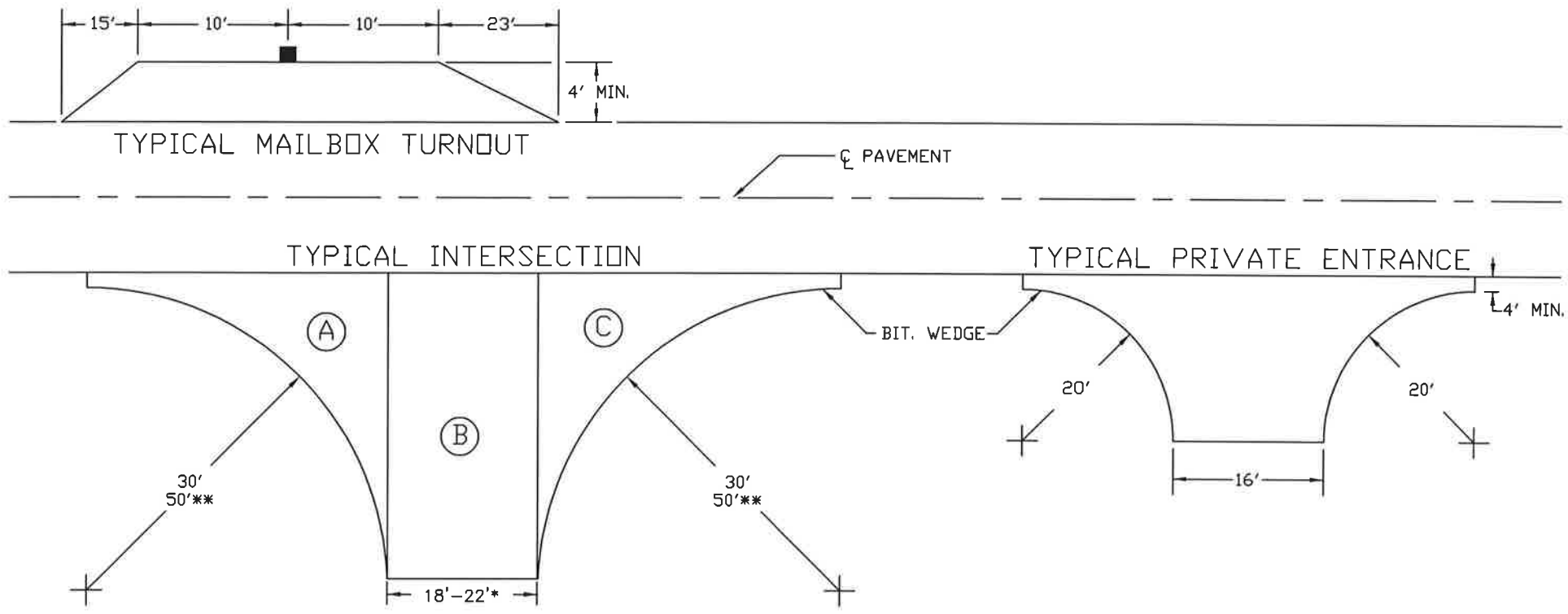

A+C = RADIUS ON MAINLINE SHOWN AS SIDE = VAR  
 ALL INTERSECTION ARE 18' WIDE UNLESS INDICATED WITH A \*.  
 A+B+C = TYPICAL SIDE ROAD INTERSECTION

NOTE: ALL PRIVATE ENTRANCES, MAIL BOX TURNOUTS AND SIDE ROAD INTERSECTIONS SHALL BE PAID FOR AS INCIDENTAL BITUMINOUS SURFACING - TOTAL 487 TON.

NOTE: AGGREGATE SHALL BE PLACED AROUND ALL PRIVATE ENTRANCES, MAIL BOX TURNOUTS AND SIDE ROAD INTERSECTIONS AND SHALL BE CONSIDERED INCIDENTAL TO AGGREGATE SHOULDERS, TYPE B AND PLACED AS DIRECTED BY THE ENGINEER.

### 40800050 - INCIDENTAL HMA SURFACING

TYPICAL INTERSECTION				TYPICAL PRIVATE & FIELD ENTRANCES				TYPICAL MAILBOX TURNOUT			
STATION	SIDE	SQ. YD.	TON	STATION	TYPE WIDTH	SQ. YD.	TON	STATION	SIDE	SQ. YD.	TON
41+59	20' LT	110	16	14+59	FE RT 10'	45	6	80+56	FE LT 4'	25	4
55+00	20' RT	110	16	14+74	FE LT 4'	25	4	81+47	FE LT 4'	25	4
57+58	16' RT	96	14	17+94	PE RT	55	8	84+51	PE LT	110	16
59+40	LT	103	15	28+15	FE RT 12'	49	7	84+63	FE RT	55	8
68+46	RT & LT	206	30	28+15	FE LT 4'	25	4	85+83	PE LT	55	8
73+53	LT	103	15	45+09	FE RT 4'	25	4	103+96	FE RT 6'	34	5
80+02	20' RT	110	16	46+20	PE RT	55	8	115+80	PE RT	55	8
87+10	LT	103	15	54+12	PE LT	55	8	116+53	PE RT	55	8
108+20	RT & LT	206	30	55+22	PE LT	55	8	117+39	PE LT	55	8
114+06	30' LT	143	20	57+85	PE LT	55	8	120+26	PE RT	55	8
118+36	RT	103	15	63+94	FE RT 6'	34	5	121+10	PE RT	55	8
122+57	16' RT & LT	192	28	72+85	PE RT	55	8	124+60	PE RT	55	8
126+89	30' RT & 24' LT	266	38	74+25	PE RT	55	8	124+60	PE LT	55	8
TOTALS		1851	268	78+03	PE RT	55	8	125+79	PE RT	55	8
				SUBTOTAL		643	94	SUBTOTAL		744	109

TOTALS 1387 SQ YD 203 TON

INCIDENTAL HMA SURFACING TOTALS	
TYPICAL INT.'S & SIDE ROADS	268 TONS
PRIVATE ENTRANCES	203 TONS
TYPICAL MAILBOX TURNOUT	16 TONS
<b>TOTAL = 487 TONS</b>	



40600982  
HMA SURFACE REMOVAL  
BUTT JOINT

STATION TO STATION	SQ. YDS.
0+30 TO 0+80	122
57+58 RT	14
59+40 LT	83
68+46 RT	12
68+46 LT	33
72+85 RT	13
91+84 TO 92+34	122
94+62 TO 95+12	122
127+56 TO 128+06	122
TOTAL =	643

40600990  
TEMPORARY RAMP

STATION	SQ. YDS.
0+30 TO 0+37	17
92+27 TO 92+34	17
94+62 TO 94+69	17
127+99 TO 128+06	17
128+15 TO 128+22	17
128+88 TO 128+95	17
TOTAL =	102

78011025  
GROOVING FOR RECESSED  
PAVEMENT MARKING 5"

STATION TO STATION	FOOT
127+20 TO 128+95 RT	175
127+20 TO 128+95 LT	175
127+20 TO 128+95	350
TOTAL =	700

ROUTE NO.	SECTION	COUNTY	TOTAL SHEETS	SHEET NO.
FAS 335	19-00154-01-RS	IRROQUOIS	10	9
JOB #: C-93-001-24		PROJECT #: N117(942)		
CONTRACT 87814				

78000200  
THERMOPLASTIC PAVEMENT  
MARKING - LINE 4"

STATION TO STATION	TYPE	COLOR	FOOT
127+20 TO 128+95 RT	EDGE LINE	WHITE	175
127+20 TO 128+95 LT	EDGE LINE	WHITE	175
127+20 TO 128+95	DOUBLE NO PASS	YELLOW	350
TOTAL =			700

78000100  
THERMOPLASTIC PAVEMENT  
MARKING, LETTERS & SYMBOLS

STATION TO STATION	SQ FT
125+49 RT	61
128+67 LT	61
TOTAL =	122

78011000  
GROOVED FOR RECESSED  
PAVEMENT MARKING  
LETTERS & SYMBOLS

STATION TO STATION	SQ FT
125+49 RT	61
128+67 LT	61
TOTAL =	122

78011125  
GROOVING FOR RECESSED  
PAVEMENT MARKING 25"

STATION	FOOT
125+26 RT	11
125+69 RT	11
127+90.5 RT	11
128+30.5 LT	11
128+45 LT	11
128+92 RT	11
128+92 LT	11
TOTAL =	77

67100100  
MOBILIZATION

STATION TO STATION	L SUM
ENTIRE JOB	1
TOTAL =	1

78000650  
THERMOPLASTIC PAVEMENT  
MARKING - LINE 24"

STATION	FOOT
125+26 RT	11
125+69 RT	11
127+90.5 RT	11
128+30.5 LT	11
128+45 LT	11
128+92 RT	11
128+92 LT	11
TOTAL =	77

78001110 - PAINT PAVEMENT MARKING - LINE 4"  
70300221 - TEMPORARY PAVEMENT MARKING  
LINE 4" - PAINT

STATION TO STATION	FOOT	LINE 4"
NO PASSING ZONES		
41+50 TO 127+20 RT	8,570	8,570
55+00 TO 127+20 LT	7,220	7,220
CENTERLINE		
0+30 TO 55+00	5,470	1,368
EDGING		
0+30 TO 128+95 RT & LT	25,380	25,380
SUB -TOTAL=		42,538
TOTAL ALL STRIPING FOR PAINT PAVEMENT MARKING LINE 4" (TWO APPLICATIONS) = 85,076'		
TOTAL FOR TEMPORARY PAVEMENT MARKING = 43,238'		

70300100  
SHORT TERM  
PAVEMENT MARKING

STATION TO STATION	FOOT
0+30 TO 92+34	921
94+62 TO 128+95	344
TOTAL =	1,265
(2 LIFTS) TOTAL =	2,530

X7010216  
TRAFFIC CONTROL &  
PROTECTION (SPECIAL)

STATION TO STATION	L SUM
ENTIRE JOB	1
TOTAL =	1

70300150  
SHORT TERM PAVEMENT  
MARKING REMOVAL

STATION TO STATION	SQ FT
0+30 TO 128+95	422
TOTAL =	422

Z0048665  
RAILROAD PROTECTIVE  
LIABILITY INSURANCE

STATION TO STATION	L SUM
ENTIRE JOB	1
TOTAL =	1

PAVEMENT SCHEDULE

PAY ITEM	40602978	40604050	48101200	40600290	40600370	Z0034105	48203100
UNIT	(TON)	(TON)	(TON)	(POUND)	(FOOT)	(TON)	(TON)
STATION TO STATION	HMA BINDER COURSE IL-9.5, N50	HMA SURFACE COURSE IL-9.5 MIX 'C' N50	AGGREGATE SHOULDERS TYPE B	BITUMINOUS MATERIALS (TACK COAT)	LONGITUDINAL JOINT SEALANT	MATERIAL TRANSFER DEVICE	HMA SHOULDERS
0+30 TO 128+95		2,750	2,400	21,631	12,628	5,500	277
0+30 TO 128+06	2,750						
128+15 TO 128+95				50			
TOTAL =	2,750	2,750	2,400	21,681	12,628	5,500	277

# EARTH EXCAVATION (WIDENING), HMA SHOULDERS, HMA BASE COURSE 10 1/2" & PAVEMENT REMOVAL

ROUTE NO.	SECTION	COUNTY	TOTAL SHEETS	SHEET NO.
FAS 335	19-00154-01-RS	IRDOUDIS	10	10
JOB #: C-93-001-24			PROJECT #: N117(942)	
CONTRACT 87814				

COUNTY HIGHWAY 10  
INTERSECTION AT  
200N/200E

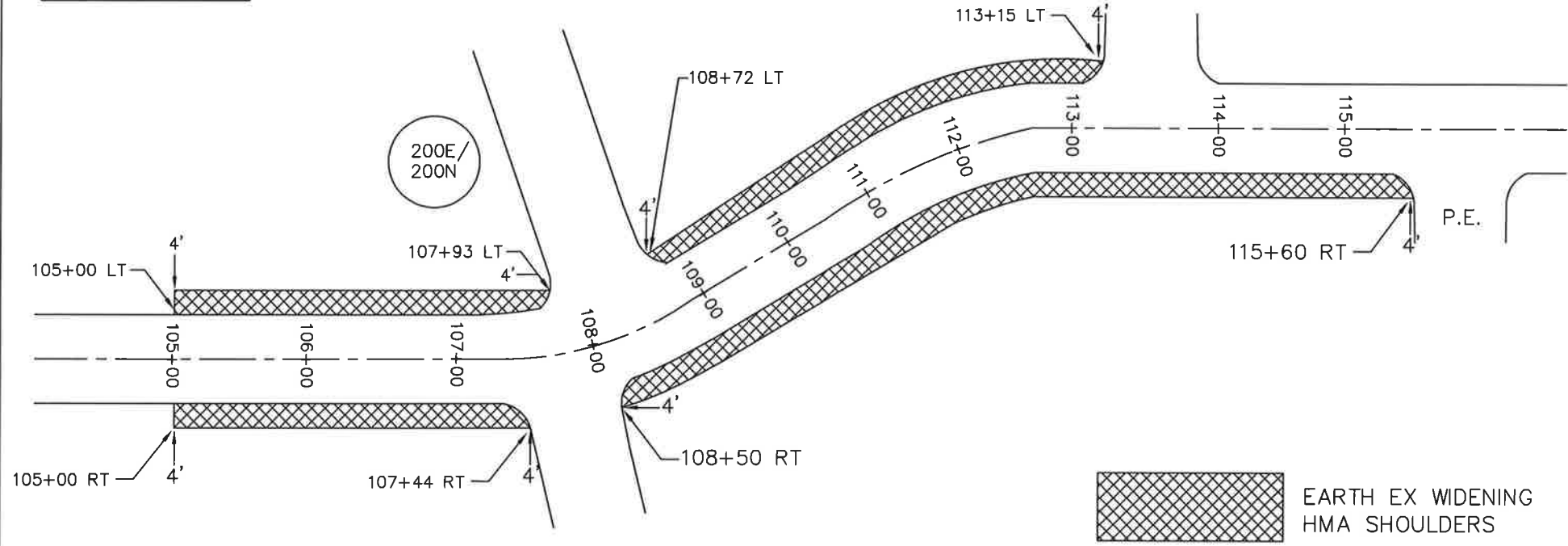

HMA BASE COURSE, 10 1/2" DETAIL  
HMA SHOULDERS DETAIL

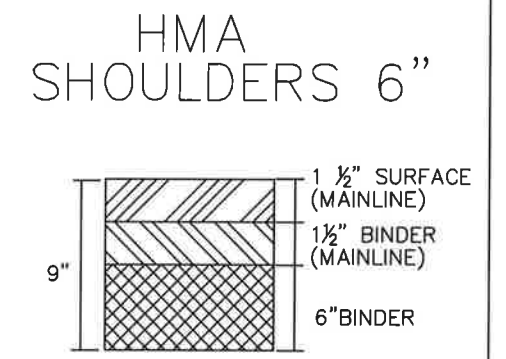
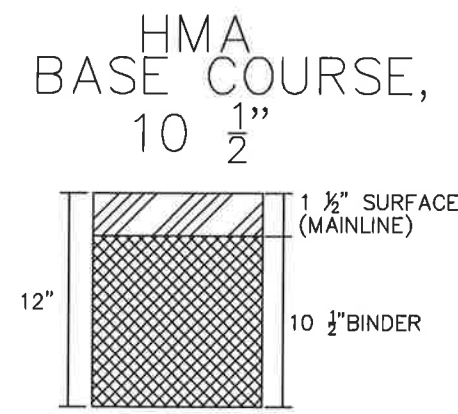

COUNTY HIGHWAY 10  
INTERSECTION AT US 45 &  
WASHINGTON STREET

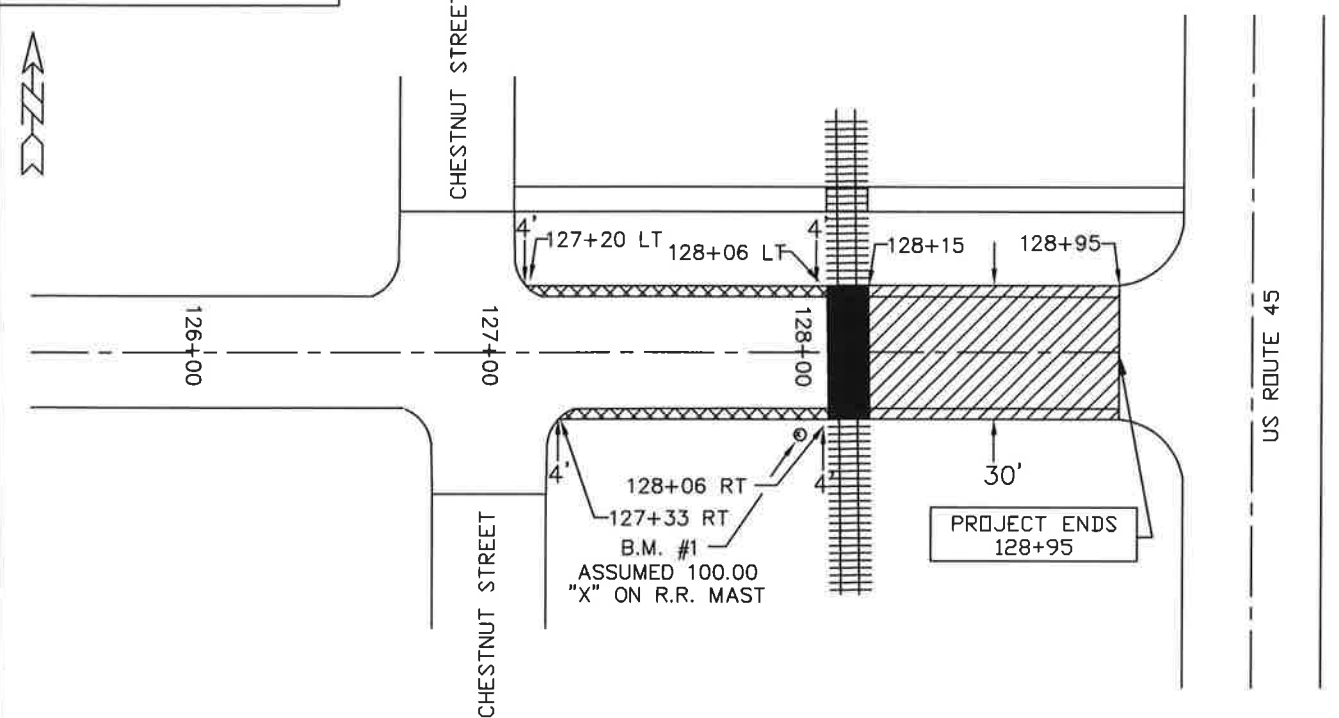

## ROADWAY ELEVATIONS

STATION	EXISTING ELEVATIONS	PROPOSED ELEVATIONS
127+50	99.13	99.38
127+60	99.32	99.57
127+70	99.52	99.77
127+80	99.71	99.83
127+90	99.58	99.91
128+00	99.94	99.94
128+06 WEST PLANK	99.94	99.94
WEST RAIL	99.96	99.96
EAST RAIL	100.00	100.00
128+15 EAST PLANK	100.00	100.00
128+20	99.97	99.97
128+30	99.76	99.85
128+40	99.46	99.57
128+50	99.06	99.16
128+60	98.53	98.62
128+70	97.82	97.94
128+80	97.09	97.26
128+90	96.58	96.58

20200500  
EARTH EXCAVATION  
(WIDENING)

STATION	CU YD
STA 105+00 TO 107+44 RT	18
STA 105+00 TO 107+93 LT	22
STA 108+50 TO 115+60 RT	53
STA 108+72 TO 113+15 LT	33
STA 127+20 TO 128+06 LT	6
STA 127+33 TO 128+06 RT	5
<b>TOTAL =</b>	<b>137</b>

44000100  
PAVEMENT REMOVAL

STATION TO STATION	SQ YD
STA 128+15 TO 128+95	267
<b>TOTAL =</b>	<b>267</b>

35501326  
HMA BASE COURSE, 10 1/2"

STATION TO STATION	SQ YD
STA 128+15 TO 128+95	267
<b>TOTAL =</b>	<b>267</b>

48203100  
HMA SHOULDERS

STATION	TON
STA 105+00 TO 107+44 RT	37
STA 105+00 TO 107+93 LT	44
STA 108+50 TO 115+60 RT	106
STA 108+72 TO 113+15 LT	66
STA 127+20 TO 128+06 LT	13
STA 127+33 TO 128+06 RT	11
<b>TOTAL =</b>	<b>277</b>

EARTH EX WIDENING  
HMA SHOULDERS

HMA BASE COURSE, 10 1/2"  
PAVEMENT REMOVAL