

F.A.P. RTE.	SECTION	COUNTY	TOTAL SHEETS	SHEET NO.
303	29R-T	McHENRY	88	29
STA. 0+643.40		TO STA. 1+026.98		
FED. ROAD DIST. NO. 1		ILLINOIS FED. AID PROJECT		
JOB D-91-190-01		CONTRACT NO. 62202		

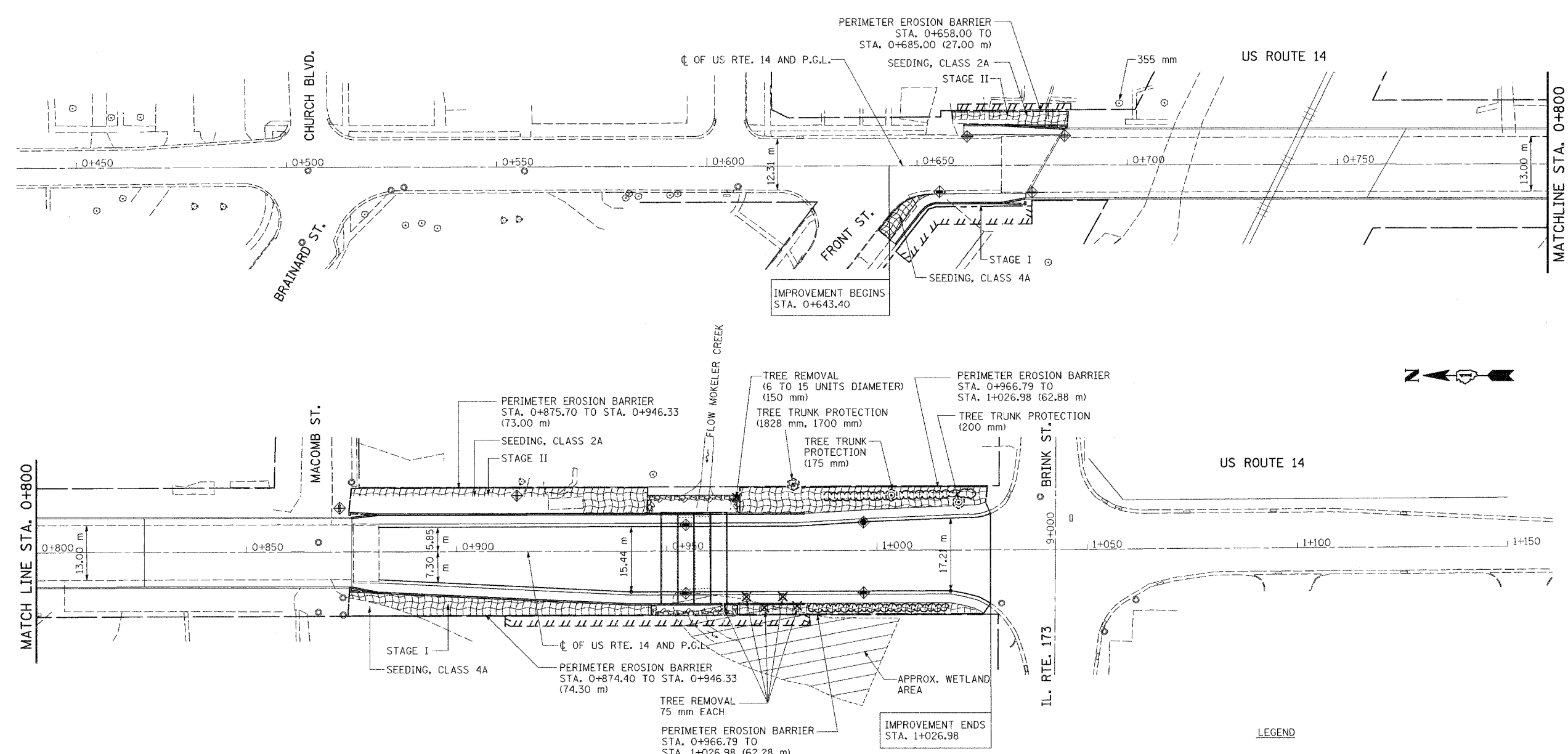

- NOTES:**
- SEE IDOT STANDARD 280001 FOR TEMPORARY EROSION CONTROL SYSTEMS.
 - THE CONTRACTOR SHALL ENSURE THAT THE PERIMETER EROSION BARRIER IS CONSTRUCTED AND SET IN PLACE PRIOR TO THE COMMENCEMENT OF ANY EXCAVATION, GRADING, OR OTHER DISTURBANCE OF THE EXISTING GROUND.
 - THE LOCATION OF THE PERIMETER EROSION BARRIER MAY BE ADJUSTED AS NEEDED FOR TEMPORARY CONSTRUCTION EASEMENTS OR ACCESS TO THE SITE. THE CONTRACTOR SHALL ENSURE THAT ADJACENT PROPERTIES REMAIN PROTECTED FROM SEDIMENT DEPOSITION.
 - SOIL STOCKPILES SHALL BE PROTECTED WITH PERIMETER EROSION BARRIER OR OTHER EROSION PROTECTION SPECIFIED BY THE RESIDENT ENGINEER. THE COST SHALL BE INCLUDED IN THE UNIT PRICE FOR THE INDIVIDUAL SOIL MATERIALS.
 - WHEREVER CONSTRUCTION VEHICLE ACCESS ROUTES INTERSECT PAVED PUBLIC ROADS, PROVISIONS SHALL BE MADE TO MINIMIZE THE TRANSPORT OF SEDIMENT BY RUNOFF OR VEHICLE TRACKING ONTO THE PAVED SURFACE. THE PROVISIONS MAY INCLUDE SPRAYING VEHICLE WHEELS TO CLEAR SEDIMENT BEFORE EXITING THE CONSTRUCTION SITE OR OTHER MEASURES APPROVED BY THE ENGINEER.
 - AT THE END OF EACH WORK DAY THE SITE SHALL BE GRADED TO MAINTAIN THE DRAINAGE PATTERN ESTABLISHED IN THE EROSION CONTROL PLAN. THE COST OF MAINTAINING THE EROSION CONTROL PLAN IS INCLUDED IN THE PRICE FOR THE EROSION CONTROL ITEMS.
 - TOP SOIL 100 mm, SEEDING CLASS 2A, SEEDING CLASS 4A AND EROSION CONTROL BLANKET SHALL BE APPLIED TO DENOTED AREAS.
 - AREAS OF EXISTING VEGETATION (WETLAND, WOOD AND GRASSLANDS) OUTSIDE THE PROPOSED CONSTRUCTION LIMITS SHALL BE IDENTIFIED BY THE ENGINEER FOR PRESERVING AND SHALL BE PROTECTED FROM CONSTRUCTION ACTIVITIES.

LEGEND

- PERIMETER EROSION BARRIER
- [Hatched Box] FURNISHING & PLACING TOP SOIL 100 mm, EROSION CONTROL BLANKET AND SEEDING
- ◆ INLET PROTECTION
- ⊙ TREE TRUNK PROTECTION

REVISIONS	
NAME	DATE

ILLINOIS DEPARTMENT OF TRANSPORTATION
US 14 - MOKELER CREEK TO N. OF
IL. 173 AND AT UPRR
LANDSCAPING AND
EROSION CONTROL PLAN

SCALE: 1:500 DRAWN BY R.A.D.
DATE FEBRUARY, 2005 CHECKED BY DR. SSS

SOODAN & ASSOCIATES INC.
Architects, Engineers & Construction Consultants

Plotted by: jslng Date: 02/10/2005 02:36:58 PM