

| | | | | |
|---------------------|---------------------------|---------|--------------|-----------|
| F.A.P. RTE. | SECTION | COUNTY | TOTAL SHEETS | SHEET NO. |
| 303 | 29R-T | McHENRY | 86 | 30 |
| STA. | TO STA. | | | |
| FED. ROAD DIST. NO. | ILLINOIS FED. AID PROJECT | | | |

CONTRACT No. 62202

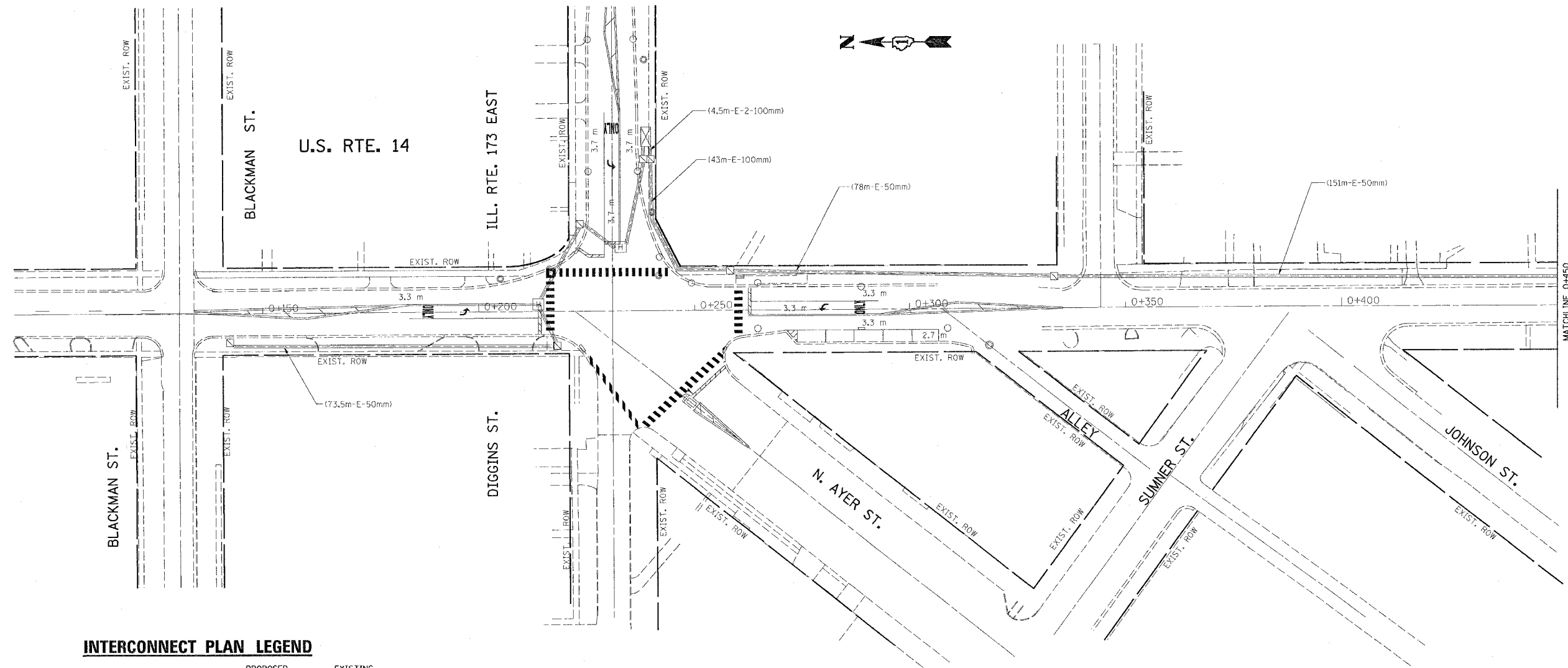

INTERCONNECT PLAN LEGEND

| | PROPOSED | EXISTING |
|--|----------|----------|
| CONTROLLER CABINET | | |
| SERVICE INSTALLATION, (P) POLE OR (G) GROUND MOUNT | | |
| TELEPHONE CONNECTION | | |
| HANDHOLE | | |
| HEAVY DUTY HANDHOLE | | |
| DOUBLE HANDHOLE | | |
| G.S. CONDUIT IN TRENCH OR PUSHED SYSTEM | | |
| INTERSECTION | IP | I |
| UNIT DUCT | UD | |
| COMMON TRENCH | CT | |
| DETECTOR LOOP, TYPE I | | |
| PREFORMED DETECTOR LOOP | | |

SCOPE OF WORK

USE EXISTING FIBER OPTIC CABLE TO MAINTAIN THE INTERCONNECT UNTIL THE WEST RETAINING WALL IS BUILT AND NEW CONDUIT ATTACHED. INTERCEPT EXISTING CONDUIT ON BRIDGE, INSTALL NEW JUNCTION BOX ATTACHED TO STRUCTURE, INSTALL NEW FIBER OPTIC AND TRACER CABLE.

| REVISIONS | | ILLINOIS DEPARTMENT OF TRANSPORTATION |
|-----------|------|--|
| NAME | DATE | |
| | | <p>INTERCONNECT PLAN U.S. RTE. 14 ILL. RTE. 173 (NORTH JUNCTION) TO ILL. RTE. 23</p> <p>1:500 DATE 10/30/03</p> <p>DRAWN BY BCK DESIGN BY SPB CHECKED BY DAD</p> |
| | | |
| | | |
| | | |
| | | |
| | | |