

F.A.I. RTE.	SECTION	COUNTY	TOTAL SHEETS	SHEET NO.
90/94	2003-0311	COOK	976	129
STA. 142+00		TO STA. 1204+00		
FED. ROAD DIST. NO.	ILLINOIS	FED. AID PROJECT	62583	

NOTES:

- SEE DRAWINGS ME-01 AND ME-02 FOR ELECTRICAL SYMBOLS AND ABBREVIATIONS.
- UNLESS NOTED OTHERWISE, ALL ITEMS AND WORK SHOWN IN HEAVY LINE WEIGHT ON THIS DRAWING ARE PROPOSED NEW ITEMS AND WORK.
- SEE DRAWING ES-01 FOR HIGH MAST LIGHT TOWER SCHEDULE.
- THE EXISTING ROADWAY LIGHTING SYSTEM SHALL REMAIN IN OPERATION UNTIL THE PROPOSED ROADWAY LIGHTING SYSTEM HAS BEEN INSTALLED, ENERGIZED, TESTED, AND ACCEPTED BY THE ENGINEER, UNLESS OTHERWISE DIRECTED BY THE ENGINEER.
- REFER SHEET ME-15 AND ME-15A FOR COMED SERVICE DETAILS.
- AERIAL CABLE AND TEMPORARY WOOD POLES SHALL BE REMOVED AFTER HIGH MAST LIGHT TOWERS ARE PERMANENTLY WIRED AND ACCEPTED BY THE ENGINEER.
- TEMPORARY WOOD POLES SHALL BE INSERTED IN GROUND TO ACCOMMODATE PROPOSED GRADING.
- REFER SHEET ME-25 FOR TEMPORARY WIRING TO TOWER DETAIL.
- UNIT DUCT TRENCH DEPTH SHALL BE ADJUSTED TO PERMIT FINAL GRADING WITHOUT DAMAGE TO UNIT DUCT.

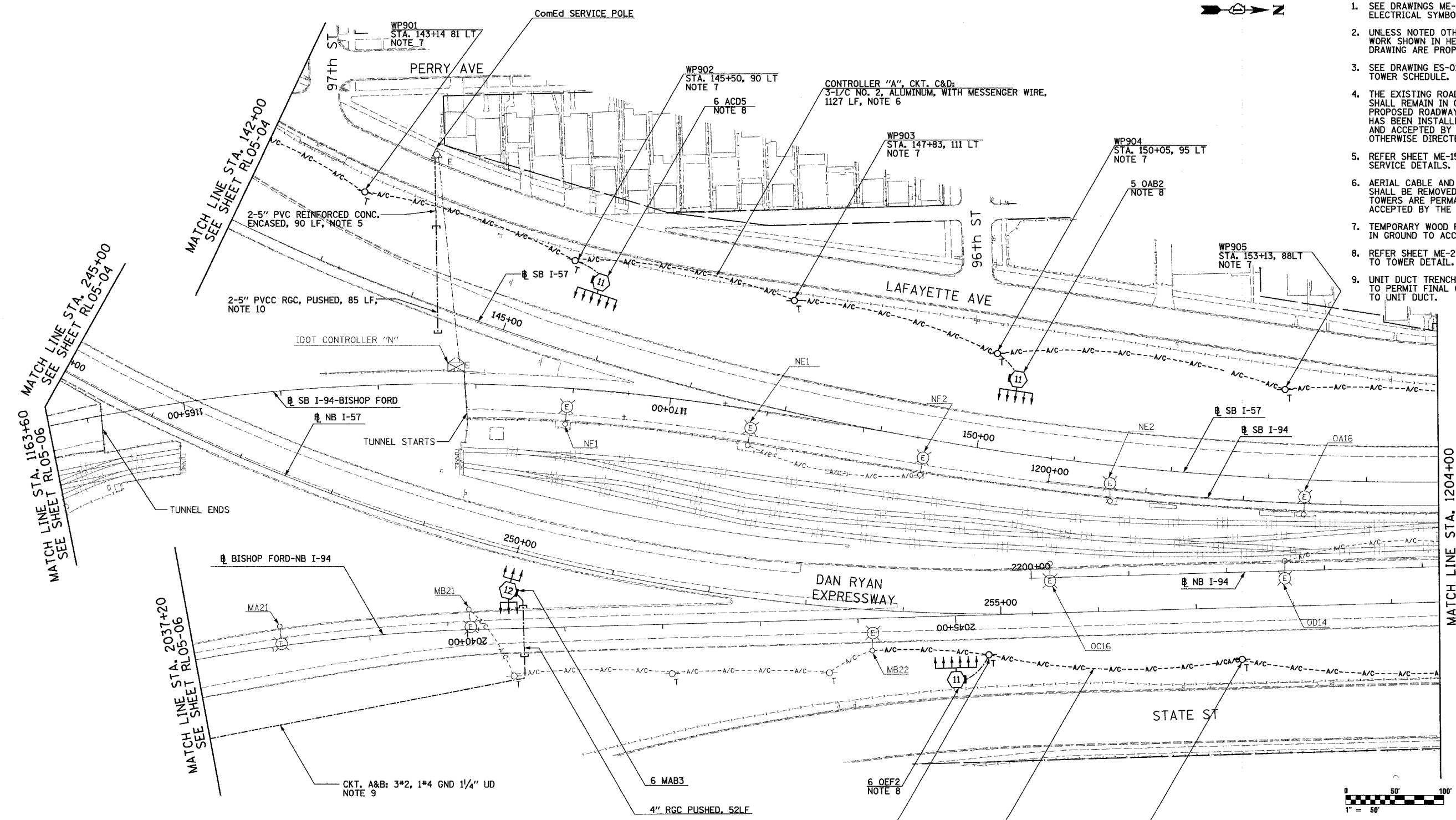
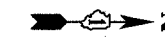

MATCH LINE STA. 1163+60
SEE SHEET RL05-06

MATCH LINE STA. 142+00
SEE SHEET RL05-04

MATCH LINE STA. 2037+20
SEE SHEET RL05-06

MATCH LINE STA. 1204+00
SEE SHEET RL05-10



RL05-09

SINGH
SINGH & ASSOCIATES, INC.
CONSULTING ENGINEERS

300 W. ADAMS ST.
CHICAGO, IL 60606
TEL: (312) 629-0240
FAX: (312) 629-8449

WP906
STA. 254+86, 41 RT
NOTE 7
CKT. A&B, FROM CONTROLLER "M":
3-1/2" NO. 2, ALUMINUM, WITH MESSENGER WIRE,
379 LF, NOTE 6

WP907
STA. 257+45, 53 RT
NOTE 7

NOTES CONTINUED:

- CAP CONDUITS FOR EXTENSION UNDER SEPARATE CONTRACT. CONDUIT TO BE MINIMUM 66" BELOW FINAL GRADE.

REVISIONS	
NAME	DATE

ILLINOIS DEPARTMENT OF TRANSPORTATION
F.A.I. 90/94 (DAN RYAN EXPRESSWAY)
31st STREET TO I-57
ROADWAY LIGHTING PLANS
PROPOSED IMPROVEMENTS 2005
SCALE: 1"=50'
DATE: OCTOBER 29, 2004
DRAWN BY: VRK
CHECKED BY: TM

11/22/2004 6:47:19 PM