

F.A.I. RTE.	SECTION	COUNTY	TOTAL SHEETS	SHEET NO.
94/90	2003-0311	COOK	976	159
STA. 1620+00		TO STA. 1632+00		
FED. ROAD DIST. NO.	ILLINOIS	FED. AID PROJECT		
62583				

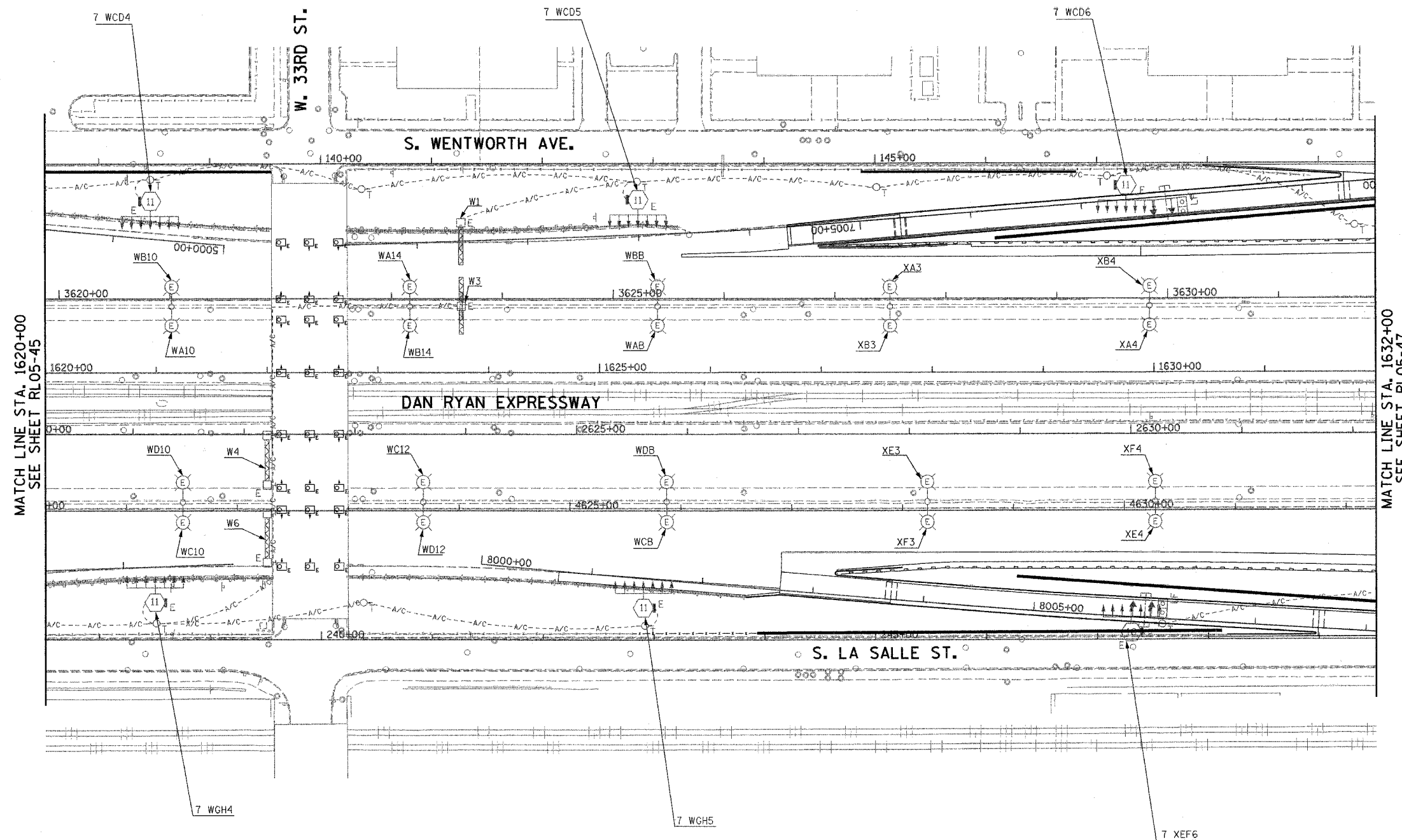

NOTE:

- SEE DRAWINGS ME-01 AND ME-02 FOR ELECTRICAL SYMBOLS AND ABBREVIATIONS.



MATCH LINE STA. 1620+00  
SEE SHEET RL05-45

MATCH LINE STA. 1632+00  
SEE SHEET RL05-47

RL05-46

**K&E** KAM ENGINEERING, INC.  
CONSULTING ENGINEERS  
707A Davis Road, Suite 205  
Elgin, Illinois 60123-1369

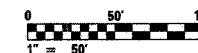

REVISIONS	
NAME	DATE

ILLINOIS DEPARTMENT OF TRANSPORTATION  
F.A.I. 94/90 (DAN RYAN EXPRESSWAY)  
31st STREET TO I-57

ROADWAY LIGHTING PLANS  
PROPOSED IMPROVEMENTS 2005

SCALE: 1"=50'

DATE: OCTOBER 29, 2004

DRAWN BY: BL

CHECKED BY: SM

11/9/09 AM 10/15/2004