

F.A.I. RTE.	SECTION	COUNTY	TOTAL SHEETS	SHEET NO.
94/90	2003-0311	COOK	976	254
STA. 1620+00		TO STA. 1632+00		
FED. ROAD DIST. NO.	ILLINOIS	FED. AID PROJECT		
62583				

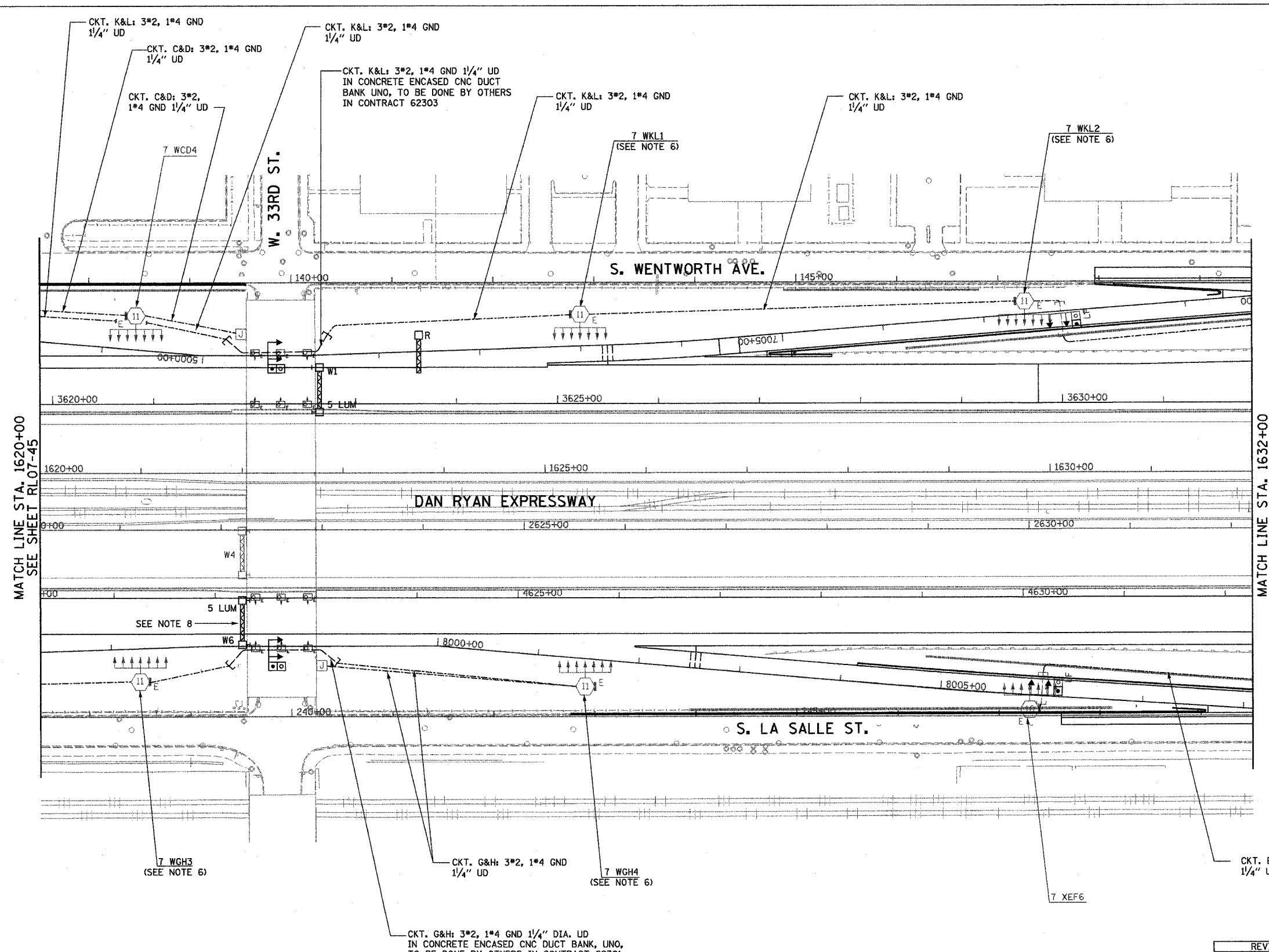

- NOTES:**
1. SEE DRAWINGS ME-01 AND ME-02 FOR ELECTRICAL SYMBOLS AND ABBREVIATIONS.
 2. UNLESS NOTED OTHERWISE, ALL ITEMS AND WORK SHOWN IN HEAVY LINE WEIGHT ON THIS DRAWING ARE PROPOSED NEW ITEMS AND WORK.
 3. THE TOWERS SHALL BE CONNECTED TO THE PROPOSED LIGHTING CONTROLLERS.
 4. REMOVE AERIAL CABLE AND WOOD POLES WHEN PERMANENT CABLE IS INSTALLED AND OPERATIONAL.
 5. RUN PARALLEL RACEWAYS IN COMMON TRENCH.
 6. THE TEMPORARY TOWER DESIGNATIONS SHALL BE REPLACED WITH THE PERMANENT DESIGNATIONS AS INDICATED ON THIS DRAWING.
 7. SEE SHEET UL-06 FOR UNDERPASS LIGHTING PLAN.
 8. EXISTING SIGN SHALL BE REMOVED PRIOR TO INSTALLATION OF PROPOSED SIGN.

MATCH LINE STA. 1620+00
SEE SHEET RL07-45

MATCH LINE STA. 1632+00
SEE SHEET RL07-47

RL07-46

K&E KAM ENGINEERING, INC.
CONSULTING ENGINEERS
707A Davis Road, Suite 205
Elgin, Illinois 60123-1363

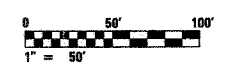

REVISIONS	
NAME	DATE

ILLINOIS DEPARTMENT OF TRANSPORTATION
F.A.I. 94/90 (DAN RYAN EXPRESSWAY)
31st STREET TO I-57

**ROADWAY LIGHTING PLANS
PROPOSED IMPROVEMENTS 2007**

SCALE: 1"=50'
DATE: OCTOBER 29, 2004

DRAWN BY: BL
CHECKED BY: SM

G:\projects\94-90\94-90-0311\Lighting\RL07-46.dwg 10/15/2004 02:56:51 PM