

F.A.I. RTE.	SECTION	COUNTY	TOTAL SHEETS	SHEET NO.
90/94	2003-0311	COOK	976	430
STA.		TO STA.		
FED. ROAD DIST. NO.		ILLINOIS FED. AID PROJECT		

62583

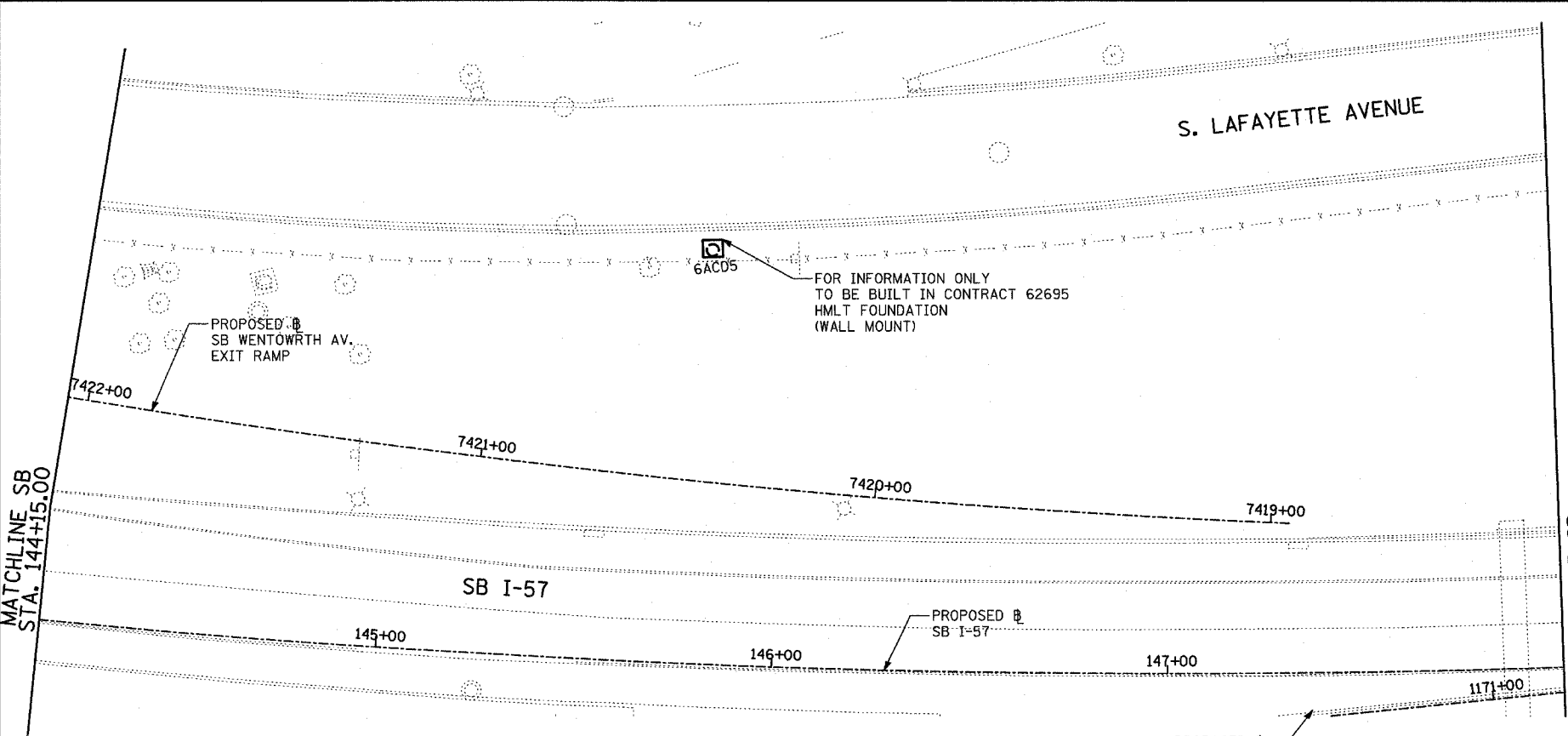

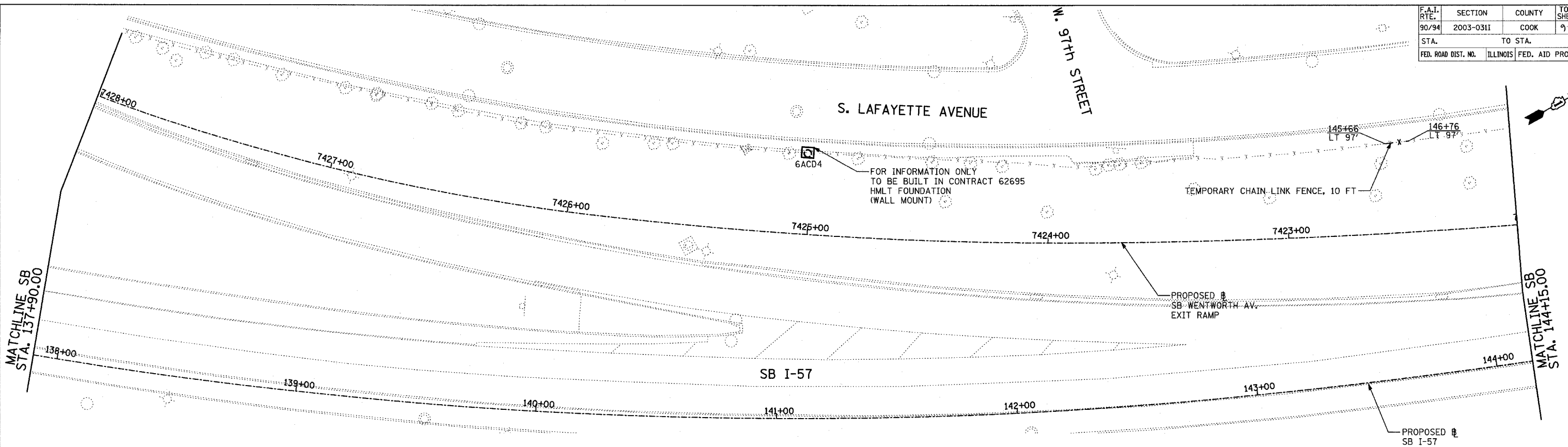



LOCATION MAP



SCALE: 1" = 20'-0"

LEGEND:

-  TEMPORARY EROSION CONTROL SEEDING
-  PERIMETER EROSION BARRIER
-  INLET FILTER, TO BE INSTALLED IN OFF PROJECT DRAINAGE STRUCTURES ACCEPTING STORMWATER RUNOFF
-  TEMPORARY FENCE (60' PER TREE)
-  LIMITS OF GRADING
-  TREE REMOVAL (UNIT) (NO UNIT SHOWN = <6)

REVISIONS	
NAME	DATE

ILLINOIS DEPARTMENT OF TRANSPORTATION
 F.A.I. 90/94 (DAN RYAN EXPRESSWAY)
 31st STREET TO I-57
 EROSION CONTROL PLAN
 SB WENTWORTH AVENUE EXIT RAMP
 SB I-57 STA. 137+90.00 TO 148+00.00

SCALE: 1"=20' DRAWN BY: RTM, JPA
 DATE: OCTOBER 29, 2004 CHECKED BY: JPM, MAG

TYLIN INTERNATIONAL

11/23/2004 02:35:43 PM