

PROFILE SURVEYED
 GRADES CHECKED
 NOTE BOOK
 NO.

F.A.I. RTE.	SECTION	COUNTY	TOTAL SHEETS	SHEET NO.
90/94	2003-0311	COOK	976	510
STA. 2200+00.00 TO STA. 2362+00.00		ILLINOIS FED. AID PROJECT		
FED. ROAD DIST. NO.				62583

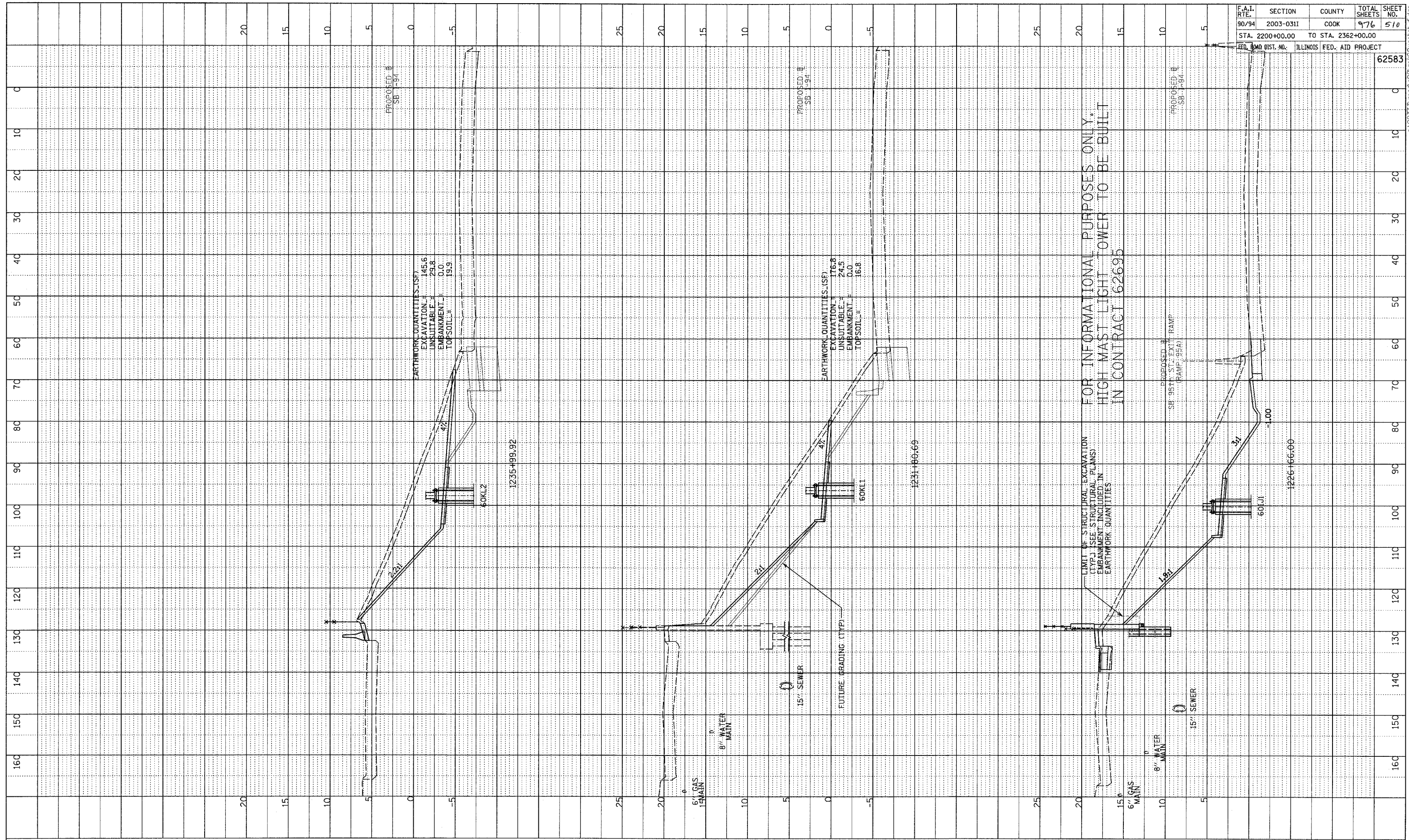

FOR INFORMATIONAL PURPOSES ONLY.
 HIGH MAST LIGHT TOWER TO BE BUILT
 IN CONTRACT 62695

TYLIN INTERNATIONAL

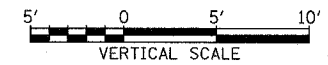
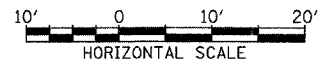

SB I-94 (DAN RYAN EXPRESSWAY)
 STA. 1226+66 TO STA. 1235+99.92

p:\0231\3\road\02\gpk02\ss\sb-1.dgn