

SECTION	COUNTY	TOTAL SHEETS	SHEET NO.
2003-0311	COOK	976	673
STA. 116+00.00 TO STA. 129+00/231+50			
FED. ROAD DIST. NO.	ILLINOIS FED. AID PROJECT		
62583			

**NOTES:**

1. SEE DRAWING ME-01 AND ME-02 FOR ELECTRICAL SYSTEMS AND ABBREVIATIONS.
2. UNLESS OTHERWISE STATED, ALL NOTED CABLE AND CONDUIT TO BE FURNISHED AND INSTALLED UNDER THIS CONTRACT.
3. THIS SHEET ONLY DEPICTS INSTALLATION OF CLOSED CIRCUIT TELEVISION ELEMENTS. SEE LIGHTING PLANS FOR LIGHTING ELEMENT INSTALLATION.
4. CONTRACTOR SHALL CONNECT CAMERA POWER FEED TO THE AUXILIARY BREAKER IN THE LIGHTING CONTROLLER CABINET AS SHOWN ON DRAWING ME-19.
5. SEE DRAWING COMM-03 FOR CCTV COMMUNICATIONS SYSTEM CONDUIT AND CABLE LAYOUT.
6. SEE DRAWING DT-17 FOR CCTV CABINET MOUNTING DETAILS ON A HIGH-MAST LIGHT TOWER.
7. CONTRACTOR SHALL COIL A MINIMUM OF 20 FEET OF 120-VOLT POWER CABLE AT THE BASE OF THE LIGHT TOWER FOR FUTURE CCTV CAMERA.

C. & W.I. R.R.

HARVARD ST.

PRINCETON ST.

YALE ST.

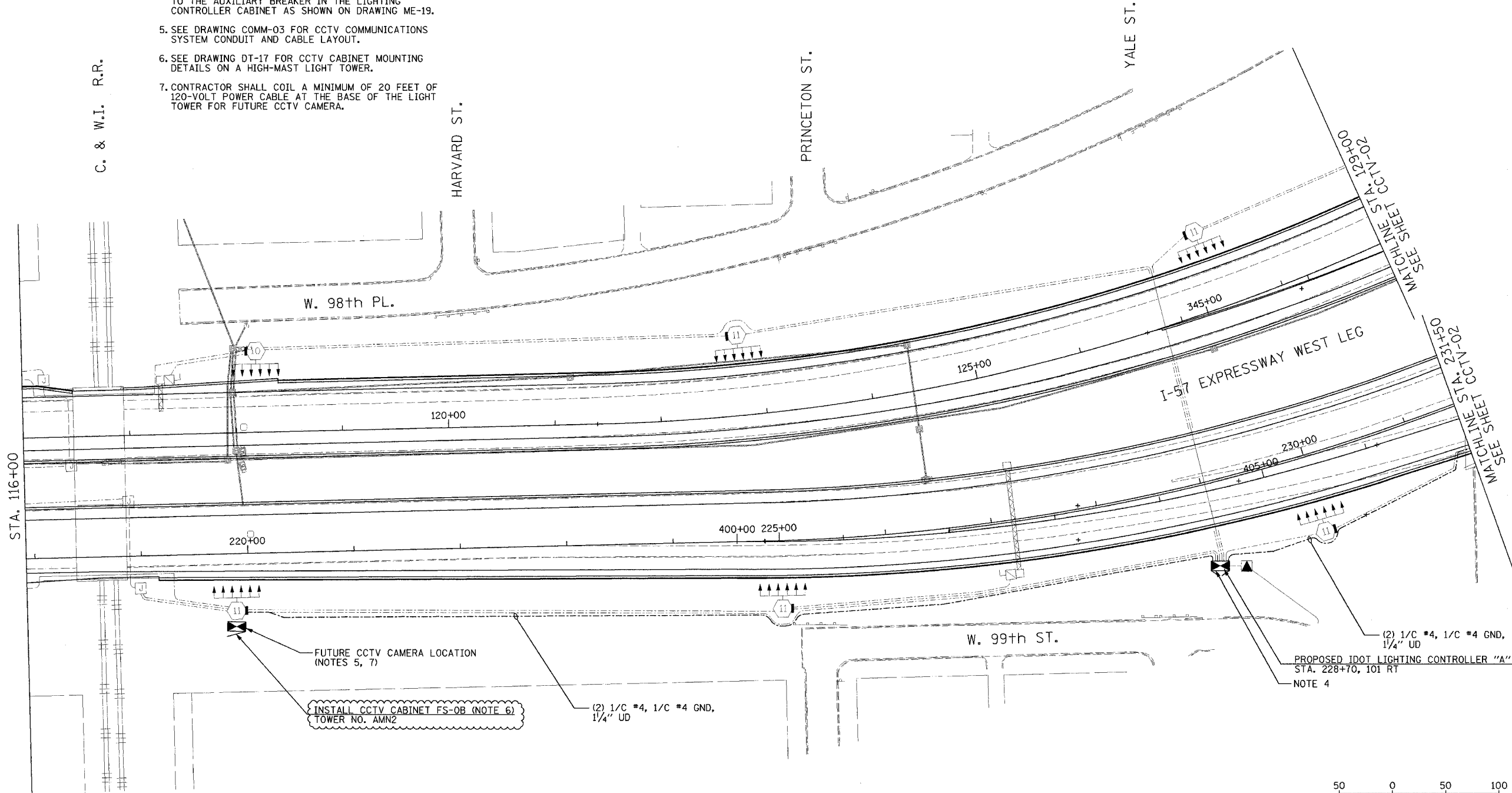

I-57 EXPRESSWAY WEST LEG

INSTALL CCTV CABINET FS-0B (NOTE 6)  
TOWER NO. AMN2

(2) 1/C #4, 1/C #4 GND,  
1/4" UD

(2) 1/C #4, 1/C #4 GND,  
1/4" UD  
PROPOSED IDOT LIGHTING CONTROLLER "A"  
STA. 228+70, 101 RT  
NOTE 4

50 0 50 100  
SCALE IN FEET

CCTV-01

**Edwards AND Kelcey**  
ONE NORTH FRANKLIN  
CHICAGO, IL 60606  
PHONE: (312) 251-3000  
FAX: (312) 251-3015  
WEB: WWW.EKCORP.COM

REVISIONS	
NAME	DATE
REVISION 1	12/17/04

ILLINOIS DEPARTMENT OF TRANSPORTATION  
F.A.I. 94/90 (DAN RYAN EXPRESSWAY)  
31st STREET TO I-57  
CLOSED CIRCUIT TELEVISION  
SITE LAYOUT  
CAMERA CH-0A (SHEET 1 OF 2)  
CAMERA CH-0B  
SCALE: 1"=50'  
DATE: October 29, 2004  
DRAWN BY: DHI  
CHECKED BY: MJL

12/15/2004 04:21:38 PM