

SECTION	COUNTY	TOTAL SHEETS	SHEET NO.
2003-0311	COOK	976	737
STA. 1376+00 TO STA. 1388+00			
FED. ROAD DIST. NO.	ILLINOIS FED. AID PROJECT		
62583			

ELECTRIC UTILITY SERVICE CONNECTION, BY OTHERS
ELECTRIC SERVICE INSTALLATION, 30A, 120V, BY OTHERS
APPROXIMATELY 210' WEST OF LAFAYETTE AVE.

MODIFY EXISTING SURVEILLANCE CABINET
CONCRETE FOUNDATION, TYPE 1, BY OTHERS
PROPOSED SURVEILLANCE CABINET 49, BY OTHERS

CABINET, MODEL 334 EQUIPMENT,
SYSTEM DETECTOR
CONCRETE FOUNDATION, TYPE 1
PROPOSED SURVEILLANCE CABINET 51
STA. 7112+50, 26RT

(5) 4/C #18
3" GSC IN TRENCH
IN TRENCH (SPARE)
HH 2409, TYPE C1
STA 7112+48
(5) 4/C #18
2" GSC IN TRENCH

2/C #2, 1/C #6 GND
2" GSC IN TRENCH
2" GSC IN TRENCH (SPARE)
2" GSC IN TRENCH (SPARE)

2" GSC IN TRENCH, BY OTHERS (SPARE)
2/C #2, 1/C #6 GND
2" GSC IN TRENCH, BY OTHERS (SPARE)
2" GSC IN TRENCH, BY OTHERS (SPARE)
HH 2410, TYPE S1
STA 7107+95, BY OTHERS

(6) 4/C #18
2" GSC IN TRENCH
2" GSC IN TRENCH (SPARE)
HH 2401, TYPE C1
STA 7104+80, BY OTHERS
(6) 4/C #18
4/C #18, BY OTHERS
2" GSC IN TRENCH, BY OTHERS
HH 2402, TYPE S1
STA 7104+65, BY OTHERS
2/C #2, 1/C #6 GND
2" GSC IN TRENCH
2" GSC IN TRENCH (SPARE)
2" GSC IN TRENCH (SPARE)

2/C #2, 1/C #6 GND, BY OTHERS
2" GSC IN TRENCH, BY OTHERS
2/C #4, 1/C #6 GND
2" GSC IN TRENCH, BY OTHERS
2" GSC IN TRENCH (SPARE), BY OTHERS
2/C #4, 1/C #6 GND, BY OTHERS
2" GSC IN TRENCH (SPARE), BY OTHERS

HH 2403 TYPE S1
STA 7103+19, BY OTHERS

RAMP METER SIGNAL, BY OTHERS
ON WALL FOUNDATION, BY OTHERS
(STA. 7102+75)

HH 2404 TYPE S1
STA 7102+83, BY OTHERS
RAMP METER FLASHER, BY OTHERS
ON WOOD POST, BY OTHERS

3/C #12, BY OTHERS
2" GSC IN TRENCH, BY OTHERS
HH 2406, TYPE S1
STA 7101+95, BY OTHERS
3" PEC IN TRENCH, BY OTHERS

LOOP DETECTOR, BY OTHERS
18'x15'
(4) 4/C #18
4/C #18, BY OTHERS
2" GSC IN TRENCH, BY OTHERS
3/C #12, BY OTHERS
2" GSC IN TRENCH, BY OTHERS
4/C #18, BY OTHERS
2" GSC IN TRENCH, BY OTHERS

(2) 3/C #12
BY OTHERS
3" GSC IN TRENCH
BY OTHERS
(3) 4/C #18
BY OTHERS
3" GSC IN TRENCH
BY OTHERS
(6) 4/C #18
4/C #18, BY OTHERS
3" GSC IN TRENCH
BY OTHERS
3" GSC IN TRENCH
(SPARE) BY OTHERS

4/C #18, 3/C #12
BY OTHERS
2" GSC IN TRENCH
BY OTHERS
2" GSC IN TRENCH
(SPARE) BY OTHERS

(2) 3/C #12, BY OTHERS
2" GSC IN TRENCH, BY OTHERS

3/C #12, BY OTHERS
2" GSC EMBEDDED IN WALL
BY OTHERS
RAMP METER SIGNAL, BY OTHERS
ON TYPE A FOUNDATION,
BY OTHERS (STA. 7102+75)
3" PEC IN TRENCH, BY OTHERS

(6) 4/C #18
4/C #18, BY OTHERS
2" GSC IN TRENCH

MATCH LINE STA. 1376+00
SEE SHEET DET-23

MATCH LINE STA. 1387+80
SEE SHEET DET-25

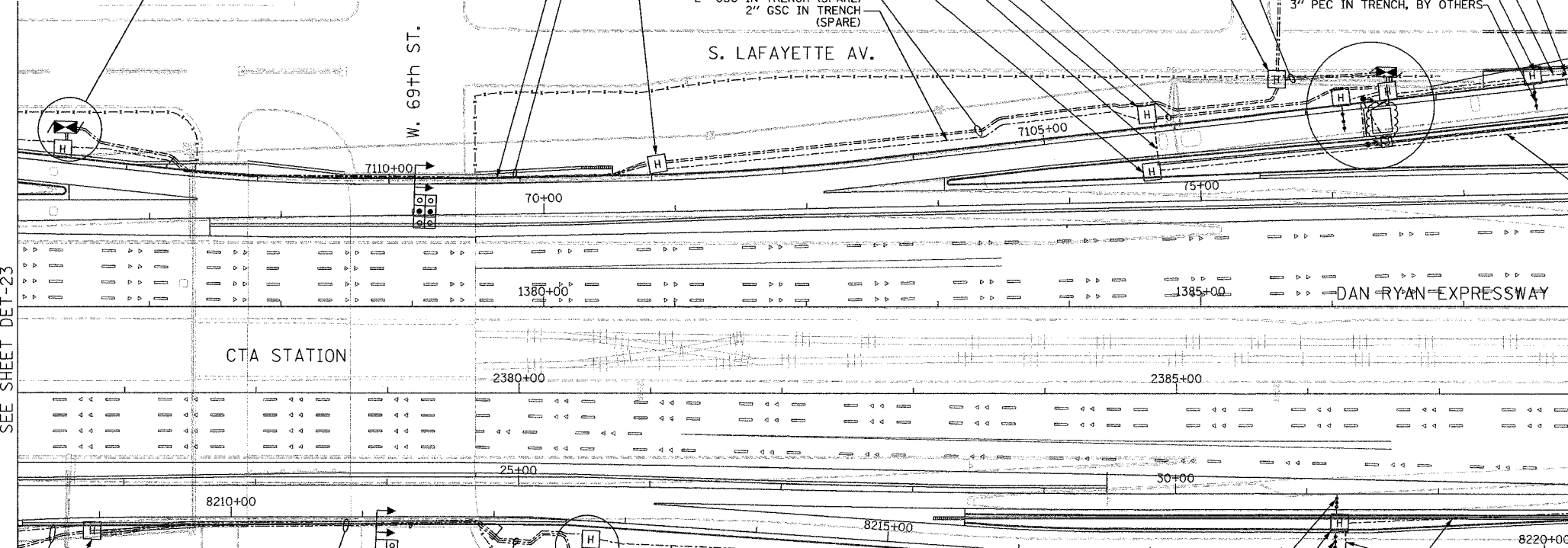

2" GSC IN TRENCH (SPARE)
2/C #2, 1/C #6 GND
2" IN TRENCH, BY OTHERS
2" IN TRENCH, BY OTHERS (SPARE)
HH 2411, TYPE S1
STA 8208+95, BY OTHERS

2" GSC CONCRETE ENCASED, BY OTHERS (SPARE)
2/C #2, 1/C #6 GND
2" GSC CONCRETE ENCASED, BY OTHERS
2" GSC CONCRETE ENCASED, BY OTHERS (SPARE)
2" GSC IN TRENCH (SPARE)
2/C #2, 1/C #6 GND
2" GSC IN TRENCH (SPARE)

- NOTES:
- SEE DRAWING ME-01 AND ME-02 FOR ELECTRICAL SYSTEMS AND ABBREVIATIONS.
 - UNLESS OTHERWISE STATED, ALL NOTED CABLE AND CONDUIT TO BE FURNISHED AND INSTALLED UNDER THIS CONTRACT.
 - TRENCHED CONDUITS INSTALLED IN PARALLEL ARE TO BE INSTALLED IN COMMON TRENCH.
 - THIS SHEET ONLY DEPICTS INSTALLATION OF DETECTION/RAMP METER ELEMENTS. REFER TO SHEETS FOR OTHER SUBSYSTEMS FOR ADDITIONAL ELEMENTS IN THE AREA SHOWN.
 - CONTRACTOR TO ROD AND CLEAN EXISTING CONDUITS PRIOR TO INSTALLING AND PULLING INNERDUCTS AND CABLES IN CONDUITS.
 - DETECTION/RAMP METER CONDUIT SHALL NOT BE INSTALLED IN ELECTRIC HANDHOLES (SEE DETAIL SHEET DT-45).
 - FOR DETECTOR PROBE INSTALLATION DETAILS, SEE SHEETS DT-23 AND DT-28.
 - FOR HANDHOLE DETAILS, SEE SHEET DT-44 AND DT-46.
 - FOR WIRING DETAILS, SEE SHEETS DET-48 THROUGH DET-53

(7) 4/C #18
2" GSC IN TRENCH
HH 2412, TYPE C1
STA 8212+76
(2) 4/C #18
3" GSC IN TRENCH, BY OTHERS
3" GSC IN TRENCH, BY OTHERS

PROPOSED SURVEILLANCE CABINET 50
STA. 8212+75, 28RT
CONCRETE FOUNDATION, TYPE 1
CABINET, MODEL 334 EQUIPMENT,
SYSTEM DETECTOR

3" PEC IN TRENCH, BY OTHERS
SEE NOTE 7 FOR DETECTOR
INSTALLATION DETAIL
HH 2407, TYPE S1
STA 31+20, BY OTHERS

3" PEC IN TRENCH, BY OTHERS
SEE NOTE 7 FOR DETECTOR
INSTALLATION DETAIL
HH 2408, TYPE S1
STA 8218+40, BY OTHERS

(6) 4/C #18
2" GSC IN TRENCH, BY OTHERS
2" GSC IN TRENCH (TO CDOT
TRAFFIC SIGNAL CONTROLLER)

(5) 4/C #18
2" GSC IN TRENCH, BY OTHERS

**Edwards
AND
Kelcey**
ONE NORTH FRANKLIN
CHICAGO, IL 60606
PHONE: (312) 251-3000
FAX: (312) 251-3015
WEB: WWW.EKCORP.COM

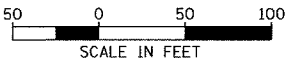

REVISIONS		DATE
NAME	REVISION	DATE
		2/11/05

ILLINOIS DEPARTMENT OF TRANSPORTATION
F.A.I. 94/90 (DAN RYAN EXPRESSWAY)
31st STREET TO I-57
SURVEILLANCE SYSTEM STATION
RAMP METERING AND DETECTOR SYSTEM
69TH ST. SITE LAYOUT
DET-25, DET-26, DET-27, DET-28, RM-11, RM-12
SCALE: 1"=50'
DATE: October 29, 2004
DRAWN BY: CJH
CHECKED BY: MJL

DET-24

02/09/2005 10:50:48 AM