

62806

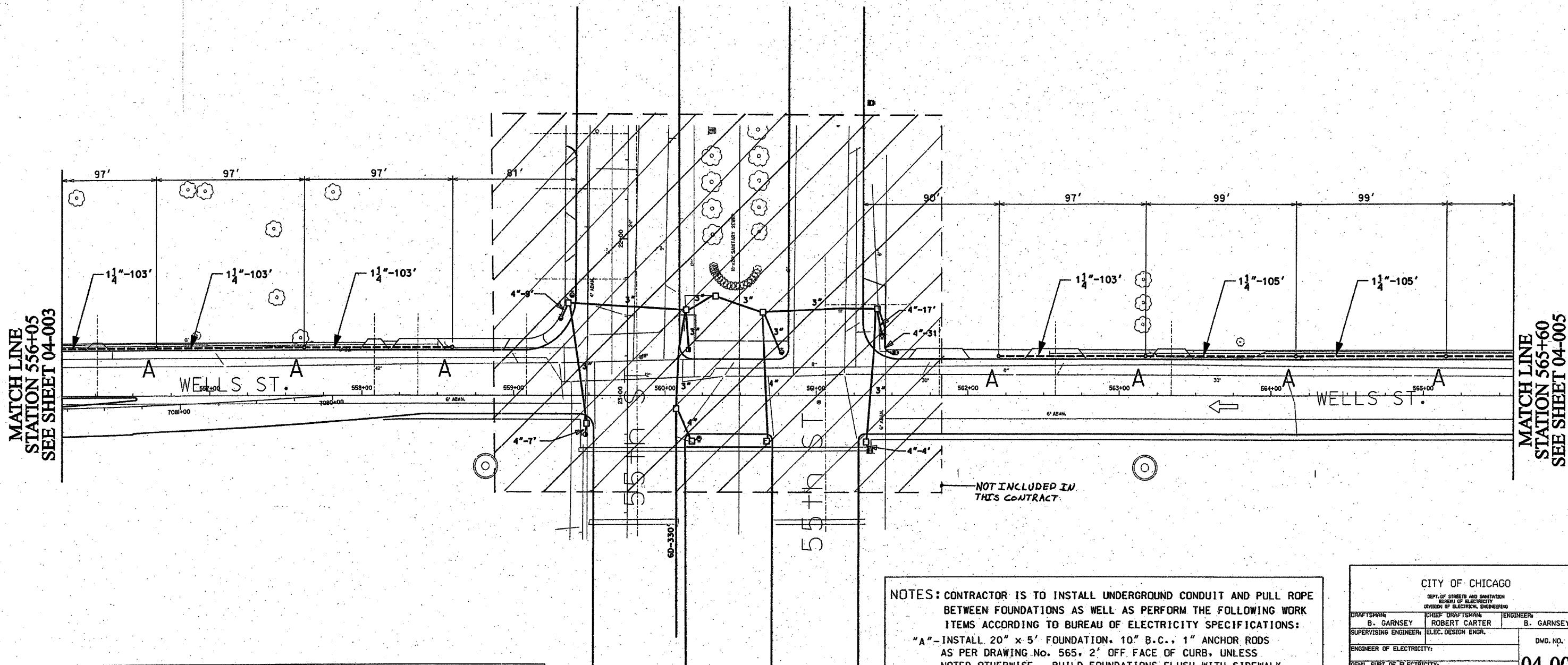

F. A. RTE	SECTION	COUNTY	TOTAL SHEETS	SHEET NO.
90/94	#	COOK	35	22
STA. 556+00		TO STA. 565+60		
FED. ROAD DIST. NO. 1		ILLINOIS		FED AID PROJECTS
* 2004-067L				



MATCH LINE
STATION 556+05
SEE SHEET 04-003

MATCH LINE
STATION 565+60
SEE SHEET 04-005

- 1 1/4" DIRECT BORED CONDUIT SCHEDULE #80 AS PER IDOT ARTICLE 810.03
- 2" DIRECT BORED CONDUIT SCHEDULE #80 AS PER IDOT ARTICLE 810.03
- 2" CONDUIT SCHEDULE #40 INSTALLED IN TRENCH AS PER IDOT ARTICLE 810.03
- 2" GALVANIZED RIGID STEEL ELBOW ON STRUCTURE
- 2" GALVANIZED RIGID STEEL CONDUIT INSTALLED IN TRENCH AS PER IDOT ARTICLE 810.03
- HAND HOLE 30" x 36" WITH 24" FRAME AND COVER
- CONCRETE FOUNDATION - 5' x 20", 10" B.C., 1" ANCHOR RODS

NOTES: CONTRACTOR IS TO INSTALL UNDERGROUND CONDUIT AND PULL ROPE BETWEEN FOUNDATIONS AS WELL AS PERFORM THE FOLLOWING WORK ITEMS ACCORDING TO BUREAU OF ELECTRICITY SPECIFICATIONS:

"A" - INSTALL 20" x 5' FOUNDATION, 10" B.C., 1" ANCHOR RODS AS PER DRAWING NO. 565, 2' OFF FACE OF CURB, UNLESS NOTED OTHERWISE. BUILD FOUNDATIONS FLUSH WITH SIDEWALK SURFACE.

"B" - INSTALL 30" HANDHOLE AS PER DRAWING NO. 867 WITH 24" FRAME AND COVER

FOR INSTALLATION PLAN SEE SHEETS 04-017, 04-018
FOR REMOVAL PLAN SEE SHEET 04-025

CITY OF CHICAGO		
<small>DEPT. OF STREETS AND SANITATION BUREAU OF ELECTRICITY DIVISION OF ELECTRICAL ENGINEERING</small>		
DRAFTSMAN B. GARNSEY	CHIEF DRAFTSMAN ROBERT CARTER	ENGINEER B. GARNSEY
SUPERVISING ENGINEER	ELEC. DESIGN ENGR.	DWG. NO.
ENGINEER OF ELECTRICITY:		04-004
GEN'L SUPT. OF ELECTRICITY:		
DEPUTY COMMISSIONER:		DATE: 1/20/04
SIZE: 22" 36"	SCALE: 1"=30'	

ILLINOIS DEPARTMENT OF TRANSPORTATION
F.A.I. 90/94 (DAN RYAN EXPRESSWAY)
57th St. TO 47th St. (FRONTAGE ROADS)

**STREET LIGHTING
UNDERGROUND CONDUIT FACILITIES**

SCALE: 1" = 30'
DATE: February 11, 2005
DRAWN BY: B.T.G.
CHECKED BY: O.L.

REVISIONS	
NAME	DATE