

F.A.P. RTE.	SECTION	COUNTY	TOTAL SHEETS	SHEET NO.
305	2004-108 BR	COOK	72	21

CONTRACT NO. 62853

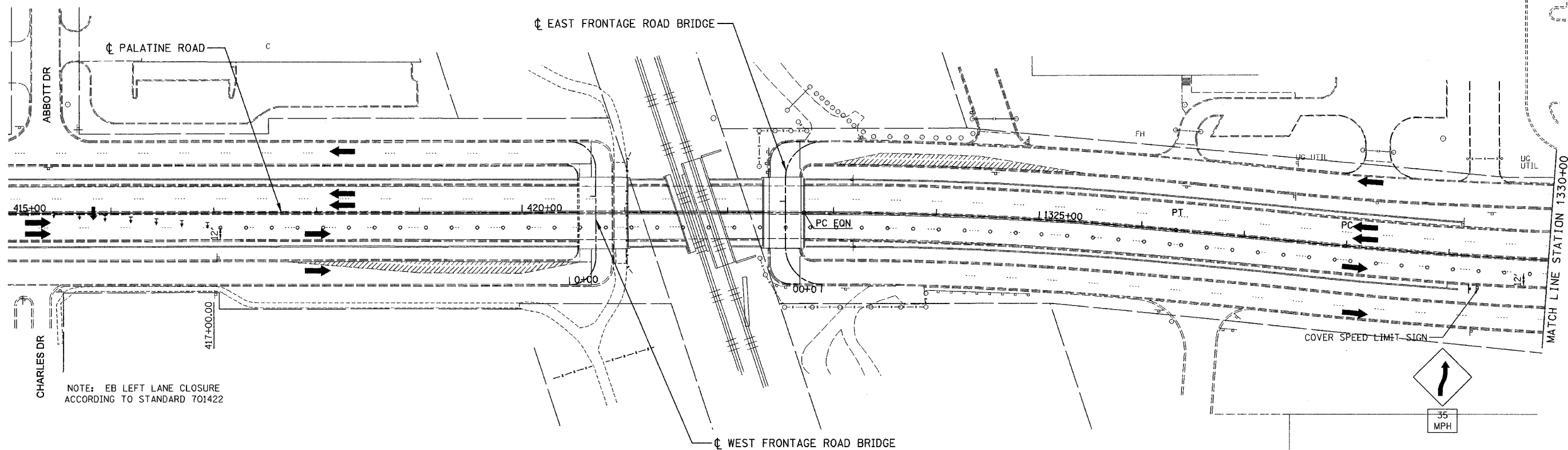

NOTE: EB LEFT LANE CLOSURE ACCORDING TO STANDARD 701422

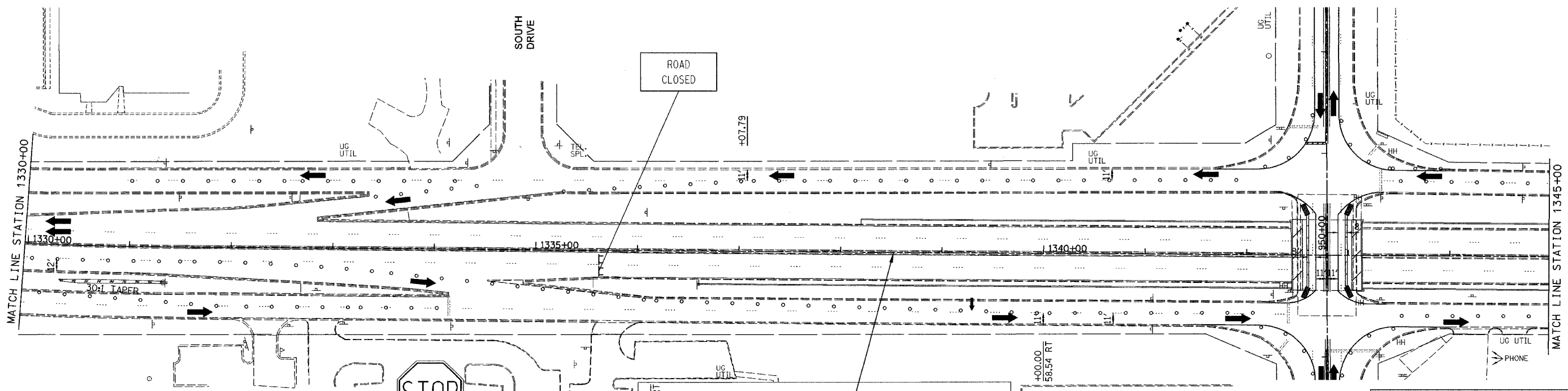

NOTE: LANE DROP ACCORDING TO HIGHWAY STANDARD 701601.

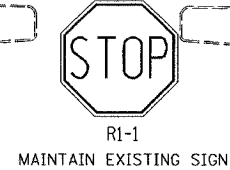

- NOTES:
1. DETOUR PALATINE ROAD FOR NIGHT TIME CLOSURES ONLY.
 2. WOLF ROAD TEMPORARY CONCRETE BARRIER IS TO REMAIN UNTIL NEW PARAPETS ARE COMPLETED.
 3. LANE CLOSURES FOR FRONTAGE ROAD MAY REMAIN IN PLACE OR BE REMOVED DAILY AT CONTRACTORS OPTION.
 4. ALL WORK INCLUDED IN PAYMENT FOR TRAFFIC CONTROL AND PROTECTION, SPECIAL.

REVISIONS	
NAME	DATE

ILLINOIS DEPARTMENT OF TRANSPORTATION
 PALATINE ROAD UNDER WCRR, UNDER W. FRONTAGE RD.,
 UNDER E. FRONTAGE RD. & UNDER WOLF RD.

**PALATINE ROAD
 MAINTENANCE OF TRAFFIC
 STAGE 2A**

SCALE: 1"=50'
 DATE 02/05

DRAWN BY ACE/CAD
 CHECKED BY TAE



11/2003 PALATINE ROAD UNDER WCRR, UNDER W. FRONTAGE RD., UNDER E. FRONTAGE RD. & UNDER WOLF RD. 02/05 06 PM