

F.A.P. RTE.	SECTION	COUNTY	TOTAL SHEETS	SHEET NO.
305	2004-108 BR	COOK	72	22

CONTRACT NO. 62853

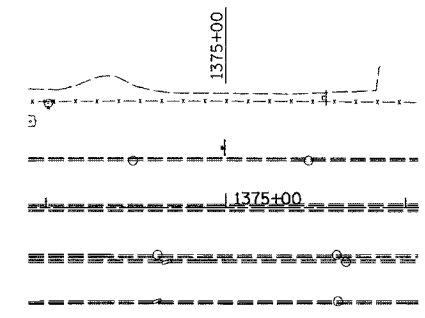
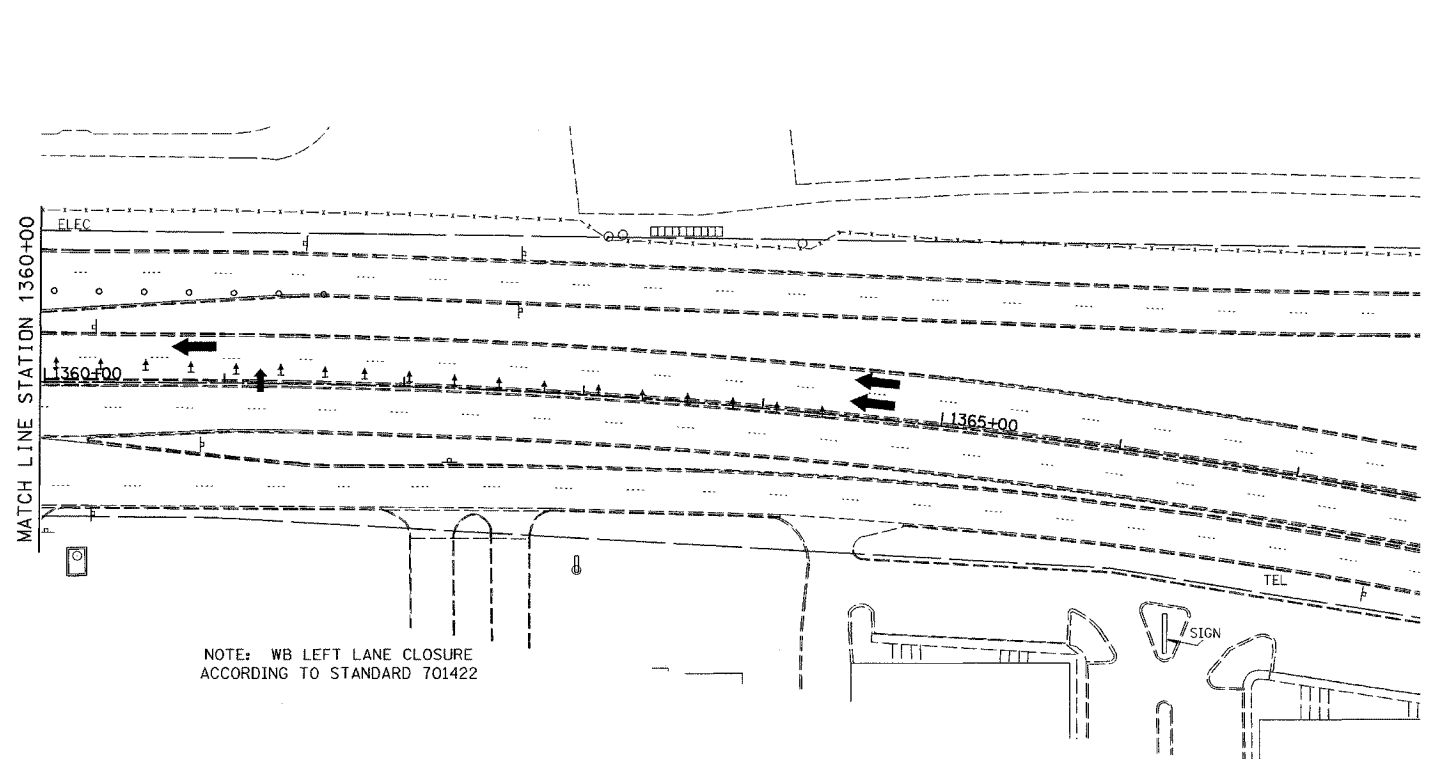
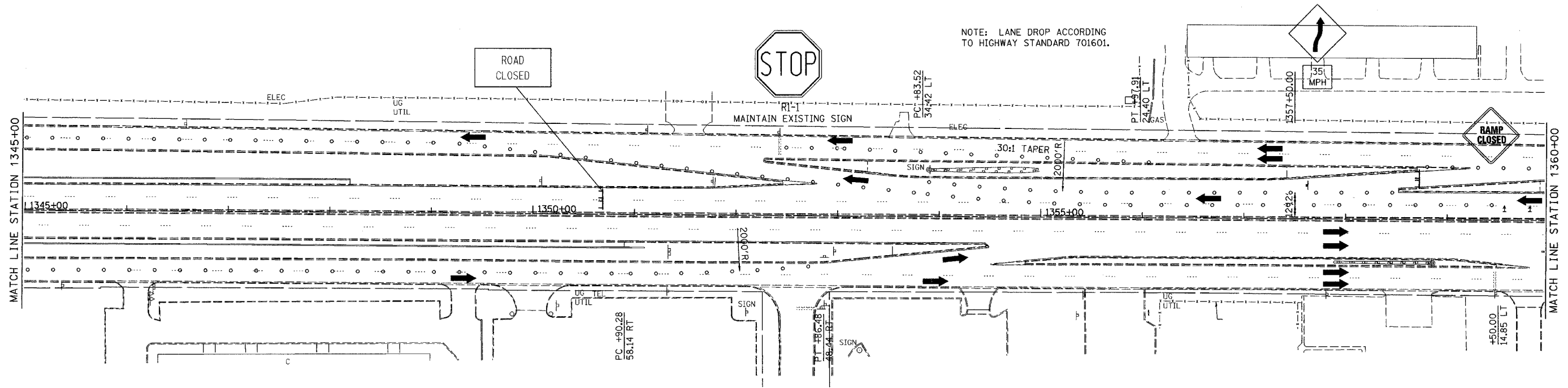

WESTBOUND

WORK ZONE PUBLIC INFORMATION SIGN

NOTE: FURNISH, ERECT, MAINTAIN AND REMOVE SIGNS IN LOCATIONS AND AT TIMES AS DIRECTED BY THE ENGINEER.

CAMERA-READY ARTWORK FOR THE SIGNS WILL BE PROVIDED TO SIGN MANUFACTURING COMPANIES UPON REQUEST BY CONTACTING THE CENTRAL BUREAU OF OPERATIONS AT 217-782-2076. THE SIGN NUMBER IS W21-I116-6048.

PAYMENT FOR WORK ZONE PUBLIC INFORMATION SIGNS SHALL BE INCLUDED IN THE COST OF TRAFFIC CONTROL AND PROTECTION, SPECIAL.

- NOTES:
1. DETOUR PALATINE ROAD FOR NIGHT TIME CLOSURES ONLY.
 2. WOLF ROAD TEMPORARY CONCRETE BARRIER IS TO REMAIN UNTIL NEW PARAPETS ARE COMPLETED.
 3. LANE CLOSURES FOR FRONTAGE ROAD MAY REMAIN IN PLACE OR BE REMOVED DAILY AT CONTRACTORS OPTION.
 4. ALL WORK INCLUDED IN PAYMENT FOR TRAFFIC CONTROL AND PROTECTION, SPECIAL.

REVISIONS	
NAME	DATE

ILLINOIS DEPARTMENT OF TRANSPORTATION
 PALATINE ROAD UNDER WCRR, UNDER W. FRONTAGE RD.,
 UNDER E. FRONTAGE RD. & UNDER WOLF RD.

**PALATINE ROAD
 MAINTENANCE OF TRAFFIC
 STAGE 2A**

SCALE: 1"=50'
 DATE 02/05

DRAWN BY ACE/CAD
 CHECKED BY TAE

AMERICAN
 CONSULTING ENGINEERS

NEW PALATINE RD. 2/13/05 11:13 AM