

STATE OF ILLINOIS
DEPARTMENT OF TRANSPORTATION
DIVISION OF HIGHWAYS

PLANS FOR PROPOSED HIGHWAY IMPROVEMENT

FAP 317 (US ROUTE 24)
SECTION 25 RS-2 & 26 RS-4
PROJECT NO. F-0317(067)
LIVINGSTON COUNTY

RESURFACING, CULVERT REHABILITATION
AND SHOULDER RECONSTRUCTION
C-93-072-02

FOR INDEX OF SHEETS, SEE SHEET NO. 2

F.A.P. RTE.	SECTION	COUNTY	TOTAL SHEETS	SHEET NO.
317	*	LIVINGSTON	205	1
CONTRACT NO. 66261				
* 25 RS-2 & 26 RS-4				
D-93-046-02				
P-93-068-98				

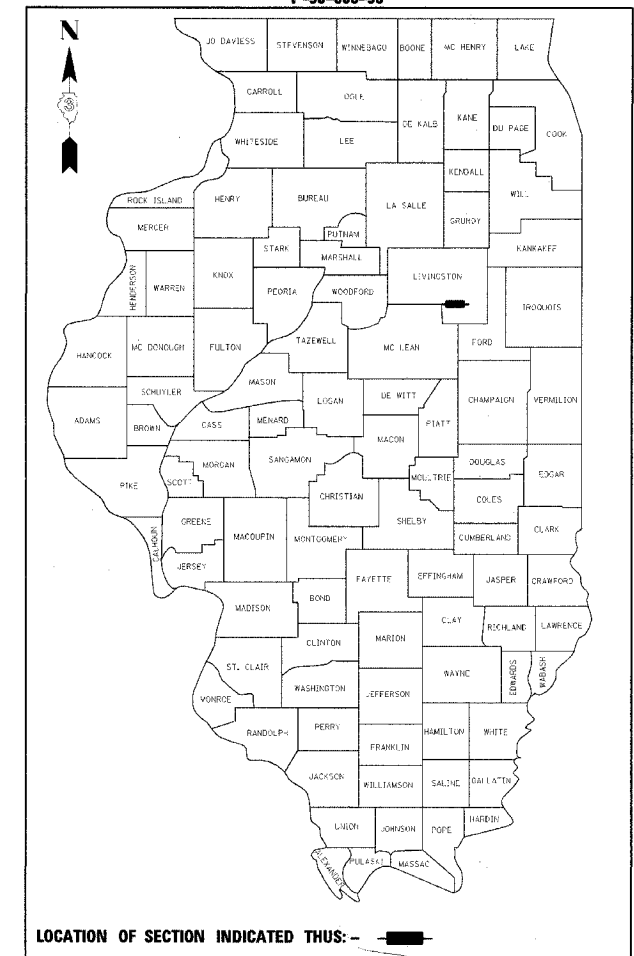

HIGHWAY CLASSIFICATION	MINOR ARTERIAL
2002 ADT US 24	5400 14.6% TRUCKS
2024 ADT US 24	7900 14.6% TRUCKS

STATE OF ILLINOIS
DEPARTMENT OF TRANSPORTATION
DIVISION OF HIGHWAYS

SUBMITTED FEB 10 20 05

Gregory L. Hunt
DEPUTY DIRECTOR OF HIGHWAYS, REGION ENGINEER

March 25, 20 05
Mike Hine
ENGINEER OF DESIGN AND ENVIRONMENT

March 25, 20 05
Victor Mader
DIRECTOR OF HIGHWAYS, CHIEF ENGINEER

ENGLISH RATIOS

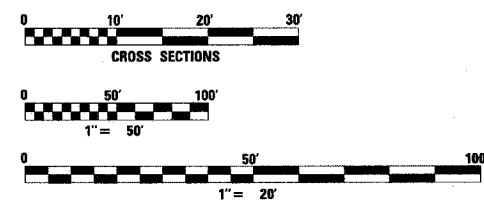

FULL SIZE PLANS HAVE BEEN PREPARED USING STANDARD ENGINEERING SCALES. REDUCED SIZED PLANS WILL NOT CONFORM TO STANDARD SCALES. IN MAKING MEASUREMENTS ON REDUCED PLANS, THE ABOVE SCALES MAY BE USED.

DISTRICT 3 NO (815) 434-6131
PROJECT ENGINEER: DAVE BROVIAK
UNIT CHIEF: MARK JONES

J.U.L.I.E.
JOINT UTILITY LOCATION INFORMATION FOR EXCAVATION
1-800-892-0123

CONTRACT NO. 66261

SECTION 25 RS-2 & 26 RS-4
BEGINS STA 229+55.00

BRIDGE OMISSION
SN 053-0019
STA 236+51.50 TO
STA 239+09.91

EXISTING
TRIPLE RC BOX CULVERT
2 X (5'8" X 4'9") &
1 X (7'4" X 4'9")
STA 359+25.96
SN 053-2003

STA EQUATION
STA 399+08.31 BK =
STA 400+36.75 AH

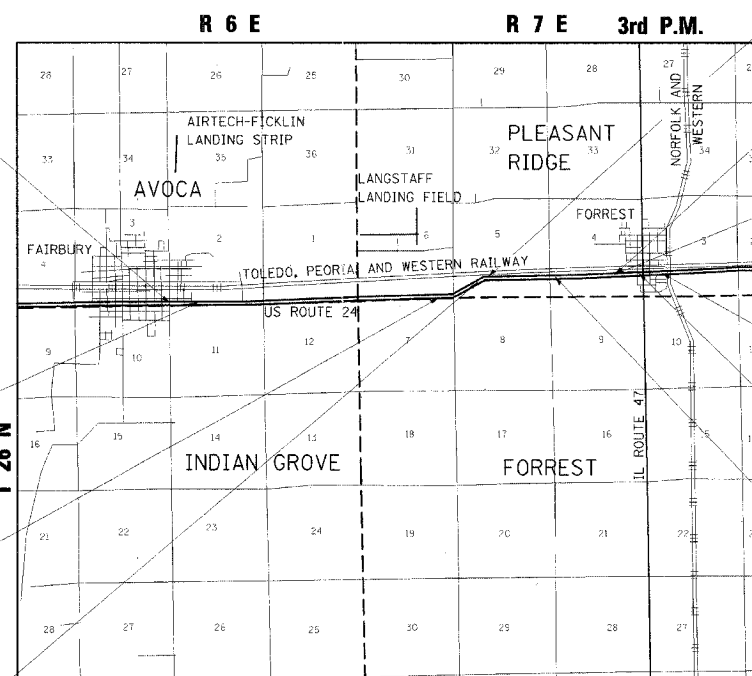

EXISTING
TRIPLE 11' X 7' REINFORCED
CONCRETE BOX CULVERT
STA 404+00.00
SN 053-2029

STA EQUATION
STA 474+92.87 BK =
STA 472+94.34 AH

BRIDGE OMISSION
SN 053-0152
STA 472+94.34 TO
STA 474+79.72

SECTION 25 RS-2 & 26 RS-4
END STA 502+00.00

INTERSECTION IL 47 & US 24
OMISSION
STA 485+60.02 TO
STA 490+03.00

STA EQUATION
STA 432+36.32 BK =
STA 434+99.92 AH

LOCATION MAP
AVOCA, INDIAN GROVE, PLEASANT RIDGE & FORREST TOWNSHIP

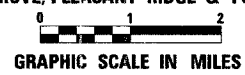

GROSS LENGTH OF SECTION 25 RS-2 & 26 RS-4 = 26,851.49 FEET = 5.09 MILES
NET LENGTH PROJECT = 25,964.72 FEET = 4.92 MILES

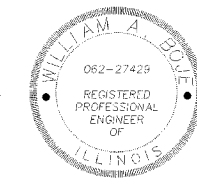

William A. Bode
ILLINOIS PROFESSIONAL ENGINEER NO. 062-27429 DATE 01-31-2005
EXP. 11-30-2005

WOOLPERT
WOOLPERT INC.
343 Fountains Parkway,
Suite 100
Fairview Heights, Illinois 62208-2044
618-632-7004
Fax-618-632-0100

**PRINTED BY THE AUTHORITY
OF THE STATE OF ILLINOIS**