

F.A.P. RTE.	SECTION	COUNTY	TOTAL SHEETS	SHEET NO.
317		LIVINGSTON	205	34
STA. 341+00.00 TO STA. 356+00.00				
CONTRACT NO. 66261				
• 25 RS-2 & 26 RS-4				

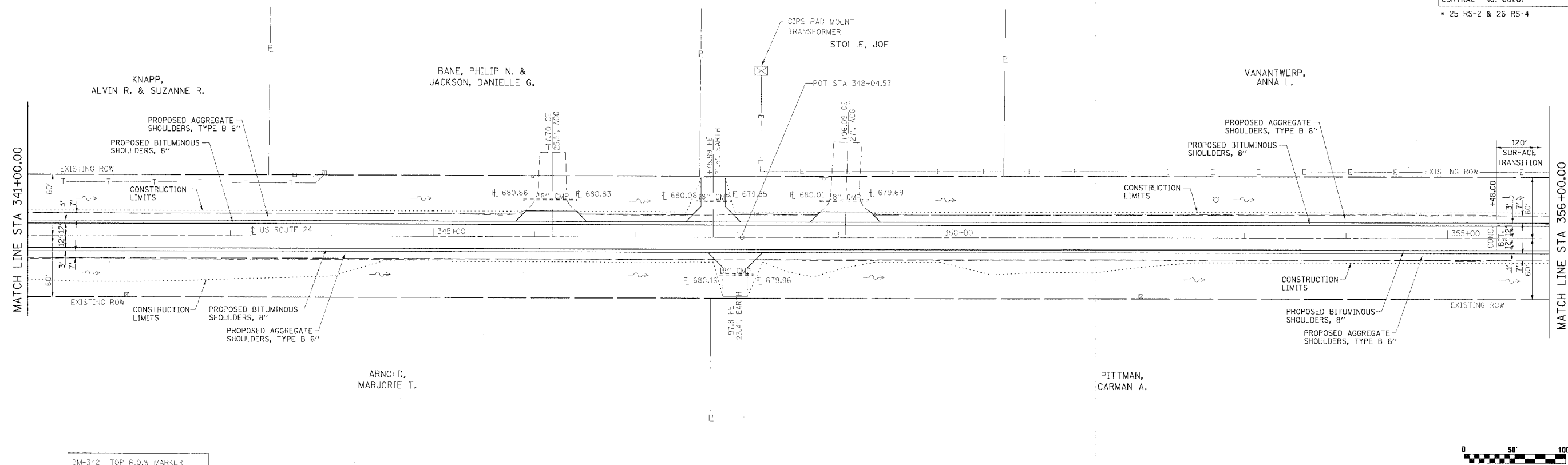

PLAN	DATE
SURVEYED	
ALIGNED	
CHECKED	
BY	
NO.	

PROFILE	DATE
BY	
NO.	



3M-342 TOP R.O.W MARKER
 STA 341+96.00, 50' LT
 ELEV 686.04

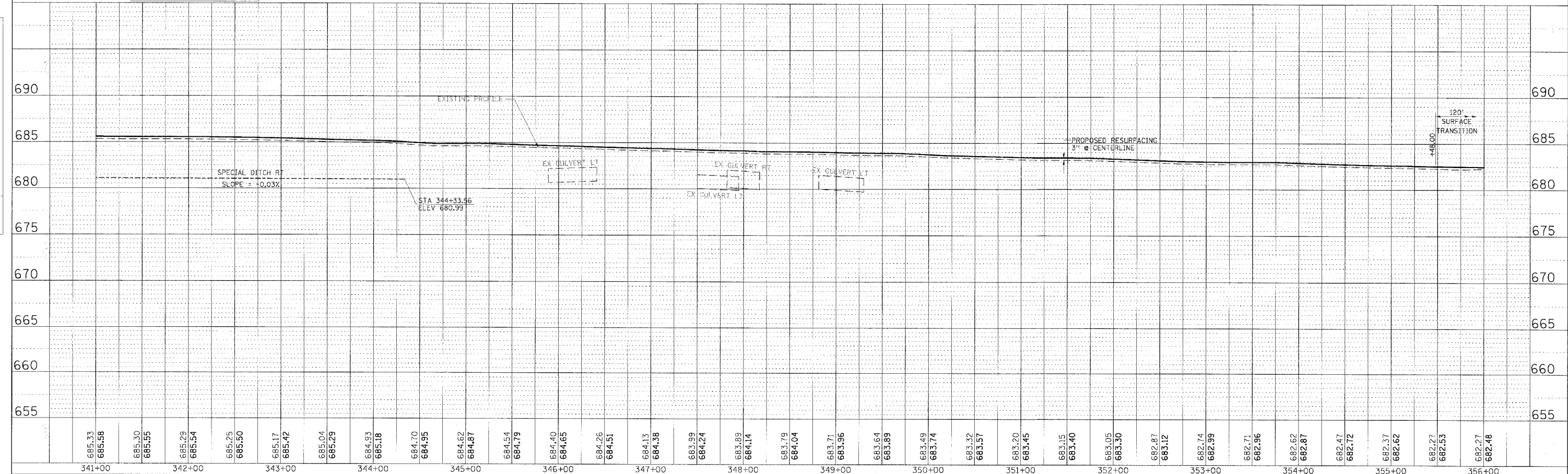

PLAN AND PROFILE, STA 341+00.00 TO STA 356+00.00, FAP 317 (US ROUTE 24)