

| | | | | |
|---------------------|---------|------------|--------------|-----------|
| F.A.P. RTE. | SECTION | COUNTY | TOTAL SHEETS | SHEET NO. |
| 317 | | LIVINGSTON | 205 | 41 |
| STA. | | TO STA. | | |
| CONTRACT NO. 66261 | | | | |
| • 25 RS-2 & 26 RS-4 | | | | |

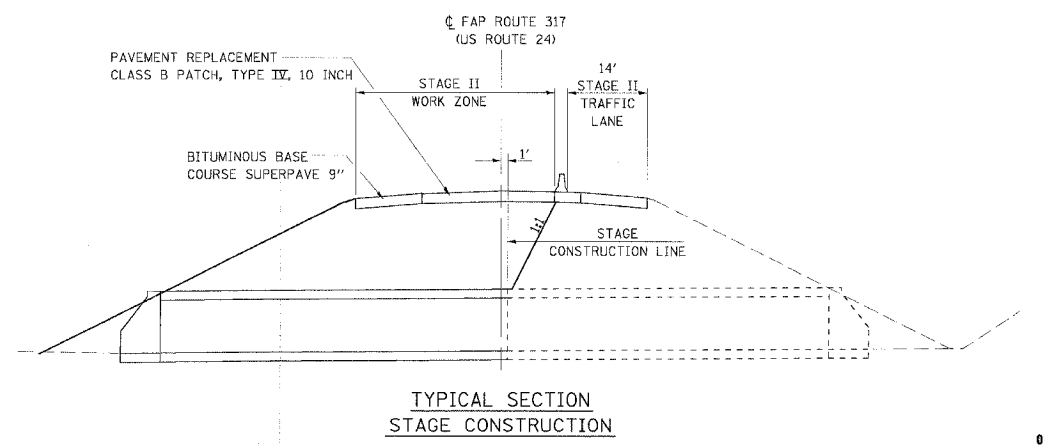
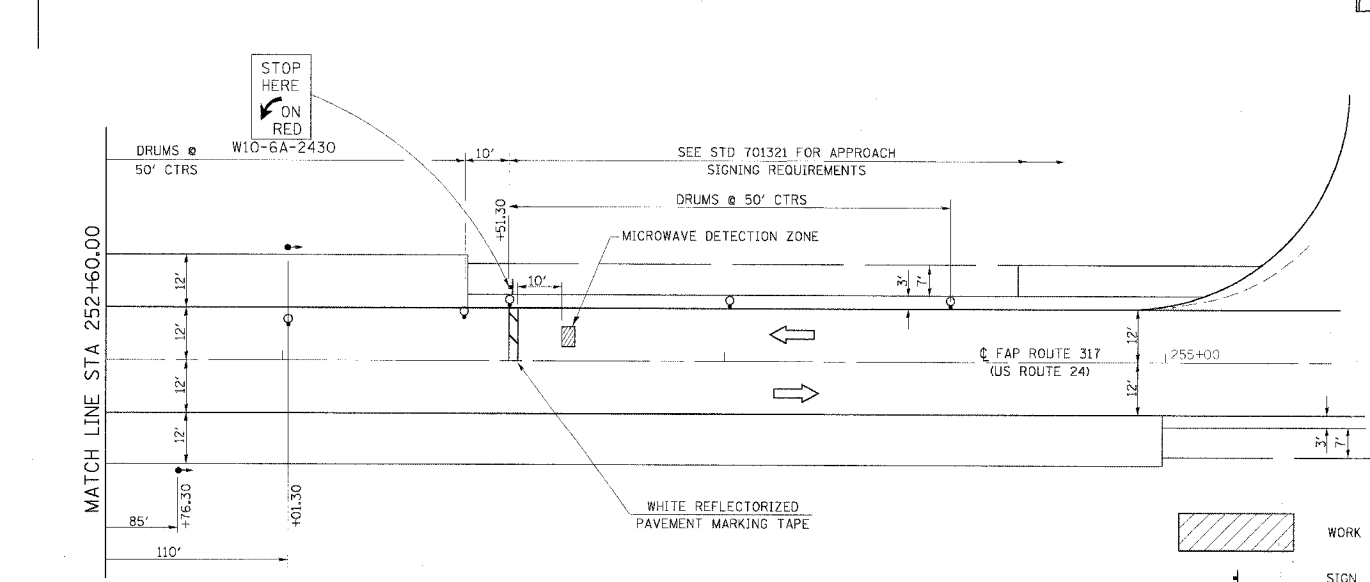
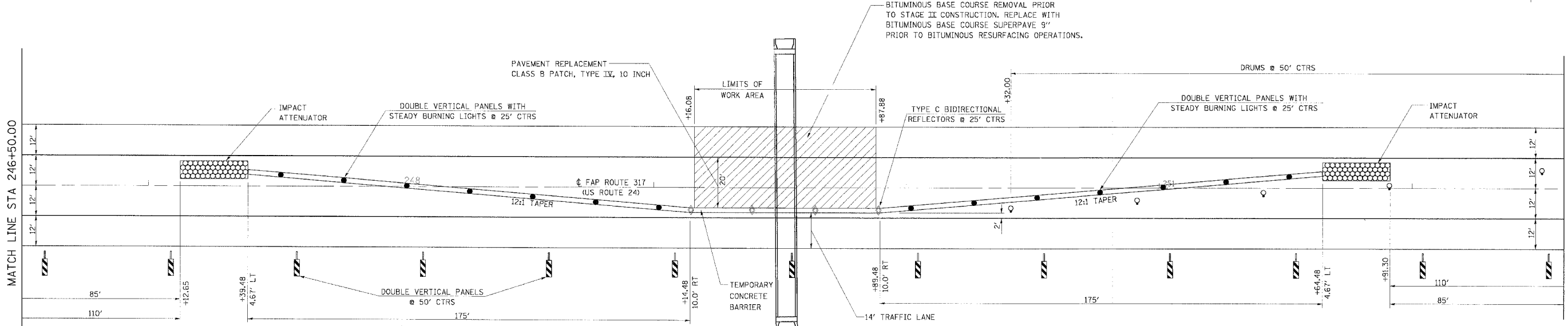
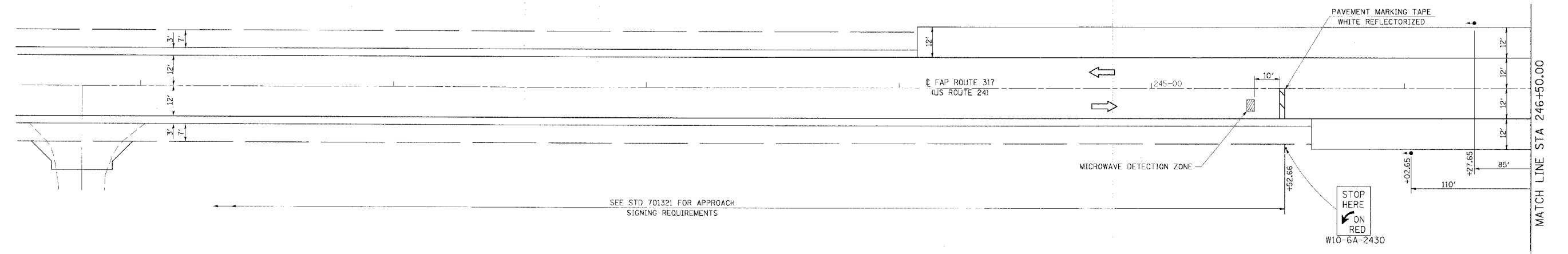

LEGEND

| | |
|--|--|
| | WORK AREA |
| | SIGN |
| | DRUM WITH STEADY BURNING LIGHT |
| | SIGN |
| | TRAFFIC SIGNAL |
| | DRUM WITH STEADY BURNING LIGHT |
| | TRAFFIC SIGNAL |
| | TYPE C BIDIRECTIONAL REFLECTOR |
| | STEADY BURNING LIGHTS AND DOUBLE VERTICAL PANELS |

| REVISIONS | |
|-----------|------|
| NAME | DATE |
| | |
| | |
| | |
| | |
| | |
| | |
| | |
| | |
| | |

ILLINOIS DEPARTMENT OF TRANSPORTATION
TRAFFIC CONTROL AND PROTECTION, STAGE II
 FAP 317 (US ROUTE 24)
 SECTION 25 RS-2 & 26 RS-4
 LIVINGSTON COUNTY
 SCALE: _____
 DATE _____
 DRAWN BY BANDY
 CHECKED BY STELIART