

F.A.P. RTE.	SECTION	COUNTY	TOTAL SHEETS	SHEET NO.
317	•	LIVINGSTON	205	65
STA. 231+19.99		TO STA. 231+50.00		
CONTRACT NO. 66261				
• 25 RS-2 & 26 RS-4				

FINAL SURVEY	NO. _____
DATE	_____
BY	_____
NO. _____	_____

ORIGINAL SURVEY	NO. _____
DATE	_____
BY	_____
NO. _____	_____

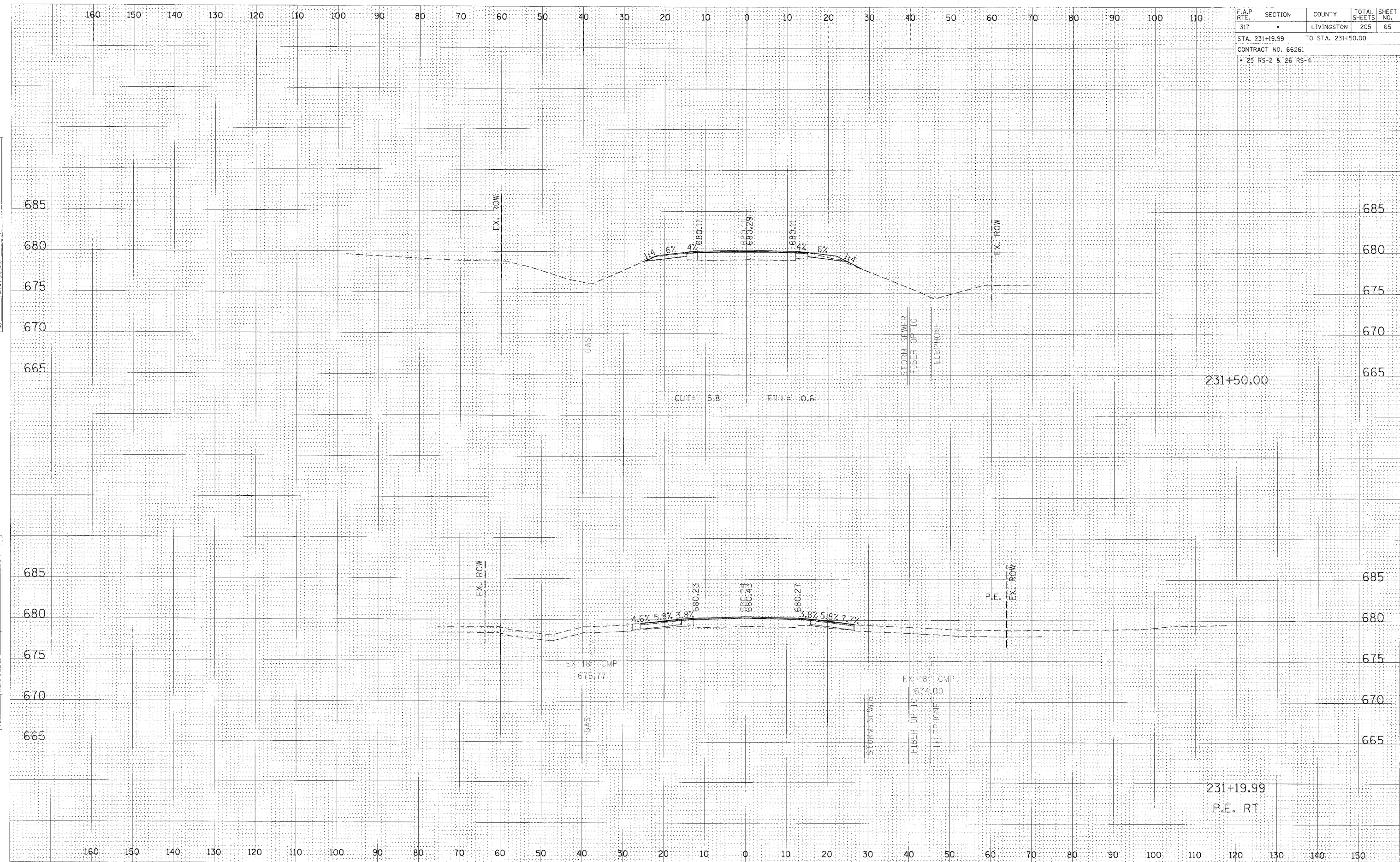

CROSS SECTION, STA 231+19.99 TO 231+50.00, FAP 317 (US ROUTE 24)