

F.A.P. RTE.	SECTION	COUNTY	TOTAL SHEETS	SHEET NO.
317	*	LIVINGSTON	205	69
STA. 233+28.00		TO STA. 233+50.00		
CONTRACT NO. 66261				
• 25 RS-2 & 26 RS-4				

FINL.	DATE
SURVY	BY
NOTE BOOK	
NO.	

ORIGINAL	DATE
SURVY	BY
NOTE BOOK	
NO.	

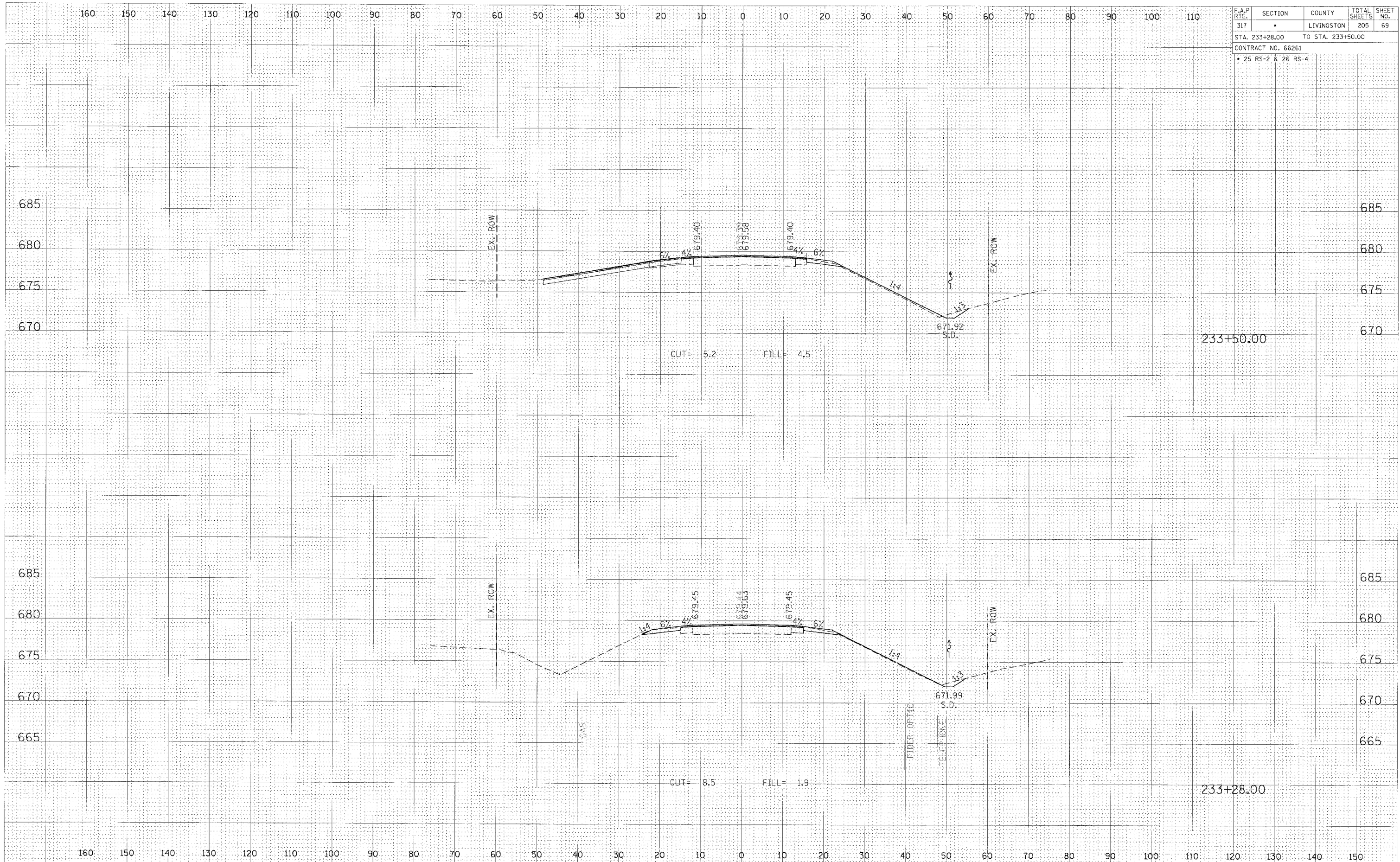

CROSS SECTION, STA 233+28.00 TO 233+50.00, FAP 317 (US ROUTE 24)