

F.A.P. RTE.	SECTION	COUNTY	TOTAL SHEETS	SHEET NO.
317	•	LIVINGSTON	205	74
STA. 239+09.91 TO STA. 239+50.00				
CONTRACT NO. 66261				
• 25 RS-2 & 26 RS-4				

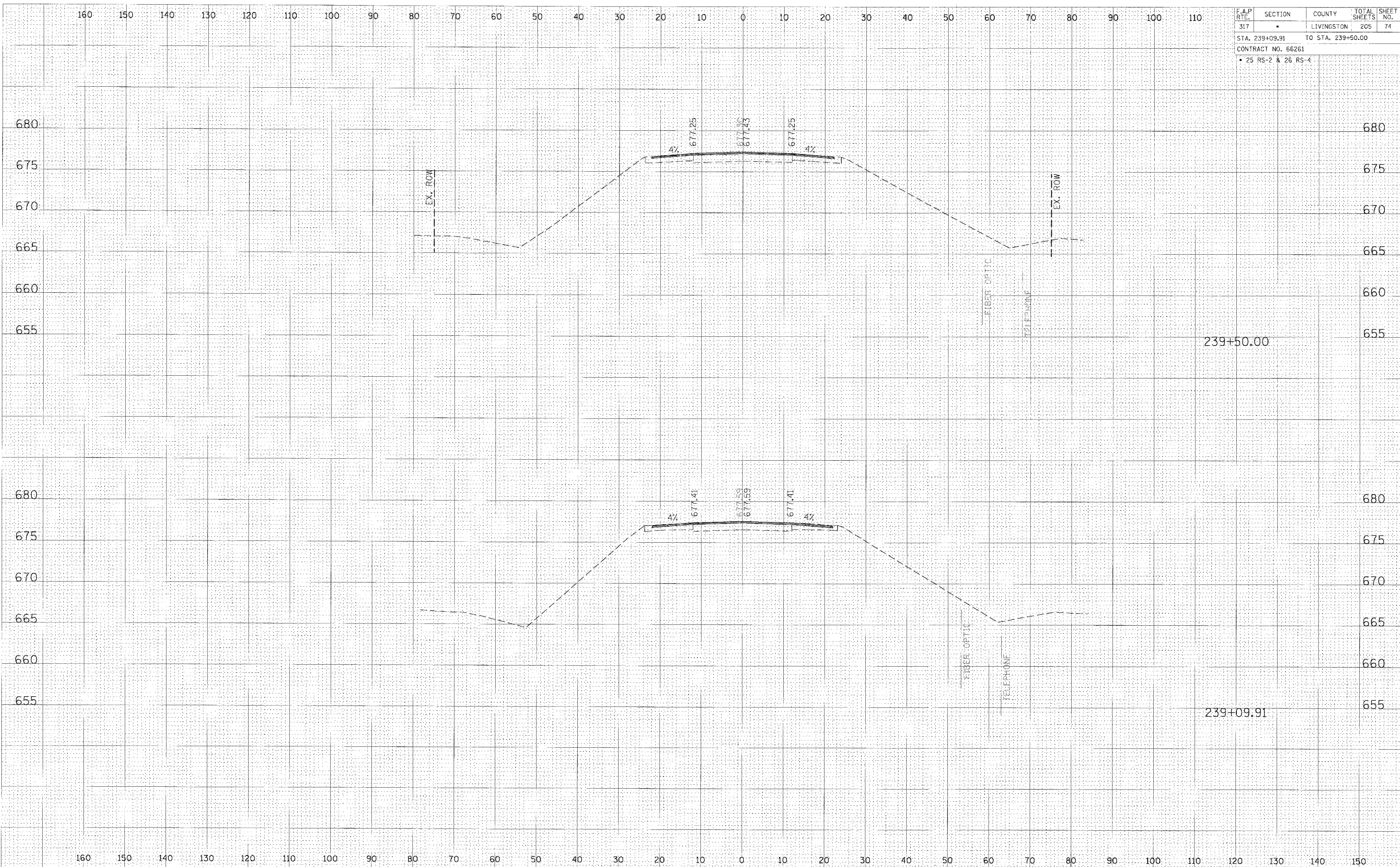

DATE: _____
 SUPERVISOR: _____
 CHECKED: _____
 PLOTTED: _____
 AREAS CHECKED: _____

DATE: _____
 SUPERVISOR: _____
 CHECKED: _____
 PLOTTED: _____
 AREAS CHECKED: _____

CROSS SECTION, STA 239+09.91 TO 239+50.00, FAP 317 (US ROUTE 24)