

F.A.P. RTE.	SECTION	COUNTY	TOTAL SHEETS	SHEET NO.
317		LIVINGSTON	205	82
STA. 246+50.00		TO STA. 247+00.00		
CONTRACT NO. 66261				
• 25 RS-2 & 26 RS-4				

DATE	BY
DATE	BY
DATE	BY

DATE	BY
DATE	BY
DATE	BY

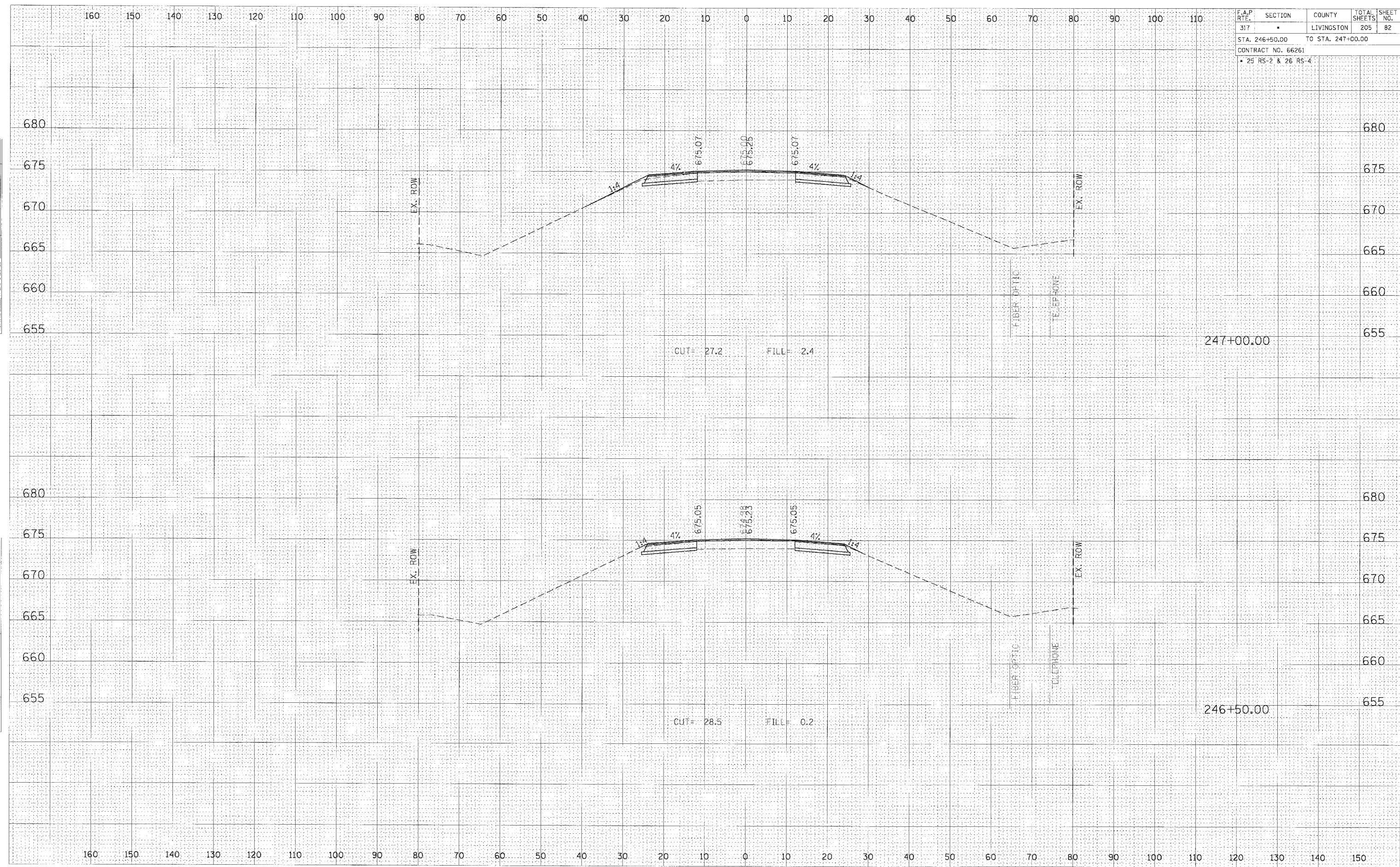

CROSS SECTION, STA 246+50.00 TO 247+00.00, FAP 317 (US ROUTE 24)