

F.A.P. RTE.	SECTION	COUNTY	TOTAL SHEETS	SHEET NO.
317	*	LIVINGSTON	205	86
STA. 250+00.00 TO STA. 250+50.00				
CONTRACT NO. 66261				
* 25 RS-2 & 26 RS-4				

FINAL SURVEY	DATE
NO. 1	
BY	
NO. 1	
NO. 1	
NO. 1	
NO. 1	

ORIGINAL SURVEY	DATE
NO. 1	
BY	
NO. 1	
NO. 1	
NO. 1	
NO. 1	

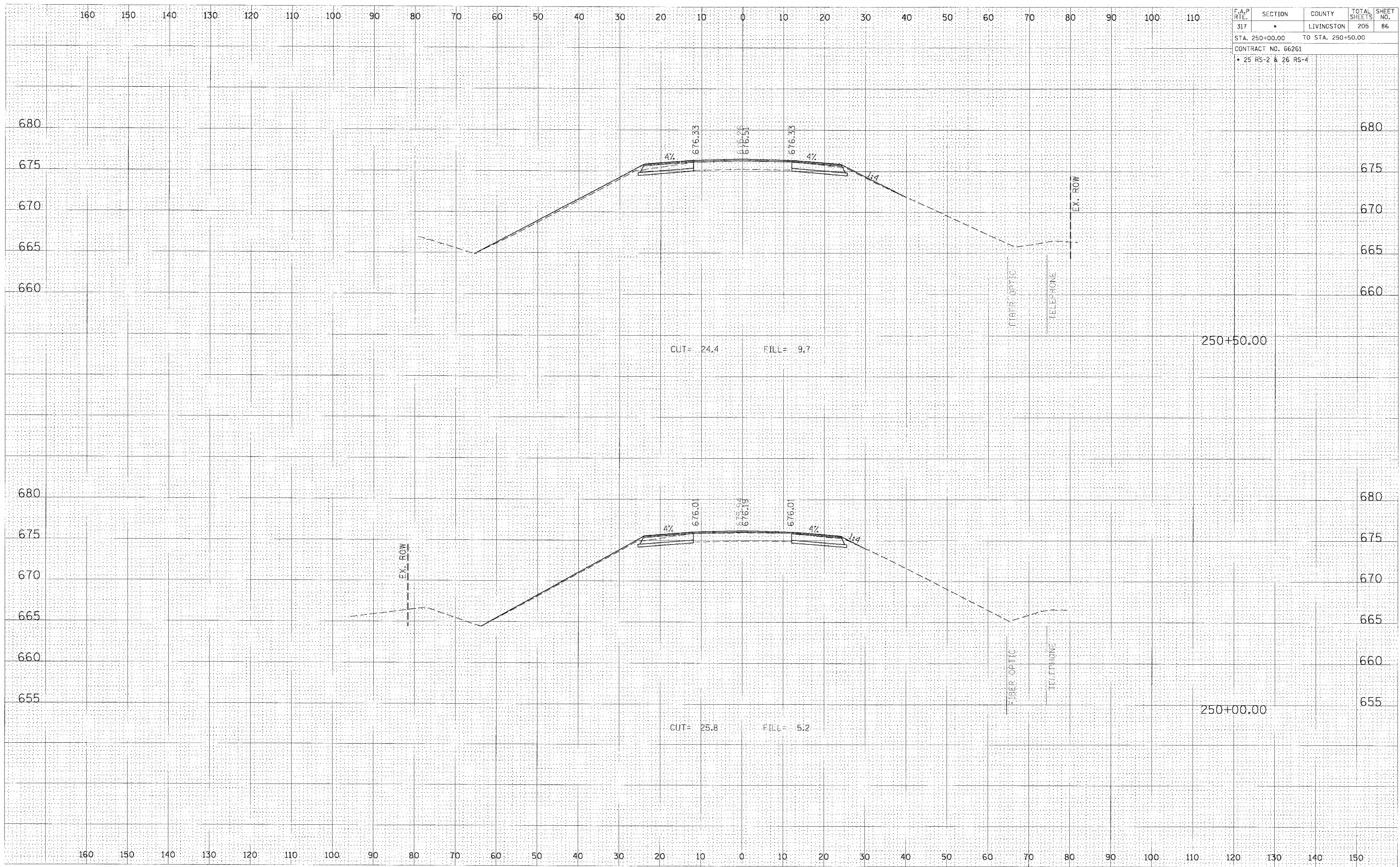

CROSS SECTION, STA 250+00.00 TO 250+50.00, FAP 317 (US ROUTE 24)