

F.A.P. RTE.	SECTION	COUNTY	TOTAL SHEETS	SHEET NO.
317	•	LIVINGSTON	205	94
STA. 258+00.00 TO STA. 258+50.00				
CONTRACT NO. 66261				
• 25 RS-2 & 26 RS-4				

FINAL SURVEY	SURVEYED	PLOTTED	DATE
NO. _____	NO. _____	NO. _____	NO. _____
BY _____	BY _____	BY _____	BY _____
NO. _____	NO. _____	NO. _____	NO. _____

ORIGINAL SURVEY	SURVEYED	PLOTTED	DATE
NO. _____	NO. _____	NO. _____	NO. _____
BY _____	BY _____	BY _____	BY _____
NO. _____	NO. _____	NO. _____	NO. _____

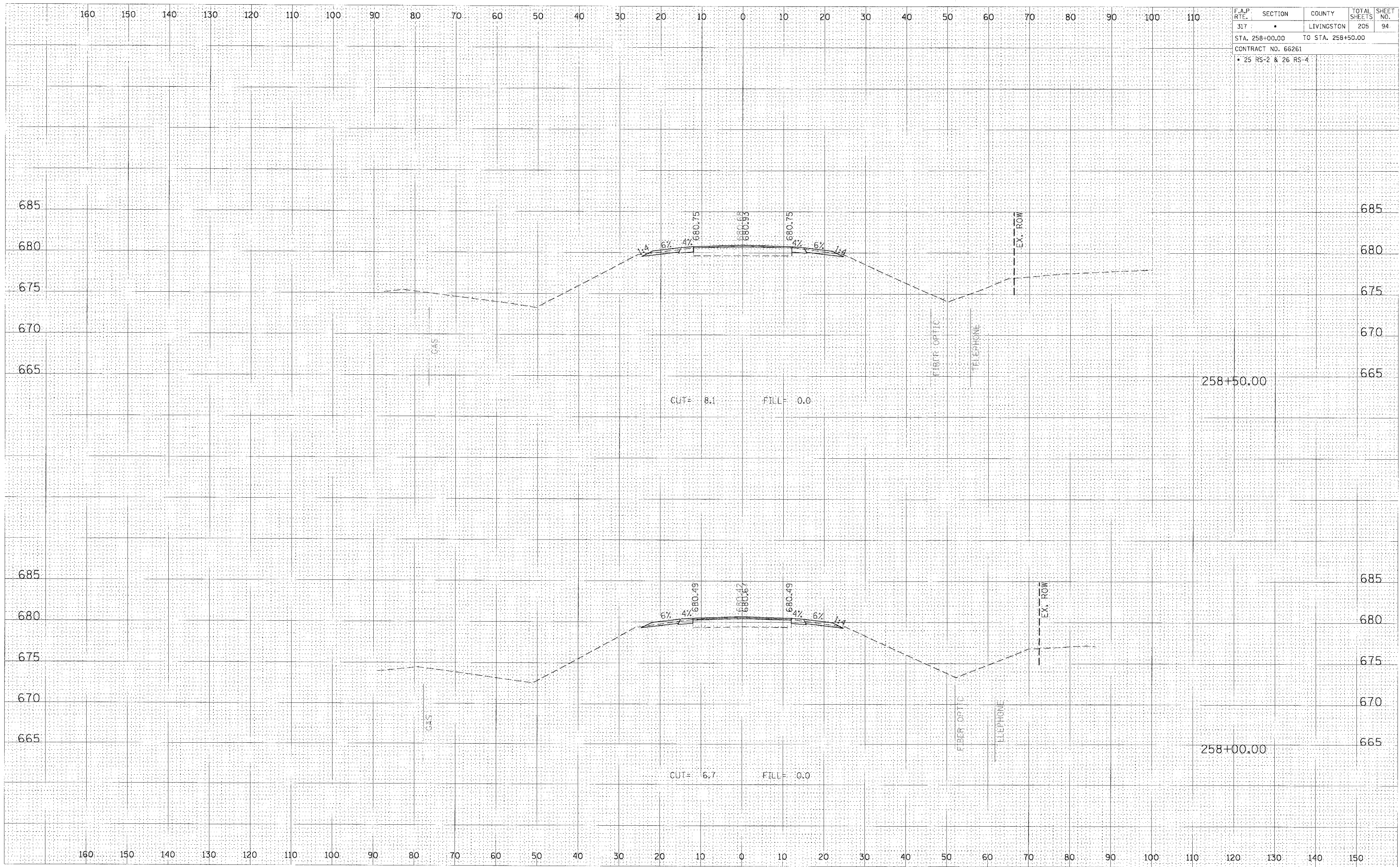

CROSS SECTION, STA 258+00.00 TO 258+50.00, FAP 317 (US ROUTE 24)