

| F.A.P. RTE.                      | SECTION | COUNTY     | TOTAL SHEETS | SHEET NO. |
|----------------------------------|---------|------------|--------------|-----------|
| 317                              | *       | LIVINGSTON | 205          | 97        |
| STA. 261+00.00 TO STA. 261+50.00 |         |            |              |           |
| CONTRACT NO. 66261               |         |            |              |           |
| • 25 RS-2 & 26 RS-4              |         |            |              |           |

FINAL SURVEY BY DATE  
 SURVEY PLOTTED BY DATE  
 NOTE BOOK NO. DATE  
 AREAS CHECKED

ORIGINAL SURVEY BY DATE  
 SURVEY PLOTTED BY DATE  
 NOTE BOOK NO. DATE  
 AREAS CHECKED

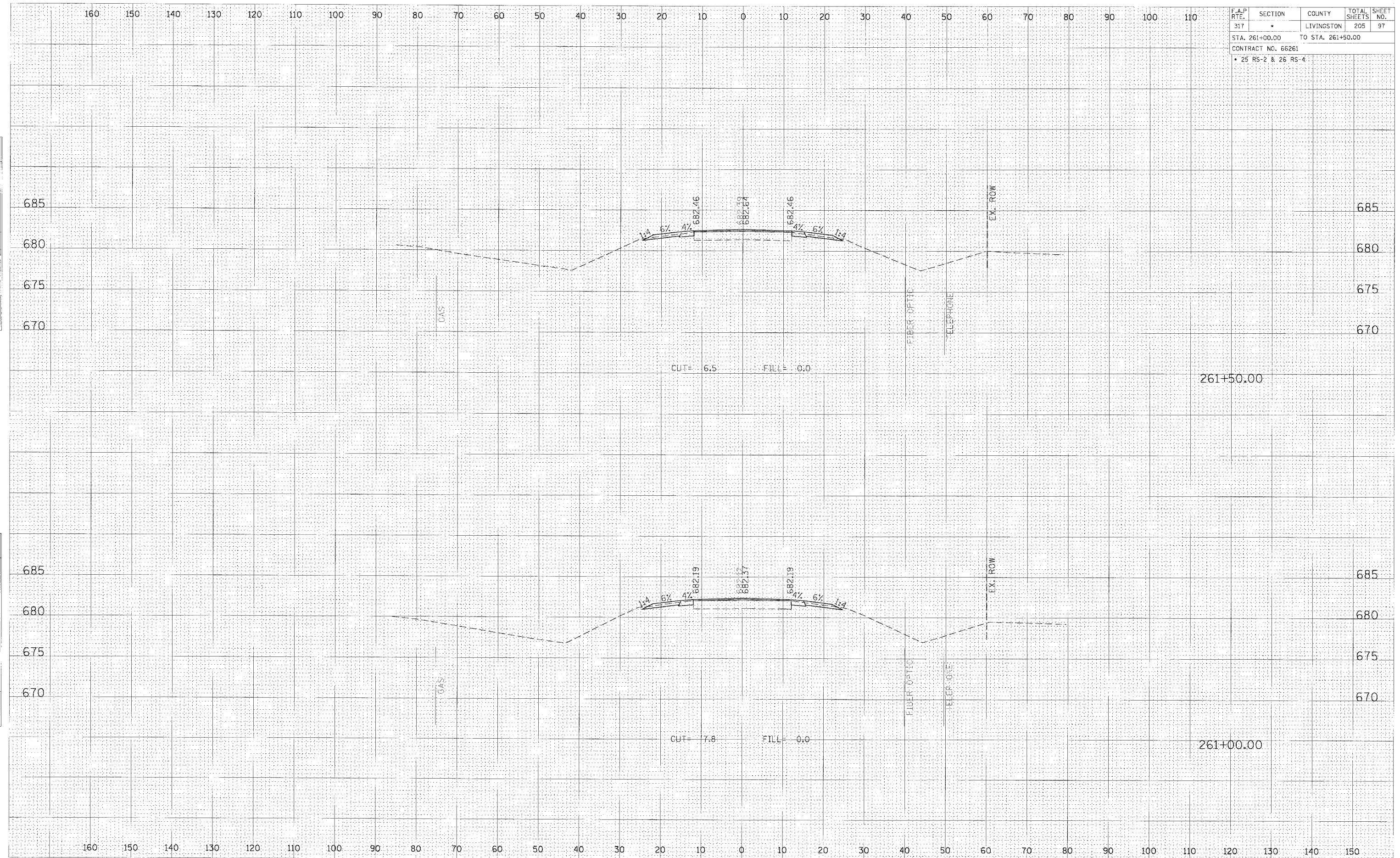

CROSS SECTION, STA 261+00.00 TO 261+50.00, FAP 317 (US ROUTE 24)