

F.A.P. RTE.	SECTION	COUNTY	TOTAL SHEETS	SHEET NO.
317	•	LIVINGSTON	205	98
STA. 262+00.00 TO STA. 262+50.00				
CONTRACT NO. 66261				
• 25 RS-2 & 26 RS-4				

FINAL SURVEY	REVIEWED	DATE
NOTE BOOK	PLOTTED	
NO.	TEMPLATE	
	AREAS CHECKED	

ORIGINAL SURVEY	REVIEWED	DATE
NOTE BOOK	PLOTTED	
NO.	TEMPLATE	
	AREAS CHECKED	

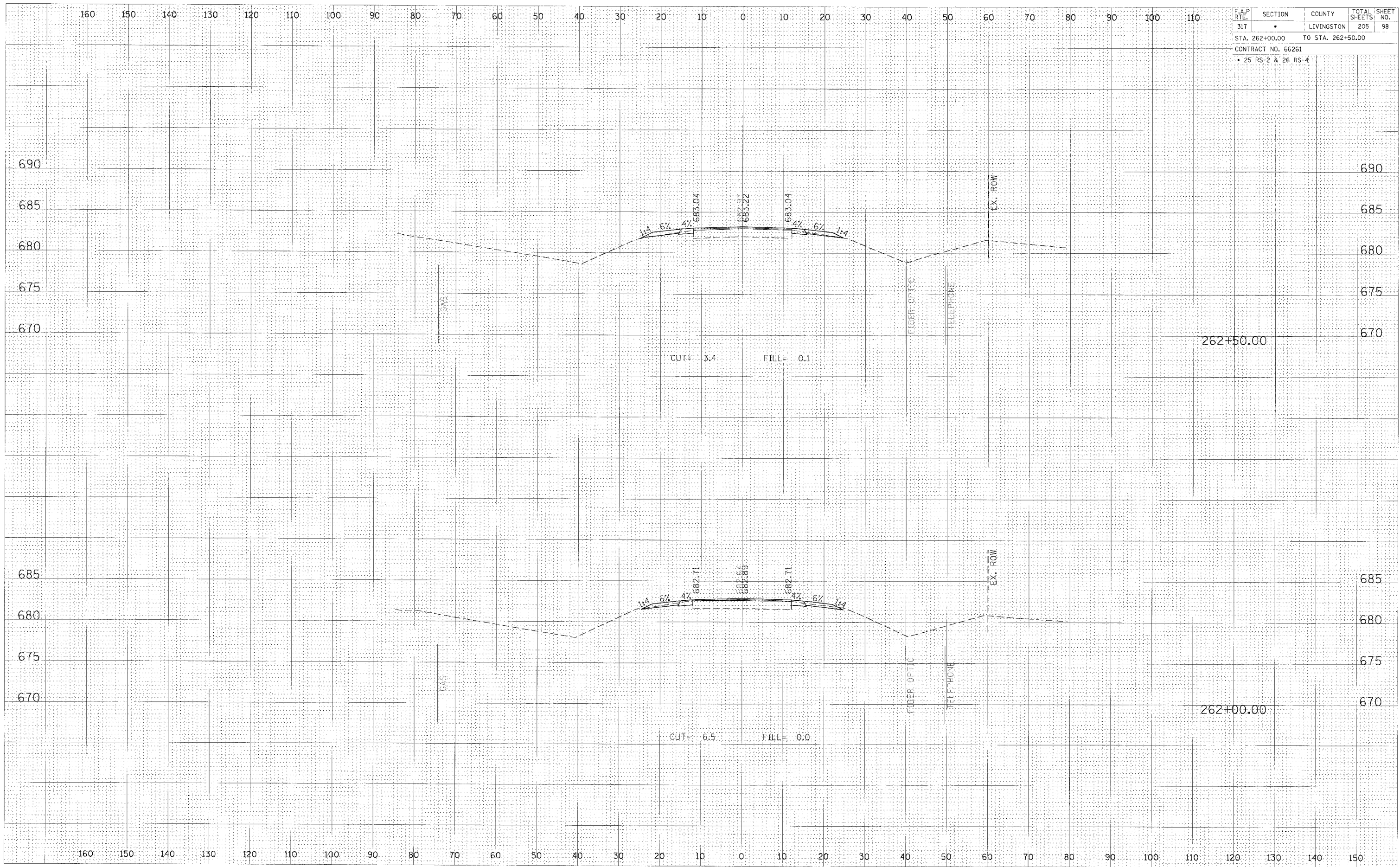

CROSS SECTION, STA 262+00.00 TO 262+50.00, FAP 317 (US ROUTE 24)