

F.A.P. RTE.	SECTION	COUNTY	TOTAL SHEETS	SHEET NO.
317	•	LIVINGSTON	205	108
STA. 271+00.00 TO STA. 271+34.99				
CONTRACT NO. 66261				
• 25 RS-2 & 26 RS-4				

FINAL SURVEY	SUBMITTED	DATE
NOTE BOOK	PLOTTED	
NO.	TEMPERATURE	
	AREAS CHECKED	

ORIGINAL SURVEY	SUBMITTED	DATE
NOTE BOOK	PLOTTED	
NO.	TEMPERATURE	
	AREAS CHECKED	

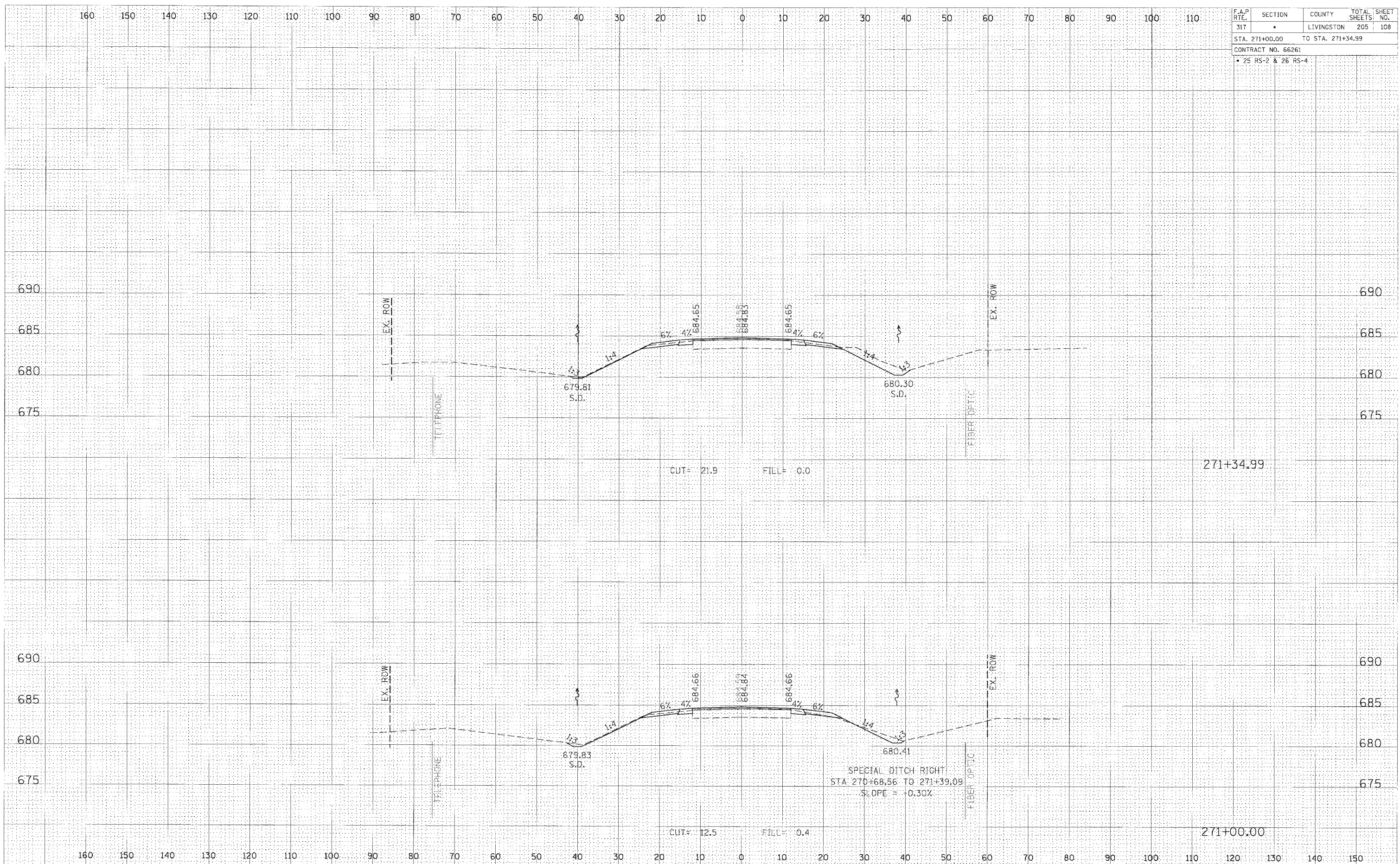

CROSS SECTION, STA 271+00.00 TO 271+34.99, FAP 317 (US ROUTE 24)