

F.A.P. RTE.	SECTION	COUNTY	TOTAL SHEETS	SHEET NO.
317	•	LIVINGSTON	205	128
STA. 289+05.37		TO STA. 289+50.00		
CONTRACT NO. 66261				
• 25 RS-2 & 26 RS-4				

DATE	
BY	
APPROVED	
NO.	

DATE	
BY	
APPROVED	
NO.	

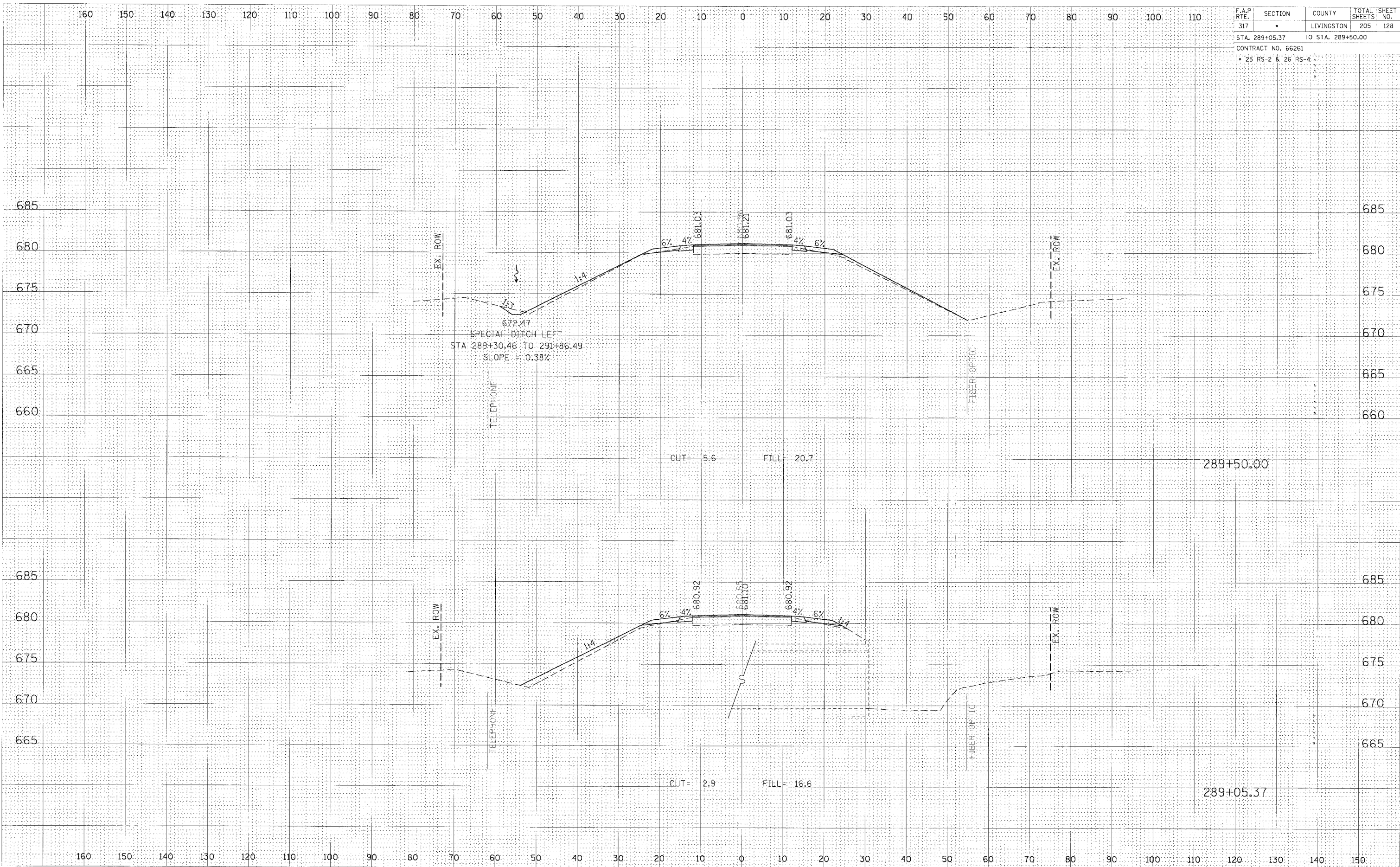

CROSS SECTION, STA 289+05.37 TO 289+50.00, FAP 317 (US ROUTE 24)