

F.A.P. RTE.	SECTION	COUNTY	TOTAL SHEETS	SHEET NO.
317	*	LIVINGSTON	205	158
STA. 315+00.00		TO STA. 315+30.00		
CONTRACT NO. 66261				
• 25 RS-2 & 26 RS-4				

DATE	BY
NO. 1 BOOK	NO. 2 BOOK
NO.	

DATE	BY
NO. 1 BOOK	NO. 2 BOOK
NO.	

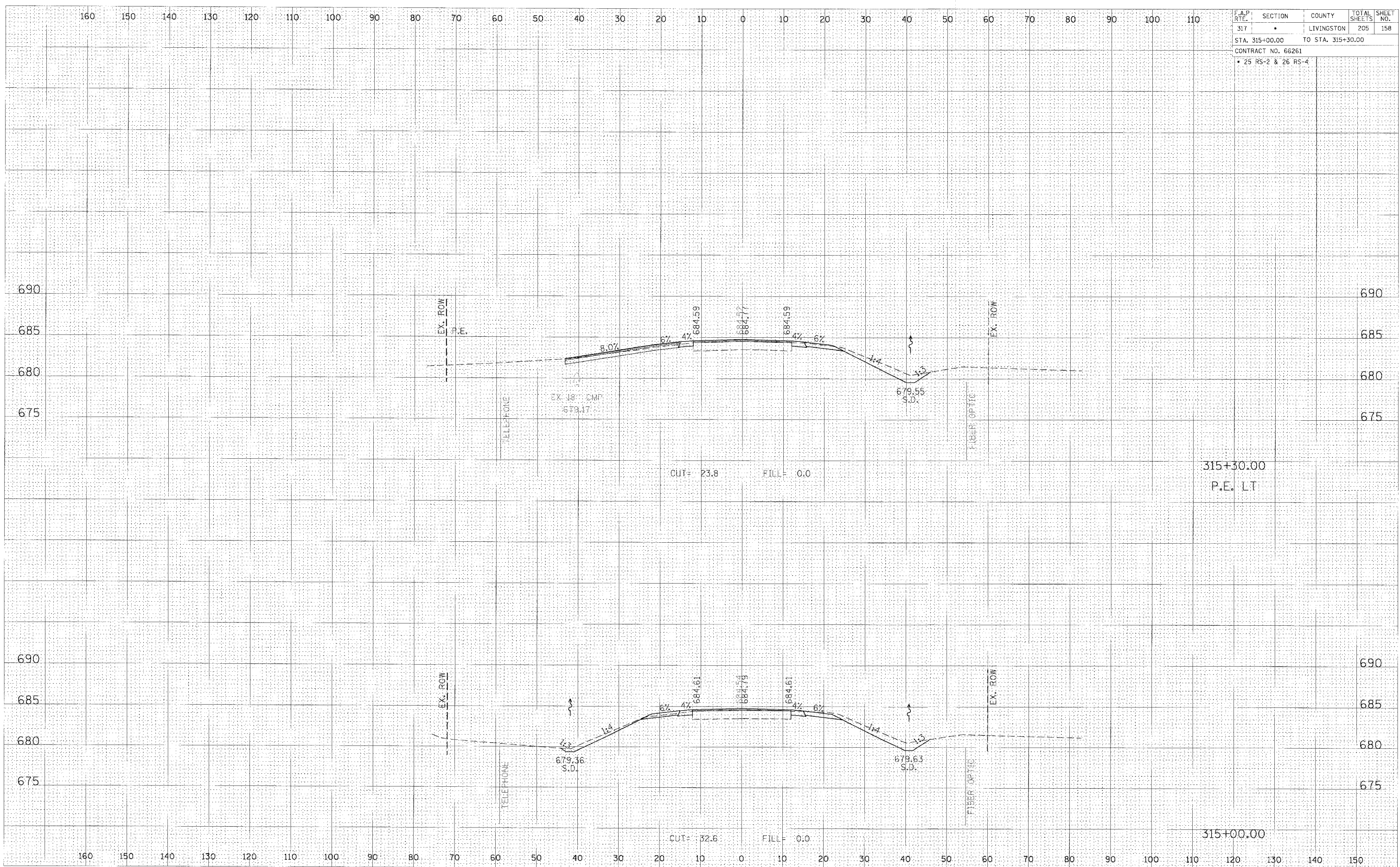

CROSS SECTION, STA 315+00.00 TO 315+30.00, FAP 317 (US ROUTE 24)