

F.A.P. RTE.	SECTION	COUNTY	TOTAL SHEETS	SHEET NO.
317	•	LIVINGSTON	205	188
STA. 343+00.00		TO STA. 343+50.00		
CONTRACT NO. 66261				
• 25 RS-2 & 26 RS-4				

FINAL SURVEY BY DATE
 SURVEYED BY DATE
 ADJUSTED BY DATE
 NOTE BOOK NO.
 AREAS CHECKED

ORIGINAL SURVEY BY DATE
 SURVEYED BY DATE
 ADJUSTED BY DATE
 NOTE BOOK NO.
 AREAS CHECKED

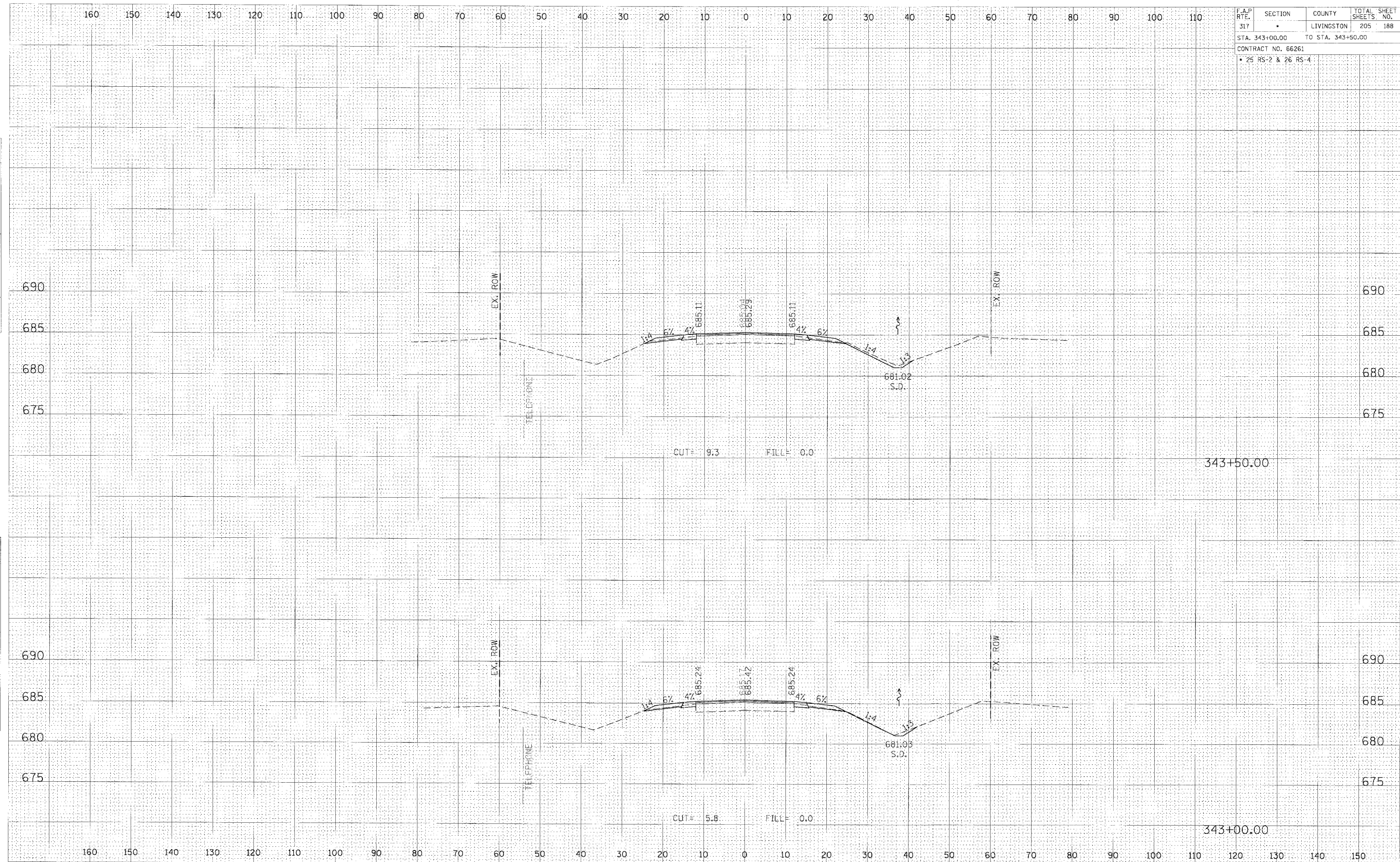

CROSS SECTION, STA 343+00.00 TO 343+50.00, FAP 317 (US ROUTE 24)