

F.A.P. RTE.	SECTION	COUNTY	TOTAL SHEETS	SHEET NO.
317		LIVINGSTON	205	189
STA. 344+00.00 TO STA. 345+00.00				
CONTRACT NO. 66261				
• 25 RS-2 & 26 RS-4				

DATE	
BY	
FINAL SURVEY	
NOTE BOOK	
NO.	

DATE	
BY	
ORIGINAL SURVEY	
NOTE BOOK	
NO.	

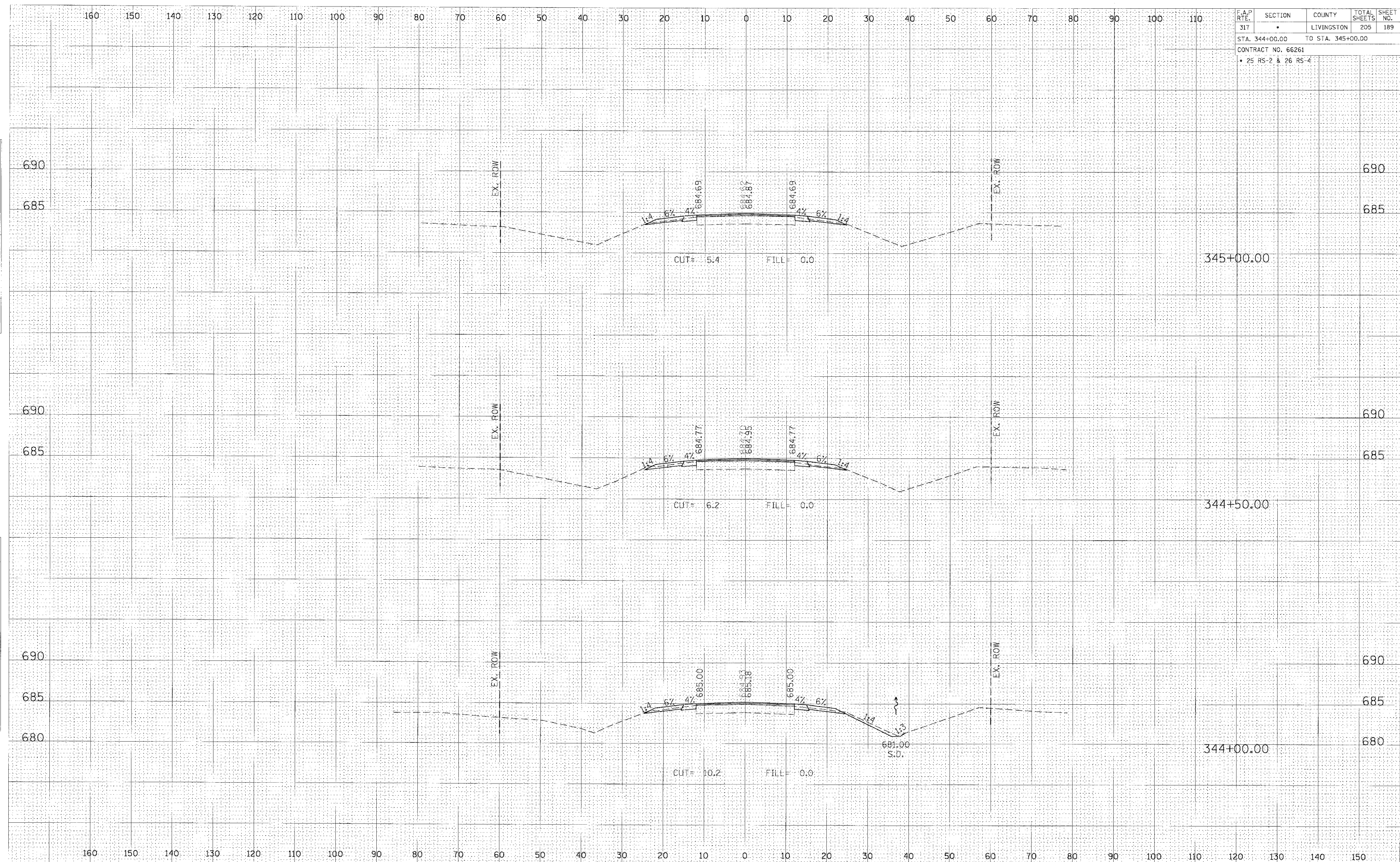

CROSS SECTION, STA 344+00.00 TO 345+00.00, FAP 317 (US ROUTE 24)